



EDIFIER B700 Soundbar System User Manual

[Home](#) » [Edifier](#) » EDIFIER B700 Soundbar System User Manual 

Contents

- [1 EDIFIER B700 Soundbar System](#)
- [2 Product Information](#)
- [3 What's in the Box](#)
- [4 Functional Operation – Soundbar](#)
- [5 Important safety instruction](#)
- [6 Functional Operation](#)
- [7 Soundbar Wall Mount Bracket Installation](#)
- [8 Operating Instructions](#)
- [9 Troubleshooting](#)
- [10 Documents / Resources](#)
 - [10.1 References](#)
- [11 Related Posts](#)

EDIFIER®

EDIFIER B700 Soundbar System



Product Information

The B700 Soundbar is a high-quality audio device that enhances the audio experience of your TV or other devices. It comes with a subwoofer for deep bass and includes various input options such as Bluetooth, HDMI, optical, coaxial, and AUX. The soundbar also has a display window, volume control buttons, and a USB port for service purposes. The package includes all the necessary cables, a remote control, a wall mount bracket, and a user manual.

What's in the Box

- Subwoofer
- Remote control
- Soundbar Wall mount bracket
- 4K HD HDMI cable
- 3.5mm-RCA audio cable
- Fiber optic audio cable
- Power cable x2
- Power adapter
- Screw for wall mounting x5
- AAA battery x1
- Plastic wall anchor x5
- Hook x2
- User manual

Functional Operation – Soundbar

Front view:

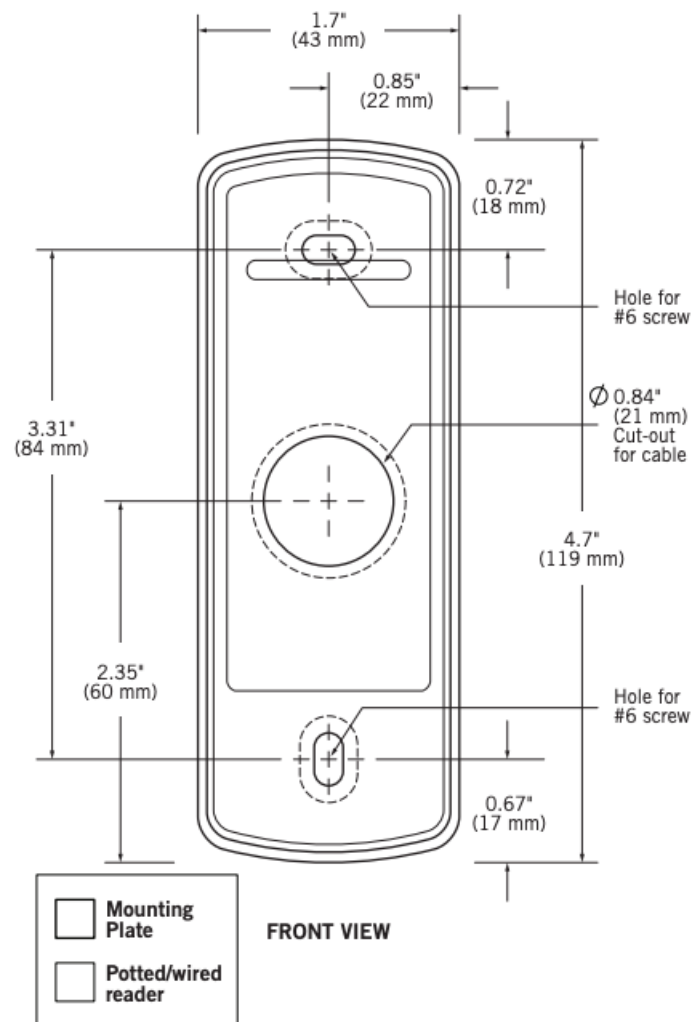

Top view:

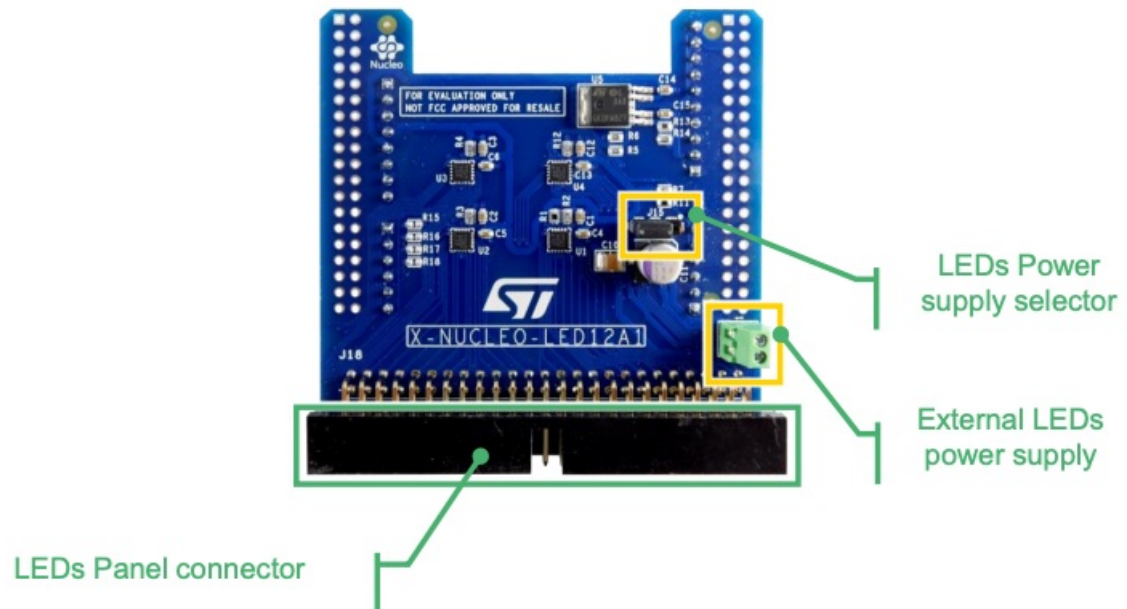

Back view:

18. Power switch
19. Power cable port

The soundbar and subwoofer are pre-paired at the factory. If the wireless connection fails, follow the provided instructions to complete the pairing again.

Remote Control:

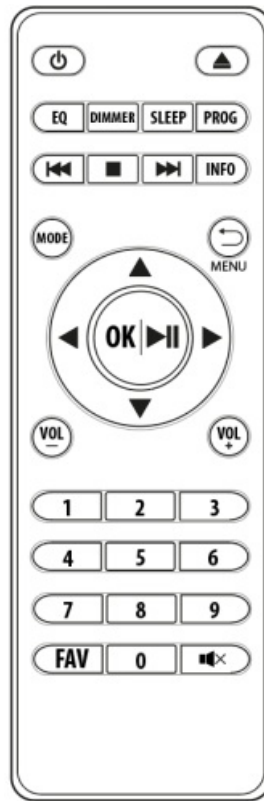

The remote control allows you to control various functions of the soundbar. It has buttons for power on/off, sound effect mode, movie, music, voice, game, bass volume, treble, HDMI inputs, HDMI ARC, optical/coaxial input, and AUX input. To install the remote control battery:

1. Press the remote control battery cover downward with your thumb and follow the arrow direction to remove the cover.
2. Insert a AAA battery into it, ensuring correct polarity (+ and -).

Note: Replace the batteries when the remote control becomes less sensitive or has a shorter control distance. Avoid mixing old and new batteries.

Soundbar Wall Mount Bracket Installation:

To install the soundbar wall mount bracket:

1. Adhere the wall mount bracket to an appropriate position on the wall.
2. Align the centerline of the wall mount bracket with that of the TV.
3. Mark 4 holes for mounting.

Note: Ensure that the wall can withstand the weight of the soundbar. Improper installation may lead to accidents,

injuries, or product damage.

Important safety instruction

- Please read the instructions carefully. Keep it in safe place for future reference.
- Use only accessories approved by the manufacturer.
- Install the instrument properly by following the instructions in the device connection section.
- Using the product in a 0-35°C environment is recommended. Shipping and storing the product in a 0-35°C environment is recommended.
- To reduce the risk of fire and electric shock, do not expose the product to rain or moisture.
- Do not use this product near water. Do not immerse the product into any liquid or have it exposed to dripping or splashing.
- Do not install or use this product near any heat source (e.g. radiator, heater, stove, or other devices that generate heat).
- Do not place any object filled with liquids, such as vases on the product; neither should any open fire, such as lighted candles be placed on the product.
- Do not block any ventilation openings. Do not insert any object into ventilation openings or slots. It may cause fire or electric shock.
- Keep sufficient clearance around the product to maintain good ventilation (minimum 5cm is recommended).
- Do not force a plug into the jack. Before connection, check for blockage in the jack and whether the plug matches the jack and is oriented to the right direction.
- Keep the provided accessories and parts (such as screws) away from children to prevent from being swallowed by mistake.
- Do not open or remove the housing yourself. It may expose you to dangerous voltage or other hazardous risks. Regardless the cause of damage (such as damaged wire or plug, exposure to liquid splash or foreign object falling in, exposure to rain or moisture, product not working or being dropped, etc.), the repair has to be performed by an authorized service professional immediately.
- Before cleaning the product with dry cloth, always turn off the product and disconnect the power plug first.
- Never use strong acid, alkali, gasoline, alcohol, or other chemical solvents to clean the product surface. Use only neutral solvent or clear water for cleaning.
- The product must be used at an altitude of lower than 2000m.
- Do not connect this product to the same power outlet used by an appliance controlled by an inverter or motor (such as a refrigerator, washing machine, microwave oven or air conditioner). Power supply noise may cause this product to malfunction or produce significant noise based on how the appliance is used. If it is not accessible to use a separate power outlet, please connect a power noise filter between this product and the power outlet.

Excessively loud music may lead to hearing loss. Please keep the volume in a safe range.

Correct Disposal of this product. This marking indicates that this product should not be disposed with other household wastes throughout the EU. To prevent possible harm to the environment or human health from uncontrolled waste disposal, recycle it responsibly to promote the sustainable reuse of material resources. To return your used device, please use the return and collection systems or contact the retailer where the product was purchased. They can take this product for environmental safe recycling.

Use only with the cart, stand, tripod, bracket, or table specified by the manufacturer, or sold with the apparatus. When a cart is used, use caution when moving the cart/apparatus combination to avoid injury from tip-over.



Excessively loud music may lead to hearing loss. Please keep the volume in a safe range.



Correct Disposal of this product. This marking indicates that this product should not be disposed with other household wastes throughout the EU. To prevent possible harm to the environment or human health from uncontrolled waste disposal, recycle it responsibly to promote the sustainable reuse of material resources. To return your used device, please use the return and collection systems or contact the retailer where the product was purchased. They can take this product for environmental safe recycling.



Use only with the cart, stand, tripod, bracket, or table specified by the manufacturer, or sold with the apparatus. When a cart is used, use caution when moving the cart/apparatus combination to avoid injury from tip-over.

Power warning:

1. Place the product near the power outlet for easy use.
2. Before use, make sure that the operating voltage is the same as your local power supply. Correct operating voltage can be found on the product plate.
3. For safety purpose, unplug the product during lightning storms or when unused for extended periods of time.
4. Under normal conditions, the power supply may get hot. Please keep good ventilation in the area and exercise caution.
5. Product nameplate and safety warning labels on the housing or bottom of the product or power adaptor.



This symbol is to alert the user to the presence of un-insulated dangerous voltage within the product's enclosure that may be of sufficient magnitude to constitute a risk of electric shock to persons.



This symbol is to warn the user not to disassemble the enclosure of the product and there is no user-replaceable part inside. Take the product to an authorized service center for repair.



This symbol indicates that the product is for indoor use only.



This symbol indicates that the product is for indoor use only.

The MAINS plug is used as the disconnect device, the disconnect device shall remain readily operable. For wireless product:

1. Wireless product may generate shortwave radio frequencies and interfere with the normal use of other

electronic devices or medical equipment.

2. Turn off the product when it's disallowed. Do not use the product in medical facilities, on airplane, at gas stations, near automatic gates, automatic fire alarm system or other automated devices.
3. Do not use the product in the vicinity of a pacemaker within a 20cm range. The radio waves may affect the normal operation of the pacemaker or other medical devices.

What's in the Box

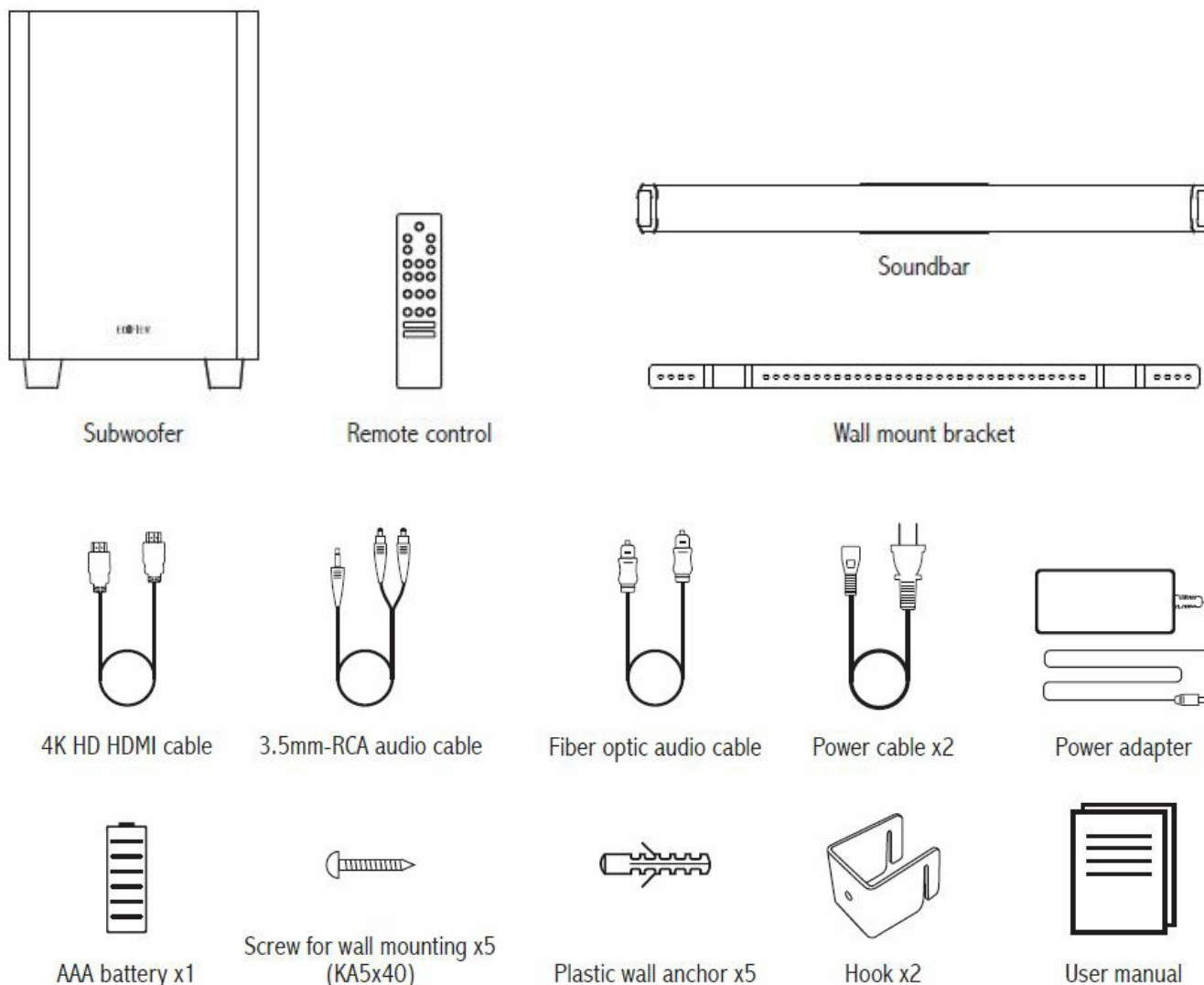

Note:

- Images are for illustrative purposes only and may differ from the actual product.
- For the need of technical improvement and system upgrade, information and specifications contained herein may be slightly different from actual product. If any difference is found, the actual product prevails.

Functional Operation

Soundbar

- 1.

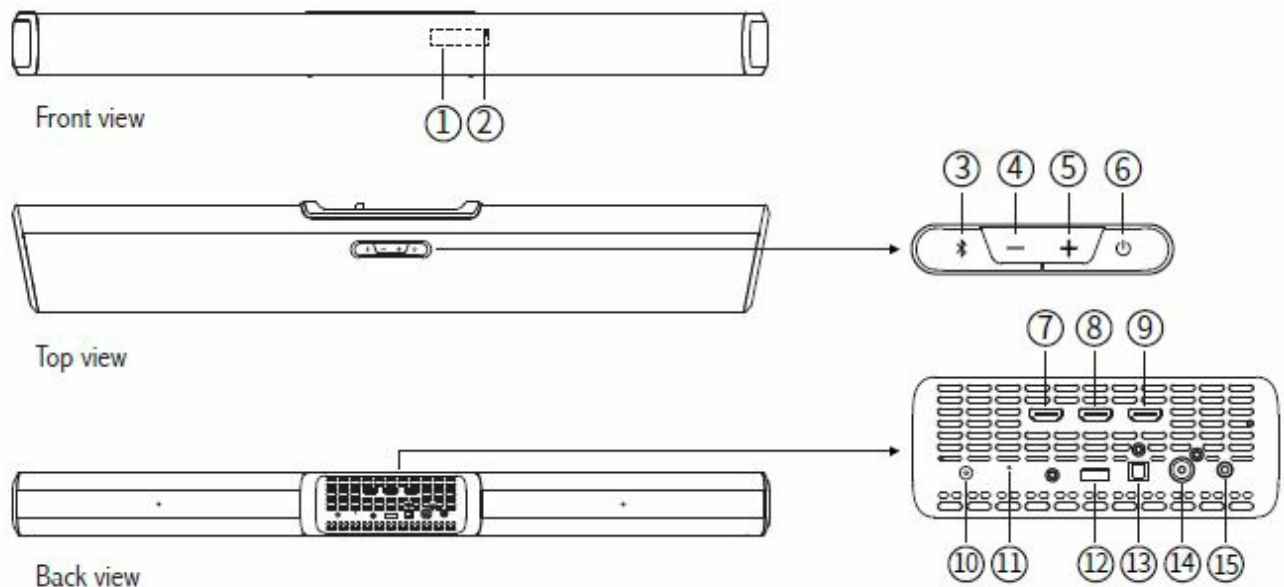

Display window

2. Receiver window for remote control

3. Bluetooth input Press: Bluetooth input Press and hold: disconnect Bluetooth (Bluetooth connected)

4. Volume down Press: volume down Press and hold: previous track (Bluetooth connected)

5. Volume up Press: volume up Press and hold: next track (Bluetooth connected)

6. Power switch/mode switch button Press: switch mode "HDMI ARC → HDMI 1 → HDMI 2 → OPT → COAX → Bluetooth → AUX" Press and hold: power on/off

7. eARC/ARC output

8. HDMI IN1 input

9. HDMI IN2 input

10. Power cable port

11. Subwoofer pairing button on the soundbar

12. USB port (service only)

13. Optical input

14. Coaxial input

15. AUX input

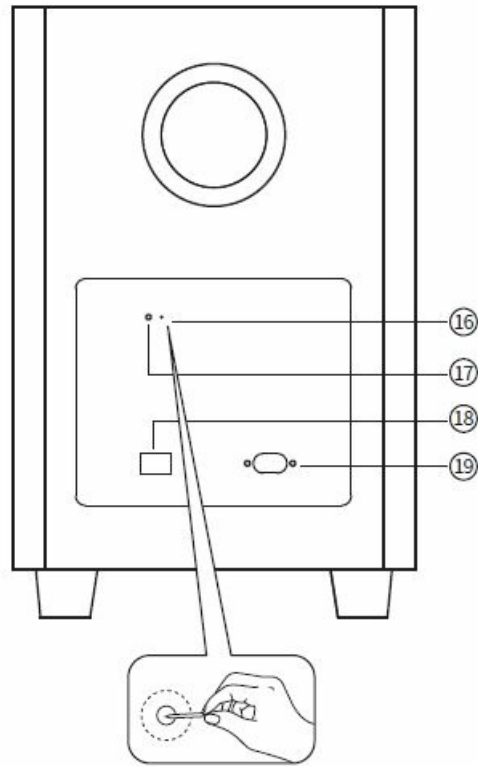

(same operation for the “11” point)

Subwoofer

16. Soundbar pairing button on the subwoofer

The B700 Soundbar has been paired with the subwoofer before leaving factory. The wireless connection is supposed to resume automatically when both active speaker and subwoofer are powered on, and the red indicator will be constantly lit. If the wireless connection fails to resume, please follow the steps below to complete the pairing again.³

- Power on the subwoofer, the status indicator should blink slowly, which means no active wireless connection;
- Press the “PAIR” button on the back panel of the subwoofer to put it into pairing mode. The status indicator will blink rapidly;
- Press the “PAIR” button on the back panel of the active speaker, or press and hold the ” ” button for 3s on the remote control to put it into pairing mode. The “PAIR” icon will show and blink rapidly in the display window; Wait until the
- status indicator on the subwoofer is lit constantly and the “PAIR” icon is lit for 2s in the display window on the active speaker. Then the pairing is done and a wireless connection is made.

17. Status indicator

18. Power switch

19. Power cable port

Remote Control

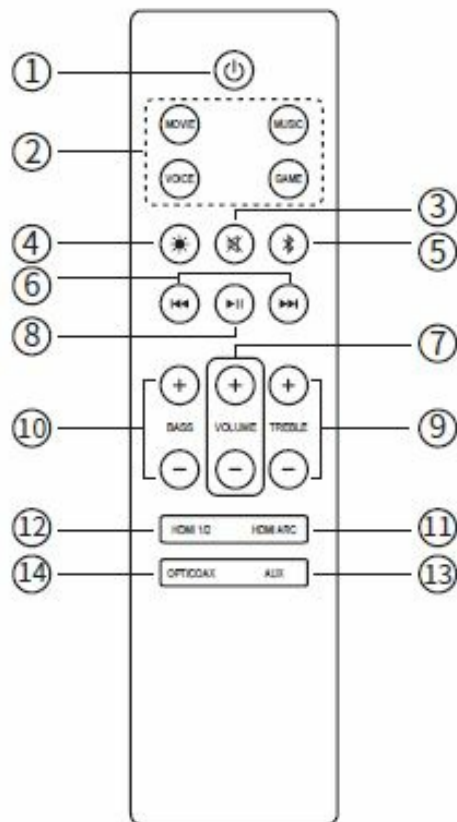

1. Power on/off
2. Sound effect mode
 - MOVIE mode
 - MUSIC mode
 - VOICE mode
 - GAME mode
3. Mute/mute off
 - Press: mute/mute off
 - Press and hold for 3s: soundbar pairing button
4. Dimmer
 - Adjust the brightness of the display window
5. Bluetooth input
 - Press: Bluetooth input
 - Press and hold: disconnect Bluetooth (Bluetooth mode)
6. Previous track/next track
 - (Bluetooth connected)
7. Volume control
8. Play/pause
 - (Bluetooth connected)
9. Treble volume control
10. Bass volume control
11. HDMI output (ARC/eARC)
12. HDMI 1/HDMI 2 input
13. AUX input

14. Optical/coaxial input

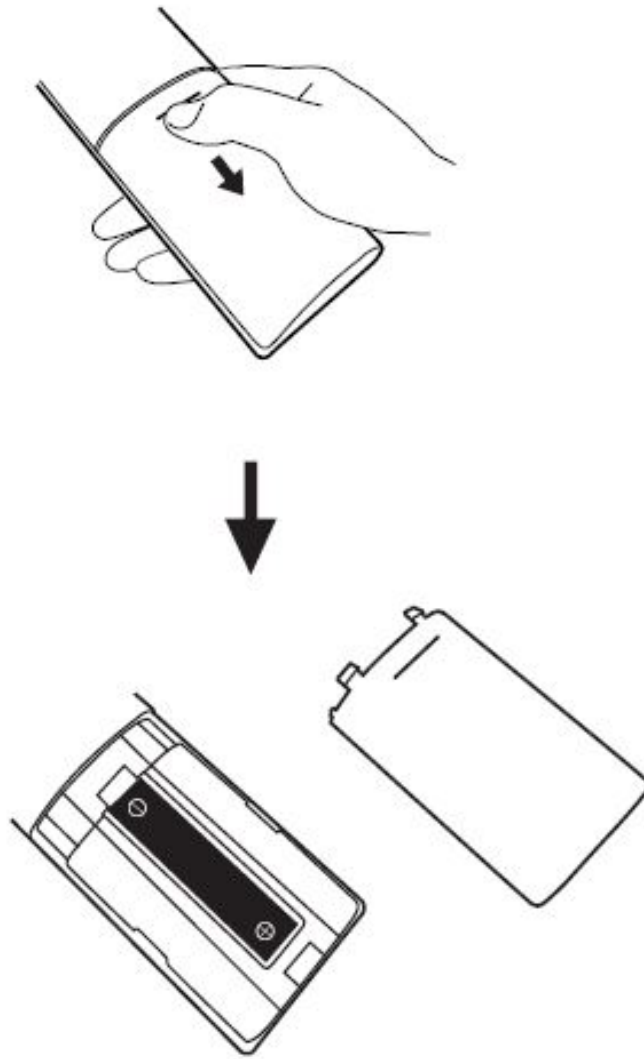

1. As the illustration shows, press the remote control battery cover downward with thumb and follow the arrow direction to remove the cover, insert a AAA battery into it(note the “+” and “-” pole).
2. The batteries life are normally about 6 months; please replace them when the remote control is not sensitive or the control distance is shortened.
3. Never use old and new batteries together.

Note:

1. Do not place the remote control in places that are hot and humid.
2. Do not charge the batteries.
3. Remove the batteries when unused for a long period of time to avoid batteries leakage.
4. The batteries should not be exposed to excessive heat such as direct sun, fire or similar.
5. Danger of explosion if batteries are incorrectly replaced. Replace only with the same or equivalent type.

Soundbar Wall Mount Bracket Installation

Mark the position of the punch hole

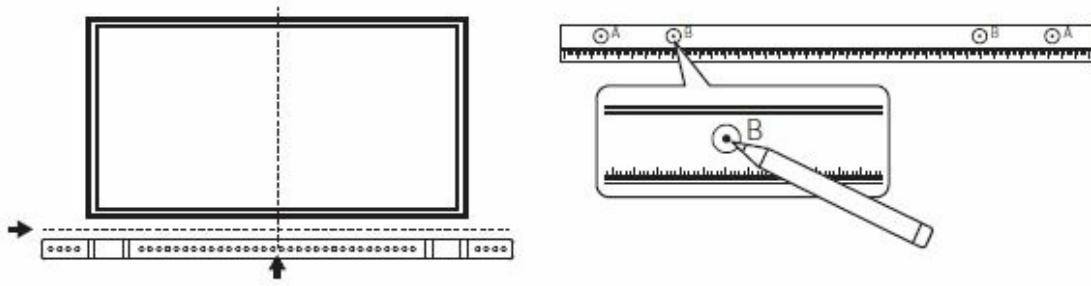

Adhere the wall mount bracket to an appropriate position on the wall and align the centerline of the wall mount bracket with that of the TV, then mark 4 holes.

Note: Please make sure the wall can withstand the weight of this product. Improper installation may lead to accidents, injuries or product damage.

Drill hole in the wall

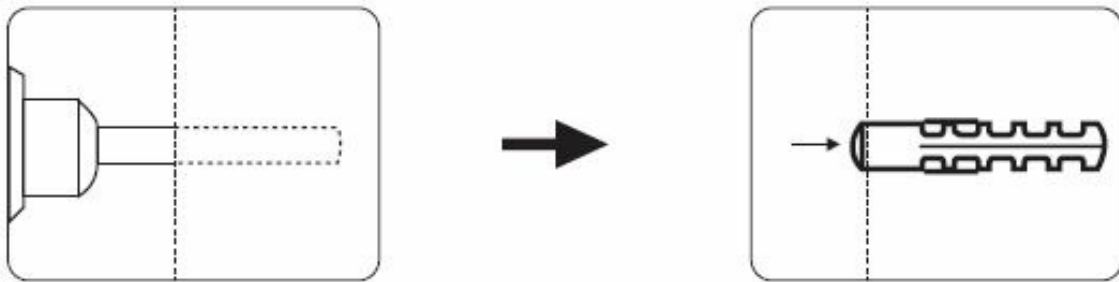

Drill 4 holes (Depth: 40mm, Hole size: 8mm) in the wall, then knock wall anchor into holes.

Note: Dimension of the hole may vary depending on wall materials, please adjust drill size to existing conditions for proper installation.

Fix wall mount bracket



Align mounting bracket with the holes and use included screws to fix wall mount bracket.

Note: The included screws are only suitable for walls of concrete and brick structure, not for walls with gypsum board, foam composite board and wood structure. Please consult a professional to ensure safety if you need to install in gypsum board and wooden structure walls.

Place soundbar on the wall mount bracket

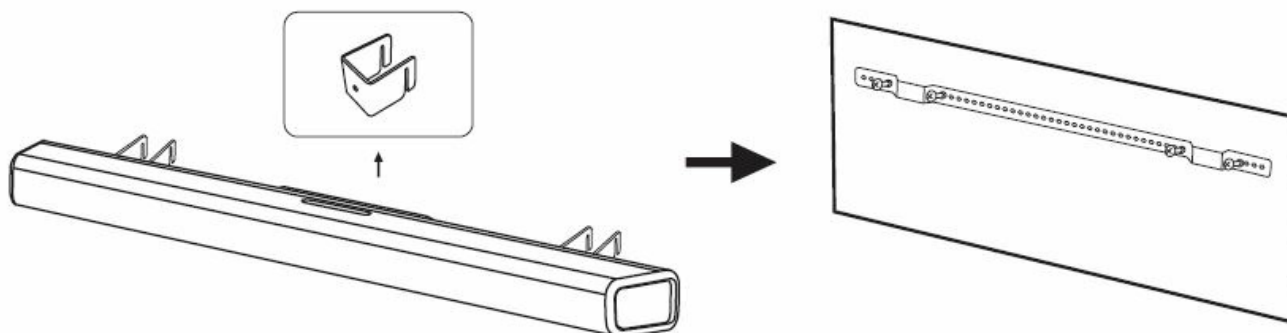

Remove the two screws on the back of the soundbar, fix 2 included hooks on it, and then hang the soundbar on the wall mount bracket.

Note: Please make sure all audio cable connections are secure before mounting the speaker.

Warning:

1. Please follow installation instructions to avoid damage to your product.
2. Please make sure the mounting height is lower than 2m.

Connection

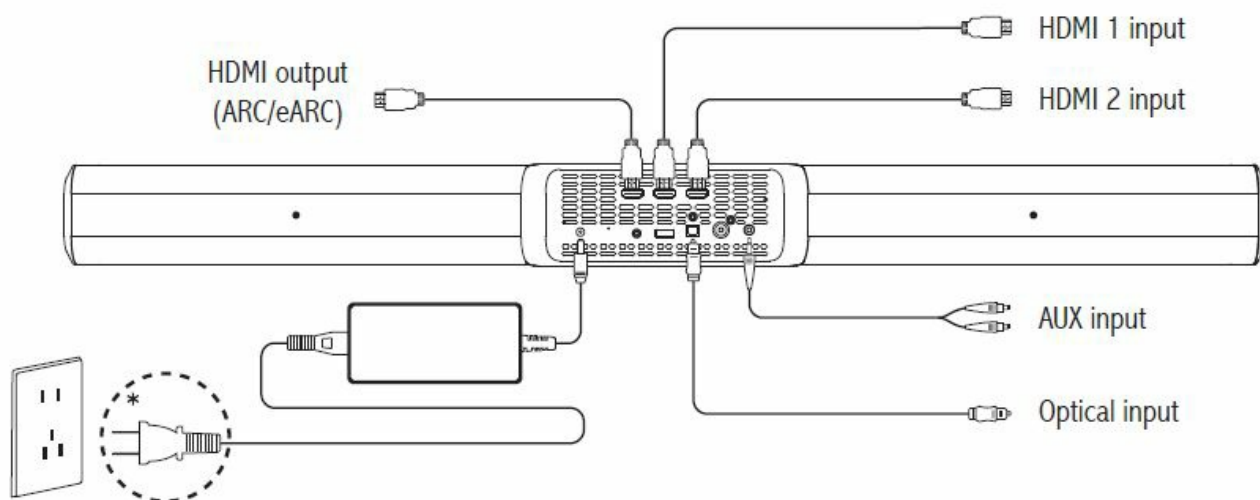

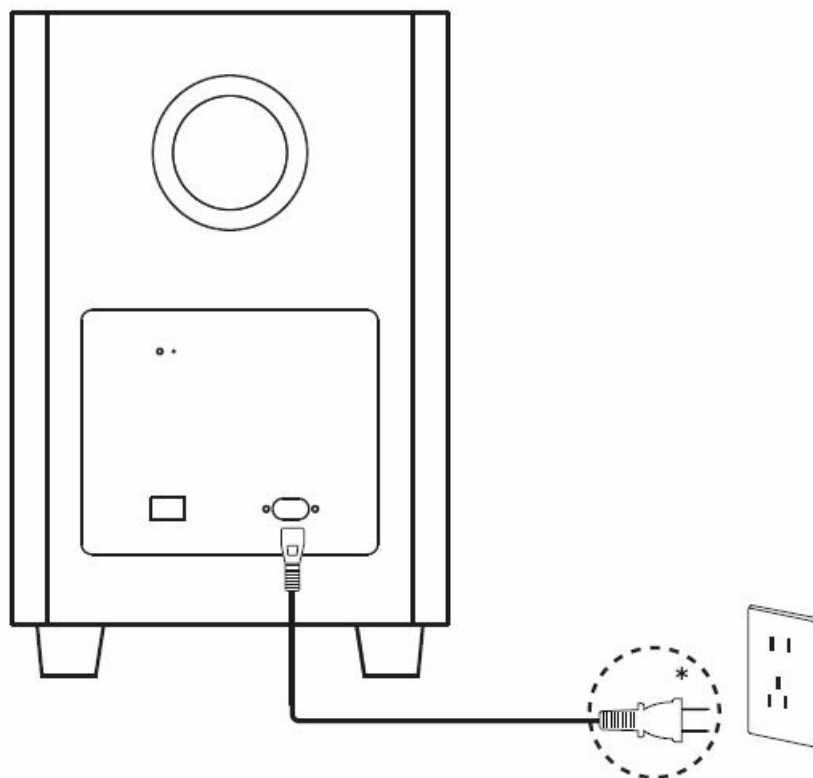

* This plug type is meant for illustration purpose only.

Operating Instructions

HDMI input/output

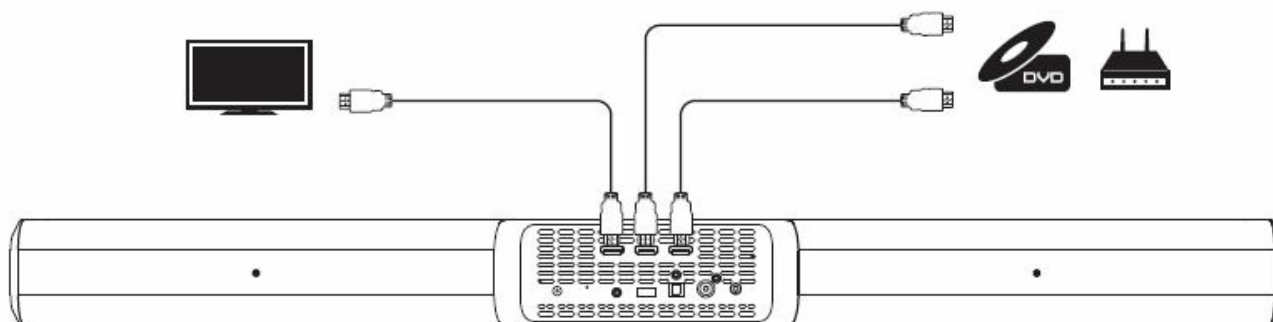

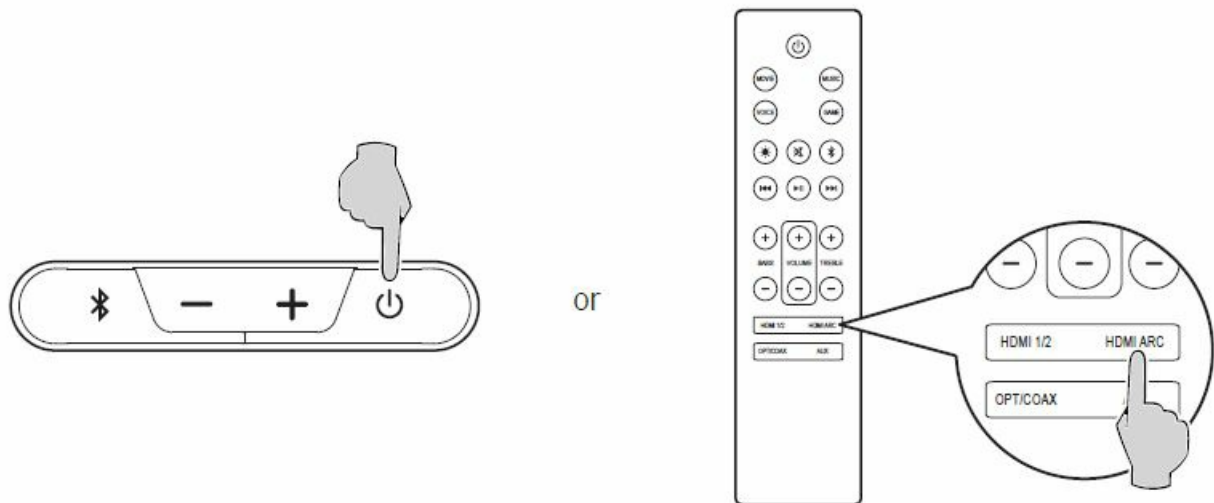

1. HDMI OUT(ARC/eARC) mode:

- Connect the “HDMI ARC” connector on the TV to the “HDMI OUT(ARC/eARC)” output port on the back panel of the soundbar using a 4K HD HDMI cable.
- Press the “” power switch button on the soundbar or the “HDMI ARC” button on the remote control to switch to HDMI ARC input mode. (The display window shows “ARC”);
- HDMI ARC will return the audio signal to the speaker via HDMI cable.

2. HDMI 1/HDMI 2 mode:

- Connect audio source (DVD, Set-Top Box, etc.) to “HDMI IN1” or “HDMI IN2” input port on the back panel of soundbar using 4K HD HDMI cable;
- Connect the “HDMI” connector on the TV to the “HDMI OUT(ARC/eARC)” output port on the back panel of the soundbar using another HDMI cable. The audio source video signal will output to the TV. (**Note:** You have been supplied with one HDMI cable; additional cables may be necessary);
- Press the “” power switch button on the soundbar or the “HDMI 1/2” button on the remote control to switch to HDMI 1 or HDMI 2 input mode. (The display window shows “HDMI 1” / “HDMI 2”).

Note:

1. All HDMI ports of the product support 4K video format.
2. Supports HDMI 2.1, HDCP, CEC, Dolby Vision®, HDR10+.

Dolby technology

Dolby Atmos®

This product supports Dolby Atmos®.

Dolby Atmos® produces astonishing audio experiences by its advanced technology and all-around audio configuration featuring overhead speakers.

1. Dolby Atmos® is only available in HDMI mode
2. Make sure the audio and video source content is Dolby Atmos®
3. Make sure that “Bitstream or RAW” format is selected for the audio output when using a Blu-ray DVD player or other devices

4. When reading Dolby Atmos®/Dolby® Digital/PCM format, the soundbar displays DOLBY ATMOS/DOLBY AUDIO/PCM respectively

Dolby Vision®

This product supports transmitting video signals of Dolby Vision® Compatible.

Dolby Vision® Compatible revolutionizes your viewing experience in theaters and on TV with breathtaking brightness, contrast ratio and color.

Audio input

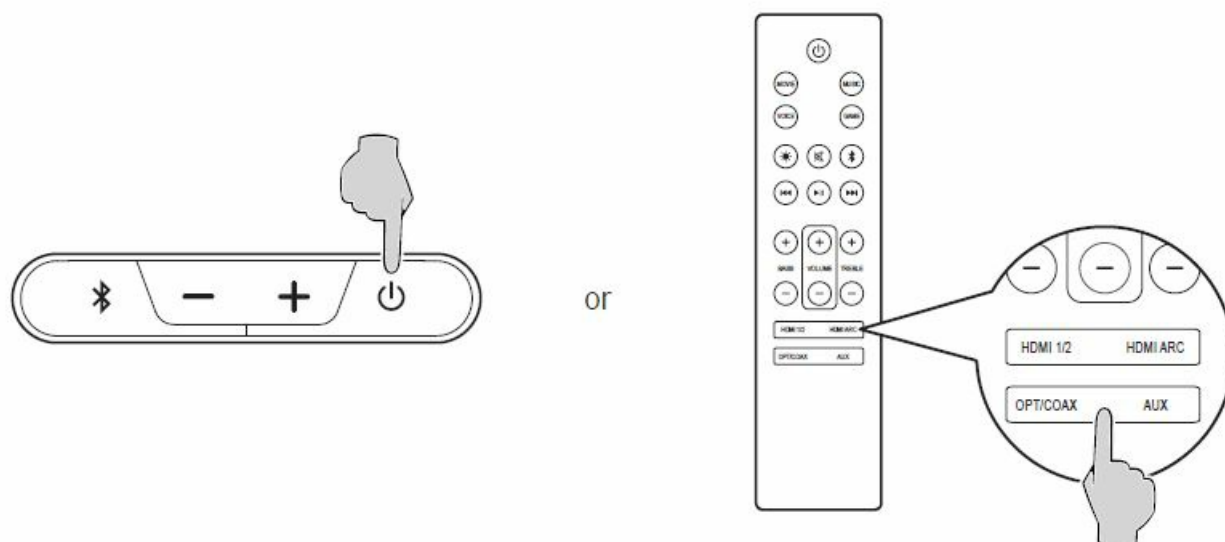

1. Optical/coaxial input

- Connect audio source (DVD, Set-Top Box, etc.) to “OPT/COAX” input port on the rear panel of the soundbar using fiber optic audio cable or coaxial cable (coaxial cable not included);
- Press the “” power switch button on the soundbar or the “OPT/COAX” button on the remote control to switch to optical/coaxial input. (The display window shows “OPT/COAX”);
- Play music on the connected device and adjust the settings to a desired level.



2. AUX input

- Connect audio source to the “AUX” input port on the rear panel of the soundbar using a 3.5mm-RCA audio cable;
- Press the “” power switch button on the soundbar or the “AUX” button on the remote control to switch to AUX input. (The display window shows “AUX”);
- Play music on the connected device and adjust the settings to a desired level.

Note:

Only the standard PCM audio signals (44.1KHz/48KHz/96KHz/192KHz) and Dolby audio-coded signals function in optical/coaxial input.

3. Bluetooth input

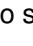
Press the “” power switch button or the “” button on the soundbar to switch to Bluetooth input. Or press the “” on the remote control to switch to Bluetooth mode. The speaker will auto-enter Bluetooth pairing state. (The Bluetooth “BT” icon will show and blink in the display window);

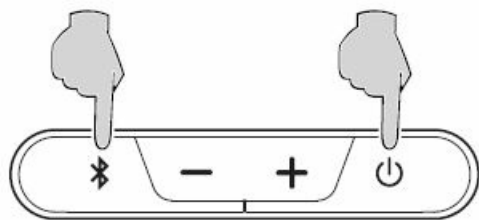

or

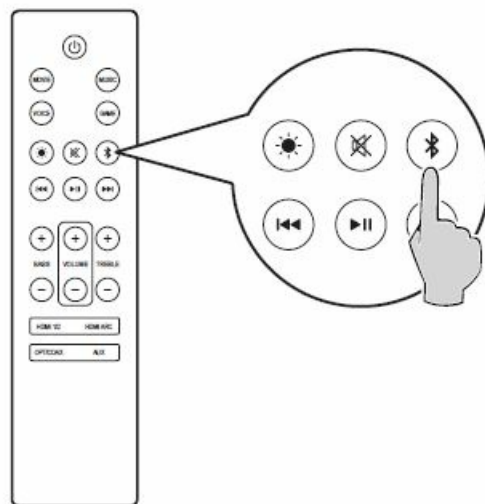

- Select “EDIFIER B700” in your device setting to connect. (The “BT” icon will show and constantly lit in the display window after connected);
- Play music on the connected device and adjust the settings to a desired level.

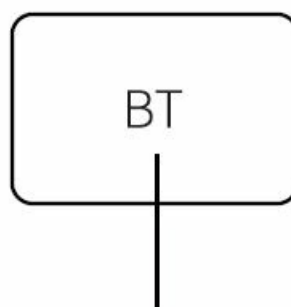
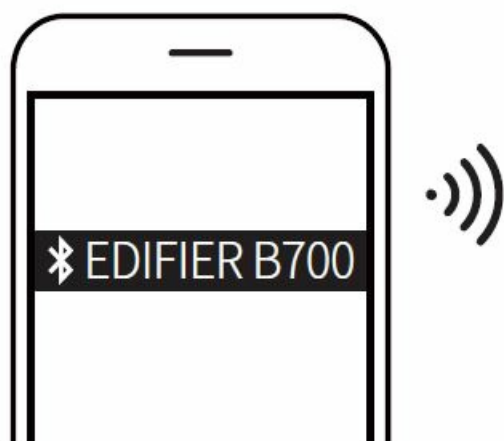

The "BT" icon will show and constantly lit in the display window

Note:

1. PIN code for connection is “0000” if needed.
2. To enjoy all Bluetooth functions of this product, please ensure your device supports A2DP and AVRCP profiles.

Specifications

- Power output: L/R/C: 15W+15W+15W, Ls/Rs: 15W+15W, Ltm/Rtm: 15W+15W
- Frequency response: 45Hz-20KHz
- Audio input: HDMI 1, HDMI 2, Optical, Coaxial, Bluetooth, AUX
- Audio output: HDMI OUT (ARC/eARC)
- Subwoofer: 70W

Power adapter information:

- Manufacturer: EDIFIER
- Model: ADT-60180
- Input: 100-240V~50/60Hz 1.5A
- Output: 18V 3A

Declaration for EU

- Frequency Band (Bluetooth): 2.402GHz ~ 2.480GHz
- Frequency Band (5.8G): 5.725GHz ~ 5.820GHz
- RF Power Output (Bluetooth): ≤10 dBm (EIRP)
- RF Power Output (5.8G): ≤14 dBm (EIRP)

There is no restriction of use.

Troubleshooting

No sound

- Check if the speaker is ON.
- Try to turn up the volume using the volume control or remote control.
- Ensure the audio cables are firmly connected and the input is set correctly on the speakers.
- Check if there is a signal output from the audio source.

Cannot connect via Bluetooth

- Make sure the speaker is switched to Bluetooth input. If it is in other audio input modes, Bluetooth will not connect. Disconnect from any Bluetooth device by pressing and holding the " " button, then try again.
- Effective Bluetooth transmission range is 10 meters; please ensure that operation is within the range.
- Try another Bluetooth device for connection.

The B700 does not turn on

- Check if main power is connected, or if the wall outlet is switched on.

Noise coming from speakers

- EDIFIER speakers generate little noise, while the background noise of some audio devices are too high. Please unplug audio cables and turn the volume up, if no sound can be heard at 1 meter away from the speaker, then there is no problem with this product.

To learn more about EDIFIER, please visit www.edifier.com For EDIFIER warranty queries, please visit the relevant country page on www.edifier.com and review the section titled Warranty Terms. USA and Canada: service@edifier.ca South America: Please visit www.edifier.com (English) or www.edifierla.com (Spanish/Portuguese) for local contact information.

For more information, please visit our website:



@Edifierglobal



@Edifier_Global



@Edifier_Global

Model: EDF100026

Edifier International Limited
P.O. Box 6264
General Post Office
Hong Kong

Tel: +852 2522 6989

Fax: +852 2522 1989

www.edifier.com

© 2022 Edifier International Limited. All rights reserved.

Printed in China

NOTICE:

For the need of technical improvement and system upgrade, information contained herein may be subject to change from time to time without prior notice.

Products of EDIFIER will be customized for different applications. Pictures and illustrations shown on this manual may be slightly different from actual product. If any difference is found, the actual product prevails.

Documents / Resources

