



EDGEWOOD CAB-5-WH 5-Drawer Mobile File Filing Cabinet Instruction Manual

[Home](#) » [EDGEWOOD](#) » EDGEWOOD CAB-5-WH 5-Drawer Mobile File Filing Cabinet Instruction Manual 



CAB-5-WH 5-Drawer Mobile File Filing Cabinet Instruction Manual

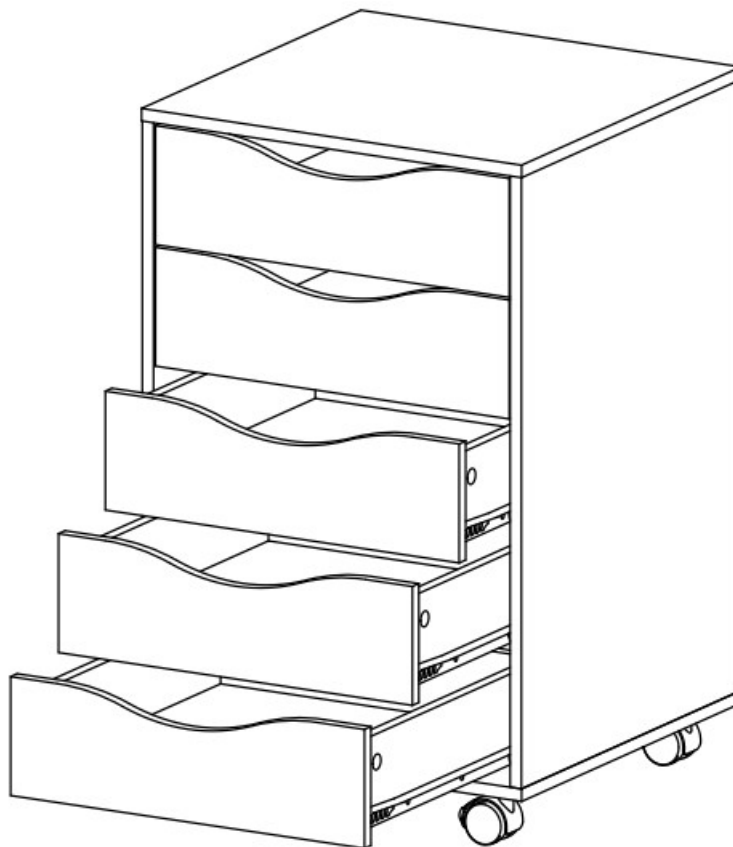

Contents

- [1 CAB-5-WH 5-Drawer Mobile File Filing Cabinet](#)
- [2 Care and Maintenance:](#)
- [3 Full Parts List](#)
- [4 Documents / Resources](#)
- [5 Related Posts](#)

CAB-5-WH 5-Drawer Mobile File Filing Cabinet



Weight total item Max 132 lb (60 kg)



Weight top shelf Max 44 lb (20 kg)



Weight each drawer Max 22 lb (10 kg)

Evenly distributed weight

Dimensions of drawers: 14.8"x14.25"x4.5"(375x361x114mm)

Review the parts list to make sure everything was included in your box.

We suggest you hand tighten screws and bolts to avoid over tightening, and stripping predrilled holes.

WARNING: Adult assembly required. Please use care when unpacking parts from this box. May contain small parts with sharp points and edges.



Children have been seriously injured by furniture tipover. It is highly recommended that tipping restraints, angle braces and/or anchors are utilized to secure unit to the wall (not included).



Never allow children to stand climb or hang on drawers, doors or shelves.



Never open more than one drawer at a time.



Place heaviest items in the lowest drawers or shelves.



Place items on level surface.

Care and Maintenance:

- Dust with a clean, dry, soft, lint free cloth
- Blot spills immediately and wipe dry
- We do not recommend the use of chemical cleaners, abrasives, or furniture polish on white painted items

Full Parts List

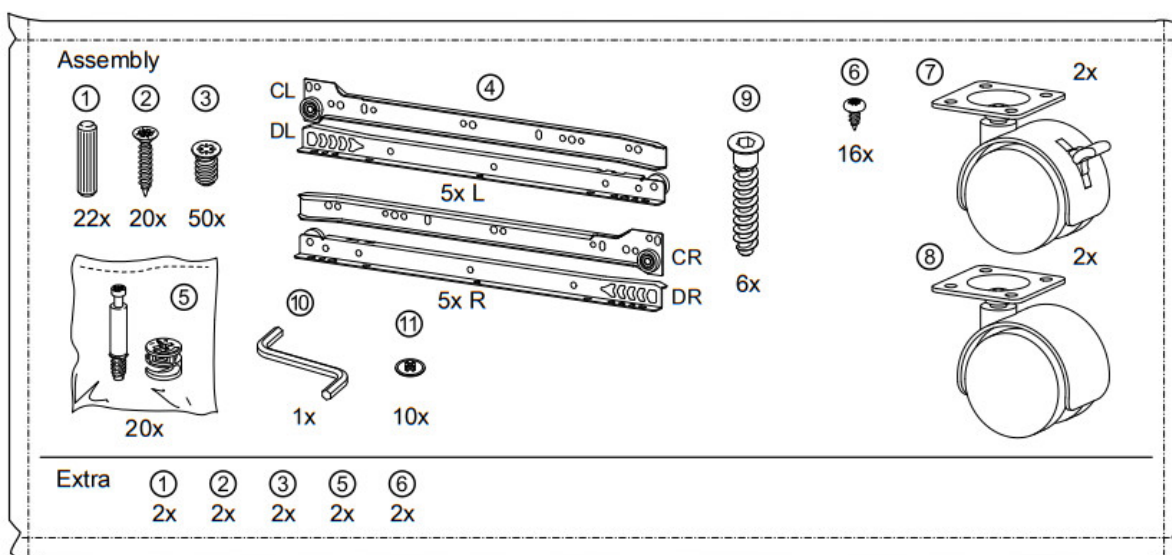
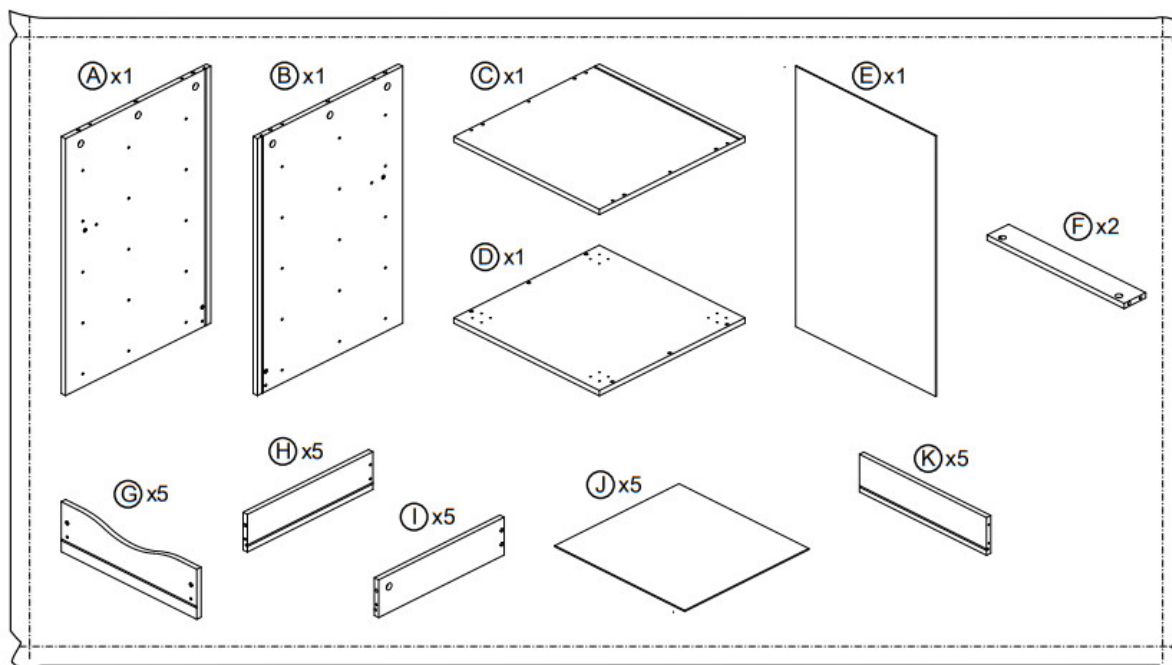

⚠ Not Included-Phillips Screwdriver

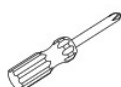

1 A,B

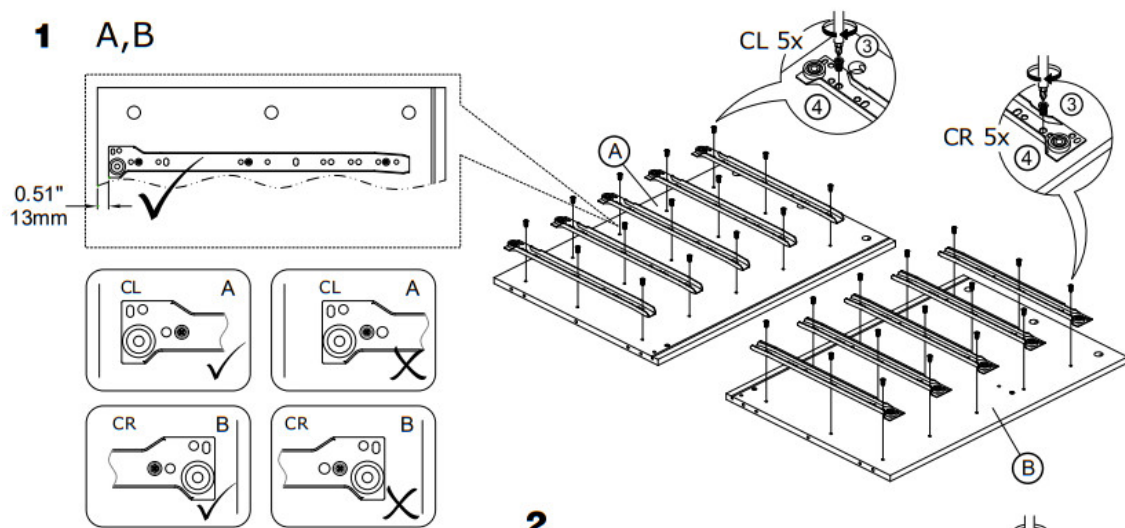

Please choose the correct mounting hole.

2

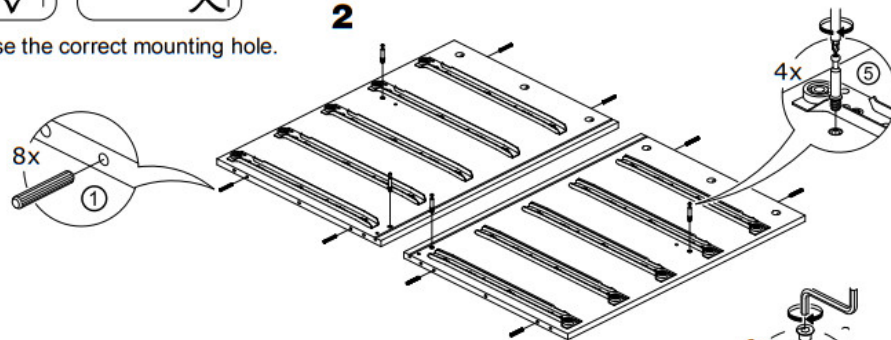

3 B,F,A

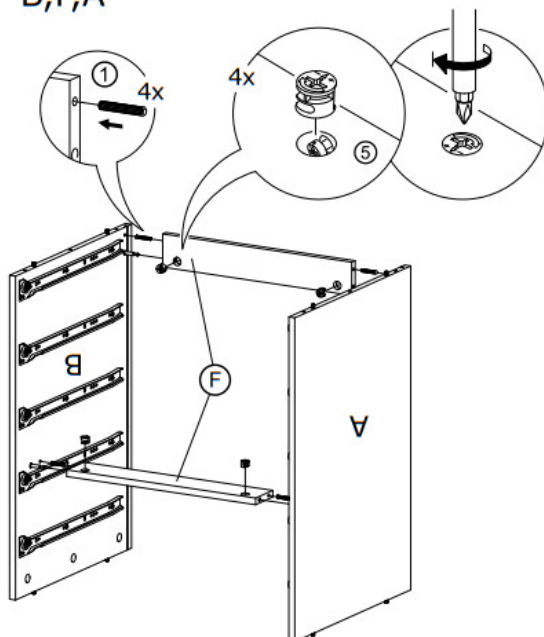

4 D

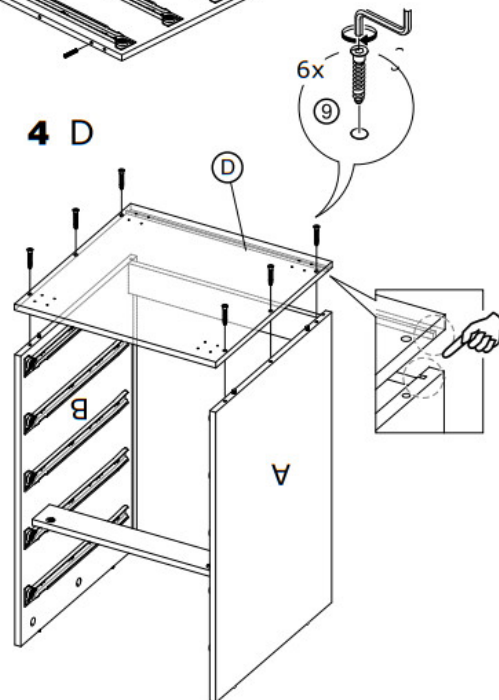

The grooves of side panel A/B and backboard D should be aligned (otherwise it may lead to rework and reinstallation of the panel D)

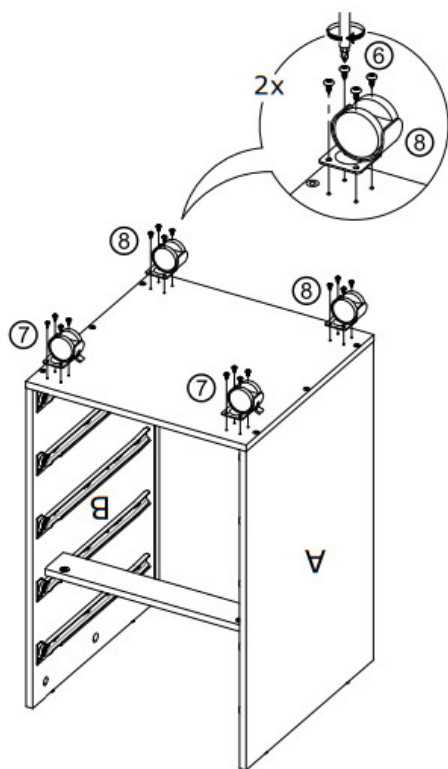
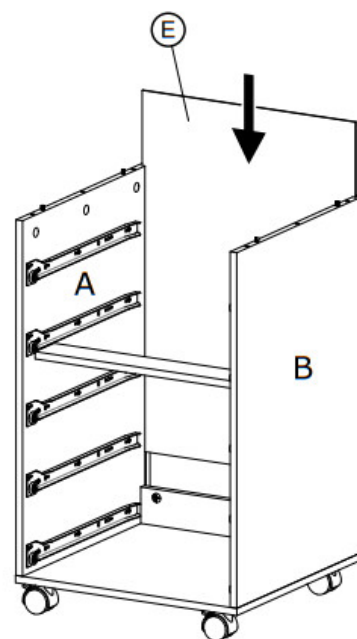
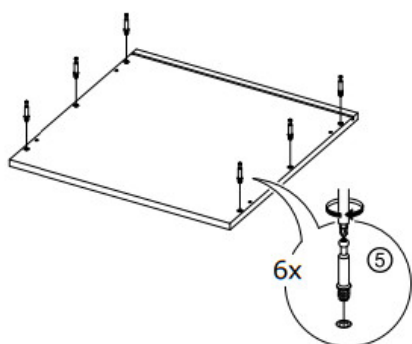
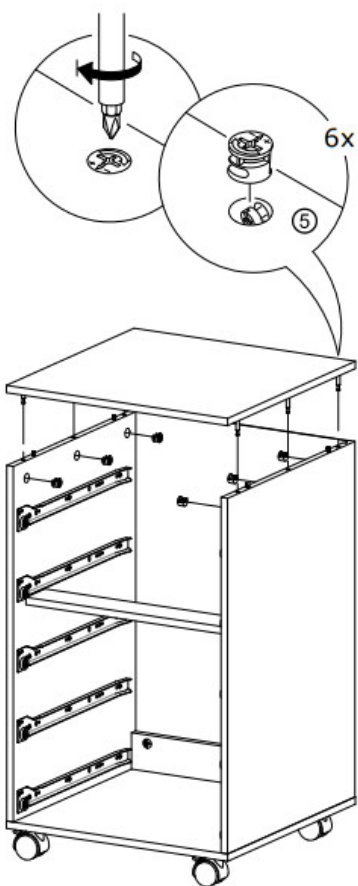
5**6 E****7 C****8**

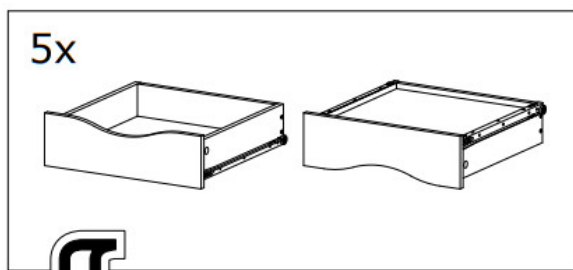

9 G

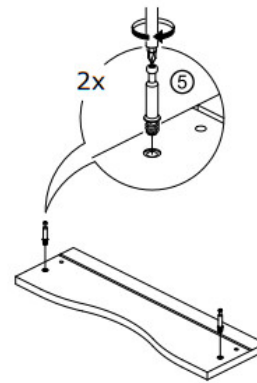

10 H,I

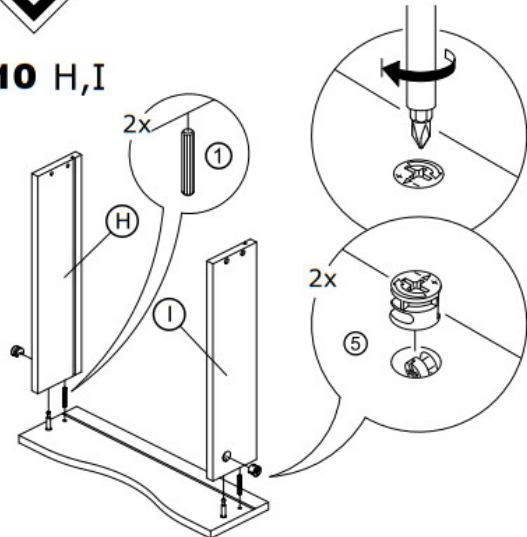

11 J

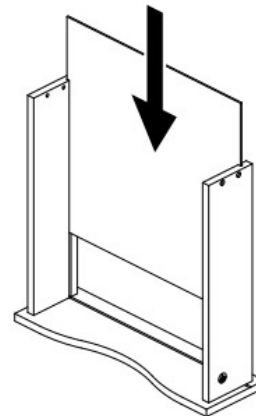

12 K

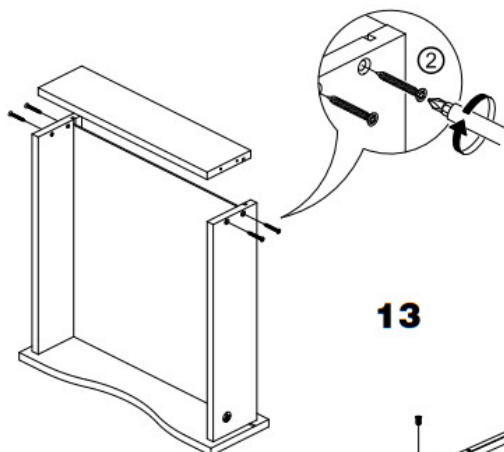

13

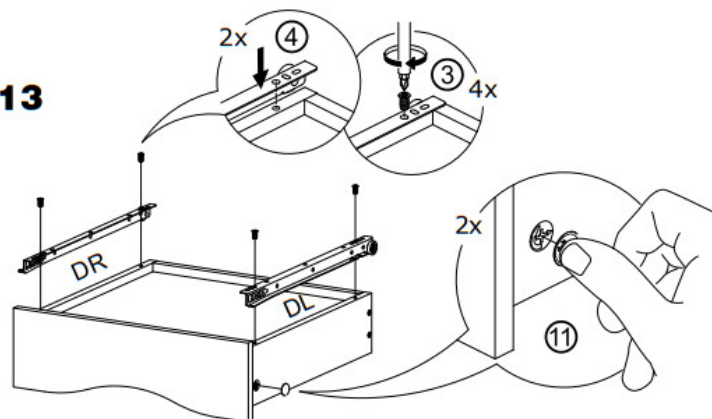

Assemble the rail to the side panel on drawer.

14



15

Lift the front of the drawer then it can be pushed back.

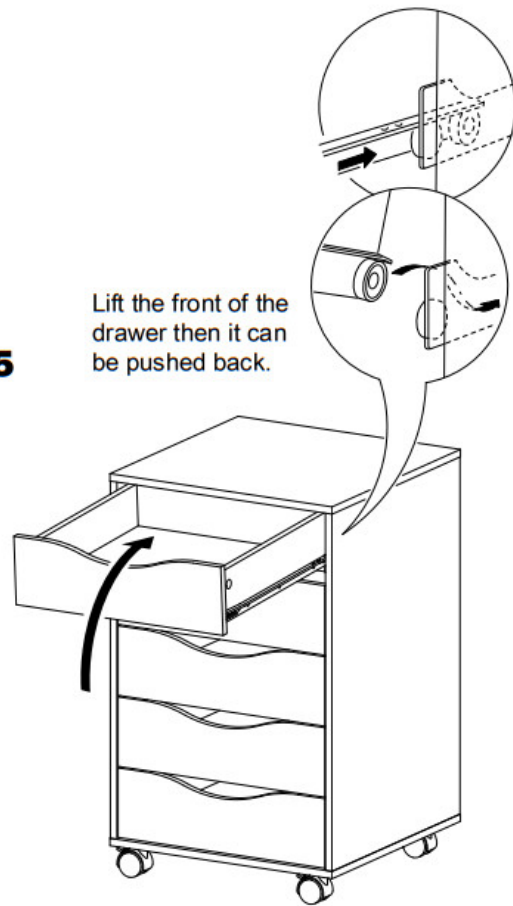

16

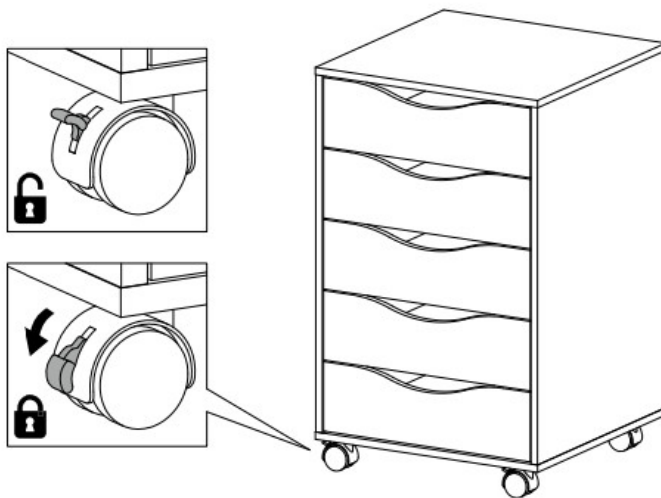

edgewood
MADE IN CHINA

Documents / Resources

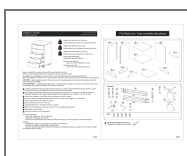

[EDGEWOOD CAB-5-WH 5-Drawer Mobile File Filing Cabinet](#) [pdf] Instruction Manual
CAB-5-WH 5-Drawer Mobile File Filing Cabinet, CAB-5-WH, 5-Drawer Mobile File Filing Cabine
t, Mobile File Filing Cabinet, File Filing Cabinet, Filing Cabinet, Cabinet