



edge-core ECS2100-10T 10-28-52-Port Gigabit Web-Smart Pro Switches Owner's Manual

[Home](#) » [Edge-core](#) » edge-core ECS2100-10T 10-28-52-Port Gigabit Web-Smart Pro Switches Owner's Manual



Contents

- 1 [edge-core ECS2100-10T 10-28-52-Port Gigabit Web-Smart Pro Switches](#)
- 2 [Product Information](#)
- 3 [Product Usage Instructions](#)
- 4 [Unpack the Device and Check the Contents](#)
- 5 [Mount the Device](#)
- 6 [Ground the Device](#)
- 7 [Connect Power](#)
 - 7.1 [Verify Device Operation](#)
 - 7.2 [Perform Initial Configuration](#)
- 8 [Connect Network Cables](#)
 - 8.1 [Hardware Stacking Connection \(Optional\)](#)
 - 8.2 [Hardware Specifications](#)
 - 8.3 [Power Specification](#)
- 9 [Documents / Resources](#)
 - 9.1 [References](#)
- 10 [Related Posts](#)



edge-core ECS2100-10T 10-28-52-Port Gigabit Web-Smart Pro Switches



Product Information

10/28/52-Port Gigabit Web-Smart Pro Switches

The ECS2100 series switches are designed for indoor use and come in six different models – ECS2100-10T, ECS2100-10P, ECS2100-10PE, ECS2100-28T, ECS2100-28P, ECS2100-28PP, and ECS2100-52T. These switches are equipped with 10/28/52 Gigabit Ethernet ports and provide web-smart management functionality. The switches come with a rack mounting kit, four adhesive foot pads, power cord (Japan, US, Continental Europe or UK), console cable (optional), quick start guide, and safety and regulatory information. Additional documentation, including the installation guide, web management guide, and CLI reference guide, can be obtained from the Edge-Core website.

Product Usage Instructions

1. Unpack the device and check its contents.
2. Mount the device either in a rack or on a desktop/shelf using the adhesive rubber foot pads.
3. Ground the device by ensuring the rack is properly grounded and attaching a #12 AWG (PoE device) or #18 AWG (non-PoE device) minimum grounding wire to the grounding point on the device rear panel and connecting it to rack ground.
4. Connect AC power by plugging the AC power cord into the socket on the rear of the device and connecting the other end of the power cord to an AC power source.
5. Verify device operation by checking the system LEDs.
6. Perform initial configuration by following the instructions in the installation guide, web management guide, or CLI reference guide obtained from the Edge-Core website.

It is important to note that for international use, the AC line cord may need to be changed. A line cord set that has been approved for the socket type in the country of use must be used.

- 10/28/52-Port Gigabit Web-Smart Pro Switches
- ECS2100-10T/ECS2100-10P/ECS2100-10PE
- ECS2100-28T/ECS2100-28P/ECS2100-28PP/ECS2100-52T

Unpack the Device and Check the Contents



- ECS2100-10T
- ECS2100-10PE
- ECS2100-10P
- ECS2100-28T
- ECS2100-28P
- ECS2100-28PP
- ECS2100-52T
- **Rack Mounting Kit**—two brackets and eight screws
- Four adhesive foot pads
- **Power Cord**—either Japan, US, Continental Europe or UK
- **Console Cable**—RJ-45 to DB-9 (Optional item)
- **Documentation**—Quick Start Guide (this document) and Safety and Regulatory Information
- **Note:** The ECS2100 series devices are for indoor use only.
- **Note:** For Safety and Regulatory information, refer to the Safety and Regulatory Information document included with the device.
- **Note:** Other documentation, including the Installation Guide,
- Web Management Guide, and CLI Reference Guide, can be obtained from www.edge-core.com.

Mount the Device

a. Mounting in a Rack

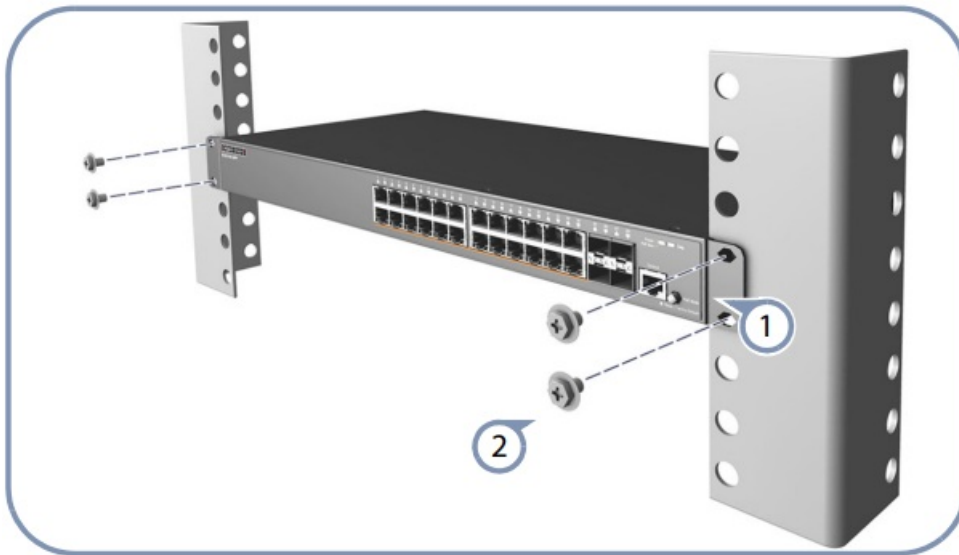

1. Attach the brackets to the device.
2. Use the screws and cage nuts supplied with the rack to secure the device in the rack.

Caution: Installing the device in a rack requires two people. One person should position the device in the rack, while the other secures it using the rack screws.

Attention: Deux personnes sont nécessaires pour installer un commutateur dans un bâti: La première personne va positionner le commutateur dans le bâti, la seconde va le fixer avec des vis de montage.

Note: The device can also be installed on a desktop or shelf using the included adhesive rubber foot pads.

b. Mounting in a Rack (ECS2100-10PE only)

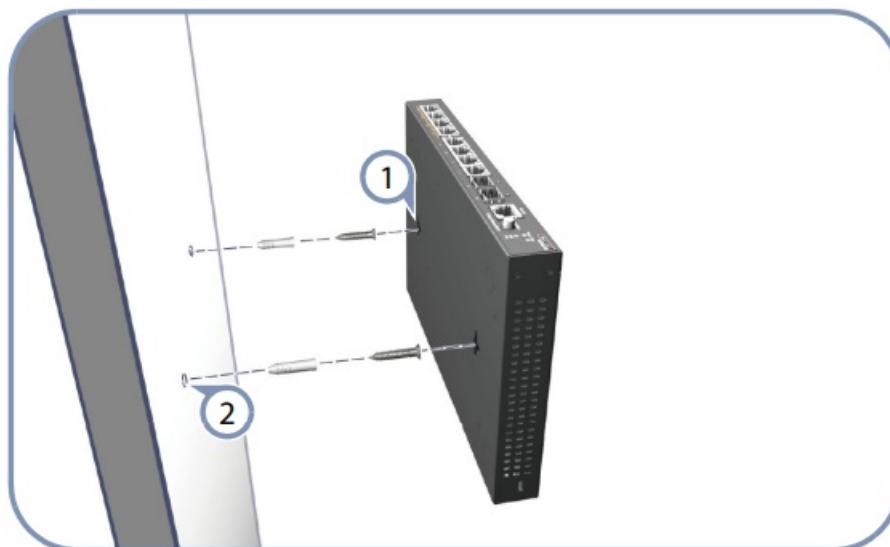

- **Caution:** For safe operation, install the device with RJ-45 ports facing up.
- **Attention:** Pour un fonctionnement sûr, installez le commutateur avec les ports RJ-45 orientés vers le haut.
- Set two screws in the wall 150 mm (5.9 in.) apart.
- Slide the device's wall mounting slots down onto the screws so that the unit is secure.

Ground the Device

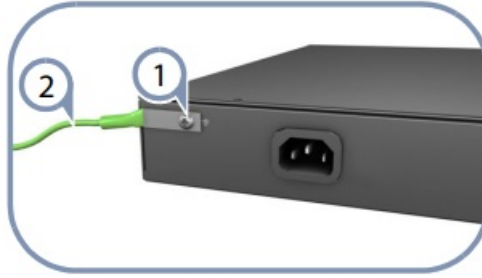

1. Ensure the rack on which the device is to be mounted is properly grounded and in compliance with ETSI ETS 300 253. Verify that there is a good electrical connection to the grounding point on the rack (no paint or isolating surface treatment).
 2. Attach a lug (not provided) to a #12 AWG (PoE device) or #18 AWG (non-PoE device) minimum grounding wire (not provided), and connect it to the grounding point on the device rear panel. Then connect the other end of the wire to the rack ground
- **Caution:** The earth connection must not be removed unless all supply connections have been disconnected.
 - **Caution:** The device must be installed in a restricted-access location. It should have a separate protective earthing terminal on the chassis that must be permanently connected to earth to adequately ground the chassis and protect the operator from electrical hazards.

Connect Power

a. Connect AC Power

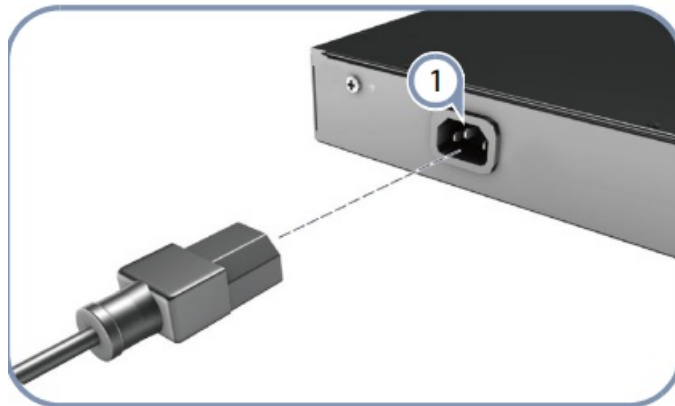

1. Plug the AC power cord into the socket on the rear of the device.
 2. Connect the other end of the power cord to an AC power source. Verify that the external AC power requirements for the device can be met as listed below:
- ECS2100-10T: AC 100-240 V, 50-60 Hz, 0.5 A
 - ECS2100-10P: AC 100-240 V, 50-60 Hz, 2.1 A
 - ECS2100-28T: AC 100-240 V, 50-60 Hz, 0.5 A (Not for China),
 - AC 100-240 V, 50/60 Hz, 0.5 A
 - ECS2100-28P: AC 100-240 V, 50-60 Hz, 3.2 A
 - ECS2100-28PP: AC 100-240 V, 50-60 Hz, 5.8 A
 - ECS2100-52T: AC 100-240 V, 50/60 Hz, 1 A

- **Warning:** For the ECS2100-10P, the bottom of the enclosure is a hot surface. Do not touch!
- **Attention:** Pour l'ECS2100-10P, le bas du boîtier est une surface chaude. Ne pas toucher!
- **Note:** For International use, you may need to change the AC line cord. You must use a line cord set that has been approved for the socket type in your country.

b. Connect DC Power to ECS2100-10PE



Note: The ECS2100-10PE includes an AC-DC power adapter. Connect the AC-DC power adapter to the device and to an AC power source. The AC-DC adapter provides 54 VDC, 1.67 A of power to the device.

1. Plug the DC power cable into the socket on the rear of the device.
2. Plug the AC-DC power adapter into a nearby AC power outlet.

Verify Device Operation



1. Verify basic device operation by checking the system LEDs. When operating normally, the Power and Diag LEDs should be on green.

Perform Initial Configuration

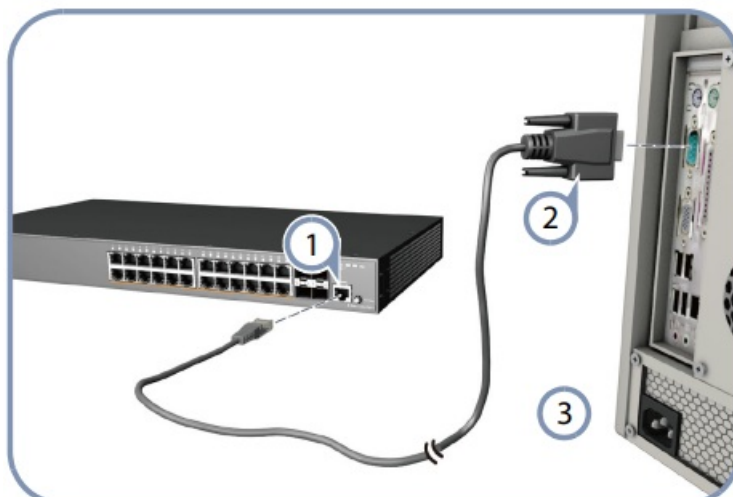

1. Connect a PC to the device console port using the included console cable.
2. Configure the PC's serial port: 115200 bps, 8 characters, no parity, one stop bit, 8 data bits, and no flow control.
3. Log in to the CLI using default settings: Username "admin" and password "admin."

Note: For further information on device configuration, refer to the Web Management Guide and CLI Reference Guide.

Connect Network Cables

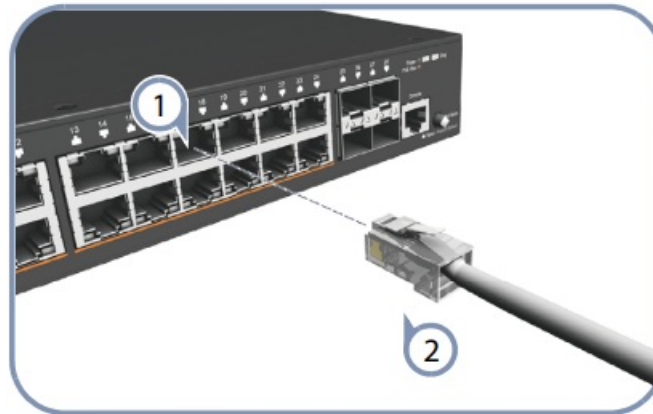

1. For RJ-45 ports, connect 100-ohm Category 5, 5e or better twisted-pair cable.
2. For the SFP/SFP+ slots, first install SFP/SFP+ transceivers and then connect fiber optic cabling to the transceiver ports. The following transceivers are supported:

- 1000BASE-SX (ET4201-SX)
- 1000BASE-LX (ET4201-LX)
- 1000BASE-ZX (ET4201-ZX)
- 1000BASE-LHX (ET4201-LHX)
- 10GBASE-SR (ET5402-SR)
- 10GBASE-LR (ET5402-LR)
- 10GBASE-ER (ET5402-ER)
- As connections are made, check the port status LEDs to be sure the links are valid. Press the Mode button to change from Ethernet to PoE status:
- **On/Blinking Green** — Port has a valid link. Blinking indicates network activity.
- **On Amber** — Port is supplying PoE power.

Hardware Stacking Connection (Optional)



- Install the ECS2100-28PP in a standard 19-inch rack and power on.
- Install the PS3000 chassis in a standard 19-inch rack.
- Install one or more EPS460W PSUs in the chassis. The chassis can support up to three EPS460W PSUs.
- Use the PSU cable (provided) to connect each EPS460W PSU to an ECS2100-28PP device.
- Connect the AC power cord to power on the EPS460W PSU, and check the LEDs on the PSUs to ensure proper operation.
- The Link LEDs for connected devices should light up.

Hardware Specifications

Device Chassis

- **Size (W x D x H) ECS2100-10T:** 19.64 x 11.71 x 3.66 cm (7.73 x 4.61 x 1.44 in.)
- **ECS2100-10P:** 33.0 x 20.4 x 4.26 cm (12.99 x 8.03 x 1.67 in.)
- **ECS2100-10PE:** 24.0 x 15.5 x 2.65 cm (9.44 x 6.10 x 1.04 in.)
- **ECS2100-28T/28P/28PP/52T:** 44 x 22 x 4.4 cm (17.32 x 8.66 x 1.73 in.)
- **Weight ECS2100-10T:** 816 g (1.8 lb)
- **ECS2100-10P:** 2.4 kg (5.34 lb)
- **ECS2100-10PE:** 973 g (2.15 lb)
- **ECS2100-28T:** 2.2 kg (4.86 lb)
- **ECS2100-28P:** 2.8 kg (6.18 lb)
- **ECS2100-28PP:** 3.1 kg (6.85 lb)
- **ECS2100-52T:** 2.5 kg (5.5 lb)
- **Temperature Operating:** 0 ° C to 50 ° C (32 ° F to 122 ° F)
- **Operating:** 0 ° C to 45 ° C (32 ° F to 113 ° F, ECS2100-28PP only)
- **Operating:** 0 ° C to 40 ° C (32 ° F to 104 ° F,
ECS2100-10P and ECS2100-28PP with one EPS460W only)
- **Storage:** -40 ° C to 70 ° C (-40 ° F to 158 ° F)
- **Humidity Operating:** 10% to 90% (non-condensing)

Power Specification

- **AC Input Power ECS2100-10T:** AC 100-240 V, 50-60 Hz, 0.5 A

- **ECS2100-10P:** AC 100-240 V, 50-60 Hz, 2.1 A
- **ECS2100-28T:** AC 100-240 V, 50-60 Hz, 0.5 A (Not for China), AC 100-240 V, 50/60 Hz, 0.5 A
- **ECS2100-28P:** AC 100-240 V, 50-60 Hz, 3.2 A
- **ECS2100-28PP:** AC 100-240 V, 50-60 Hz, 5.8 A
- **ECS2100-52T:** AC 100-240 V, 50/60 Hz, 1 A
- AC-DC Power Adapter
 - (ECS2100-10PE only)
- **Input:** AC 100-240 V, 50-60 Hz, 1 A
- **Output:** 54 VDC, 1.67A
- Total Power Consumption
- **ECS2100-10T:** 8 W
 - **ECS2100-10P:** 160 W
- **ECS2100-10PE:** 80 W
 - **ECS2100-28T:** 20 W
- **ECS2100-28P:** 260 W
 - **ECS2100-28PP:** 490 W
- **ECS2100-28PP+ one extended power supply:** 950 W
- **ECS2100-52T:** 40 W
- Regulatory Compliances
- Emissions CE Mark
- **EN 55032:**2015+A1:2020 Class A
- **EN IEC 61000-3-2:2019+A1:**2021, Class A
- **EN 61000-3-3:**2013/A2:2021/AC:2022-01
- FCC Class A
- CCC GB 9254-2008 Class A
- BSMI CNS 15936, Class A (ECS2100-28T/
- ECS2100-28PP only)
- BSMI CNS 13438, Class A
- **Immunity EN 55035:**2017+A11:2020
- IEC 61000-4-2/3/4/5/6/11
- **Safety** UL/CUL(UL60950-1, CSA60950-1)
- UL/CUL (UL 62368-1, 2nd Ed & CAN/CSA C22.2
- No. 62368-1-14, 2nd Edition)
- CB (IEC/EN 60950-1 & IEC/EN 62368-1)
- BSMI CNS15598-1 (ECS2100-28T/ECS2100-28PP only)
- BSMI CNS 14336-1

Documents / Resources

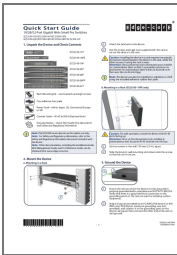

[edge-core ECS2100-10T 10-28-52-Port Gigabit Web-Smart Pro Switches](#) [pdf] Owner's Manual
ECS2100-10T, ECS2100-10P, ECS2100-10PE, ECS2100-28T, ECS2100-28P, ECS2100-28PP, ECS2100-52T, ECS2100-10T 10-28-52-Port Gigabit Web-Smart Pro Switches, ECS2100-10T, 10-28-52-Port Gigabit Web-Smart Pro Switches, Gigabit Web-Smart Pro Switches, Web-Smart Pro Switches, Switches

References

-  [Edgecore Networks](#)