



edelkrone 80392 Motor Module for Slideplus User Manual

[Home](#) » [Edelkrone](#) » edelkrone 80392 Motor Module for Slideplus User Manual 



Motor Module for Slideplus User Manual

Contents

- [1 Module for Slideplus](#)
- [2 WHAT'S IN THE BOX & THE BASICS](#)
- [3 ATTACHING BATTERY BRACKET](#)
- [4 INCLINED MOTION](#)
- [5 DISPOSAL OF THE PRODUCT & WARNINGS](#)
- [6 Documents / Resources](#)
- [7 Related Posts](#)

Module for Slideplus

Before operating your edelkrone, please watch the user's manual video from the link below



<http://edel.kr/sm3>

WHAT'S IN THE BOX & THE BASICS

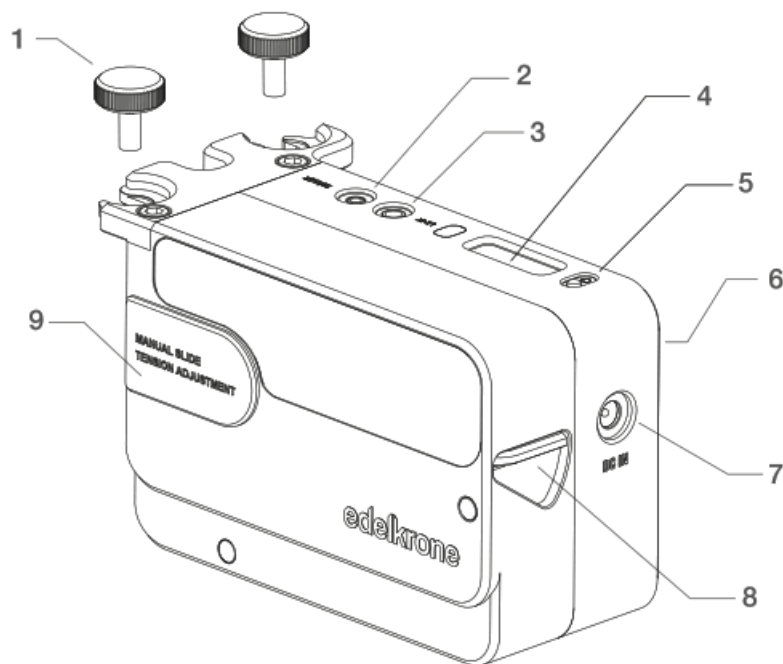

1. Connection screws for Motor Module
2. Shutter trigger cable port
3. Link port
4. Information screen
5. On/Off Button
6. Battery bracket ports
7. DC IN socket & Cable
8. Holder Port 2.5 mm Allen key
9. Manual slide tension adjustment port

ATTACHING BATTERY BRACKET

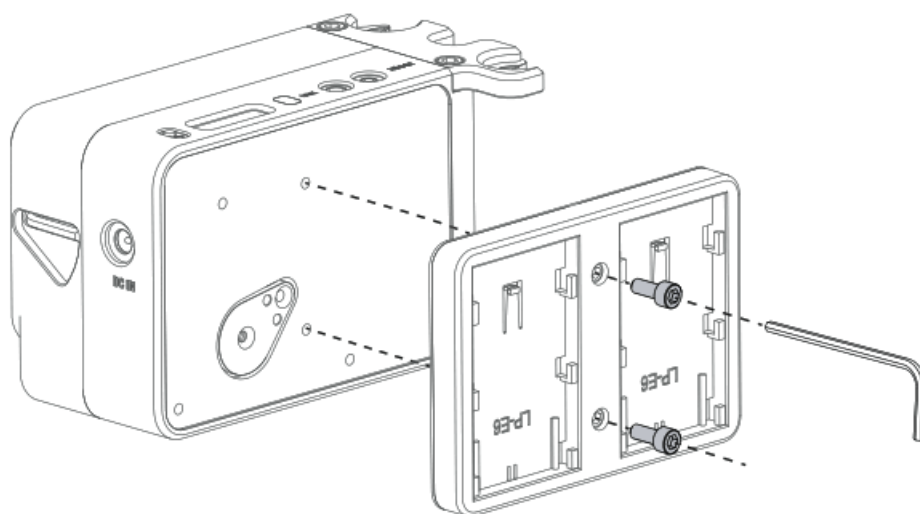

Depending on your choice of battery, you need to mount the related battery bracket with 2 screws to Motor Module. Battery brackets are sold separately.

MOUNTING YOUR MOTOR MODULE TO YOUR SLIDERPLUS

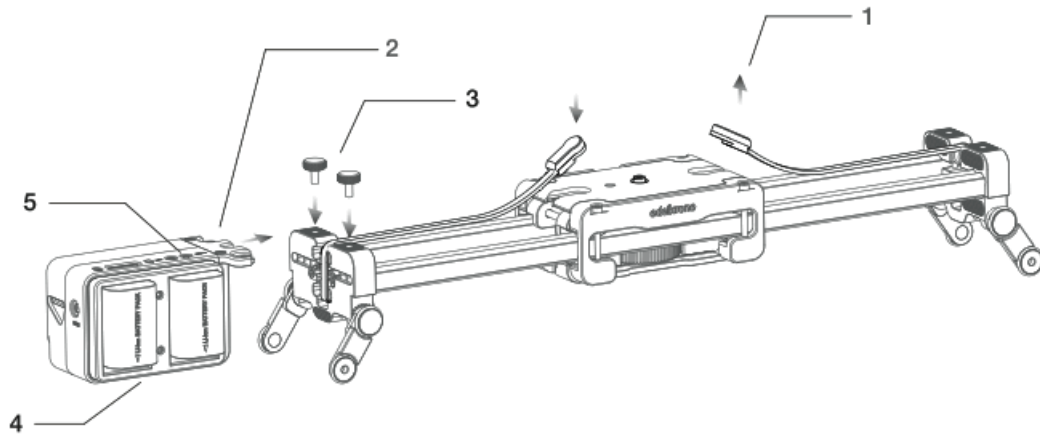

1. Detach manual slide control belt and attach the motion control belt.
2. Attach Motor Module to SliderPLUS.
3. Place the connection screws and tightethem.
4. Connect the batteries or power adapter to the DC IN socket.
5. Connect shutter trigger cable to the shutter trigger cable port (@ when you intend to shoot time-lapse and stopmotion).



Connecting cables to incorrect ports may cause serious damage to the modules.



detailed video explaining how to attach belt and mounting details can be found at: <http://edel.kr/sm3>

ADJUSTING TENSION

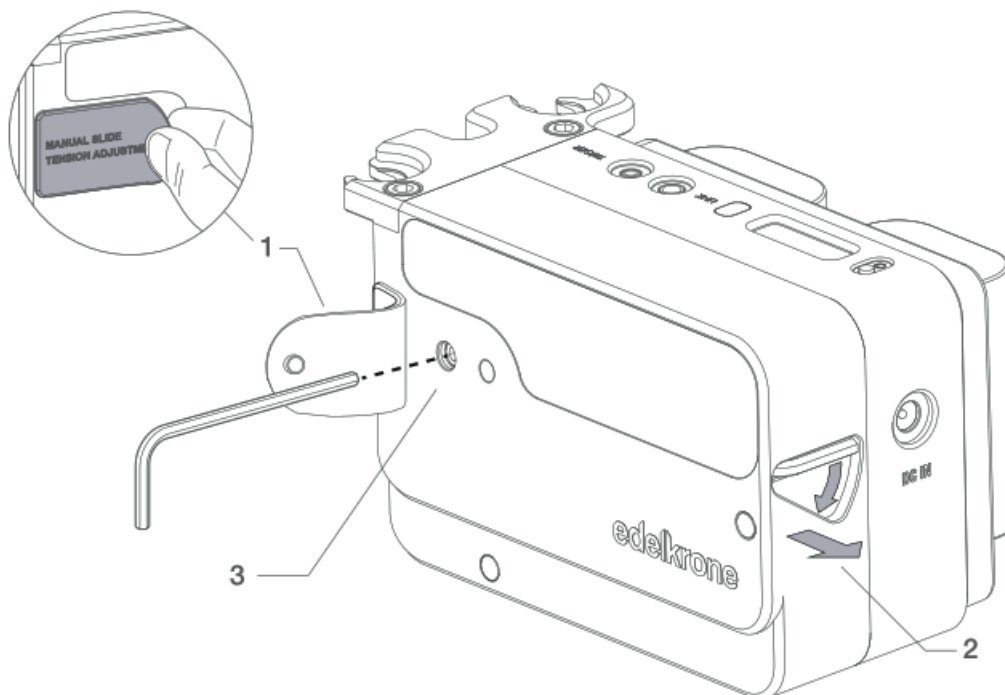

- Open Manual slide tension adjustment cover to reach the screw.
- Turn the allen key down and pull it out.
- Use the allen key to adjust the tension.

! If you are not able to slide manually after inclined operation. try loosening the tension. Make as small adjustments as possible.

INCLINED MOTION

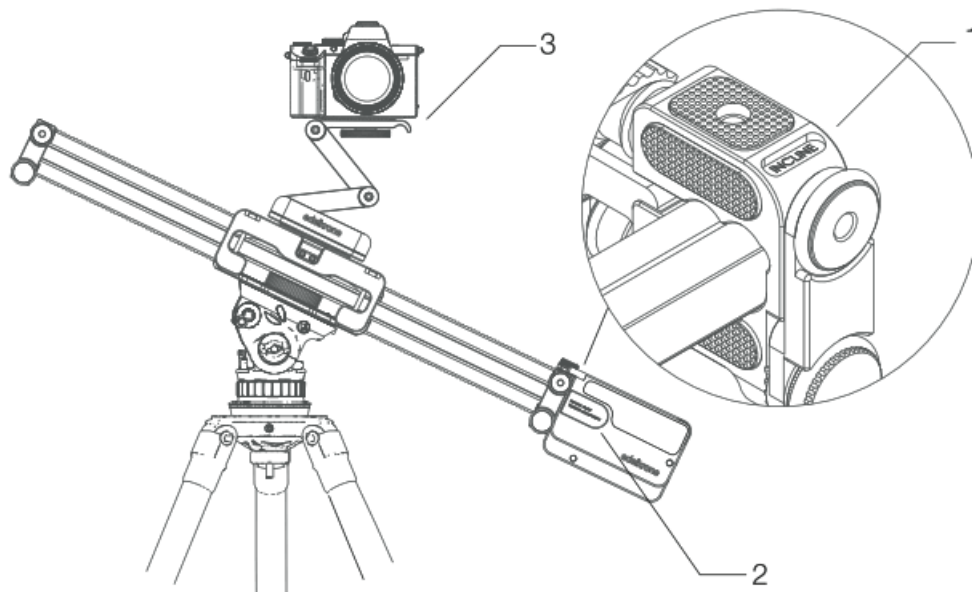

To get inclined shots:

1. You should attach your Motor Module to incline side of the SliderPLUS.
2. . You should tighten slide tension of the Motor Module to get inclined motion.
3. Place your camera to FlexTILT Head or any camera head.

! Please make sure that your tripod legs are opened widely to prevent falls and

! If you are not able to slide manually, try loosening the tension. Make as small balance issues. adjustments as possible.

HOT SWAPPING

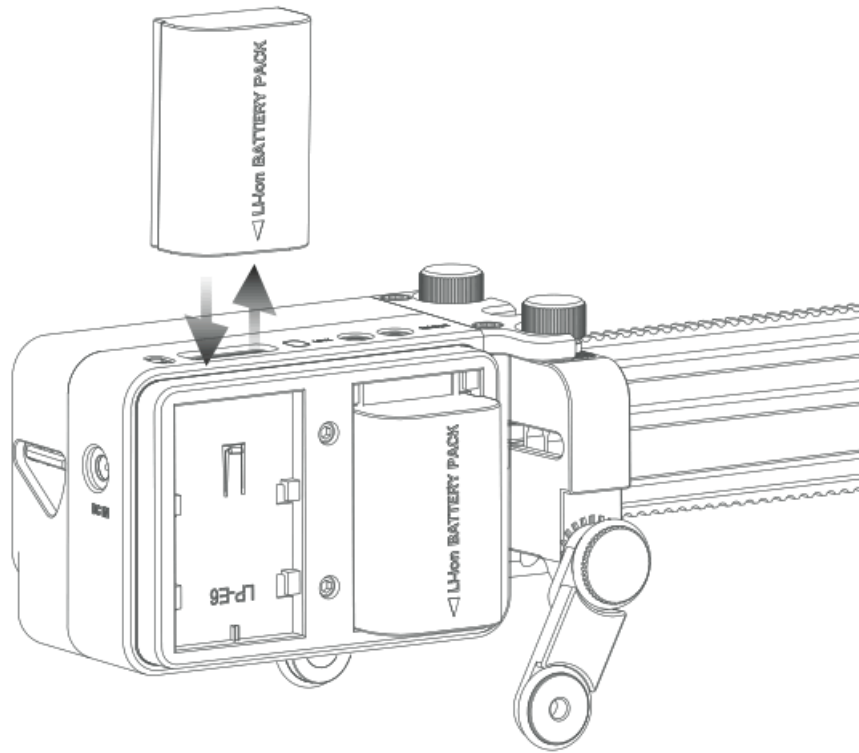

START USING



1. Download the edelkrone App to your mobile device from the App Store or Google Play. Links can be found at www.edelkrone.com/products/motor-module
 2. edelkrone App will automatically pair with your Motor Module through Bluetooth/Wifi.
 3. . Motor Module will turn on with a beep sound. 4. You are now ready to use your Motor Module for SliderPLUS.
- Just keep following the instructions on your mobile device or visit manuals.edelkrone.com for a detailed video instruction.



Always start using with fully charged batteries.



Make sure your mob. device's Bluetooth connection is on.

DISPOSAL OF THE PRODUCT & WARNINGS



Should the product become damaged beyond repair, or if you wish to dispose of it, it must be disposed separately from the municipal waste stream via designated collection facilities appointed by the government or the local authorities. Observe the regulations of your area and country that relate to the disposal of electronic products.

- Keep your electronic Motion Control Unit away from all sorts of liquids.
- In order to preserve your Motion Control Unit and battery performance at their best, use the exact same

disassemble or modify any internal parts of your Motion

- Do not attempt to disassemble or modify any internal parts of your Motion Control Unit. If the device appears to be malfunctioning, discontinue use immediately and contact support for qualified service.
 - Never force a different type of connector into a port.
 - Never use or store your Motion Control Unit in areas subject to extreme temperatures, or high levels of vibration.
 - If your motion control unit becomes unresponsive, disconnect and re-connect the power source. Make sure your DC adapter is plugged in or your batteries are properly charged. If the problem persists, contact our support team.
 - Environmental factors may affect your Motion Control Unit's performance. Keep your product away from environmental hazards such as dust or heat, resonance. Do not use chemical materials to clean your product.
 - * Only use included battery plate, DC adapter or equivalent power sources. Use of an inappropriate power source may permanently damage your Motion Control Unit.
 - * If there is an impairment on the power or connector cable, stop using the Motion Control Unit immediately. *Avoid dropping or causing physical damage to your Motion Control Unit.
 - Do not place heavy objects on top of your Motion Control Unit.
 - **edelkrone cannot be held responsible for damage caused by improper use or modification of the product.
 - * Rated Voltage: 7.4V-14.8V (2 x 7.4V Parallel LP-E6 or NP-F Battery / AC-DC Adapter)
- Rated Current: 2A
- Operating Temperature: -5°C to +45°C

edelkrone[®]
filmmaking solutions

A detailed video explaining the edelkrone

App can be found at: <http://edel.krism3>

Documents / Resources

	edelkrone 80392 Motor Module for Slideplus [pdf] User Manual 80392 Motor Module for Slideplus, 80392, Motor Module for Slideplus, Motor Module, Module
---	---