



## ECS Electronics SZ-019-DL Towbar Wiring Kits Instruction Manual

[Home](#) » [ECS Electronics](#) » ECS Electronics SZ-019-DL Towbar Wiring Kits Instruction Manual 



## Contents

- 1 SZ-019-DL Towbar Wiring Kits
- 2 Part List
- 3 Socket connection
- 4 Documents / Resources
  - 4.1 References

## SZ-019-DL Towbar Wiring Kits

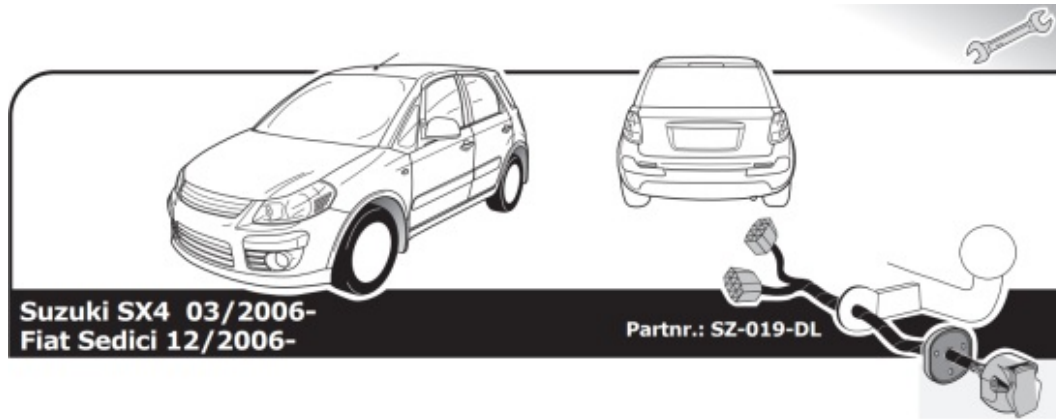

Fitting instructions electric wiring kit tow bar with 13-P socket up to DIN/ISO Norm 11446.

- We would expressly point out that assembly not carried out properly by a competent installer will result in cancellation of any right to damage compensation, in particular those arising by virtue of the product liability act.
- Contents of these kits and their fitting manuals are subject to alteration without notice, please ensure that these instructions are read and fully understood before commencing installation.
- Do not overload circuits; the maximum loads per connection are detailed in this manual.

## Part List

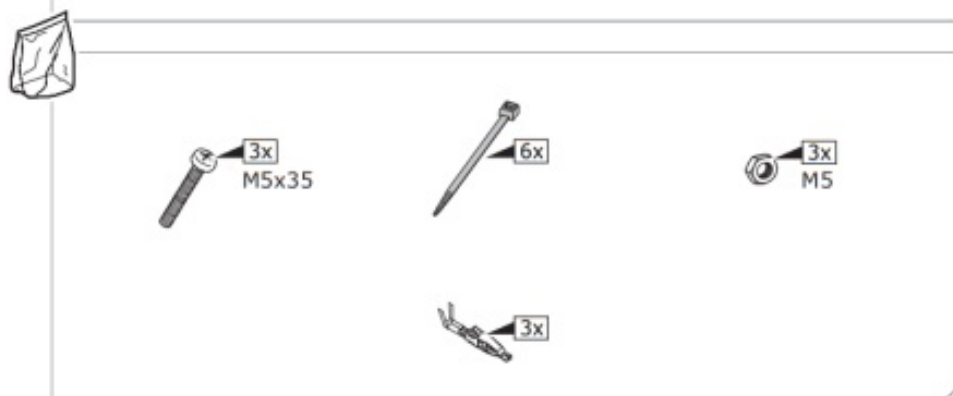
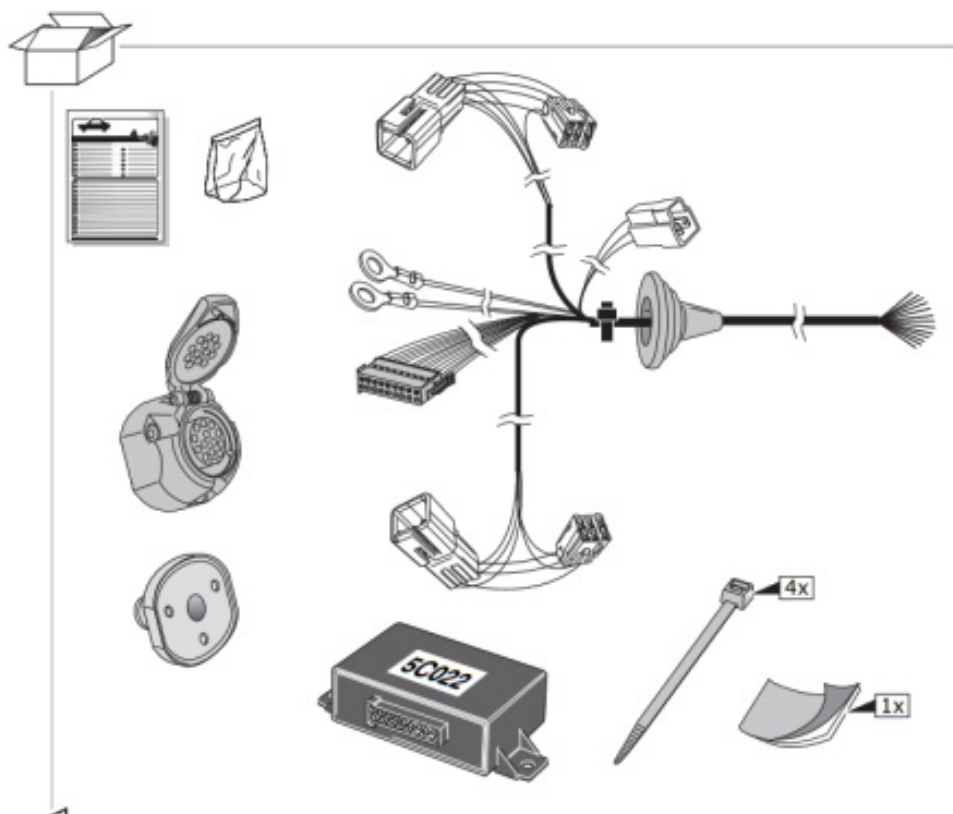

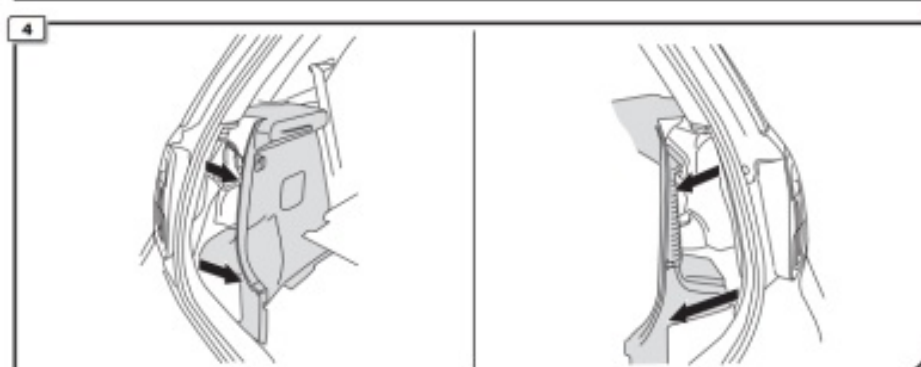
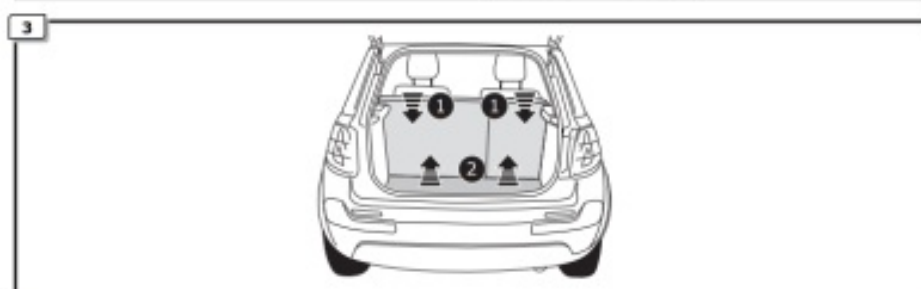
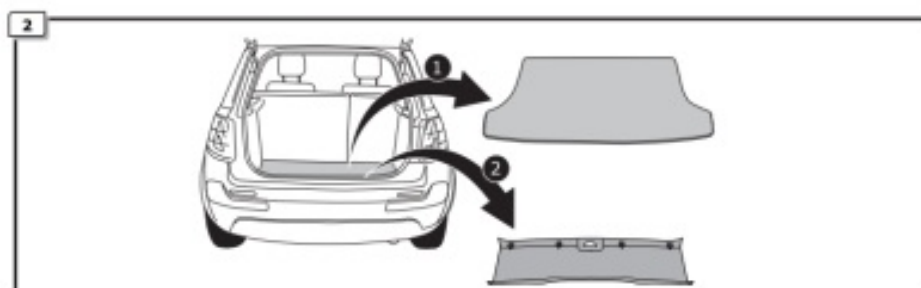
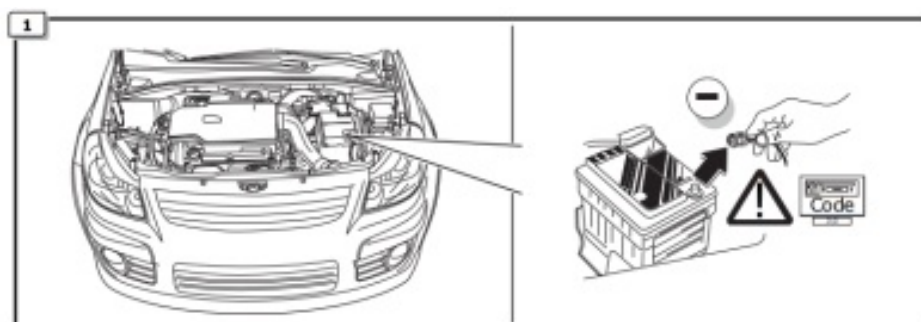

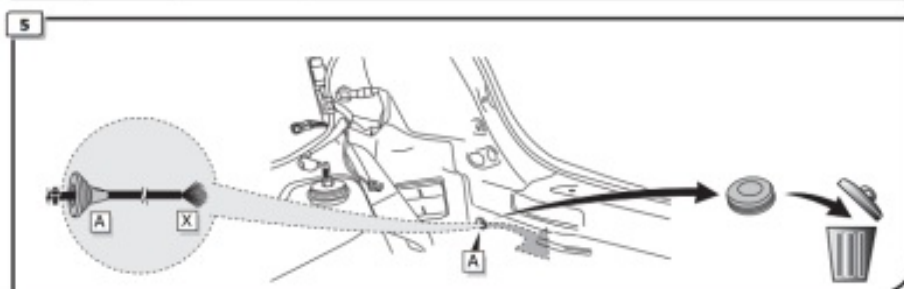
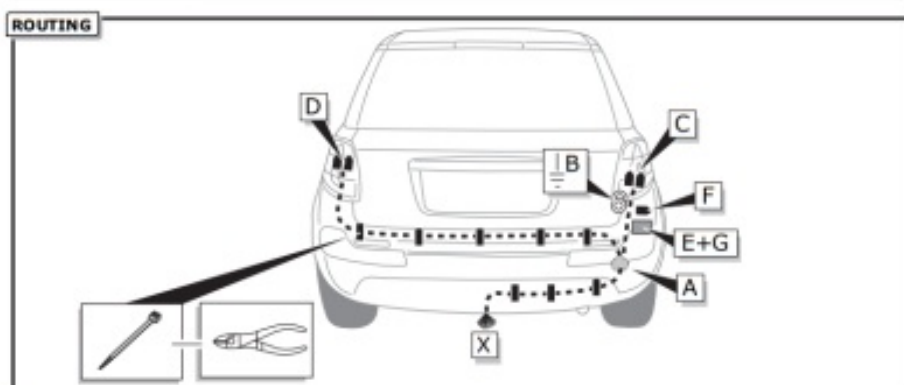
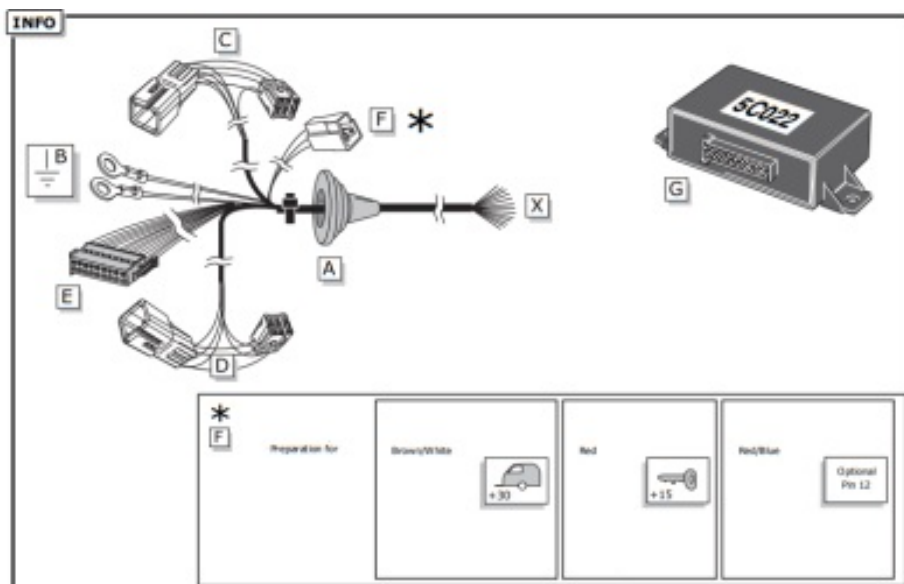

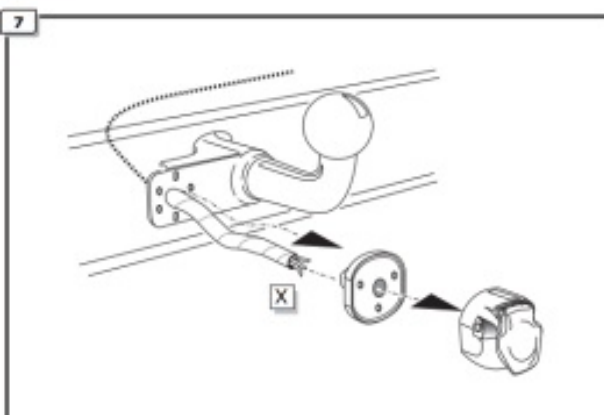
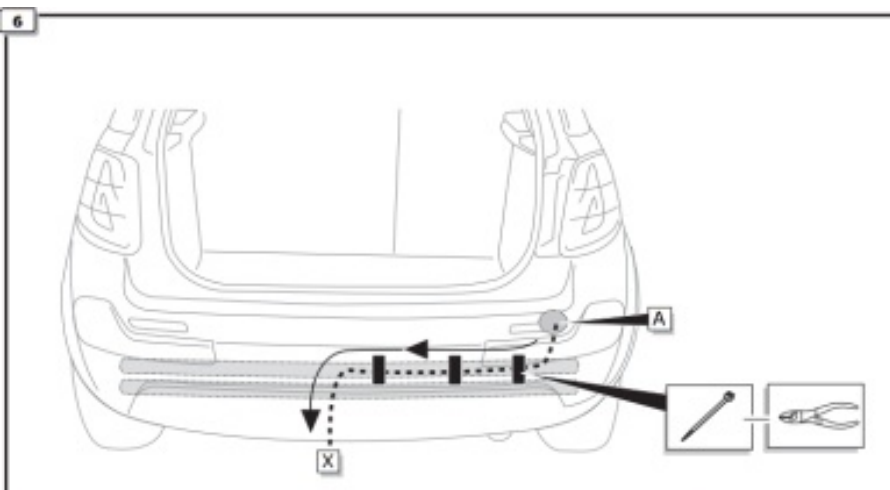

**INFO**

Socket connection

**Fig. 12**

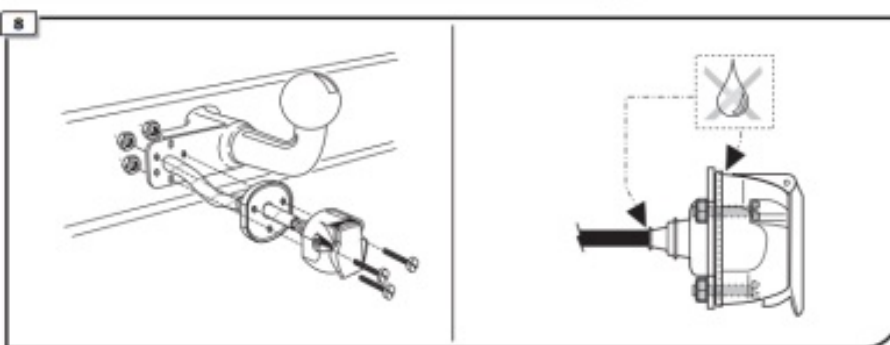

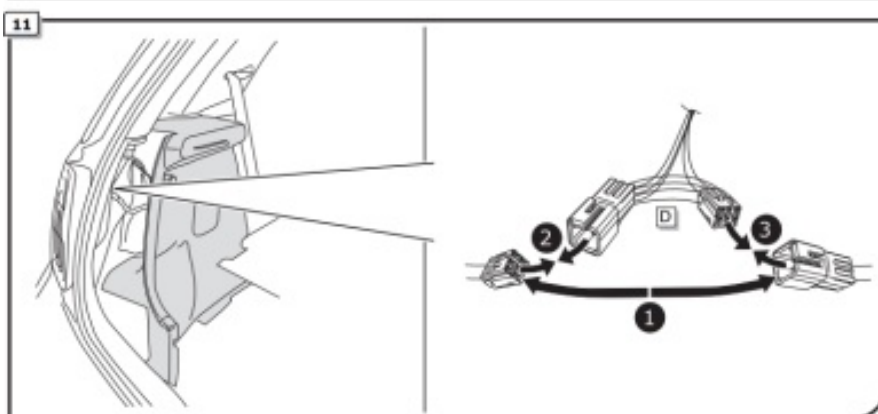
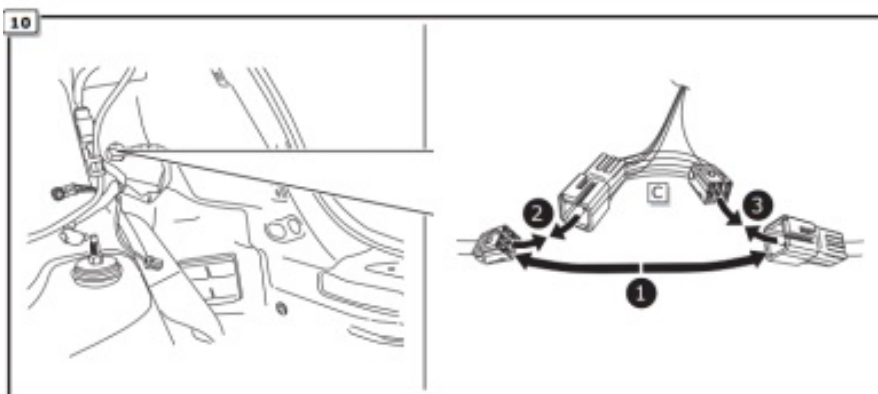
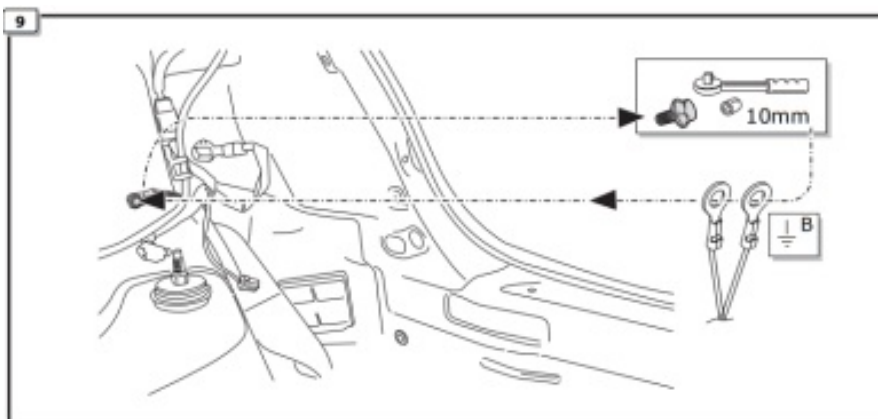

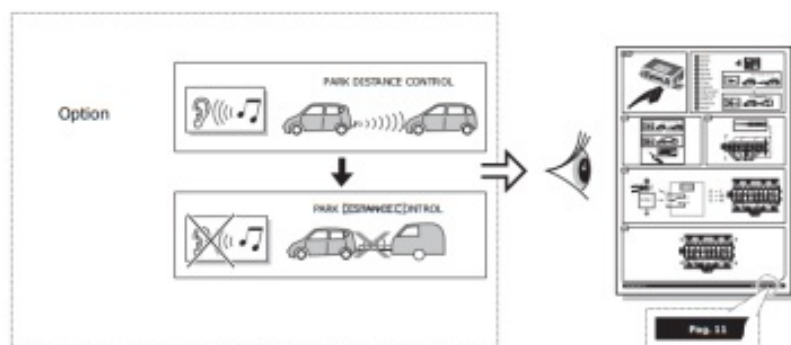

12

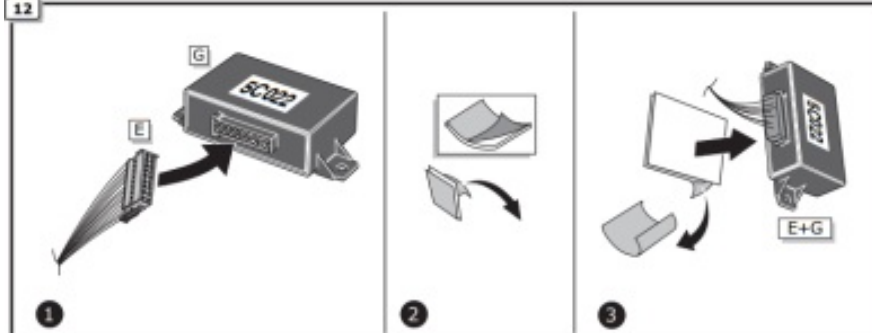

13

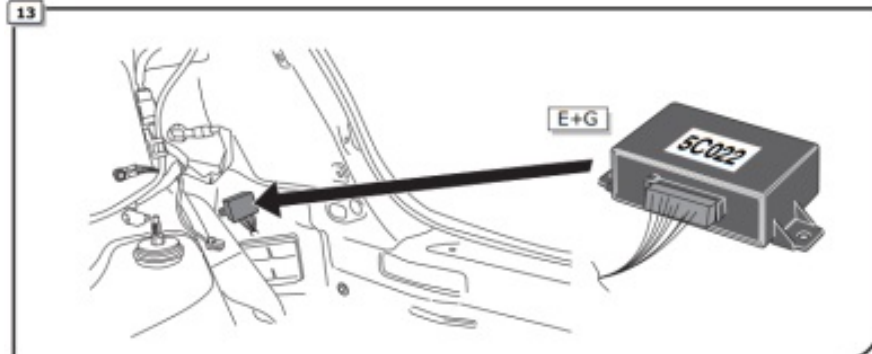



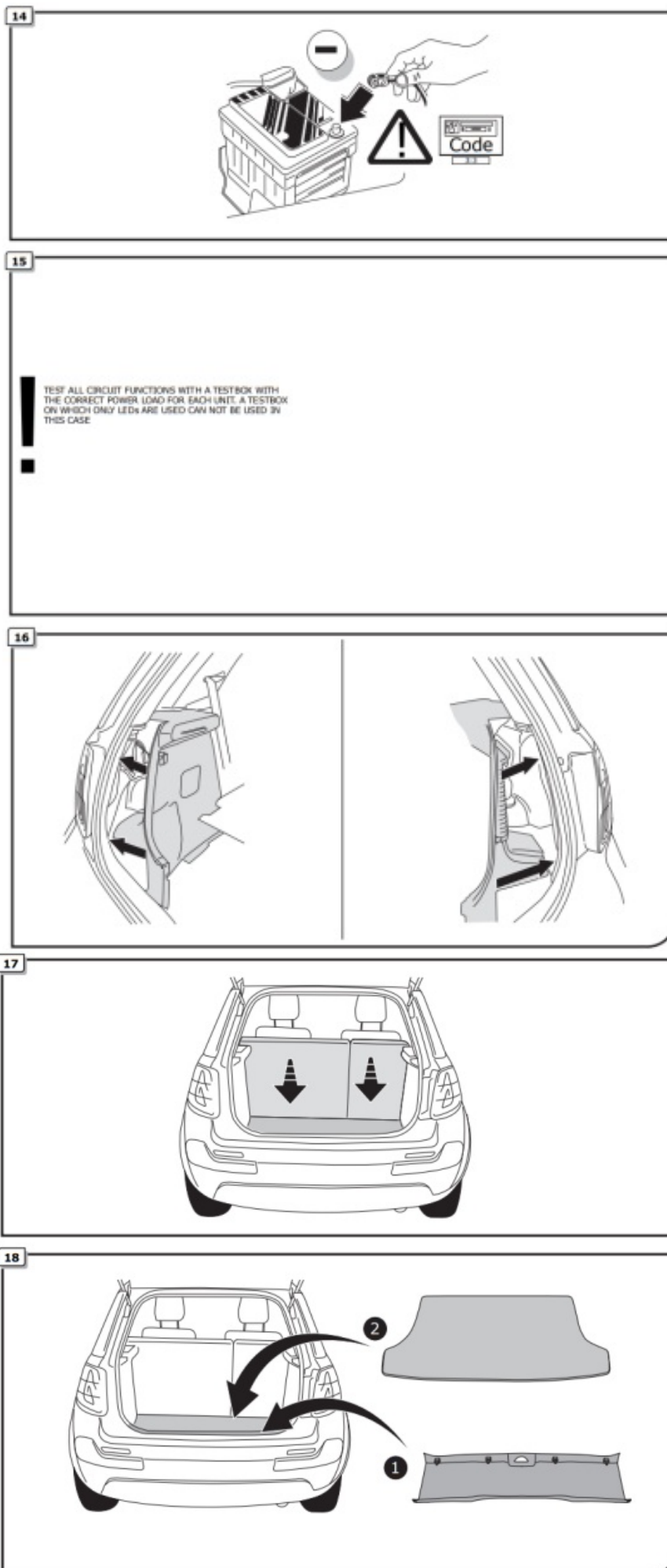





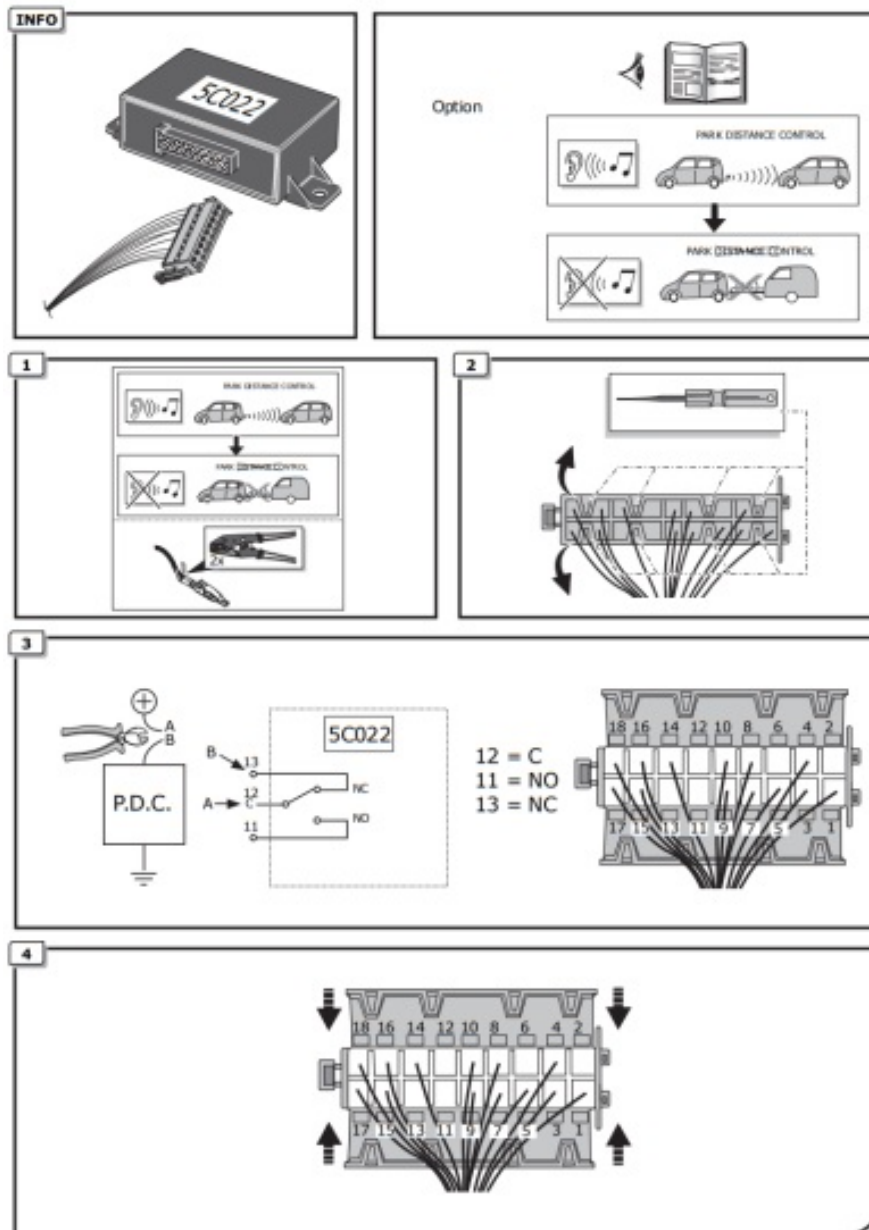



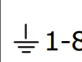

13-pole wiring-harness kit with C2-module. In this wiring-harness kit, the C2 module is used instead of a flasher relay with a C2 light failure sensor. A defective indicator of the car or/and caravan/trailer is stated by a quicker

flashing of the other indicator lights (Following the European directive 76/756/EEC §4.5.8. and StVZO §54). This wiring kit recognizes when a trailer/caravan is connected with the connection № 12 of the 13 pole socket. In the plug of the trailer/caravan, this connection has to be connected with the earth (connection № 3). - In order to avoid an overload of the C2 module, a maximum of 21W in indicator lights can be connected on each side. The functioning of the C2-module can be tested by connecting the trailer/caravan (or a test-box with 21W lamps) and switching on the indicator lights with a removed indicator light. The other indicator lights will flash quicker. (ATTENTION: a test-box on which only LED's are being used, can not be used in this case).

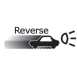

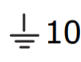
## Socket connection

|                                  |  |  |  |  |  |  |  |  |   |  |  |  |       |
|----------------------------------|--|--|--|--|--|--|--|--|---|--|--|--|-------|
| DI<br>N/I<br>SO<br>11<br>44<br>6 |  |  |  |  |  |  |  |  |  |  |  |  |       |
|                                  | 1 / L  | 2  | 3/31   | 4/R  | 5/58-R   | 6/54   | 7/58-L   | 8  | 9   | 10   | 11   | 12   | 13    |
| Pm<br>ax                         | 21W  | 2x21<br>W  |  | 21W  | 52W  | 3x21<br>W  | 52W  | 2x21<br>W  | 180W<br>/15A<br>mp.   | 180W<br>/15A<br>mp.  |  |  |       |
|                                  | Yell<br>ow   | Blue   | White  | Green  | Brow<br>n  | Red (1,00m<br>m²)  | Black  | Black/<br>Red  | Brow<br>n/Whi<br>te   | Red(2,50 m<br>m² )   | White  | Red/<br>Blue   | White |

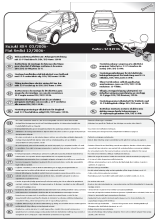

## Documents / Resources

|  |  |
|--|--|
|  | <a href="#">ECS Electronics SZ-019-DL Towbar Wiring Kits</a> [pdf] Instruction Manual<br>SZ-019-DL, SZ-019-DL Towbar Wiring Kits, SZ-019-DL, Towbar Wiring Kits, Wiring Kits, Kits |
|--|--|

## References

- [User Manual](#)

[Manuals+](#), [Privacy Policy](#)

This website is an independent publication and is neither affiliated with nor endorsed by any of the trademark owners. The "Bluetooth®" word mark and logos are registered trademarks owned by Bluetooth SIG, Inc. The "Wi-Fi®" word mark and logos are registered trademarks owned by the Wi-Fi Alliance. Any use of these marks on this website does not imply any affiliation with or endorsement.