



ecowitt GW1100 WiFi Weather Station Sensor Gateway User Guide

[Home](#) » [ECOWITT](#) » ecowitt GW1100 WiFi Weather Station Sensor Gateway User Guide 

ecowitt GW1100 WiFi Weather Station Sensor Gateway User Guide



Contents

- 1 Overview
- 2 Descriptions
- 3 Documents / Resources
 - 3.1 References
- 4 Related Posts

Overview

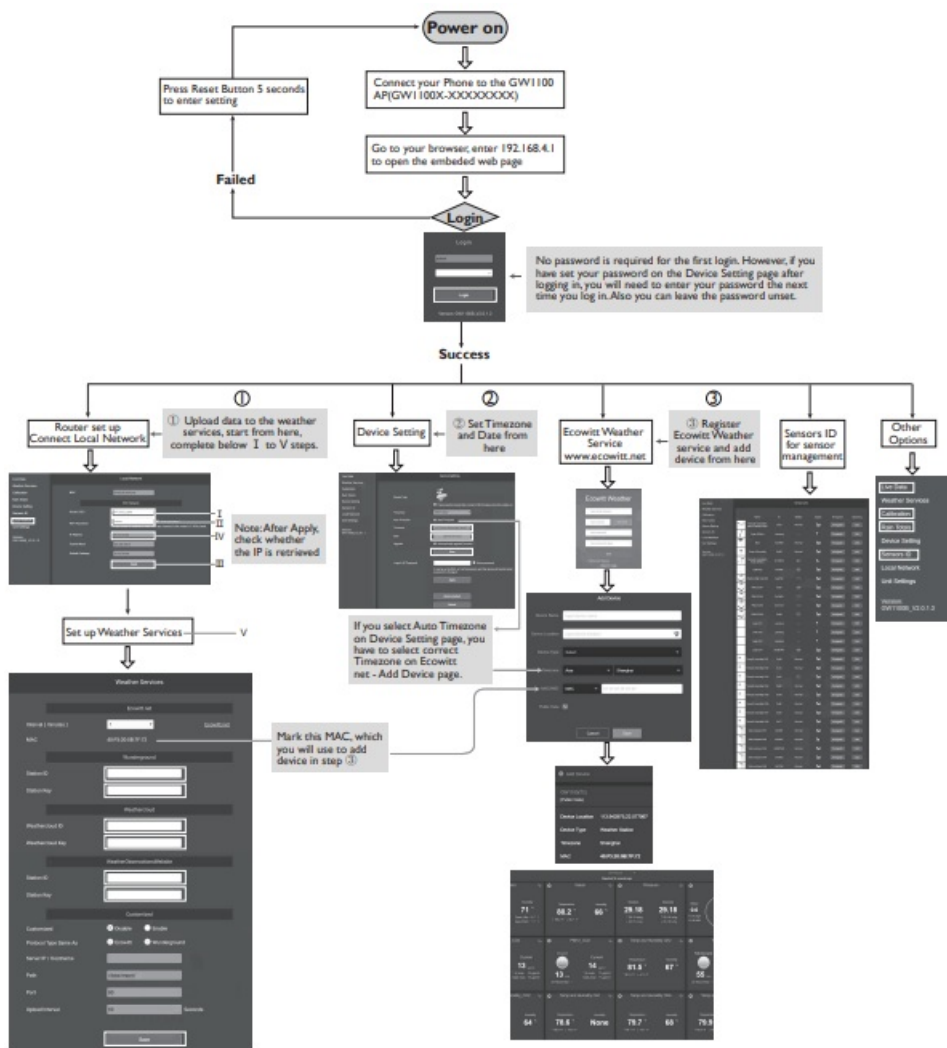

Attention:

Our product is continuously changing and improving, particularly online services and associated applications. To download the latest manual and additional help, please contact us at support@ecowitt.com or support.eu@ecowitt.net (EU/UK).

Manufacturer

ShenZhenShi OuSaiTeDianZi YouXianGongSi

Add: C Dong 4 Ceng A, Minzhujiujiugongyecheng AQU, Xihuanlu, Shajingjiedao, Baoanqu Shenzhen, Guangdong 518101, CN

E-mail: support@ecowitt.com support.eu@ecowitt.net (EU/UK)

UK representative

UK/AR

HUA TENG LIMITED
3 Glass Street, Hanley, Stoke On Trent, ST1 2ET United Kingdom

EC representative

EC/REP

AC WORKS CONSULTING Srl
Via Vilfredo Pareto 125, 47521 Casena(FC), ITALY

Descriptions

Warning:

- Any metal object may attract a lightning strike, including your weather station mounting pole. Never install the weather station in a storm.
- If you are mounting the weather station to a house or structure, consult a licensed electrician for proper grounding. A direct lightning strike to a metal pole can damage or destroy your home and the product.
- Installing your weather station in a high location may result in injury or death. Perform as much of the initial check out and operation on the ground and inside a building or home. Only install the weather station on a clear, dry, day.
- Please setup the system and put the sensors in a conveniently accessible temporary location for a few days, familiar with the system and make sure the system operate normally before install them into a permanent position. When you mount the sensor, remember to take your phone and have the webpage showing the data displayed, before fixing to the mounting pole, be sure you can see the signal can be picked up by the GW1100 gateway reliably. So check out on site system data while you are mounting the sensors.

Model difference overview:

Sensor Matched		GW1100	GW1101	GW1102	GW1103	GW1104
Multi CH T&H	WH31					<input checked="" type="checkbox"/>
Outdoor T&H	WH32			<input checked="" type="checkbox"/>		
Rain Gauge	WH40			<input checked="" type="checkbox"/>	<input checked="" type="checkbox"/>	
Wind & Solar	WS68			<input checked="" type="checkbox"/>		
Sensor Array	WS69		<input checked="" type="checkbox"/>			
Sonic Wind	WS80				<input checked="" type="checkbox"/>	

WH31&WH32

WH31 and WH32 looks quite similar, but with different function definition applied. WH32 is a dedicated outdoor temperature and humidity sensor, it has highest priority against WS69 or WS80 integrated sensor temperature and humidity data. WH31 is a dip switch selectable multi-channel temperature and humidity sensor. It supports maximum 8 channels. Sensor operates on 2pcs AA Alkaline batteries.

- ☒ Switch in down position.
☐ Switch in up position.

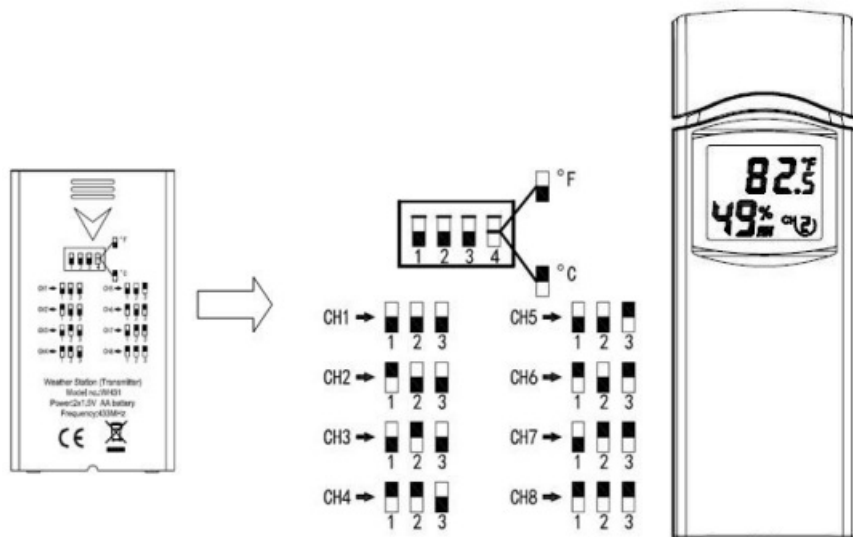

WH40

WH40 is a rain gauge. Be sure to lock the funnel firmly and in position(tell by having the arrow mark matched).The battery door should be tightly locked without gaps. 1pcAA battery (Lithium non rechargeable recommended). LED flashes every 49s in normal operation. Press “RESET” button if LED doesn’t light up or stays on all the time.

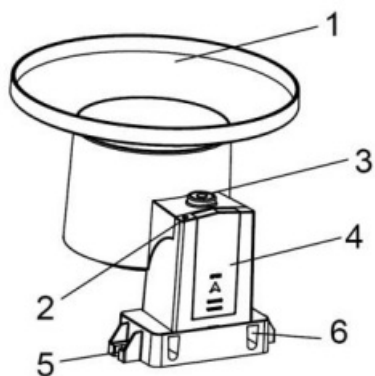

1. Rain collector top	4. Battery compartment door
2. LED Indicator	5. Surface installation screw hole
3. Bubble level	6. U-bolt installation hole

surface mounting:

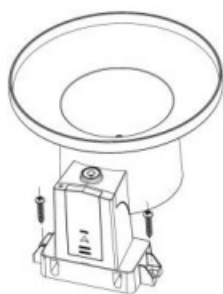

Pole mounting:
(not included)

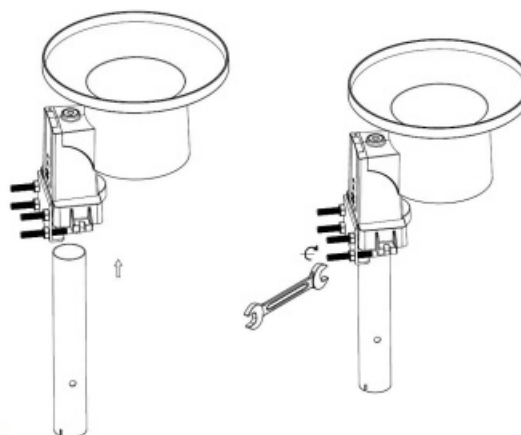

WS68

It operates on 1 AA battery (Lithium recommended).

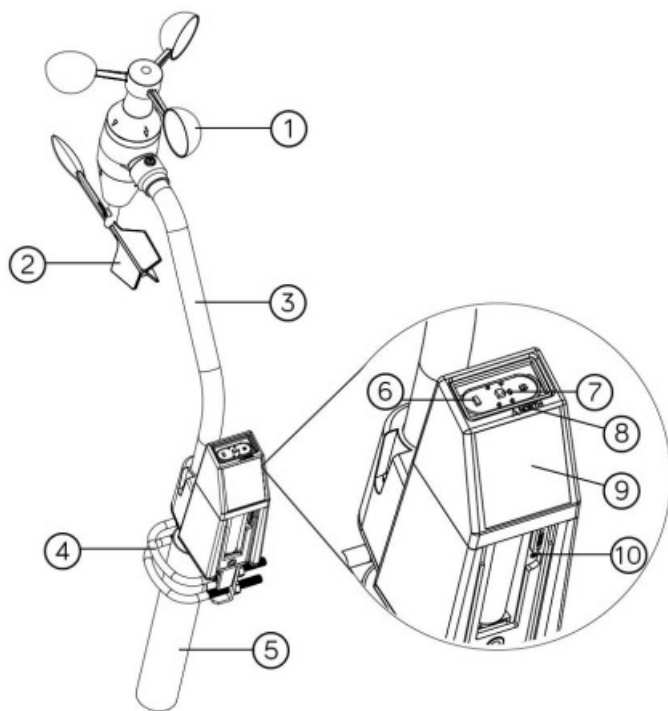

1.Wind speed cups	6. LED (red) to indicate data transmission
2.Wind vane	7. Light sensor and UV sensor
3. Connection tube	8. NORTH arrow
4. U-Bolts	9. Solar panel
5. Mounting Pole(not included)	10. Reset button

WS69

It requires 2pcs AA Lithium(recommended) or Alkaline batteries. LED flashes every 16s in normal operation. Press "RESET" button if LED doesn't light up or stays on all the time.

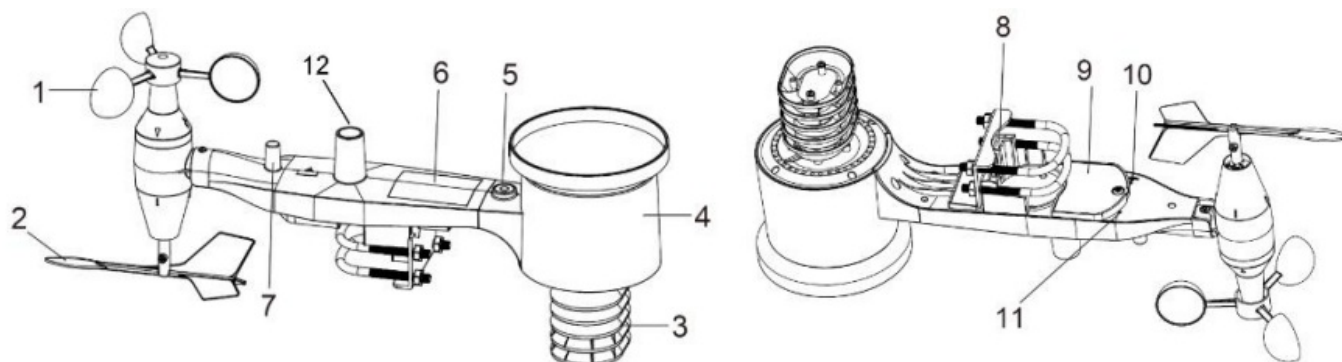

1. Surface tension conditioner layer (patent pending)	7. Mounting arm
2. Battery compartment	8. Mounting bracelet and U-bolt set
3. Temperature & humidity sensor	9. Power cord for built-in heater(12v1.0A)
4. Light & UV sensor, LED indicator	10. USB port (factory use only)
5. Solar Panel	11.Calibration button (factory use only)
6. NORTH alignment indicator	12. Reset button

WS80

It requires 2pcs AA Lithium(recommended) or Alkaline batteries. LED flashes every 5s in normal operation. Press "RESET" button if LED doesn't light up or stays on all the time.

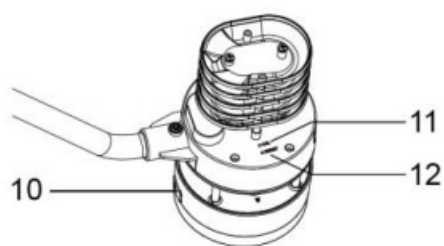
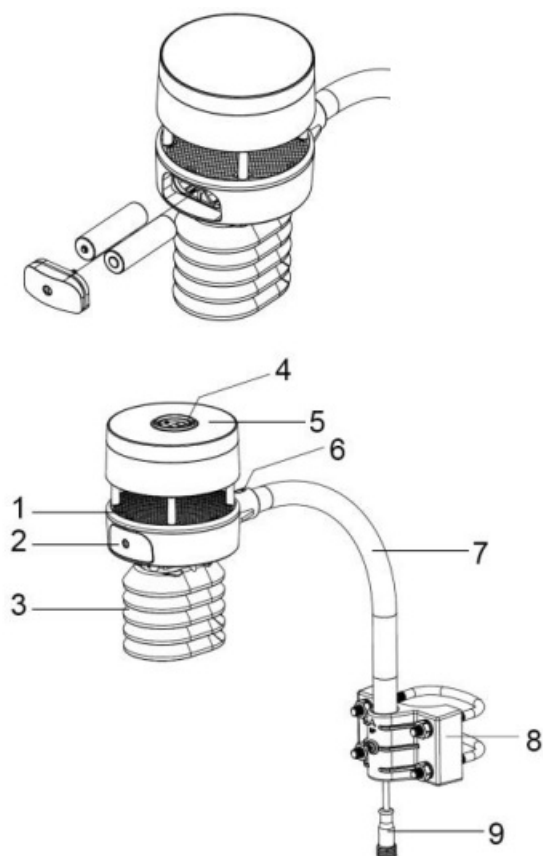

1. Surface tension conditioner layer (patent pending)	7. Mounting arm
2. Battery compartment	8. Mounting bracelet and U-bolt set
3. Temperature & humidity sensor	9. Power cord for built-in heater(12v1.0A)
4. Light & UV sensor, LED indicator	10. USB port (factory use only)
5. Solar Panel	11.Calibration button (factory useonly)
6. NORTH alignment indicator	12. Reset button



Please scan the QR code to read English manual and keep it for future reference

Instruction manuals

<https://www.ecowitt.com/support/download/106>

Documents / Resources

	<p>ecowitt GW1100 WiFi Weather Station Sensor Gateway [pdf] User Guide GW1100, WiFi Weather Station Sensor Gateway, GW1100 WiFi Weather Station Sensor Gateway, Weather Station Sensor Gateway, Sensor Gateway, Gateway</p>
--	--

References

- [Ecowitt Weather](#)
- [ECOWITT Welcome to Ecowitt!](#)

