



# ECOVACS ROBOTICS Deebot R95 Robot Vacuum Instruction Manual

[Home](#) » [ECOVACS ROBOTICS](#) » ECOVACS ROBOTICS Deebot R95 Robot Vacuum Instruction Manual 



## Contents

- [1 Deebot R95 Robot Vacuum](#)
- [2 Important Safety Instructions](#)
- [3 Package Contents and Technical Specifications](#)
- [4 Operating and Programming](#)
- [5 Maintenance](#)
- [6 Troubleshooting](#)
- [7 Documents / Resources](#)
  - [7.1 References](#)

## Deebot R95 Robot Vacuum



## Instruction Manual

### Live Smart. Enjoy Life.

Congratulations on the purchase of your ECOVACS ROBOTICS DEEBOT!

We hope it brings you many years of satisfaction. We trust the purchase of your new robot will help keep your home clean and provide you with more quality time to do other things.

Before you go any further, please register your product on the ECOVACS ROBOTICS website at [www.ecovacsrobotics.com/registration/](http://www.ecovacsrobotics.com/registration/). We also suggest you record your model number, serial number, date of purchase and attach your receipt to this page for safekeeping.

MODEL #

SERIAL #

DATE OF PURCHASE —/—/—

Should you have any problems programming the robot or getting your robot to function properly, please call us before contacting or returning it to the place of purchase. Call toll free number 1-844-ECOVACS (1-844-326-8227) or 1-330-994-1760 from outside the United States of America and Canada for assistance.

**Thank you for choosing DEEBOT!**

## Important Safety Instructions

### IMPORTANT SAFETY INSTRUCTIONS

**WARNING:** Read all safety warnings and instructions. "

Failure to follow the warnings and instructions may result in electric shock, fire or serious injury. When using an electrical appliance, basic precautions should always be followed, including the following:

**READ ALL [INSTRUCTIONS BEFORE USING THIS APPLIANCE.**

**WARNING** — To reduce the risk of fire, electric shock, or injury:

1. Do not allow to be used as a toy. Close attention is necessary when used by or near children.
2. Clear the area to be cleaned. Remove power cords and small objects from the floor that could entangle the Appliance. Tuck rug fringe under the rug base, and lift items such as curtains and tablecloths off the floor.
3. If there is a drop off in the cleaning area due to a step or stairs, you should operate the Appliance to ensure that it can detect the step without falling over the edge. It may become necessary to place a physical barrier at the edge to keep the unit from falling. Make sure the physical barrier is not a trip hazard.
4. Only use as described in this manual. Only use attachments recommended or sold by the manufacturer.
5. Please make sure your power supply voltage matches the power voltage marked on the Charging Dock.

6. Do not handle plug or appliance with wet hands.
7. Use only the original rechargeable battery and Charging Dock provided with the Appliance from the manufacturer. Non- rechargeable batteries are prohibited. For battery information, please refer to Specifications section.
8. Do not use without dust bin and/or filters in place.
9. Do not operate the vacuum in an area where there are lit candles or fragile objects on the floor to be cleaned.
10. Do not use and store in extremely hot or cold environments (below -5°C /23°F or above 40°C/104°F). Please charge the robot in temperature above 0°C/32°F and below 40°C/104°F.
11. Keep hair, loose clothing, fingers, and all parts of body away from any openings and moving parts.
12. Do not operate the Appliance in a room where an infant or child is sleeping.
13. Do not use Appliance on wet surfaces or surfaces with standing water. Do not use outdoors. For INDOOR use ONLY.
14. Do not allow the Appliance to pick up large objects like stones, large pieces of paper or any item that may clog the Appliance.
15. Do not use Appliance to pick up flammable or combustible materials such as gasoline, printer or copier toner, or use in areas where they may be present. “
16. Do not use Appliance to pick up anything that is burning or smoking, such as cigarettes, matches, hot ashes, or anything that could cause a fire.
17. Do not put any object into openings. Do not use with any opening blocked; keep free of dust, lint, hair, and anything that may reduce air flow.
18. Take care not to damage the power cord. Do not pull on or carry the Appliance or Charging Dock by the power cord, use the power cord as a handle, close a door on the power cord, or pull power cord around sharp edges or corners. Do not run Appliance over the power cord. Keep power cord away from hot surfaces. Do not unplug by pulling on cord. To unplug, grasp the plug, not the cord.
19. If the power cord is damaged, it must be replaced by the manufacturer or its service agent in order to avoid a hazard.
20. Do not use the Charging Dock if it is damaged.
21. Do not use with a damaged power cord or plug. Do not use the Appliance or Charging Dock if it is not working properly, has been dropped, damaged, left outdoors, or come in contact with water. It must be repaired by the manufacturer or its service agent in order to avoid a hazard.
22. Turn OFF the power switch before cleaning or maintaining the Appliance. Turn off all controls before unplugging.
23. The plug must be removed from the receptacle before cleaning or maintaining the Charging Dock.
24. Remove the Appliance from the Charging Dock, and turn OFF the power switch to the Appliance before removing the battery for disposal of the Appliance.
25. The battery must be removed and discarded according to local laws and regulations before disposal of the Appliance.
26. Please dispose of used batteries according to local laws and regulations.
27. Do not incinerate the Appliance even if it is severely damaged. The batteries can explode in a fire.
28. When not using the Charging Dock for a long period of time, please unplug it.
29. The Appliance must be used in accordance with the directions in this Instruction Manual. ECOVACS ROBOTICS cannot be held liable or responsible for any damages or injuries caused by improper use.
30. Prevent unintentional starting. Ensure the switch is in the off position before connecting to battery pack, picking

up or carrying the appliance. Carrying the appliance with your finger on the switch or energizing appliance that have the switch on invites accidents.

31. When battery pack is not in use, keep it away from other metal objects, like paper clips, coins, keys, nails, screws or other small metal objects, that can make a connection from one terminal to another. Shorting the battery terminals together may cause burns or a fire.
32. Under abusive conditions, liquid may be ejected from the battery; avoid contact. If contact accidentally occurs, flush with water. If liquid contacts eyes, additionally seek medical help. Liquid ejected from the battery may cause irritation or burns.
33. Do not use a battery pack or appliance that is damaged or modified. Damaged or modified batteries may exhibit unpredictable behavior resulting in fire, explosion or risk of injury.
34. Do not expose a battery pack or appliance to fire or excessive temperature. Exposure to fire or temperature above 130°C may cause explosion. The temperature of 130°C can be replaced by the temperature of 265°F.
35. Follow all charging instructions and do not charge the battery pack or appliance outside of the temperature range specified in the instructions. Charging improperly or at temperatures outside of the specified range may damage the battery and increase the risk of fire.
36. Have servicing performed by a qualified repair person using only identical replacement parts. This will ensure that the safety of the product is maintained.
37. Do not modify or attempt to repair the appliance or the battery pack (as applicable) except as indicated in the instructions for use and care.
38. Disconnect the battery pack from the appliance before making any adjustments, changing accessories, or storing appliance. Such preventive safety measures reduce the risk of starting the appliance accidentally.
39. Place the cords from other appliances out of the area to be cleaned.
40. Do not operate the vacuum in a room that has lit candles on furniture that the vacuum may accidentally hit or bump into.
41. Do not allow children to sit on the vacuum.
42. Recharge only with the charger specified by the manufacturer. A charger that is suitable for one type of battery pack may create a risk of fire when used with another battery pack.
43. Use appliances only with specifically designated battery packs. Use of any other battery packs may create a risk of injury and fire.
44. The robot contains batteries that are only replaceable by skilled persons. To replace the robot's battery, please contact Customer Service.
45. If the robot will not be used for a long time, power OFF the robot for storage and unplug the Charging Dock.

#### **For Household Use Only.**

This Device Complies with DHHS Radiation Rules, 21CFR Chapter 1, Subchapter J.

This device complies with Part 15 of the FCC Rules / Industry Canada licence-exempt RSS standard(s).

Operation is subject to the following two conditions: (1) this device may not cause harmful interference, and (2) this device must accept any interference received, including interference that may cause undesired operation. Changes or modifications not expressly approved by the party responsible for compliance could void the user's authority to operate the equipment.

This equipment has been tested and found to comply with the limits for a Class B digital device, pursuant to part 15 of the FCC Rules. These limits are designed to provide reasonable protection against harmful interference in a residential installation.

This equipment generates uses and can radiate radio frequency energy and, if not installed and used in accordance with the instructions, may cause harmful interference to radio communications.

However, there is no guarantee that interference will not occur in a particular installation. If this equipment does cause harmful interference to radio or television reception, which can be determined by turning the equipment off

and on, the user is encouraged to try to correct the interference by one or more of the following measures:

- Reorient or relocate the receiving antenna.
- Increase the separation between the equipment and receiver.
- Connect the equipment into an outlet on a circuit different from that to which the receiver is connected.
- Consult the dealer or an experienced radio/TV technician for help.

To satisfy FCC / IC RF exposure requirements, a separation distance of 20 cm or more should be maintained between the antenna of this device and persons during device operation.

To ensure compliance, operations at closer than this distance is not recommended.

To disable Wi-Fi module on DEEBOT, power the robot ON. Place the robot on the Charging Dock making sure the Charging Contacts on DEEBOT and the Charging Dock Pins make a connection.

Press and hold the AUTO Mode Button on the robot for 20 seconds until DEEBOT emits 3 beeps.

To enable Wi-Fi module on DEEBOT, power the robot OFF and then power ON. The Wi-Fi module is turned on when DEEBOT is restarted.

## Package Contents and Technical Specifications

### 2.1 Package Contents

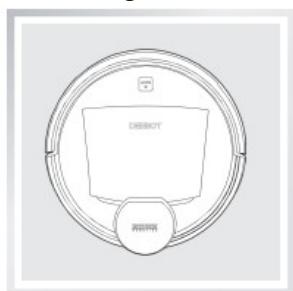

Robot

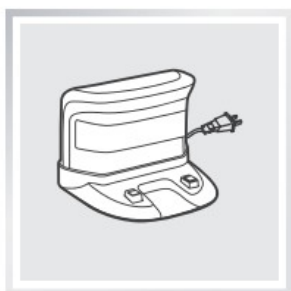

Charging Dock



Instruction Manual

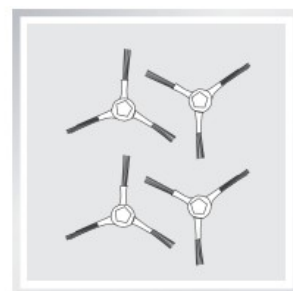

(4) Side Brushes

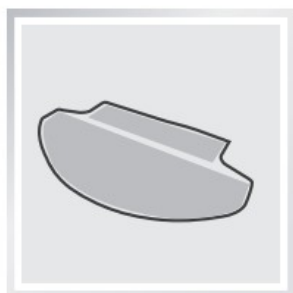

(2) Advanced Wet/  
Dry Cleaning Cloths

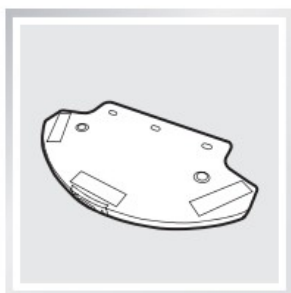

Advanced Wet/Dry  
Reservoir



Measuring Cup



QSG

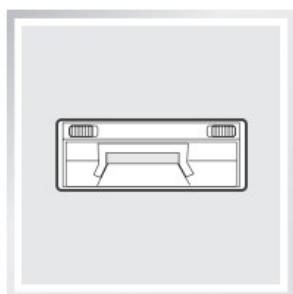

Direct Suction Option

### 2.2 Specifications

Model	DR95		
Working Voltage	14.8V DC	Rated Power	30W
Charging Dock Model	CH1465A		
Rated Input Voltage	100-240V AC	Rated Output Voltage	20V DC
Rated Output Current	1A	Rated Power	25W
Battery	Lithium Battery 2850mAh		
Laser	Max. Power 2.5mW		
	Frequency 1.8KHz		
	Rotate Speed SOO: 5 drcle/mln		

\* Technical and design specifications may be changed li the course of continuous product improvement.

## 2.3 Product Diagram Robot

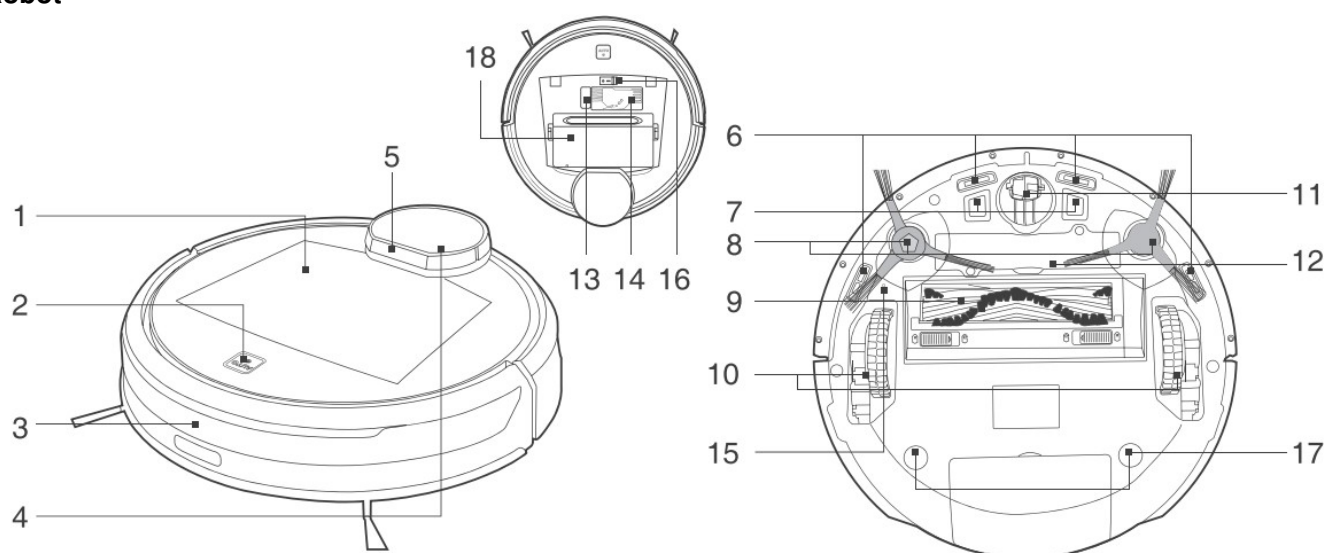

1. Top Cover
2. AUTO Mode Button
3. Anti-Collision Sensors and Bumper
4. LDS (Laser Distance Sensor)
5. LDS Bumper
6. Anti-Drop Sensors
7. Charging Contacts
8. Side Brushes
9. Main Brush

10. Driving Wheels
11. Universal Wheel
12. Battery Pack with Screws
13. Upgrade Port
14. Multi-Function Cleaning Tool
15. RESET Button
16. Power Switch
17. Advanced Wet/Dry Reservoir Slots
18. Dust Bin

## Control Panel

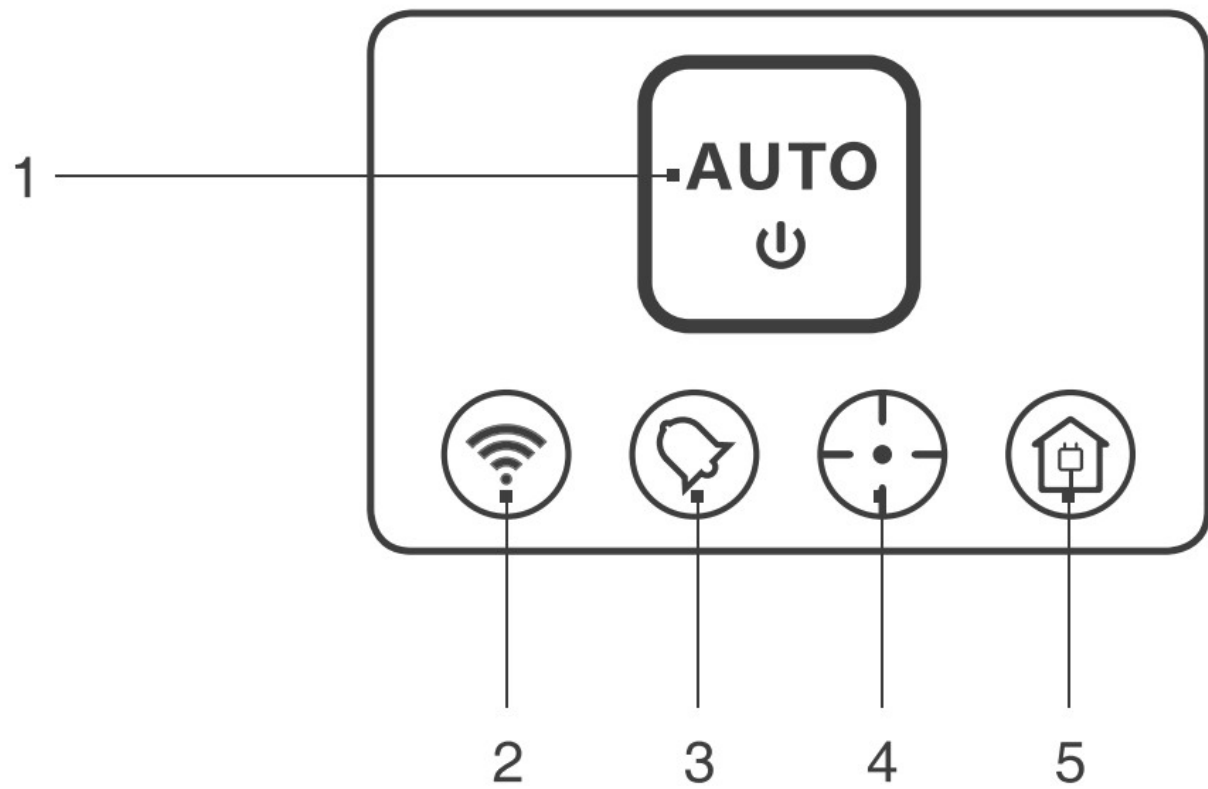

1. AUTO Mode Button
2. Wi-Fi Indicator
3. Scheduled Cleaning Indicator
4. Spot Mode Indicator
5. Return to Charger Mode Indicator

### Charging Dock

- 1.

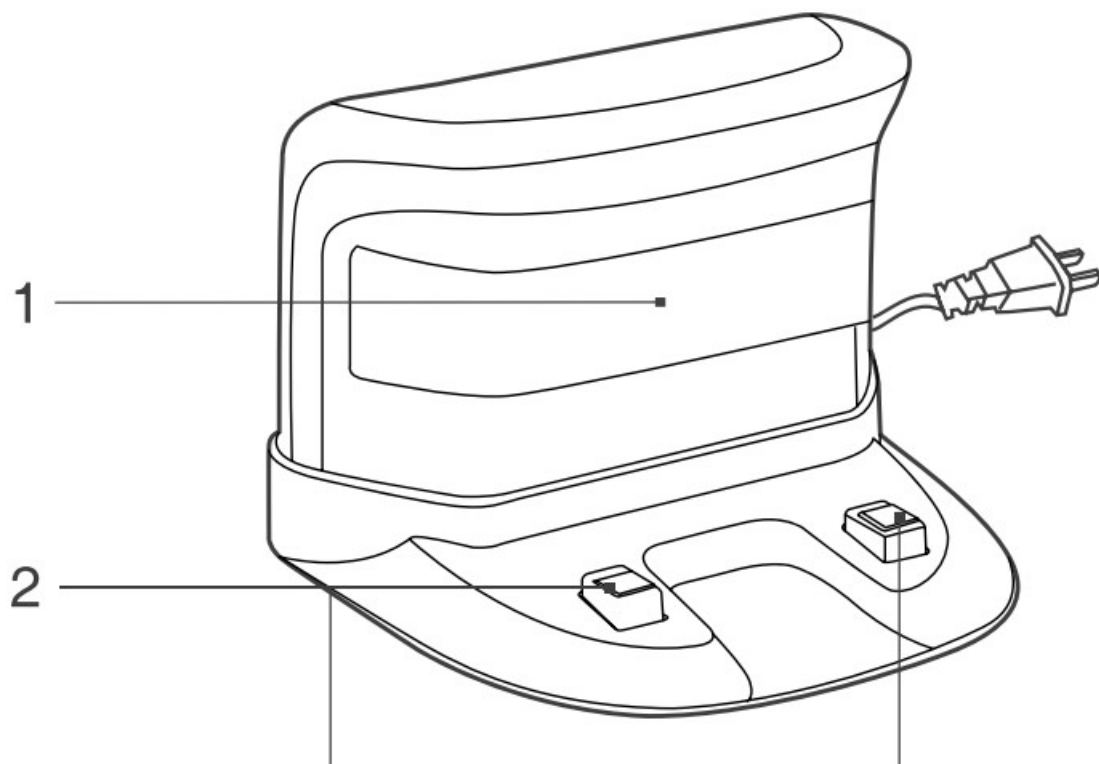

Infrared Signal Generators

2. Charging Dock Pins

### Dust Bin

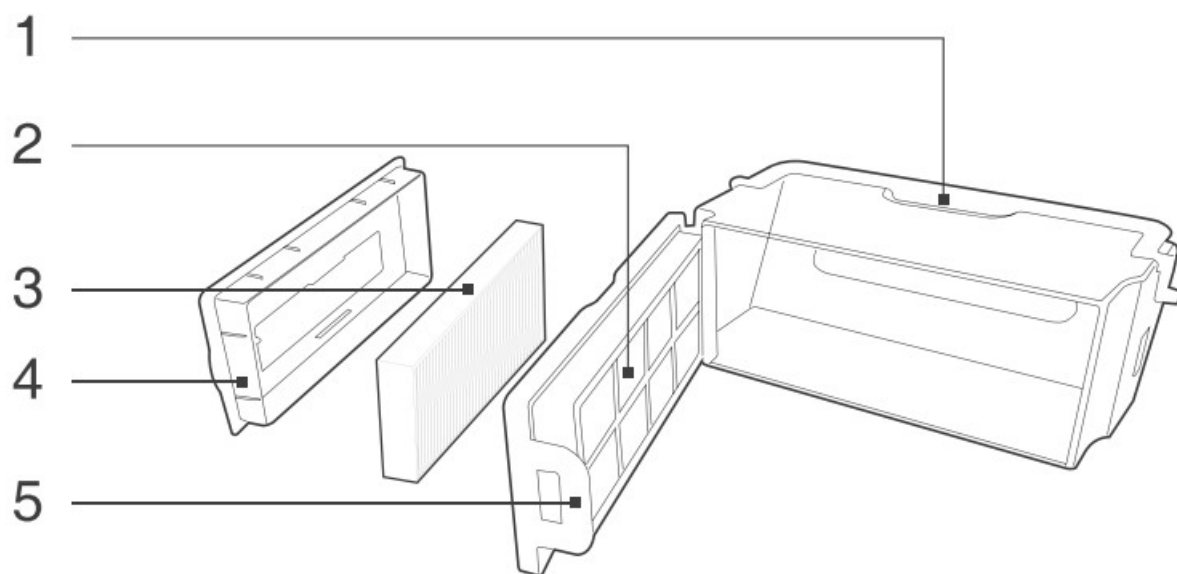

1. Dust Bin Handle
2. Filter Net
3. High Efficiency Filter
4. Dust Bin Cover
5. Dust Bin Lock

### Advanced Wet/Dry Cleaning Cloth and Advanced Wet/Dry Reservoir



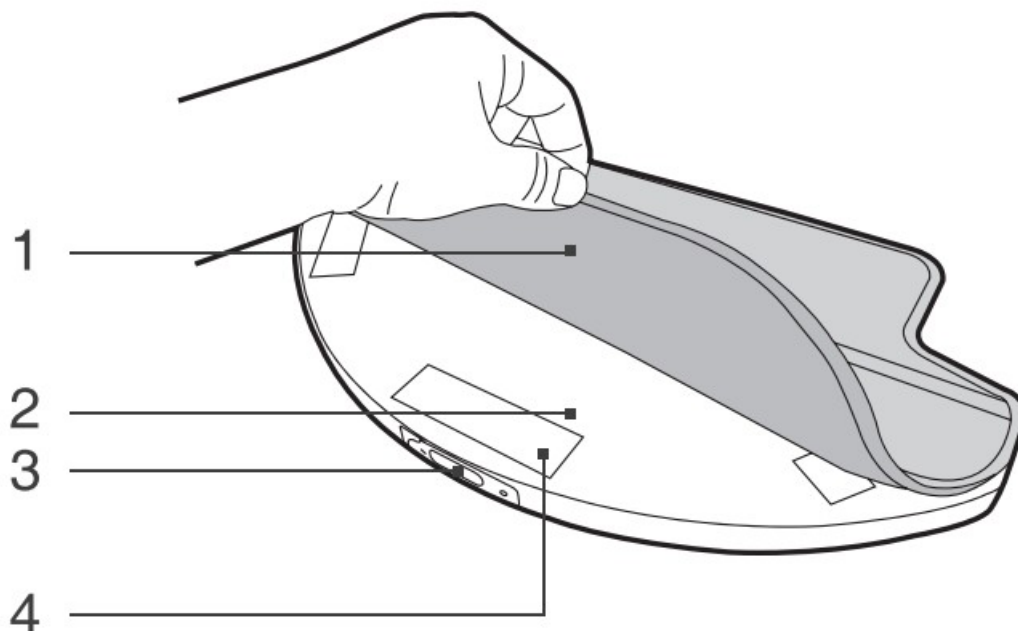

1. Advanced Wet/Dry Cleaning Cloth
2. Advanced Wet/Dry Reservoir
3. Water Inlet
4. Velcro

## Operating and Programming

### 3.1 Notes Before Cleaning

DEEGOT uses SMART NAVI technology (a proprietary laser scanning and mapping system) to scan and generate a map of the home environment.

Before operating DEEBOT, take a few moments to survey the area to be cleaned and remove any obstacles. Please supervise DEEBOT during its first cleaning and assist should there be a problem.

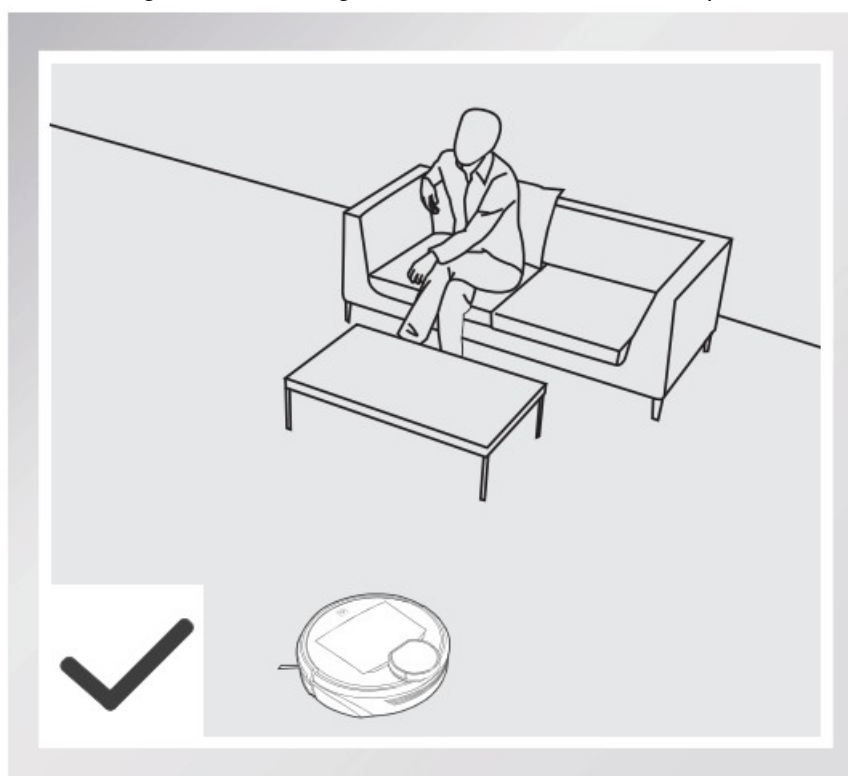

Remove power cords and small objects from the floor that could entangle the product.

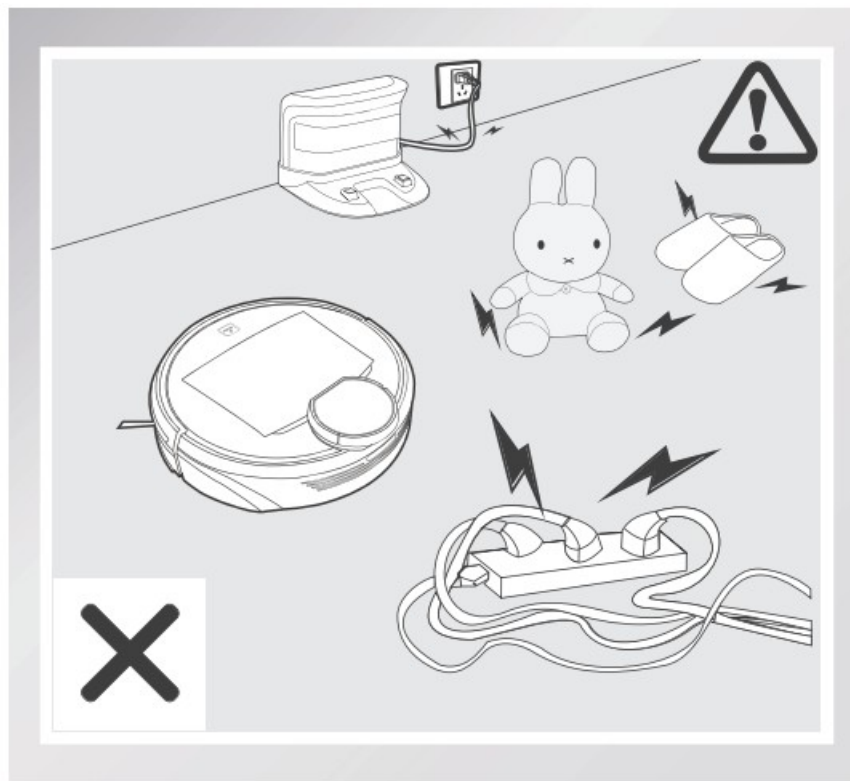

If there is a narrow entrance to a space between furniture, please place a physical barrier to stop the unit from entering that area.

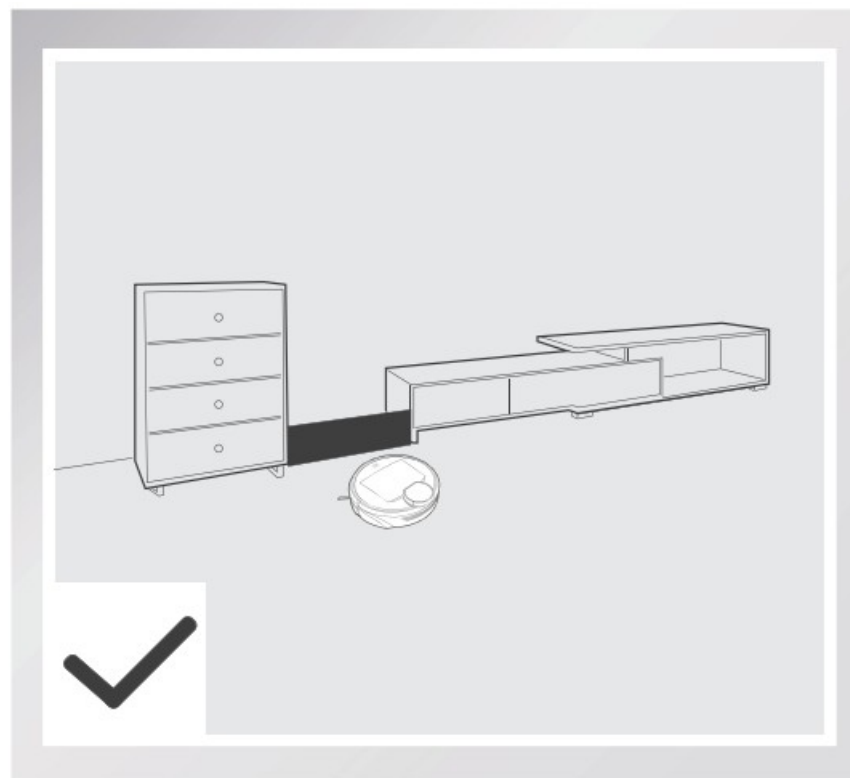

The product is not suitable for use on long pile carpet. Before using the product near an area rug with tasseled edges, please fold area rug edges under themselves.

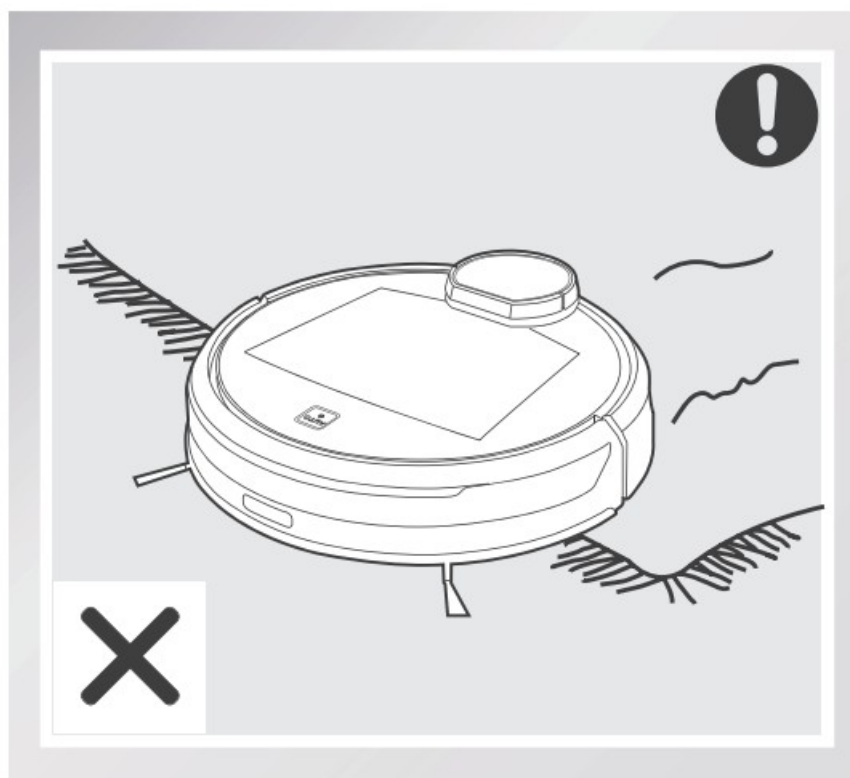

Please be aware that DEEBOT may climb on objects of less than 1.8cm (0.7") height. Please remove these objects if possible.

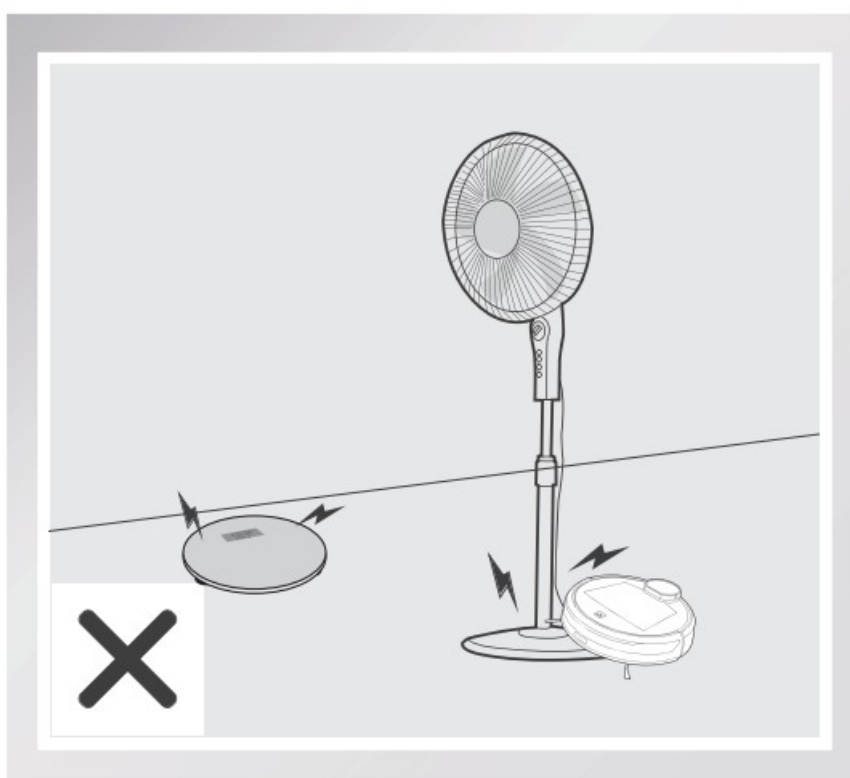

Please be aware that DEEBOT needs at least an 110m (4.3°) clearance to clean under furniture without complications.

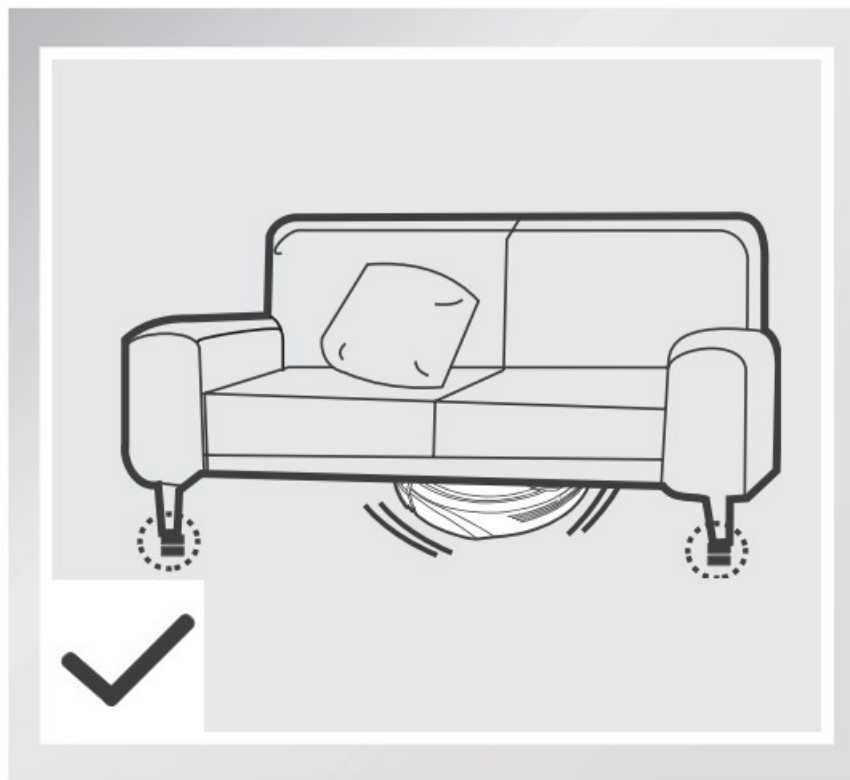

If there is a step or stairs in the cleaning area, please operate DEEBOT to ensure its Anti-Drop Sensors can detect the drop off. It may be necessary to place a physical barrier at the edge of the drop off to keep the unit from falling over the edge.

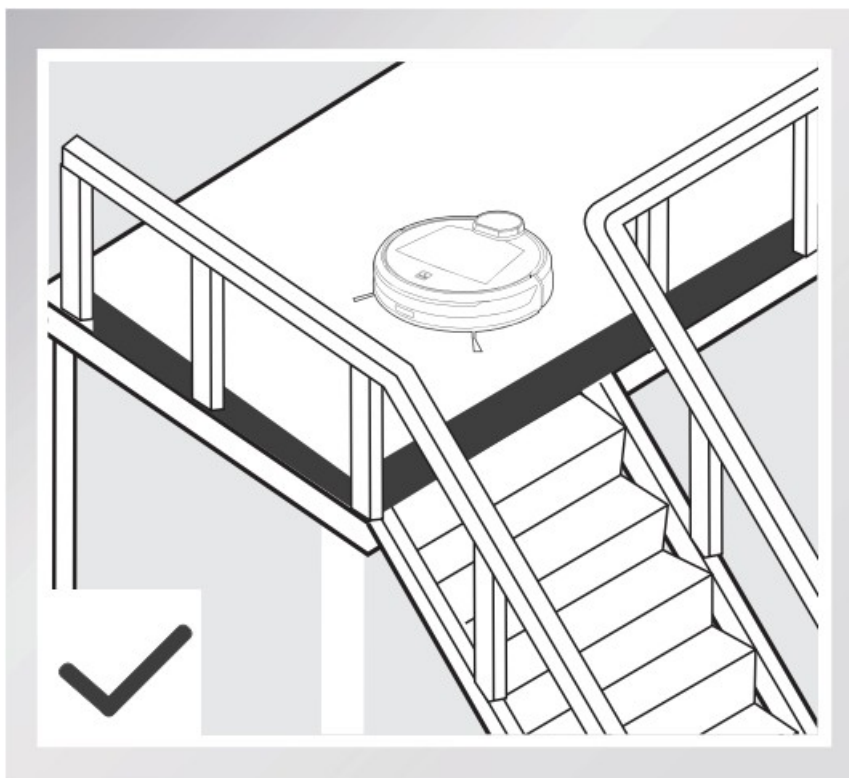

Please cover reflective surfaces 13cm (5.1") from the ground,

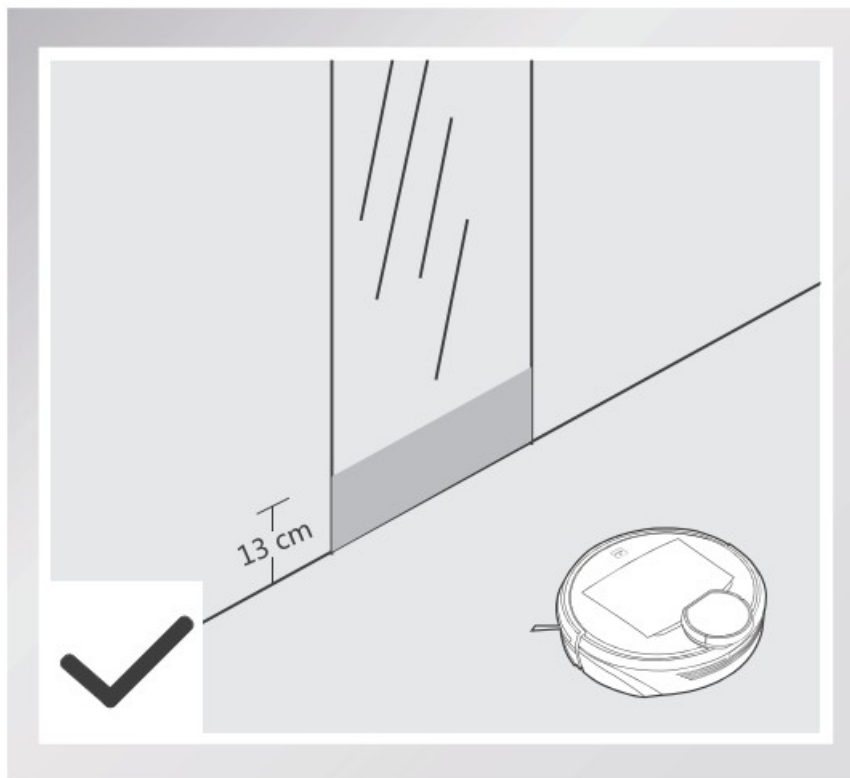

When DEEBOT is cleaning, please do not stand in narrow spaces, such as hallways, or DEEBOT may fail to identify the area to be cleaned.

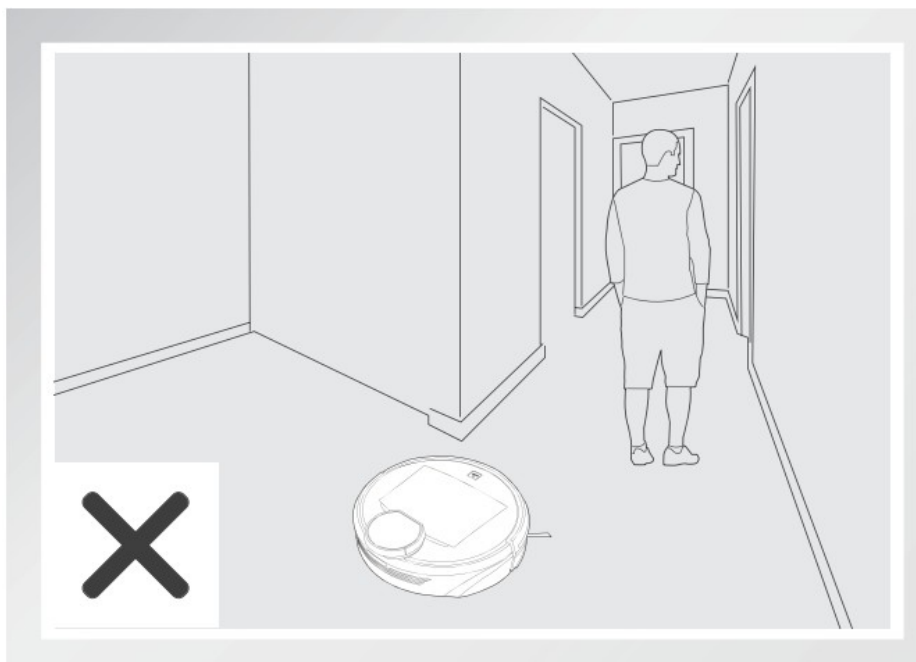

### 3.2 Quick Start

Remove the protection strip from the robot's Bumper before use.

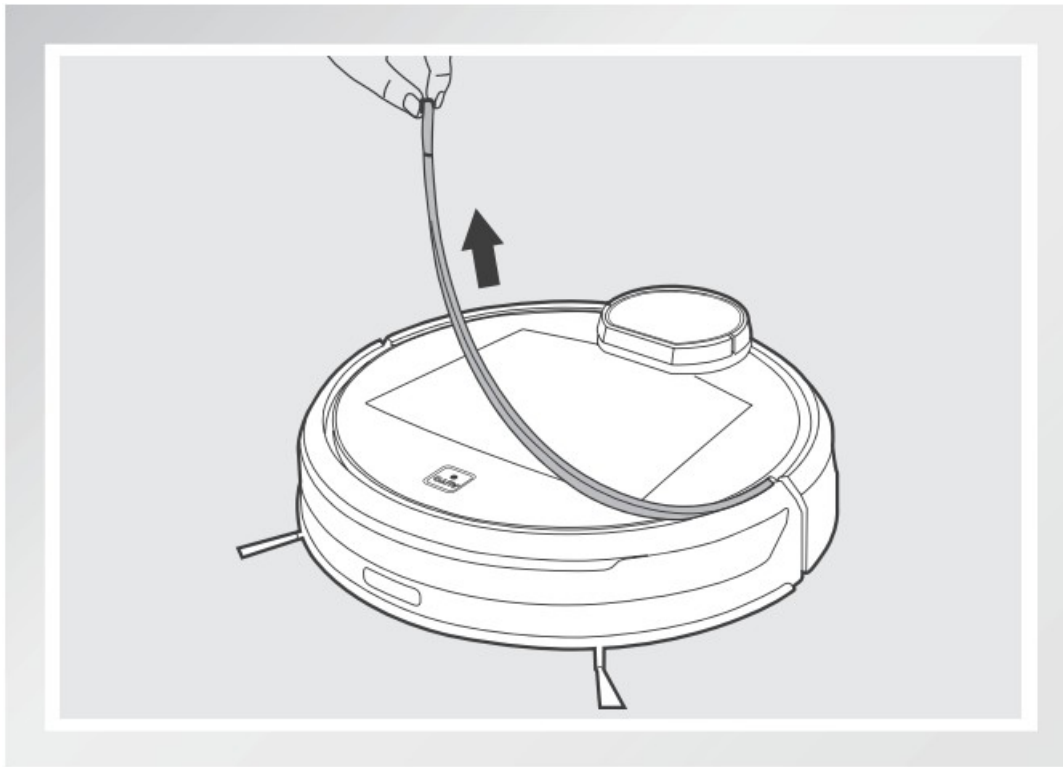

### 1. Charging Dock Placement

Place the Charging Dock on a level floor surface against the wall with the base perpendicular to the ground. Keep the immediate area 1.5m (5') in front of the charger and 0.5m (1.6') on both sides of the charger clear of objects and reflective surfaces.

Plug the Charging Dock in.

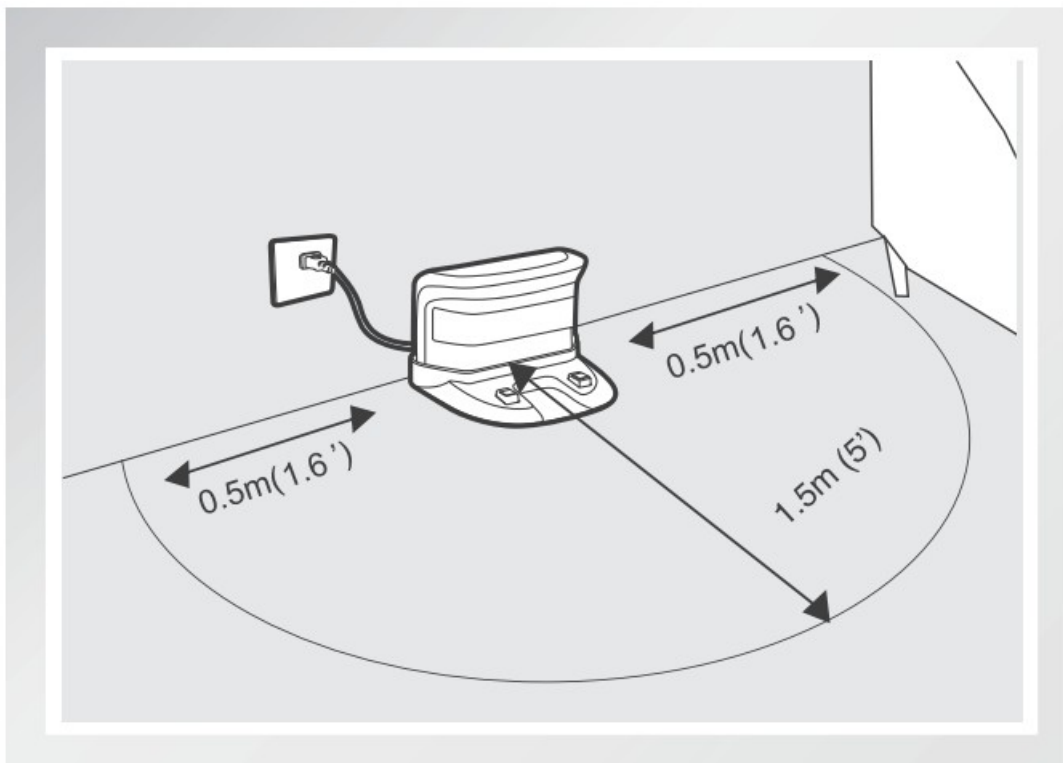

\* Do not change the location of the Charging Dock once DEEBOT has scanned the environment. If it is necessary to relocate Charging Dock, power OFF DEEBOT and then power back ON so DEEBOT can re-scan the environment.

### 2. Install Side Brushes

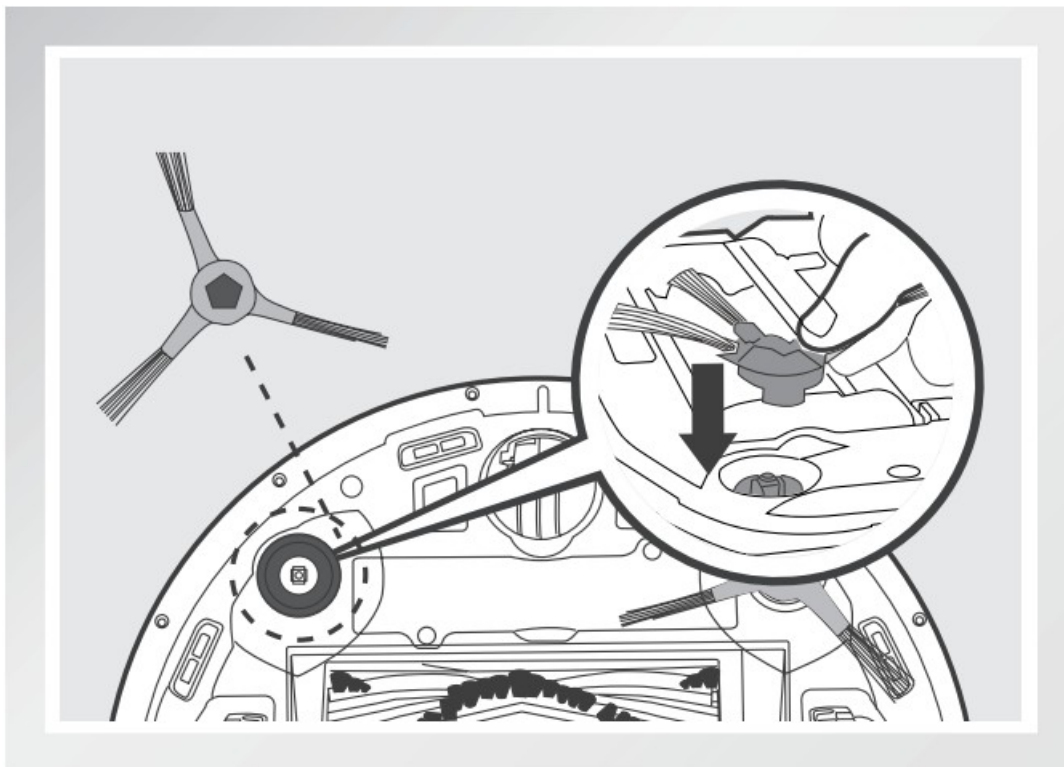

Attach Side Brushes to the bottom of DEEBOT by pressing a brush into each slot with the matching color until it clicks.

### 3. **Power ON**

» Open the Top Cover. Move the Power Switch to the “|” position. The Control Panel illuminates, DEEBOT plays a musical tune and the AUTO Mode Button flashes. DEEBOT TEN is powered ON when the AUTO Mode Button stays illuminated.

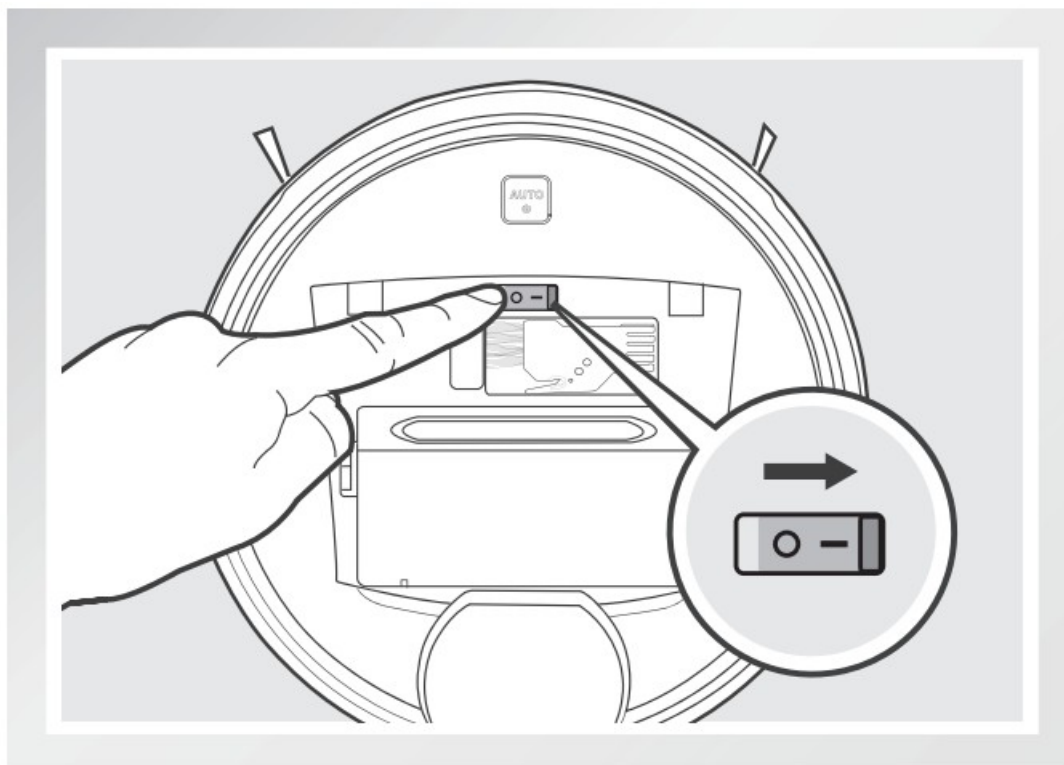

### 4. **Charge DEEBOT**

» Place DEEBOT on the Charging Dock making sure the Charging Contacts on DEEBOT and the Charging Dock Pins make



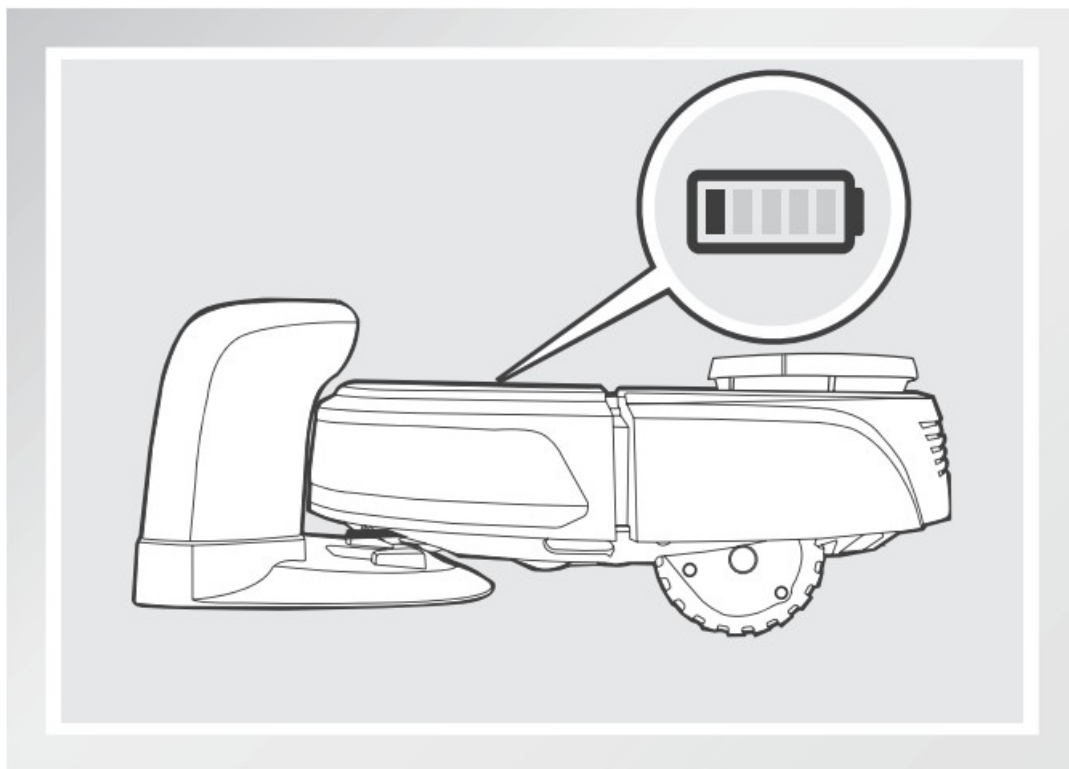

- \* Please make sure the Power Switch is turned ON before charging. ("O" indicates OFF and "I" indicates ON).
- \* Charge DEEBOT for at least 4 hours before the first use. The AUTO Mode Button flashes when charging, and goes out when DEEBOT is fully charged. Press the AUTO Mode Button on the robot or press any button on the App screen to wake up the robot.
- \* Remove the Advanced Wet/Dry Reservoir before charging DEEBOT.

#### 5. **Attach a Cleaning Cloth, if Desired**

- \* To use the robot's optional Advanced Wet/Dry Mopping System, attach the Advanced Wet/Dry Reservoir and an Advanced Wet/ Dry Cleaning Cloth before use.

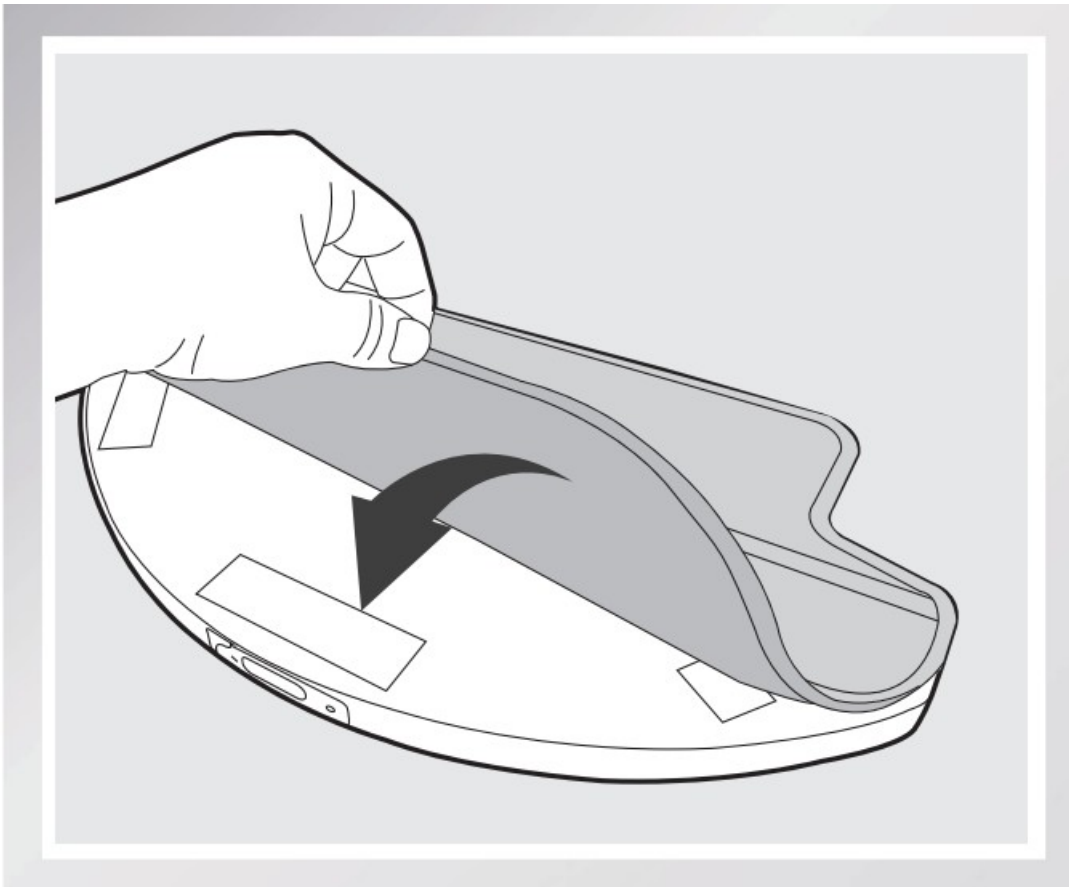

- \* When using the mopping feature, fold area rug edges under themselves so DEEBOT avoids the rug.



\* Please see section 3.7 Optional Advanced Wet/Dry Mopping System for complete instructions.

## 6. Start

» Press the AUTO Mode Button on DEEBOT.

DEEBOT moves around to scan the environment and build the map, and starts to work in AUTO Cleaning Mode at the same time.

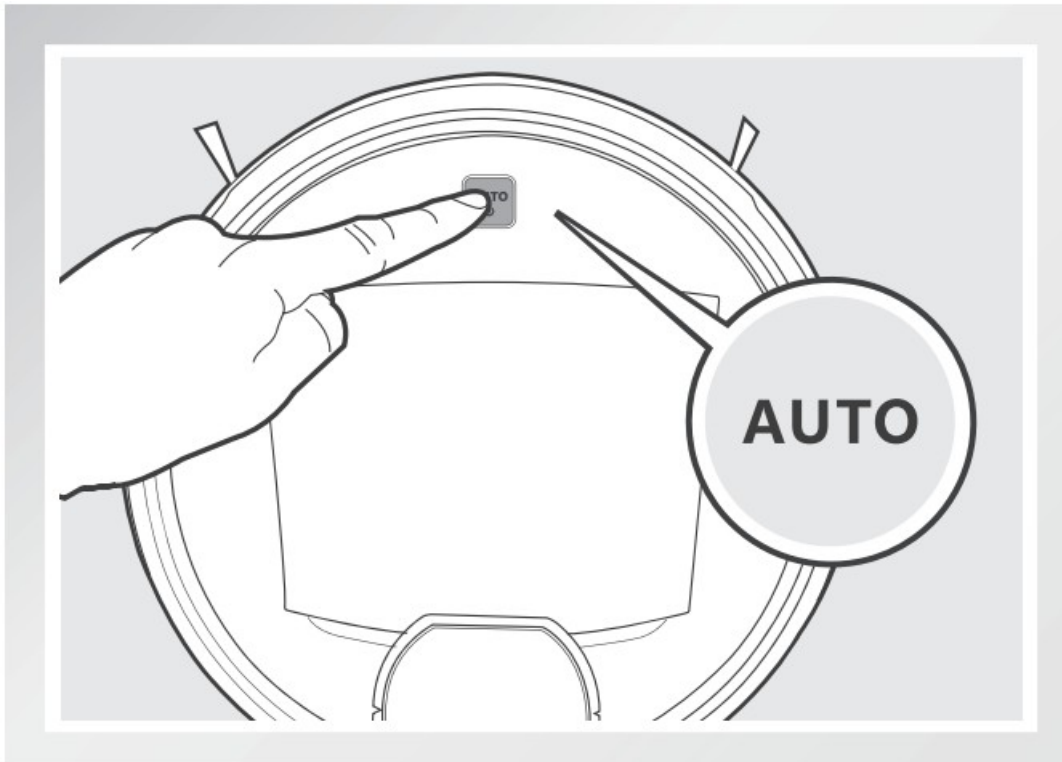

\* DEEBOT must be powered ON to clean.

\* To choose another Cleaning Mode, please refer to section 3.3 Cleaning Mode Selection for details.

\* Do not manually move the robot when it is cleaning or charging.

## 7. Pause

» Pause DEEBOT by pressing the AUTO Mode Button on the robot.

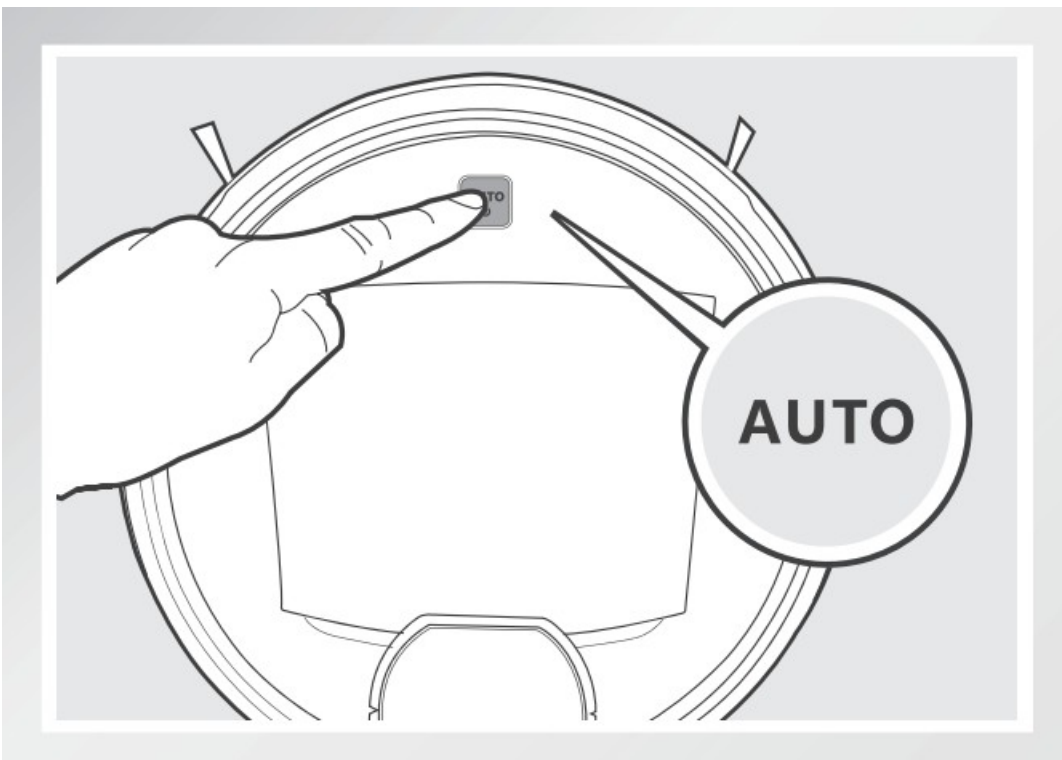

\* The AUTO Mode Button on the robot's Control Panel stops glowing if the robot pauses for more than 10

minutes. Press the AUTO Mode Button on the robot or press any button on the App screen to wake up the robot.

## 8. Power OFF

» Open the robot's Top Cover. Move the Power Switch to the "O" position to power OFF

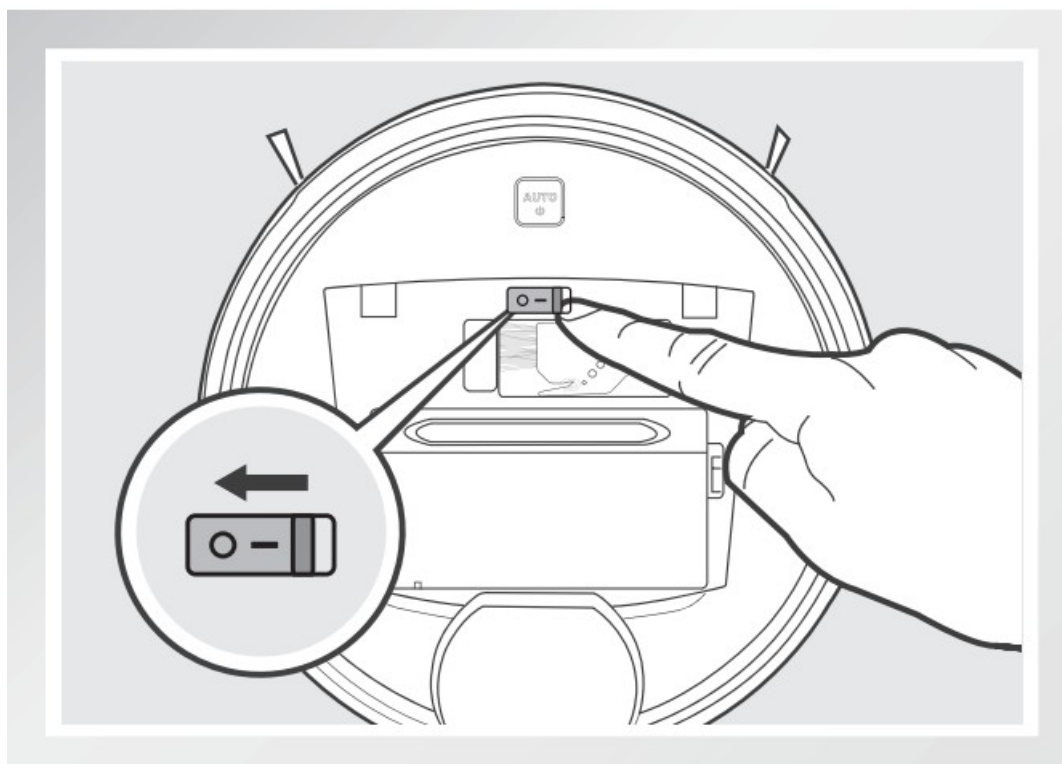

\* When DEEBOT is not working, it is suggested to keep it powered ON and charging.

\* DEEBOT loses its map once it is powered OFF. It is suggested to keep DEEBOT powered ON if it remains in the same home environment.

\* In case DEEBOT is powered OFF, to restore the map in the same home environment, power ON DEEBOT and follow the instructions on ECOVACS App.

## 3.3 Cleaning Mode Selection

DEEBOT has several Cleaning Modes to choose from to effectively clean different floors. Cleaning Modes are selected using the ECOVACS App or using the AUTO Mode Button on the robot's Control Panel.

### 1. AUTO Cleaning Mode

This is the most commonly used mode. In AUTO Cleaning Mode, DEEBOT cleans in a back and forth straight-line pattern.

» To start AUTO Cleaning Mode, press the AUTO Mode Button on the robot or  on LPN the App.

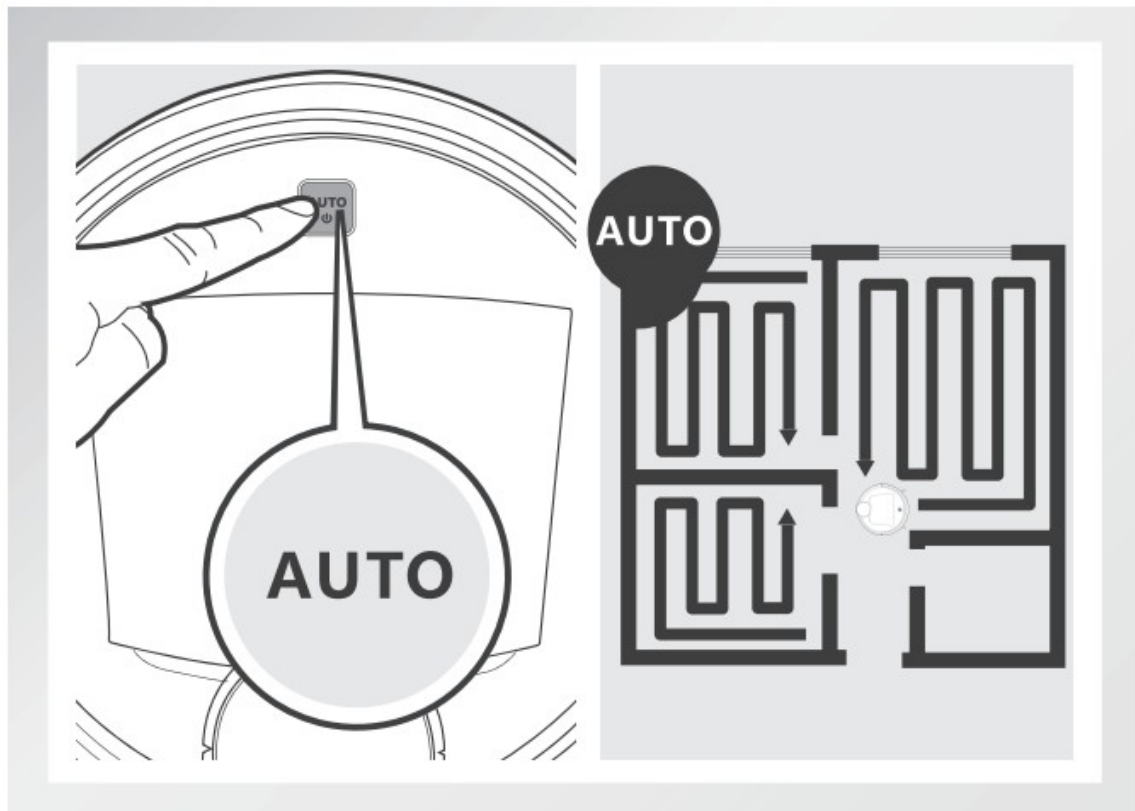

## 2. Spot Cleaning Mode

This mode is applicable for an area of highly concentrated dirt or dust. In Spot Cleaning Mode, DEEBOT focuses on a specific area to clean and returns to the Charging Dock once the Spot Cleaning is completed.

To start Spot Mode Cleaning, press  on the App's map screen. DEEBOT cleans the selected spot and a 1m/3.2' area around the spot.

## 3. Area Cleaning Mode

After DEEBOT has scanned and mapped the environment, specific areas on the map can be selected to be cleaned using Area Cleaning Mode. Area Cleaning Mode can only be selected using the App.

To set or discard cleaning areas, press  on the App's map screen.

\* DEEBOT can only recognize a room with doorway ranging from 40cm (1.3') to 160cm (5.2') and perimeter larger than 8m (26.2').

## 4. Return to Charger Mode

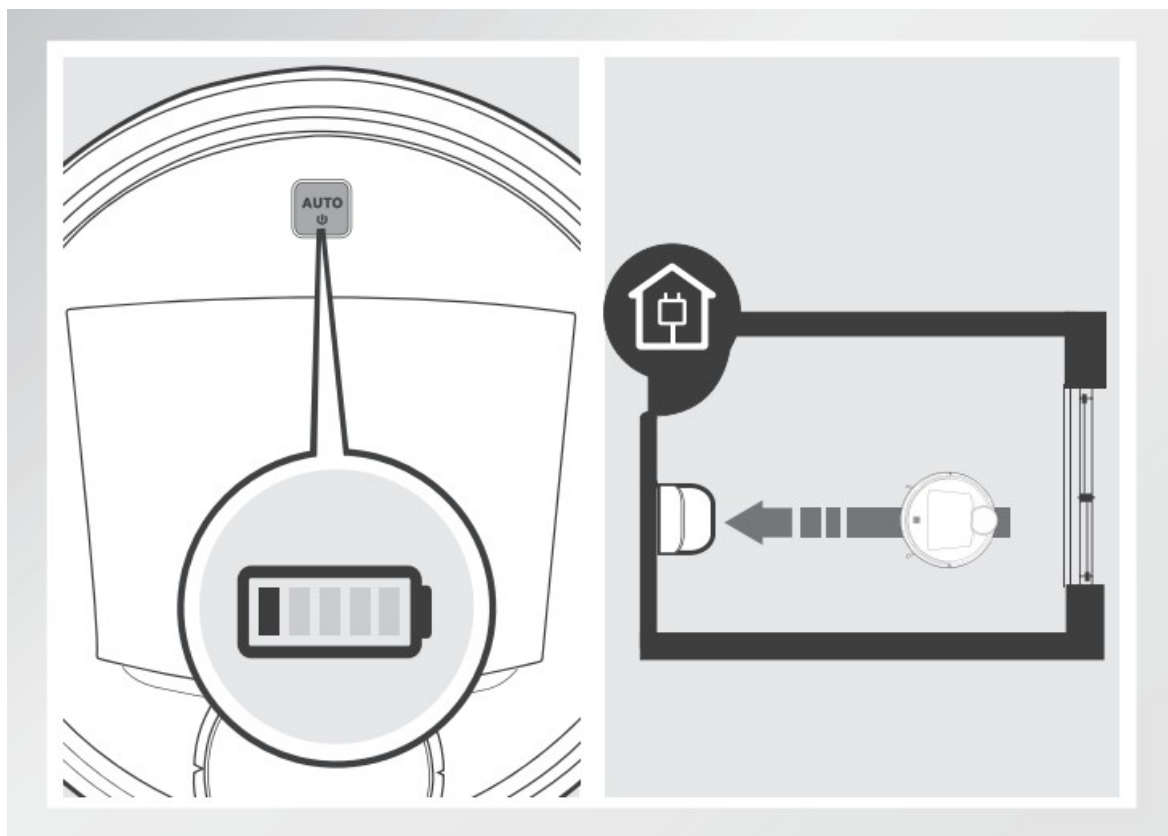

- » When battery power gets low, DEEBOT Poe automatically switches to Return to Charger a Mode and returns to the Charging Dock to ay recharge itself.
- » DEEBOT can also be sent back to the Charging Dock at any time by pressing the Return to Charger Mode Button on the main screen of the ECOVACS App.
- \* After pressing the Return to Charger Mode Button on the App's main screen, DEEBOT will continue cleaning until it gets close to the Charging Dock. Once it is near the Charging Dock, DEEBOT reduces power and gently dock itself to recharge.

### 3.4 Programming the Robot

DEEGOT has an Intelligent Scheduling function and a Time Scheduling function to schedule cleaning times. DEEGOT can be programmed to automatically clean once per day at the same time with Intelligent Scheduling using the robot's Control Panel. OEEBOT can also be programmed weekly to clean once per day at specific times with Time Scheduling using the App. All scheduled cleanings are performed in AUTO Cleaning Mode or Area Cleaning Mode whichever is selected when scheduling the cleanings.

#### Schedule the Cleaning Time

##### 1. Schedule the Cleaning Time Using Intelligent Scheduling

DEEBOT can be scheduled to clean once per day at the same time, even if nobody is at home. Press the AUTO Mode Button on the robot twice to set the current time as the scheduled cleaning time. Intelligent Scheduling is set successfully when the robot generates a voice report. DEEBOT automatically cleans at the scheduled cleaning time every day.

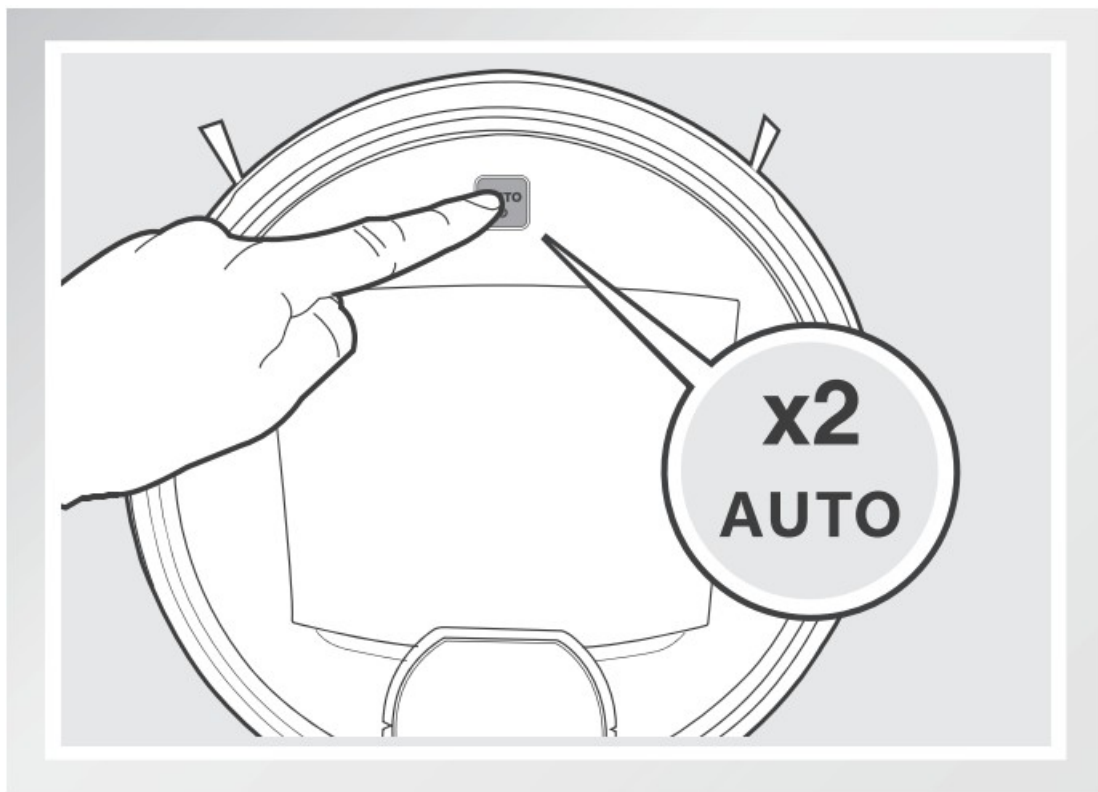

## 2. Cancel the Cleaning Time Using Intelligent Scheduling

Press the AUTO Mode Button on the robot twice. Intelligent Scheduling is cancelled when the robot generates a voice report.

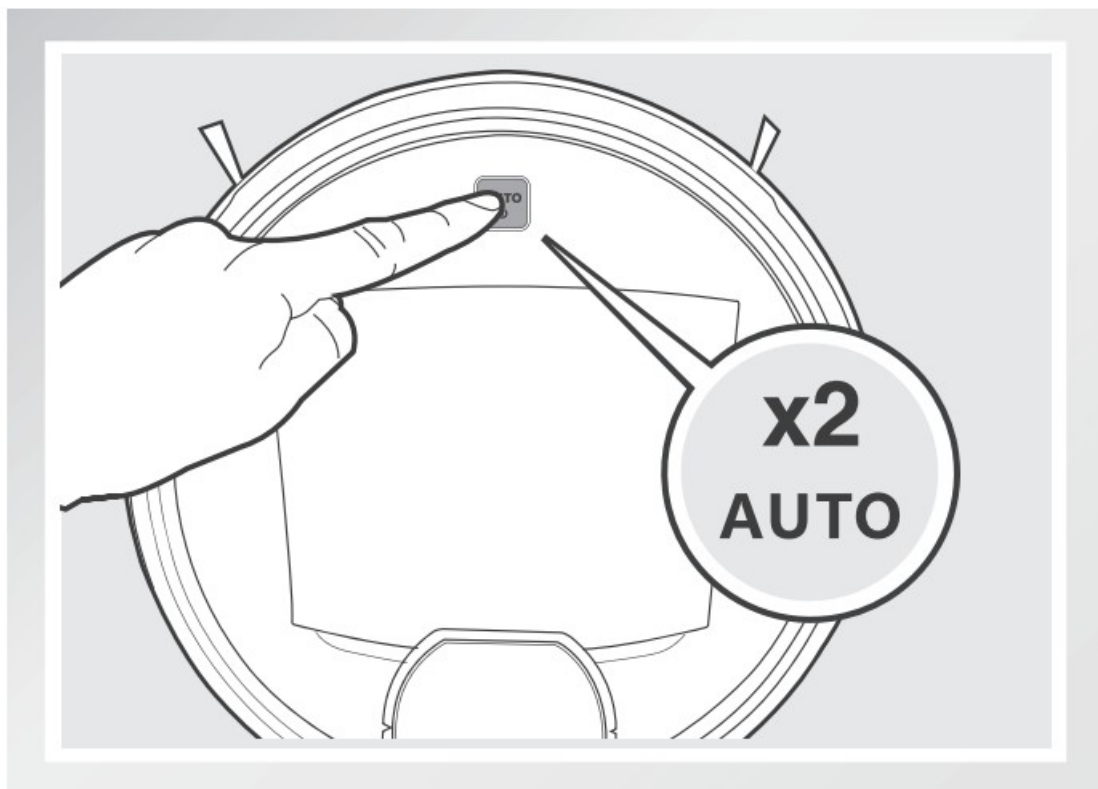

## 3. Schedule the Cleaning Time Using Time Scheduling

DEEBOT can be programmed weekly to clean once per day at specific times using the ECOVACS App.

Open the ECOVACS App. Press “...” in top right corner on the App’s main screen. Set new scheduled cleanings and cancel existing scheduled cleanings in “Time Scheduling.”

### 3.5 Additional Settings

#### Virtual Boundary

A Virtual Boundary blocks DEEBOT from cleaning a specified area.

To set a Virtual Boundary, press  on the App's map screen.

\* DEEBOT can be manually directed to blocked areas using  in the App.

\* DEEBOT still returns to the Charging Dock if it is placed in the blocked area.

### **Continued Cleaning Function with Do Not Disturb Option**

When Continued Cleaning function is turned on, once DEEBOT is fully recharged, it automatically returns to and continues to clean the uncleaned area not completed during the last cleaning task.

User can set a Do Not Disturb time to forbid DEEBOT from coming out to continue cleaning during the set time.

For more settings, press "... " in top right corner on the App's main screen. Check cleaning record, set Continued Cleaning function, schedule cleaning time, reset the map, set voice reporting language and update firmware are located in this area.

### **3.6 Choosing a Suction Option**

The robot has 2 interchangeable suction options for your convenience.

**Main Brush Option:** The best choice for deep cleaning with a combination of the Main Brush and strong suction. The Main Brush Option comes pre-installed in DEEBOT.

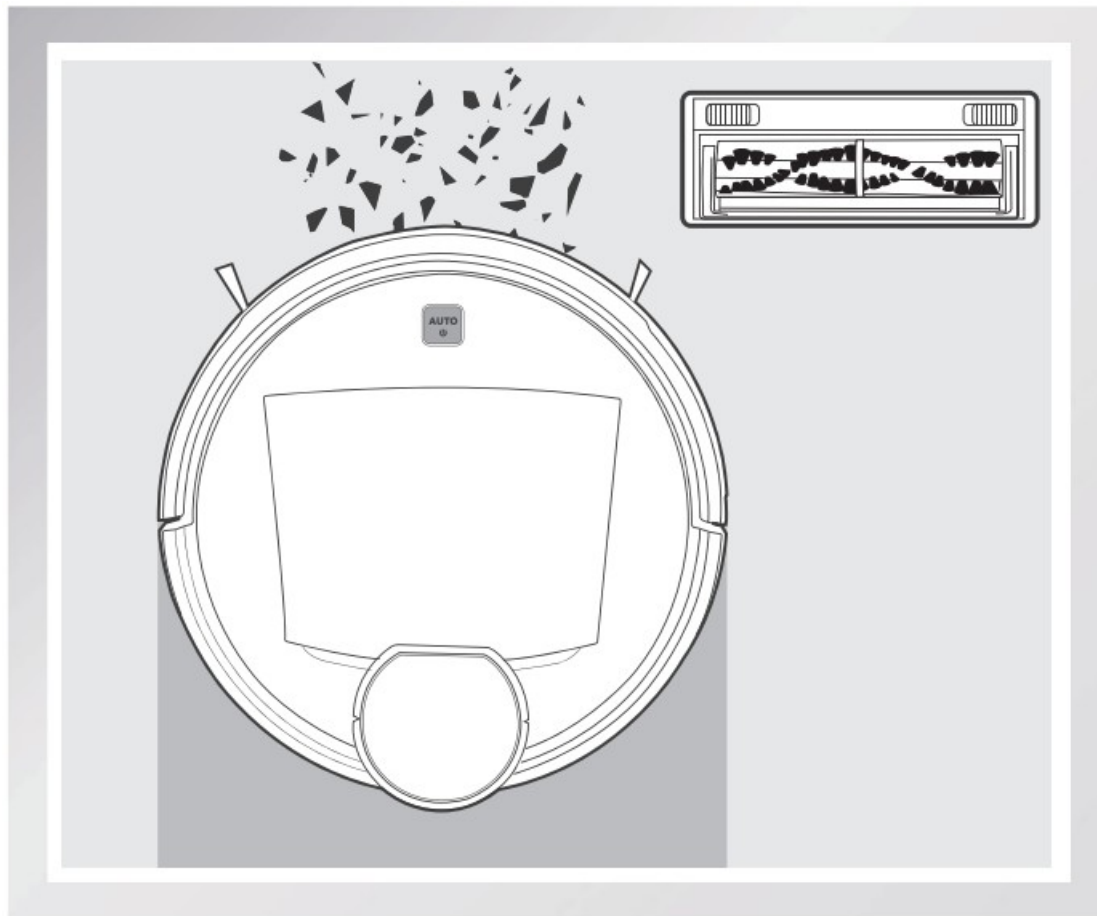

**Direct Suction Option:** The best choice for daily cleaning with the Main Brush removed for direct suction. This Suction Option is specifically designed to pick up hair without tangling.

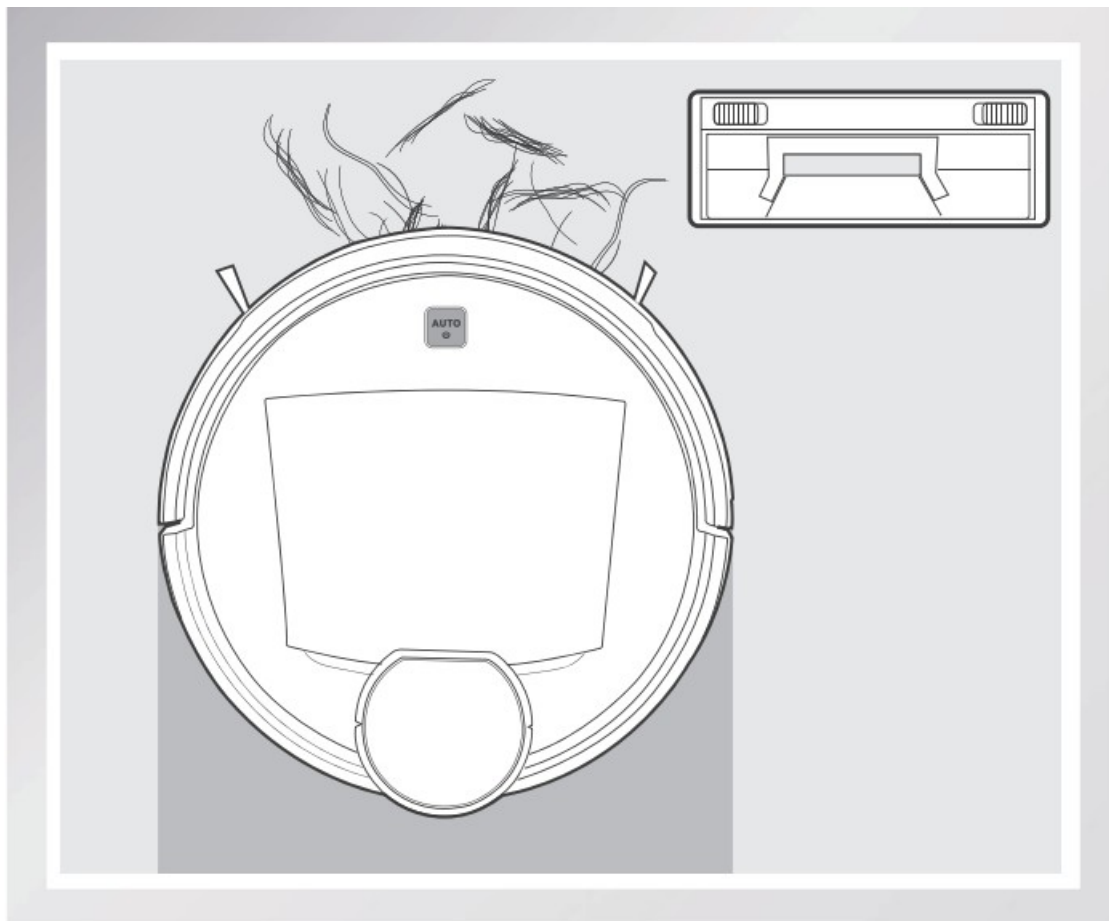

### Install the Direct Suction Option

Turn the robot over. Push both buttons on the Main Brush Option and remove the Main Brush Cover.

Remove the Main Brush.

Line up the Direct Suction Option tabs with the slots on the bottom of the robot. Press until the component clicks into place.

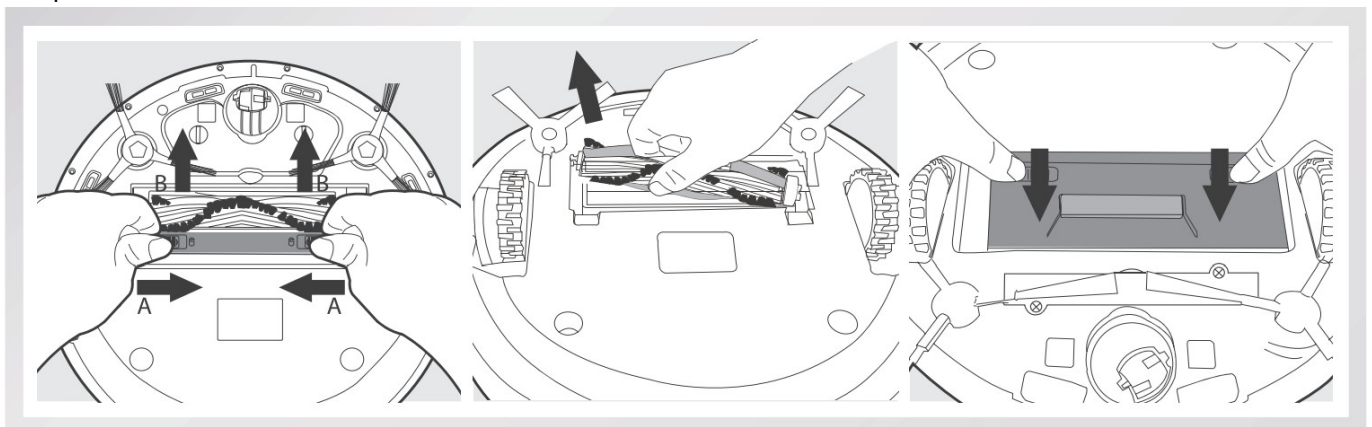

### Install the Main Brush Option

Turn the robot over. Push both buttons on the Direct Suction Option and remove Direct Suction Option.

Insert the Main Brush into the bottom of the robot.

Line up the Main Brush Cover tabs with the slots on the bottom of the robot. Press until the component clicks into place.



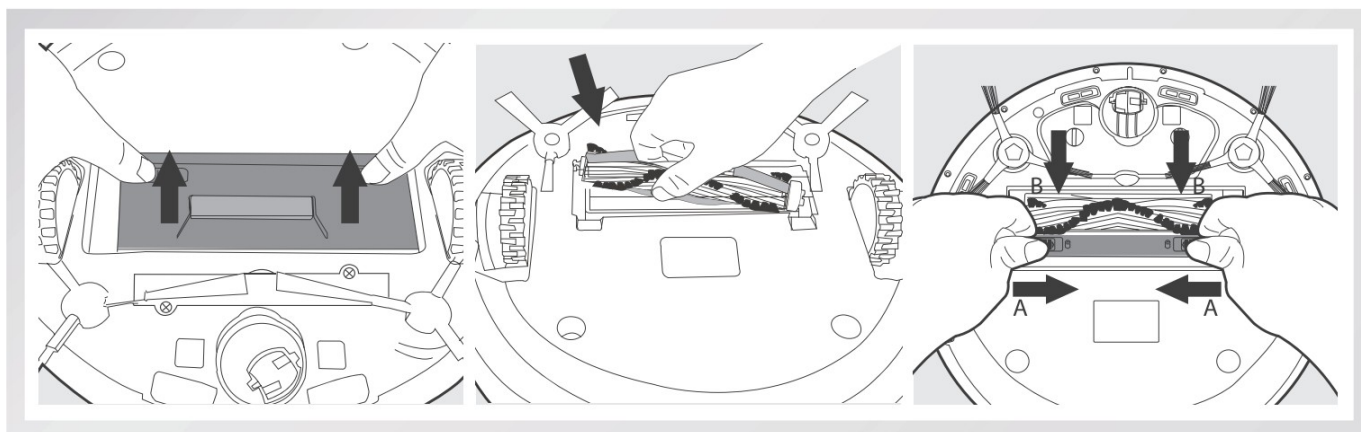

### 3.7 Optional Advanced Wet/Dry Mopping System

DEEBOT has an optional mopping system that uses an Advanced Wet/Dry Cleaning Cloth attached to the Advanced Wet/Dry Reservoir. The Advanced Wet/Dry Cleaning Cloth automatically damp mops and then dries the floor to a spotless clean.

- \* Do not use the mopping system on carpet.
- \* When using the mopping system, fold area rug edges under themselves so DEEBOT will avoid the rug.
- \* When using the mopping system, do not stop the robot and allow it to stand still. This prevents the Advanced Wet/Dry Reservoir from leaving water on the floor.
- \* Remove the Advanced Wet/Dry Reservoir before charging DEEBOT.

#### 1. Attach Advanced Wet/Dry Cleaning

Attach the Advanced Wet/Dry Cleaning Cloth to the Advanced Wet/Dry Reservoir.

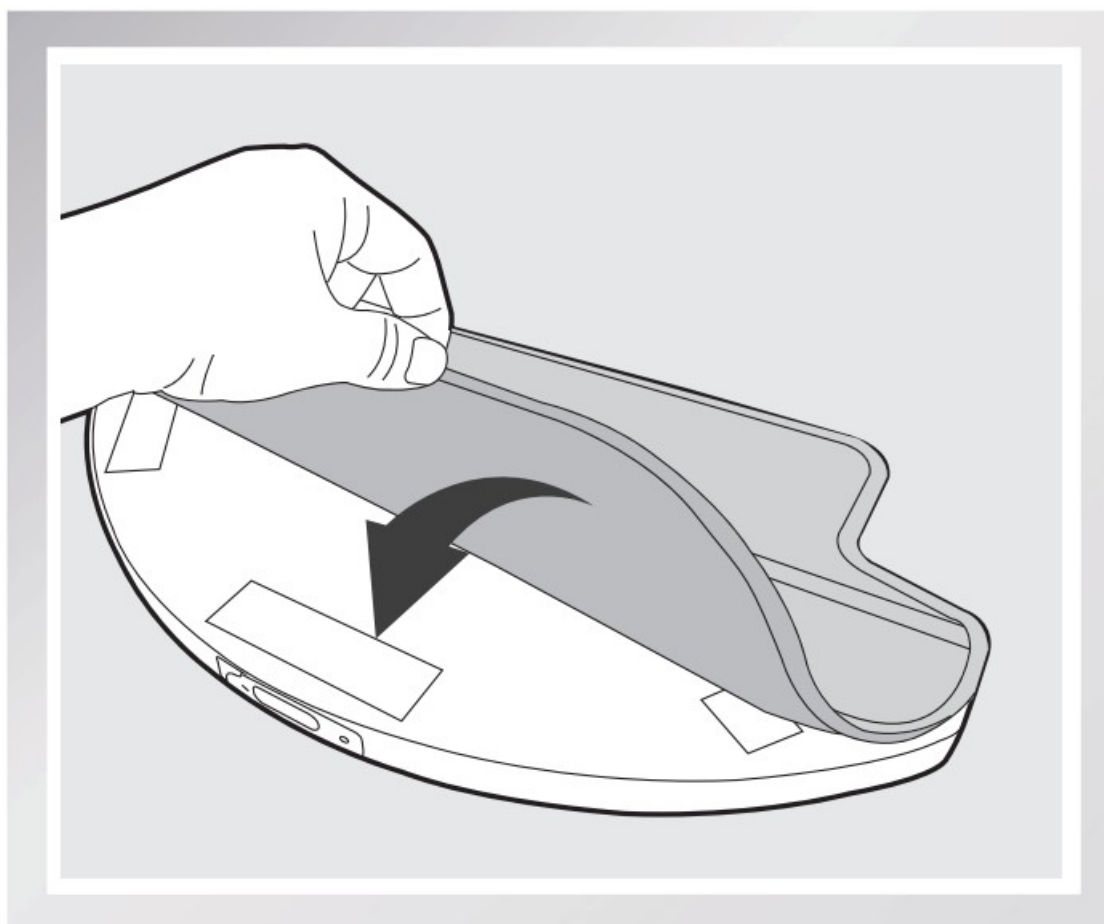

#### 2. Add Water to the Advanced Wet/Dry Reservoir

- \* Before adding water to the Advanced Wet/Dry Reservoir, remove the Advanced Wet/Dry Reservoir from the bottom of the robot.

Fill the provided Measuring Cup with water. Open the lid of the Water Inlet on the Advanced Wet/Dry Reservoir and slowly pour water from the Measuring Cup into the Reservoir. Close the Water Inlet lid.



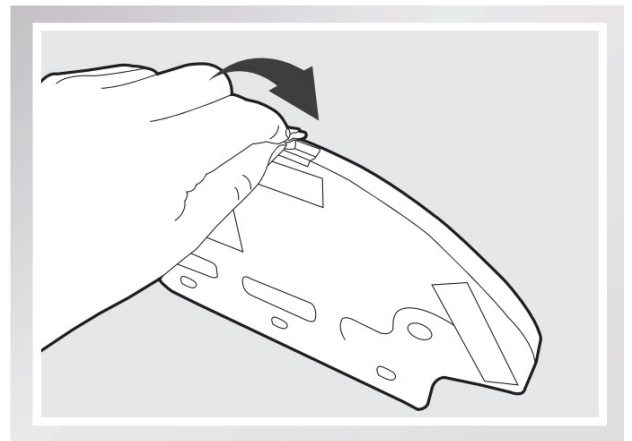
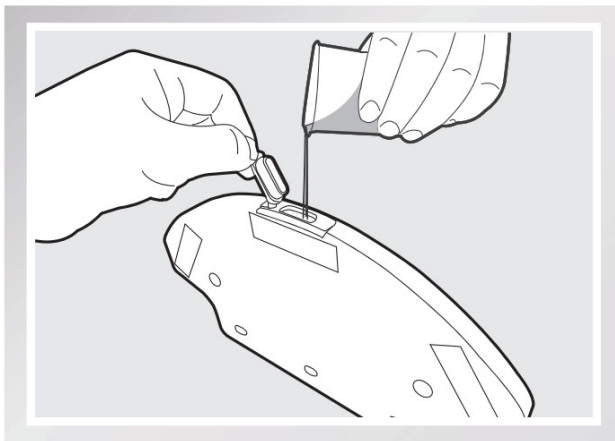

Attach the Advanced Wet/Dry Reservoir to the bottom of the robot. Insert the tabs on the Advanced Wet/Dry Reservoir into the Advanced Wet/Dry Reservoir Slots on the bottom of the robot until you hear a click.

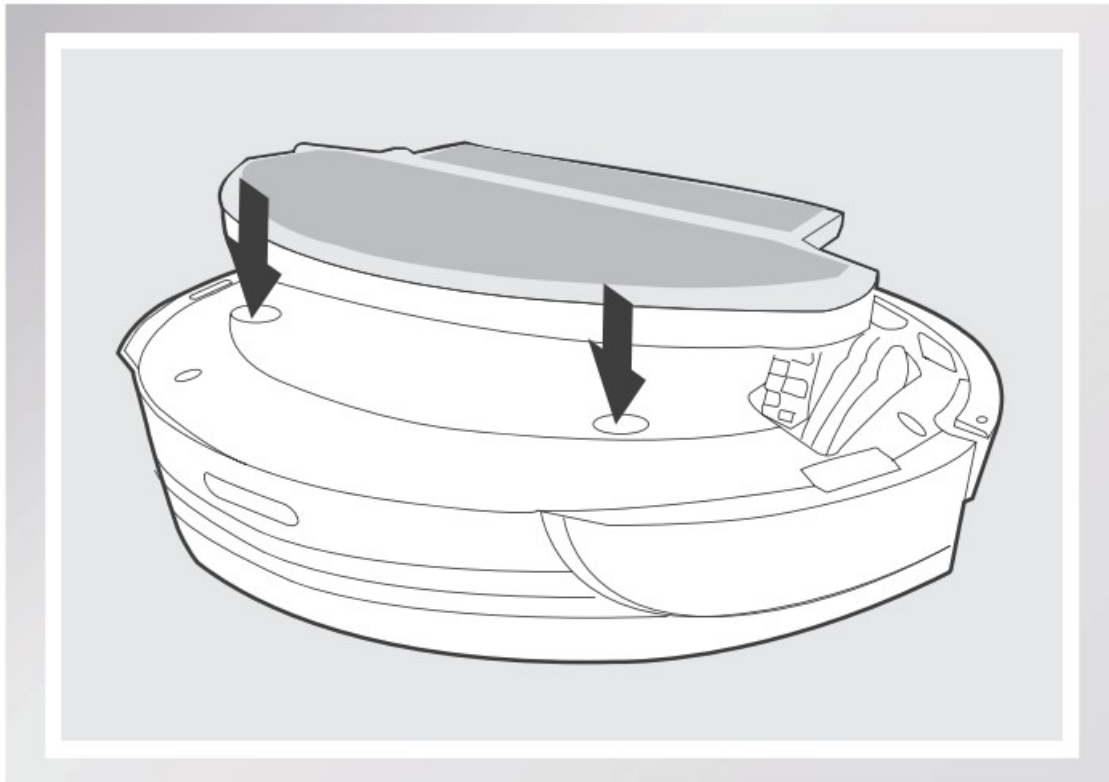

### **Start**

Select the desired Cleaning Mode. DEEBOT sweeps, lifts, vacuums, mops and dries in the selected mode.

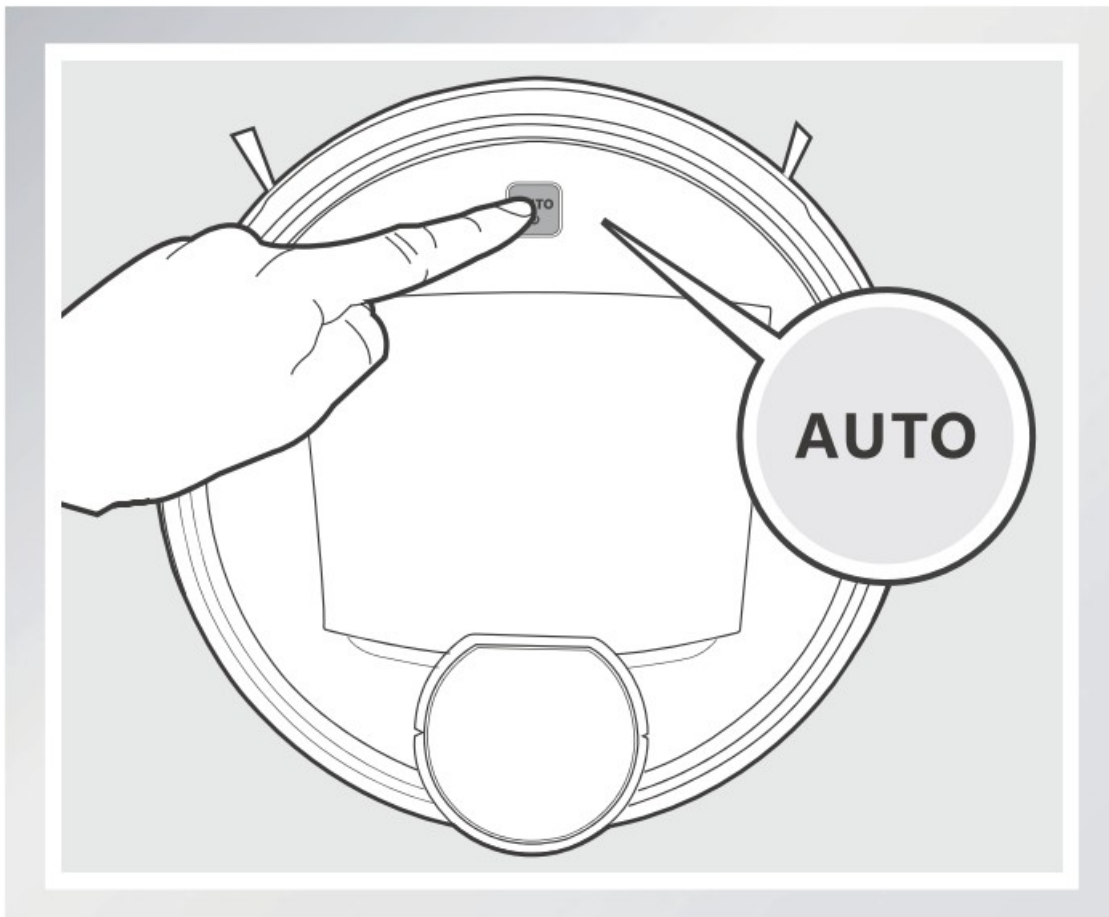

### Remove

After DEEBOT finishes cleaning, remove the Advanced Wet/Dry Reservoir from DEEBOT, empty any remaining water, and remove the Advanced Wet/Dry Cleaning Cloth.

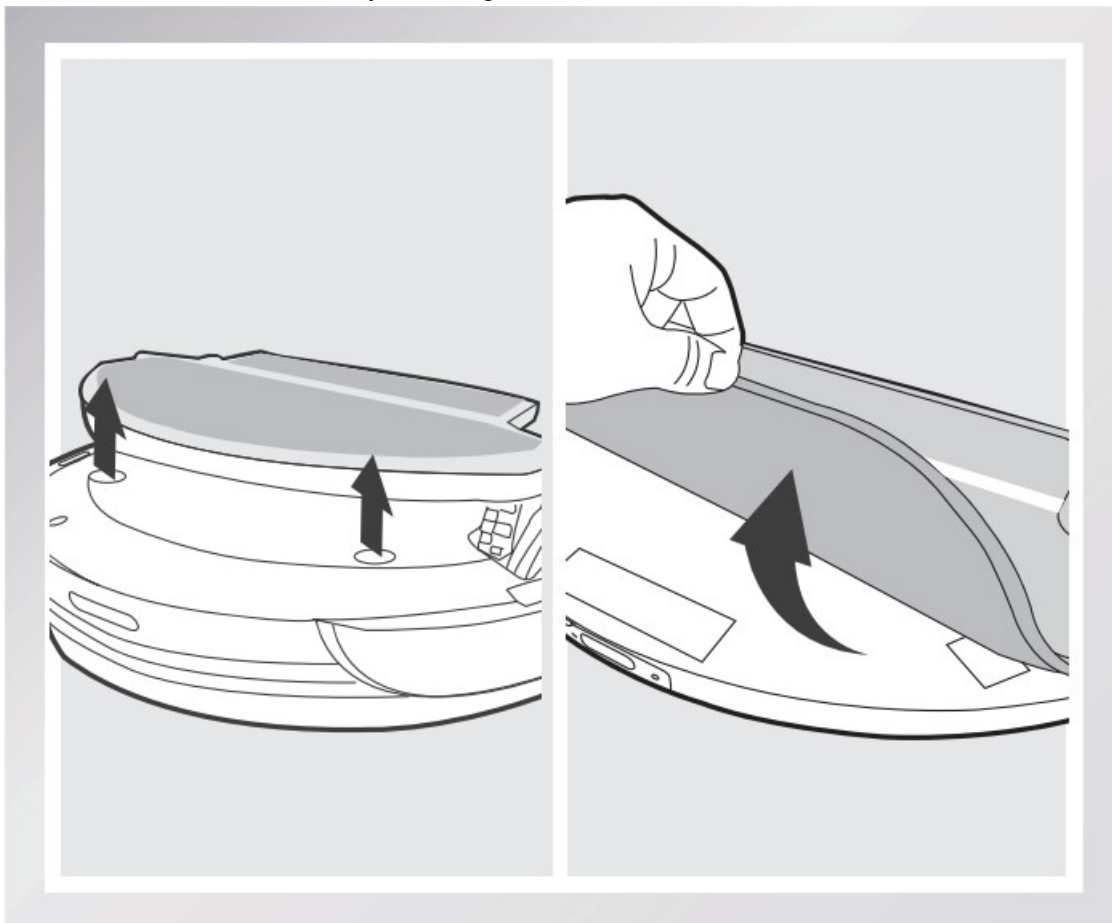

### 3.8 Voice Reporting

No.	Voice Report	Situation or Solution
1	My Cleaning time is scheduled.	Scheduled cleaning time is set.
2	My Cleaning time is cancelled.	Scheduled cleaning time is cancelled.
3	My Driving Wheel is suspended.	Place the robot on an even surface so it can regain traction.
4	My Driving Wheel is blocked.	Driving Wheel is blocked by an incline or doorsill. Move the robot by hand.
5	I am stuck.	DEEBOT is trapped by obstacles on the floor. Move the robot by hand and/or remove the obstacles.
6	My dust bin is missing.	The Dust Bin is missing or is not installed properly. Install or reinstall the Dust Bin and ensure it is properly seated.
7	My Brush is tangled.	Check the Main Brush and/or Side Brushes for debris or tangled hair and clean as described in section 4.
8	My Battery is low.	DEEBOT cannot find the Charging Dock. Place DEEBOT on the Charging Dock by hand.
9	My navigation system failed.	LDS has a problem. Please contact Customer Service.
10	I am connected to the Wi-Fi network.	DEEBOT is connected to the Wi-Fi network.
11	Time is synchronized.	DEEBOT time is successfully synchronized with the time on your smartphone.
12	Wi-Fi connection failed.	DEEBOT failed to connect to the Wi-Fi network.
13	Cleaning is complete.	DEEBOT has completed the cleaning cycle.
14	I am scanning. Please Wait.	DEEBOT is scanning the environment. Please wait.
15	My Map is Loading. Please Wait.	DEEBOT is analyzing and generating the map. Please wait.
16	Mapping is complete.	DEEBOT has generated the map.

## Maintenance

\* Before performing cleaning and maintenance on DEEBOT, power OFF the robot and unplug the Charging Dock.

### 4.1 Dust Bin and Filters

Open the robot's Top Cover and remove the Dust Bin. Open the Dust Bin Lock and empty the Dust Bin.

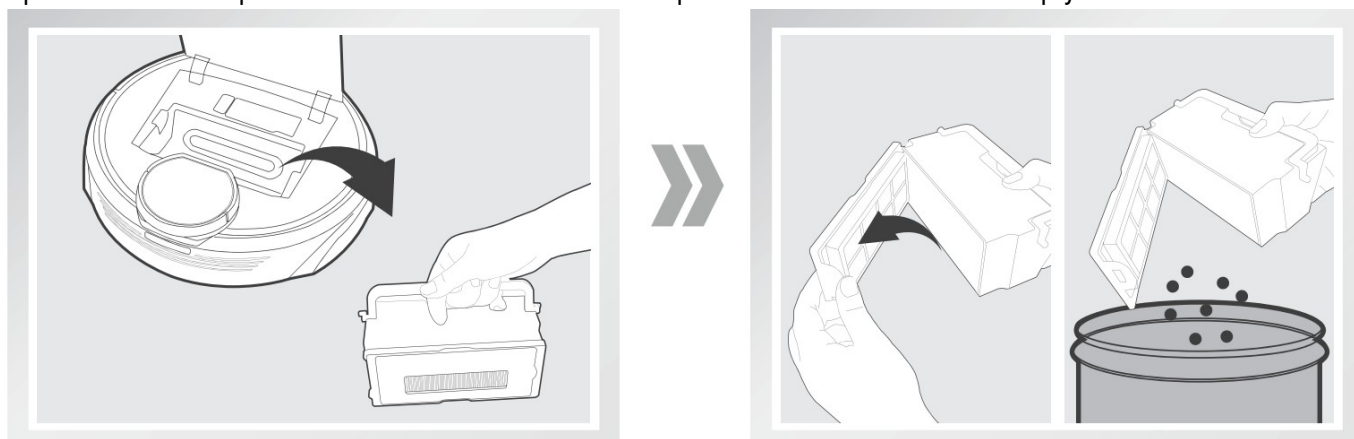

Remove the filters. Pat the High Efficiency Filter clean. Do not rinse the High Efficiency Filter under water.

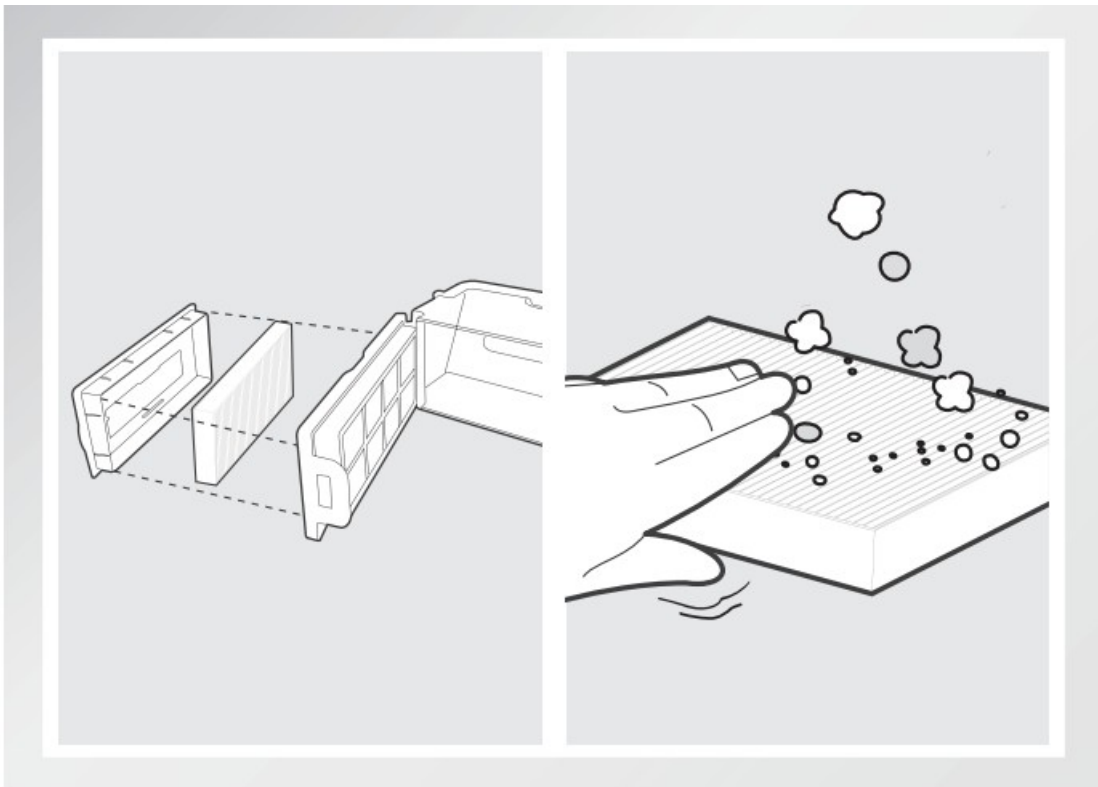

Rinse the Dust Bin and Filter Net under running water.

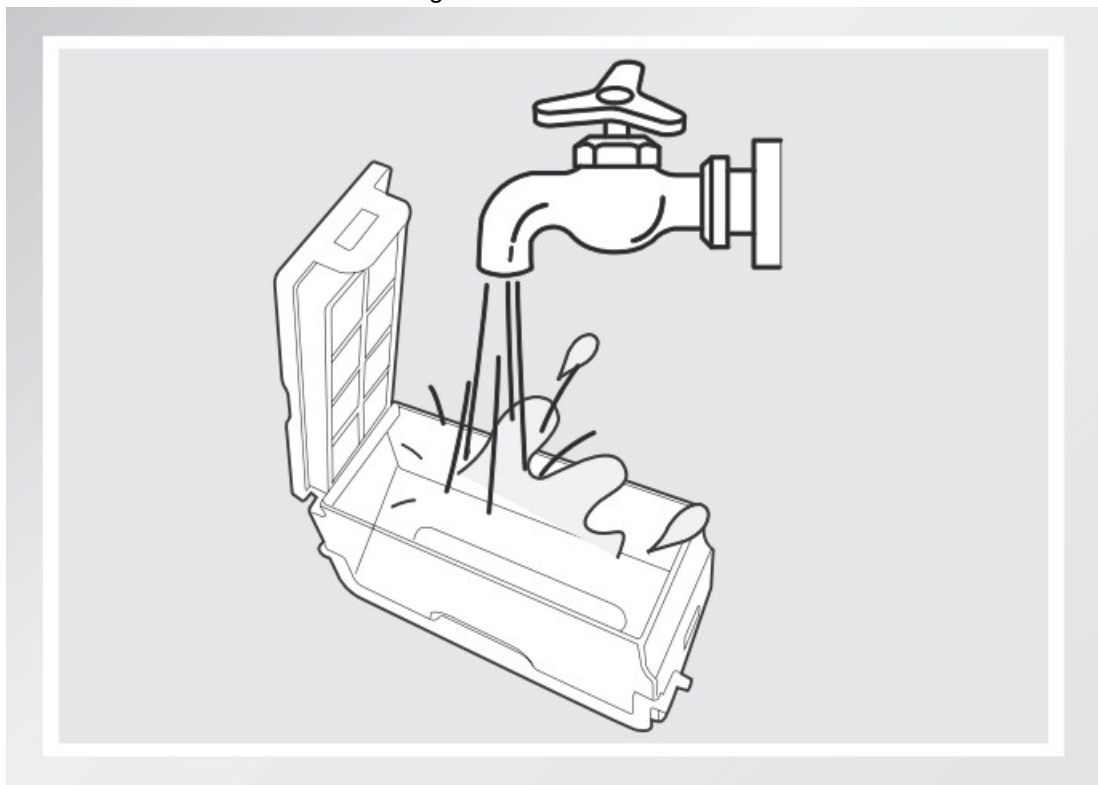

Dry the Dust Bin and Filter Net completely before reinstalling.

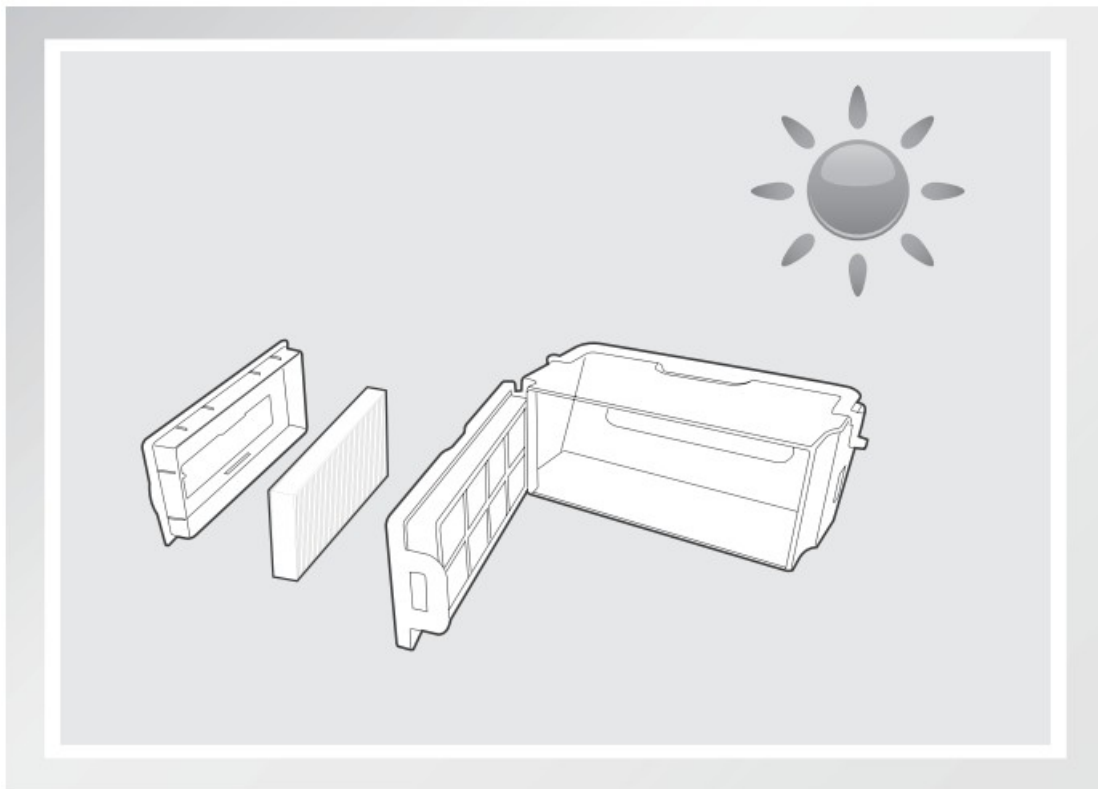

#### **4.2 Advanced Wet/Dry Cleaning Cloth and Advanced Wet/Dry Reservoir**

##### **Advanced Wet/Dry Cleaning Cloth**

If the mopping system was used, remove the Advanced Wet/Dry Reservoir from the bottom of DEEBOT and remove the Advanced Wet/Dry Cleaning Cloth.

Empty any remaining water from the Advanced Wet/Dry Reservoir.

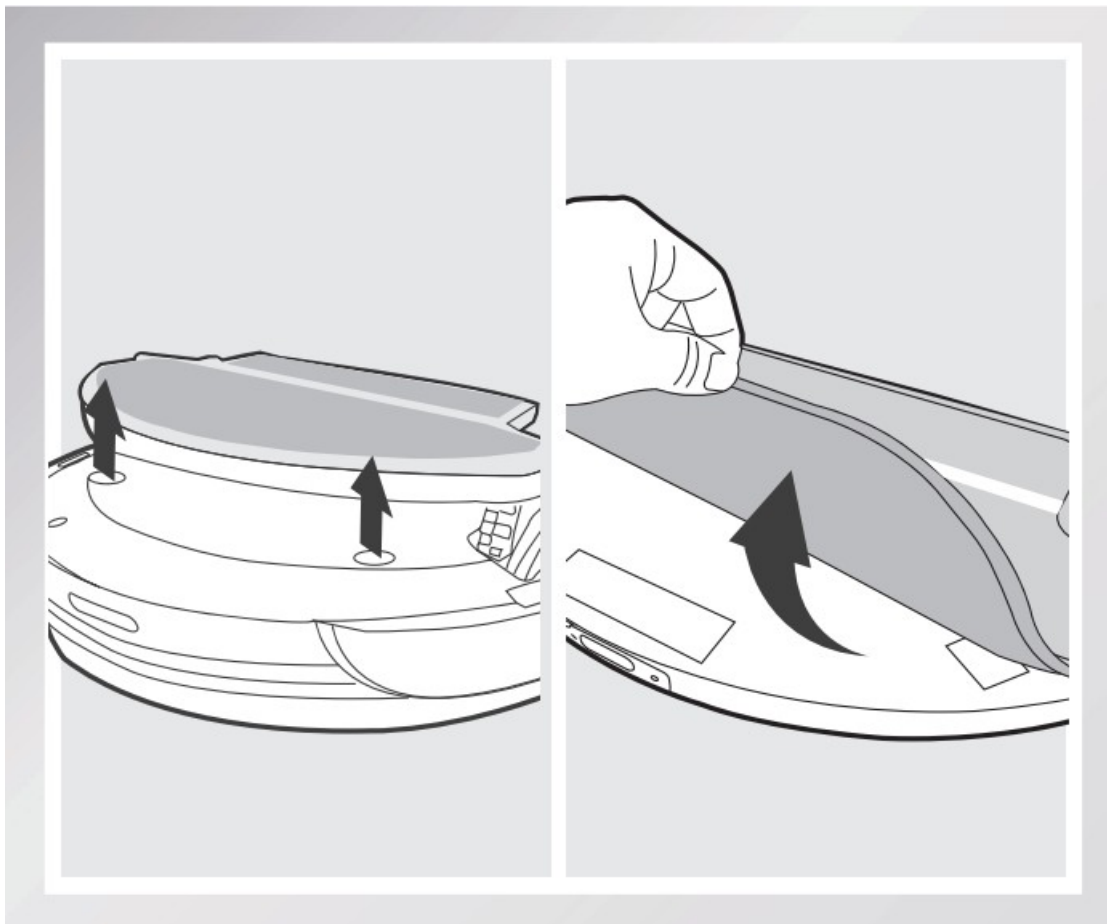

Wash the Advanced Wet/Dry Cleaning Cloth by hand or in the washing machine, and lay flat to dry.

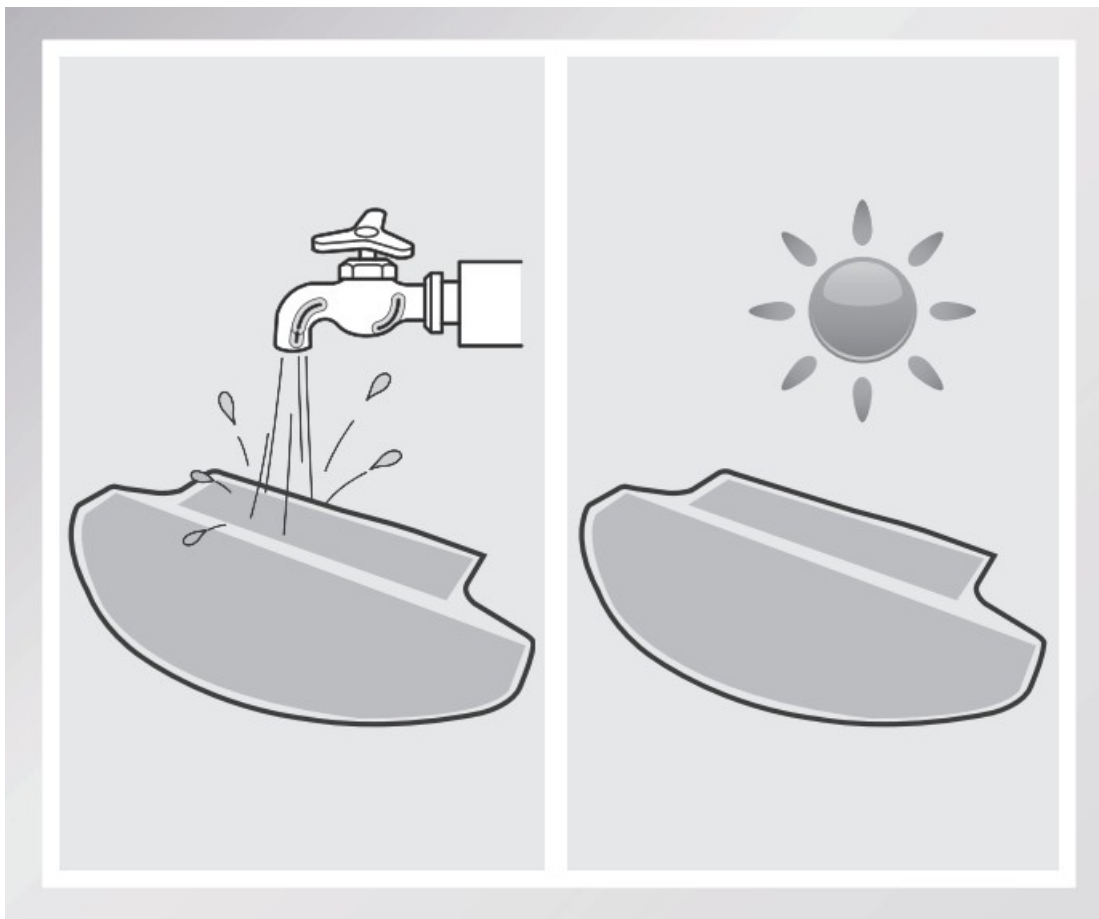

#### **Advanced Wet/Dry Reservoir**

If the mopping system was used, remove the Advanced Wet/Dry Reservoir from the bottom of DEEBOT. Empty any remaining water from the Advanced Wet/Dry Reservoir and set out to dry.

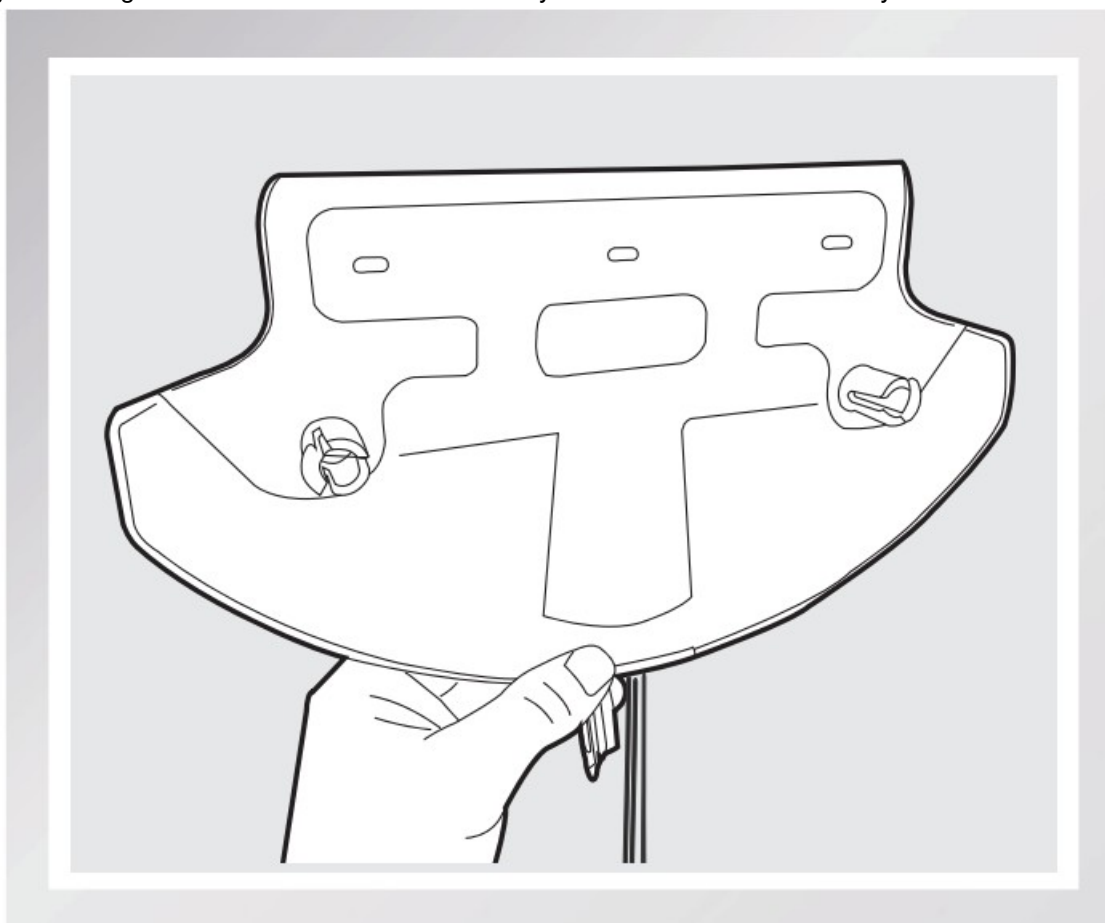

Wipe the outside of the Advanced Wet/Dry Reservoir with a dry cloth.

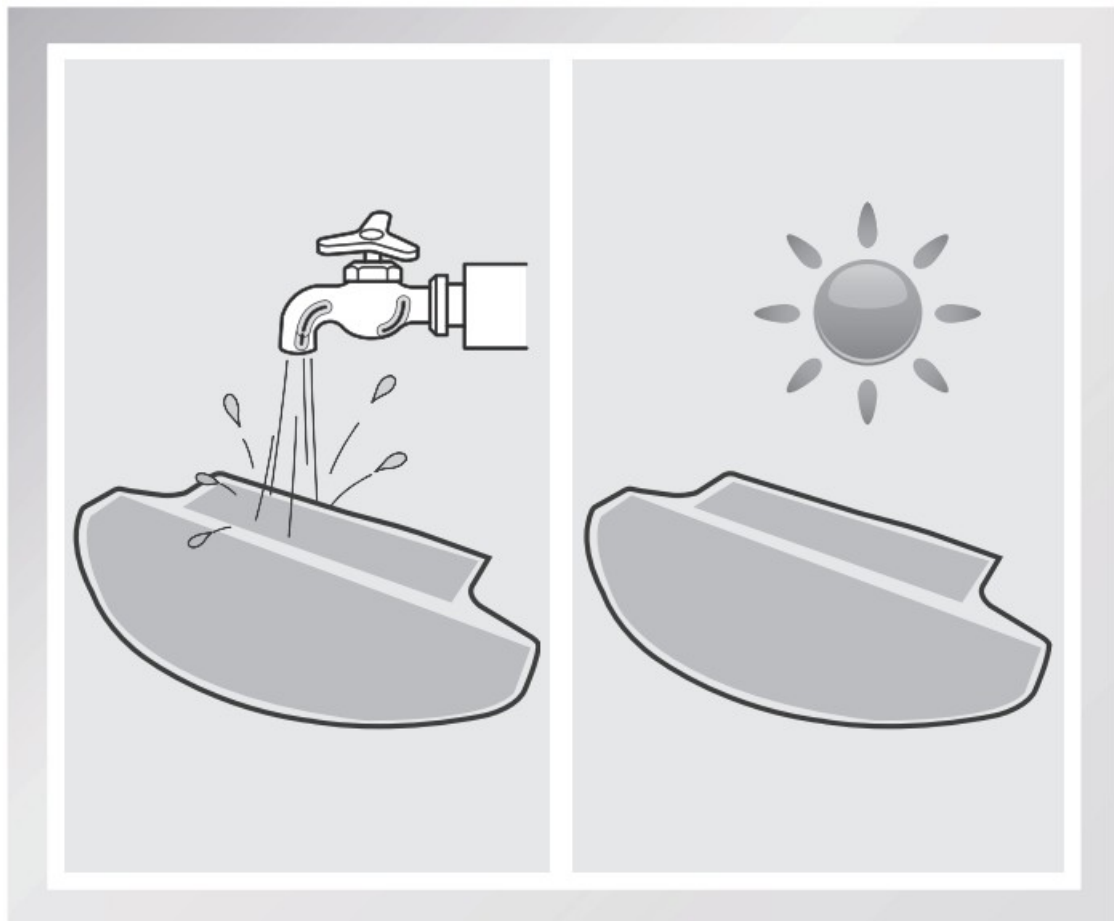

#### 4.3 Main Brush, Direct Suction Option and Side Brushes

A Multi-Function Cleaning Tool is provided for easy maintenance. Handle with care, this cleaning tool has sharp edges.

##### Cleaning the Main Brush

Turn the robot over. Push both buttons under the Main Brush towards the center of the robot.

Remove the main brush cover.

Remove the Main Brush.

Use the Multi-Function Cleaning Tool to cut off and remove any hair tangled around the Main Brush.

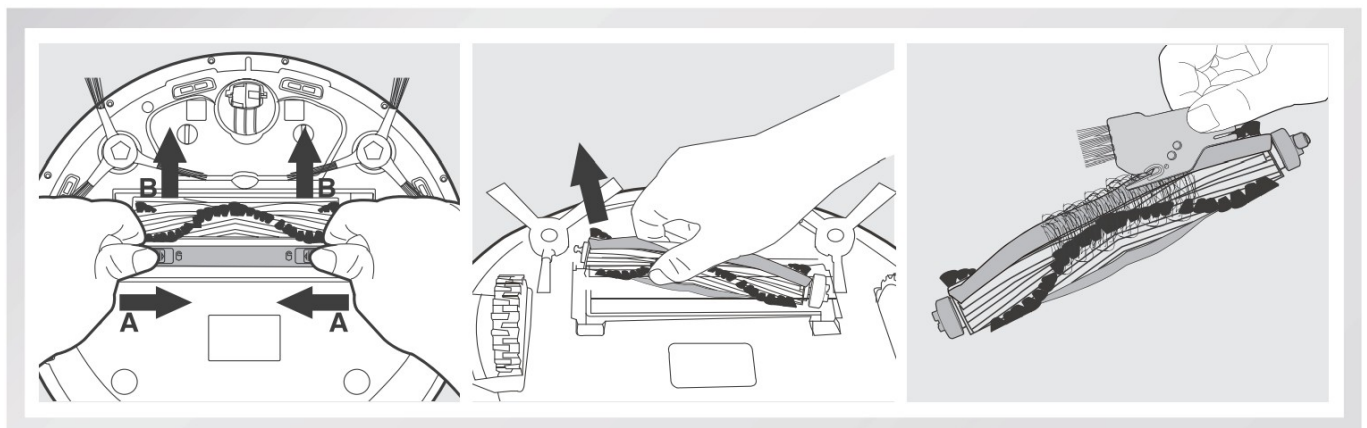

Pull out the plastic nut on the end of the Main Brush. Remove the plastic caps on both ends. Clean any tangled hair or debris from both ends of the Main Brush and inside the plastic caps.



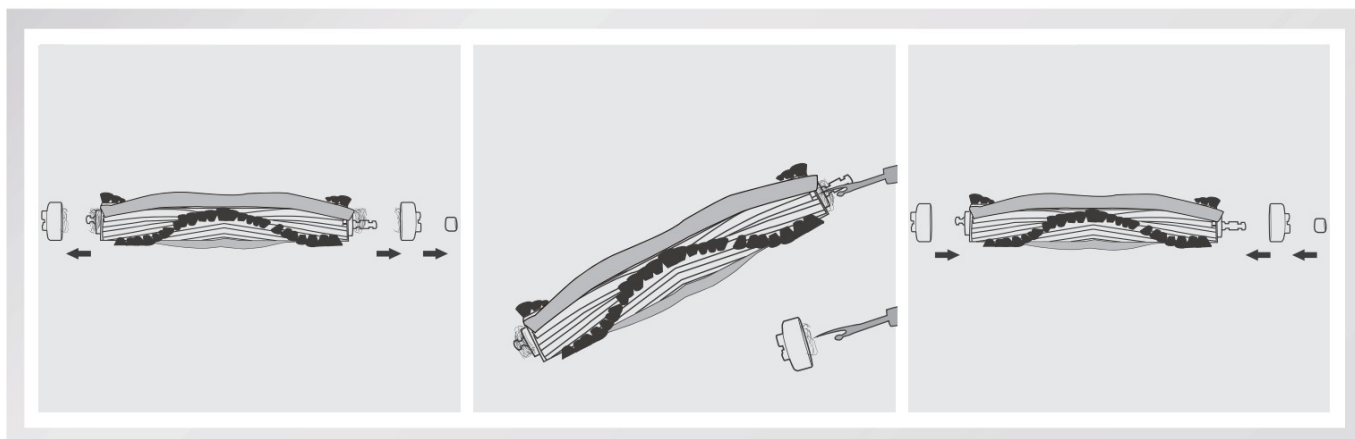

### **Cleaning the Direct Suction Option**

Wipe the Direct Suction Option clean with a dry doth.

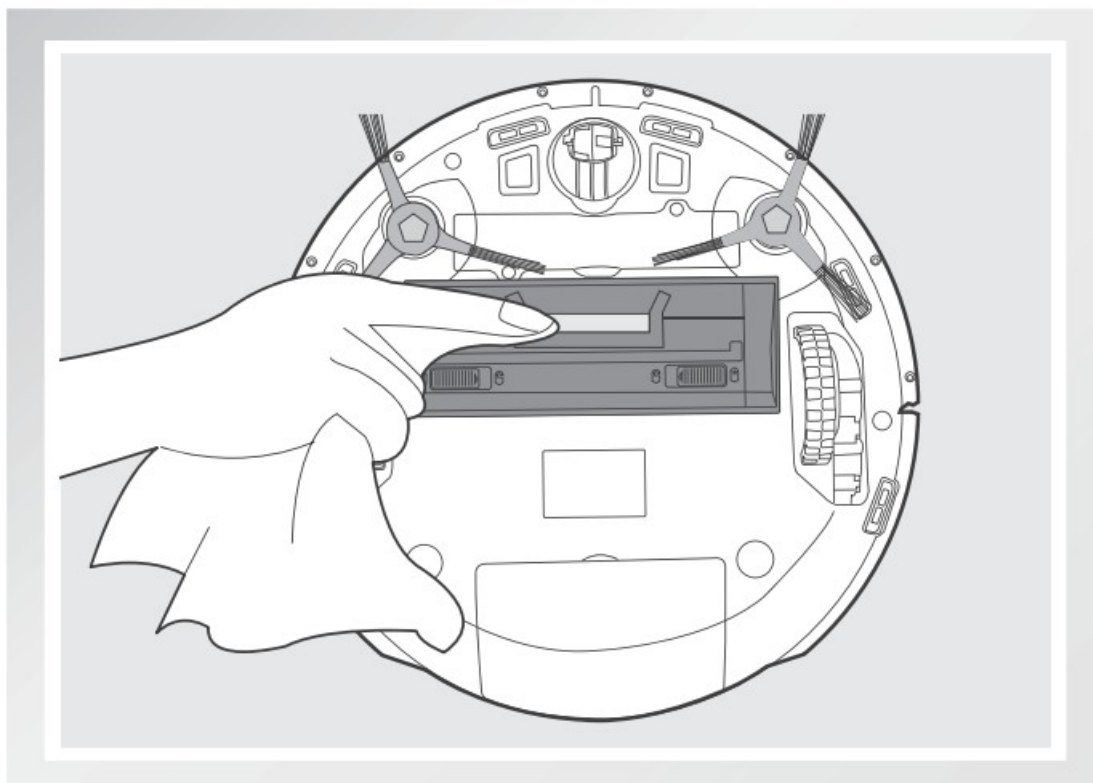

### **Cleaning the Side Brushes**

Remove the Side Brushes. Wipe the Side Brushes and their slots with a dry cloth.



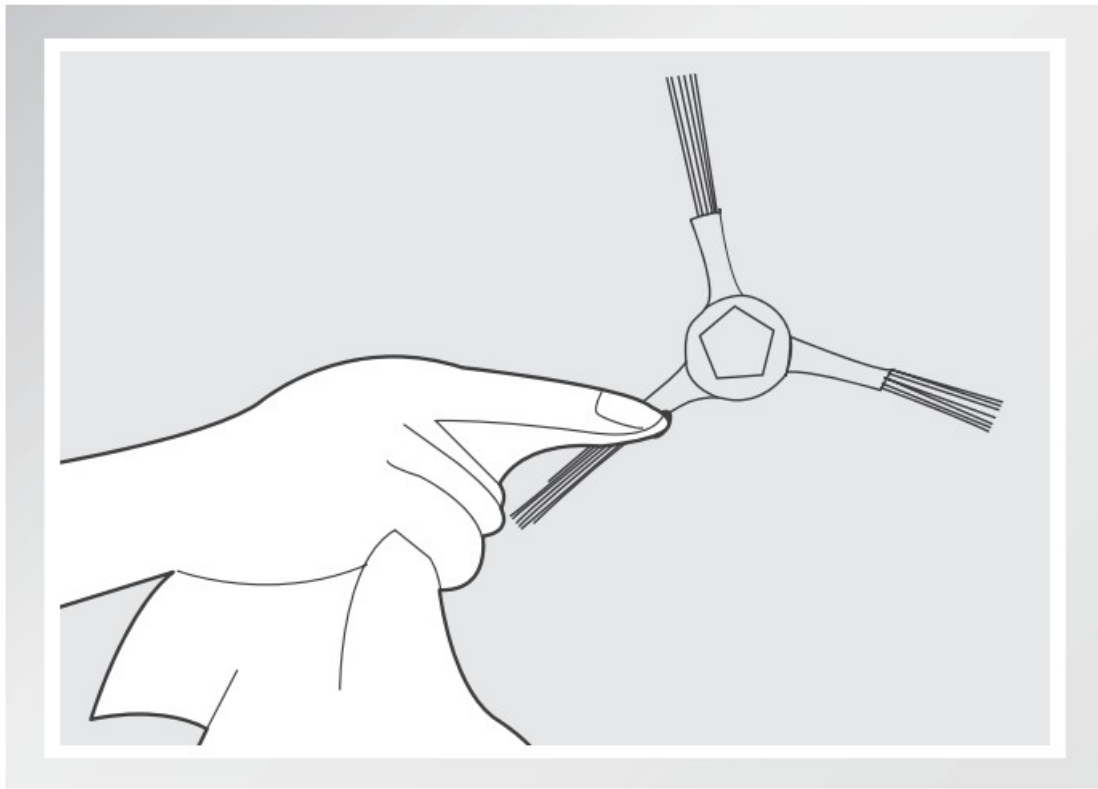

#### 4.4 Other Components

Use the Multi-Function Cleaning Tool to cut off and remove any hair tangled around the Universal Wheel.

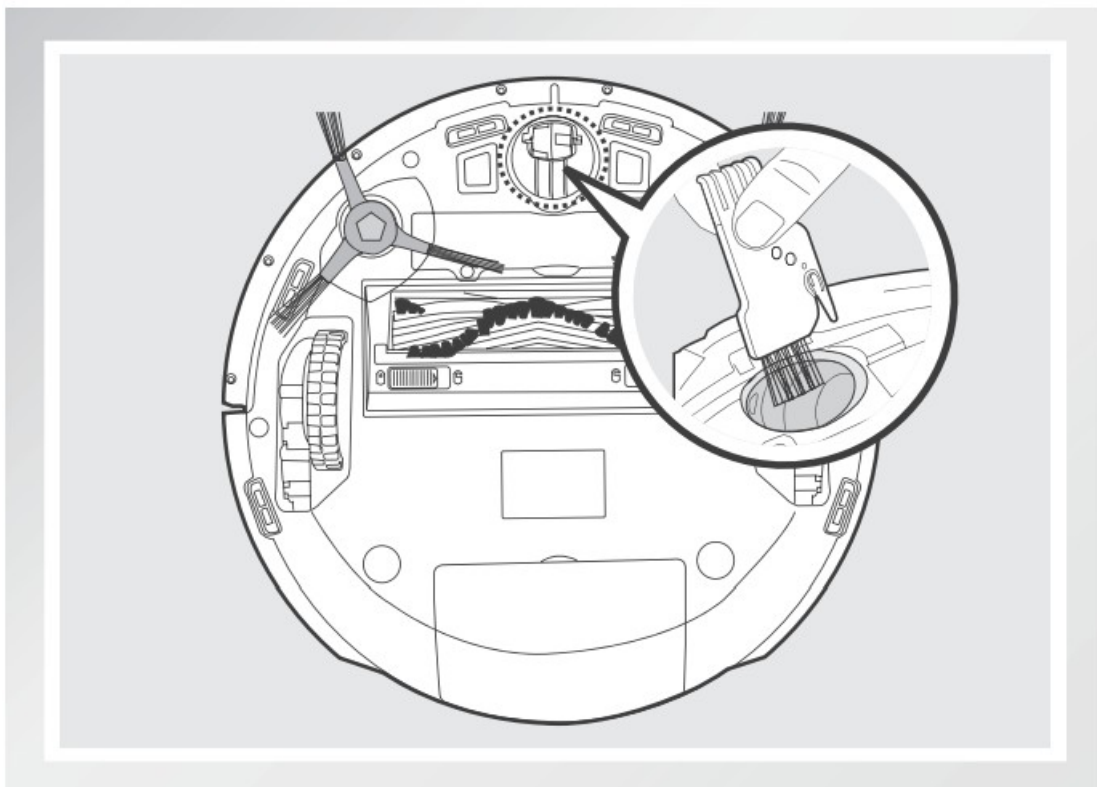

Wipe the Anti-Drop Sensors with the brush or the felt side of the Multi-Function Cleaning Tool to maintain their effectiveness.

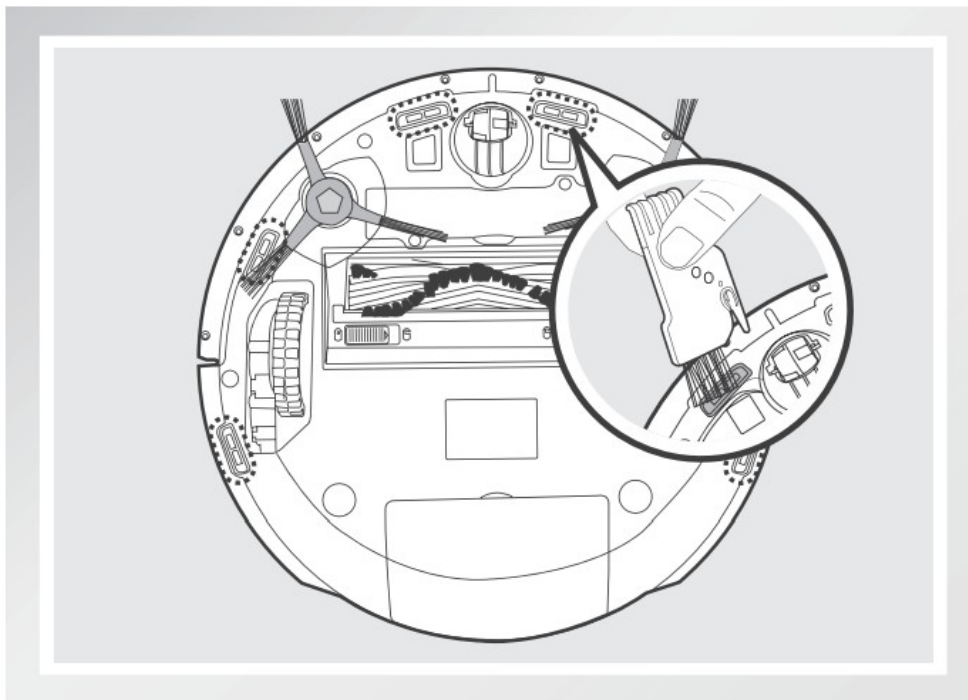

Wipe the Charging Contacts and Charging Dock Pins clean with the brush or the felt side of the Multi-Function Cleaning Tool! to maintain their effectiveness.

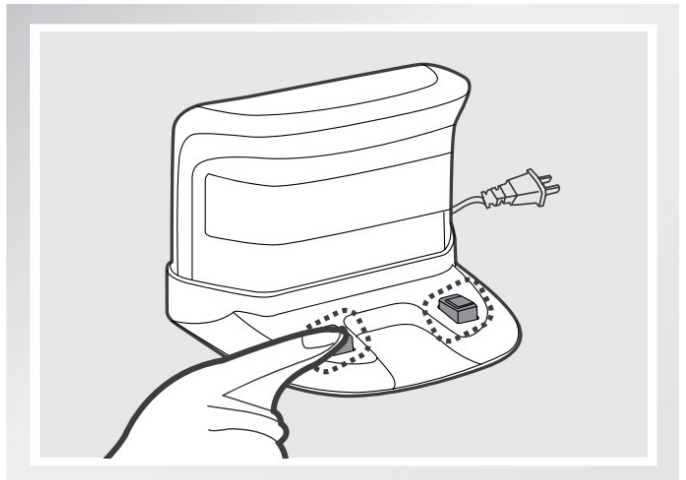
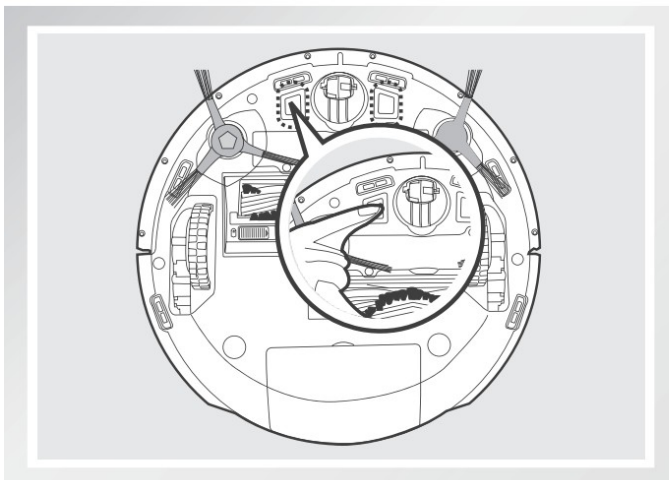

\* Avoid touching the Charging Contacts and Charging Dock Pins with wet hands or wet cloth.  
Wipe the Bumper clean with the brush of the Multi-Function Cleaning Tool to maintain the effectiveness of the Anti-Collision Sensors.

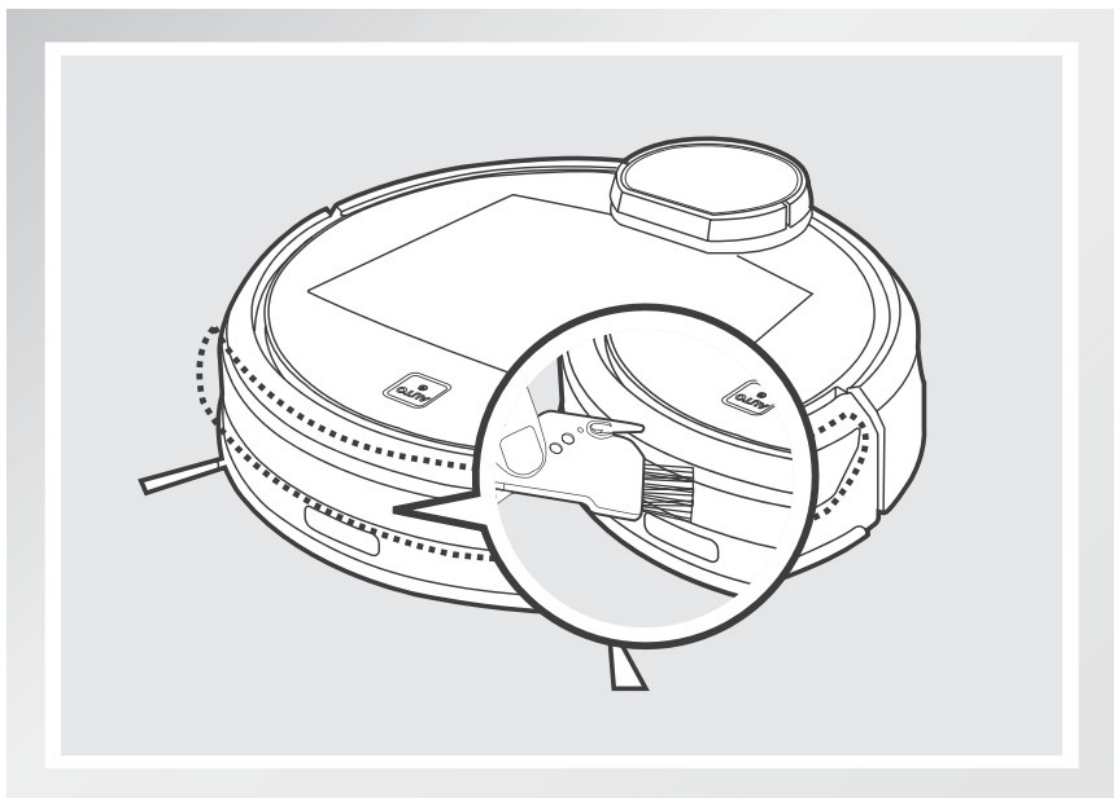

#### 4.5 Regular Maintenance

To keep DEEBOT running at peak performance, perform the maintenance and replacement according to the following frequency. A multi-Function Cleaning Tool is provided for easy maintenance. Handle with care, this cleaning tool has sharp edges.

Robot Part	Maintenance Frequency	Replacement Frequency
Cleaning Cloth	After each use	Every 50 washings
Dust Bin Advanced Wet/Dry Reservoir	After each use	/
Side brush	Once every 2 weeks	Every 3.6 months
Main Brush	Once per week	Every 6-12 months
Sponge Filter/ High Efficiency Filter	Once per week (twice per week with pets in home)	Every 4-6 months
Universal Wheel Anti-Drop Sensors Charging Contacts Charging Dock Pins	Once per week	/

**Note:** ECOVACS manufactures various replacement parts and assemblies. Please contact Customer Service for more information on replacement parts.

#### Troubleshooting

Please use this chart to troubleshoot common problems using DEEBOT R9.

No.	Malfunction	Possible Causes	Solutions
1	DEEBOT will not charge.	DEEBOT is not powered ON.	Power ON DEEBOT.
		DEEBOT has not made a connection with the Charging Dock.	Be sure that the robot's Charging Contacts have made a connection with the Charging Dock Pins. You may move the robot manually to make the connection if necessary.
		Charging Dock is unplugged while DEEBOT is powered ON, which causes battery consumption.	Plug in the Charging Dock and ensure DEEBOT is powered ON. Keep DEEBOT on the Charging Dock to make sure it has a full battery to work at any time.
		The battery is completely discharged.	Re-activate the battery. Power ON. Place DEEBOT on the Charging Dock by hand, remove after charging for 3 minutes, repeat 3 times; then charge normally.
2	DEEBOT gets into trouble while working and stops.	DEEBOT is tangled with something on the floor (electrical cords, drooping curtains, carpet fringe etc.).	DEEBOT will try various ways to get itself out of trouble. If it is unsuccessful, manually remove the obstacles, place DEEBOT to the original place and restart.
3	DEEBOT returns to the Charging Dock before it finishes cleaning.	When battery power gets low, DEEBOT automatically switches to Return to Charger Mode and returns to the Charging Dock to recharge itself.	This is normal. No solution necessary.
		Working time varies according to floor surface, room complexity and the selected Cleaning Mode.	This is normal. No solution necessary.

4	DEEBOT will not clean automatically at scheduled time.	The scheduled cleaning time is cancelled.	Schedule a cleaning time as described in section 3.4.
		Continued Cleaning function is turned ON. DEEBOT has just finished cleaning the scheduled cleaning area.	This is normal. No solution necessary.
		DEEBOT is powered OFF.	Power ON DEEBOT.
		The robot's battery is low or is not on the Charging Dock.	Keep DEEBOT powered ON and on the Charging Dock to make sure it has a full battery to work at any time.
		DEEBOT's components are tangled with debris.	Power OFF DEEBOT, clean the Dust Bin, and invert the robot. Clean Side Brushes and the Main Brush as described in section 4.
5	DEEBOT is not able to connect to home Wi-Fi network.	Incorrect home Wi-Fi username or password entered.	Enter the correct home Wi-Fi username and password.
		DEEBOT is not within range of your home Wi-Fi signal.	Make sure DEEBOT is within range of your home Wi-Fi signal.
		Network setup started before DEEBOT was ready.	Turn ON Power Switch. Press the RESET Button using a needle. DEEBOT is ready for network setup when DEEBOT plays a musical tune and its Wi-Fi Indicator light flashes slowly.
		Your smartphone's operating system needs to be updated.	Update your smartphone's operating system. The ECOVACS App runs on iOS 9.0 and above, Android 4.0 and above.
6	To reset DEEBOT, press the RESET Button using a needle for 5 seconds. DEEBOT is successfully reset when it plays a musical tune.		



Model : DR95

Vacuum Cleaner

The Floor Cleaning Robot

Rated Voltage : 14.8V DC

Use only with Ecovacs Robotics Co., Ltd. CH1465A charger.

This Device Complies with DHHS Radiation Rules, 21CFR Chapter 1,

CLASS I LASER PRODUCT

Contains FCC ID: 2AC72-ESPWROOM02.

Contains IC:21098- ESPWROOM02 Intertek



Intertek

5003840

5003840

Conforms to UL Std. 1017

MADE IN CHINA

Certified to CSA Std. C22.2 NO, 243

<https://manual-hub.com>

Ecovacs Robotics Co., Ltd.

No. 18 You Xiang Road, Wuzhong District, Suzhou City,  
Jiangsu Province, P.R.China DR95-AM01-IM2016R02

---

## Documents / Resources

	<p><a href="#">ECOVACS ROBOTICS Deebot R95 Robot Vacuum</a> [pdf] Instruction Manual Deebot R95 Robot Vacuum, Deebot R95, Robot Vacuum, Vacuum</p>
---	--

## References

- <sup>MH</sup> [Search - Manual-Hub.com](#)