



# ECOSENSE F170 Macro Aiming System Installation Guide

[Home](#) » [ECOSENSE](#) » ECOSENSE F170 Macro Aiming System Installation Guide 

# ECOSENSE®

**RISE™**  
**F170 | QUAD**

**MACRO™**  
**Aiming System**  
**INCLUDED**

RISE F170 QUAD Installation Guide

Every lighting fixture includes firmware that facilitates electronic dimming control

\*For other RISE Installation Guides visit <https://www.ecosenselighting.com/resources/#rise>

## **OPTIONAL ITEMS**

Interchangeable Lens

Color Filter

Snoot/Half Snoot

EcoSpec®

LDCM 0-10V Module

EcoSense Tenon, RISE-MULTI-SMP-(Finish)

\*For more accessories visit <https://www.ecosenselighting.com/products/#rise-accessories>

## **NOTES**

Screw Torque Settings:

Screws to replace the Lens and Bezel: Screws for MACRO™ Lock Pan and Tilt: Screw for main tilt arm: Set screws for tenon mount: EC Cable Length: Wire Color Description:	Hex 3mm; 1.25Nm ± 0.25Nm Hex 5mm; 27.0Nm ± 2.0Nm Hex 6mm; 27.0Nm ± 2.0Nm Hex 4mm; 9.5Nm ± 0.5N m3.048m (10ft) Brown or Black = Line Blue or White = Neutral Green or Green/Yellow = Ground
---	---

## Contents

### [1 INSTALL THE FIXTURE](#)

### [2 OPTIONAL INSTALL-F170 INTERCHANGEABLE LENS](#)

### [3 OPTIONAL INSTALL-F170 SNOOTS](#)

### [4 INSTALLATION CONSIDERATIONS](#)

### [5 FREEDOM TO CREATE™](#)

### [6 Documents / Resources](#)

#### [6.1 References](#)

### [7 Related Posts](#)

## INSTALL THE FIXTURE

1. Connect the wires from the fixture to the building wires.
2. Slide the base of the tenon mount over the tenon until the fixture can no longer slide down.
3. Swivel the fixture about the tenon to pan it in the desired direction.
4. Tighten the 4 set screws using a 4mm hex driver or key to 9.5Nm.
5. Use a 6mm hex driver or key to loosen the main tilt arm screw to tilt all four heads to the desired direction. Retighten to 27Nm.
6. Use a 5mm hex driver or key to loosen the MACRO™ Lock screws if individual head aiming is needed. Retighten to 27Nm.

## NON-ECO SENSE TENON

## OPTIONAL ECOSENSE TENON MOUNT

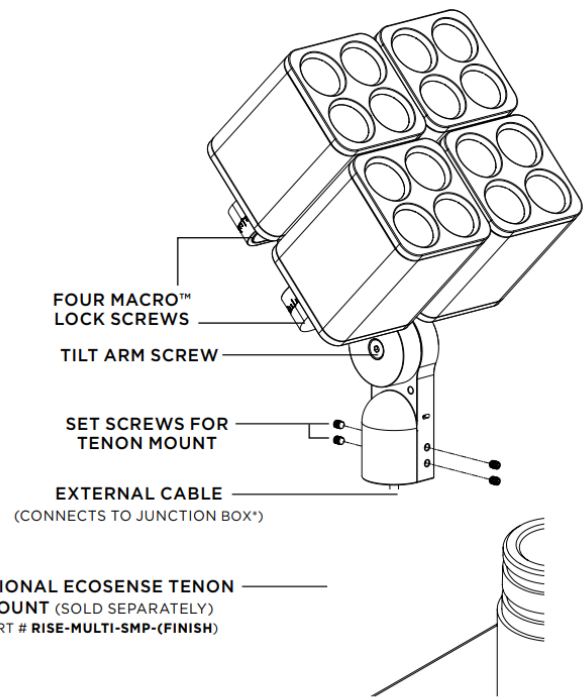
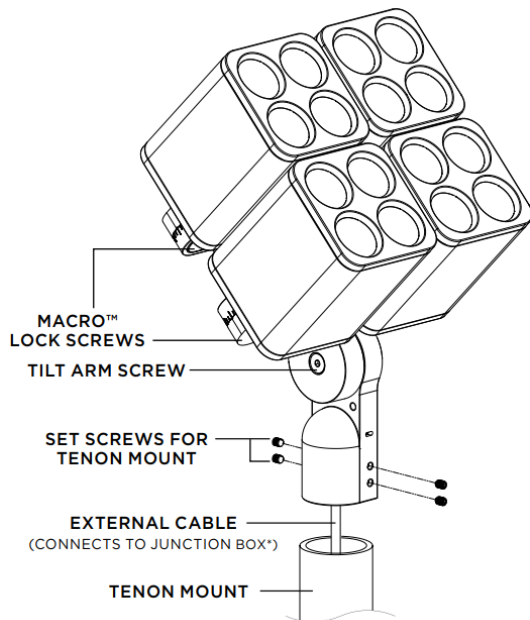

F170 QUAD can also mount to any 2-3/8" OD pipe or tenon.



Ensure power is OFF

\*Supplied by others

## OPTIONAL INSTALL-F170 INTERCHANGEABLE LENS

1. Loosen the four screws on the Back Bezel with a 3mm hex driver or key until the Front Bezel comes off.  
Screws are captive and will not fully disengage.
2. Remove the center screw using a 3mm hex driver or key from the lens.
3. Remove the old lens and install the new lens. Refer to Lens Installation Instructions for specifics.
4. Replace the new Lens and then re-fasten the Center Screw to 1.5Nm.
5. Secure the Front Bezel and tighten with the four screws from the back to 1.5Nm.

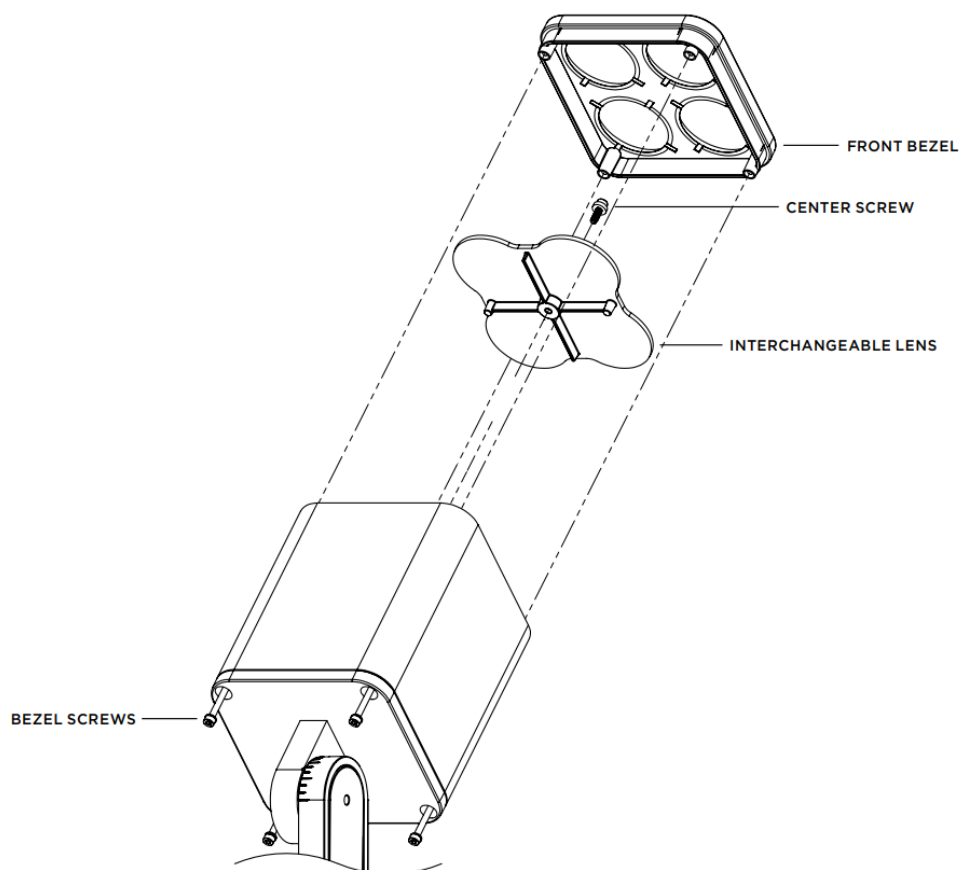

Ensure power is OFF

### OPTIONAL INSTALL-F170 SNOOTS

1. Loosen the four screws on the Back Bezel with a 3mm hex driver or key until the Front Bezel comes off.
2. Place the Snoot on and then tighten the four screws from the back to 1.5Nm.

FULL SNOOT  
Plein Coupe-Flux / Cono Completo

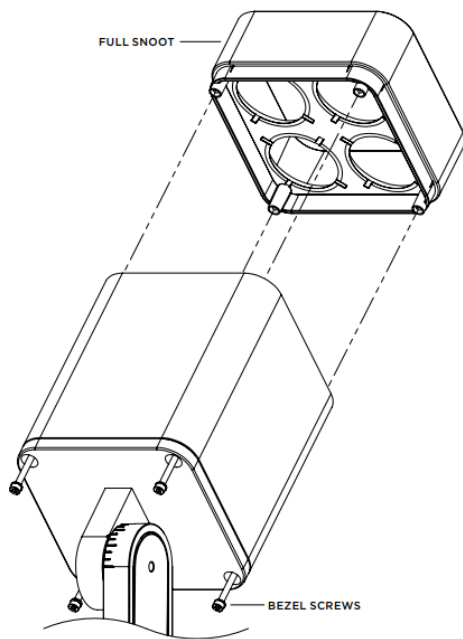

HALF SNOOT  
Moitié Coupe-Flux / Medio Cono

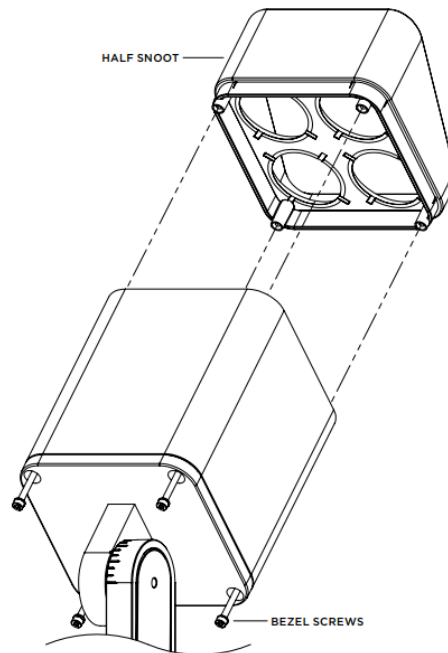

## INSTALLATION CONSIDERATIONS

POWER CONSUMPTION	52W / 100W / 152W
OPERATING TEMPERATURE	–40°C to 50°C
OPERATING VOLTAGE	120–277VAC, 50–60Hz
OPERATING AMPERAGE	Vea las características eléctricas en la etiqueta del producto
WEIGHT	27.6lbs ; (12.5kg)
DIMENSIONS	W 10.5" x H 16" x L 10.1" ; (268mm x 407mm x 258mm)

\*NOM Only

Refer to the electrical rating marked on the luminaire.

- Read and understand the installation instructions before attempting to install or use the fixture.
- Only use fixtures with voltage for which it is rated. Do not exceed the specified voltage and current input.
- Do not use fixtures if the housing, lens, or power cable are damaged.
- Ensure that the main power supply is off before installing or wiring a fixture.
- Hazardous live parts shall not be accessible after installation, and it is the installer's responsibility to ensure that the installation/connections are in compliance with national and local electrical codes and regulations.
- The wire connection method shall be determined by local electrical codes and regulations, typically using either wire nuts or screw terminal blocks.
- Possibly hazardous optical radiation emitted from this product.
- Polycarbonate Chemical Warning: Please contact an EcoSense sales representative for a complete list of chemicals that can cause damage to polycarbonate lenses and silicone gaskets. EcoSense must not be held responsible for damage to, or failure of, fixtures where any of these, or chemicals of similar nature and

makeup, are applied intentionally or inadvertently to EcoSense's fixtures.

- Earth leakage Statement: Please contact an EcoSense factory representative for full information on the earth leakage properties of fixtures when installed according to all local electrical codes and proper installation techniques.
- EcoSense Inrush Current Statement: Please contact an EcoSense Lighting sales representative for a complete list of Inrush Current Peak (A) at specific product Voltage, and Inrush Current Duration/Width (ms), for each EcoSense product.
- The external flexible cable of this luminaire cannot be replaced; if the cord is damaged, the luminaire shall be destroyed.
- The light source contained in this luminaire shall only be replaced by the manufacturer or his service agent or a similarly qualified person.

This equipment has been tested and found to comply with the limits for a Class B digital device, pursuant to part 15 of the FCC Rules. These limits are designed to provide reasonable protection against harmful interference in a residential installation.

This equipment generates, uses, and can radiate radio frequency energy and, if not installed and used in accordance with the instructions, may cause harmful interference to radio communications. However, there is no guarantee that interference will not occur in a particular installation.

If this equipment does cause harmful interference to radio or television reception, which can be determined by turning the equipment off and on, the user is encouraged to try to correct the interference by one or more of the following measures:

- Reorient or relocate the receiving antenna.
- Increase the separation between the equipment and receiver.
- Connect the equipment into an outlet on a circuit different from that to which the receiver is connected.
- Consult the dealer or experienced radio/TV technician for help.

#### **Modifications:**

Changes or modifications not expressly approved by the party responsible for compliance could void the user's authority to operate the equipment.

## **FREEDOM TO CREATE™**



Read the following instructions before operating the luminaire.

EcoSense Lighting fixtures must be installed by a qualified electrician.

EcoSense Lighting, Inc. is not responsible if its fixtures are not installed in accordance with all national and local safety standards.

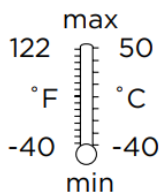

**IP66**



**IK10**

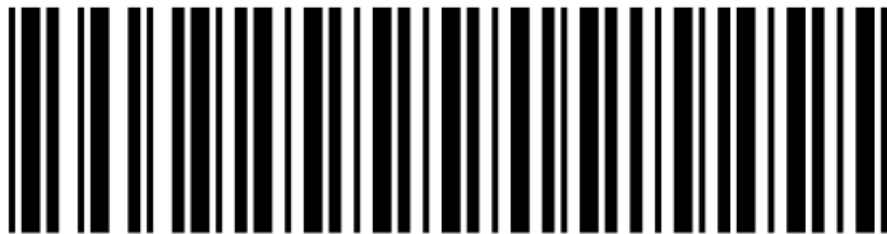

**Part Number: MNL-000104-00**



Surge Protection Devices with a minimum discharge current rating of 20kA, which meet UL1449, CSA C22.2 No. 269.1, and IEC TR 62066, should be installed on each branch circuit.

**ECOSENSE™**

ECOSENSE LIGHTING INC.  
837 NORTH SPRING STREET  
SUITE 103  
LOS ANGELES, CA 90012  
P • 310.496.6255  
F • 310.496.6256  
T • 855.632.6736  
855.6.ECOSEN

SPECIFICATIONS ARE SUBJECT TO CHANGE WITHOUT NOTICE.  
VISIT [ECOSENSELIGHTING.COM](http://ECOSENSELIGHTING.COM) FOR THE MOST CURRENT SPECIFICATIONS.

FOR A LIST OF PATENTS VISIT [ECOSENSELIGHTING.COM/IP-PORTFOLIO/](http://ECOSENSELIGHTING.COM/IP-PORTFOLIO/)

©2019 ECOSENSE LIGHTING INC. ALL RIGHTS RESERVED. ECOSENSE, THE  
ECO SENSE LOGO, TRoV, TROV, AND ECOSPEC ARE REGISTERED TRADEMARKS  
OF ECOSENSE LIGHTING INC.

RISE™, SLIM COVE™, FREEDOM TO CREATE™, MACRO™, FLIP-TO-FLAT™ ARE  
TRADEMARKS OF ECOSENSE LIGHTING INC.

## Documents / Resources

	<a href="#">ECOSense F170 Macro Aiming System</a> [pdf] Installation Guide F170, Macro Aiming System
---	---

## References

- [Ecosense Lighting: LED Technology | Linear and Flood LED Lighting](#)
- [Ecosense Lighting: LED Technology | Linear and Flood LED Lighting](#)
- [Products - Ecosense Lighting](#)
- [Products - Ecosense Lighting](#)
- [Downloads - Ecosense Lighting](#)