

ecolight<sup>®</sup>  
lights & more

**ecolight  
Floodlights  
with PIR  
Motion Sensor**



## ecolight Floodlights with PIR Motion Sensor Instruction Manual

[Home](#) » [ecolight](#) » ecolight Floodlights with PIR Motion Sensor Instruction Manual 

### Contents

- [1 ecolight Floodlights with PIR Motion Sensor](#)
- [2 Product Information](#)
- [3 Product Usage Instructions](#)
- [4 CHARACTERISTICS](#)
- [5 INSTALLATION](#)
- [6 NOTE](#)
- [7 SAFETY AND MAINTENANCE](#)
- [8 FAQ](#)
- [9 Documents / Resources](#)
  - [9.1 References](#)

ecolight<sup>®</sup>  
lights & more

**ecolight Floodlights with PIR Motion Sensor**



## Product Information

### Specifications

- **Light Intensity:** 3-2000 LUX
- **Lighting Duration:** 10 seconds – 7 minutes
- **Range:** 2-8 meters

### Product Usage Instructions

#### Setting Up the Product

1. Locate a suitable mounting location within the specified range of 2-8 meters.
2. Ensure the product is positioned to detect motion effectively.
3. Connect the product to a power source according to the provided guidelines.

#### Adjusting Light Intensity and Duration

To adjust the light intensity and duration, follow these steps:

1. Use the provided controls to set the desired light intensity between 3-2000 LUX.
2. Select the lighting duration from 10 seconds to 7 minutes based on your preference.

## CHARACTERISTICS

LED floodlights are energy-efficient fixtures for indoor and outdoor use, with IP65 protection. They are suitable for lighting buildings, gardens, parking lots, shop windows, and humid rooms. The aluminum cast housing dissipates heat, and the tempered glass protects the LEDs from damage. They come with an adjustable mounting bracket and an SMD LED panel that saves energy. The light sources are non-replaceable when they expire, the entire fixture needs replacement. Powered by 220-240V, with a cable fed through a sealed gland.

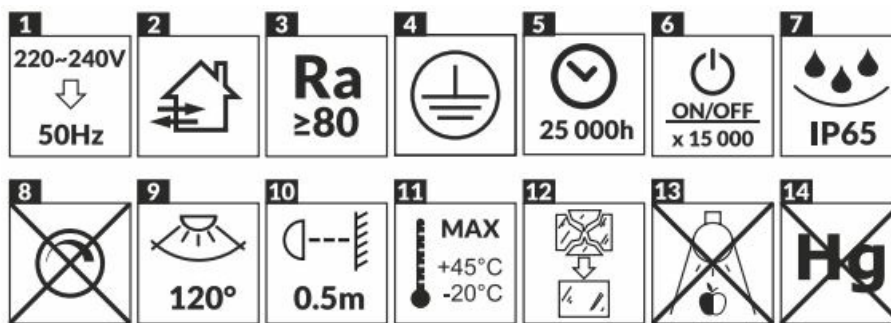

WYMIARY (mm)

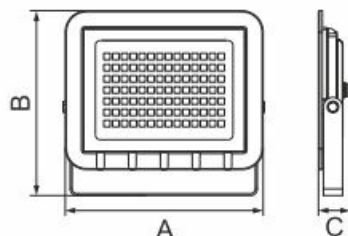

Model	10W	20W	30W	50W	100W	150W	200W
A [mm]	92.5	144	122	190	256	328	388
B [mm]	77.5	125	107	151.5	208	250	275
C [mm]	21.6	23.1	26.3	27	30.5	34	38

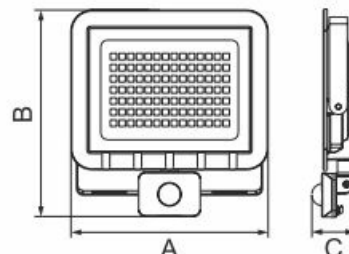

Model	10W	20W	30W	50W
A [mm]	96	126	150	192
B [mm]	147	175	195	225
C [mm]	37	37	40	40

## INSTALLATION

The installation must be done by a qualified electrician. Before installation, disconnect the power to avoid electric shock. The wires must be connected according to the instructions and regulations.

1. Mark the drilling points and install the expansion plugs.
2. Connect the power cable to the terminal block or connector:
  - Phase wire (brown) to "L"
  - Neutral wire (blue) to "N"
  - Ground (yellow-green)
3. Screw the fixture to the base.
4. Stabilize the floodlight in the desired position.

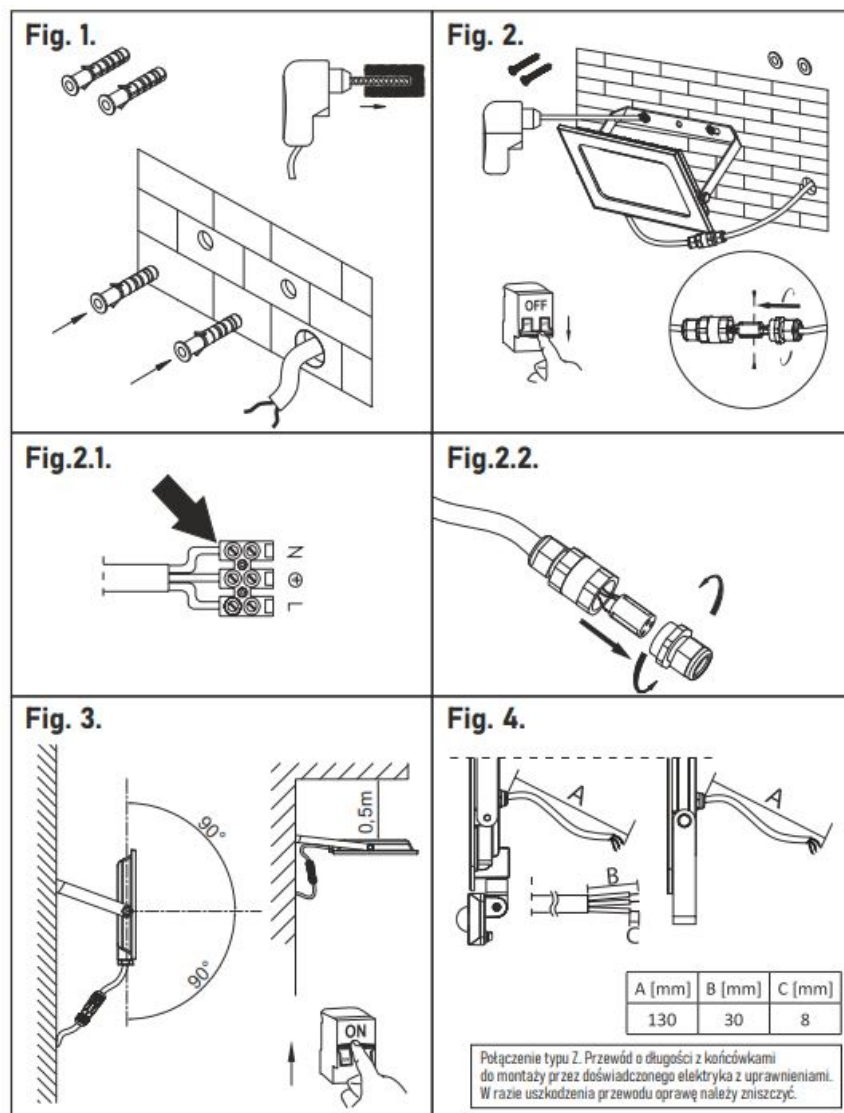

## NOTE

1. Power the fixture only with the rated voltage.
2. No hermetic cable connector for the 220-240V network is included.
3. Do not use the fixture without or with a damaged protective glass.
4. Avoid mounting on surfaces prone to vibration.
5. Do not look directly into the LED light beam.
6. Maintain a minimum distance of 1m from the illuminated object.
7. We are not responsible for damages caused by incorrect installation.
8. We reserve the right to make changes to the product design.
9. The content of the manual may change without prior notice.
10. Warranty for physical defects expires after 2 years.

## SAFETY AND MAINTENANCE

Before cleaning, disconnect the device from power to avoid electric shock. Clean with soft, dry cloths. Avoid caustic agents, solvents, and pressure water.



The symbol indicates selective collection of electrical and electronic equipment, meaning that this product should not be treated like other household waste. It should be taken to a proper collection point for used electrical and electronic equipment. Proper handling of tasks related to the collection of used electrical and electronic equipment is particularly important when the equipment contains hazardous substances that have a particularly negative impact on the environment\ and human health.

ECO LIGHT Sp. z o.o., ul. Działkowa 2a, 62-872 Borek  
Wyprodukowano w P.R.C.

## FAQ

### Q: What should I do if the product does not detect motion?

A: Check the positioning of the product to ensure it is within the specified range of 2-8 meters and adjust as needed. Additionally, make sure there are no obstructions blocking the motion sensor.

### Q: Can I install the product outdoors?

A: It is recommended to install the product in a sheltered outdoor area to protect it from harsh weather conditions.

## Documents / Resources



[ecolight Floodlights with PIR Motion Sensor](#) [pdf] Instruction Manual  
Floodlights with PIR Motion Sensor, PIR Motion Sensor, Motion Sensor, Sensor

## References

- [User Manual](#)

### Manuals+. Privacy Policy

This website is an independent publication and is neither affiliated with nor endorsed by any of the trademark owners. The "Bluetooth®" word mark and logos are registered trademarks owned by Bluetooth SIG, Inc. The "Wi-Fi®" word mark and logos are registered trademarks owned by the Wi-Fi Alliance. Any use of these marks on this website does not imply any affiliation with or endorsement.