



# ECOFLOW WAVE Series Velcro Strap Handle User Guide

July 14,  
2025



## Contents [ [hide](#) ]

### [1 QUICK START GUIDE V1.0](#)

#### [1.1 EcoFlow Velcro Strap Handle](#)

##### [1.1.1 EcoFlow WAVE Series Car Vent Seal](#)

##### [1.1.2 EcoFlow Shower Kit](#)

### [2 Documents / Resources](#)

#### [2.1 References](#)

## QUICK START GUIDE V1.0

### EcoFlow Velcro Strap Handle

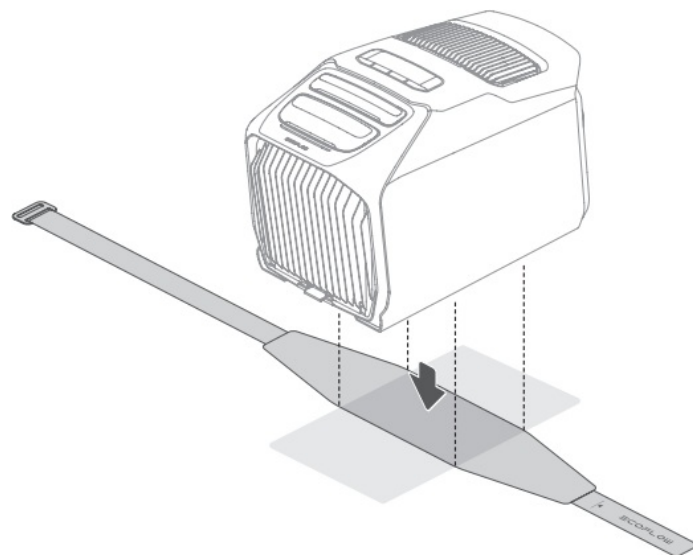

**2**

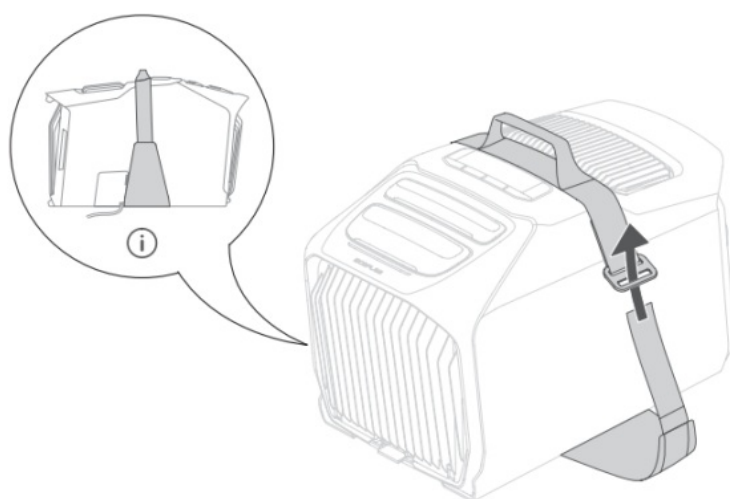

**3**

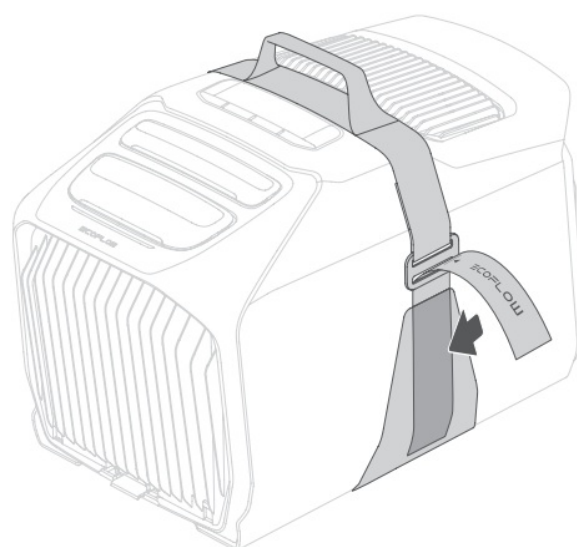

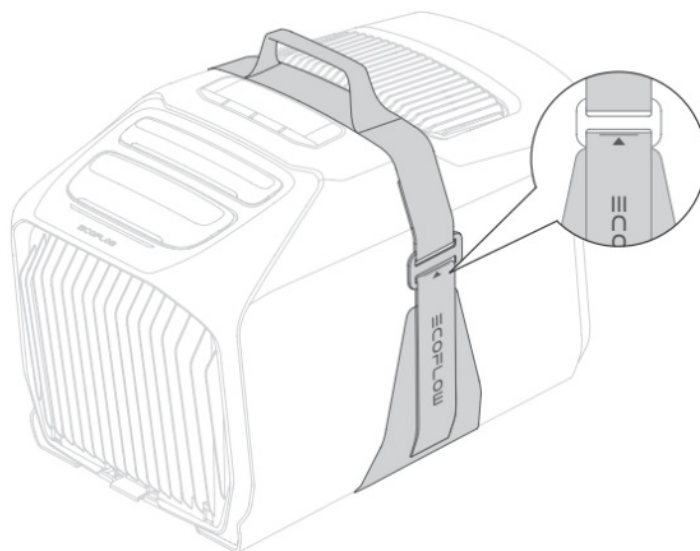

© 2025 EcoFlow Inc. All rights reserved.



\* Images in this document are for reference only.

### EcoFlow WAVE Series Car Vent Seal

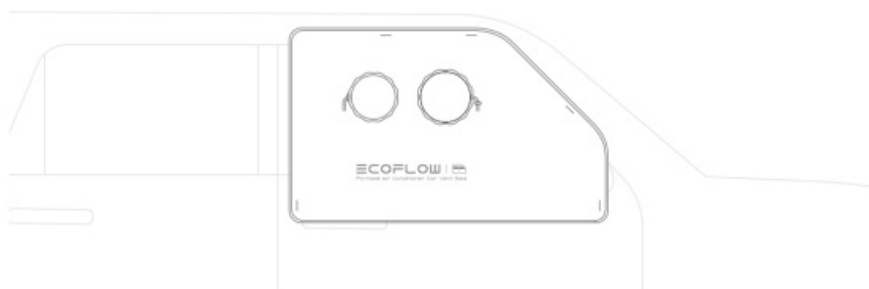

© 2025 EcoFlow Inc. All rights reserved.



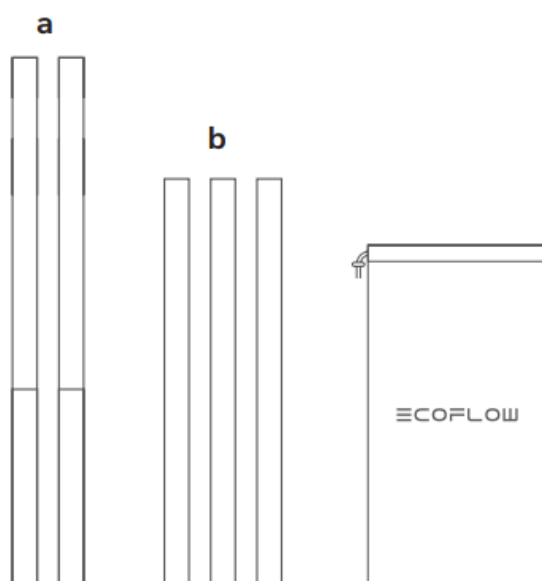
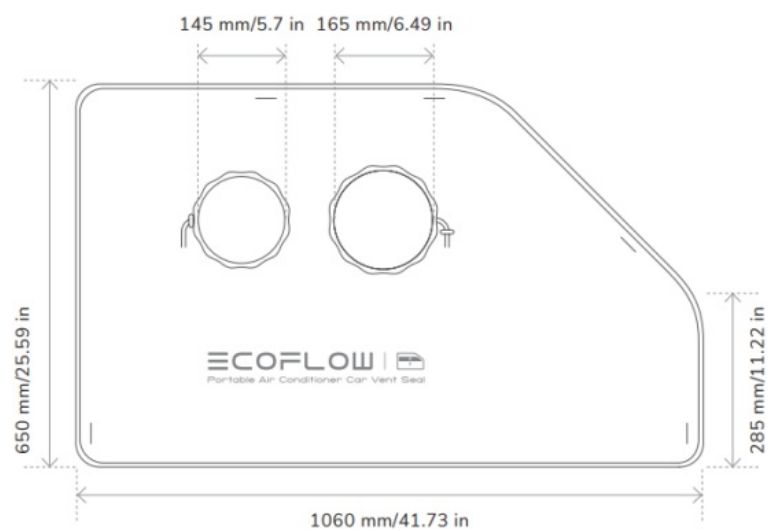

## Magnetic Use

1

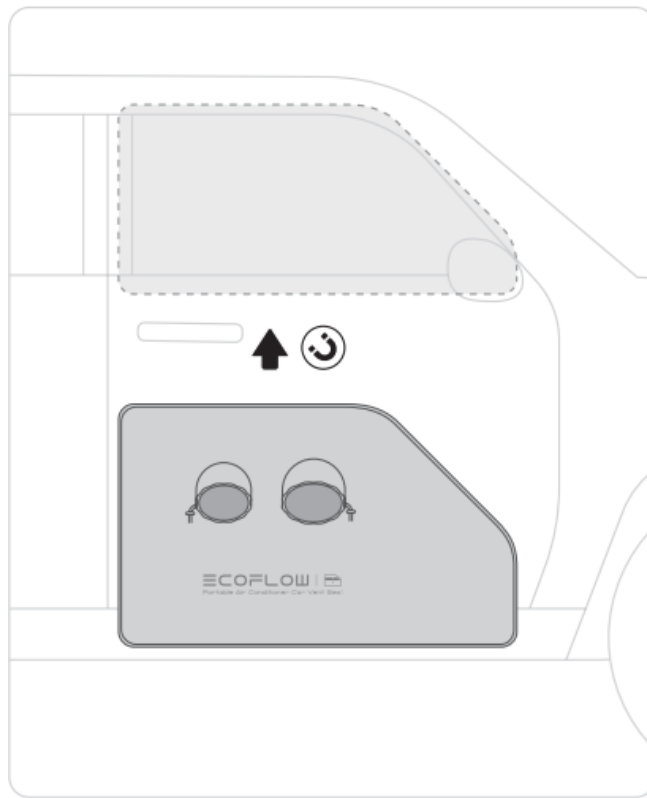

2

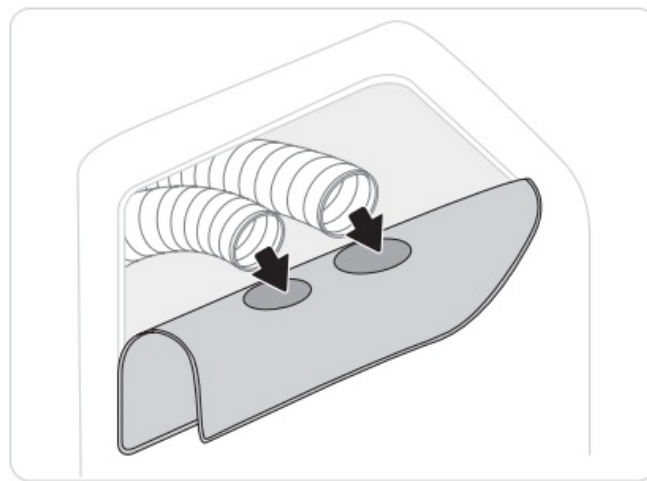

3

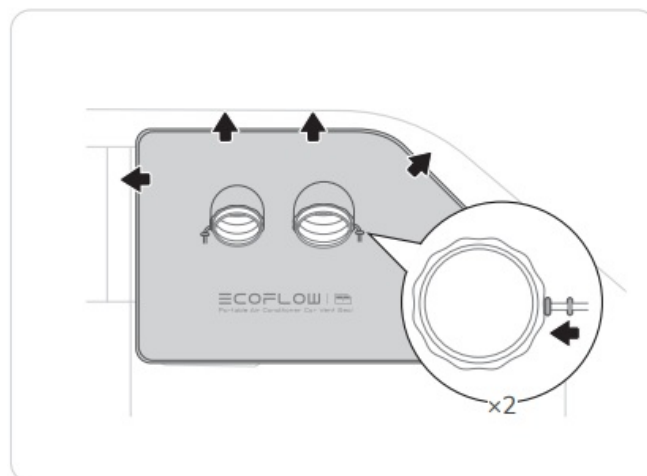

## Non-Magnetic Use

1

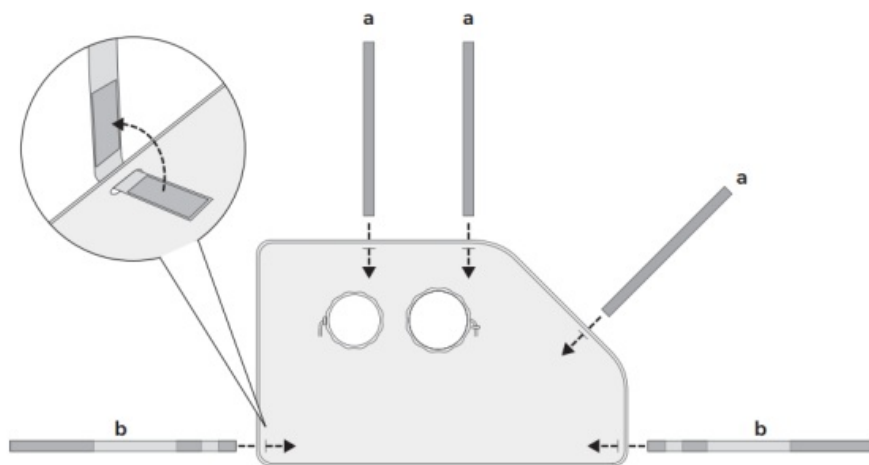

2

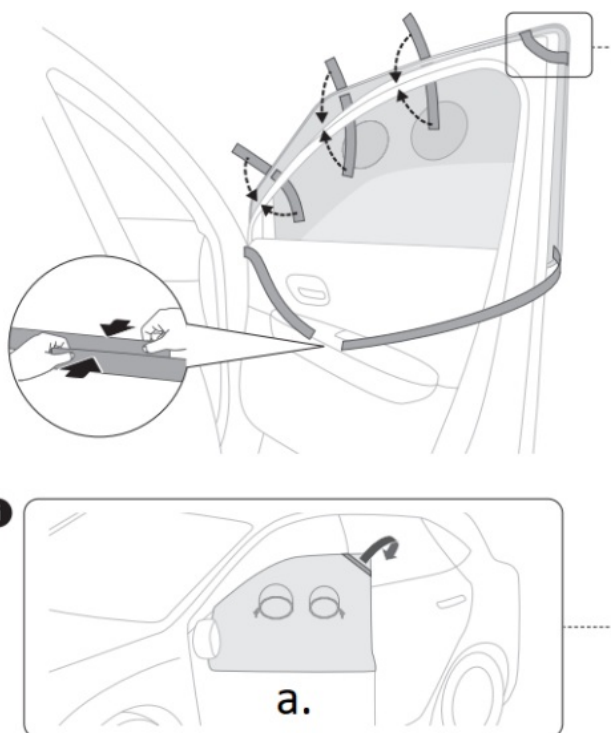

a. LEFT DOOR

3

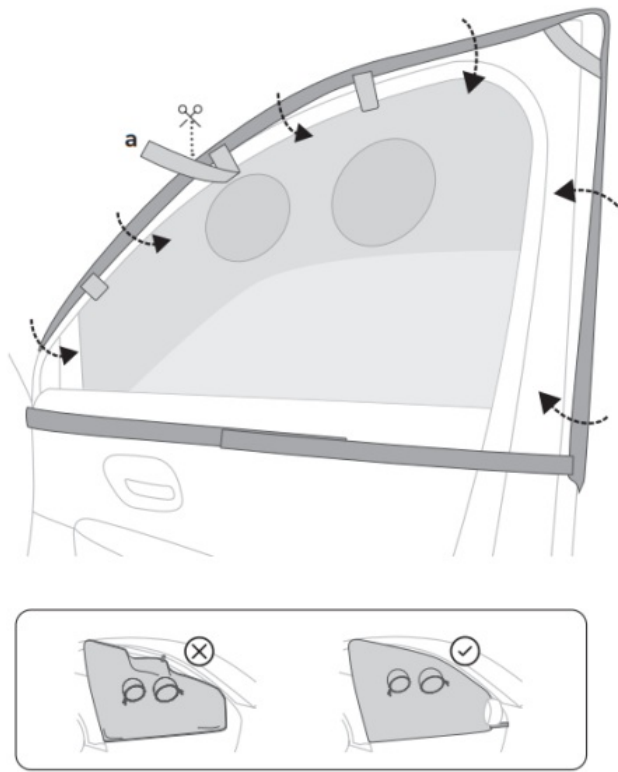

4

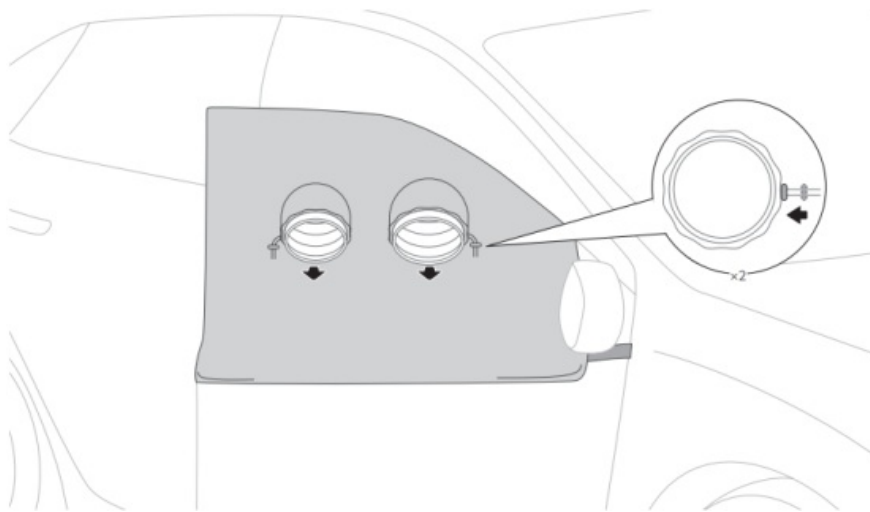

## EcoFlow Shower Kit

1

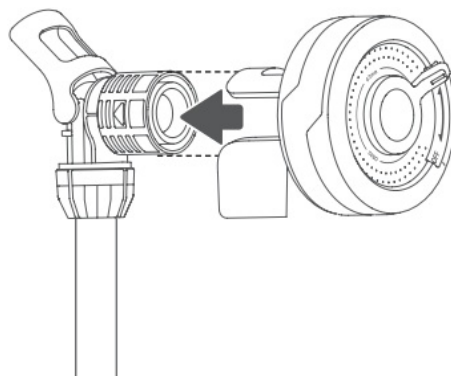

2

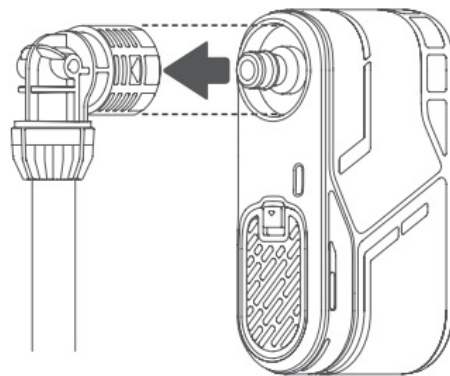

3

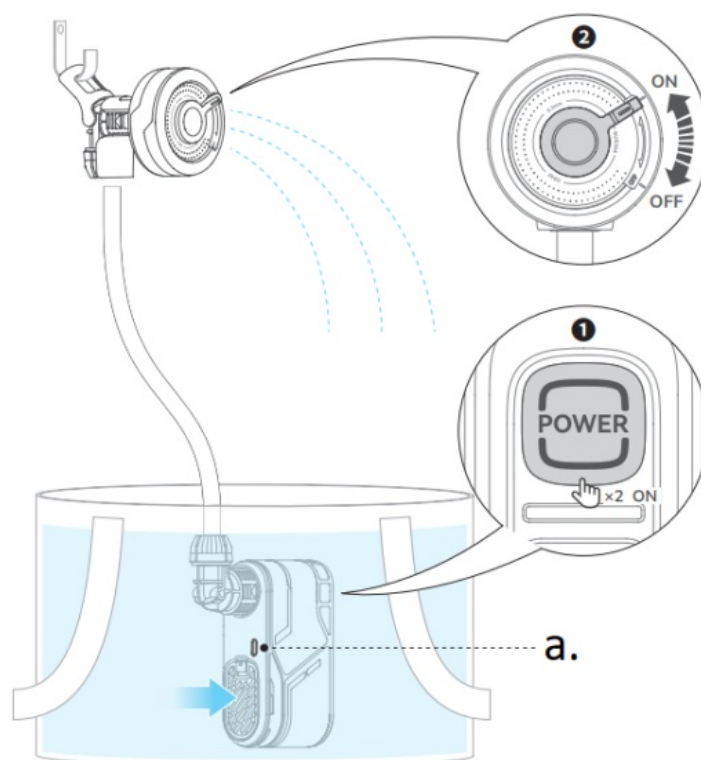

**a. Battery Level**

 0% – 5%

 6% – 100%





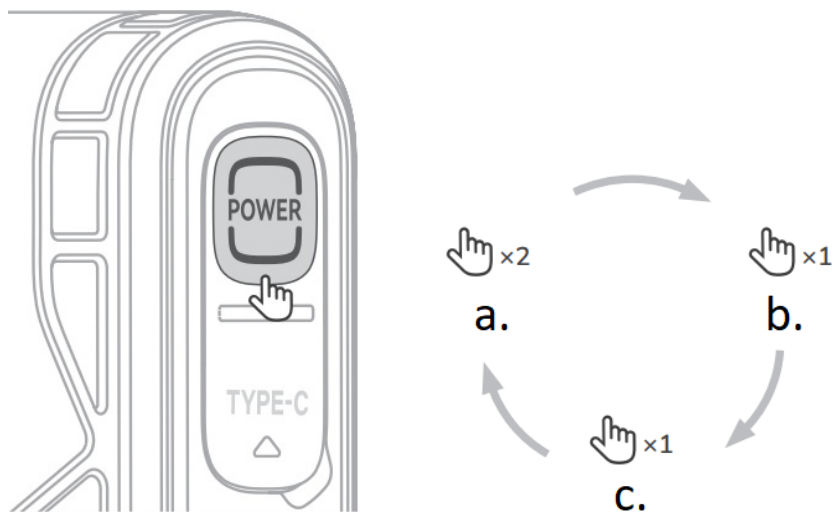

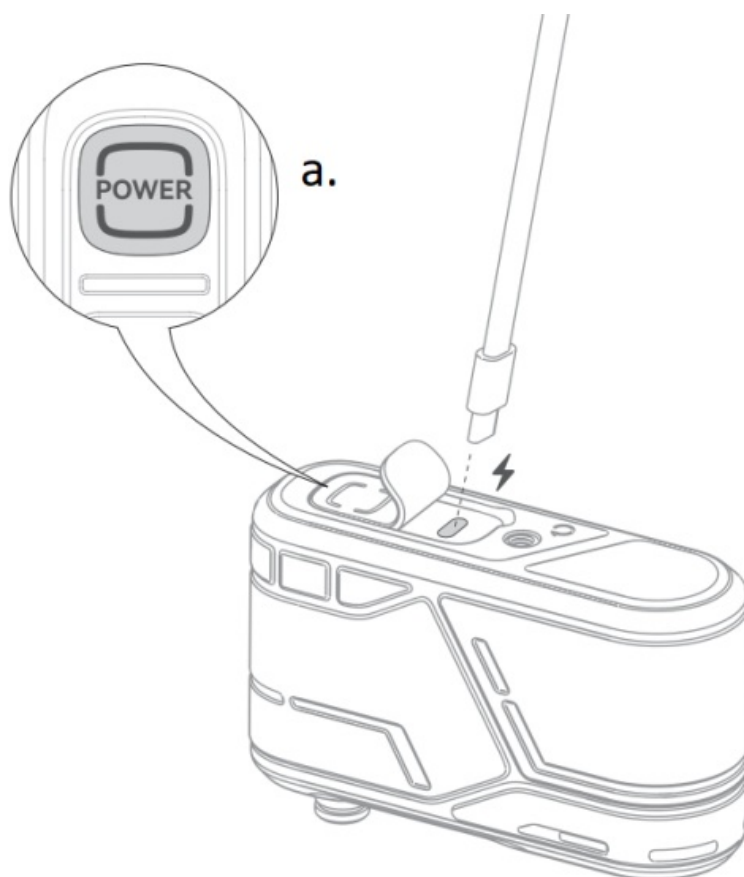

- a. Turn On
- b. Switch Mode
- c. Turn Off



#### a. Charging Status

-  0% – 99%
-  100%

\* Images in this document are for reference only.



© 2025 EcoFlow Inc. All rights reserved.

# Documents / Resources

	<a href="#">ECOFLOW WAVE Series Velcro Strap Handle [pdf]</a> User Guide WAVE Series Car Vent Seal, Velcro Strap Handle, Shower Kit, WAVE Series Velcro Strap Handle, WAVE Series, Velcro Strap Handle, Strap Handle, Handle
---	---

## References

- [User Manual](#)

ECOFLOW  
ECOFLOW, Handle, Shower Kit, Strap Handle, Velcro Strap Handle, Wave Series, WAVE Series Car Vent Seal, WAVE Series Velcro Strap Handle

# Leave a comment

Your email address will not be published. Required fields are marked \*

Comment \*

Name

Email

Website

☐ Save my name, email, and website in this browser for the next time I comment.

**Post Comment**

**Search:**

**Search**

[Manuals+](#) | [Upload](#) | [Deep Search](#) | [Privacy Policy](#) | [@manuals.plus](#) | [YouTube](#)

This website is an independent publication and is neither affiliated with nor endorsed by any of the trademark owners. The "Bluetooth®" word mark and logos are registered trademarks owned by Bluetooth SIG, Inc. The "Wi-Fi®" word mark and logos are registered trademarks owned by the Wi-Fi Alliance. Any use of these marks on this website does not imply any affiliation with or endorsement.