



## EBELONG ERC112 Smart Dimming Lighting Controller Instructions

[Home](#) » [EBELONG](#) » EBELONG ERC112 Smart Dimming Lighting Controller Instructions 

### EBELONG ERC112 Smart Dimming Lighting Controller Instructions



## Contents

- [1 Introduction](#)
- [2 Product parameters](#)
- [3 Installation](#)
- [4 Pairing Method](#)
- [5 Control Instructions](#)
- [6 ECHO](#)
- [7 Troubleshooting](#)
- [8 FCC STATEMENT](#)
- [9 Documents / Resources](#)
- [10 Related Posts](#)

## Introduction

ERC112 smart controller can be controlled with EU1254 wireless kinetic switch, no battery is needed during use. It has WiFi module inside, so can be controlled remotely with mobile APP, and also can use voice control with Amazon Alexa.

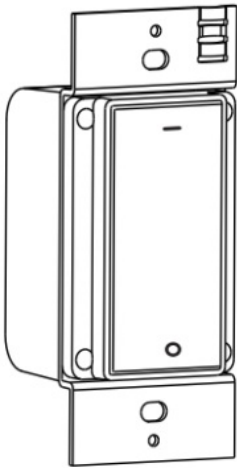

ERC112 Smart Controller

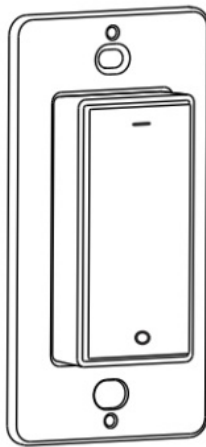

EU1254 Kinetic Switch

## Product parameters

- **Controller Model:** ERC112
- **Kinetic Switch:** EU1254
- **Controller Voltage:** AC100V-240V 50/60Hz
- **Rated Load:** 500W
- **Wireless Communication** WiFi 2.4GHz & RF 902 MHz
- **Control distance** : 50m(Outdoor) 30m Indoor
- **Sensitivity:** -110dBm
- **Storage Capacity:** Maximum 10 switch keys can be paired
- **Dimming controller dimensions:** L44\*W41\*H107mm
- **Kinetic switch dimensions:** L33\*W16\*H65mm (Excluding base plate)
- **Switch base plate dimensions:** L44\*W3\*H107mm
- **Temperature:** -15°C~ +45°C

## Installation

## Controller

1. Use the line cap to wire as shown.
2. Load the controller into the wire box and use screw to fix.

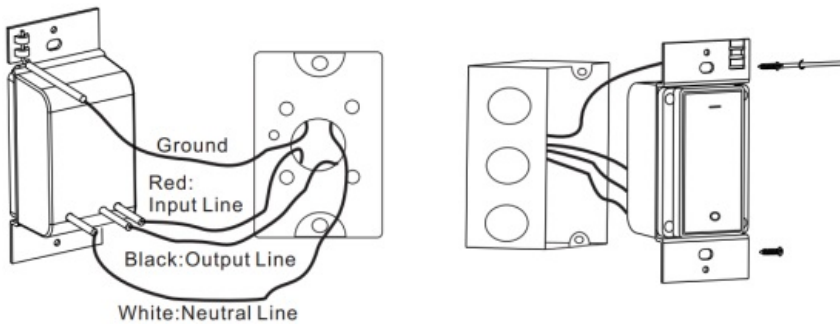

## EU1254 Kinetic Switch

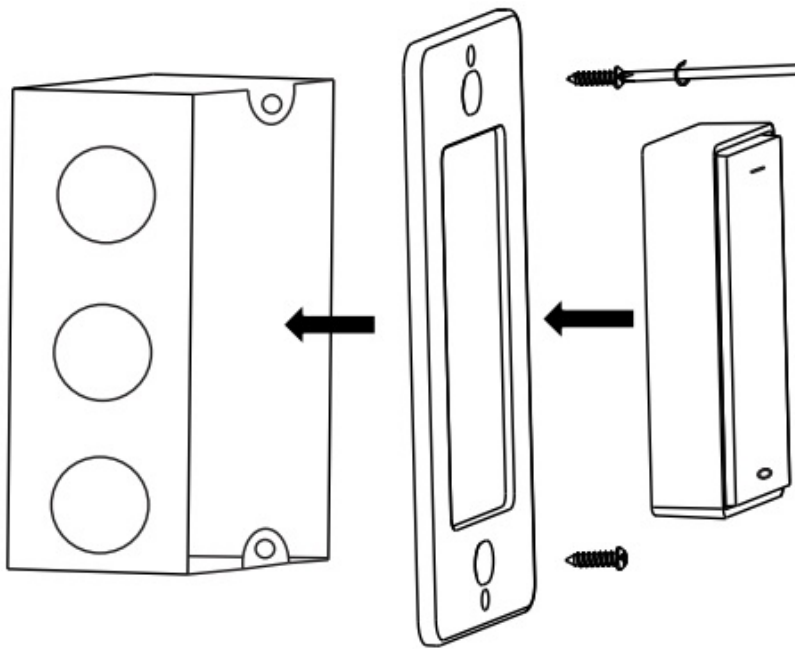

1. Mount the base plate on the wire box or wall
2. Adhere the wireless kinetic switch to the base plate.

## Pairing Method

In some cases, you need to re-pair the controller and kinetic energy switch. Methods as below.

1. Power on the dimming controller, and then keep pressing the pairing key about 6 seconds, when the indicator light flash slowly (flash 1 time per second), then release the key, and the controller is ready for pairing. You can also click the “pairing” button in the app to make device enter pairing mode.
2. At this time, press any button of the kinetic energy switch once (do not press several times). If the indicator light is off, it means that pairing is successful.
3. If need to pair with multiple switches, repeat the above procedure. Please note one controller can be paired with maximum 10 switches.
4. After pairing, can press the kinetic energy switch to control dimming controller.

## Common Pairing Method

1. Long press pairing key 6 seconds, indicator light will flash slowly
2. click any key of kinetic switch once.

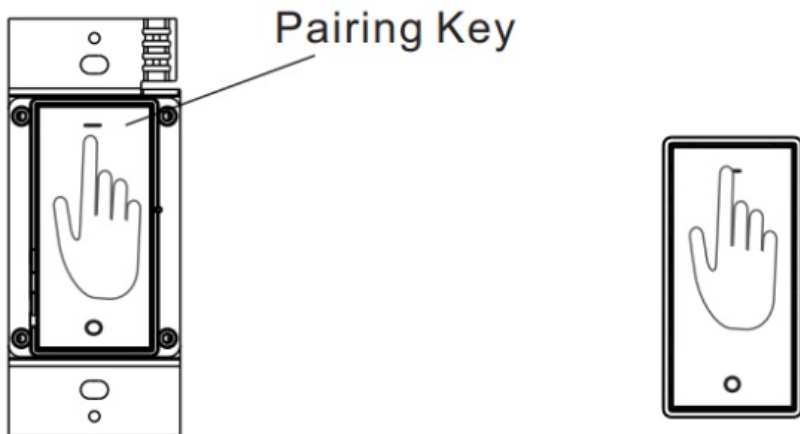

## Control Instructions

Dimming controller can be controlled by kinetic switch after paired:

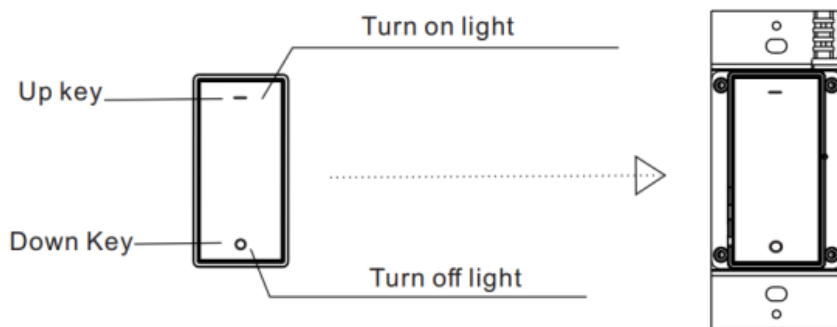

## Clear Pairing

1. If you need to clear pairing of switch and controller. You should keep press the pairing key 12 seconds until the light changes from blinking to steady light and then goes out. Or click on the "Clear Pairing" button in the app.
2. After clearing the pairing, the kinetic switch will no longer control the controller, but can be paired again.

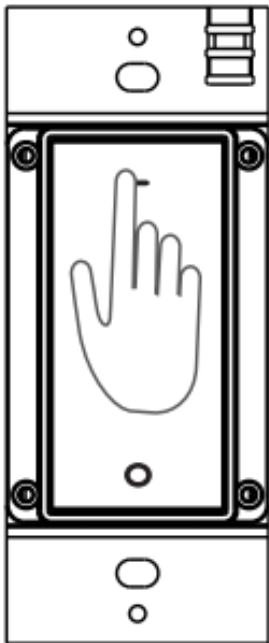

### APP download

This controller can use mobile APP for remote control. Search “ Kinetic switch” in App Store or Google Play and download, or scan below QR code to download.



### Connect WiFi Method

1. Use mobile phone to download the app and follow the prompts to register your account in the app.
2. Power on the controller , and confirm the indicator light flashes quickly (twice per second ).If the indicator light is not flashing quickly, press and hold pairing key about 10 seconds, the indicator light will flash from slowly to stay on, release pairing key when the indicator light stay on. After 3 seconds,the indicator light will flash quickly(twice per second),which means that controller is ready for WiFi connection.
3. Click the “+” button in top right corner of APP, and then select “Single receiver controller”.
4. Then click “confirm indicator light rapidly blink” and enter password of WiFi, it starts to connect. If the indicator light goes off, which means APP connect successfully and you can find the device in the home page of APP.
5. After the pairing with network, so can use APP to trun on/off light . Also,you can use mobile app for remote control, timed control and scene control.
6. If you need to replace the router, you need to delete all the devices in the app, and then re-add each device to your account once in the new router.

Confirm the indicator light flash quickly

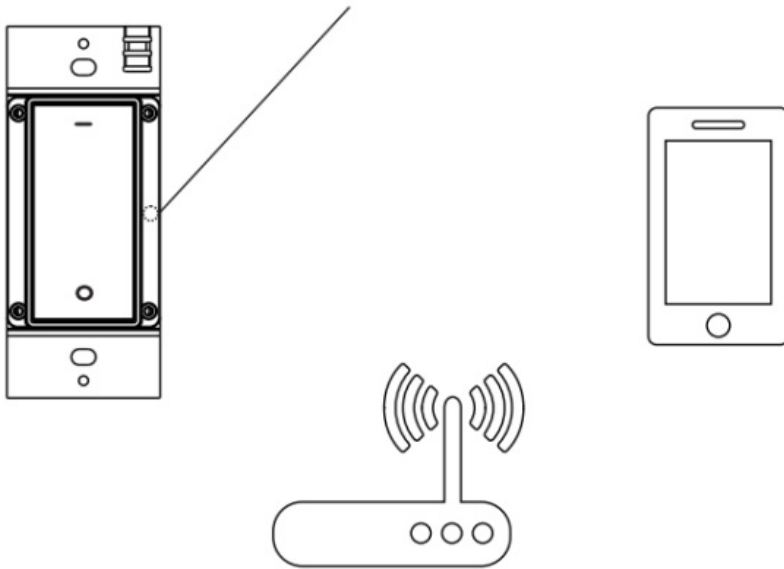

## ECHO

1. In the Kinetic Switch APP, rename the controller devices, such as bedroom lights.
2. Add the SmartLife skill in Alexa APP, and log in by using the account and password of the Kinetic Switch APP.
3. Discover the device in the smart application selection in the Alexa APP.
4. Now you can control and controller with voice.

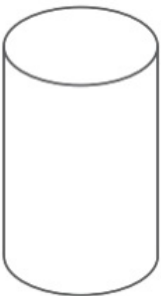

“Alexa, turn on/off bedroom light”

“Alexa, bright bedroom light”

## Troubleshooting

### 1. WiFi connection failed

Troubleshooting method: Please confirm the indicator light is blink rapidly (twice per second); If not blink rapidly, please set the indicator light to blink rapidly according to connect WiFi method. Let router, controller and mobile phone as close as possible (within 5 meters).

### 2. The controller is off line in APP

Troubleshooting method: Maybe the number of the router connection over the maximum. Usually, only 15 devices can be connected with Common router, please upgrade router and close devices not needed.

### 3. Controller can not work after power on

Troubleshooting method: If the loads exceed the rated current or short circuit, the fuse may blow. Please check the loads if suitable.

## FCC STATEMENT

This device complies with Part 15 of the FCC rules and Industry Canada license-exempt RSS standard(s).

Operation is subject to the following two conditions: (1) this device may not cause harmful interference, and (2) this device must accept any interference received, including interference that may cause undesired operation.

The manufacturer is not responsible for any radio or TV interference caused by unauthorized modifications or change to this equipment. Such modifications or change could void the user’s authority to operate the equipment.

This radio transmitter (identify the device by certification number or model number if Category II) has been approved by Industry Canada to operate with the antenna types listed below with the maximum permissible gain indicated. Antenna types not included in this list, having a gain greater than the maximum gain indicated for that type, are strictly prohibited for use with this device.

This equipment has been tested and found to comply with the limits for a Class B digital device, pursuant to part 15 of the FCC Rules. These limits are designed to provide reasonable protection against harmful interference in a residential installation. This equipment generates, uses and can radiate radio frequency energy and, if not installed and used in accordance with the instructions, may cause harmful interference to radio communications. However, there is no guarantee that interference will not occur in a particular installation. If this equipment does cause harmful interference to radio or television reception, which can be determined by turning the equipment off and on, the user is encouraged to try to correct the interference by one or more of the following measures:

- Reorient or relocate the receiving antenna.
- Increase the separation between the equipment and receiver.
- Connect the equipment into an outlet on a circuit different from that to which the receiver is connected.
- Consult the dealer or an experienced radio/TV technician for help.

The device has been evaluated to meet general RF exposure requirement.

To maintain compliance with FCC’s RF exposure guidelines, this equipment should be installed and operated with a minimum distance of 20cm between the radiator and your body.

**Documents / Resources**

	<p><b><a href="#">EBELONG ERC112 Smart Dimming Lighting Controller</a></b> [pdf] Instructions ERC112, 2AL7Q-ERC112, 2AL7QERC112, ERC112 Smart Dimming Lighting Controller, Smart Dimming Lighting Controller</p>
---	--