

**EASTERN
TABLETOP**
ST9600
Treasure
Trove
Display
Stand
Buggy Cart



EASTERN TABLETOP ST9600 Treasure Trove Display Stand Buggy Cart Instruction Manual

[Home](#) » [EASTERN TABLETOP](#) » EASTERN TABLETOP ST9600 Treasure Trove Display Stand Buggy Cart Instruction Manual 

Contents

- [1 EASTERN TABLETOP ST9600 Treasure Trove Display Stand Buggy Cart](#)
- [2 Specifications](#)
- [3 Product Usage Instructions](#)
- [4 FAQs](#)
- [5 TREASURE TROVE](#)
- [6 THE ARCH Display Stand](#)
- [7 BUGGY CART Mobile Display](#)
- [8 CONTACT INFORMATION](#)
- [9 Documents / Resources](#)
 - [9.1 References](#)
- [10 Related Posts](#)

EASTERN
TABLETOP

EASTERN TABLETOP ST9600 Treasure Trove Display Stand Buggy Cart



Specifications

- **Model:** ST9600
- **Features:**
 - 6 half shelves bagel/doughnut hooks
 - 3 shelves with railings
 - 6 wheels
 - 4 LED lights
 - 2 outlets
 - 5 drawers with 4 depth
- **Additional Information:** Panels & frames are available in a variety of finishes and XYLO color options

Product Usage Instructions

- **Assembly:**
 - Identify all components and arrange them in an organized manner.
 - Follow the provided assembly instructions carefully to put together the buffet station.
 - Ensure all parts are securely connected before use.
- **Operation:**
 - To open, unlatch the closure mechanism.
 - Utilize the shelves and drawers for displaying and storing items.
 - Make use of the outlets for powering additional equipment or appliances.
- **Maintenance:**
 - Regularly clean the station to maintain its appearance and hygiene.
 - Check and replace any faulty LED lights or outlets as needed.
 - Inspect and lubricate wheels for smooth mobility.

FAQs

- **Q: Can I customize the color of the panels and frame?**

- **A:** Yes, the panels and frame are available in a wide variety of finishes and XYLO color options to suit your preferences.

- **Q: How do I transport the buffet station?**

- **A:** The station is equipped with 6 wheels for easy mobility. Simply push or pull the station to move it to a different location.

- **Q: Are the shelves adjustable?**

- **A:** The shelves are fixed but provide ample space for displaying various items. The drawers offer flexibility in storage depth.

TREASURE TROVE

Multipurpose Station

- **MODEL #ST9600**

- **Closed:** 35 1/2" x 35 1/2" x 78 3/4"

- **Open:** 27 1/2" x 70 7/8" x 78 3/4"

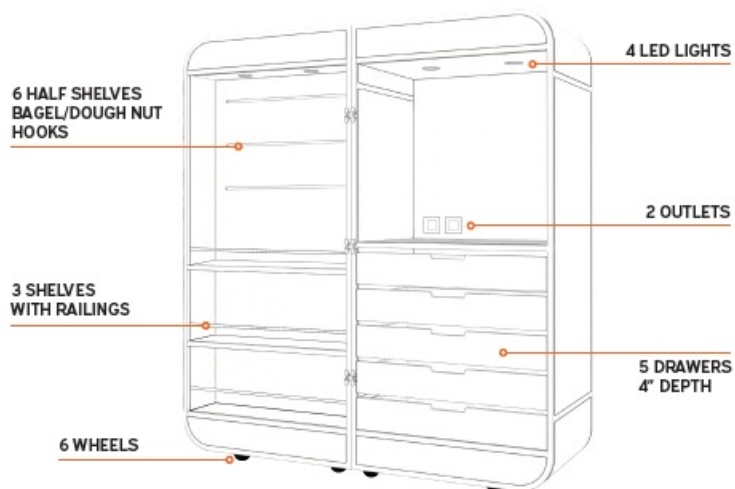

Panels & Frame are available in a wide variety of finishes and XYLO color options.





THE ARCH Display Stand

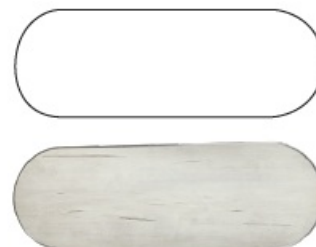

MODEL #ST4330

41" x 23" x 78 ¾"
Stainless Steel, 5 Levels



MODEL #ST4320

37" x 23" x 67 ½"
Stainless Steel, 4 Levels



MODEL #ST4310

37" x 23" x 64 ½"
Stainless Steel, 4 Levels

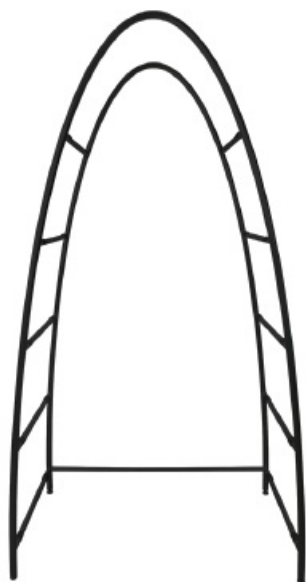

MODEL #ST4330MB

41" x 23" x 78 ¾"
Black, 5 Levels

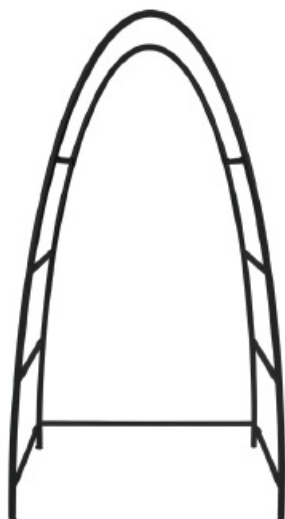

MODEL #ST4320MB

37" x 23" x 67 ½"
Black, 4 Levels

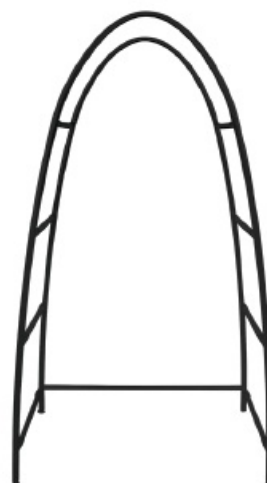

MODEL #ST4310MB

37" x 23" x 64 ½"
Black, 4 Levels





MODEL #ST4330RZ
41" x 23" x 78 ¾"
Bronze, 5 Levels

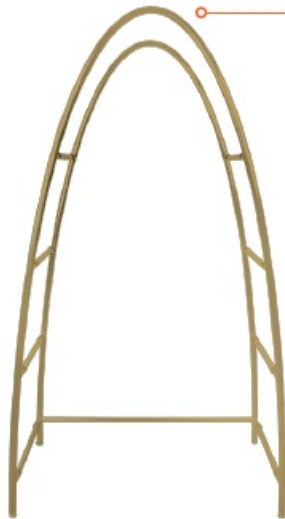

MODEL #ST4320RZ
37" x 23" x 67 ½"
Bronze, 4 Levels

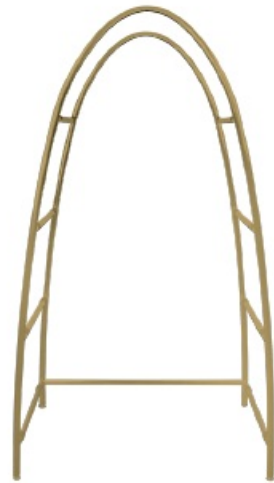

MODEL #ST4310RZ
37" x 23" x 64 ½"
Bronze, 4 Levels

XYLO POWDER
COATING
AVAILABLE

SOLID ONE PIECE
CONSTRUCTION

SHELVES
SELF-STORE
WITHIN UNIT

NESTS FOR
STORAGE

SHELVES
PROTECTED WITH
STAINLESS STEEL
EDGING

EASY TO
TRANSPORT





BUGGY CART Mobile Display

- **MODEL #BC6800**
 - BUGGY CART
- **MODEL #BC6820**
 - BUGGY CART + CANOPY + ICE CREAM TILES
 - 70 7/8" x 31 1/2" x 33 1/2" Height with canopy: 82 5/8"





CONTACT INFORMATION

- **Corporate Headquarters, Showroom & Warehouse:** Eastern Tabletop Manufacturing Company Inc. 50 Ingham Avenue Bayonne NJ 07002
- **Telephone:** 1-[718-240-9595](tel:7182409595)
- **Toll Free:** 1-[888-422-4142](tel:8884224142)
- **Email:** sales@easterntabletop.com
- **Visit** www.EasternTableTop.com. for full product details.



Documents / Resources



[EASTERN TABLETOP ST9600 Treasure Trove Display Stand Buggy Cart](#) [pdf] Instruction Manual
ST9600, ST9600 Treasure Trove Display Stand Buggy Cart, Treasure Trove Display Stand Buggy Cart, Trove Display Stand Buggy Cart, Display Stand Buggy Cart, Stand Buggy Cart, Buggy Cart, Cart

References

- [Eastern Tabletop | Chafing Dishes | Juice & Beverage Dispensers, Coffee Urns](#)
- [User Manual](#)

[Manuals+](#), [Privacy Policy](#)

This website is an independent publication and is neither affiliated with nor endorsed by any of the trademark owners. The "Bluetooth®" word mark and logos are registered trademarks owned by Bluetooth SIG, Inc. The "Wi-Fi®" word mark and logos are registered trademarks owned by the Wi-Fi Alliance. Any use of these marks on this website does not imply any affiliation with or endorsement.