



Earthquake Sound ECS 3.0 In-Ceiling Speaker User Manual

[Home](#) » [EARTHQUAKE SOUND](#) » Earthquake Sound ECS 3.0 In-Ceiling Speaker User Manual 

Contents

- 1 Earthquake Sound ECS 3.0 In-Ceiling Speaker
- 2 Introduction
- 3 Specifications
 - 3.1 MOUNTING INFORMATION
- 4 TECH SUPPORT
- 5 Features
- 6 What's In The Box?
- 7 Product Description
- 8 Product Assembly
- 9 General Warranty Information
- 10 Earthquake Sound Corporation
- 11 FAQs
- 12 Related Posts



Earthquake Sound ECS 3.0 In-Ceiling Speaker



Introduction

In the audio industry, Earthquake Sound has earned a reputation for engineering innovative and high-quality audio products. One such marvel is the Earthquake Sound ECS 3.0 In-Ceiling Speaker, a powerful full-range and Dolby Atmos compatible speaker designed to elevate your listening experience in any part of your home. With over three decades of expertise, Earthquake Sound continually exceeds consumer expectations, and this speaker is no exception.

Specifications

- **Brand:** Earthquake Sound
- **Dimensions:** 3.19 x 3.19 x 2.51 inches
- **Color:** White
- **Item Weight:** 7.68 ounces (7.7 on the product information)
- **Output Wattage:** 45.0 Watts
- **Country of Origin:** China
- **Language:** English

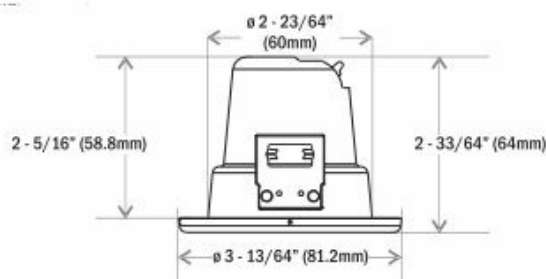

- **Nominal Impedance:** 80hm
- **Frequency Response:** 150Hz – 20kHz
- **Sensitivity:** 85 dB
- **Voice Coil Diameter:** 1" (25.2mm)

MOUNTING INFORMATION

- **Cutout Diameter:** 2 – 9/16" (65mm)
- **Mounting Depth:** 2 – 5/16" (58.8mm)
- **Weight:** 0.45 lbs (0.23 kgs)

TECH SUPPORT

- **US Toll Free:** 1-800-576-7944
- **E-mail:** tech@earthquakesound.com

Features

- **Superior Sound Quality:** The ECS 3.0 is a full-range speaker that is also Dolby Atmos compatible, making it perfect for enhancing existing surround sound systems. Its high output wattage of 45.0 Watts ensures that it can deliver robust and dynamic sound quality.
- **Versatility:** Designed to be the ideal audio solution for various settings, the ECS 3.0 is perfect for kitchens, bathrooms, and garages. Its compatibility with Dolby Atmos makes it an excellent choice for overhead home theater systems, adding a multidimensional sound field to your entertainment space.
- **Aesthetic Design:** The ECS 3.0 comes with a paintable grille and an edgeless design, allowing it to seamlessly integrate into any décor. The sleek design and white color make it a subtle yet effective addition to your interiors.
- **Easy Installation:** With easy-connect push terminals and mounting clips, installing the ECS 3.0 is a breeze. The self-enclosed design is resistant to humidity, making it a durable option for rooms with variable moisture levels.

What's In The Box?

- ECS 3.0 Speakers with Grilles (2)
- Cutout Templates (2)
- Mounting Clips (4)
- Product Installation Guide



Product Description

The Earthquake Sound ECS 3.0 In-Ceiling Speaker offers a blend of excellent sound quality, easy installation, and aesthetic design. It's the ideal choice for those who want to elevate their home audio experience without compromising on the look and feel of their living space. With Earthquake Sound's legacy of quality and innovation, you're not just buying a speaker; you're investing in a product that stands for excellence.

Benefits Over Previous Model (ACS 3.0)

The ECS 3.0 is sold by the pair and is an upgraded model from the ACS 3.0, offering better sound quality, easier installation, and a more attractive design.

Why Choose Earthquake Sound?

For over 30 years, Earthquake Sound has been a pioneer in the audio industry. Their focus on quality and innovation has led to a range of products that deliver exceptional sound. The ECS 3.0, like all Earthquake Sound products, is a result of meticulous engineering and a true dedication to audiophile standards.

Product Assembly

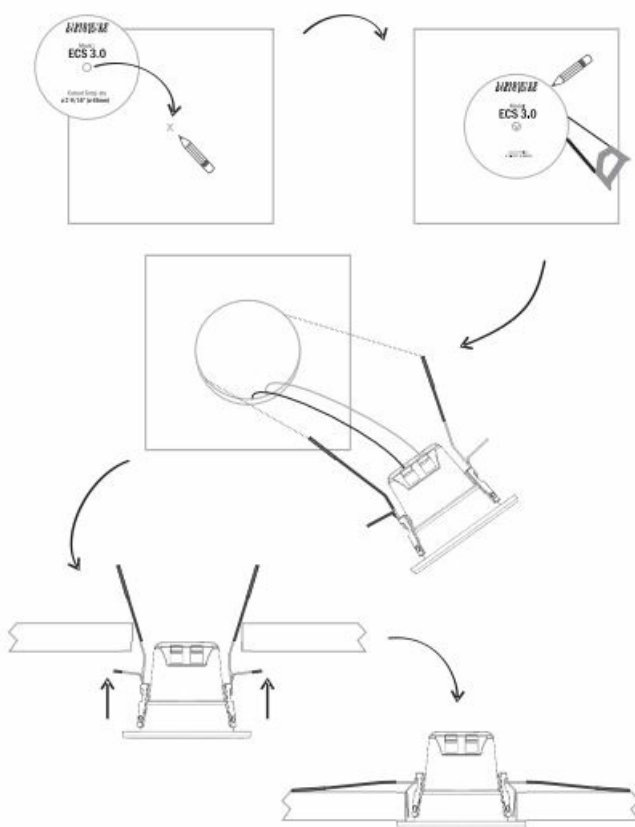

General Warranty Information

- Earthquake Sound warrants the original purchaser that all Factory Sealed New Audio Products will be free from defects in material and workmanship for one year from the date of purchase.
 - The one-year warranty period is valid only if the product is properly installed by an Earthquake-authorized party and the warranty registration card is properly filled out and sent to Earthquake Sound Corporation.
 - If the product is installed by a non-authorized party, a thirty (30) day warranty period applies.

One (1) year limited warranty guidelines:

- Earthquake pays for labor, parts, and ground freight (US mainland only) back to the customer.

Warning:

- Products sent for repair that are tested by Earthquake technicians and deemed to have no problems will not be

covered by the limited warranty.

- The customer will be charged a minimum of one hour of labor at ongoing rates plus shipping charges back to the customer.

Repair or Replacement Provisions:

- Earthquake agrees to repair or replace defective products/parts subject to the following:
 - Products/parts have not been altered or repaired other than by an Earthquake factory-approved technician.
 - Products/parts have not been subjected to negligence, misuse, improper use, or accidents.

Warranty Limitations:

- Earthquake warranty does not cover:
 - Damages to driver enclosure or finish due to misuse or abuse.
 - Bent driver frame, broken speaker connectors, holes in the grille, or burnt speaker voice coil.
 - Damage from improper exposure to elements or from other products.
- A warranty claim is not valid if the warranty registration card is not properly filled and returned with a copy of the sales invoice.

Service Request:

- Contact Earthquake Sound's service department at (510) 732-1000 for an RMA (Return Material Authorization) number.
 - Make sure to provide a complete shipping address, valid phone number, and description of the problem.

Shipping Instructions:

- The product must be packaged in its original protective boxes to minimize transport damage.
- Shipper claims regarding items damaged in transit must be presented to the carrier.
- An original sales receipt must accompany the product returned for service.

Dispute Resolution:

- All disputes must be resolved according to the laws and regulations of the county of Alameda, California.

By carefully reading and adhering to these guidelines, you can ensure you are fully aware of your warranty coverage and how to go about making a warranty claim or service request.

Earthquake Sound Corporation

- 2727 McCone Avenue. Hayward, CA 94545.USA
- **US Toll-Free:** 1-800-576-7944 |
- **Tel:** 510-732-1000 | **Fax:** 510-732-1095
- www.earthquakesound.com

- tech@earthquakesound.com

FAQs

What are the dimensions of the Earthquake Sound ECS 3.0 In-Ceiling Speaker?

The dimensions of the speaker are 3.19 x 3.19 x 2.51 inches.

What is the output wattage of the ECS 3.0 speaker?

The output wattage of the ECS 3.0 speaker is 45.0 Watts.

Is the ECS 3.0 speaker compatible with Dolby Atmos?

Yes, the ECS 3.0 speaker is Dolby Atmos compatible.

Can the ECS 3.0 speaker be used in kitchens, bathrooms, and garages?

Yes, the ECS 3.0 speaker is designed to be the ideal audio solution for various settings, including kitchens, bathrooms, and garages.

Is the ECS 3.0 speaker easy to install?

Yes, the ECS 3.0 speaker comes with easy-connect push terminals and mounting clips, making installation a breeze.

Does the ECS 3.0 speaker come with a warranty?

Yes, Earthquake Sound offers a one-year limited warranty for the ECS 3.0 speaker.

How can I contact Earthquake Sound's tech support?

You can contact Earthquake Sound's tech support by calling their US Toll-Free number at 1-800-576-7944.

What is the weight of the ECS 3.0 speaker?

The weight of the ECS 3.0 speaker is 7.68 ounces (7.7 ounces according to the product information).

What is the frequency response of the ECS 3.0 speaker?

The frequency response of the ECS 3.0 speaker is 150Hz - 20kHz.

What is the sensitivity of the ECS 3.0 speaker?

The sensitivity of the ECS 3.0 speaker is 85 dB.

Where is the Earthquake Sound ECS 3.0 speaker manufactured?

The Earthquake Sound ECS 3.0 speaker is manufactured in China.

Can the ECS 3.0 speaker be painted to match the decor?

Yes, the ECS 3.0 speaker comes with a paintable grille, allowing it to seamlessly integrate into any decor.

Download This PDF Link: [Earthquake Sound ECS 3.0 In-Ceiling Speaker User Manual](#)