

Earda Technologies 10TBBVBA Smart Button Instruction Manual

[Home](#) » [Earda Technologies](#) » Earda Technologies 10TBBVBA Smart Button Instruction Manual 

Earda Technologies 10TBBVBA Smart Button

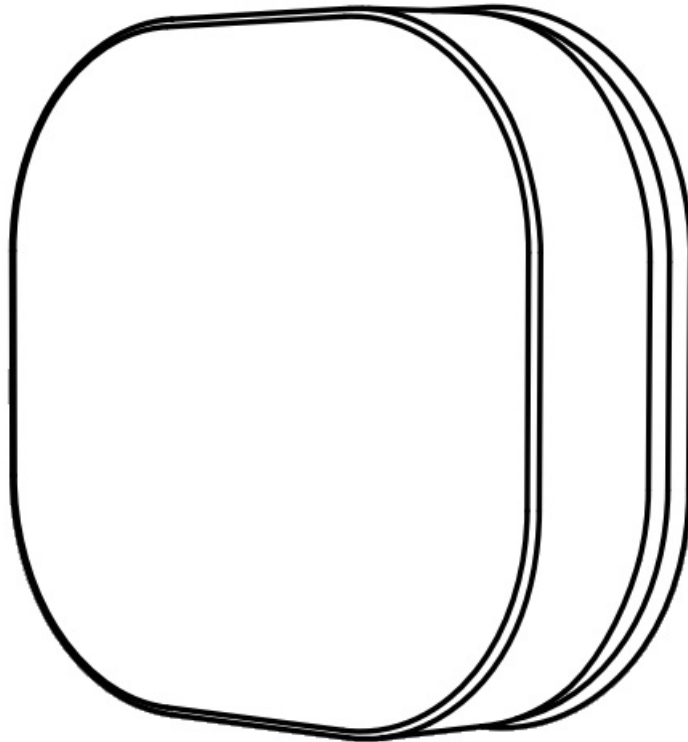

Contents

- 1 Dimension
- 2 Specification
- 3 Install the battery / Reset / Pairing
- 4 Connet to Network
- 5 Add Device
 - 5.1 Add Device
 - 5.2 Remote mode (Default mode)
 - 5.3 Remote mode
 - 5.4 Mode swap
 - 5.5 Scene mode
 - 5.6 FCC Warning
- 6 Documents / Resources
- 7 Related Posts

Dimension

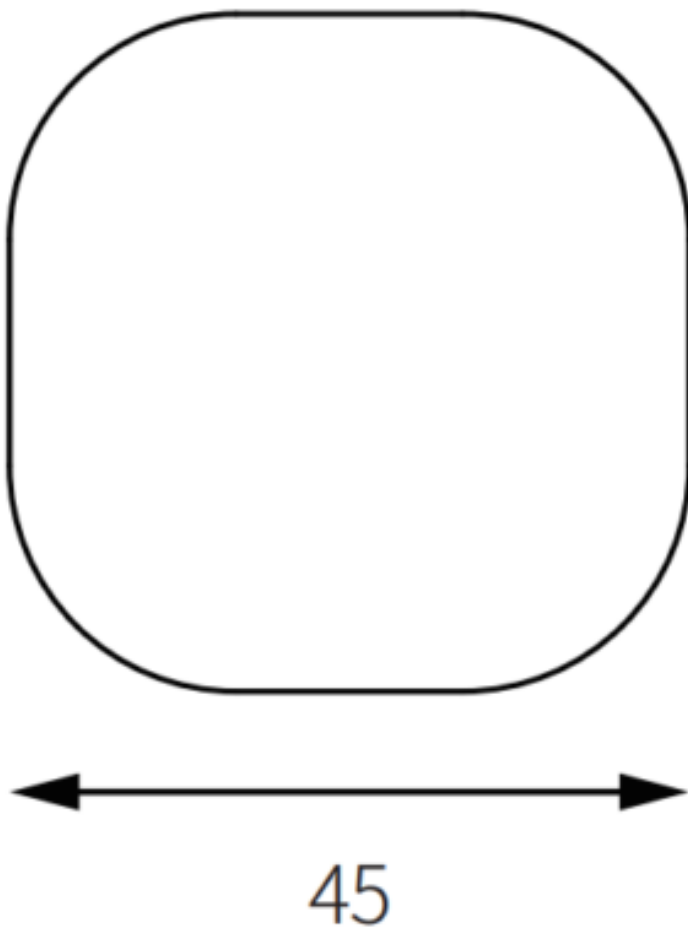

Specification

Power supply:	Battery CR2032 3V DC
Communication:	ZigBee 3.0* Bluetooth Low Energy*
Control distance:	25m open area
Ingress Protection:	IP55
Dimensions:	45 X 45 X 12.5mm
Operating temperature:	-10 °C~45 °C
Working Humidity:	<90%RH
Life of battery	1 years (General use)

Install the battery / Reset / Pairing

1. Remove the screw

2. Install the CR2032 battery

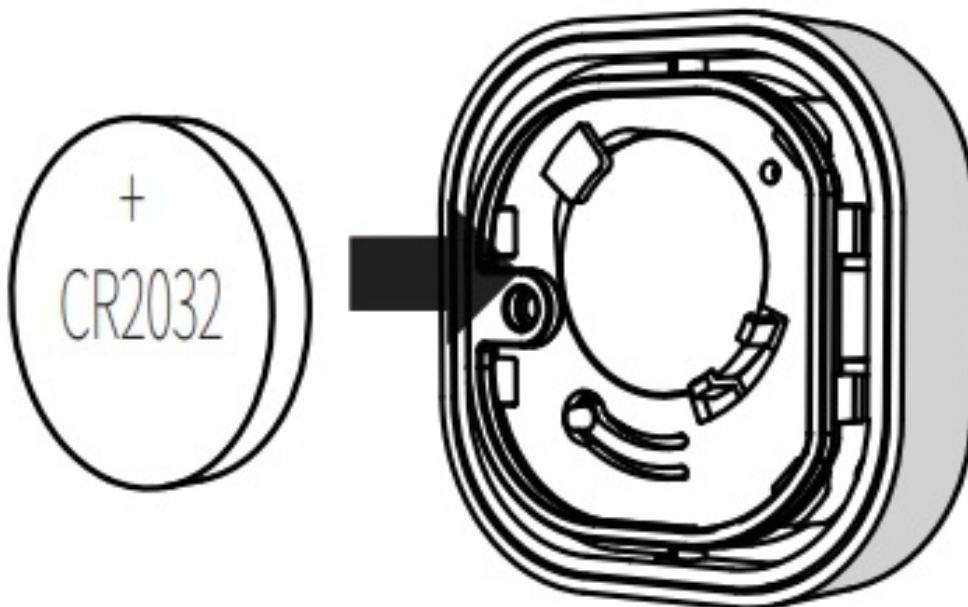

3. Hold "RESET" to 6s, LED will start flashing

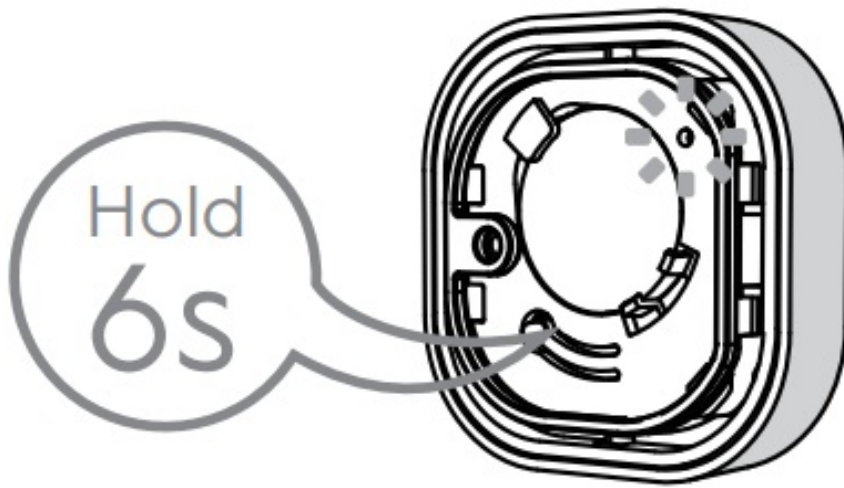

4. Install the cover

Connet to Network

Scan the QR code to download APP



Gateway is required to connect device

Add Device

ZigBee model

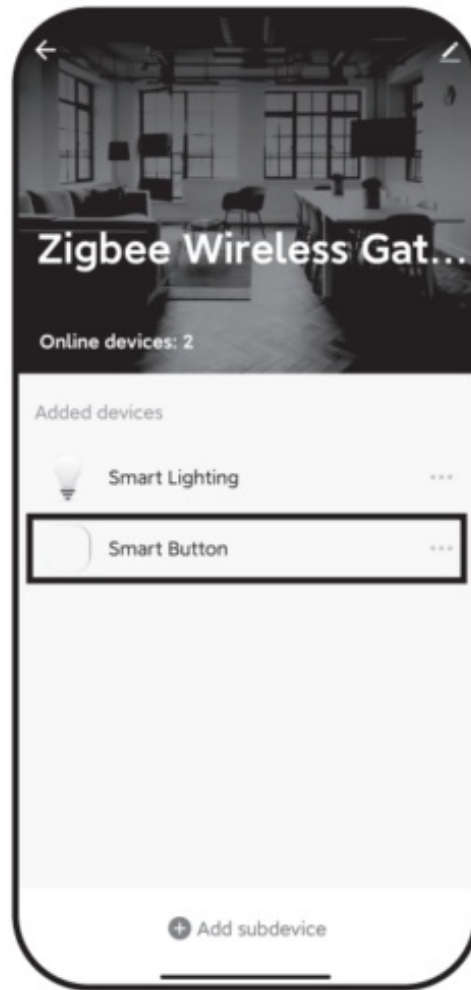
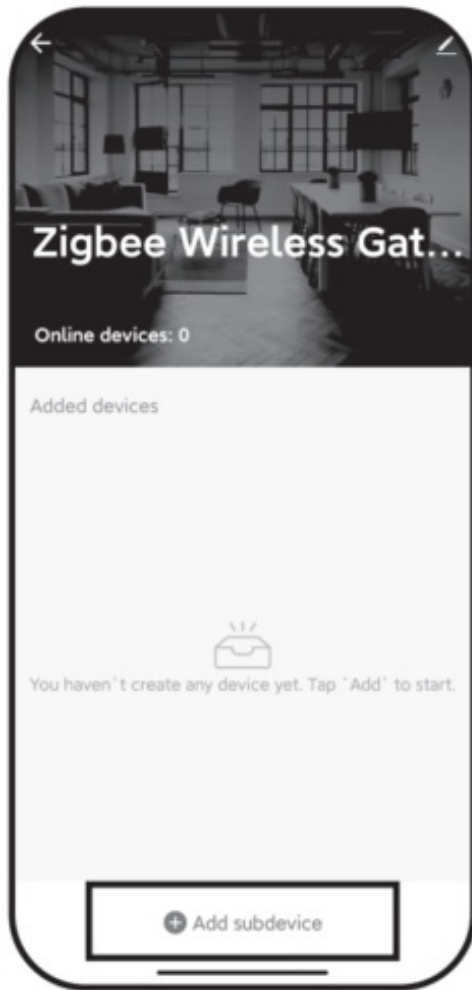

Add Device

Bluetooth model



Remote mode (Default mode)

ZigBee model Only



Remote mode



UI or functions may change according to firmware or APP version

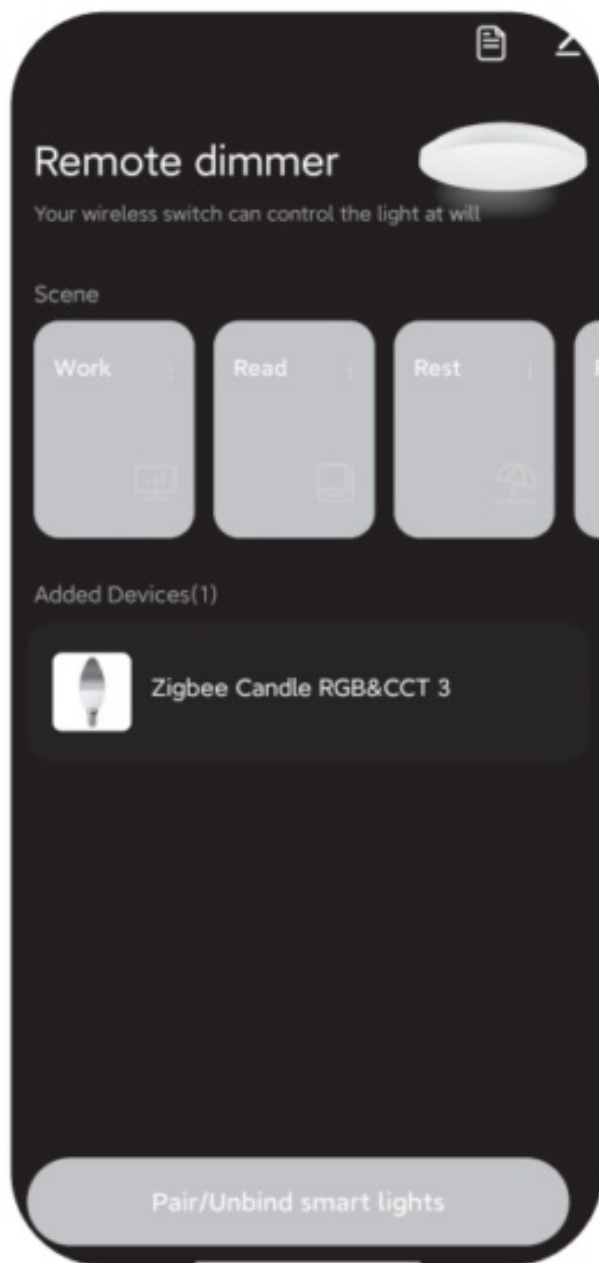

B. Control description under remote mode

	<p>Single Press On</p>
	<p>Dual Press Of</p>
	<p>Single Press Change preset light mode when light up</p>
	<p>Long Press >3s Dimming</p>

Note: The above functions may be different depending on the model of the smart bulb

Mode swap



Remote
mode



Scene
mode

Scene mode

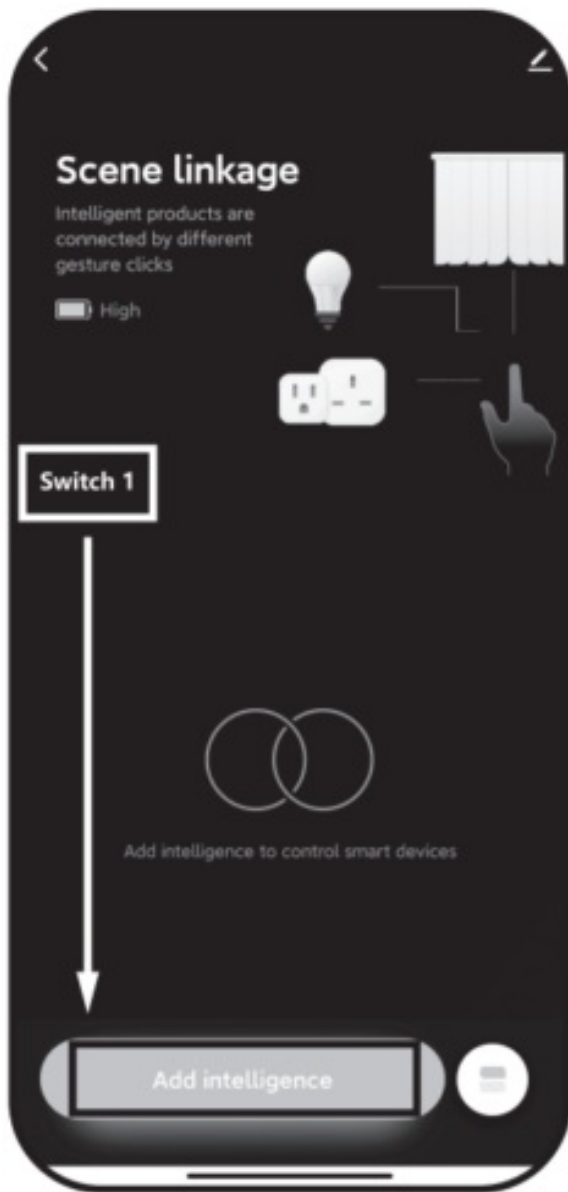



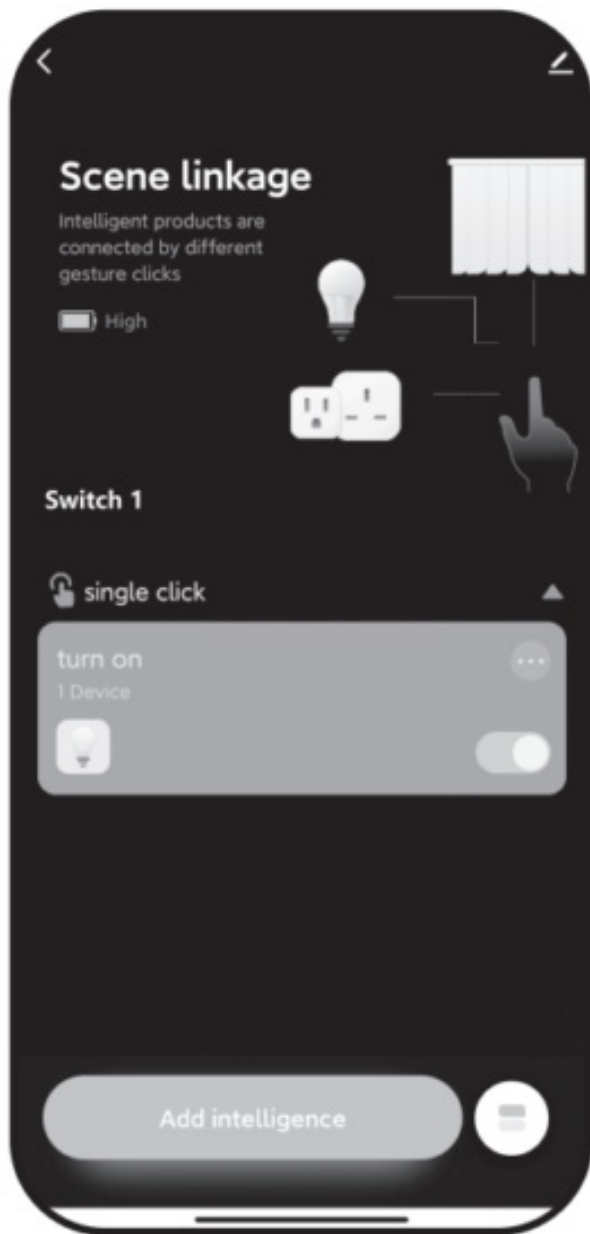

FCC Warning

This device complies with part 15 of the FCC Rules. Operation is subject to the following two conditions: (1) This device may not cause harmful interference, and (2) this device must accept any interference received, including interference that may cause undesired operation.

Note: This equipment has been tested and found to comply with the limits for a Class B digital device, pursuant to part 15 of the FCC Rules. These limits are designed to provide reasonable protection against harmful interference in a residential installation. This equipment generates, uses and can radiate radio frequency energy and, if not installed and used in accordance with the instructions, may cause harmful interference to radio communications. However, there is no guarantee that interference will not occur in a particular installation. If this equipment does cause harmful interference to radio or television reception, which can be determined by turning the equipment off and on, the user is encouraged to try to correct the interference by one or more of the following measures:

- Reorient or relocate the receiving antenna.
- Increase the separation between the equipment and receiver.
- Connect the equipment into an outlet on a circuit different from that to which the receiver is connected.
- Consult the dealer or an experienced radio/TV technician for help.

Note: The Grantee is not responsible for any changes or modifications not expressly approved by the party

responsible for compliance. such modifications could void the user’s authority to operate the equipment. The device has been evaluated to meet general RF exposure requirement.

To maintain compliance with FCC’s RF exposure guidelines, the distance must be at least 20 cm between the radiator and your body, and fully supported by the operating and installation configurations of the transmitter and its antenna(s).

Documents / Resources

	Earda Technologies 10TBBVBA Smart Button [pdf] Instruction Manual 10TBBVBA, 2AMM6-10TBBVBA, 2AMM610TBBVBA, 10TBBVBA Smart Button, 10TBBVBA, Smart Button
---	---

[Manuals+.](#)