

**EAPUDUN**

FMA1138-FBDT  
CEILING LIGHT



## EAPUDUN FMA1138-FBDT Ceiling Light Installation Instructions

[Home](#) » [EAPUDUN](#) » EAPUDUN FMA1138-FBDT Ceiling Light Installation Instructions 

### Contents

- [1 EAPUDUN FMA1138-FBDT Ceiling Light](#)
- [2 INTRODUCTION](#)
- [3 FEATURES](#)
- [4 SETUP GUIDE](#)
- [5 CARE & MAINTENANCE](#)
- [6 TROUBLESHOOTING](#)
- [7 PROS & CONS](#)
- [8 WARRANTY](#)
- [9 FREQUENTLY ASKED QUESTIONS](#)
- [10 VIDEO – PRODUCT OVERVIEW](#)
- [11 References](#)
- [12 Related Posts](#)

# EAPUDUN

**EAPUDUN FMA1138-FBDT Ceiling Light**



## INTRODUCTION

The EAPUDUN FMA1138-FBDT Ceiling Light is a beautiful light fixture that combines old-fashioned style with modern convenience. This ceiling light has Edison bulbs, incandescent bulbs, CFLs, and LED bulbs in it, so it can match a wide range of interior styles. It also has different lighting choices for each room. With a 26.67 lm/W rate and an amazing 1600 lumens of brightness, it gives off plenty of light while being energy-efficient. The light fixture is hardwired to make sure the link is safe and stable. It runs on 110–120V AC. When it came out on June 24, 2020, the EAPUDUN FMA1138-FBDT, which cost \$44.64, was a great deal because of its stylish style and energy-saving features. An app controls the product and makes it easy for users to change settings and brightness. It's perfect for bathrooms, kitchens, or living rooms because it's small (13 x 13 x 4.6 inches) and has a modern look.

**CAUTION:** Read instructions carefully and turn the electricity off at the main circuit breaker panel before beginning installation.

- **WARNING** – If any Special Control Devices are used with this Fixture, Follow the instructions carefully to ensure full compliance with N.E.C. requirements. If there are any questions, contact a Qualified Electrical Contractor.
- **WARNING** – This product contains chemicals known to the State of California to cause cancer, birth defects and /or other reproductive harm. Thoroughly wash hands after installing, handling, cleaning, or otherwise touching this product
- **CAUTION** – All glass is fragile, use care when handling Glass component(s) and or Lamp(S).

**CUSTOMER SERVICE TEAM:** [eapudun\\_service@outlook.com](mailto:eapudun_service@outlook.com)

FMA1138-FBDT

## CANOPY MOUNTING & WIRE CONNECTION ASSEMBLY STEPS:

1. E.C —————> J

- 2. H.I → D
- 3. A.B → C

I.J(Wire and Mounting Box Not Included)

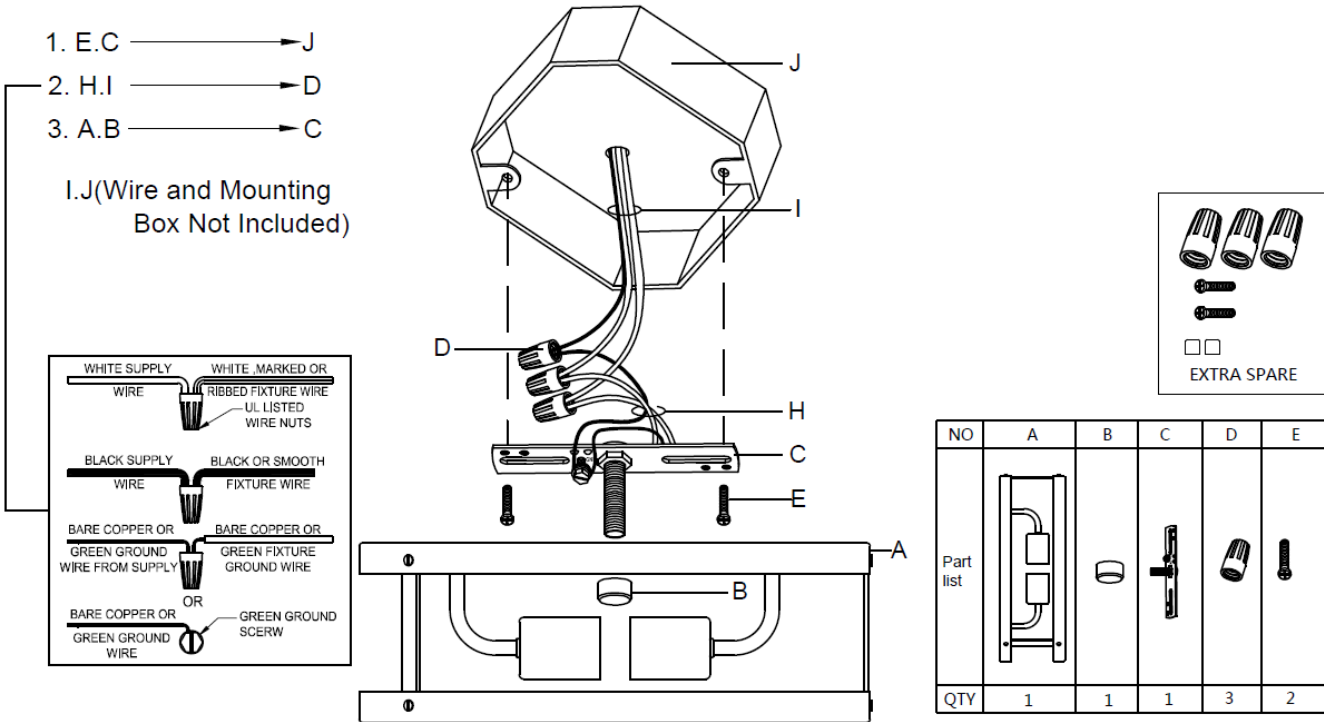

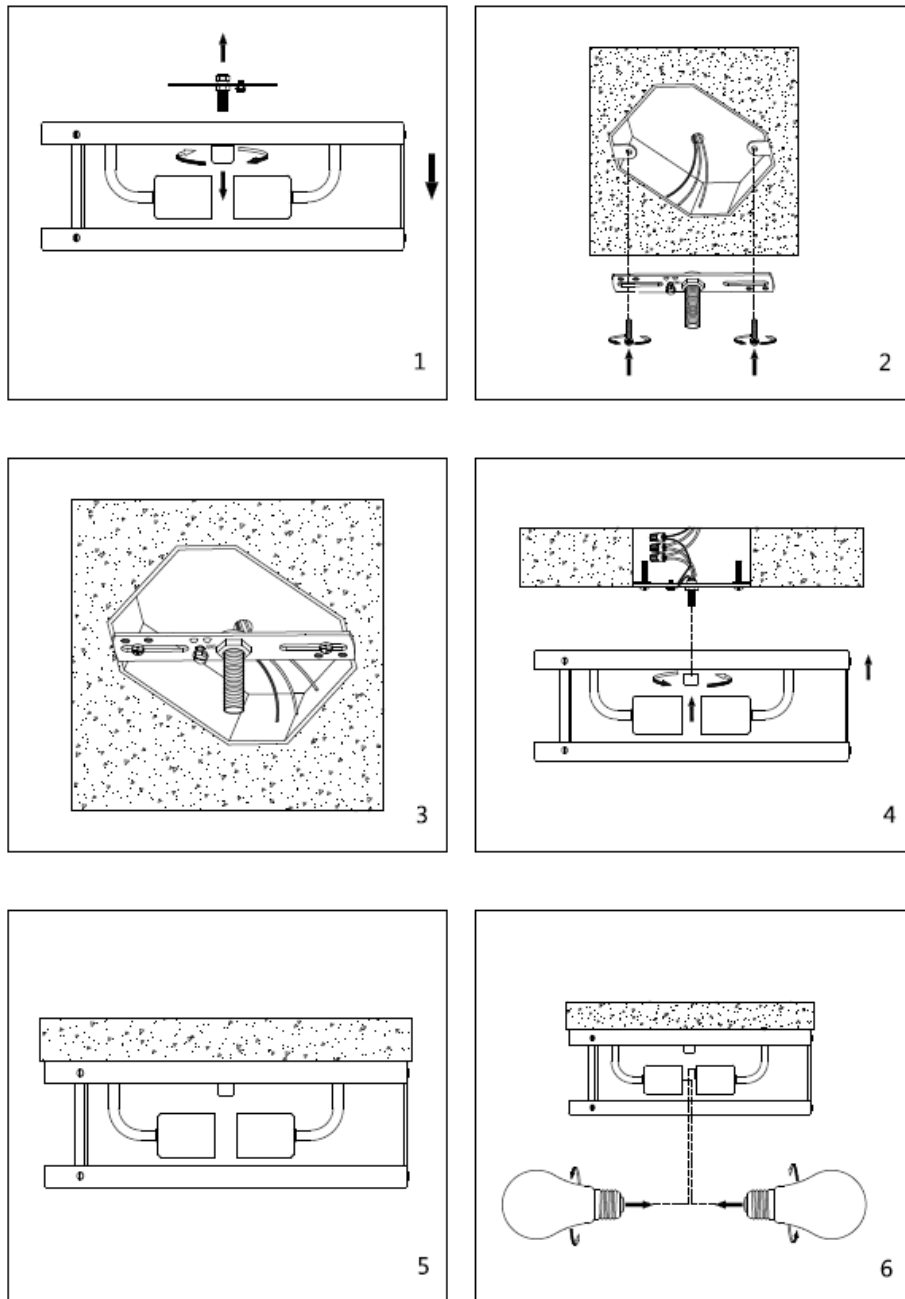

## FEATURES

- **Unique Dual Lamp Head Design**: The unique double lamp head design gives you a new way to look at things and better lighting effects, making this light fixture stand out from others in terms of both style and function.
- **Rustic and Modern Design**: The light has both an old-fashioned country look and an industrial charm. The use of fake wood and a metal frame makes it both durable and stylish, while still having a classic look.
- **Materials of High Quality**: The light is made from materials of high quality that won't fade, rust, or corrode, so it will stay in great shape for a long time.
- **Lighting that uses less energy**: Works with different kinds of lights, like Edison bulbs, incandescent bulbs, CFLs, and LEDs. The LED way of lighting saves energy and lasts a long time.
- **Dimmable Compatibility**: The ceiling light works with dimmable E26 base bulbs, so you can change how bright the light is and make the right atmosphere for different places.
- **Options for a Wide Range of Bulbs**: This light fixture works with many E26 base bulbs, so you can pick bulbs with various color temperatures to create the mood you want.
- **Beautiful Lighting**: The unique design of the two lamp heads makes the lighting effects better, making it great

for making any room feel cozy or dramatic.

- **The right size for a variety of rooms**: This ceiling light, which is 13" L x 4.5" H, can be used in many places, like the hallway, bedroom, kitchen, or living room.
- **Easy to Install**: The fixture comes with all the fastening hardware it needs, and it's easy enough for one person to do. You can use your new light right away because it's easy to set up.
- **UL Certified for Safety**: This light fixture meets the strict requirements set by UL, which means it is safe to use in both homes and businesses.
- **Broad Use**: The ceiling light can be used in many places, including bedrooms, kitchens, dining rooms, living rooms, halls, entryways, and even balconies or foyers.
- **Adjustable Ambiance**: The E26 base lets you try out different lights and color temperatures, so you can make the perfect lighting for any event, whether you want it to be bright and useful or warm and cozy.
- **Affordable Price**: This ceiling light, which costs \$44.64, is a great deal for the quality, style, and versatility it offers. It is a cheap way to light up any home.
- **Efficient Brightness**: This ceiling light has a brightness output of 1600 lumens and an efficiency of 26.67 lm/W, so it gives off a lot of light while using little energy.

## SETUP GUIDE

- **Unbox and Check**: Carefully take the light fixture out of its box and make sure that all of its parts are whole and undamaged. This includes the mounting tools and lamp heads.
- **Pick out the Installation Location**: Pick a spot on the ceiling that has good lighting and goes with the style of the room. Think about places like the living room, bedroom, or hallway.
- **Prepare the roof**: Make sure there is nothing on the roof and that it is clean. Make sure the surface you're putting the fixture on is stable enough to hold its weight.
- **Install the Mounting Bracket**: Use the screws that come with the mounting bracket to attach it to the ceiling. Make sure the bracket is level and the screws are tight.
- **Connect the Wiring**: Join the power lines from the light fixture to the electrical wiring in the ceiling. To keep the links safe, use wire nuts and follow standard wiring practices.
- **Put the Light Fixture on**: Once the wiring is done, carefully put the light fixture on the bracket that was attached and tighten any screws that are there to keep it in place.
- **Install the lights**: Put in E26 base lights that work with the fixture and can handle up to 60W of power. Pick bulbs that give off the effect you want, whether you want ones that can be dimmed or ones that can't.
- **Check the Wiring and Connections**: Look over the wiring again to make sure all the connections are tight and there are no wires that are loose or sticking out. For electricity safety, safety first.
- **Test the Light**: Check the Light: Turn on the power and make sure the light works right. Check to see if the bulb is blinking or not working right.
- **Change the Position**: If you need to, you can change the fixture's position to make sure it hangs straight and gives the room even lighting.
- **Install a Dimmer**: If you want to change how bright the lights are, you might want to install a dimmer switch that works with your lights. This makes the light source more useful and flexible.
- **Clean Up**: Once the fixture is safely in place and working properly, clean up any dust or other debris that was left over from the installation.
- **Make sure it's safe**: Before you use the light often, make sure the fixture is fixed correctly and the electrical connections are tight.

- **Try Out Different Bulbs:** Play around with different types of E26 bulbs to make different lighting effects and moods, from bright and useful to soft and cozy.
- **Take Advantage of the New Light:** Once the EAPUDUN FMA1138-FBDT ceiling light is set up, you can enjoy its warm and welcoming glow.

## CARE & MAINTENANCE

- **Frequent Dusting:** Use a soft cloth or microfiber duster to dust the device often to keep it looking nice and prevent dust buildup.
- **Clean the Bulbs:** Wipe the bulbs down with a soft cloth every so often to get rid of dust and fingerprints and keep the light clear and bright.
- **Do Not Use Abrasive Cleaners:** Do not use rough or strong cleaners that could damage the finish. To keep the materials safe, only use a damp cloth to clean them.
- **Check the Wiring:** Make sure there are no frayed or uncovered wires or other signs of wear on the wiring by checking it often. If you see any damage, you should call a skilled electrician.
- **Replace Burned-Out lights:** Immediately replace any burned-out lights to keep the fixture working well and keep the electrical parts from being overworked.
- **Avoid Water:** To keep the fixture from rusting and electrical damage, make sure it doesn't get wet or have too much wetness on it.
- **Tighten Loose Screws:** Check for loose screws and links often. Tighten any parts that need it to make sure the fixture stays fixed to the ceiling.
- **Check for Flickering:** If the light flickers or dims without warning, make sure the wires and bulb are working right. If needed, change the lights or make changes to the connections.
- **Protect from Physical Damage:** Do not hit or bump the light fixture. Doing so could damage the frame or bulbs, which could cause them to stop working.
- **Clean the Metal Frame:** Use a soft cloth to gently clean the metal frame to keep it looking good. Do not use rough materials that could scratch or damage the surface.
- **Avoid Too Much Heat:** Keep the light fixture away from sources of high heat, as this can damage it and shorten its life.
- **Use Energy-Efficient lights:** Choose energy-efficient LED lights that work with an E26 base to save money on energy costs and get good performance over time.
- **As Needed:** If the light bulb starts to hang unevenly over time, carefully move it to make sure it stays in place and gives off even light.
- **Regularly Check for Rust:** Look at the metal frame for any signs of rust. If you find rust, clean it off with a rust remover and think about changing any parts that are corroded.

## TROUBLESHOOTING

Issue	Possible Cause	Solution
Light not turning on	Power connection or wiring issue	Check wiring connections and ensure power supply
Flickering light	Bulb not properly installed or malfunction	Reinstall the bulb or replace it with a new one
Light is too dim	Wrong wattage bulb or faulty bulb	Ensure correct bulb type and wattage compatibility
Light does not respond to app	App connectivity or setup issue	Reconnect the light to the app or reset the app
Light is overheating	Poor ventilation or incorrect wattage	Ensure adequate airflow and use compatible bulbs
Light output uneven	Bulb or fixture defect	Replace faulty bulb or inspect fixture connections
Controller unresponsive	Power or signal interruption	Restart the controller or check the app connection
Light turns off unexpectedly	Power surge or overheating protection	Wait for light to cool down and check the power supply
Light color temperature inconsistent	Bulb compatibility issue	Use uniform bulbs (LED, Edison, etc.)
Loud noise from the fixture	Loose wiring or faulty components	Tighten connections and check for any component damage

## PROS & CONS

### PROS

1. Versatile compatibility with Edison, incandescent, CFL, and LED bulbs.
2. 1600 lumens of brightness, perfect for illuminating medium to large spaces.
3. Energy-efficient with a high lumen per watt rate (26.67 lm/W).
4. The app-controlled feature offers ease of use and convenience.
5. Affordable pricing makes it a cost-effective lighting solution.

### CONS

1. Hardwired installation may require professional help.
2. Limited to spaces with compatible wiring setups.
3. Bulb replacement may be necessary if using non-LED options.
4. Brightness may not be sufficient for very large rooms.
5. The app-controlled feature may not be compatible with all devices

### WARRANTY

The EAPUDUN FMA1138-FBDT Ceiling Light comes with a **1-year limited warranty**, covering defects in materials and workmanship. The warranty ensures that any faulty product will be repaired or replaced at no extra cost within

the first year of purchase. It's highly recommended to register your product after purchase for warranty activation. Always retain your proof of purchase for warranty claims. This warranty excludes damage caused by misuse, accidents, or improper installation. Please refer to the manufacturer's policy for more details on terms and conditions.

## FREQUENTLY ASKED QUESTIONS

What is the EAPUDUN FMA1138-FBDT Ceiling Light?

The EAPUDUN FMA1138-FBDT Ceiling Light is a modern and versatile lighting fixture designed to provide efficient illumination. It supports a variety of bulb types, including Edison bulbs, incandescent bulbs, CFLs, and LED bulbs, with a brightness of 1600 lumens.

What is the price of the EAPUDUN FMA1138-FBDT Ceiling Light?

The EAPUDUN FMA1138-FBDT Ceiling Light is priced at \$44.64, making it a budget-friendly option for adding stylish and functional lighting to any room.

What is the power source for the EAPUDUN FMA1138-FBDT Ceiling Light?

The EAPUDUN FMA1138-FBDT Ceiling Light is powered by 110-120V AC and is hardwired for secure and reliable installation.

How can the EAPUDUN FMA1138-FBDT Ceiling Light be controlled?

The EAPUDUN FMA1138-FBDT Ceiling Light can be controlled via an app, providing convenient smart home integration for adjusting lighting settings remotely.

What light sources are compatible with the EAPUDUN FMA1138-FBDT Ceiling Light?

The EAPUDUN FMA1138-FBDT Ceiling Light is compatible with Edison bulbs, incandescent bulbs, CFLs, and LED bulbs, allowing you to choose the light source that best suits your needs and style preferences.

What is the voltage requirement for the EAPUDUN FMA1138-FBDT Ceiling Light?



The EAPUDUN FMA1138-FBDT Ceiling Light operates on 120 volts, which is typical for most household lighting systems in the U.S.

What is the wattage of the EAPUDUN FMA1138-FBDT Ceiling Light?

The EAPUDUN FMA1138-FBDT Ceiling Light has a 60-watt wattage, providing sufficient lighting for most medium-sized rooms.

What is the brightness of the EAPUDUN FMA1138-FBDT Ceiling Light?

The EAPUDUN FMA1138-FBDT Ceiling Light offers a 1600-lumen brightness, delivering bright and efficient light for various home spaces.

**VIDEO – PRODUCT OVERVIEW**



**DOWNLOAD THE PDF LINK:** [EAPUDUN FMA1138-FBDT Ceiling Light Installation Instructions](#)  
[Ceiling-Light-Installation-Instructions.mp4](#)

**REFERENCE:** [EAPUDUN FMA1138-FBDT Ceiling Light Installation Instructions-Device.Report](#)

**References**

- [User Manual](#)

[Manuals+](#), [Privacy Policy](#)

This website is an independent publication and is neither affiliated with nor endorsed by any of the trademark owners. The "Bluetooth®" word mark and logos are registered trademarks owned by Bluetooth SIG, Inc. The "Wi-Fi®" word mark and logos are registered trademarks owned by the Wi-Fi Alliance. Any use of these marks on this website does not imply any affiliation with or endorsement.