



Eachine E120 Axis Flybarless Scale RC Helicopter User Manual

[Home](#) » [Eachine](#) » Eachine E120 Axis Flybarless Scale RC Helicopter User Manual 



User Manual
E12

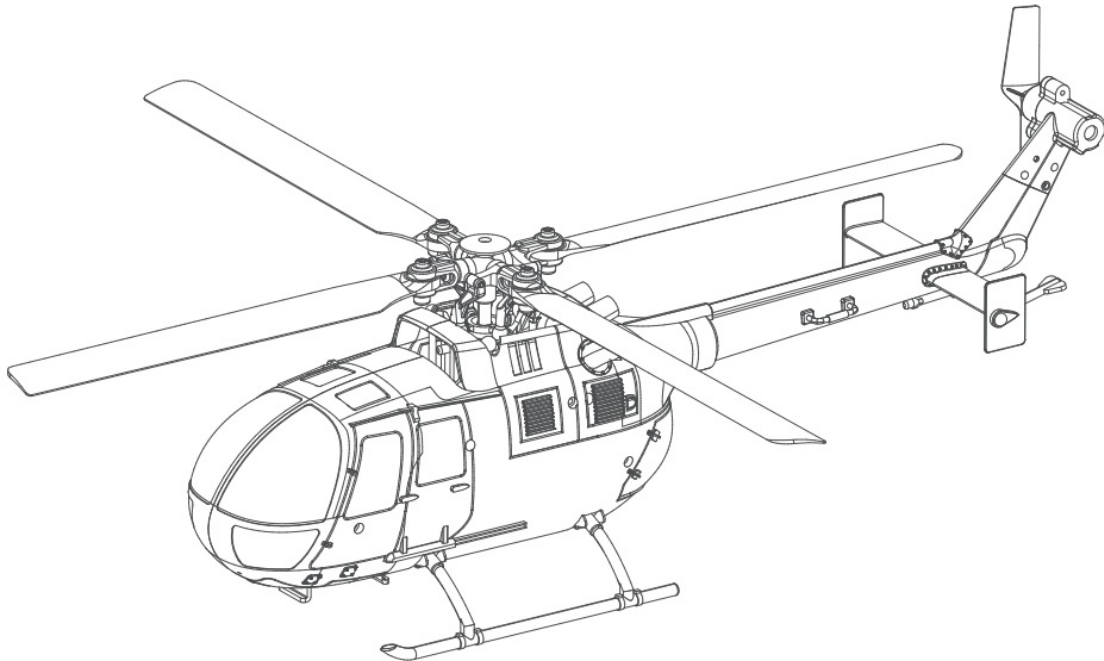

Contents

- [1 Important Note](#)
- [2 Helicopter parameter](#)
- [3 Introduction of transmitter function](#)
- [4 Batteries Charging Method](#)
- [5 Installation method of remote controller battery](#)
- [6 Commonly used parts replacement instructions](#)
- [7 Abnormal Problem Solving Method](#)
- [8 Documents / Resources](#)
- [9 Related Posts](#)

Important Note

Please read the manual to learn the function of this product before operation.

Damage to the product and potential personal injury may occur if you make an operational error.

This is an RC helicopter, not a toy. You should not only have a prudent operation but also have an operational basis. All children using it should be under adult supervision. The manual includes safety, operation, and maintenance. In order to avoid causing damage or serious injury, please obey the instructions and warnings before you using this product

Additional Safety Precautions And Warnings

1. Recommended age of users: Not suitable for children under 14 years old.
2. Operate it in an open space, away from the traffic and people.
3. Obey the instructions and warnings, including the use of optional equipment.
4. It has to stay away from chemicals. Small parts and electric equipment must be out of the reach of children.
5. Keep away from water because this product has no waterproof function.
6. Do not put any parts in the mouth, it will cause injury or death.
7. Don't operate the model if the transmitter's battery is in low voltage.
8. Don't view the beam of the light-emitting diodes, it would effect the eyesight.
9. The motor and electrical equipment will be heated after flight. Please do not touch them to avoid scalding.
10. In order to avoid causing damage, please do not touch the high-speed

Warning And The Guide Of Using Batter



Note: Using the original factory USB charger can ensure charging safety. Suggest you use the original factory USB charger part, other chargers may cause battery damage and property damage.

Warnings! The battery will fire, explode or leak if not strictly observing this item described below. :

1. Do not immerse the battery in water or seawater, and keep the battery in a cool dry environment during a stand-by period.
2. Keep all batteries out of the reach of little children. Consult a doctor immediately if a battery is swallowed.
3. Do not use or leave the battery near a heat source such as a fire or heater.
4. Use the battery charger specifically for that purpose when recharging.
5. Do not reverse the positive (+) and negative (-) terminals.
6. Do not connect the battery to an electrical outlet.
7. Do not dispose of the battery in fire or heat.
8. Do not short-circuit the battery by directly connecting the positive (+) and negative (-) terminals with metal objects such as a wire.
9. Do not transport or store the battery together with metal objects such as necklaces, hairpins etc.
10. Do not strike or throw the battery against a hard surface.
11. Do not directly solder the battery.
12. Do not unpack the battery with a nail or other sharp object.
13. Never disassemble the battery in any way.

Note: The battery can not be placed for a long time under full power and low power.

Otherwise, the battery will not be charged or the battery will be wrapped. For long-term storage, please charge the battery to 3.7V and store it in a dry and safe place

Helicopter parameter

Length	235 mm
Height	80 mm
Weight	95G
Propeller Length	256 mm
Battery Specification	350mAh
Flight Time	About 15 min
Main Motor	1020
Tail Motor	720
Charge Time	About 60 min

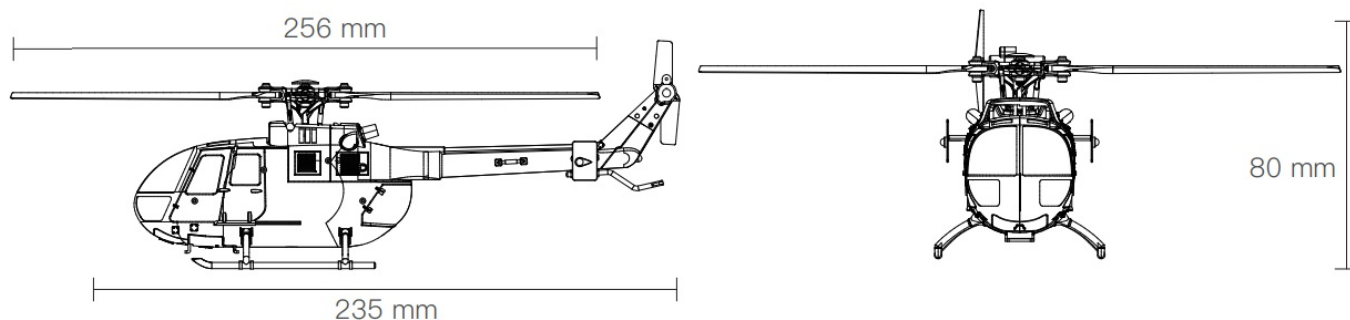

Packaging List

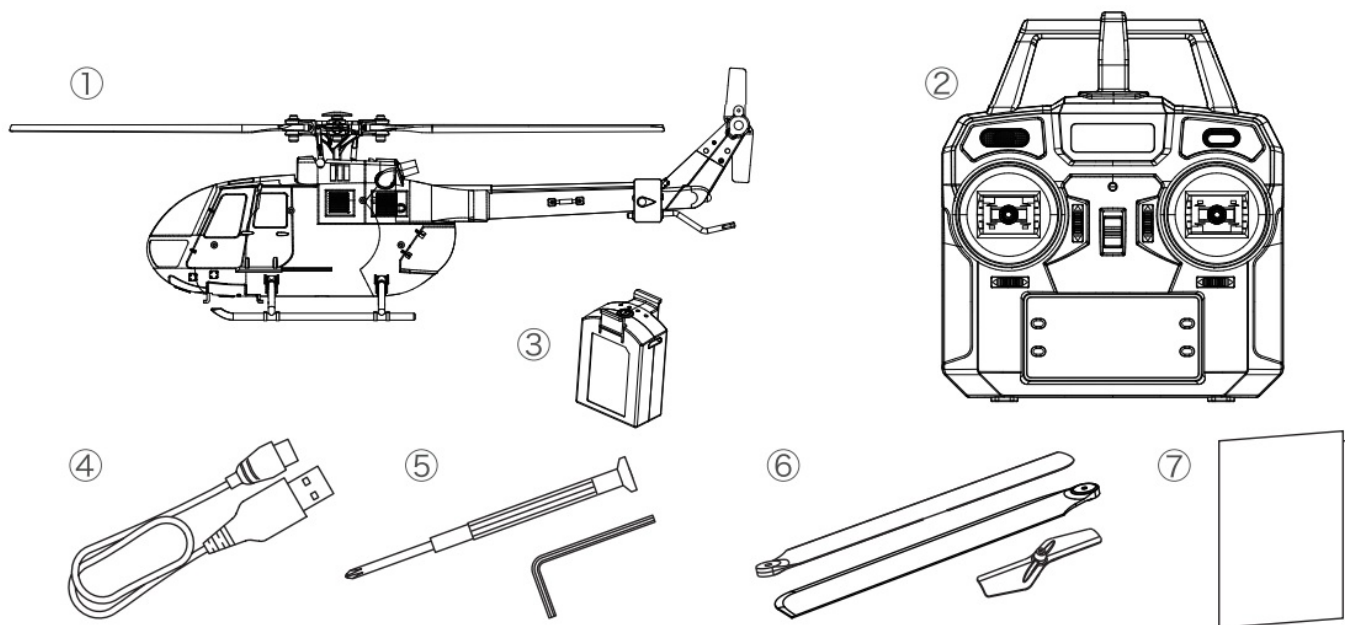

Remote Control
Helicopter
Phillips screwdriver+hex wrench

Lipo battery
USB charger
Instruction manual
Upper connecting rod /Prop

Introduction of transmitter function

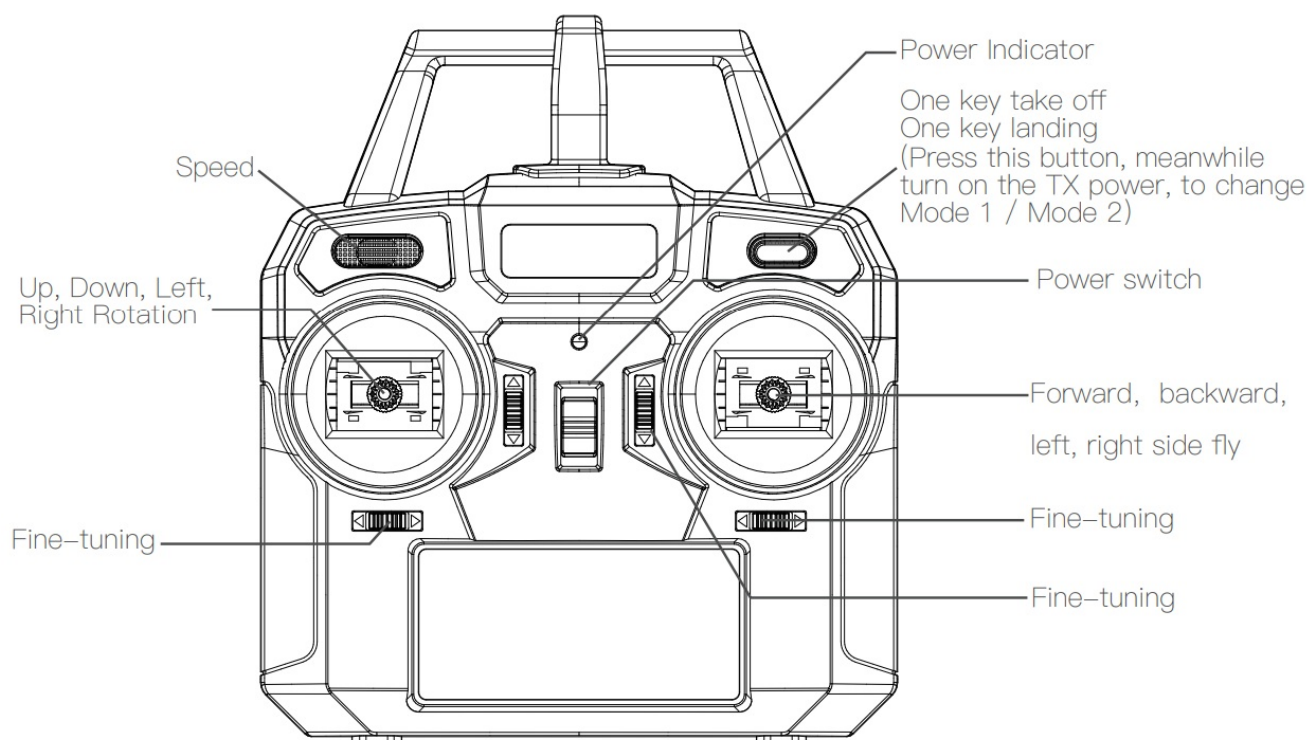

PARTS

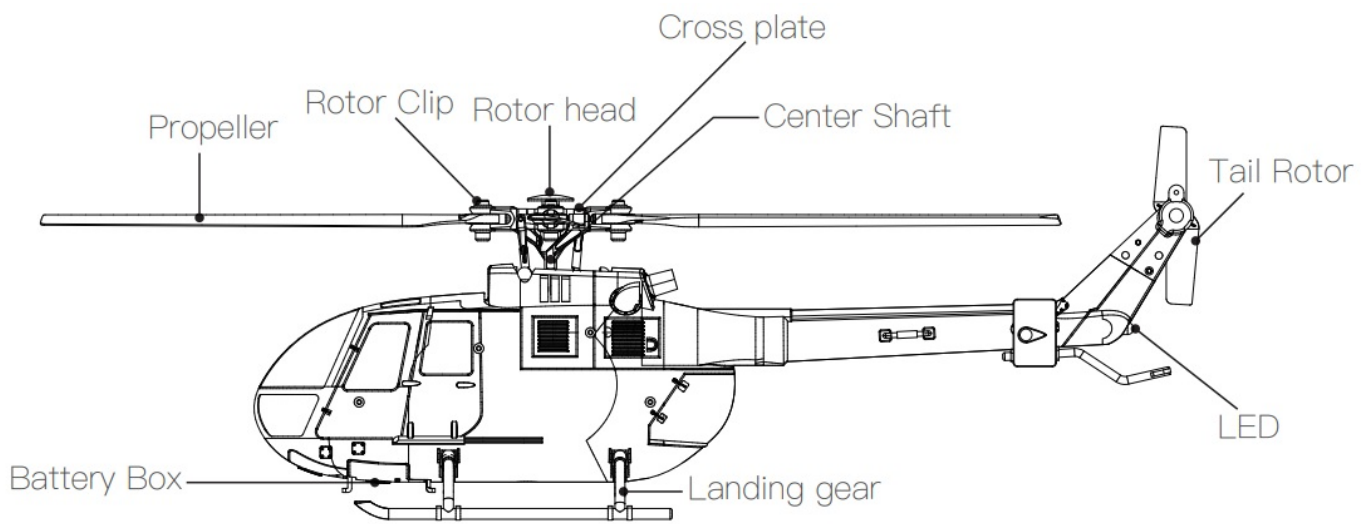

Batteries Charging Method

Charging method 1

Charging the battery by the USB port on a computer

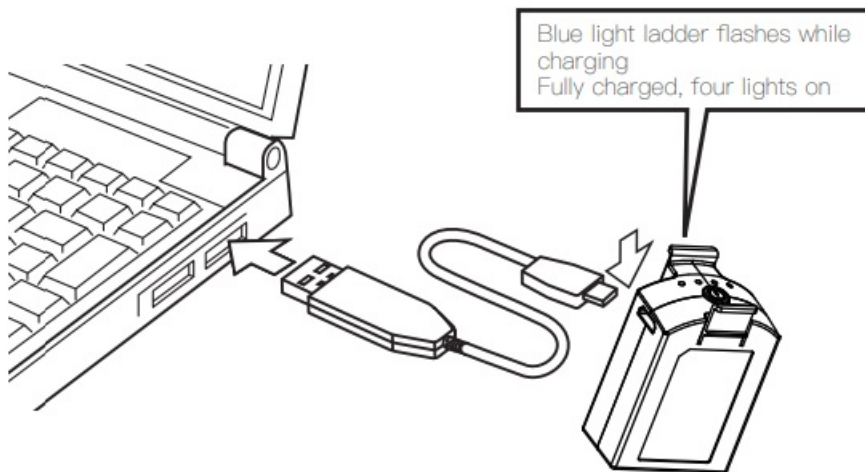

Description:

1. Connect the USB charger with the USB port.
2. Connect the battery with a USB charger: Blue light ladder flashes while charging Fully charged, four lights o

Charging method 2:Charging battery by power supply adapter.

1. Connect the USB charger with the power supply adapter.
2. Connect the battery with a USB charger: Blue light ladder flashes while charging Fully charged, four lights on

Charging method 3:Charging battery by power bank

1. Connect the USB charger with a power bank.
2. Connect the battery with a USB charger: Blue light ladder flashes while charging Fully charged, four lights o

First Flight Preparation CAUTION

1. ensure sufficient power supply of the transmitter and helicopter.
2. Keep a flight in a suitable space which away from the traffic, people, electricity pylons, and a pool.
3. Do not lock the main rotor screws too tightly to keep folding smoothly. If the main rotor screws are too tight, the helicopter will shake when flying.
4. Under an emergency situation, you can press the “sharp stop” button for 3” to land the helicopter without rotating. (Note: this action may cause a helicopter to crash.)

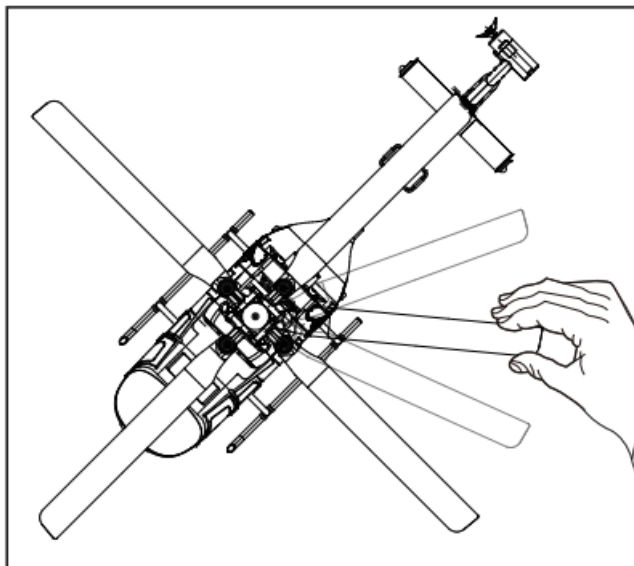

Installation method of remote controller battery

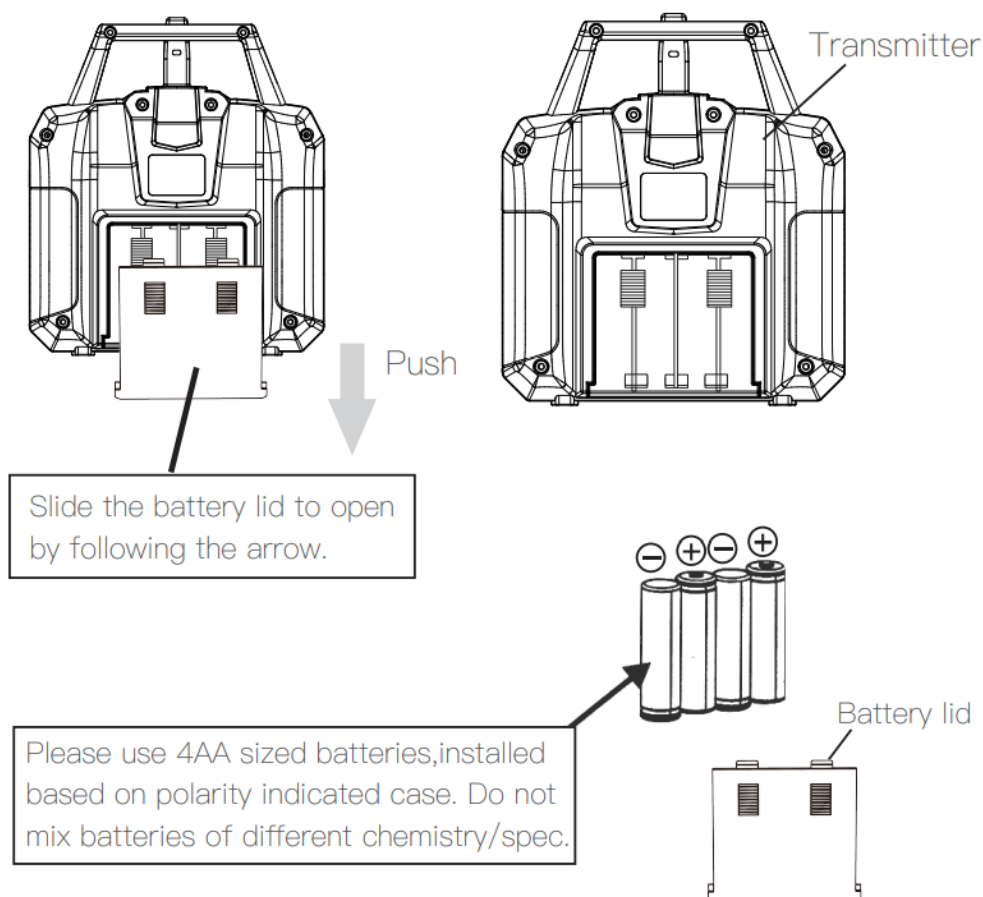

Direction of operation

If you're not familiar with the controls, take a few minutes to familiarize yourself with them, and then try your first flight.

Throttle

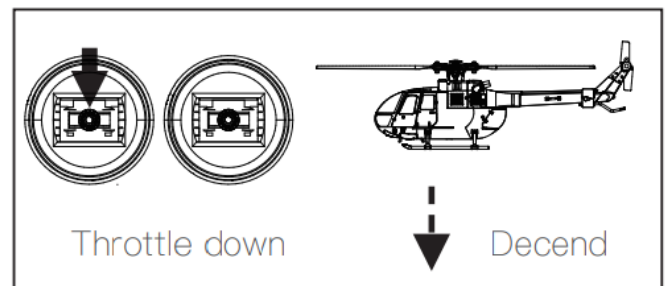
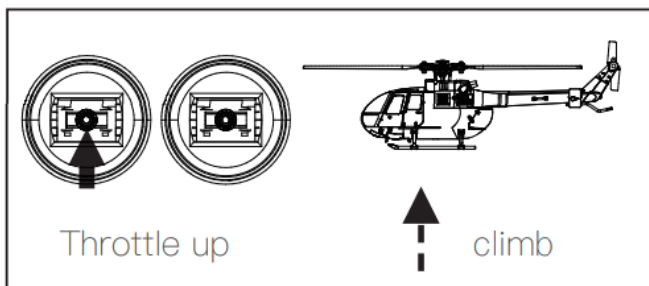

Rudder

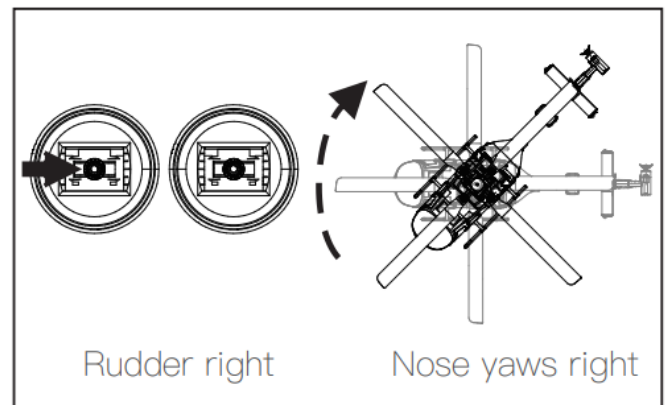
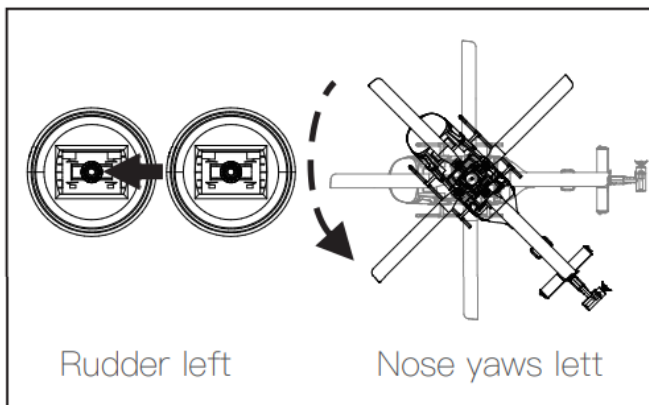

Elevator

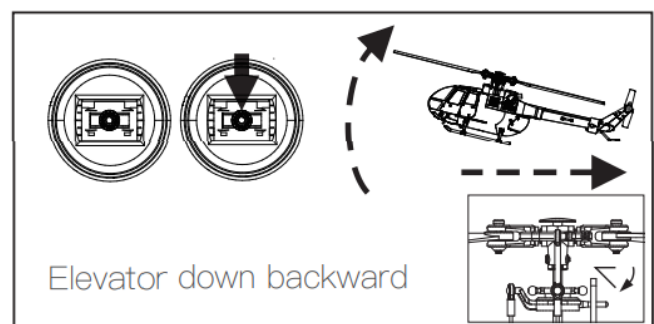
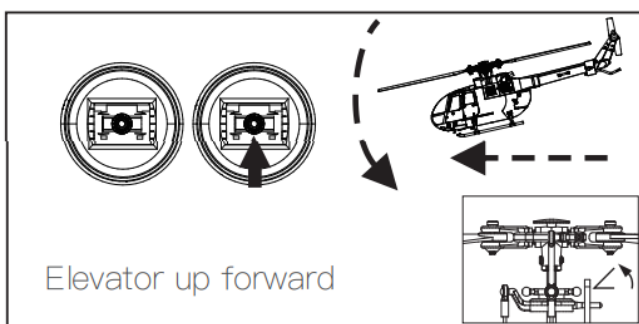

Aileron

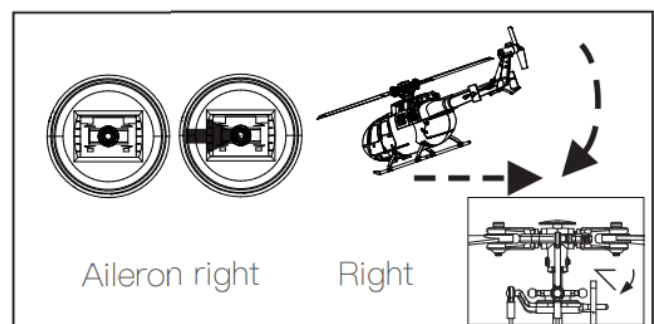
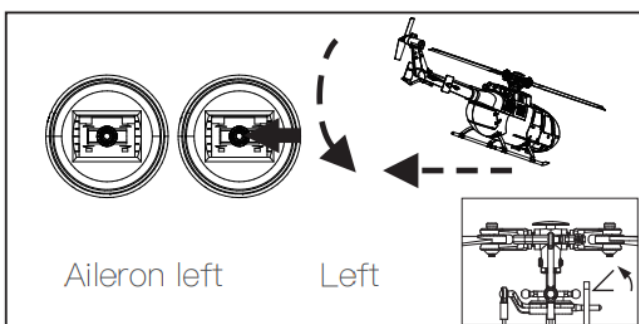

Flight Operation Steps

1. Turn on the transmitter and let the helicopter stay near to transmitter.

2. Install the aircraft battery in the battery compartment safely and securely. Press the power switch for 2 seconds to turn on the aircraft power.
3. The lights of the helicopter and the remote control flash at the same time. Then push the throttle stick from top to bottom quickly. The remote control makes a 'DI' sound, and the indicator lights of the helicopter and remote control are always on, which means binding successfully.
4. Pull the two joysticks to the outer eight angles to start the helicopter. (You can also press the one-key takeoff button to take off the helicopter directly.)
5. Keep the helicopter head forward, and keep a safe distance from the helicopter.
6. When manually operating the aircraft to land, please keep the throttle stick at the bottom for 2-3 seconds, and then release it after the propeller has completely stopped rotating. (This operation is not required when using the one-key landing function)

⚠ Note:

1. In order to avoid hitting, do not look at the helicopter at the hip level when it fly.
2. In order to avoid distractions, please confirm without other transmitters at work around.

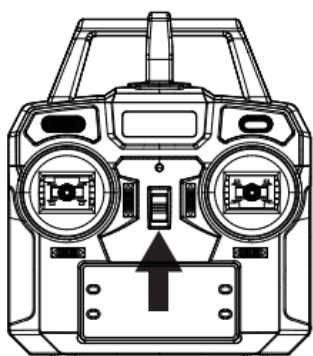

Corresponding to step 1

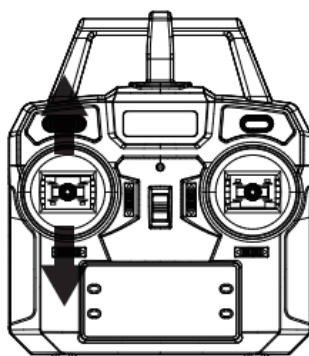

Corresponding to step 3

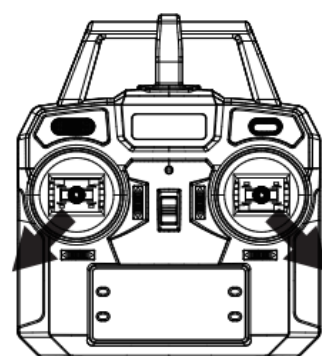

Corresponding to step 4

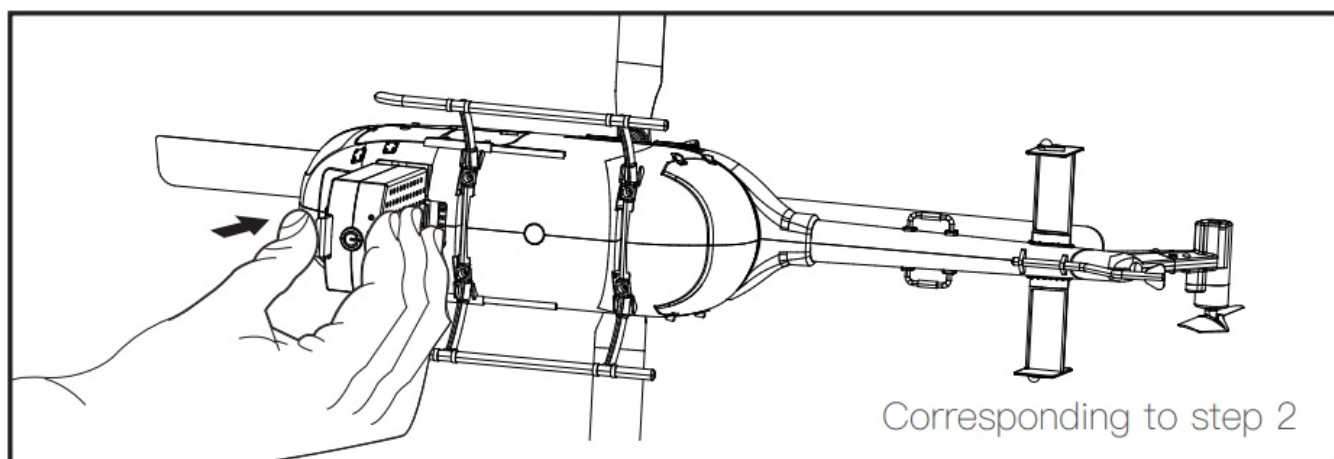

Corresponding to step 2

Note: The direction of the battery Card buckle



Note: Beginners should pay attention to the direction of flight. Keep the head forward to avoid causing injury.

Flight Yaw correction method

Press the trimming button when the helicopter has yaw problems.

The helicopter has set up hovering. If you are dissatisfied with hovering or the helicopter has yaw, please follow their steps to adjust.

Take off with the throttle joystick. According to the direction of yaw, press the fine-tuning button in the opposite direction until the plane hovers.

Forward/ backward Yaw			Fine-tune according to the direction of the arrow
Left/right Yaw			Fine-tune according to the direction of the arrow
Side fly Yaw			Fine-tune according to the direction of the arrow

Trimming Notes

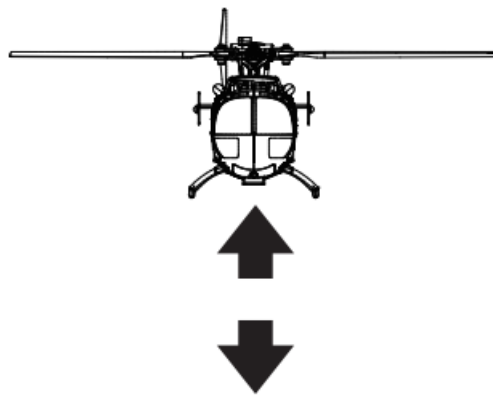

Warning

Maintain a flying altitude above one meter

Introduction of the corresponding socket of the receiver

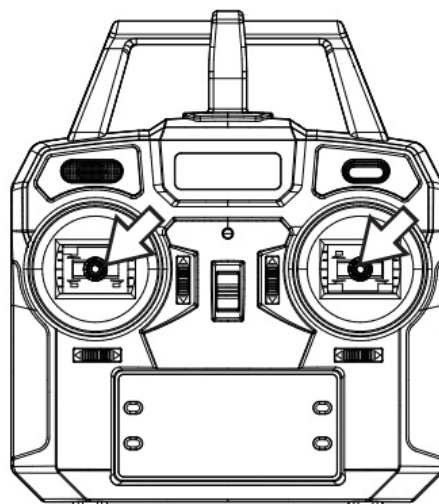
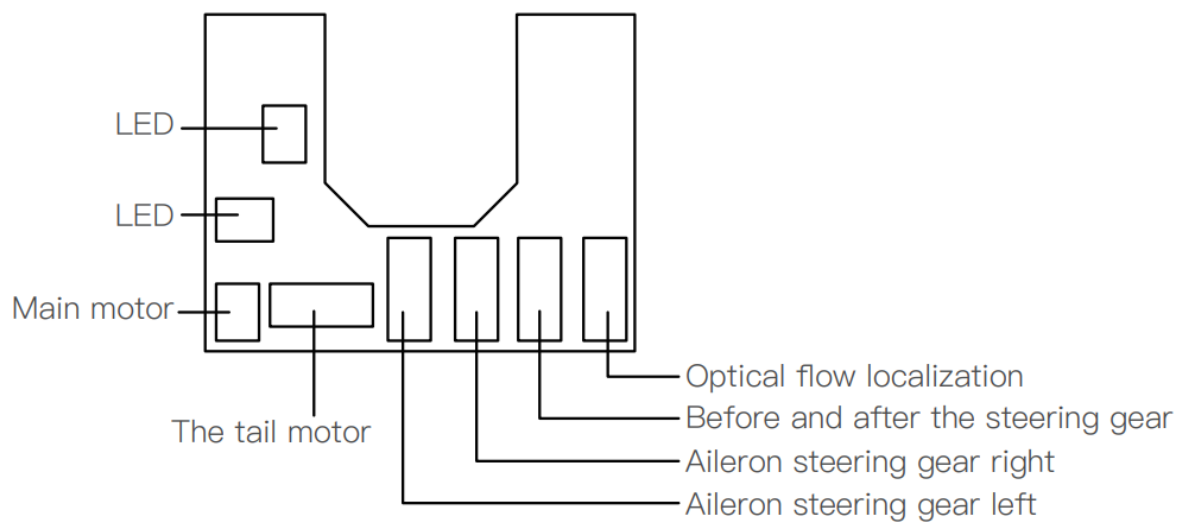

Gyro calibration method

1. When flying yaw, first land and calibrate the gyroscope.
2. When calibrating the gyroscope, the aircraft must be placed on level ground.
3. The indicator light will flash quickly during the calibration process, the indicator light stops flashing to take off.

Commonly used parts replacement instructions

Remove the propeller with a hex wrench, Be careful not to be too tight when installing the new propeller

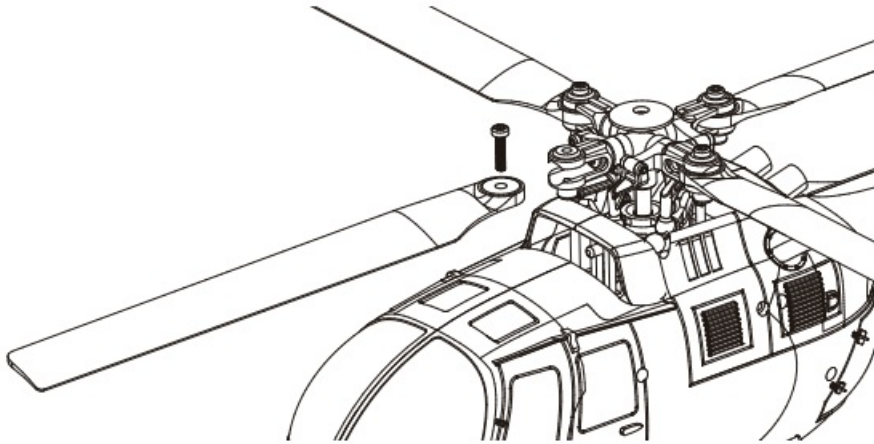

Unplug the plug, then twist the motor left and right to pull out

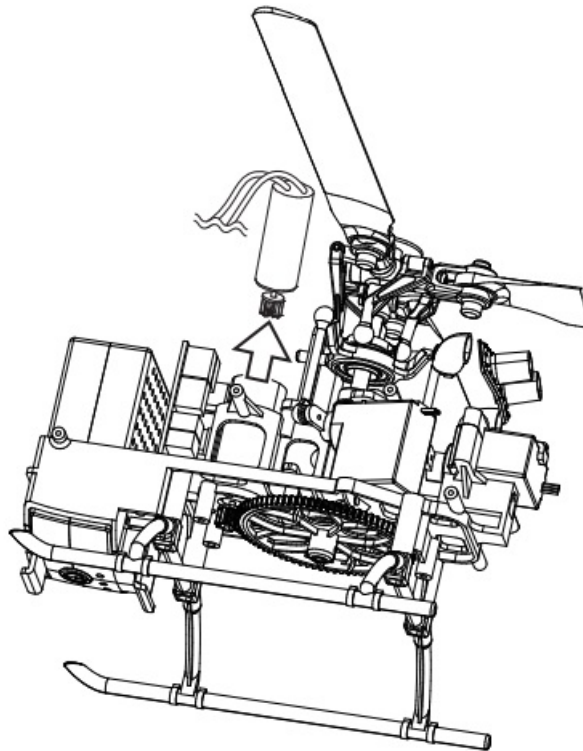

First, pull out the screw, and then pull out the big gear directly downward. Pay attention to the direction when installing the new gear.

The plane of the shaft should be aligned with the plane of the inner hole of the gear.

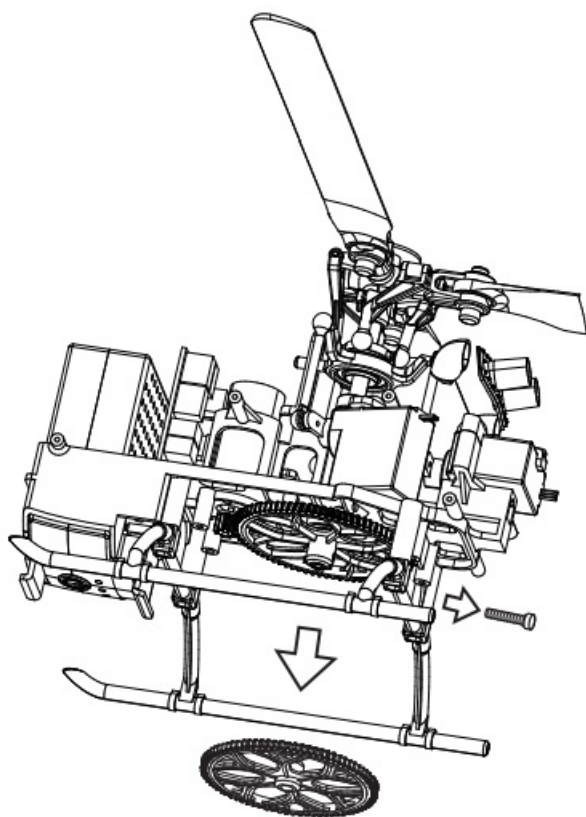

When removing and replacing the tail rotor, please pay attention to the direction, align the motor shaft and press it slowly to ensure smooth rotation.

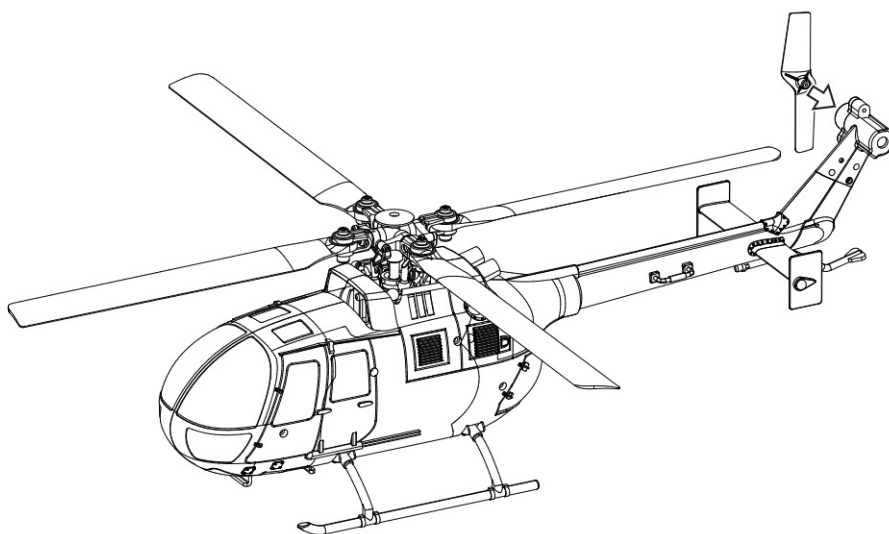

Abnormal Problem Solving Method

	Problem	Possible Cause	Solution
	Chopper power on. Taillight on. Slinking, no response to operation.	The helicopter without bound to the transmitter.	Bind the transmitter again
2	After turning on the chopper; the power switched and the chopper Nothing happened.	Check the power supply of the helicopter and transmitter; Check the battery's voltage of the helicopter and transmitter; Batteries had a poor connection.	Check the installation site of the Transmitter's batteries; Use full voltage batteries; Install the batteries again; Confirm the batteries have a good connection.
	'use the throttle but the motor not at work, the receiver's, signal light keeps flashing	Helicopter's battery has a low voltage; The lipo battery has poor connecting.	Charge the battery or change a full charge battery; Connect the battery with the receiver again.
	Turn on the helicopter after bind, the main blade can rotate but the helicopter can not take off	Chopper battery low, no paddles, Loose or stuck	Charge the battery or replace it with a fully charged one, The propeller will be reinstalled and turned smoothly.
3	The helicopter is violent; shaking	The main rotor is deformed cross shaft bent tail rotor bent Blade clamp screws are too tight to cause the main blade can not rotate	Change the main blade; Change the cross shaft; Change tail rotor; Loose the blade clamp screw.
	Helicopter spinning to left and take off.	The tail motor has a poor power; The blades loose; The tail motor was broken.	Check the connection of the tail blade and motor shaft. if loose, change the tail blade or tail motor.
7	• The helicopter has a little yaw	made an operational error of the trimming button	1. According to its yaw direction, push the trimming button in the opposite direction; 2. Reset the hovering point.
	• the helicopter has a serious yaw.		Check the servo if works properly; Check the swash plate; Check the rod sticks if losing.

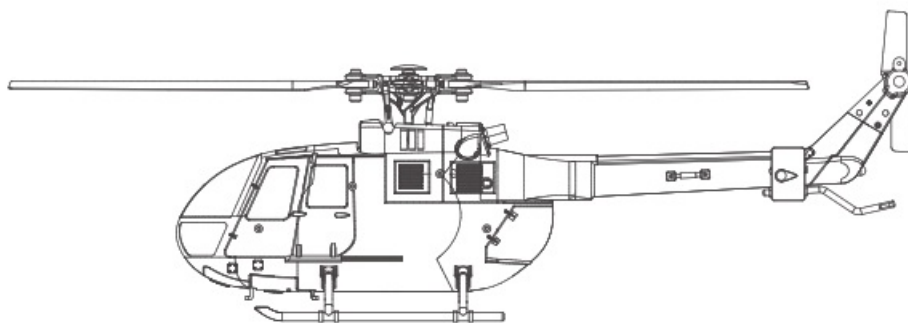

Company: Lotus NL B.V.
Address: Koningin Julianaplein 10, 1e Verd, 2595AA, The Hague,
The Netherlands.

E-mail: peter@lotusnl.com

Tel: +31644168999



Documents / Resources

	<p>Eachine E120 Axis Flybarless Scale RC Helicopter [pdf] User Manual</p> <p>E120 Axis Flybarless Scale RC Helicopter, Axis Flybarless Scale RC Helicopter, Scale RC Helicopter, RC Helicopter</p>
---	--

Manuals+.