

E-Welink 7-32V Switch Three Mode Wi-Fi Switch User Guide

[Home](#) » [E-Welink](#) » E-Welink 7-32V Switch Three Mode Wi-Fi Switch User Guide 

E-Welink 7-32V Switch Three Mode Wi-Fi Switch

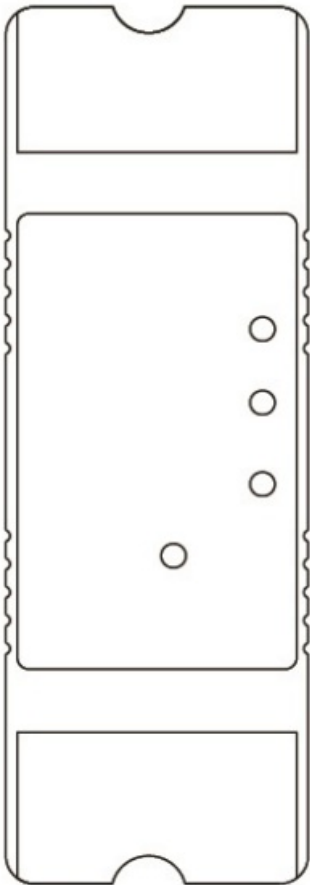

Contents

- 1 Parameters
- 2 Checklist before using the device
- 3 User Guide
- 4 Add device flow to mobile APP
- 5 Remote control matches the code
- 6 TROUBLESHOOTING
- 7 Documents / Resources
 - 7.1 References
- 8 Related Posts

Parameters

- **Input voltage:** DC/AC 7V~32V
- **Max. Current:** 2200W / 1 0A/ Gang
- **Wi-Fi Standard:** Wi-Fi 2.4ghz b/ g/n
- **Working temperature:** -20°C~70°C
- **Material:** ABS
- **Size:** 116*38*2Smm

Checklist before using the device

- Your smart phone or tablet has connected to a 2.4g WiFi with internet.
- You have the correct WiFi PWD.
- You smart phone or tablet must have access to APP store, Google play.
- Your router is MAC-open.

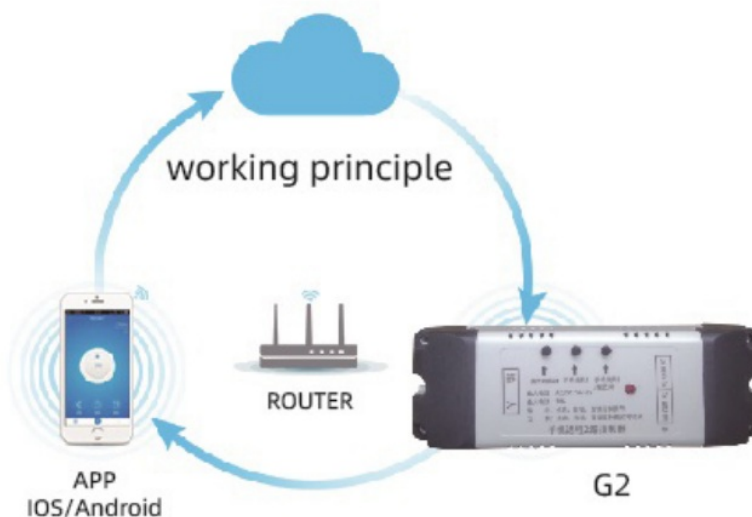

User Guide

1. Start with "EWelink" APP.

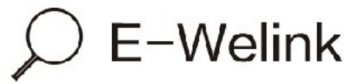

2. Register an EWlink account.
3. If you have EWelink account.
4. just login.
5. Power up.

ON/OFF operating principle :

The connected appliances work/stop through live wire power on/off.

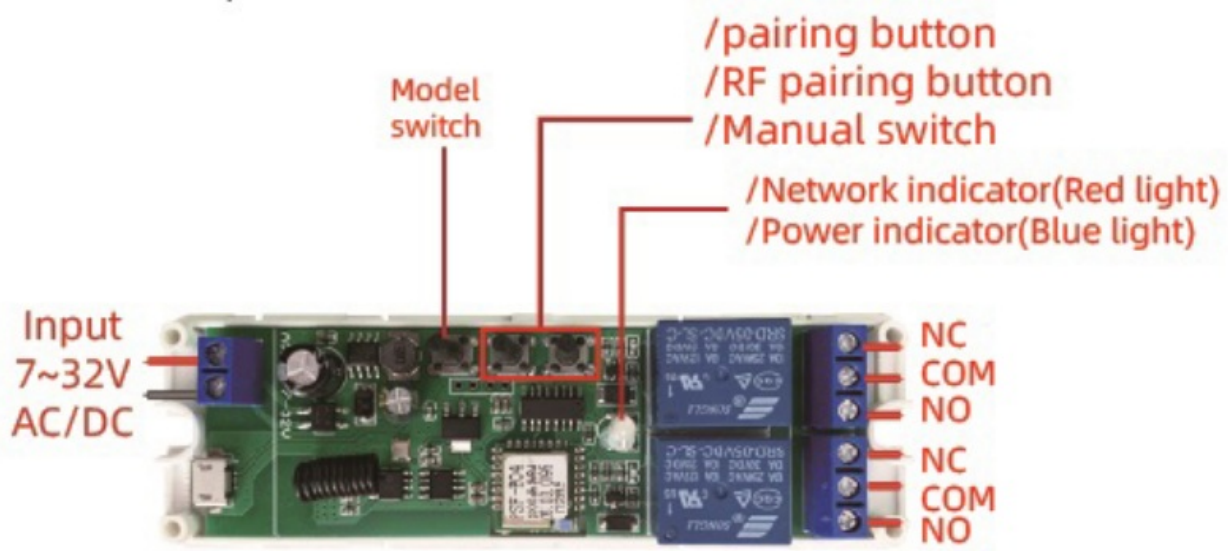

self-locking 1



self-locking 2



On the device, the default call is closed and can be set to call or maintain in the APP change.

Add device flow to mobile APP

1. After installation ,power the device and long press pairing button(anyone) for 5 seconds until Network indicator blinks quickly(blinking twice and on).
2. Tap  on EWelink app.
3. Select Quick Pairing .

special cases You can try compatibility Model (AP)



4. Input your WiFi password.



5. Name your device.

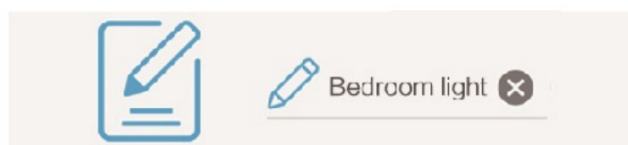

- When the network indicator is on, the device is online.
- Click the on/off buttons on the APP can control device, Manual control se itch also can be display real -t ime on the AP P.

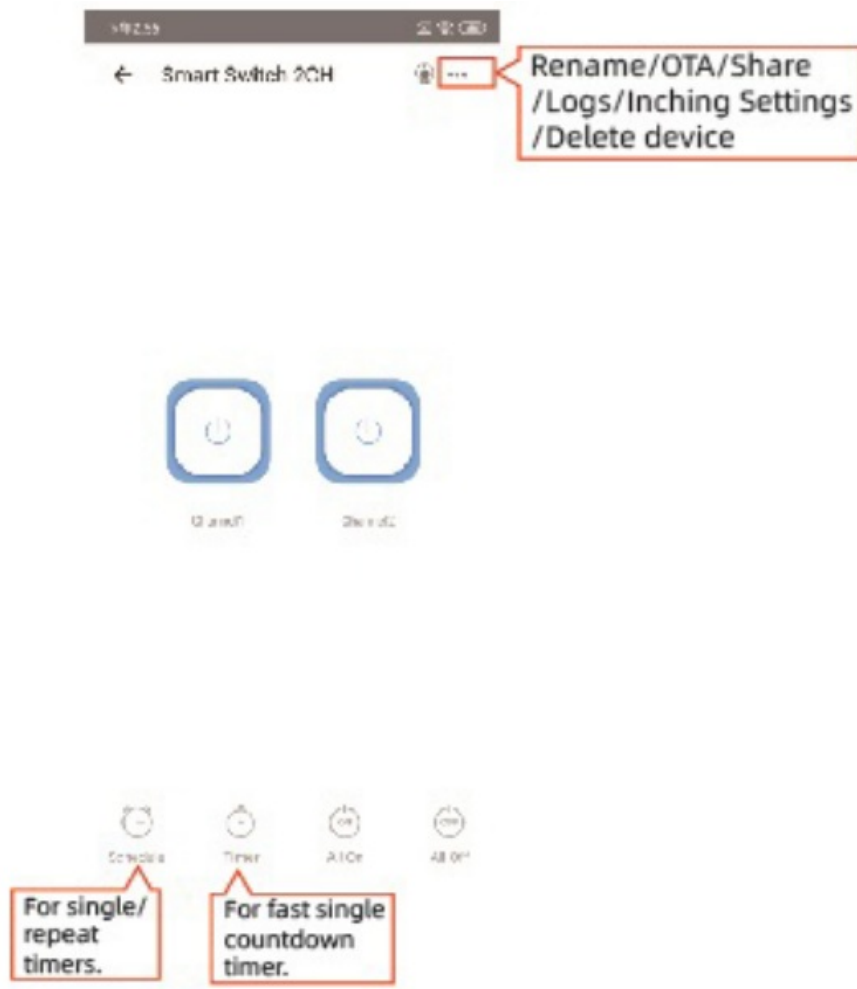

Remote control matches the code

Matching:

- hold RF pairing button for 3 seconds you want to match ,until blue light is on .
- then long press remote control button you want to match.
- loosen the remote control buttons, matching success

Clear code:

Long press the RF pairing button for 15 seconds , loosen the RF pairing button until the RF pairing indicator is off.

note: the matching/clear code method is only available with RF function switch/module reference.

TROUBLESHOOTING

Enter the homepage of App, click the icon in the lower right corner of the interface to enter.

“Message” >hits” Guide” ” Profile” >hits” Ewelink support”

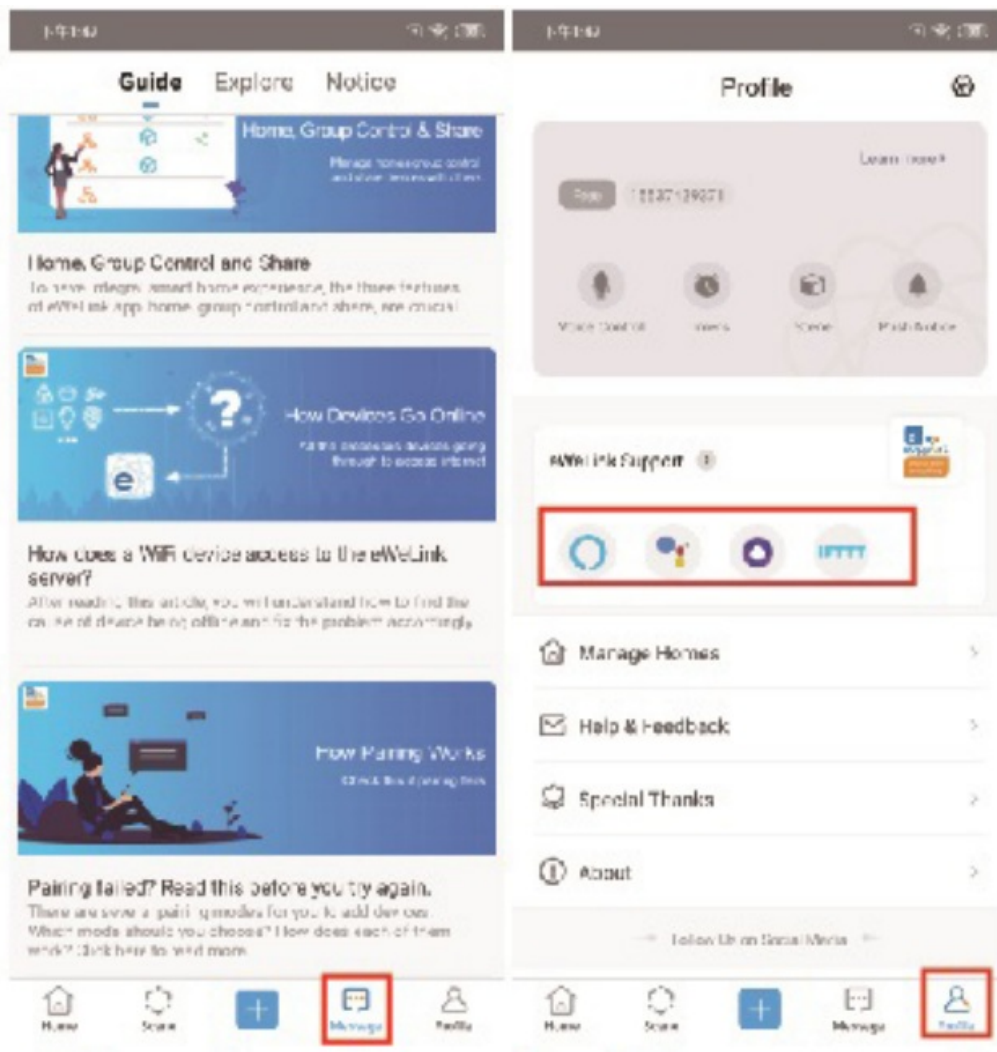

If none of the above is resolved, please open it with another phone. Personal hotspot. try to readd.

Documents / Resources

| | |
|---|--|
|  | <p>E-Welink 7-32V Switch Three Mode Wi-Fi Switch [pdf] User Guide 7-32V Switch Three Mode Wi-Fi Switch, 7-32V Switch, Three Mode Wi-Fi Switch, Mode Wi-Fi Switch, Wi-Fi Switch, Switch</p> |
|---|--|

References

- [User Manual](#)