



E-IMAGE EG03A3 Video Tripod System Instructions

[Home](#) » [E-IMAGE](#) » E-IMAGE EG03A3 Video Tripod System Instructions 

Contents

- [1 E-IMAGE EG03A3 Video Tripod System](#)
- [2 EG03A3 Video Tripod System](#)
- [3 GH03F Flat Base Fluid Head](#)
- [4 GA752 75mm Video Tripod](#)
- [5 Documents / Resources](#)



E-IMAGE EG03A3 Video Tripod System



EG03A3 Video Tripod System

E-Image 2-stage aluminum tripod legs with GH03F flat base fluid head & 75BF adapter supports cameras and accessories weighing up to 5kg (11lbs). It includes a GH03F flat base fluid head & 75BF adapter, a GA752 two stages aluminum legs, and a GS01 mid-level spreader. The fluid head and tripod legs feature a 75mm ball/bowl. The tripod extends to a height of 170cm and collapses down as low as 76.5cm. A kit bag is included.



SC-1 Carry bag

Full padded portable carrying bag providing good protection during movement.

Specifications

- **Payload:** 5.0kg / 11.0lbs
- **Height range:** 76.5-170.0cm / 30.1-66.9in
- **Transport length:** 85.0cm / 33.5in
- **Net weight:** 5.0kg / 11.0lbs
- **Bowl size:** 75mm

What's included:

- **Head:** GH03F
- **Tripod:** GA752
- **Adapter:** 75BF
- **Packing:** SC-1 Carry bag

GH03F Flat Base Fluid Head

The E-Image GH03F fluid head with flat base supports cameras and accessories weighing up to 5kg (11lbs).

With flat base, the head is designed to use with flat-base tripods and fit sliders, skate dollies and other equipments. With standard 1/4" and 3/8" screw holes on the sides, monitor arms and other accessories can be installed on it. The pan handle can be attached to rosette adapters on the left or right side of the head.



Features



Specifications

	Payload	5.0kg / 11.0lbs
	Counterbalance	Fixed
	Grades of pan drag	Fixed
	Grades of tilt drag	Continuous adjustable

	Tilt range	-80°~+90°
	Temperature range	-40°C~+80°C
	Net weight	1.2kg / 2.6lbs
	Bowl size	Flat base

Counterbalance Graph

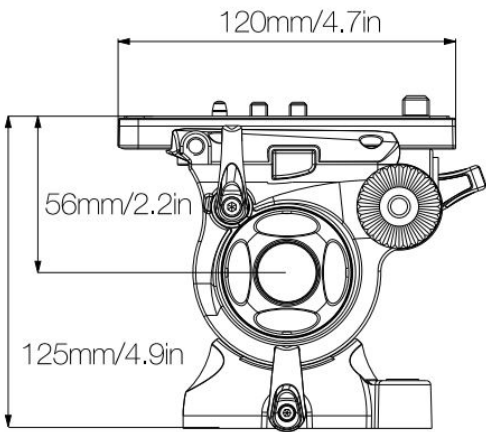
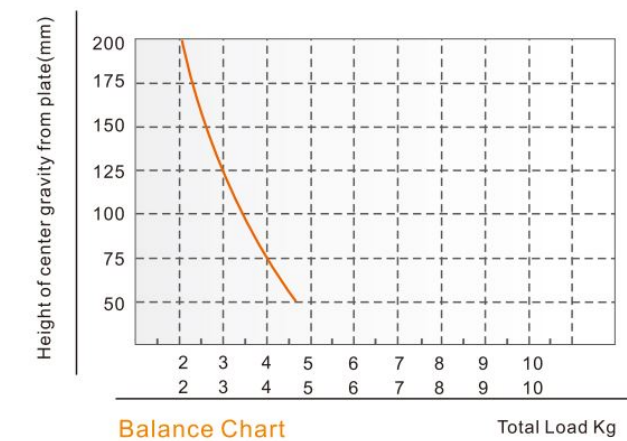

GA752 75mm Video Tripod

The E-IMAGE GA752 two stages aluminum tripod supports a payload weighing up to 88lbs. It is made of lightweight aluminum has a 75mm bowl and the legs are a twin tube design with two stages. The Mono-Lock feature allows for quick height adjustments of both stages with one twist. An adjustable mid-level spreader provides extra security and stability.



75mm bowl size.



Ergonomic hand locking knob.



The Mono-Lock feature allows for quick height adjustments of both stages with one twist.



High quality aluminum tube.



Adjustable middle spreader adding extra stability.



Spike foot & big rubber are both available.

Specifications:

- **Payload:** 40.0kg / 88.0lbs
- **Height range:** 63.5-157.0cm / 25.0-61.8in
- **Transport length:** 72.0cm / 28.3in
- **Net weight:** 3.6kg / 7.9lbs
- **Bowl size:** 75mm
- **Sections:** 3
- **Material:** Aluminum

Recommend accessories



GS02 Ground spreader



EI-7003 Dolly



EI-7003C Dolly

www.eimagevideo.com

Documents / Resources



E-IMAGE EG03A3 Video Tripod System [pdf] Instructions
EG03A3 Video Tripod System, EG03A3, Video Tripod System, Tripod System