



Dynojet Yamaha R6 2017-2020 Power Commander V Ignition Module Installation Guide

[Home](#) » [Dynojet](#) » Dynojet Yamaha R6 2017-2020 Power Commander V Ignition Module Installation Guide 

Dynojet Yamaha R6 2017-2020 Power Commander V Ignition Module



Contents

- [1 PARTS LIST](#)
- [2 INPUT ACCESSORY GUIDE](#)
- [3 OPTIONAL ACCESSORY INPUTS](#)
- [4 WIRE CONNECTIONS](#)
- [5 INSTALLING THE POWER COMMANDER](#)
- [6](#)
- [6 Documents / Resources](#)
 - [6.1 References](#)
- [7 Related Posts](#)

PARTS LIST

- 1 POWER COMMANDER 6
- 1 INSTALLATION GUIDE
- 1 USB CABLE
- 2 DYNOJET DECALS
- 2 POWER COMMANDER DECALS

- 2 VELCRO STRIPS
- 1 ALCOHOL SWAB
- 1 POSI-TAP

PLEASE READ ALL DIRECTIONS BEFORE STARTING INSTALLATION. THE IGNITION MUST BE TURNED OFF BEFORE INSTALLATION.

INPUT ACCESSORY GUIDE

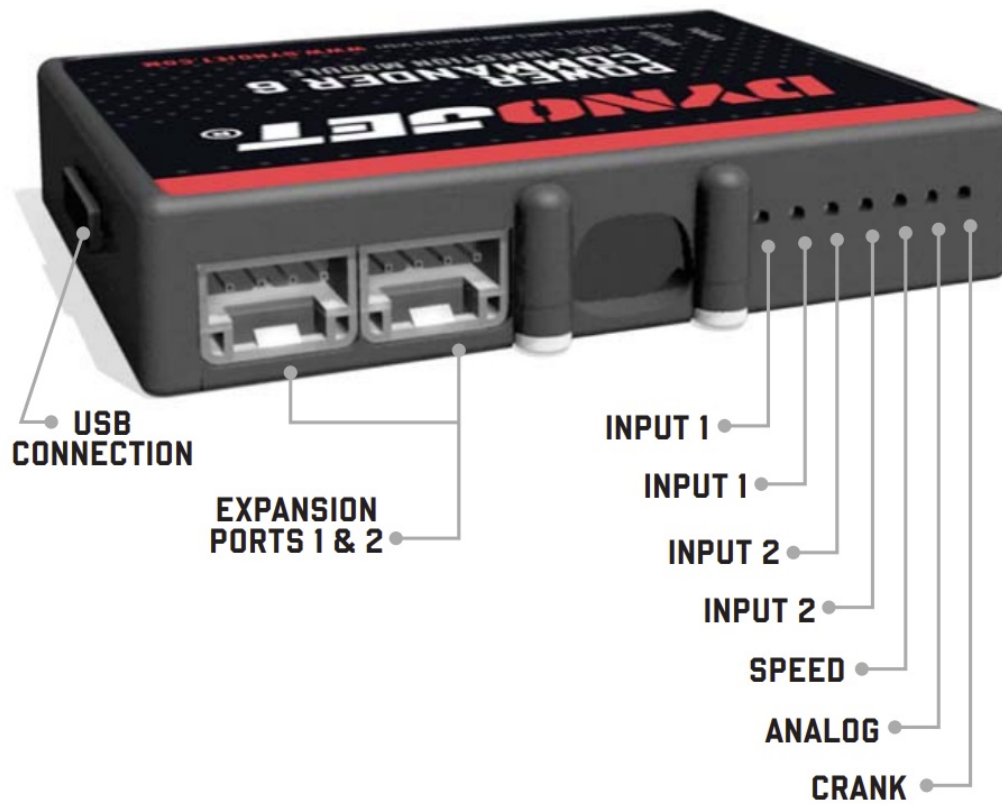

OPTIONAL ACCESSORY INPUTS

Map	(Input 1 or 2) The PC6 has the ability to hold 2 different base maps. You can switch on the fly between these two base maps when you hook up a switch to the MAP inputs. You can use any open/close type switch. The polarity of the wires is not important.
Shifter	(Input 1 or 2) Used for clutch-less full throttle upshifts. Insert the wires from the Dynojet quick shifter into either Input 1 or Input 2. The polarity of the wires is not important. Set to Input 2 by default.
Speed	If your application has a speed sensor then you can tap into the signal side of the sensor and run a wire into this input. This will allow you to calculate gear position in the Control Center Software. Once gear position is setup you can alter your map based on gear position and setup gear dependent kill times when using a quick shifter.
Analog	This input is for a 0-5v signal such as engine temp, boost, etc. Once this input is established you can alter your fuel curve based on this input in the Power Core software.
Launch	You can connect a wire to either Input 1 or Input 2 and then the other end to a switch. This switch when engaged (continuity) will only allow the RPM to be raised to a certain limit (set in the software). When released, you will have full RPM.

WIRE CONNECTIONS

To input wires into the PC6 first remove the rubber plug on the backside of the unit and loosen the screw for the corresponding input. Using a 22-24 gauge wire, strip about 10mm from its end. Push the wire into the hole of the PC6 until it stops and then tighten the screw. Make sure to reinstall the rubber plug.

NOTE: If you tin the wires with solder it will make inserting them easier.

INSTALLATION GUIDE

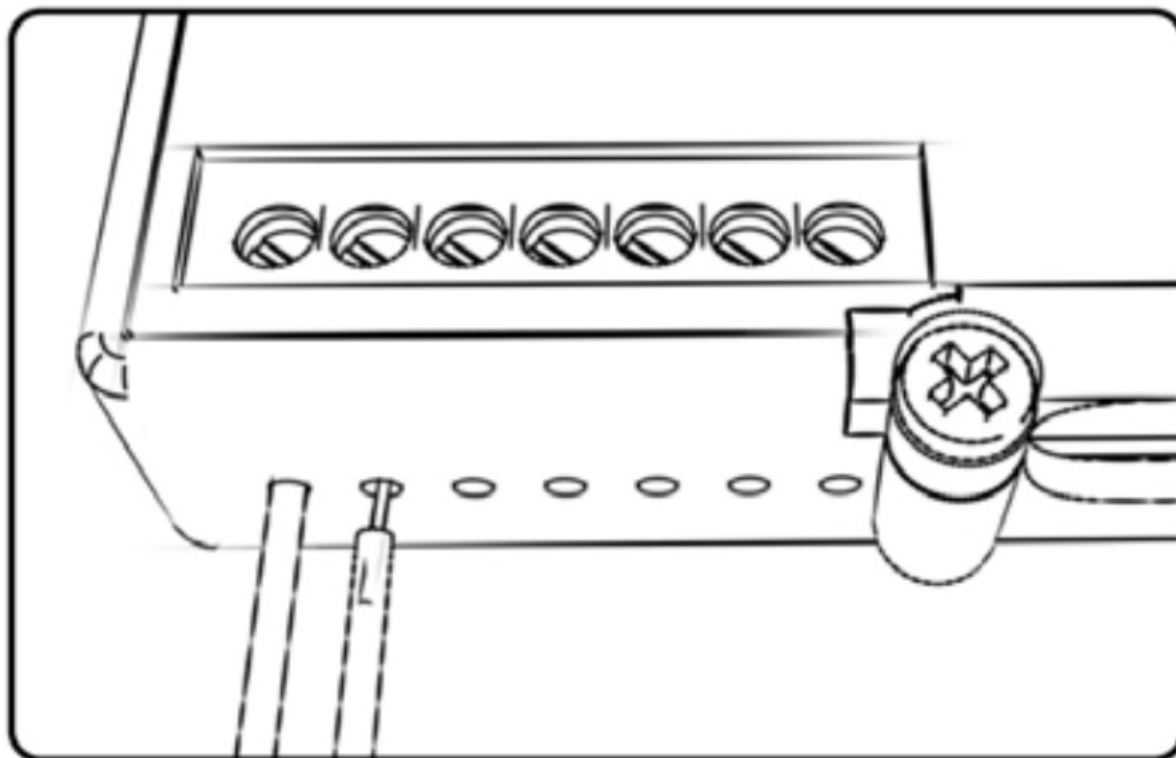

INSTALLING THE POWER COMMANDER 6

1. Remove the seat.

2. Prop the front of the fuel tank up or remove the entire fuel tank.
3. Secure the PC6 in the tail section on top of the ECU using the supplied Velcro.

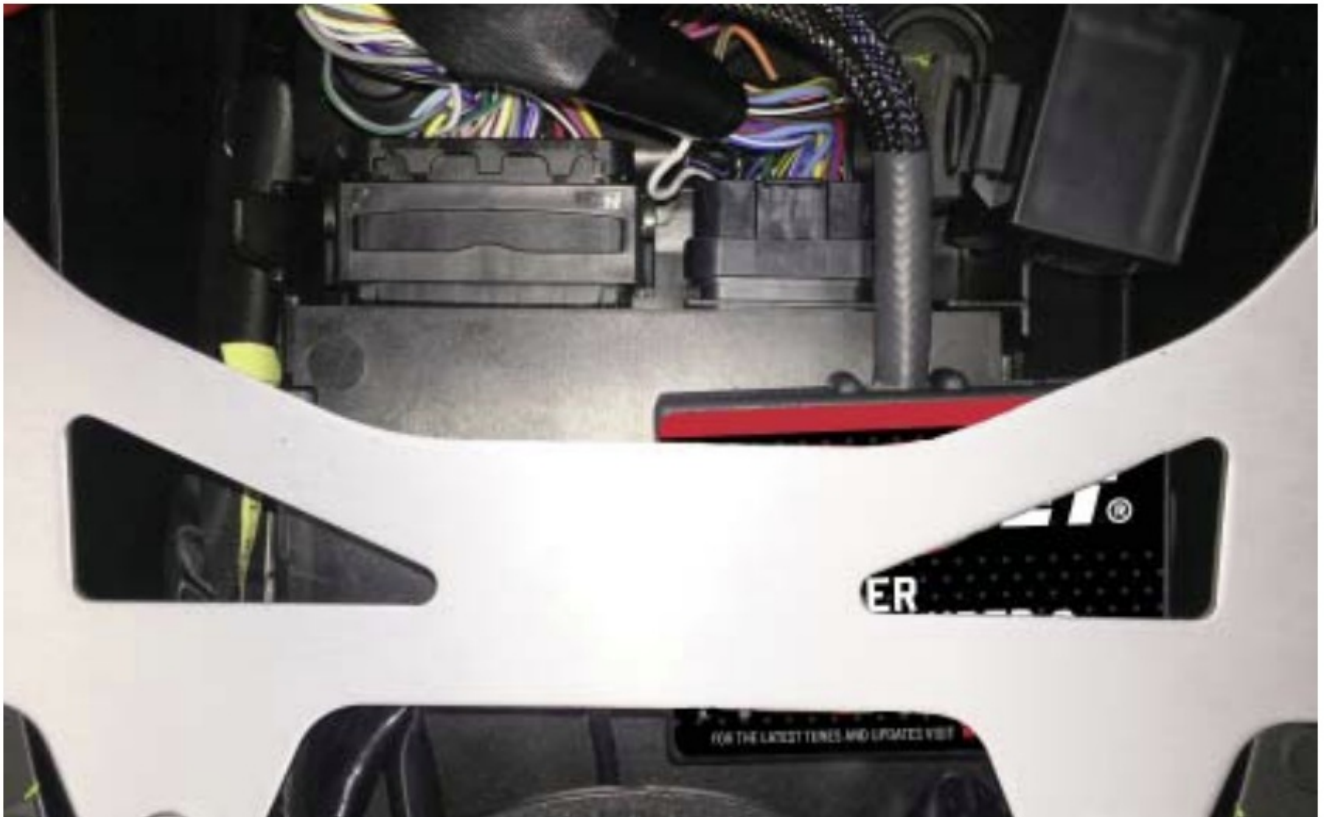

4. Unplug the small connector from the ECU. This will allow access to the harness. Pull the sheathing back
5. Use the supplied Posi-tap to attach the PC6 GREY wire to the stock WHITE wire of the ECU.

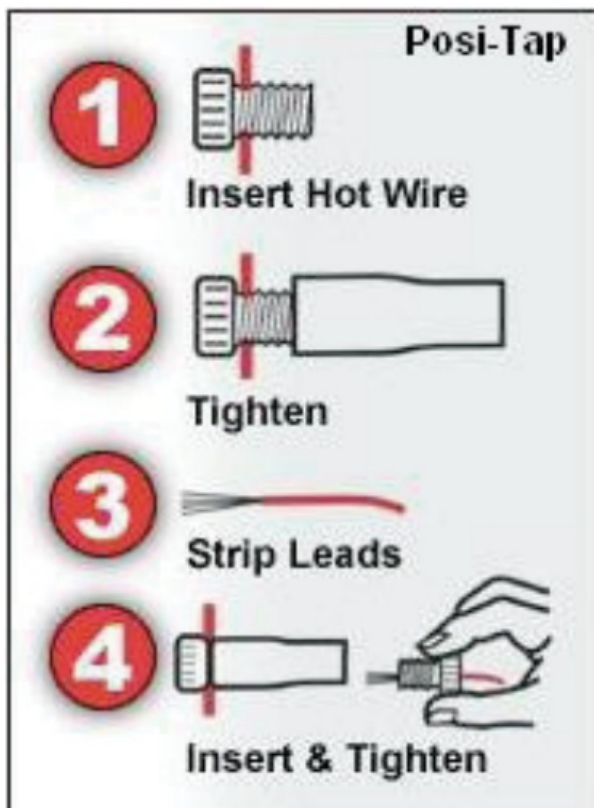

There are 2 WHITE wires. Looking at the back of the connector go to pin #11.

6. Plug the connector back into the ECU.

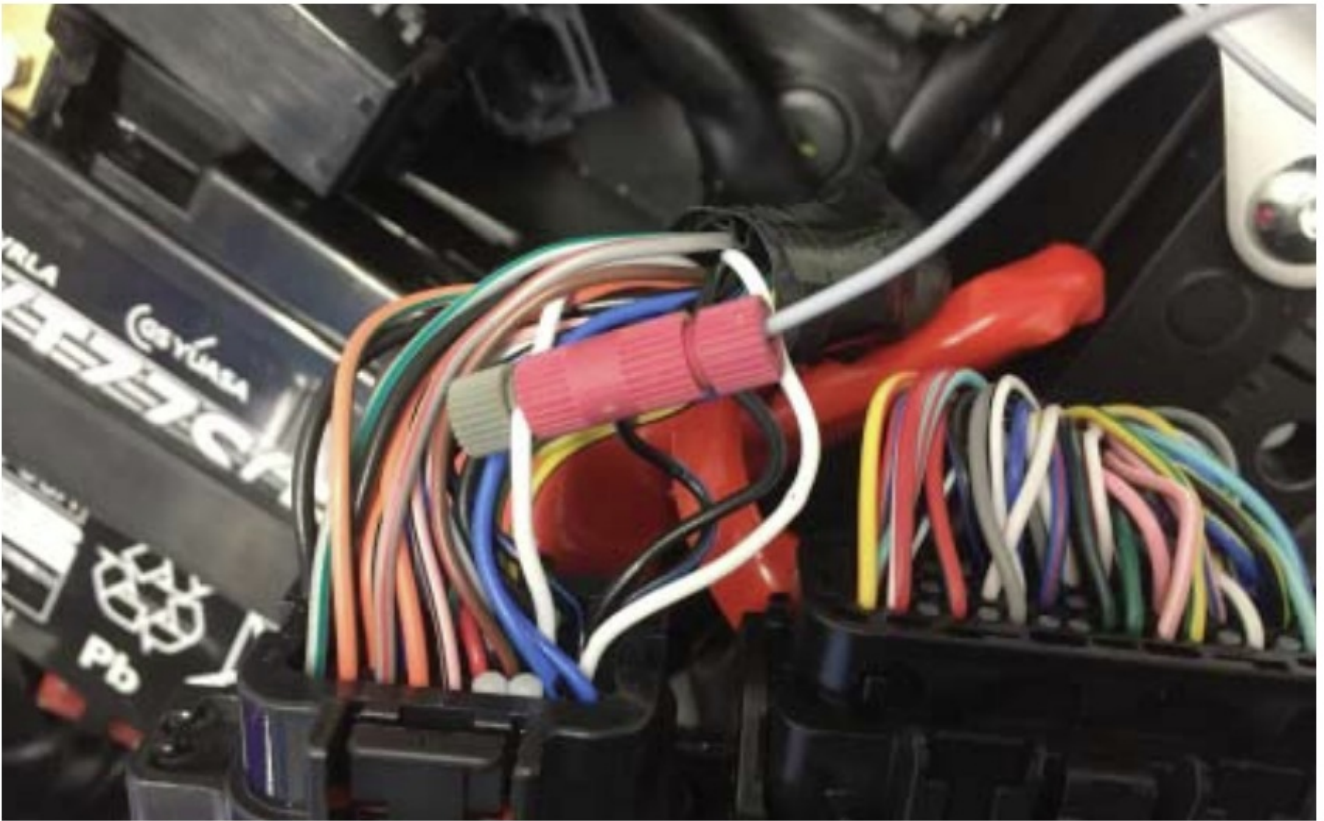

7. Attach the ground wire of the PC6 to the common ground location towards the rear of the engine.



8. Plug the PC6 in-line of the stock gear position sensor and wiring harness. **This connection is located on the left side of the engine above the sprocket cover.**

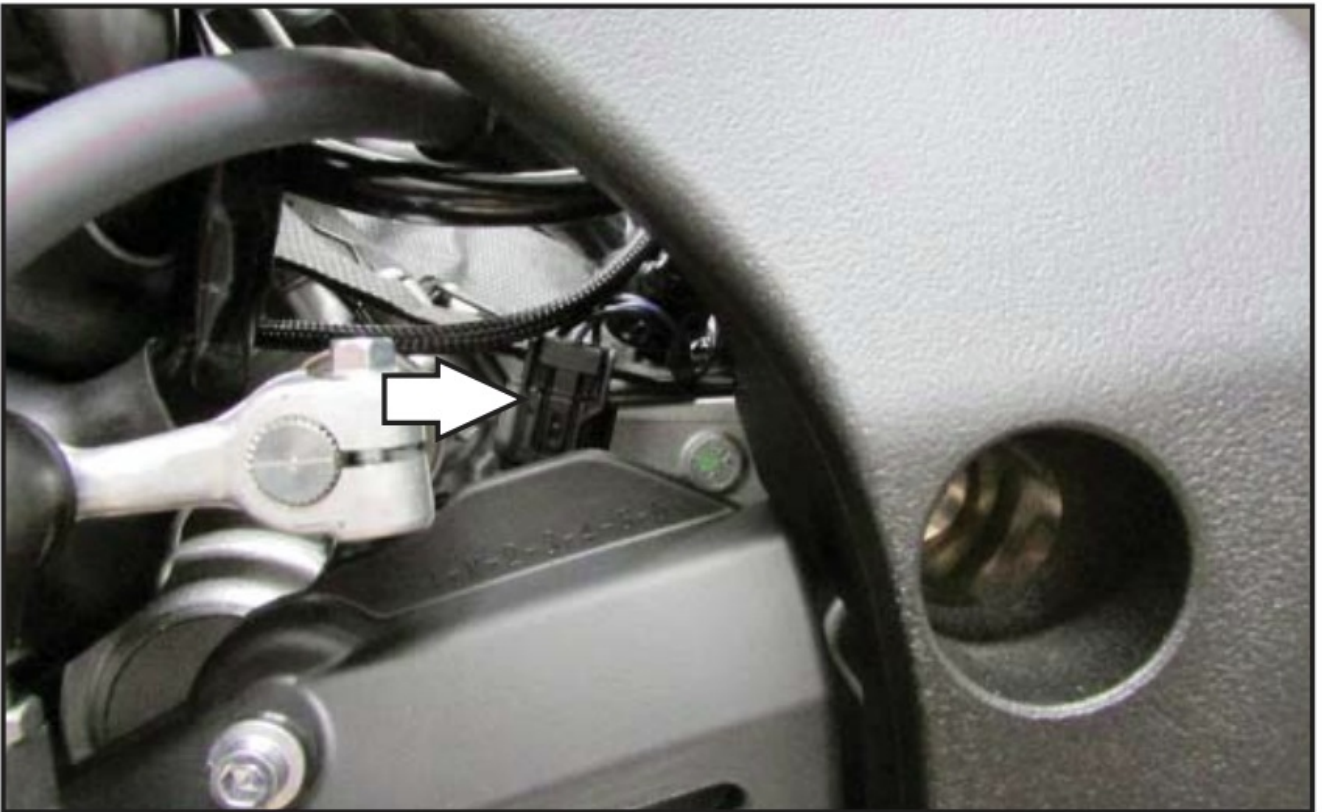

Make sure to connect to the LOWER set of injectors.

9. Plug the PC6 in-line of the stock injectors and wiring harness.

PC6 ORANGE colored wires go to cylinder #1.

PC6 YELLOW colored wires go to cylinder #2.

PC6 GREEN colored wires go to cylinder #3.

PC6 BLUE colored wires go to cylinder #4.



10. Unplug the crank position sensor connector.

This connection is located near the rear of the engine, to the right of the ground location.

11. Plug the PC6 crank connectors in-line of the stock wiring harness and crank sensor.

12. Reinstall the fuel tank and seat.



Download the latest map files from our web site at dynojet.com/tunes.



Documents / Resources

	<p>Dynojet Yamaha R6 2017-2020 Power Commander V Ignition Module [pdf] Installation Guide</p> <p>Yamaha R6 2017-2020, Power Commander V Ignition Module, Ignition Module, Power Commander V Module, Module, Yamaha R6 2017-2020</p>
---	---

References

- [DYNO Powersports Vehicle Parts | Performance Ignition & Fuel Parts | Dynojet](#)
- [DYNO Tunes | Dynojet](#)

