



PDDEG-S Ethernet Gateway Supervisor



Dynalite PDDEG-S Ethernet Gateway Supervisor Installation Guide

[Home](#) » [Dynalite](#) » Dynalite PDDEG-S Ethernet Gateway Supervisor Installation Guide 

Contents

- [1 Dynalite PDDEG-S Ethernet Gateway Supervisor](#)
- [2 Product Information](#)
- [3 Product Usage Instructions](#)
- [4 REQUIRED TOOLS](#)
- [5 DIMENSION](#)
- [6 INSTALLATION INSTRUCTIONS](#)
- [7 FAQ](#)
- [8 Documents / Resources](#)
 - [8.1 References](#)
- [9 Related Posts](#)



Dynalite PDDEG-S Ethernet Gateway Supervisor



Product Information

Specifications:

- **Model:** PDDEG-S
- **Product Name:** Ethernet Gateway Supervisor
- **Dimensions:** 216 mm x 104 mm x 95 mm (8.50 in x 4.09 in x 3.74 in)
- **Pollution Degree:** 1A IEC Pollution Degree II
- **Operating Temperature:** 0-45°C (32-113°F)
- **Humidity:** 90%
- **Power Input:** 100-277 V, 0.25 A
- **Overvoltage Category:** IEC Overvoltage Category III

Product Usage Instructions

• Installation:

Devices must be installed in an approved enclosure by a qualified electrician following all national and local electrical and construction codes and regulations.

• Connection:

Connect the Ethernet Gateway Supervisor to the power source and ensure proper grounding.

• Network Configuration:

For optimal performance, connect to Ethernet ports as instructed. Refer to dynamalite.com/support for port availability details.

• BMS and Lighting Integration:

It is recommended to connect the Building Management System (BMS) and lighting systems on separate VLANs for efficient operation.

Devices must be installed in an approved enclosure by a qualified electrician in accordance with all national and local electrical and construction codes and regulations.

MANUAL INSTRUCTIONS

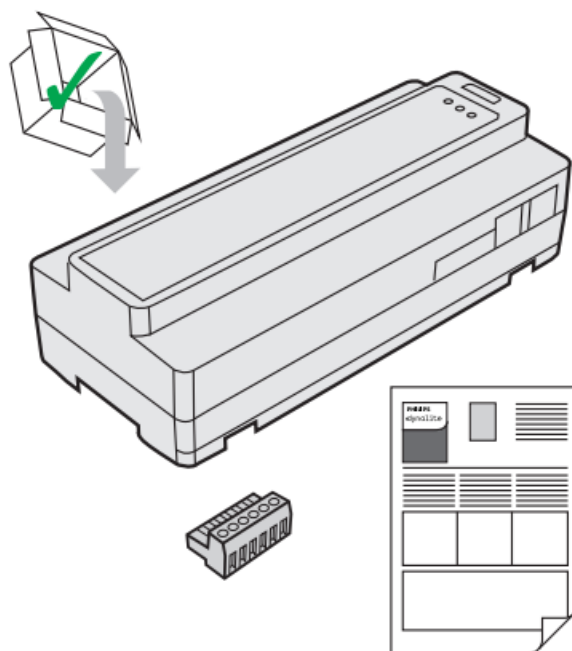

REQUIRED TOOLS

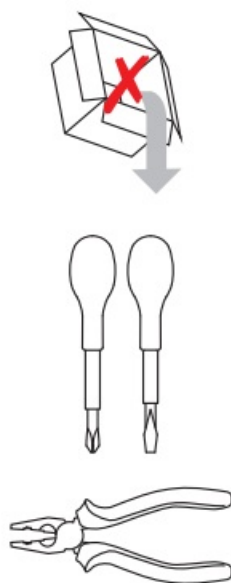

DIMENSION

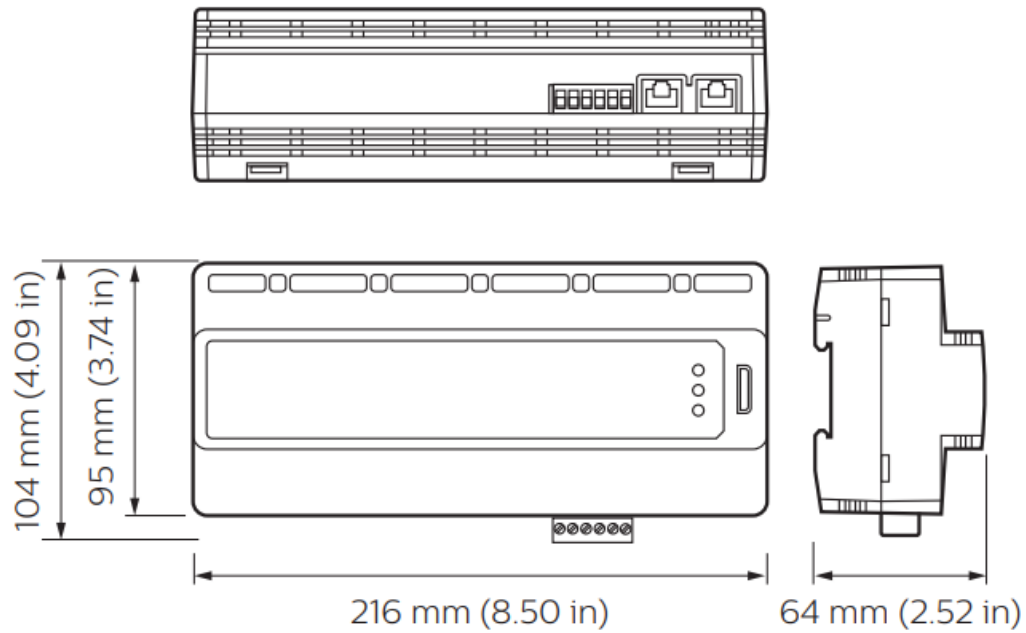

INSTALLATION INSTRUCTIONS

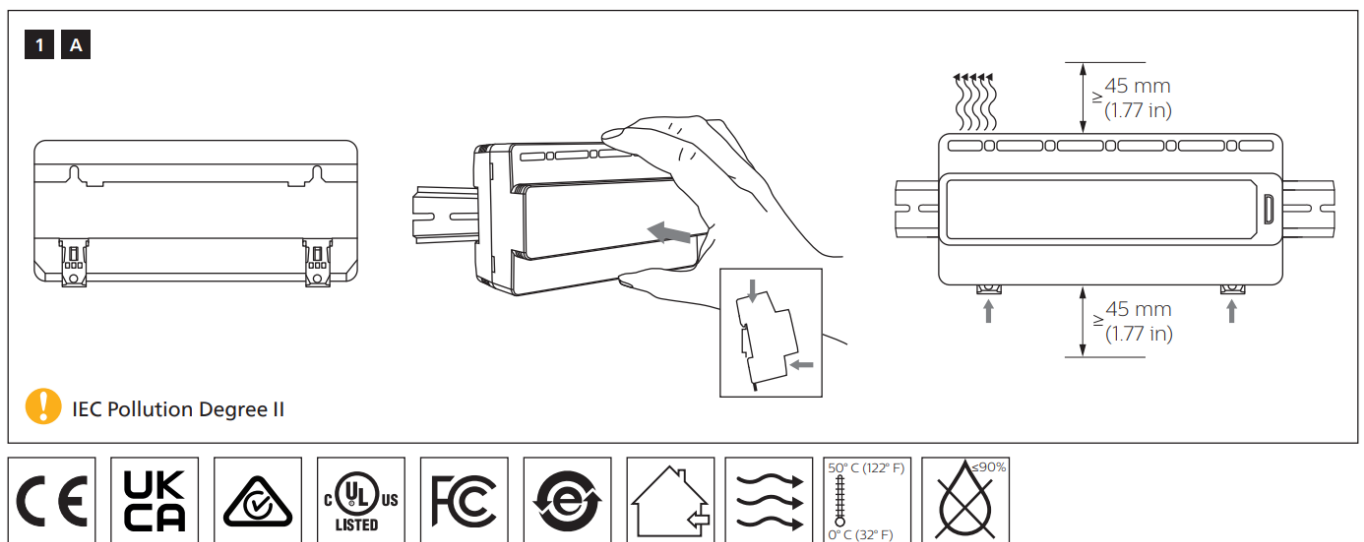

1 B

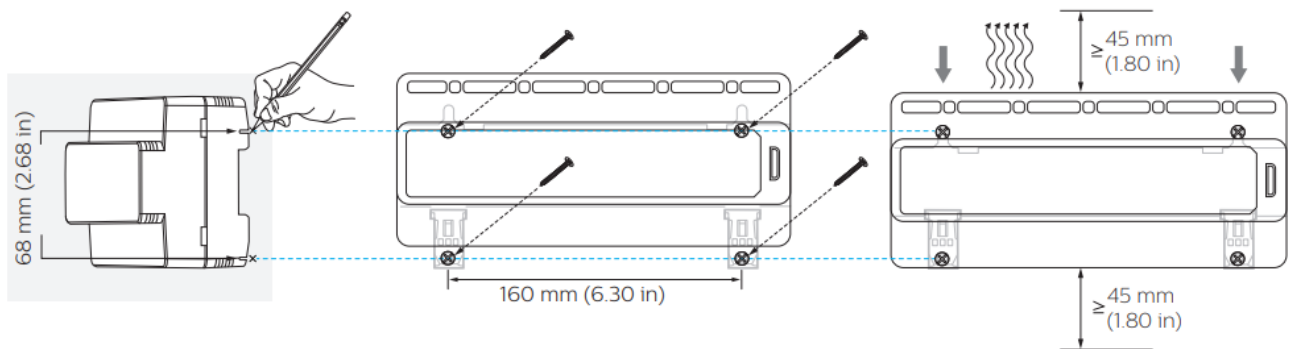

2

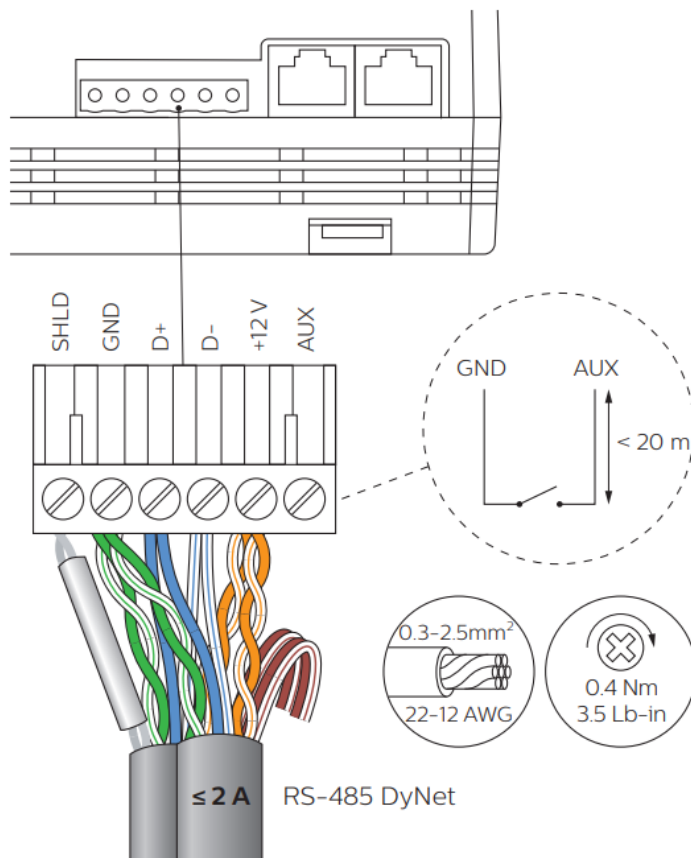

3

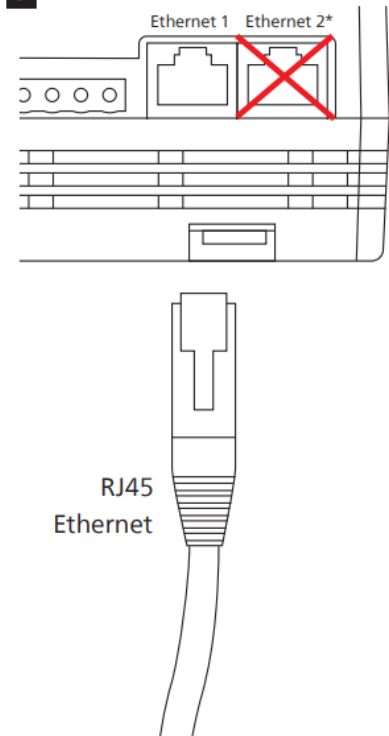

*Refer to dynamlite.com/support for port 2 availability.

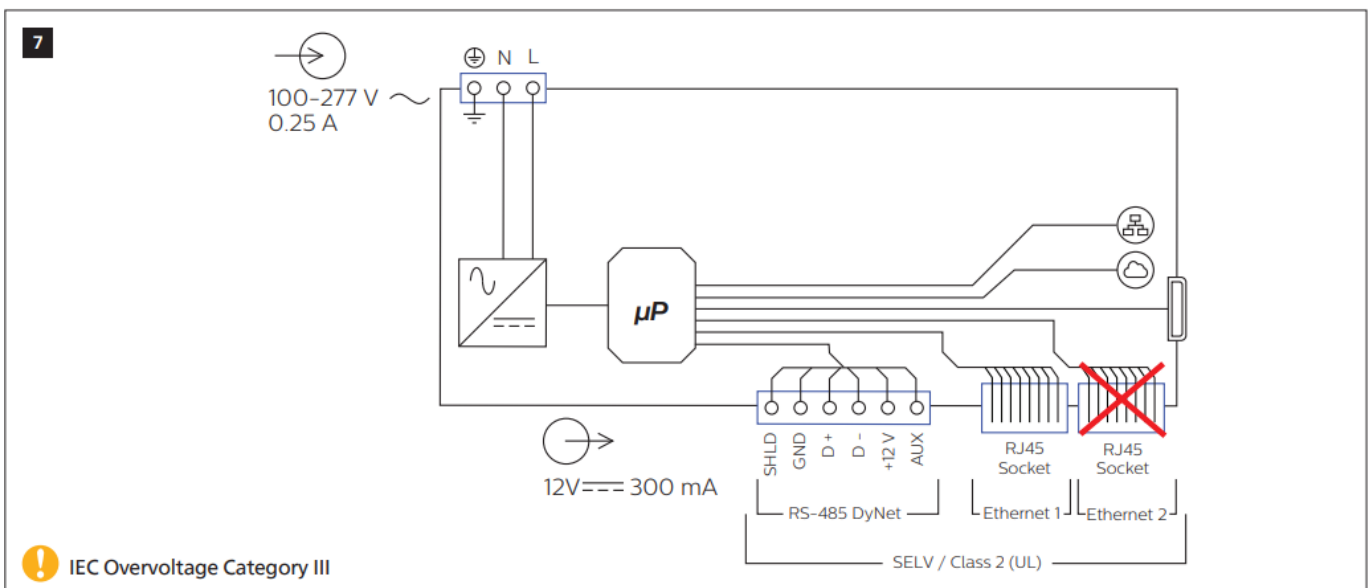
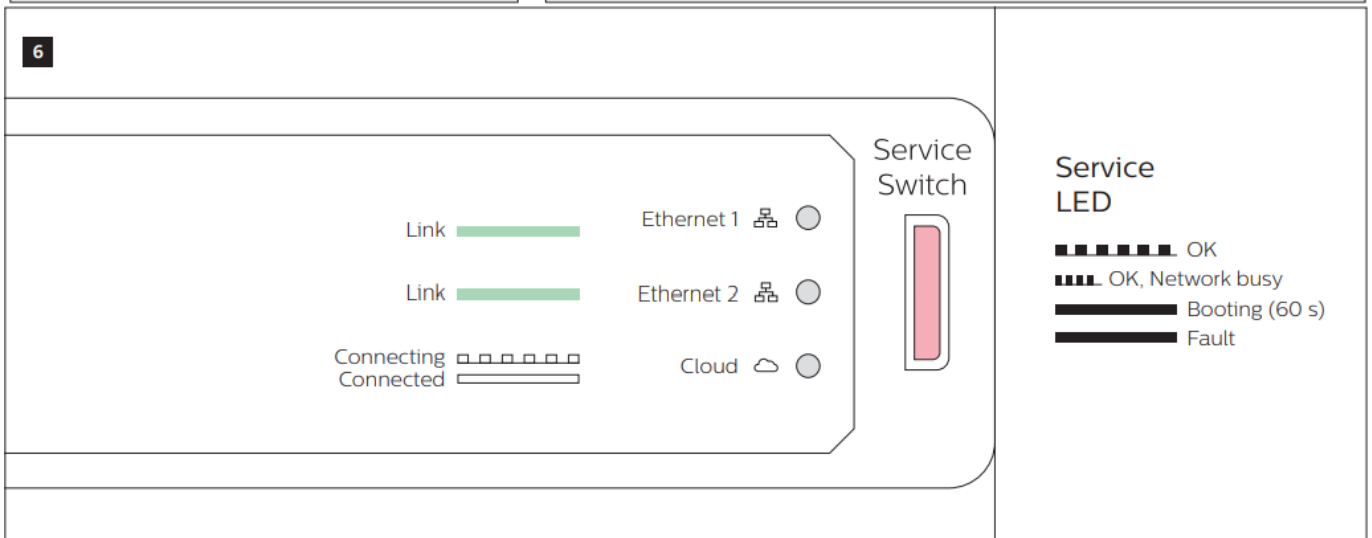
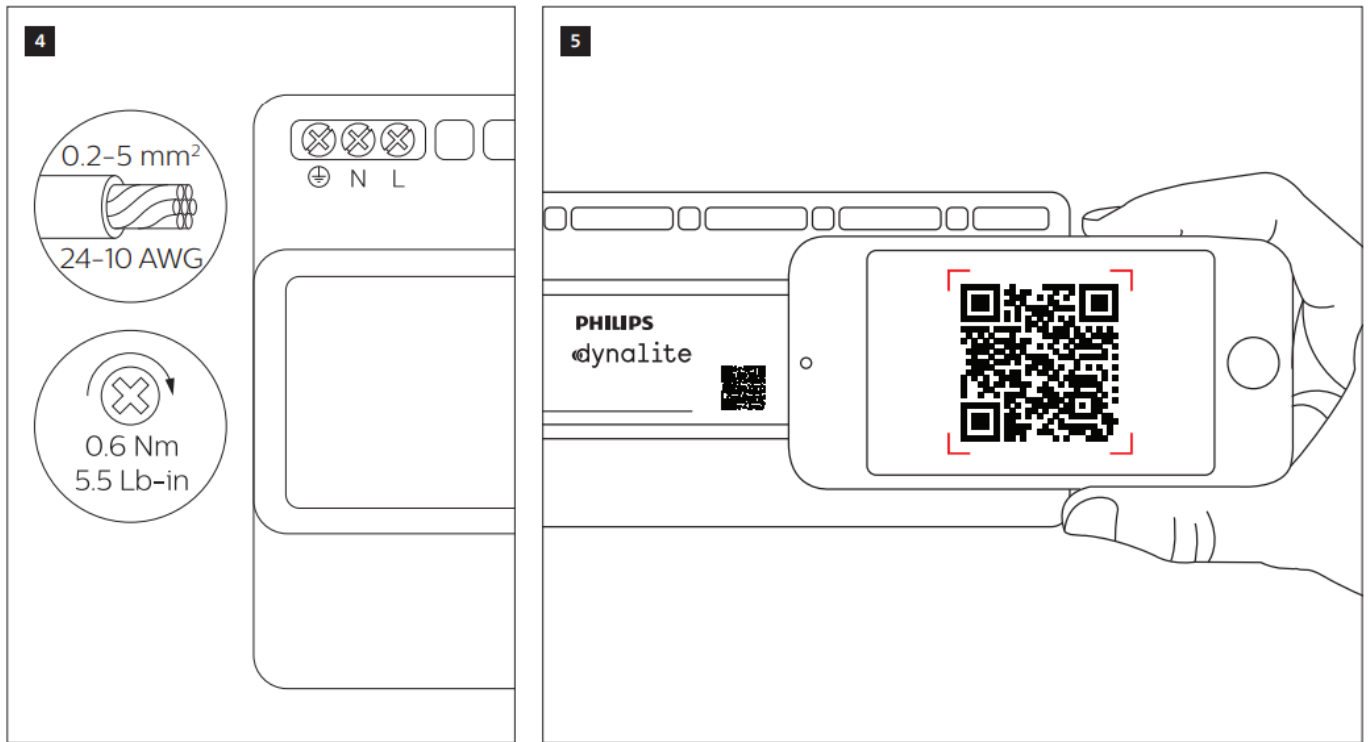

8 A BACnet Integration

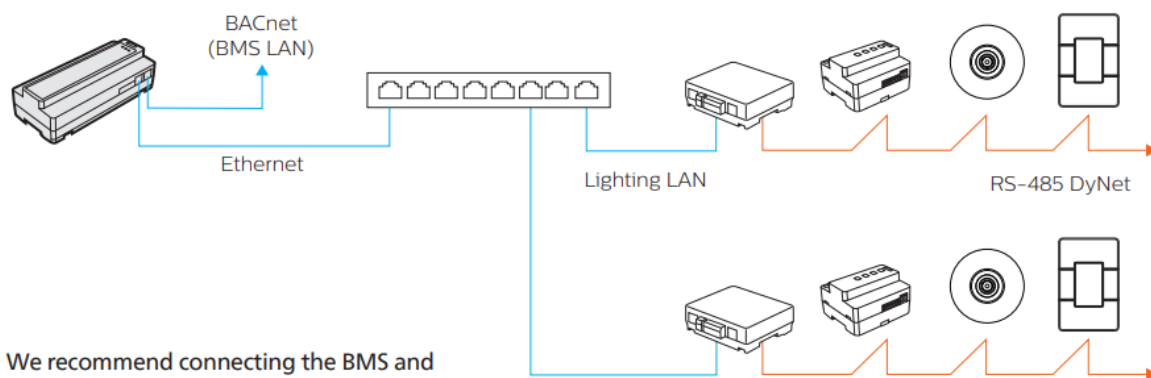

8 B

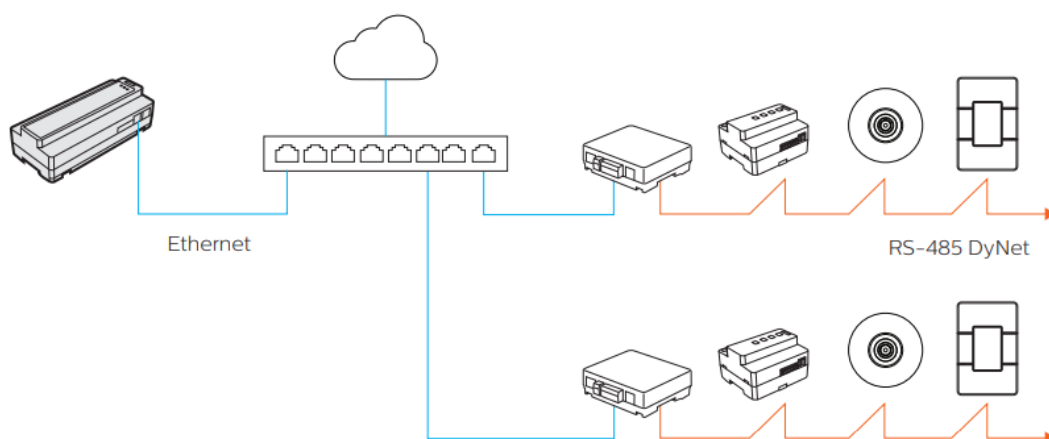

8 C

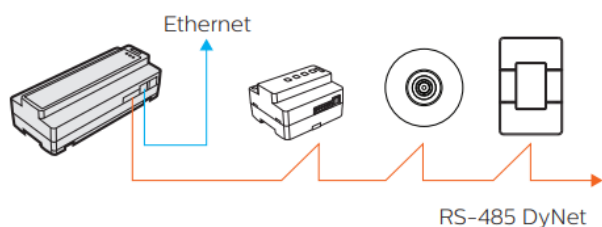

9

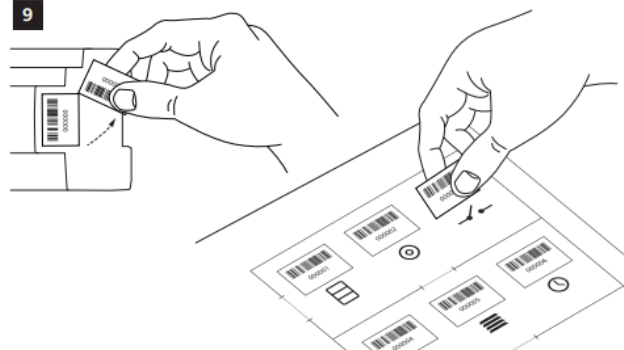

FCC and RSS-210 of IC (Industry Canada) Rules – This equipment has been tested and found to comply with the limits for a Class B digital device, pursuant to part 15 of the FCC Rules and pursuant to RSS210 of the IC Rules. These limits are designed to provide reasonable protection against harmful interference in a residential installation. This equipment generates, uses, and can radiate radio frequency energy and, if not installed and used in accordance with the instructions, may cause harmful interference to radio communications. However, there is no guarantee that interference will not occur in a particular installation. If this equipment does cause harmful interference to radio or television reception, which can be determined by turning the equipment off and on, the user is encouraged to try to correct the interference by one or more of the following measures:

- Reorient or relocate the receiving antenna.
- Increase the separation between the equipment and receiver.
- Connect the equipment into an outlet on a circuit different from that to which the receiver is connected.
- Consult the dealer or an experienced radio/TV technician for help. Any modifications not approved by the manufacturer of this device could void the user's authority to operate this device.

This Class B digital apparatus complies with Canadian ICES-003: CAN ICES-3(B)/NMB-3(B). Cet appareil numérique de la Classe B est conforme a la norme

NMB-003 du Canada: CAN ICES-3(B)/NMB-3(B).

Installation of a home and building automation and control system shall comply with IEC 60364 (all parts). The temperature limits and current-carrying capacities for the communication wires specified in IEC 60364-5-52 shall not be exceeded.

© 2024 Signify Holding. All rights reserved. Specifications are subject to change without notice. No representation or warranty as to the accuracy or completeness of the information included herein is given and any liability for any action in reliance thereon is disclaimed. Philips and the Philips Shield Emblem are registered trademarks of Koninklijke Philips N.V. All other trademarks are owned by Signify Holding or their respective owners.

www.dynalite.com

FAQ

Q: What are the temperature limits for communication wires?

A: The temperature limits and current-carrying capacities for the communication wires specified in IEC 60364-5-52 should not be exceeded during installation.

Q: What standards does the product comply with?

A: **The product complies with Canadian ICES-003:** CAN ICES-3(B)/NMB-3(B) and IEC 60364 standards for home and building automation systems.

Documents / Resources

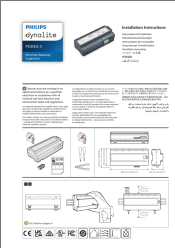
	<p>Dynalite PDDEG-S Ethernet Gateway Supervisor [pdf] Installation Guide PDDEG-S, PDDEG-S Ethernet Gateway Supervisor, Ethernet Gateway Supervisor, Gateway Supervisor</p>
---	--

References

- [Philips Dynalite Support](#)
- [Philips Dynalite - Lighting Controls, Lighting Management](#)
- [User Manual](#)

[Manuals+](#), [Privacy Policy](#)

This website is an independent publication and is neither affiliated with nor endorsed by any of the trademark owners. The "Bluetooth®" word mark and logos are registered trademarks owned by Bluetooth SIG, Inc. The "Wi-Fi®" word mark and logos are registered trademarks owned by the Wi-Fi Alliance. Any use of these marks on this website does not imply any affiliation with or endorsement.