



**PRODUCT MANUAL
BY 9 LANGUAGES**



**RECORD PLAYER
RP-11
INSTRUDUCTION MANUAL**

Contents [[hide](#)]

1 Initial Setup

2 Output Connection

3 Safety Instructions

4 Bluetooth Function

5 Gramophone

6 Documents / Resources

6.1 References

Initial Setup

1. Place the record player on a flat and level surface .The selected location should be stable and free from vibration
2. Remove the tonearm clip that is holding the tonearm.
3. Connect the DC adaptor to the Power Jack of the record player.
4. Select the correct speed of the vinyl record you played (33 3/4/78).
5. When playing the large-hole disc, place the 45 RPM Adapter into the middle.

Note: Do not plug the DC power adaptor to power outlet before all the assembly is completed Before turning the power on, make sure again all the connection settings are correct. Always turn off the power when connecting or disconnecting.

Auto stop

If the Auto-stop Switch is set to ON position, the platter will stop spinning automatically when the record plays to the end In some rare occasion, if the turntable stops playing before the end of the record, set the switch to OFF position the turntable should overcome this issue.

Output Connection

Connect to external loudspeaker or power amplifier with audio wire: Red plug connect to “R” channel output, White plug connect to “L” channel output.

Tips: please confirm the connection before playing, after the connection is good, control the volume by power amplifier audio.

Playing a record

1. Rotate the On/Off Volume Knob to turn on the power, the power led will be light.
2. Set the Function to PHONO position.
3. Select the correct speed of the vinyl record you played (33 13/45/78).
4. Place the record on the turntable. Use the 45 RPM Adapter on the record spindle if necessary.
5. Remove the stylus shield from the stylus assembly.
Note: To avoid stylus damage, make certain the included stylus shield is in place whenever the turntable is being moved or cleaned.
6. Release the tonearm Hold Down Clip. Note: When the turntable is not in use, remember to lock back hold down clip.
7. Use the Tonearm Lever to lift up the tonearm.
8. Gently move the tonearm over the record where play is desired to begin. Set the Tonearm Lever back to the down position, the tonearm will descend slowly onto the record and begin to playback.
9. When the record is finished playing, use the Tone arm Lever again to raise the tonearm and then return it to the Tonearm Rest. Release the lever to let the tonearm sit back at its rest. To suspend the playback, repeat the same steps.
10. Lock the Hold Down lip to secure the tonearm.



To avoid fire or vibration, don't extend the power cord or use other socket, make sure to insert the contact piece of the plug into the hole completely.

Safety Instructions

1. Choose a safe location and do not use this product near water or heat source.
2. Do not attempt to service this product yourself as opening or removing covers may expose you to dangerous voltage or other hazards. Refer all servicing to qualified

service personnel.

3. Do not use attachments not recommended by the product manufacturer as they may cause hazards.
4. Unplug the product during lightning storm or when unused for long periods of time.
5. Do not move the power cord randomly or squeeze the plug.
6. Do not attempt to clean the unit with chemical solvent as this might damage it. Using a clean & dry cloth is recommended for cleaning.
7. Before starting the machine, please confirm whether the plug is fully plugged in.
8. Please unplug the power before moving the player.

Bluetooth Function

1. Set the Function to BT position.
2. Turn on the Bluetooth feature of your audio device, search for “RPBT” and pair.
3. Once your device is successfully paired with the unit, you will hear “Ding Dong”
4. Play and control music from your device to the record player.

Line In Function

1. Set the Function to LINE IN position.
2. Connect your iPad, MP3 player, mobile phones etc to the AUX IN port with a 3.5mm audio cable (not included).
3. Rotary the volume knob to adjust the volume. (iPad, MP3 player, mobile phones volume control may also impact the volume level so ensure that it is also turned up.)

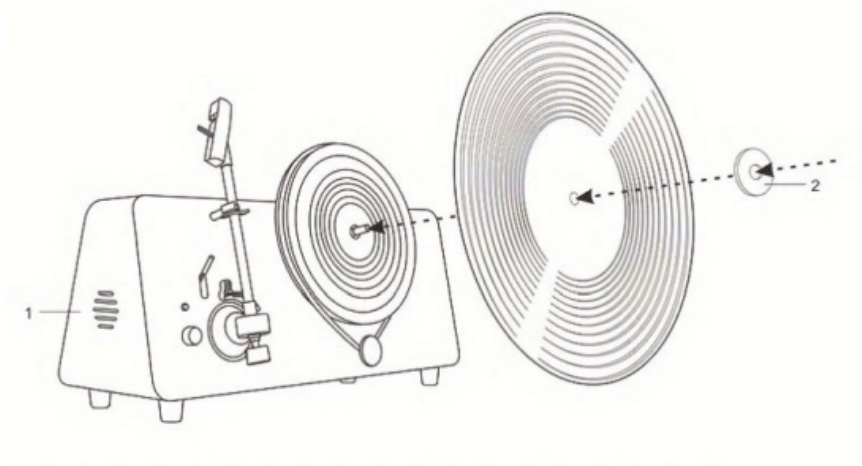

1. Speaker

2. Fixed device/45 RPM adapter

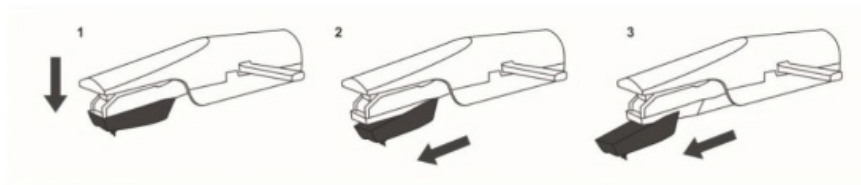

Needle Replacement

Removing Needle

1. Gently pull down the front edge of the needle.
2. Pull needle forward.
3. Pull out and remove.

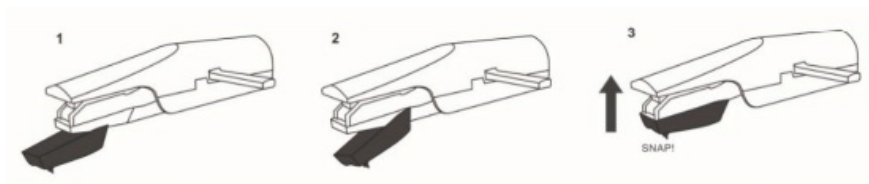

Installing Needle

1. Position the needle with its tip facing down.
2. Line up the back of the needle with the cartridge.
3. Insert the needle with its front end at a downward angle and gently lift the front of the needle upward until it snaps into place.

Gramophone

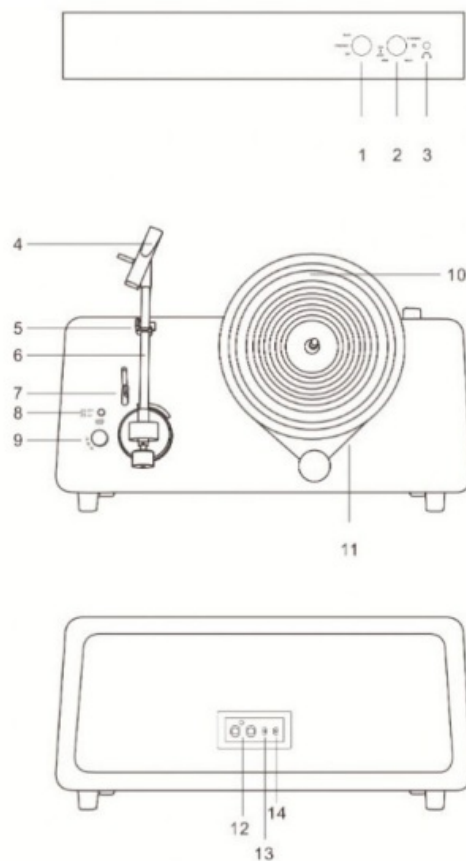

1. Function keys(LINE IN,PHONO, BT)
2. Power volume switch
3. Head Phone Jack
4. Stylus Needle
5. Hold Down Clip
6. Tonearm
7. Tonearm Lever
8. Automatic stop switch
9. Speed Switch (33 1/3/45/78)
10. Turntable Platter
11. Belt
12. LINE OUT audio output interface
13. AUXIN Jack
14. DC IN power Jack

Manufacturer Information

Manufacturer: Dybala Tech Co., Ltd.

Address: Unit 2,Building 13,NEW Century Yilongwan,NO.2,Yilong East Road, Gaobu
Town, Dongguan City, Guangdong Provice, China

Documents / Resources

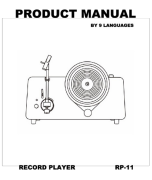
	Dybala RP-11 Record Player [pdf] Instruction Manual 2BMPO-RP11, 2BMPORP11, rp11, RP-11 Record Player, RP-11, Record Player, Player
-----------------------------------------------------------------------------------	-------------------------------------------------------------------------------------------------------------------------------------------------------

References

- [User Manual](#)

2BMPO-RP11, 2BMPORP11, Dybala, player, Record Player, RP-11, RP-11 Record Player,

Dybala rp11

Leave a comment

Your email address will not be published. Required fields are marked *

Comment *

Name

Email

Website

☐ Save my name, email, and website in this browser for the next time I comment.

Post Comment

Search:

e.g. whirlpool wrf535swhz

Search

[Manuals+](#) | [Upload](#) | [Deep Search](#) | [Privacy Policy](#) | [@manuals.plus](#) | [YouTube](#)

This website is an independent publication and is neither affiliated with nor endorsed by any of the trademark owners. The "Bluetooth®" word mark and logos are registered trademarks owned by Bluetooth SIG, Inc. The "Wi-Fi®" word mark and logos are registered trademarks owned by the Wi-Fi Alliance. Any use of these marks on this website does not imply any affiliation with or endorsement.