



## DURATECH PL-REM Controller User Manual

[Home](#) » [DURATECH](#) » DURATECH PL-REM Controller User Manual 

# ***DuraTech***®

Manual  
PL-REM



LINK Driver

## Contents

- 1 Technical specifications
- 2 Box contents
- 3 Installation instructions
- 4 Pairing handheld transmitter & controller
- 5 Handheld transmitter functions
- 6 Change Relay A/B mode
- 7 Troubleshooting
- 8 Declarations of Conformity
- 9 Contact details
- 10 Documents / Resources
  - 10.1 References
- 11 Related Posts

## Technical specifications

### Electrical specifications

Nominal Input voltage Max rating Relay Contacts “Color Light”, “A” and “B” Resistive Load Inductive Load Frequency band transmitter IEC Protection Class	230 VAC 50 Hz 14A 250VAC 14A 30VDC 6A 250VAC 6A 30VDC 868 MHz Class II 
--	--

### General specifications Controller

Ambient air temperature Humidity Dimensions Weight Ingress protection rate	0°C ... +40°C 10% ... 90% RH non condensing 150x157x51 mm 500 g IP54
--	---



For operation only with 12VAC safety isolation transformer to power Spectravision ® LED Pool Lights

## Box contents

1. PL-REM controller
2. Handheld transmitter (Dural ink™ version)

3. Spare battery (type A23 12V)
4. Screws (4x) & wall plugs (4x)
5. Owner's manual

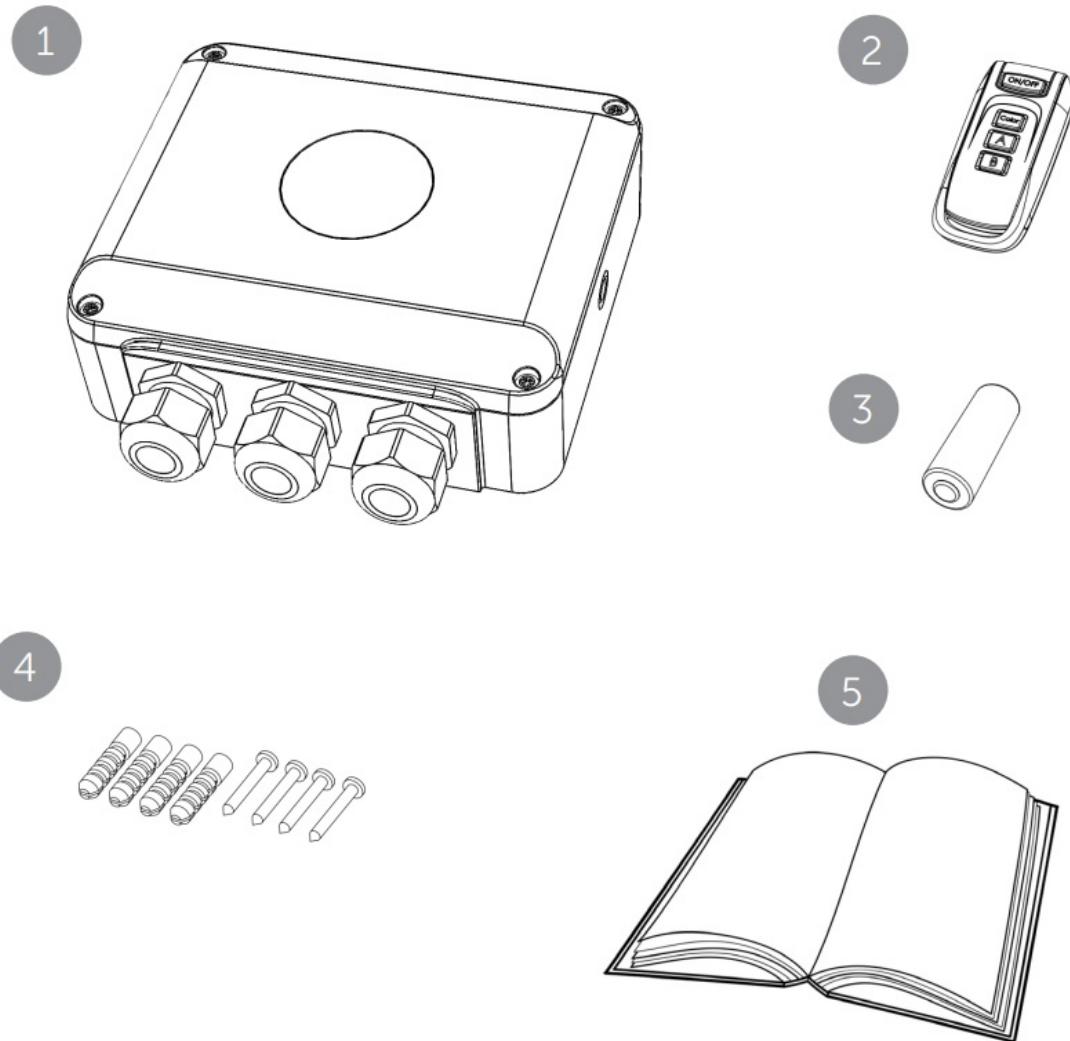

## Installation instructions

### Option 1: PL-REM in transformer primary

- Connect a 230VAC power source to the “220-240VAC INPUT” terminal
- Connect the primary circuit of a 12VAC transformer (sold separately) in series with the “Color Light” terminal of the PL-REM.

Optional: The “Switch A” & “switch B” terminals can be used to control auxiliary circuits like a pool cover or garden lights.



The “Color Light” relay contact has an output of 14A, which can drive a 12V transformer of max. 3000W (220Vx14A).

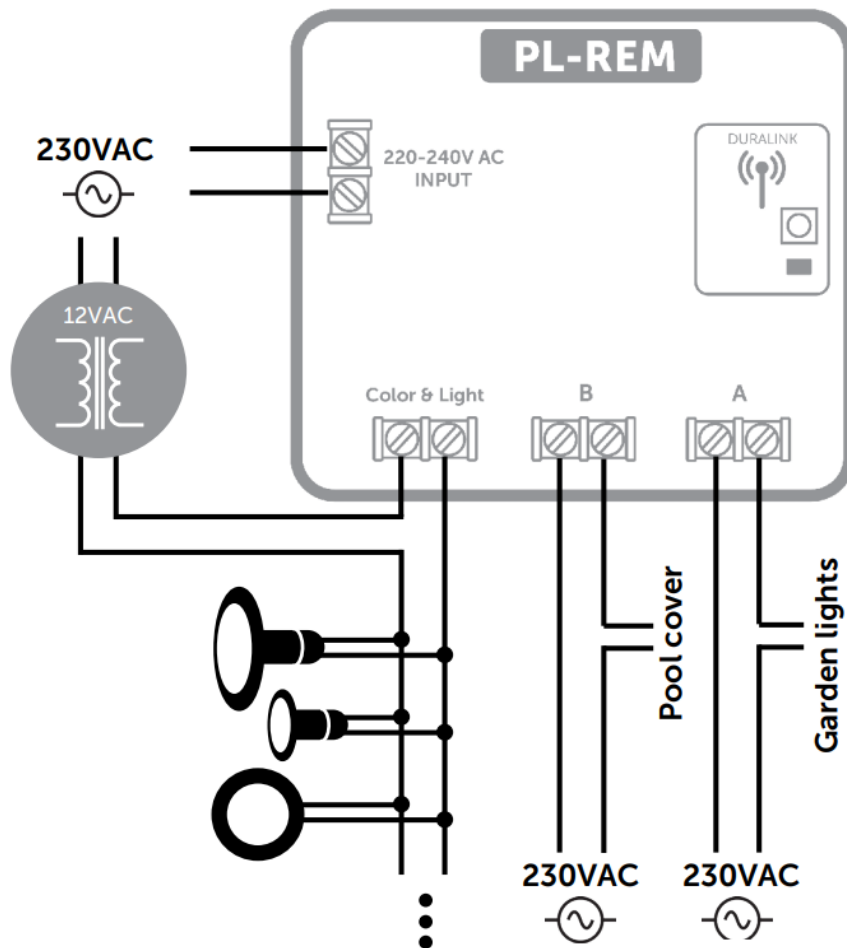

#### Option 2: PL-REM in transformer secondary

- Connect a 230VAC power source to the "220-240V AC INPUT" terminal
- Connect the secondary circuit of a 12VAC transformer (sold separately) in series with the "Color Light" terminal of the PL-REM.

Optional: The "Switch A" & "switch B" terminals can be used to control auxiliary circuits like a pool cover or garden lights.



The "Color Light" relay contact has an output of 14A, or 170W on a 12V transformer secondary (14Ax12V). The total load of pool lights can not exceed this.

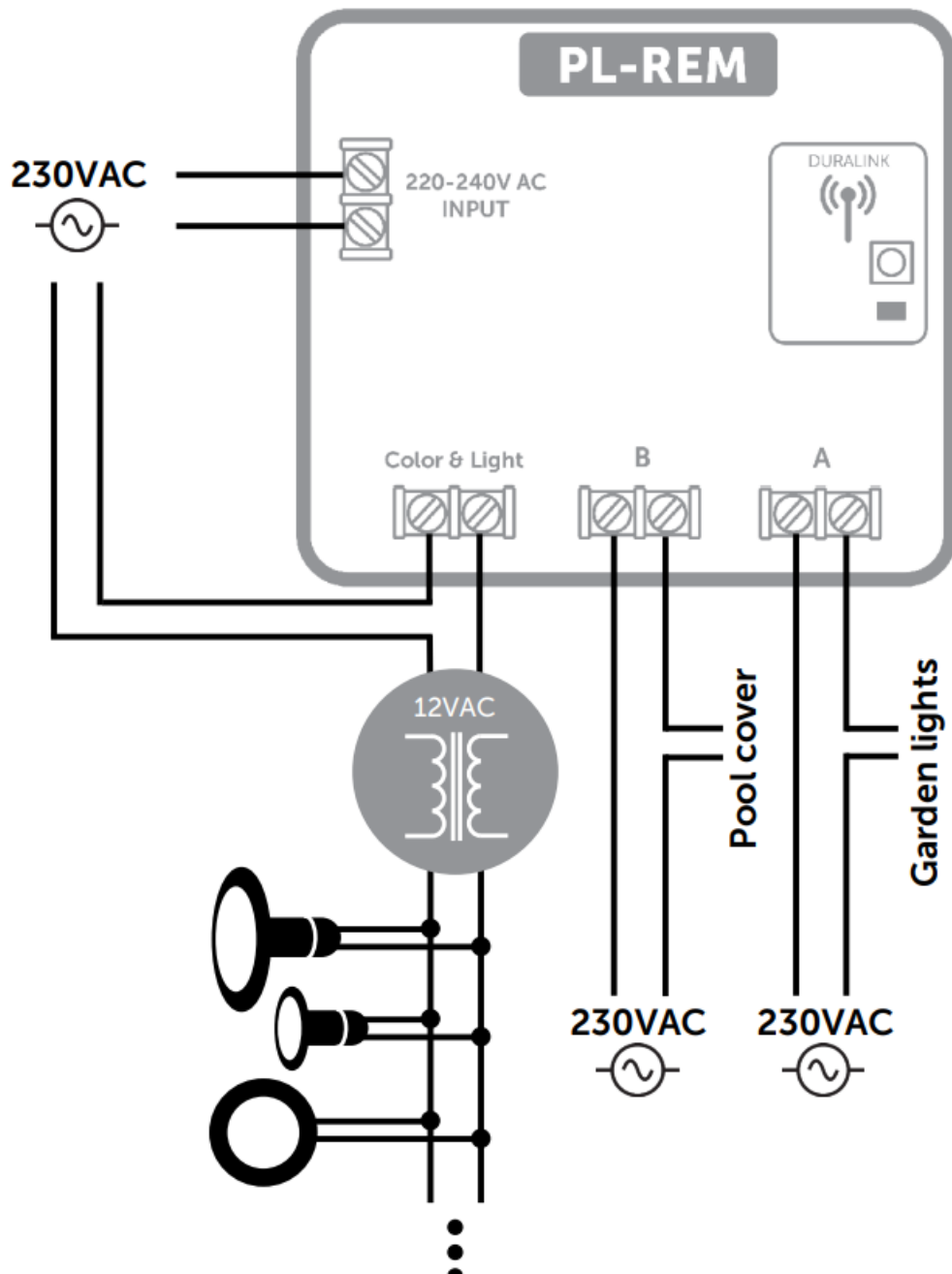

## Pairing handheld transmitter & controller

The handheld transmitter is already paired in the factory and ready to use. The PL-REM can pair with up to 6 handheld transmitters. In case a problem arises, the pairing process can be done manually:

### Manual Pairing process:

Make sure the PL-REM is connected to a power source.

1. Press the pairing button on the small circuit board, inside the controller for at least 5 seconds. → The LED will start to blink fast
2. Within 25 seconds, press any button on the handheld transmitter.
  - If the transmitter is paired correctly, the LED will flash slowly for 5 times
  - If the PL-REM pairing memory is full, the LED will flash 15 times.

This means 6 handheld devices have already been paired.

To unpair all handheld transmitters with the controller: Push the pairing button for at least 5 seconds, then do nothing for at least 25 seconds.

→ The pair memory will be erased – the green LED will flash 5x on/off.



If no transmitters are paired, the PL-REM-200 will accept messages from any transmitter!

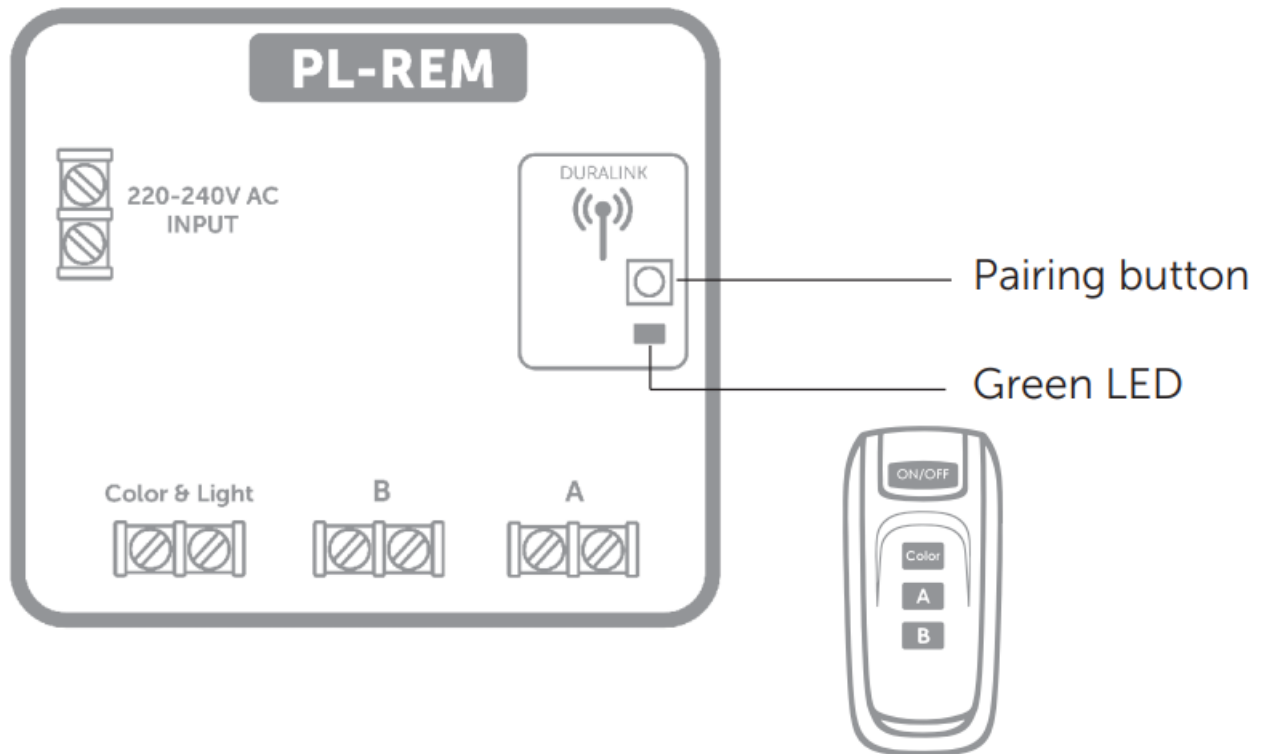

### Handheld transmitter functions

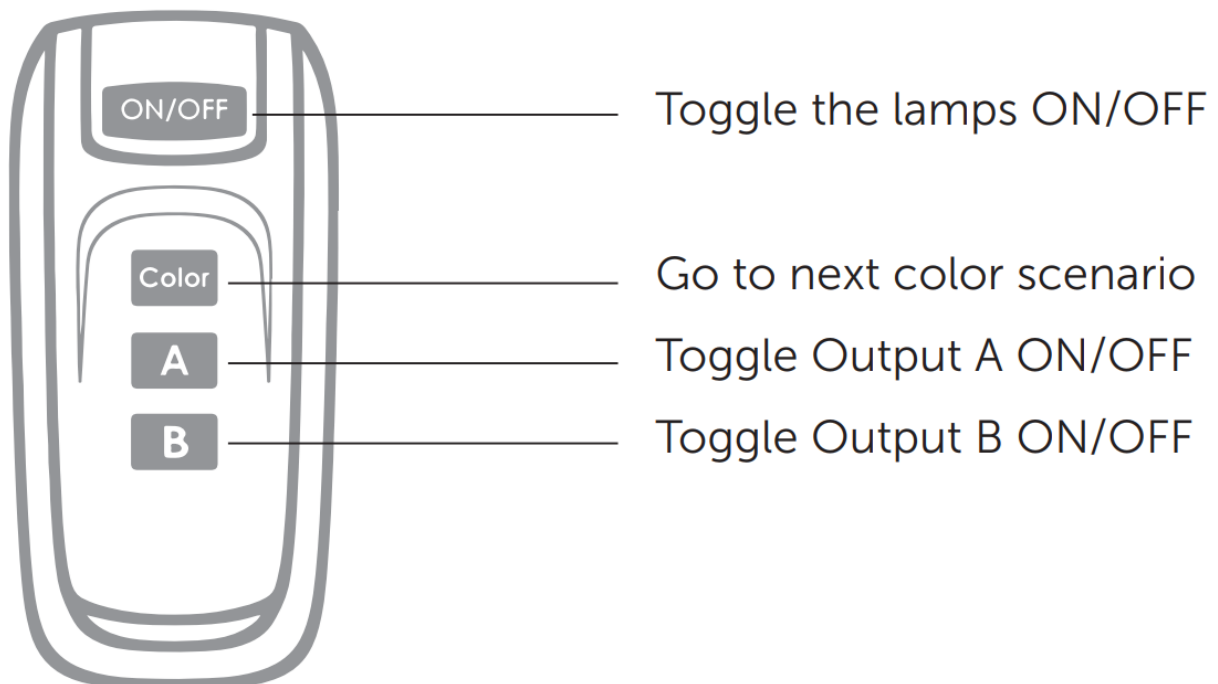

### Replacing transmitter battery

- Remove the philips head screw and open the transmitter
- Replace the battery, respecting the polarity

Battery type: A23 12V

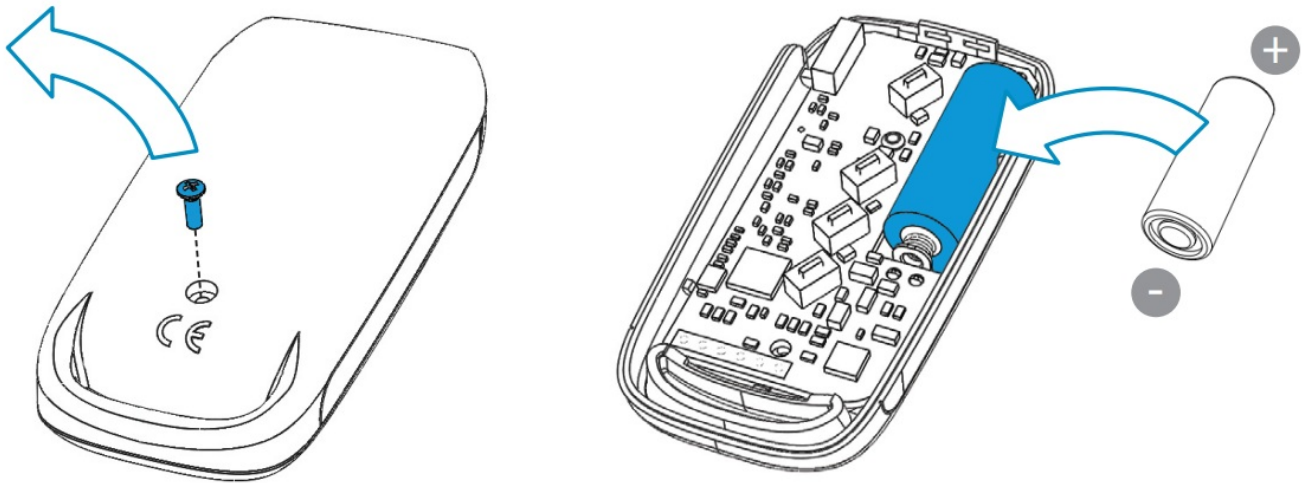

## Change Relay A/B mode

The relays A & B can be used to control auxiliary circuits like garden lighting or a pool cover.

The operation mode of these relays can be modified:

Option 1: Normal open/closed contact

Option 2: Pulsed contact

### Modification process:

1. Locate the 5 pinholes on the circuit board
2. Make a connection between pin 1 and 2 (use a piece of wire, or a paperclip)
3. Power ON the device by connecting a 230VAC power source to the 220-240VAC INPUT terminal
4. Power OFF the device
5. Remove the connection between pin 1 and 2 Every time the above process is repeated, the A & B relays switch between Normal open/closed mode and Pulsed operation mode

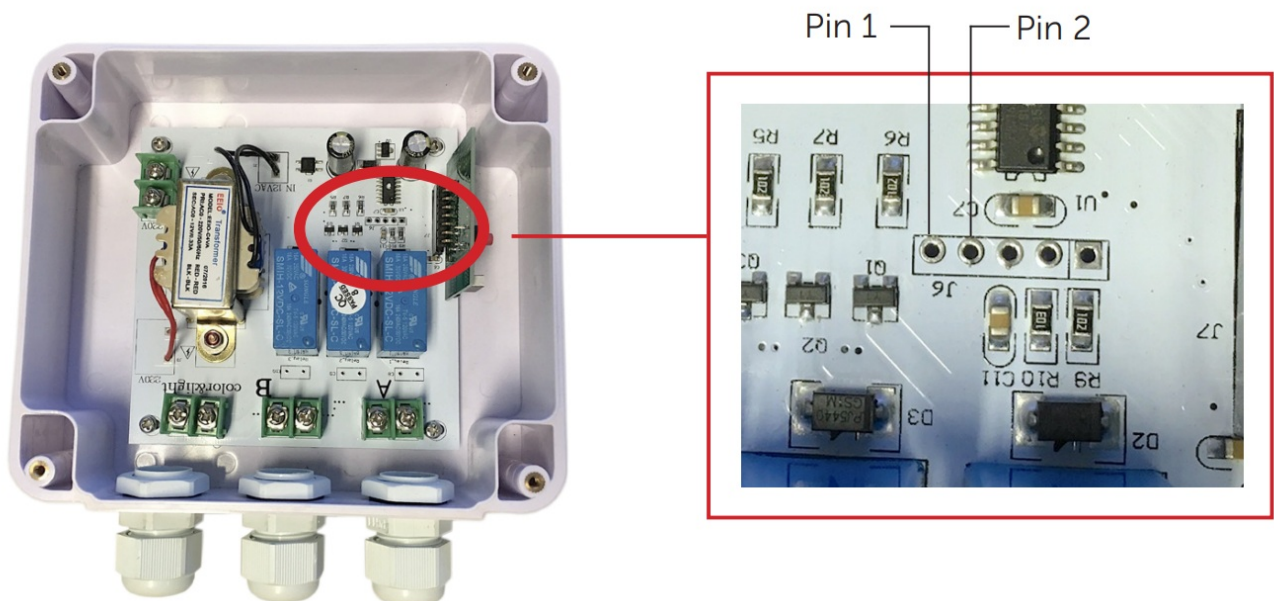

## Troubleshooting

PROBLEM	SOLUTION
The controller doesn't react to transmitter commands	<ul style="list-style-type: none"> <li>•Check the battery of the handheld transmitter</li> <li>•The transmitter is not paired correctly with the controller. Repeat the pairing process</li> <li>•Reduce the distance between handheld transmitter and PLREM and/or remove obstacles</li> </ul>
The pool lights don't work	<ul style="list-style-type: none"> <li>•Check if all connections are made according to the electrical scheme on page 5 or 6.</li> <li>•Check if the "Color Light" output terminals of the controller switch on and of when pushing the on/off button on the transmitter.</li> </ul>

## Declarations of Conformity

Declarations of conformity covering this product are available for download from the House of Eurotech website:  
[www.duratech.be](http://www.duratech.be)

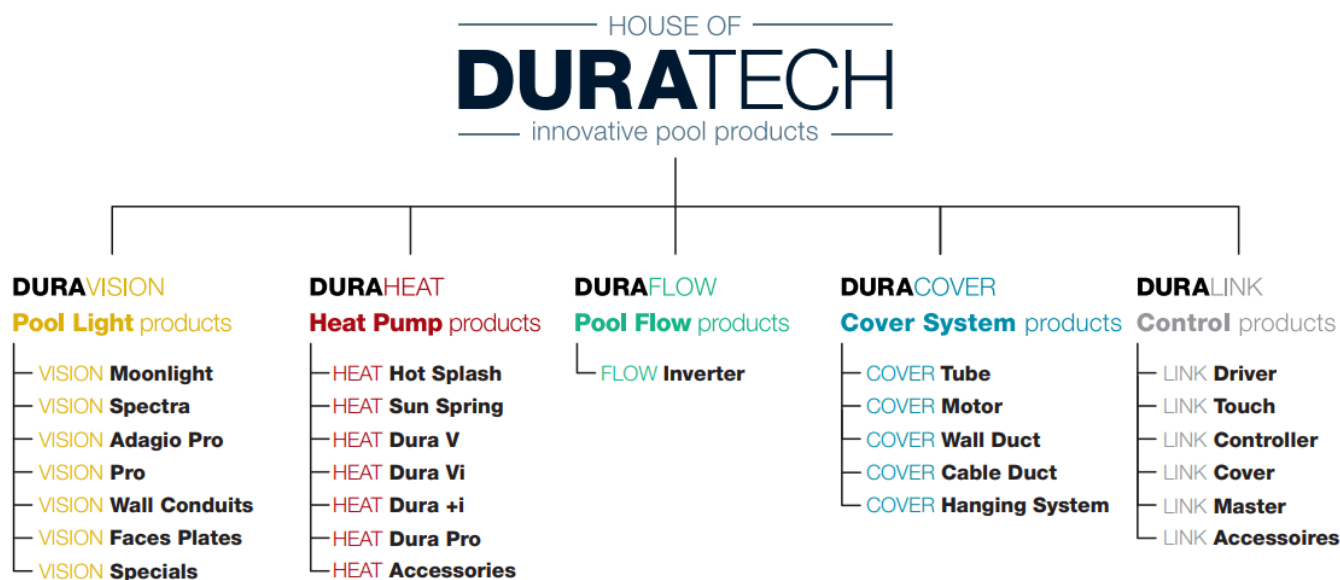

## Contact details

### Propulsion Systems bv

Doormen 72

1785 Merchets, Belgium

Tel +32 2 461 02 53

[www.duratech.be](http://www.duratech.be)

[info@propulsionsystems.be](mailto:info@propulsionsystems.be)





<http://www.propulsionsystems.be>

DURA LINK



We reserve the rights to change all or part of the contents of this document without prior notice  
402-0248-2

## Documents / Resources

	<p><a href="#">DURATECH PL-REM Controller</a> [pdf] User Manual PL-REM, Controller, PL-REM Controller</p>
--	---

## References

- [Duratech | Home](#)

[Manuals+](#).