

Duclsaty Ceiling Fan No Light with Remote Control



Duclsaty Ceiling Fan No Light with Remote Control Instruction Manual

[Home](#) » [Duclsaty](#) » Duclsaty Ceiling Fan No Light with Remote Control Instruction Manual 

Contents

- [1 Duclsaty Ceiling Fan No Light with Remote Control](#)
- [2 Product Usage Instructions](#)
- [3 Safety Precautions](#)
- [4 Pre-Installation](#)
- [5 SPECIFICATION](#)
- [6 Installation](#)
- [7 Remote Control \(Emitter \) Operation](#)
- [8 Remote Control](#)
- [9 TroubleShooting](#)
- [10 Quick Answers to common Questions](#)
- [11 Documents / Resources](#)
 - [11.1 References](#)

Duclsaty

Duclsaty Ceiling Fan No Light with Remote Control



Specifications

- Model: Mounted Ceiling Fan No Light

- Version: General
- Type: Ceiling Fan
- Power Supply: AC
- Installation: Mounted (Ceiling)

Product Usage Instructions

Safety Precautions

1. Installation and electrical connections should be performed by a qualified electrician.
2. Ensure the fan power supply is switched off at the circuit breaker box and wall switch before installation.

Pre-Installation

Tools Needed

- Wood Ceiling Screws (4)
- Concrete Ceiling Screws (2)
- Blades Screws (6)
- Bracket Screws (4)
- Cap (4)

Installation Kit

Part Description:

- AA Wood Ceiling Screws
- BB Concrete Ceiling Screws
- CC Blades Screws
- DD Bracket Screws
- EE Cap

Installation

Step 1 (Ceiling Bracket Installation)

Turn off the fan power supply at the circuit breaker box and wall switch.

Choose the appropriate installation method based on the roof type.

Step 2 (Wiring Installation)

Connect wires according to polarity. House power cord colors may vary.

Arrange the receiver into the wires and tighten screws.

Step 3 (Blades and No Light Cover Installation)

Align and fix blades with mounting holes using screws.

Step 4 (Switch On and Test)

Switch on the fan and test its operation.

Remote Control Operation

If the remote control doesn't work:

1. Check battery installation and charge. Replace if needed.
2. Avoid interference from similar frequency remote controls nearby.
3. Press and hold buttons within 10 seconds of powering on until you hear two beeps.

FAQ

What should I do if the ceiling fan does not turn on after installation?

If the fan does not turn on post-installation, check the wiring connections and power supply. Ensure the circuit breaker is on and the wall switch is in the 'on' position.

Can I install this ceiling fan on a sloped ceiling?

This ceiling fan is suitable for installation on flat or sloped ceilings. Ensure proper support and follow installation instructions carefully.

General Version for Mounted Ceiling Fan No Light

Ceiling Fan

Installation Instructions

Retain this manual for future use

We appreciate the trust and confidence you have placed in us through the purchase of this ceiling fan.

We strive to continually create quality products designed to enhance your home.

Thank you for choosing us!

Safety Precautions

The information contained in the following pages has been prepared to ensure your maximum enjoyment of your fan

Please remove the fuse or turn off the circuit breaker to cut off the power before installing the fan. Ensure all electrical connections are in compliance with local laws, regulations and national electrical codes. If you are not familiar with electrical installation and wiring, please hire a qualified electrician or consult the wiring manual.

1. For your safety, all electrical connections and disconnections should be performed by a qualified electrician.
2. Any action performed for the electrical connection of the device must be carried out after ensuring that the general power supply is disconnected, by removing the corresponding fuse or disarming the protective switch in order to ensure total isolation of the power supply.
3. When deciding where to mount the fan, be sure that there is at least 30 inches (76 cm) of space between the fan and any wall or other obstruction that the fan blades could collide with. The greater this distance, the more effective the air flow produced. After the fan is mounted, be sure that the blades are no less than 7ft (2.1 m) above the ground.
4. The anchor point for the fan must be able to support a weight of at least 100 pounds (45 kg). If mounting on a

ceiling junctionbox, be sure that the fan is adequately supported to prevent loosening or turning.

5. The fan's electrical connection must be "grounded" (the fan's ground cable connected to the installation's grounding network) in order to avoid any branching that may be dangerous to people.
6. Do not connect the fan's power supply to any dimmers, potentiometers, or light switches, as it will cause the fan to malfunction and/or will damage the motor. The fan must be directly connected to a properly protected installation circuit (magnetothermal differential switch with the adequate size for the fan's consumption and technical specifications). Only use the fan's control to turn it on or stop it.
7. It is recommended to not use these types of fans along with gas installations simultaneously in the same room.
8. The fan must not be moving and must have come to a complete stop before changing its direction of rotation. This will prevent damage to its motor and to the control unit, when applicable.
9. Do not insert anything that could hit the fan's blades into its pathway while it is moving, as this could cause damage to people, can damage the blades, and can offset the balance of the unit, causing vibrations and wobbling.
10. After installing the fan, ensure that all fastenings are secure and tightened in order to avoid any noise caused by loose elements.
11. Due to the fan's movement, certain fastenings may become loose. Check all fastenings twice per year at a minimum in order to ensure that they are sufficiently tight. If necessary, they must be retightened.
12. The motor housing can be cleaned with a soft brush or a lint-free cloth to avoid scratching the surface. Clean the blades with a lint-free cloth. Important: Turn off the main power supply before starting any maintenance. Do not clean the fans with water or a damp cloth.

Note: The important warnings and instructions indicated in this manual are not guaranteed to cover all possible conditions and situations that may occur. It must be understood that common sense, precaution, and care are factors that cannot be included in all products. These factors can and must only be provided by the user who maintains and enjoys this fan.

Warranty

The manufacturer warrants the fan motor to be free from defects in workmanship and material present at time of shipment from the factory for a period of lifetime after the date of purchase by the original purchaser.

The manufacturer warrants the light kit (excluding any glass), to be free from defects in workmanship and material at the time of shipment from the factory for a period of three years after the date of purchase by the original purchaser. The manufacturer also warrants that all other fan parts, excluding any glass or acrylic blades, to be free from defects in workmanship and material at the time of shipment from the factory for a period of one year after the date of purchase by the original purchaser. We agree to correct such defects without charge or at our option replace with a comparable or superior model if the product is returned. To obtain warranty service, you must present a copy of the receipt as proof of purchase. All costs of removing and reinstalling the product are your responsibility. Damage to any part such as by accident, misuse, improper installation or by affixing any accessories, is not covered by this warranty.

Because of varying climatic conditions this warranty does not cover any changes in brass finish, including rusting, pitting, corroding, tarnishing or peeling. Brass finishes of this type give the longest useful life when protected from varying weather conditions. A certain amount of "wobble" is normal and should not be considered a defect. Servicing performed by unauthorized persons shall render the warranty invalid.

There is no other express warranty. We hereby disclaim any and all warranties, including but not limited to those of merchantability and fitness for a particular purpose to the extent permitted by law. The duration of any implied warranty which cannot be disclaimed is limited to the time period as specified in the express warranty. Some states do not allow limitation on how long an implied warranty lasts, so the above limitation may not apply to you. The retailer shall not be liable for incidental, consequential, or special damages arising out of or in connection with product use or performance except as may otherwise be accorded by law. Some states do not allow the exclusion of incidental or consequential damages, so the above exclusion or limitation may not apply to you.

This warranty gives specific legal rights, and you may also have other rights which vary from state to state. This warranty supersedes all prior warranties. Shipping costs for any return of product as part of a claim on the warranty must be paid by the customer.

Pre-Installation

Tools Needed

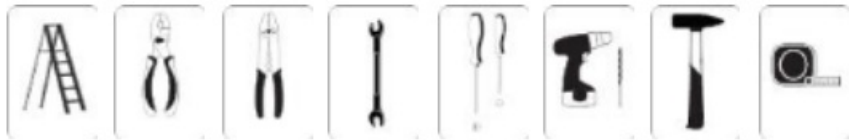

Installation kit

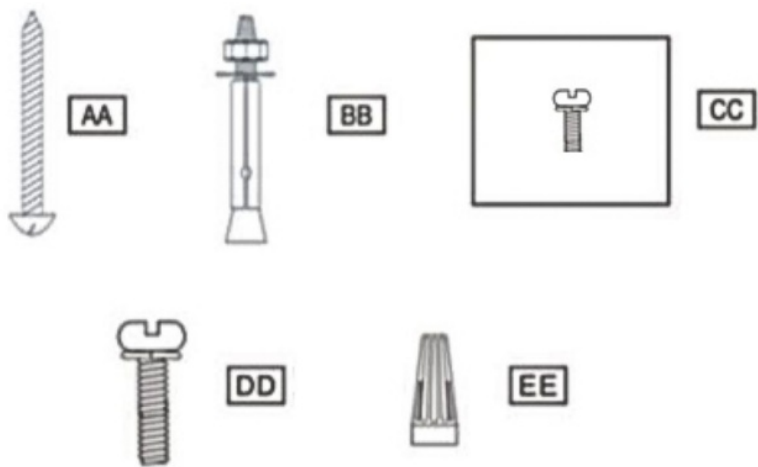

Part	Description	Quantity
AA	Wood Ceiling Screws	4
BB	Concrete Ceiling Screws	2
CC	Blades Screws	6
DD	Bracket Screws	4
EE	Cap	4

CC&DD are pre-installed in the fan Body/Motor

SPECIFICATION

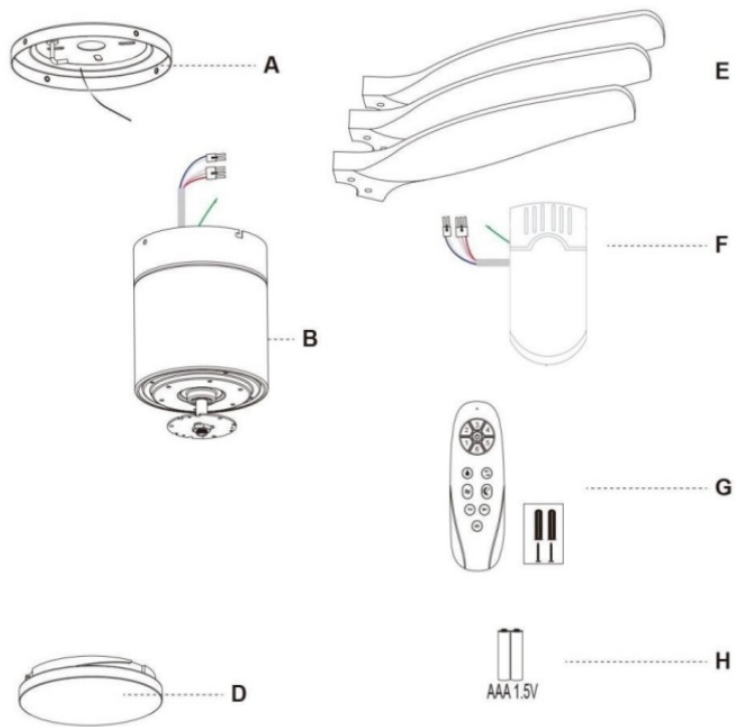

Part	Description	Quantity
A	Ceiling Bracket	1
B	Body/Motor	1
D	Lightless Cover	1
E	Blades	3
F	Receptor	1
G	Remote Control	1
H	Remote Control Batteries	2
* Remote Control for the ceiling fan excludes Batteries		

Installation

Step 1 (Ceiling bracket installation and fan into the installed Bracket.)

1. Turn off the fan power supply at the circuit breaker box and the wall switch.

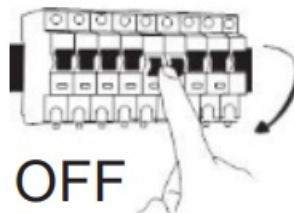

2. Choose the following installation methods according to the actual situation of the roof.

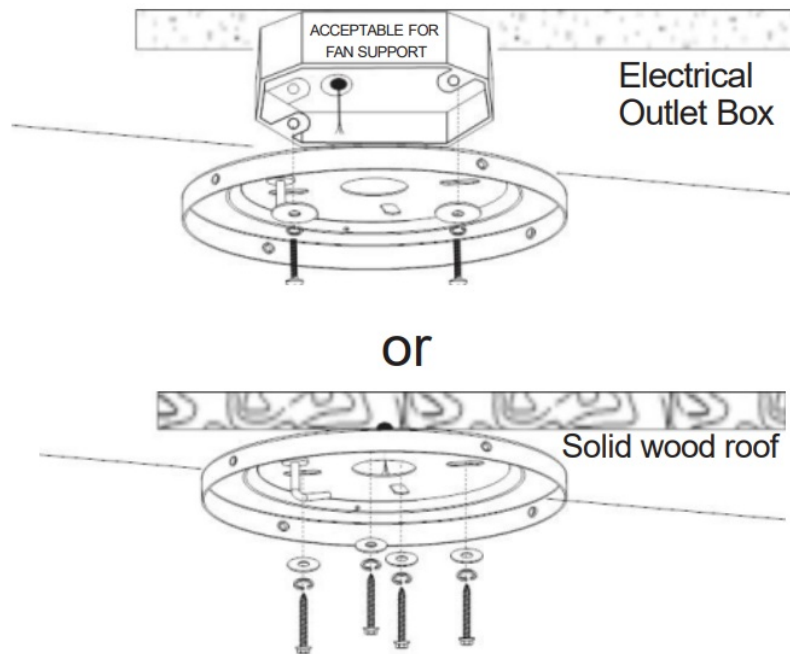

Step 2 (Wiring and fan into the installed Bracket.)

1. Connect the wires according to the polarity (the color of the House power cord may be different if the color is the same).

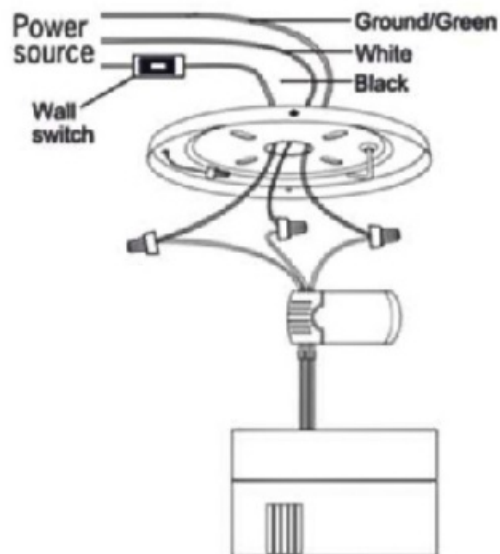

2. Put the receiver into the Bracket and arrange the wires

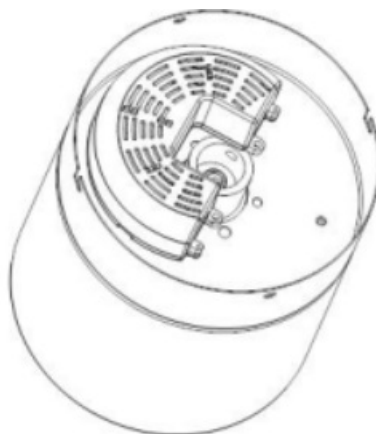

3. Remove two separated pre-lock screws from Bracket, and loosen the other two (no need to take them out)

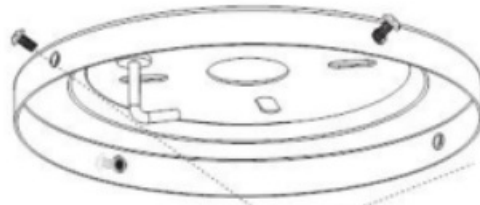

take out

4. Remove the body from the Bracket hook, lift and rotate the it to make the seven-character slot of the body is hung on the two nails on the Bracket

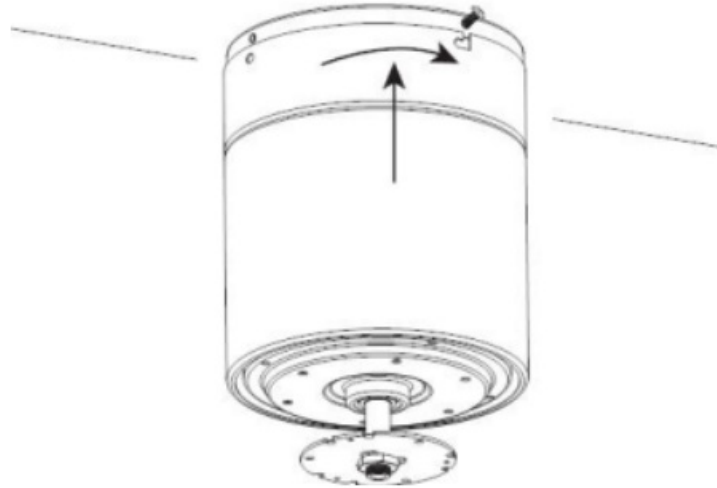

5. Tighten the screws



Step 3 (Blades and No Light Cover installation)

1. Align the connected blade with the mounting hole, and then fix it with screws.

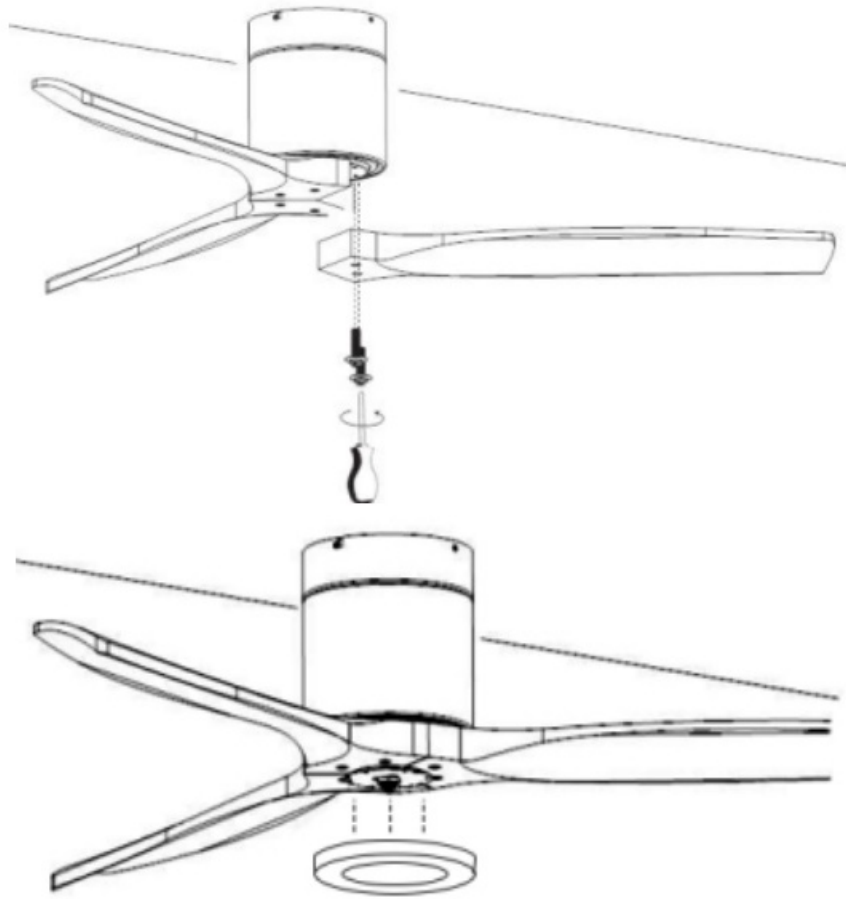

2. Installation of No light cover

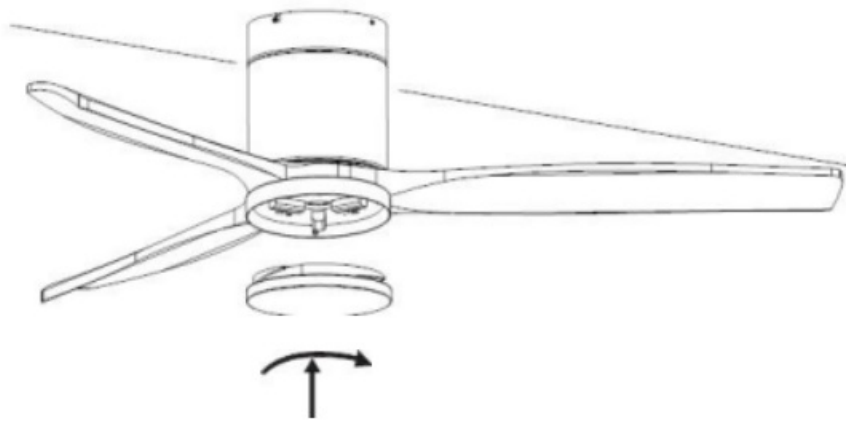

Step 4 (Switch on and ceiling fan works)

ON

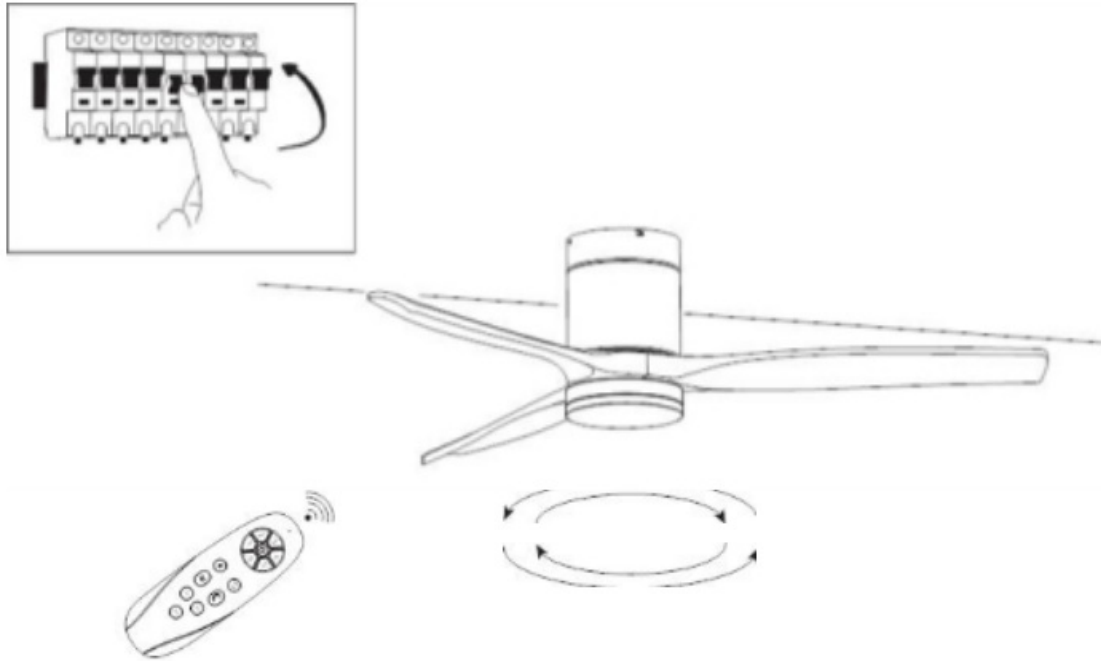

Remote Control (Emitter) Operation

If emitter can not control the fan

1. Please check whether the battery is installed correctly and whether it is charged. If necessary, replace the remote control battery.
2. Please check if there are similar remote control products working nearby, because remote control products of the same frequency will interfere with each other.
3. Please press and hold the “1” and “2” buttons at the same time within 10 seconds after the product is powered on, until you hear two beeps to succeed.

If it doesn't work. please try again.

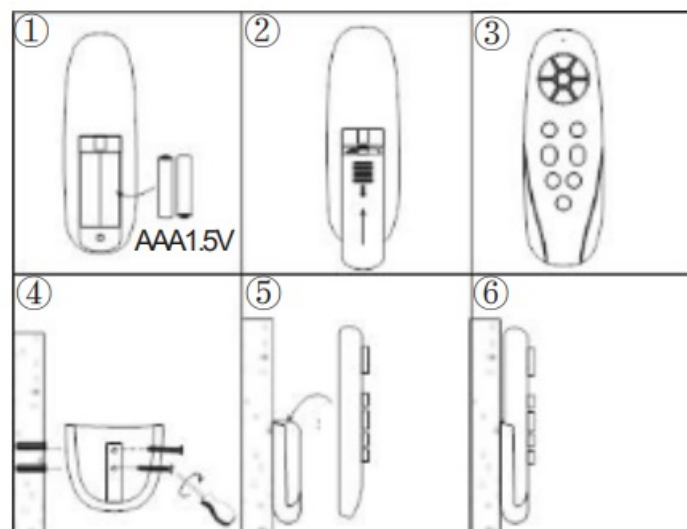

Remote Control



TroubleShooting

WARNING: Make sure the power is off at the electrical panel box before you attempt any repairs.

Problem	Solution
The fan will not start.	<ul style="list-style-type: none"> □ Check the main and branch circuit fuses or breakers. □ Check the line wire connections to the fan and switch wire connections in the switch housing. □ Check to make sure the frequency switches from the remote control and receiver are set to the same frequency.
The fan sounds noisy.	<ul style="list-style-type: none"> □ Make sure all motor housing screws are snug. □ Make sure the screws that attach the fan blade to the motor hub are tight. □ Make sure the wire nut connections are not rattling against each other or the interior wall of the switch housing. □ Allow a 24-hour "breaking-in" period. Most noises associated with a new fan disappear during this time. □ If using the ceiling light kit, make sure the glassware is secured tightly. □ Make sure there is a short distance from the ceiling to the canopy. It should not touch the ceiling. □ Make sure your ceiling box is secure and that rubber isolator pads are used between the mounting bracket and outlet box.
The remote control is not working.	<ul style="list-style-type: none"> □ Do not connect the fan with wall mounted variable speed control(s). □ Make sure the frequency switches are set correctly.
The light is not working	□ Check the LED driver is assembled correctly with the LED light source
Parts broken or missing	□ Contact vendor for new parts replacement

Quick Answers to common Questions

How do you change the blade speed, I cannot get it to change?

Use the remote control. Level 1-6 speed adjustment by press 1-6 button.

Can this fan be installed on a concrete ceiling

Yes,it can.

Does the remote control require a battery, if so what size?

Yes, it needs two AAA battery.The remote control does not contain batteries.

Is this a DC motor?Is DC different from AC

Yes,the ceiling fan is DC motor driven.DC motor is much more efficient and durable than AC ones. Fan blades can reverse by DC motor by pressing one button on the remote controller.

Can this be installed where an existing light was without extra wiring involved for the fan portion of this fixture?

Yes, it can be installed where an existing light was without extra wiring involved . Just remove your existing light and install the new ceiling fans.

Can this used in exterior space?

If the exterior space is some covered space,then yes.But we suggest to use indoors only as the product is not waterproof.

Documents / Resources

	Duclosat Ceiling Fan No Light with Remote Control [pdf] Instruction Manual Ceiling Fan No Light with Remote Control, Ceiling, Fan No Light with Remote Control, Light with Remote Control, Remote Control
---	--

References

- [User Manual](#)

[Manuals+](#), [Privacy Policy](#)

This website is an independent publication and is neither affiliated with nor endorsed by any of the trademark owners. The "Bluetooth®" word mark and logos are registered trademarks owned by Bluetooth SIG, Inc. The "Wi-Fi®" word mark and logos are registered trademarks owned by the Wi-Fi Alliance. Any use of these marks on this website does not imply any affiliation with or endorsement.