



## DT Systems DT-103 Training Collar System User Manual

[Home](#) » [DT Systems](#) » DT Systems DT-103 Training Collar System User Manual 

### User Manual Training Collar System



#### DT-103

Pls, read this entire manual before using this product.

**Warning!!!** This product doesn't come with a charger. You can charge it by connecting your phone charger or computer with the USB cable. Please charge the product with a 5V-Output charger only! Warranty Loss and charging damage may be caused by charging with an improper charger.

**Notes:** You can see the output voltage information on the surface of the charger.

**CAUTION:**

Risk of skin damage: Please read and follow the instructions carefully in this guide, proper fit of the collars is

important because a loose collar may cause inconsistent performance. A collar worn for too long or made too tight on the pet's neck may cause skin damage, ranging from redness to pressure ulcers (commonly known as bedsores). These collars can cause pressure necrosis if used incorrectly and are often misidentified as burns.

- Avoid leaving the collar on the dog for more than 12 hours per day.
- When possible reposition the collar on the pet's neck every 1 to 2 hours.
- Check the fit to prevent excessive pressure, and it is okay to trim any excess strap length.
- Never connect a lead to the electronic collar because it may cause excessive pressure on the contacts.
- Wash the dog's neck area and contacts of the collar weekly with a damp cloth.
- Examine the contact area daily for signs of a rash or a sore.
- If a rash or sore is found, discontinue use of the collar until the skin has healed.
- If the condition persists beyond 48 hours, see your veterinarian.

These steps will help your pet safe and comfortable. Millions of pets are comfortable while wearing stainless steel contacts. Some pets are sensitive to contact pressure. You may find after some time that your pet is very tolerant of the collar. If so you may relax some of these precautions, it is important to continue daily checks of the contact area. If redness or sores are detected, discontinue use until the skin has fully healed.

Thank you for choosing our product! You and your pet deserve companionship that includes memorable moments and a shared understanding together. Our mission is to ensure your pet's safety by providing you with the tools and techniques to successfully train your pet. Should you have any queries, please contact our customer service.

**NOTE:** Please charge before using the product.

## Contents

- [1 Components](#)
- [2 Features](#)
- [3 Key Definitions](#)
- [4 Operating Guide](#)
- [5 Troubleshooting](#)
- [6 General Training Tips](#)
- [7 LIMITED 90-days WARRANTY](#)
- [8 FCC Statement](#)
- [9 Radiation Exposure Statement](#)
- [10 Documents / Resources](#)
- [11 Related Posts](#)

## Components

### DT103-1(1 for 1)

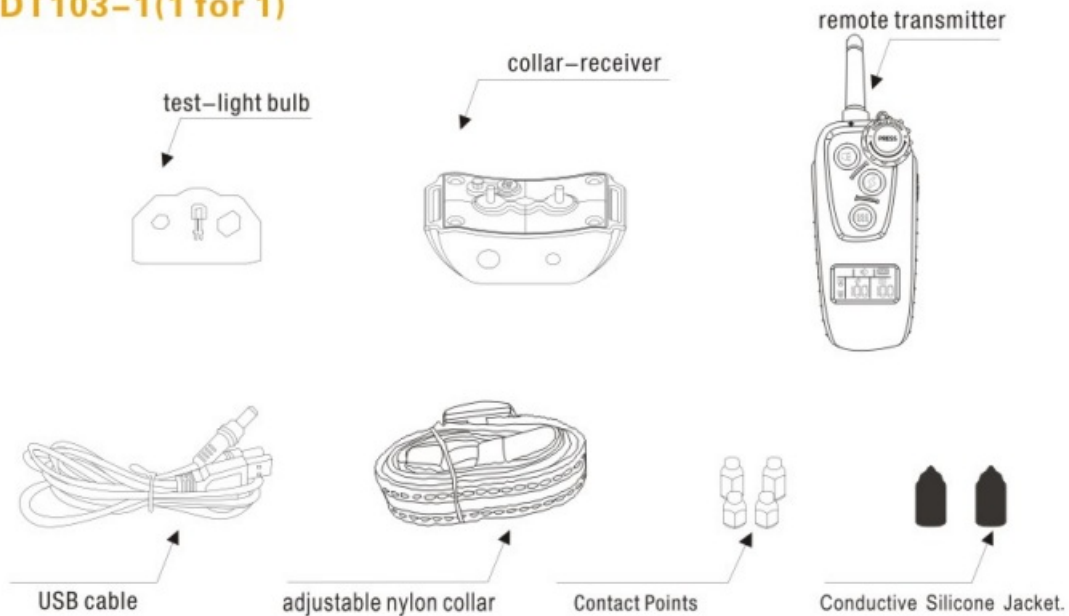

### DT103-2(1 for 2)

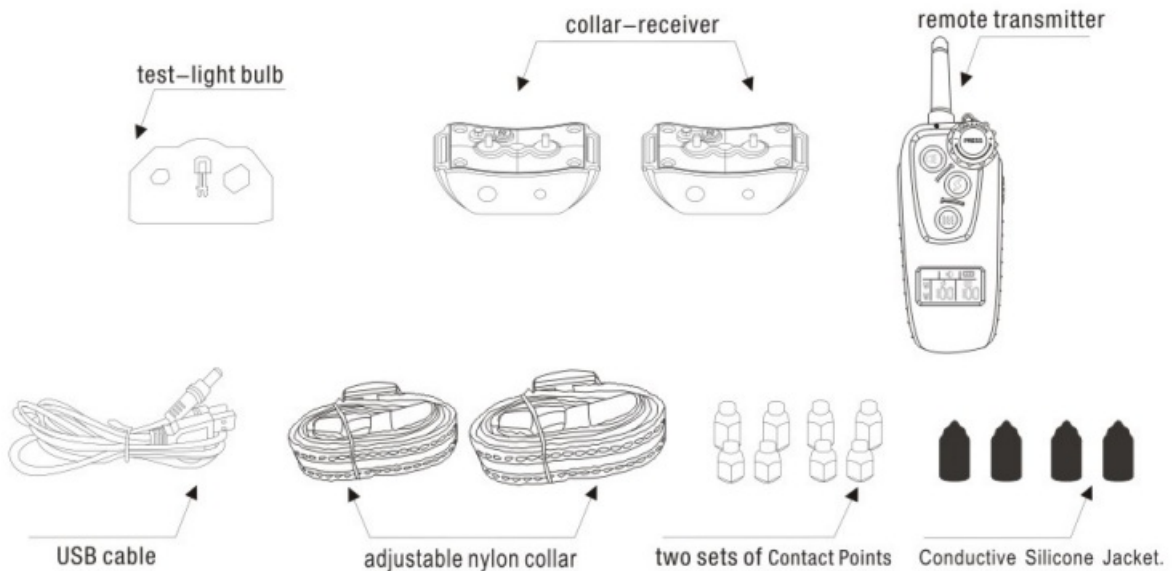

#### How does the dog training system work?

This system has been proven safe, comfortable, and effective for all pets over 15lbs, it assists you in controlling your pet without a leash in a range up to 300M. At the push of a button, the remote transmitter sends a signal, activating the collar-receiver. Using the remote trainer consistently and correctly, most misbehaviors that your pet exhibits can be corrected or any basic obedience commands taught. It can also be used to deter such unwanted behaviors as jumping up, digging, and chasing. While the stimulation is startling it is harmless to your pet. Electronic training devices require interaction and training from the owner to achieve desired results.

**Important:** The system has a range up to 300M. Depending on the way you hold the remote transmitter, the range may vary. Hold the remote transmitter in a horizontal position away from your body to achieve optimum range. Terrain, weather, vegetation, transmission from other radio devices, and other factors will affect the range of your remote transmitter.

#### Features

1. Rechargeable remote transmitter and collar receiver.
2. Waterproof collar-receiver
3. LCD display with backlight screen for night using
4. Standard Tone
5. 100 intensity levels of vibrations
6. 100 intensity levels of static shocks
7. Three channels: Private Channel A, channel B, and Public channel A+B
8. Security keypad lock
9. power saving:
  - If the remote transmitter is left unused for 10 seconds. will enter into 'STANDBY' status; if unused for 5 minutes. it will enter into 'DEEP SLEEP' status. To activate the transmitter in separate cases, you can simply press any button
10. Independent buttons for tone, vibration, and static shock
11. Collar-receiver with beautiful LED breathing light

## Key Definitions

### ► Remote Transmitter

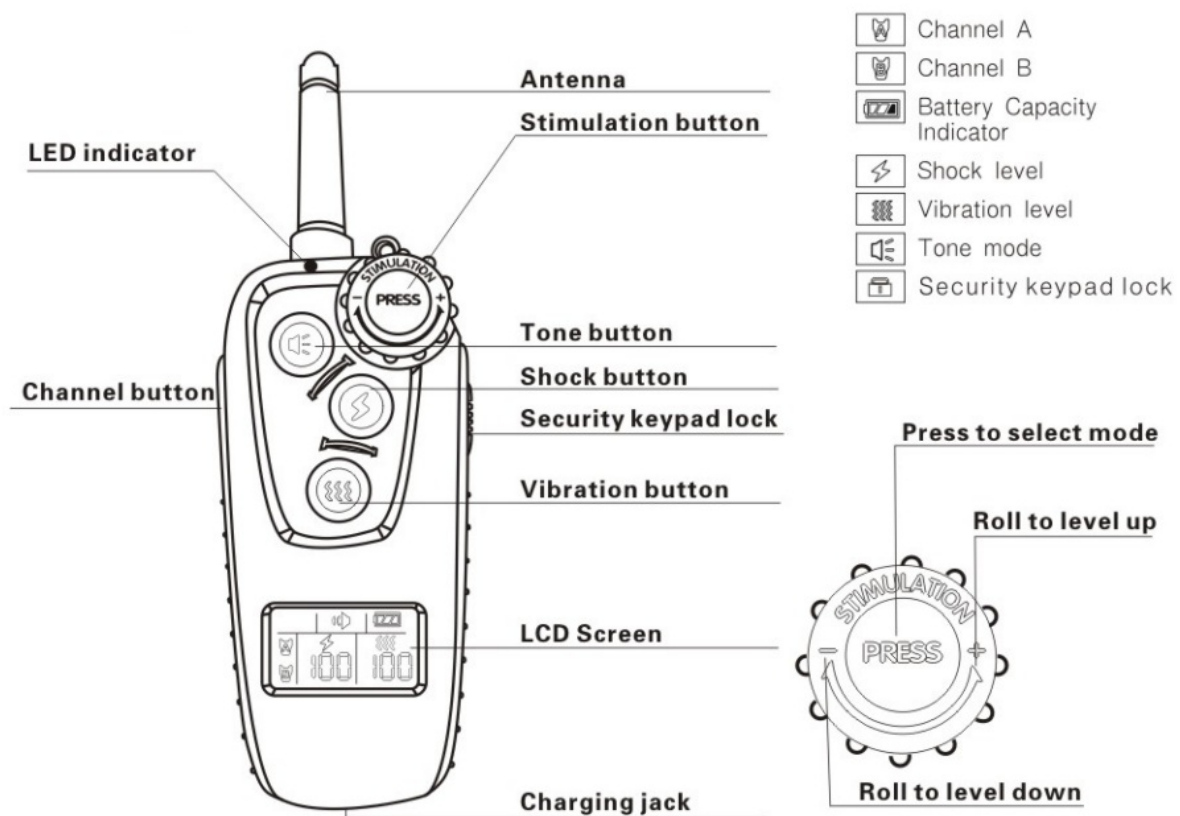

#### 1. LED Indicator:

- When charging, the red LED light, will turn green when fully charged.

- In “standby” status, the LED light will flash green every 5 seconds and will flash red when the battery is at low power mode (please charge it asap).
  - The LED light will flash green when the receiver collar receives the commands from the remote transmitter.
2. **Tone Button:** when it is pressed, the collar-receiver will give a warning beep.
  3. **Vibration Button:** when it is pressed, the collar-receiver will vibrate, levels can be adjusted from 0 to 8 by pressing the STIMULATION BUTTON after pressing **the Vibration Button within 5 seconds**
  4. **Shock Button:** when it is pressed, the collar-receiver will issue the shock, static shock levels can be adjusted from 00 to 16 by pressing the STIMULATION BUTTON.
  5. **Stimulation Button :**
    - Press the Stimulation Button to unlock shock/vibration mode, and roll up/down the shock/vibration level.
    - The level of **the shock/vibration will blink twice when you press the Stimulation Button.**
    - **If there is no operation on the Stimulation Button within 3 seconds, the level of the shock/vibration can NOT be adjusted.**
  6. **Channel Button:** When it is pressed, you can sync the collar-receiver and the transmitter via a different channel (if encoded at the public channel of “A-EB”, can control the collar-receiver at any of the channels).
  7. **LCD Screen:** Display the channel, intensity, and Battery Fuel Gauge.
  8. **Charging Hole:** For remote transmitter charging.
  9. **Security keypad lock:** Easy to carry, say goodbye to Accidental shock.

► Collar receiver:

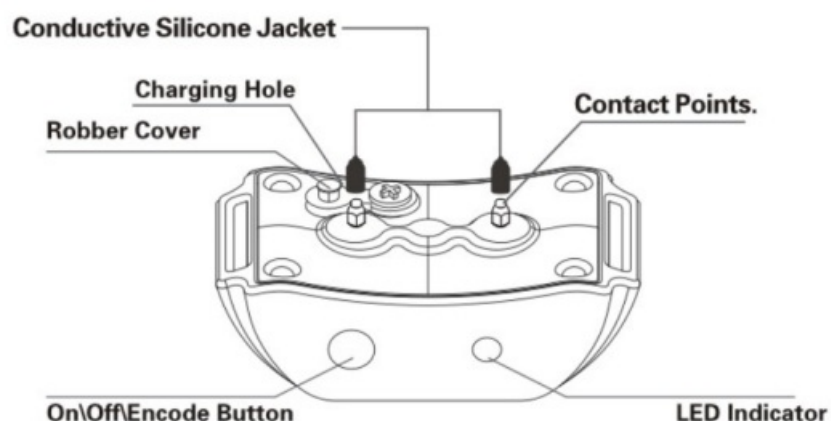

1. **Contact Points:** Deliver vibration and static shock.
2. **ON/OFF/Encode/Breathing Light Button:**
  - Turn on/off the collar receiver.
  - Hold it for a few seconds to encode the receiver UNDER THE SHUT POWER OFF STATE.
  - Hold it for a few seconds to open the LED breathing light UNDER THE POWER ON STATE
3. **Rubber Cover:** After completion of charging please put the cover in place to safeguard the internal unit from dust and water.
4. **Charging Hole:** for collar-receiver charging.
5. **Conductive Silicone Jacket:** Avoid the injury to the dog's skin because of the friction of the metal contact

point.

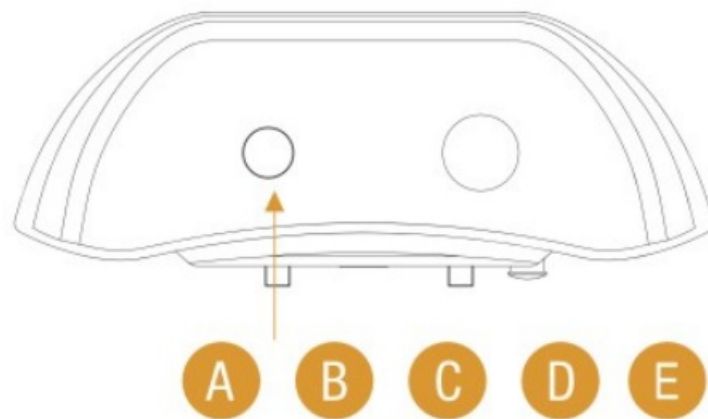

- A** When charging, the LED light is red; when fully charged, it turns green.
- B** In “standby” status, the LED light will flash green every 5 seconds and will flash red when the battery is at low power mode(please charge it asap).
- C** The LED light will flash green when the receiver collar receives the commands %. from the remote transmitter.
- D** UNDER THE POWER OFF STATE, press and hold the ON/OFF/ENCODE button for 3 seconds to encode it.
- E** UNDER THE POWER ON STATE, press and hold the ON/OFF/ENCODE button for 3 seconds to turn on/off the LED breathing light.

## Operating Guide

### Step 1

#### Prepare the remote transmitter:

##### Charge the remote transmitter

1. **Connect the charger connector to the charging hole** 5V Output charger only).
2. **Plug the charger** into a standard outlet.
3. The red light in the transmitter will be on, indicating that charging is taking place.
4. Charge the transmitter for at least 2 hours for the first charge or until the indication that charging is complete.
5. When charging is complete, the red light **will turn** Also the Battery Capacity Indicator will not flash anymore.
6. When the battery capacity “” Indicator is empty, please charge it asap.

##### How to use the remote transmitter

1. Press any button to turn on the transmitter,
2. Press the STIMULATION BUTTON to adjust the intensity level of vibration or static shock.
3. The “A/8”(channel) button indicates either channel A, channel B, or channel A+B on the transmitter. Select one channel for use with one collar receiver. if encoded at the public channel of “A+B”, you can control the collar-receiver at any of the channels.
4. The remote transmitter will go into STANDBY MODE if no operation for 10 seconds and will go into SLEEP MODE if no operation for 5 minutes. Can be activated by pressing any of the function buttons.

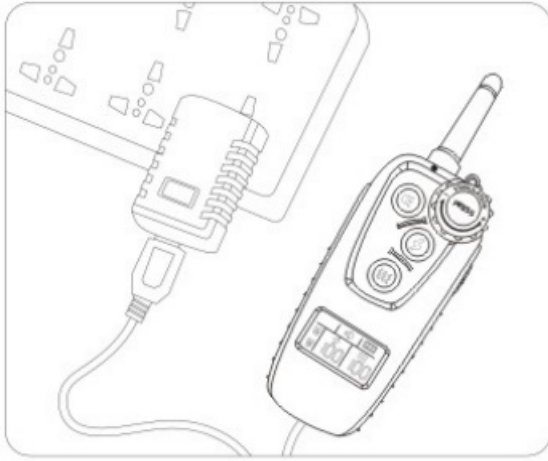

## Prepare the Collar-receiver: Charge the collar-receiver

### Step 2

1. **Connect** the charger connector to the charging jack 5V-Output charger only ).
2. Plug the charger into a standard outlet.
3. The red LED light in the collar receiver will turn on. (A)
4. Charge the collar-receiver for at least 3 hours for the first charge or until the indication that charging is complete.
5. After the receiver has been fully charged, the LED light **will** turn green. (B)
6. When charging is finished, put the rubber cover in place to keep the internal unit from dust and water.

**NB:** The collar-receiver will flash red at STANDBY mode if it needs recharging.

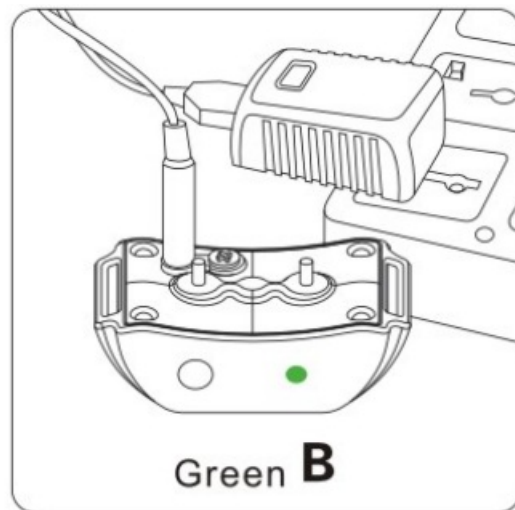
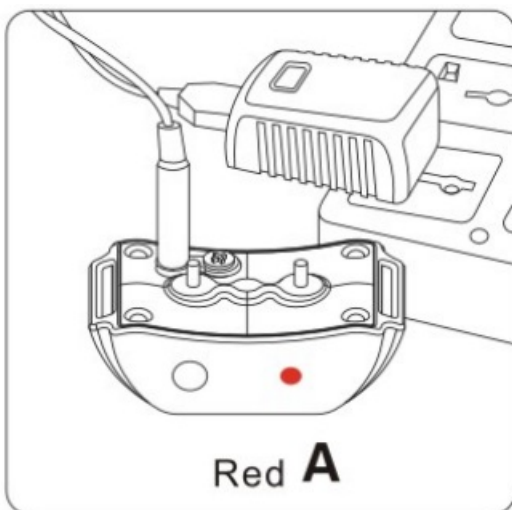

### Step 3

## Sync transmitter with collar-receiver:

1. Press any button on the transmitter to activate it.
2. Select channel A, B, or A+B.



3. Power off the Receiver Collar by pressing the ON/OFF button on the collar, (a beep power on, two beeps power off).
4. Press the **ON/OFF** button afresh and hold it for 3 seconds, and then the LED light will start to flash green quickly for 10 seconds.
5. Now you can hear the first beep from the collar-receiver and then press any of the command buttons (tone, shock or vibration) of the transmitter before the green light on the receiver stops flashing quickly.
6. You will hear the second beep from the receiver, which signifies that the transmitter and the receiver have been synced.
7. To sync the transmitter and the second receiver, repeat steps 2 through 6.
8. Please be sure to choose the other channel.

**NB:** According to the factory default settings, when the collar-receiver has been turned on the syncing should be completed within 10 seconds, thereby you have to press the **COMMAND BUTTON** in good time or press it at least within 10 seconds. Please DO NOT try to sync the transmitter with the two collar-receivers (if any) at the same time.

## Test the training system

### Step 4

The following testing methods will help you ascertain whether this training system functions swimmingly. Please make sure that you have connected the transmitter and collar-receiver before testing.

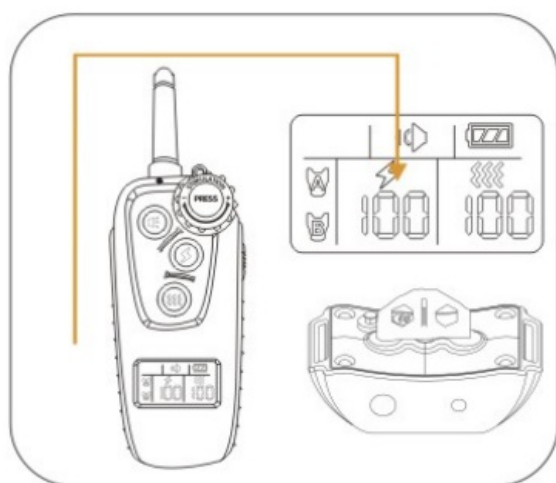

(Figure 2-1)

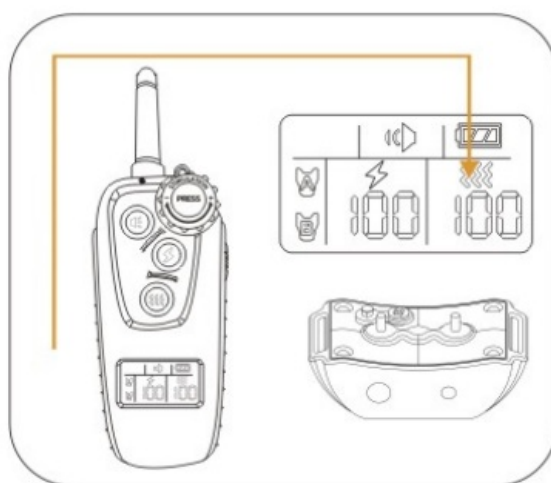

(Figure 2-2)

### Test the static shock function (Figure 2-1)

Put the test light on the contact points of the collar receiver. Turn on the remote transmitter, and press the STIMULATION BUTTON to adjust the intensity level.

Press the shock button and the bulb will flash, signifying that the SHOCK function works. Please make sure the SHOCK level is above 5 when testing the function to see more clearly.

**Note:** If wanting to test the shock function on yourself, please ensure your finger or hand is across both contact points to ensure the connection is complete. Otherwise, the user will feel no stimulation.

### Test the vibration functions (Figure 2-2)

Turn on the remote transmitter, press the VIBRATION BUONE first then press the STIMULATION BUTTON within



5seconds to adjust the vibration level.

Press the vibration button on the remote transmitter and the collar receiver will vibration, signifying the VIBRATION function works.

### Test the beep function (Figure 2-3)

Turn on the remote transmitter.

Press the vibration button, and the collar- the receiver will beep, signifying the BEEP function works.

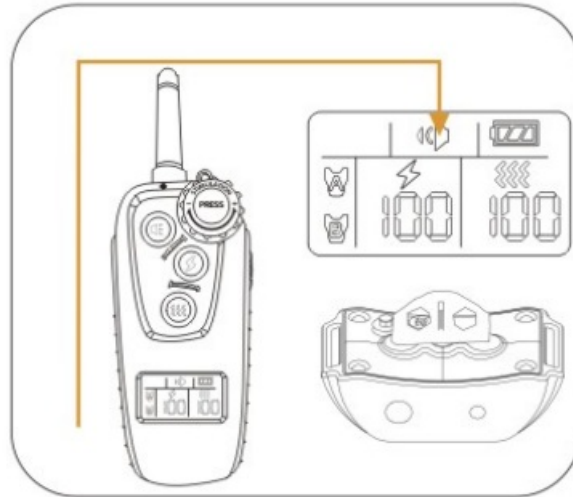

(Figure 2-3)

### NB:

1. To save power, the transmitter will go into STANDBY mode if there's no operation in 5 minutes; you can press any COMMAND button to activate it, and then its screen will display.
2. The collar-receiver will go into SLEEP mode if there is no operation for 2 minutes, and the LED stop flashing. Will be activated within 60 milliseconds once receiving the command(shock, vibration, or tone) from the transmitter.

### Fit the collar-receiver

#### Step 5

Important: The proper fit and placement of the collar-receiver are essential for effective training. The metal contact probes must have direct contact with your dog's skin as follows:

1. To fit the collar-receiver you will need to attach the collar strap to the receiver box. Ensure you have selected the appropriate length metal probes for your dog (i.e. long-length probes for long-haired dogs and short-length for short-haired dogs). **(3A)**
2. With your dog standing in front of you, place the collar-receiver around its neck so the receiver box and probes are on the underside of your dog's neck, making direct contact with the skin. You may need to trim the fur to ensure good contact. **(3B)**
3. Fasten the collar strap. The fit should be snug, but not taut. You should be able to place one finger beneath the collar strap around your dog's neck. **(3C)**
4. Allow your dog to wear the collar receiver for several minutes and then check the strap again. As your dog

becomes more familiar with the collar-receiver you should ensure the fit is comfy and flattering.

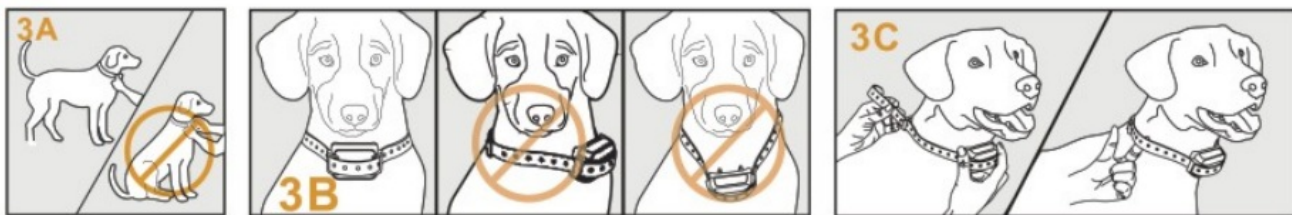

#### Re-thread the collar (as diagram)

#### Step 4

#### Regular Maintenance

- Check the metal probes for tightness on a weekly basis.
- Rinse the metal probes with alcohol on a weekly basis. (NB: Please turn off the collar receiver before touching the metal probes.)
- Check your dog's neck for irritation and wash it on a weekly basis.

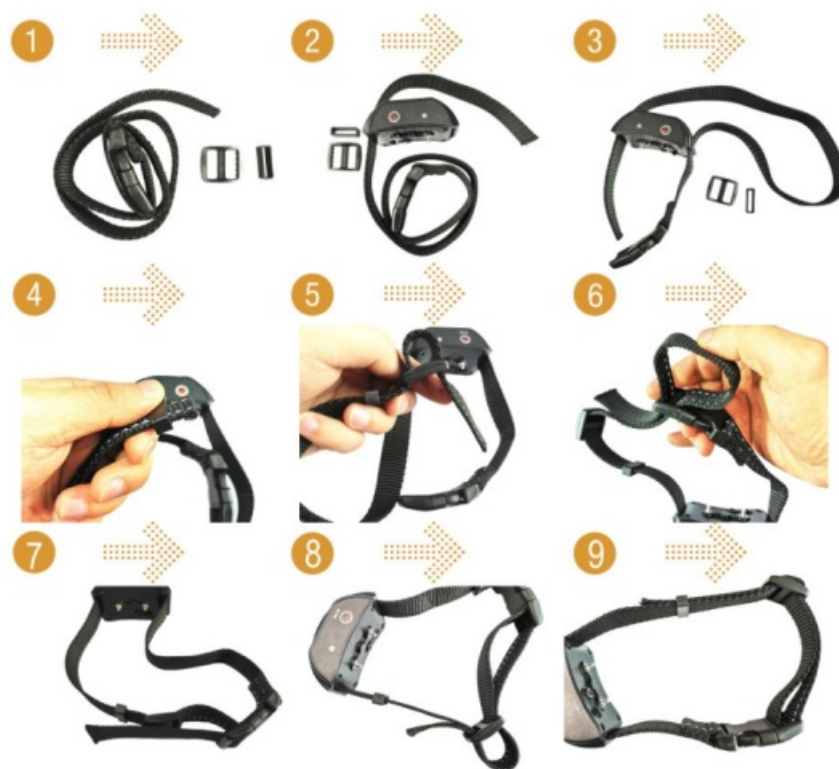

#### Troubleshooting

##### My pet is not responding after the pet training system has been installed successfully.

- You need to charge the remote transmitter and the collar receiver for 2 H separately before initial use.
- Check to see if the remote transmitter and the collar-receiver have been turned
- Check the intensity levels of vibration and static shock.
- Make sure the collar-receiver has sufficient power to operate.

- Restart the collar receiver by pressing the ON/OFF button.
- Please test the 3 functions (BEEP, VIBRATION AND, STATIC SHOCK) before initial use. See the “test the training system” pad of this guide for testing methods.
- Check whether the collar-receiver has entered into the DEEP SLEEP mode.
- Check if the collar fits snugly with your pet’s neck.
- Check the thickness of your pet’s fur and use appropriate length metal probes. If necessary, please trim your pet’s neck hair so that the metal probes come in direct contact with your pet’s skin.
- If all of the above have been addressed and your pet still gives no response. Please try to re-connect the remote transmitter and the collar receiver.

#### **The remote transmitter does not work.**

- Check if the remote transmitter is in low battery status. If the Battery Capacity ajar indicator is empty, battery exhaustion is imminent.
- You have to press and hold the power button on the transmitter to turn it on.
- Check if the transmitter has entered into the STANDBY or DEEP SLEEP status.

#### **My collar-receiver works great for some time, yet it does not work after charging.**

- First, check if the receiver has been charged correctly. Check the “prepare the collar-receiver” part of the guide for the correct charging method.
- Check if the receiver has been turned on.

#### **I want to test the collar-receiver on myself, but it does not work.**

- When testing the receiver on your hands, please touch the 2 electrodes at the same time as touching one single electrode will not work.

### **General Training Tips**

#### **The following are tips on how to get the best out of your Remote Pet Training Collar:**

1. Make the training sessions short and positive (between 10-15 minutes long each time), which will enable your dog to keep its attention focused on you.
2. Train one dog at a time.
3. During initial training sessions, keep your dog in a familiar outdoor environment g. an enclosed area of the garden and away from other dogs/animals and people. Training in new locations may cause your dog to become distracted causing you to reinforce your commands with the remote collar-receiver more often collar-receiver more than accordingly.
4. Use a long leash fastened to a non-metallic collar to help his/her learning. Ensure the additional collar and leash do not interfere with the skin contact of the metal probes on the collar receiver. Do not use the remote training collar without a long leash until your dog is fully trained.
5. You will have more success by teaching the dog a command first before trying to reinforce to command with the remote trainer.

6. For basic obedience training, VIBRATION and AUDIO modes are more useful.
7. Issue an obedience command at a time, which will focus your dog's attention and reduce confusion. Do not use the remote collar to correct commands that have not already been covered.
8. During training, look for all the positive changes in your dog's behavior and remember to reinforce them promptly with ample praise and reward.
9. Avoid over-correcting your dog. Use as few remote corrections as possible during the training process.
10. When your dog has become apparently perplexed, shift the focus of the training session by drawing his/her attention to a command they are familiar with, e.g. sit. Give your dog praise and encouragement galore on successful completion of the command. Repeat this several times before returning to training with remote corrections.
11. If you know particular misbehavior your dog does, then reinvent this situation during a training session. You will have far more success if you deal with one misbehavior at a time in a controlled situation.
12. Be consistent; give your dog a tone, vibration, or static-stimulation correction for each misbehavior. When reinforcing a command with a correction. It is critical that you do so without emotion then immediately praise and reward your dog for making the right decision.
13. When your dog seems to react in a timid and frightened fashion to either the tone, vibration, or static stimulation, particularly in early training sessions, do not be flabbergasted. Shift the focus of the training session by drawing his/her attention to a command they are familiar with. E.G. sit and give your dog abundant praise and encouragement on successful completion of the command.
14. Do not use Remote Pet Training Collar to correct or eliminate forms of aggression or biting behavior. When your dog is showing signs of aggressive behavior then contact a professional dog trainer in your vicinity.
15. Please be reminded that you should keep training sessions short and end every session on a high note. Stop training and play with your dog as soon as he/she has accomplished a new level of proficiency.

SIZE	NECK GIRTH (IN)	NECK GIRTH (IN)	BACK LENGTH (IN)	WEIGHT (LBS)	BREED
x-SMALL	7.8-8.6	9.8-11.8	7.4	1-10	Chihuahua, Yorkshire terrier
SMALL	7.8-9.4	11.4-14.1	9.0	11-25	Poodle, Pomeranian
MEDIUM	9.0-11.0	13.7-16.5	11.0	26-40	Shih Tzu, Maltese Dog
LARGE	10.6-12.2	16.1-18.5	12.2	41-70	Miniature Schnauzer, Pekingese
LARGE	11.8-13.3	18.1-20.8	13.7	71-90	English Cocker Spaniel
LARGE	12.9-14.5	20.4-23.2	15.7	91-110	Beagle
X-LARGE	16.9-18.9	29.9-33.0	23.6	N/A	Husky
X-LARGE	18.5-20.4	34.6-38.1	23.6	N/A	Labrador Retriever
X-LARGE	20.4-24.4	36.2-39.3	27.5	N/A	Golden Retriever, Old English Sheepdog

#### Addendum and Upgrading Notes:

The range of “up to 300M” specified in the user manual denotes the maximum valid value that can be possibly achieved in ideal conditions. According to multiple hands-on field experiments, this training system has an effective range up to 100-280M.

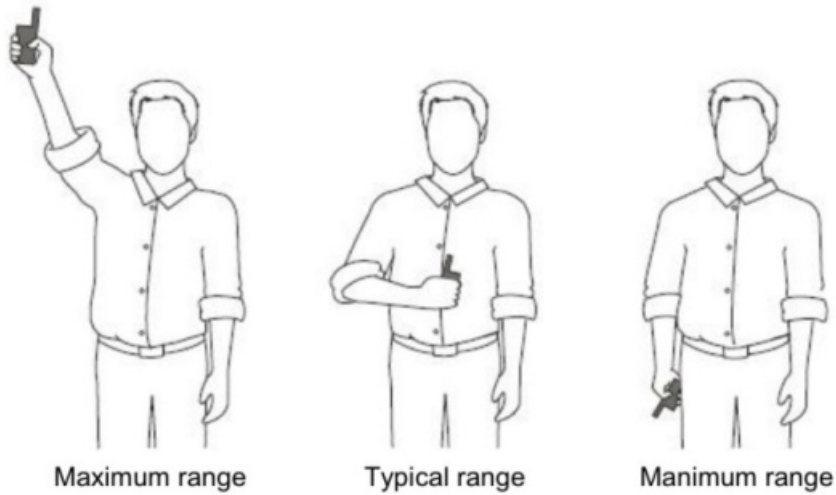

\*Avoid touching the antenna(at the backside of the LED indicator in the transmitter) or the range may decrease substantially.

### **LIMITED 90-days WARRANTY**

We warrant this product to be free of defects in parts, materials, and workmanship for a period of 90days, from the date of purchase. Should any repairs or servicing under this warranty be required, contact Customer Service by phone or email for instructions on how to pack and ship the product

### **FCC Statement**

This device complies with part 15 of the FCC rules. Operation is subject to the following two conditions: (1) this device may not cause harmful interference, and (2) this device must accept any interference received, including interference that may cause undesired operation.

Caution: Changes or modifications not expressly approved by the party responsible for compliance could void the user's authority to operate the equipment.

**NOTE:** This equipment has been tested and found to comply with the limits for a Class B digital device, pursuant to part 15 of the FCC Rules. These limits are designed to provide reasonable protection against harmful interference in a residential installation. This equipment generates uses and can radiate radio frequency energy and, if not installed and used in accordance with the instructions, may cause harmful interference to radio communications. However, there is no guarantee that interference will not occur in a particular installation. If this equipment does cause harmful interference to radio or television reception, which can be determined by turning the equipment off and on, the user is encouraged to try to correct the interference by one or more of the following measures:

- Reorient or relocate the receiving antenna.
- Increase the separation between the equipment and receiver.
- Connect the equipment into an outlet on a circuit different from that to which the receiver is connected.
- Consult the dealer or an experienced radio/TV technician for help with an important announcement

### **Radiation Exposure Statement**

The device has been evaluated to meet the general RE exposure requirements. The device can be used in portable exposure conditions without restriction.

### **Documents / Resources**



[DT Systems DT-103 Training Collar System](#) [pdf] User Manual  
DT103, 2ATEO-DT103, 2ATEODT103, DT-103, Training Collar System

Manuals+