



DT SWISS L2/L3 Remote Lever User Manual

[Home](#) » [DT SWISS](#) » DT SWISS L2/L3 Remote Lever User Manual 

DT SWISS L2/L3 Remote Lever

User Manual

L2 / L3 REMOTE LEVER

USER MANUAL

V2022.01

Congratulations on the purchase of your new DT Swiss remote lever! You have purchased a quality product made by DT Swiss.

Contents

1 GENERAL INFORMATION

2 SAFETY

2.1 2.1 COMPATIBILITY

3 SCOPE OF DELIVERY

3.1 3.1 L2 REMOTE LEVER

3.2 3.2 L3 REMOTE LEVER

4 ASSEMBLY

4.1 4.1 INSTALLING THE L2 REMOTE LEVER

4.2 4.2 INSTALLING THE CABLE AND CABLE HOUSING ON THE L2 REMOTE LEVER

4.3 4.3 INSTALLING THE L1 TRIGGER LEVER

4.4 4.4 INSTALLING THE CABLE ON THE L3 REMOTE LEVER

5 SERVICE AND CARE

5.1 5.1 CLEANING AND GREASING THE TRACK OF THE GRID

5.2 5.2 DISPOSAL AND ENVIRONMENTAL PROTECTION

6 6. WARRANTY

7 Documents / Resources

7.1 References

8 Related Posts

GENERAL INFORMATION

This user manual is intended for the user of the remote lever. It includes information on the assembly, maintenance and care.

For further information and activities refer to www.dtswiss.com.

Users must read and understand this manual before using the component. Third-party users must also be informed about the following provisions. Keep this user manual handy / for reference in case you need to refer to it later.

SAFETY



NOTE

Incorrect handling, incorrect installation and incorrect maintenance or care can lead to malfunctions or damage!

- Compliance with the following provisions is a prerequisite for accident-free use and faultless performance.
- Assembly and maintenance of the remote lever requires a basic knowledge of handling bicycle components. If in any doubt, consult your retailer.
- After assembly, the cable must be at least long enough to allow the handlebars to be turned freely without the cable becoming too taut.
- The remote lever must be compatible with all parts of the bicycle.
- Only use original DT Swiss spare parts.
- The remote lever must not be changed or modified.
- The remote lever must not be used if it is damaged or there are any signs of damage. If in any doubt, consult your retailer.

2.1 COMPATIBILITY

The L2 Remote Lever is compatible with DT Swiss forks and shocks. The L3 Remote Lever is also compatible with DT Swiss dropper seat posts.

Compatibility with components from other manufacturers may be possible, but DT Swiss gives no functional guarantee and offers no support.

SCOPE OF DELIVERY

3.1 L2 REMOTE LEVER

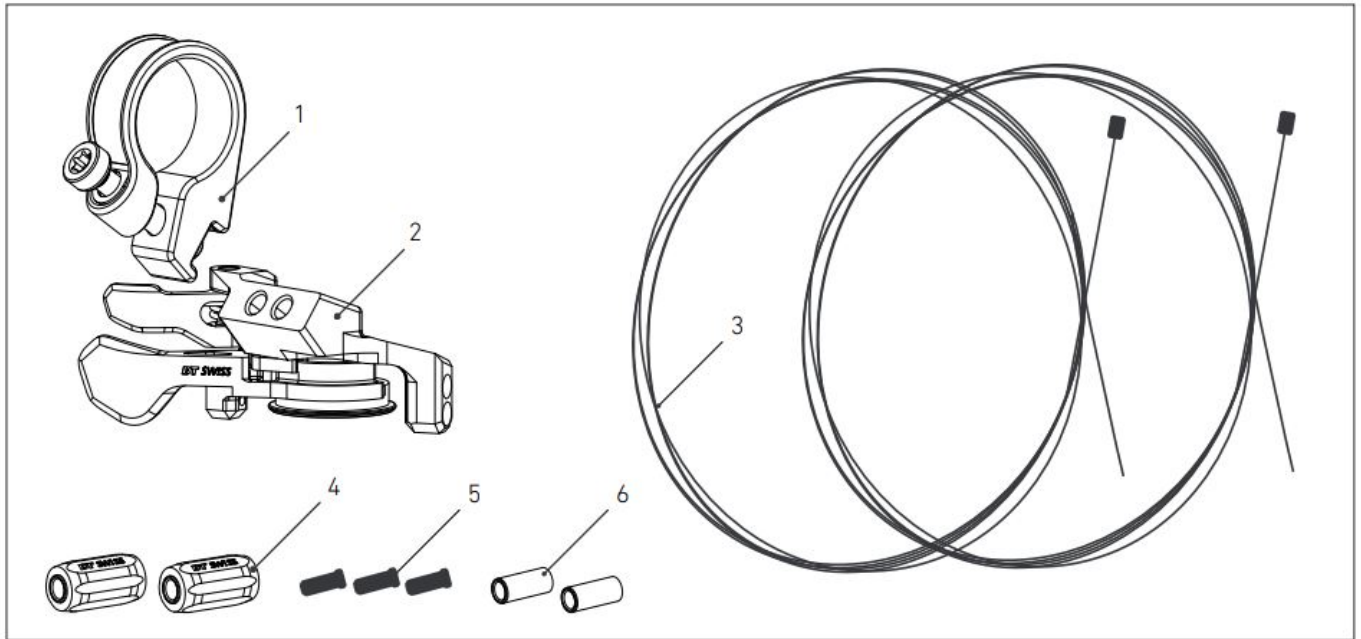

1. handlebar clamp
2. L2 Remote Lever
3. 2x shift cable
4. 2x cable adjuster
5. 3x cable end crimp
6. 2x ferrule

3.2 L3 REMOTE LEVER

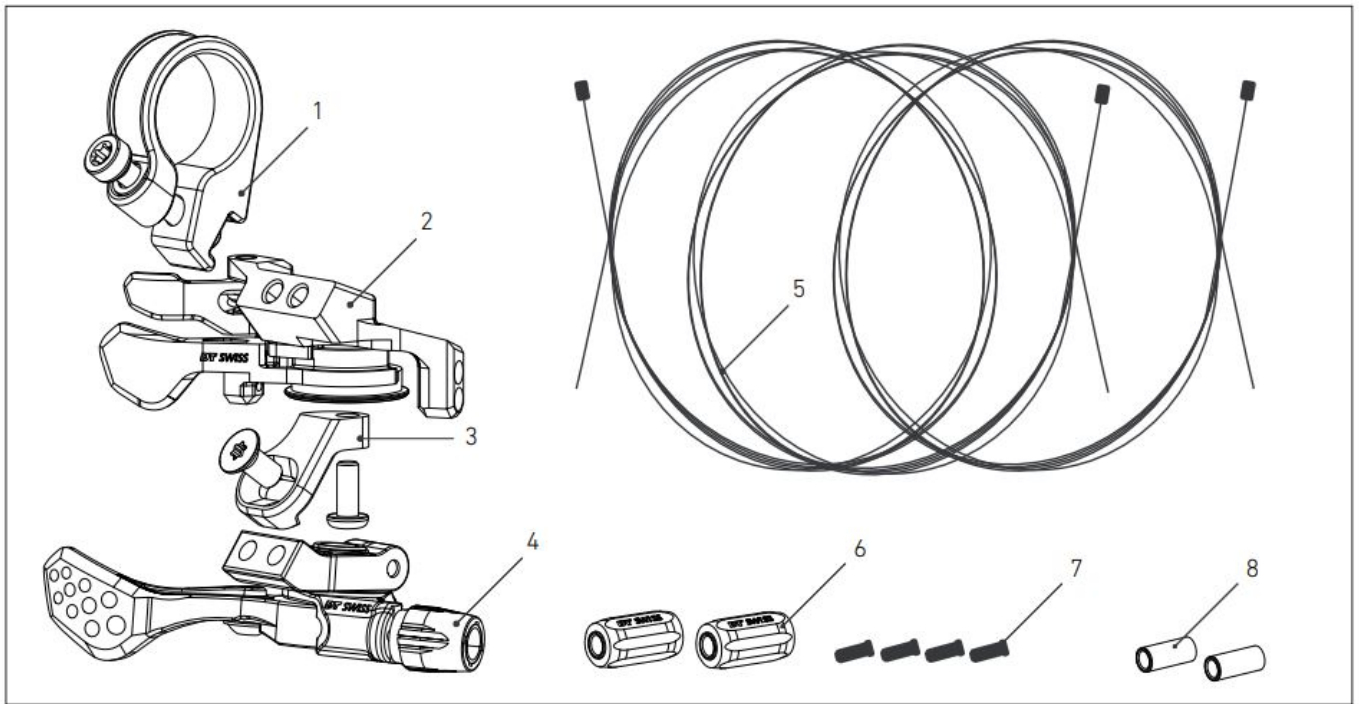

1. handlebar clamp
2. L2 Remote Lever
3. L2/L3 adapter*
4. L1 Trigger Lever
5. 3x shift cable
6. 2x cable adjuster
7. 4x cable end crimp
8. 2x ferrule

* The adapter Art. LWKL3XXS37901S is also available as a single item.

ASSEMBLY

4.1 INSTALLING THE L2 REMOTE LEVER

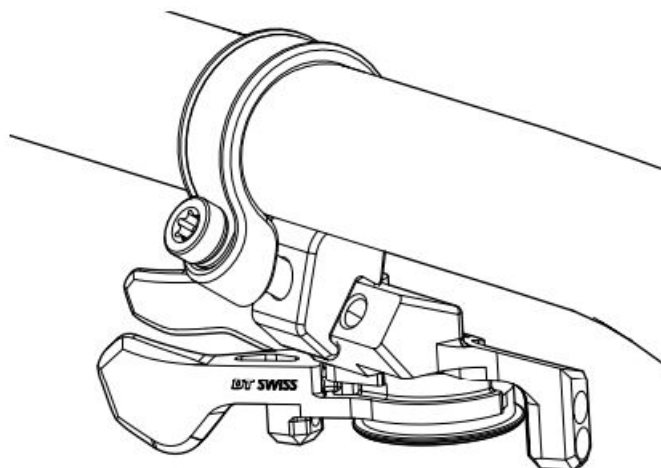

NOTE: The L2 remote lever is compatible with the Matchmaker X interface. This allows the remote lever to be

attached directly to the clamp of a Sram brake lever without a clamp.

1. Dismount the grip from the handlebar, open the screw of the clamp slightly and slide the clamp onto the left side of the handlebar.
2. Position the remote lever in such a way that the lever can be comfortably reached with the thumb and neither impairs its own function nor interferes with the function of other control elements.
3. Tighten the fixing screw with a Torx T25 key with a torque of max. 1.5 Nm.

→ If the remote lever is fitted on carbon handlebars, the maximum torque may be lower. Observe the handlebar manufacturer's user manual!

4.2 INSTALLING THE CABLE AND CABLE HOUSING ON THE L2 REMOTE LEVER

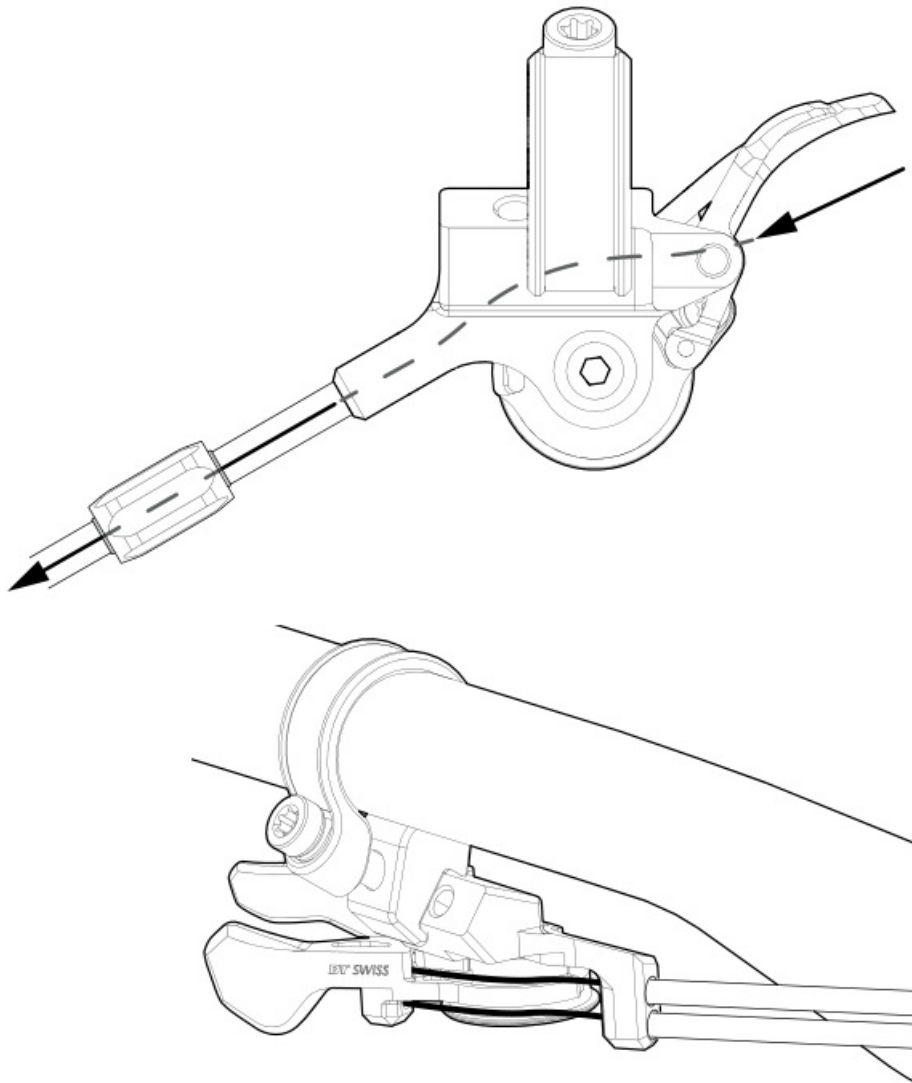

1. Move the remote lever to the starting position (see picture).
2. Attach the cable housing and the cable adjuster.
 - Only cable housings with an outer diameter of 4.2 mm must be used.
 - Before and after the cable adjuster there must be at least one short piece of cable housing.
 - Screw in the cable adjuster completely and then loosen one turn.
3. Shorten the cable housing to the desired length.
4. Put the shift cable through the remote lever.

5. Attach the cable to the component to be operated and shorten it if necessary.

For more information, refer to the user manual or the technical manual of the corresponding component.

6. Check the function and readjust the cable if necessary.
7. Repeat the above steps as necessary to assemble a second cable.

4.3 INSTALLING THE L1 TRIGGER LEVER

1. Attach the adapter to the L2 Lever and screw in the fixing screw with a 2.5 mm hex key.
2. Tighten the fixing screw with a torque of max. 2.5 Nm.

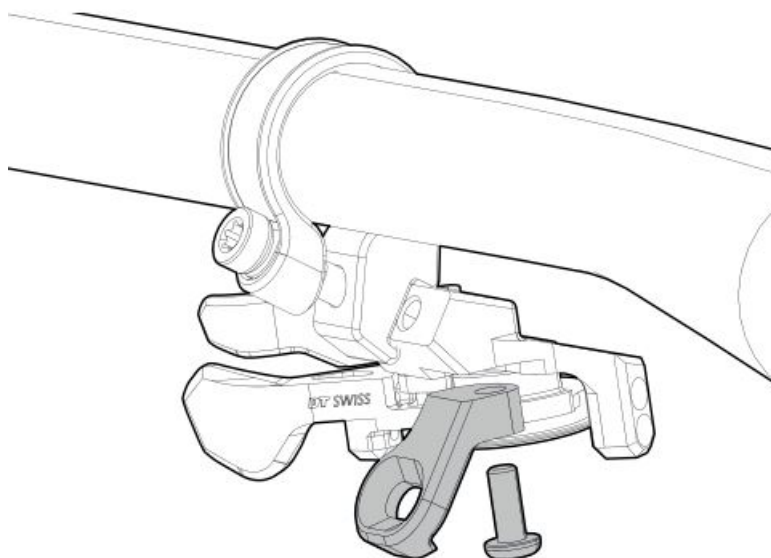

3. Attach the L1 Trigger Lever to the adapter.
4. Screw the fixing screw into one of the two threads using a Torx T25 key.
5. Tighten the fixing screw with a torque of max. 1.5 Nm.

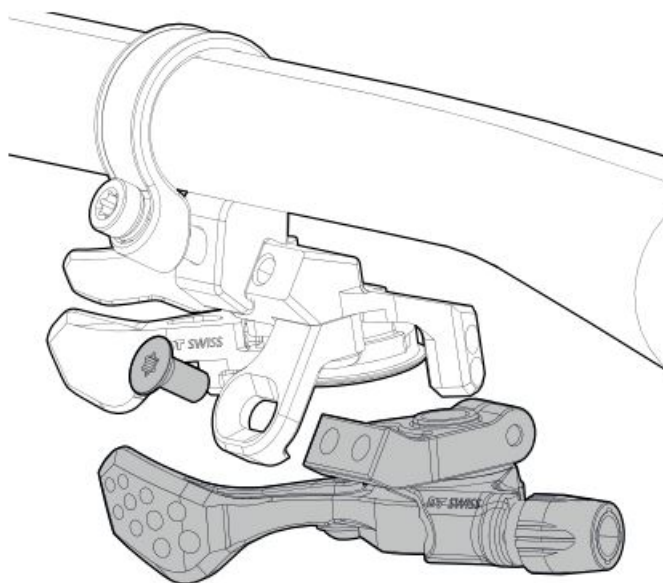

The position of the remote lever can be adjusted if necessary.

6. Loosen the screw (1) with a 3 mm hex key.
7. Turn the remote lever to the desired position.

8. Tighten the screw (1) with a torque of 2 Nm.

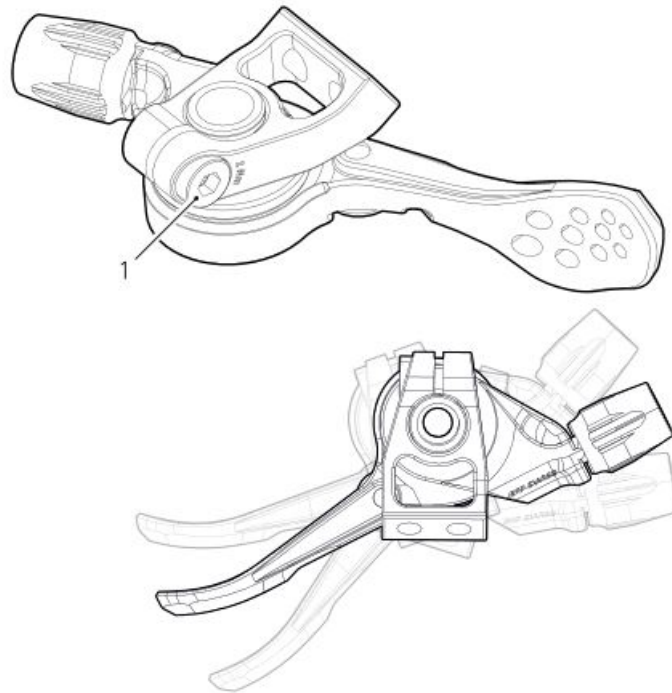

4.4 INSTALLING THE CABLE ON THE L3 REMOTE LEVER

1. Take the user manual of the component that is to be operated by the remote lever and check it for information on how to mount the cable.
2. Screw in the cable adjuster (1) fully and then turn it back out two turns.
→ This achieves the greatest adjustment range.

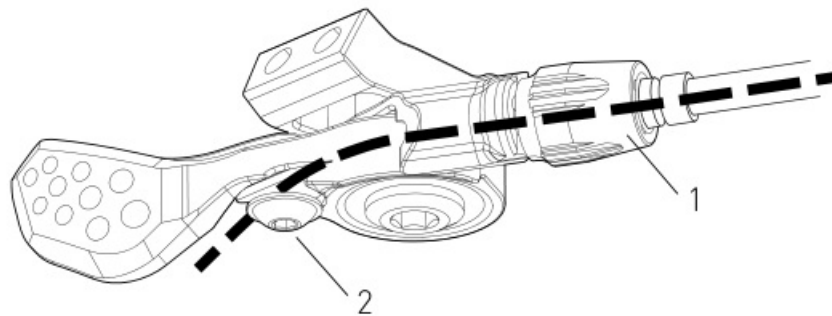

3. Put a ferrule on the end of the cable housing and insert the cable housing into the cable adjuster (1) of the remote lever.
4. Use a 2.5 mm hex key to unscrew the clamping screw (2) for the cable on the remote lever by a few turns.
5. Push the cable through the cable adjuster (1) and push the cable end through the remote lever.
6. Pull the cable tight and screw in the clamping screw (2) to clamp the cable.
7. Adjust the cable adjuster (1) until there is sufficient cable tension to remove play at the remote lever.
8. Trim off the protruding end of the cable and fit a cable end crimp on the cable.

SERVICE AND CARE

Task	Interval
Check if the fastening is correct	before each ride
Check the functionality	Before each ride
Clean with soft cloth and a suitable cleaner. Do not use high pressure cleaners or aggressive cleaning agents!	After each ride
Clean and lightly grease the track of the grid (see chapter 5.1).	regularly
Check for damage.	regularly

5.1 CLEANING AND GREASING THE TRACK OF THE GRID

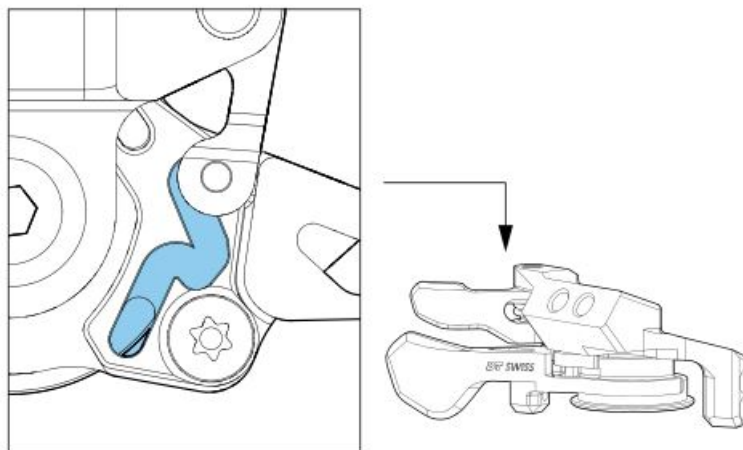

1. Push the lower lever fully forward to access the track of the grid.
2. Clean the track with water and a mild detergent.
3. Grease the track with universal grease.
4. Operate the lever a few times and remove excess grease.

5.2 DISPOSAL AND ENVIRONMENTAL PROTECTION

The statutory regulations shall apply. Whenever possible, avoid creating waste. Waste, especially carbon, lubricants, cleaners and any other fluids must be disposed in an environmentally compatible manner.

6. WARRANTY

Warranty conditions can be found at www.dtswiss.com

DT SWISS ASIA LTD.

No.5, Jingke 5th Rd., Nantun District
Taichung City 408
Taiwan (R.O.C.)
info.tw@dtswiss.com

DT SWISS, INC.
2493 Industrial Blvd.
USA – Grand Junction, CO 81505
info.us@dtswiss.com

DT SWISS DEUTSCHLAND GmbH
Albert-Einstein-Strasse 3
59302 Oelde
Germany
info.de@dtswiss.com

DT SWISS (FRANCE) S.A.S.
Parc d'Activites de la Sarrée
Route de Gourdon
F – 06620 Le Bar sur Loup
info.fr@dtswiss.com

DT SWISS POLSKA Sp. z o.o.
ul. Towarowa 36
PL-64-600 Oborniki
Poland
info.pl@dtswiss.com

Subject to technical alterations, errors and misprints excepted.
All rights reserved.
© by DT SWISS AG
www.dtswiss.com
LXW2023XUMXXXS

Documents / Resources

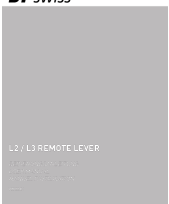
	<p>DT SWISS L2/L3 Remote Lever [pdf] User Manual L2 L3 Remote Lever, L2 Remote Lever, L3 Remote Lever</p>
---	---

References

-  [DT Swiss: manufacturer of bicycle components | DT Swiss](#)

-  [DT Swiss: manufacturer of bicycle components | DT Swiss](#)

Manuals+.