



DSI HD6472D Camden 1 Light Matte Black Pendant with Frosted Bound Glass Shade User Manual

[Home](#) » [DSI](#) » DSI HD6472D Camden 1 Light Matte Black Pendant with Frosted Bound Glass Shade User Manual



USE AND CARE GUIDE
1-LIGHT PENDANT



Item # 0000 000 000

Model # HD6472D

Questions, problems, missing parts? Before returning to the store, call Design Solutions International Customer Service

Mon-Fri 9:30 am to 3:00 pm EST

1-800-388-6141 ext. 216

For customer service support and the fastest response, please email us at

CustomerSupport@DSLighting.com

Contents

- 1 Safety Information**
- 2 Warranty**
- 3 Pre-Installation**
- 4 Installation**
- 5 Care and Cleaning**
- 6 Troubleshooting**
- 7 Service Parts**
- 8 Documents / Resources**

Safety Information

READ AND SAVE THESE INSTRUCTIONS.

- For your protection and safety, carefully read and understand the information provided in this manual completely before attempting to assemble, install, or operate this product. Failure to do so could lead to

electrical shock, fire, or other injuries that could be hazardous or even fatal.

- Before touching any wire, use a voltage tester to make sure it is not live.
- When replacing fuses, turn off the main power first. Make sure your hands and feet are dry, and place one hand behind your back to prevent electricity from making a complete circuit through your chest. Touch the plug fuse only by its insulated rim. Remove the cartridge fuses with a fuse puller.
- Use tools with insulated handles and ladders made of wood or fiberglass.
- To protect children, place a safety cover over any unused outlets.



DANGER: Before starting installation of this fixture or removal of a previous fixture, disconnect the power by turning off the circuit breaker, removing the fuse at the fuse box, or tripping the breaker that controls that circuit. Tape a sign to the panel warning others to leave the circuit alone while you work.



CAUTION: CONSULT A QUALIFIED ELECTRICIAN IF YOU HAVE ANY ELECTRICAL QUESTIONS. If you have any non-electrical questions about this fixture, please call our Customer Service Team at 1-800-388-6141 ext 216. Please reference your item (0000 000 000) or UPC (802513198713).

Warranty

THREE (3) YEAR WARRANTY

WHAT IS COVERED

The manufacturer warrants this fixture to be free from defects in materials and workmanship for a period of three (3) years from the date of purchase. This warranty applies only to the original consumer purchaser and only to products used in normal use and service. If this product is found to be defective, the manufacturer's only obligation and your exclusive remedy, is the repair or replacement of the product at the manufacturer's discretion, provided that the product has not been damaged through misuse, abuse, accident, modifications, alteration, neglect, or mishandling. This warranty shall not apply to any product that is found to have been improperly installed, set-up, or used in any way not in accordance with the instructions supplied with the product. This warranty shall not apply to a failure of the product as a result of an accident, misuse, abuse, negligence, alteration, faulty installation, or any other failure not relating to faulty material or workmanship. This warranty shall not apply to the finish on any portion of the product, such as surface and/or weathering, as this is considered normal wear and tear.

WHAT IS NOT COVERED

The manufacturer does not warrant and specifically disclaims any warranty, whether expressed or implied, of fitness for a particular purpose, other than the warranty contained herein. The manufacturer specifically disclaims any liability and shall not be liable for any consequential or incidental loss or damage, including but not limited to any labor/expense costs involved in the replacement or repair of said product.

Contact the Customer Service Team at 1-800-388-6141 ext 216 Eastern Time, Mon-Fri 9:30 am to 3:00 pm EST. For customer service support and the fastest response, please email us at CustomerSupport@DSILighting.com.

Pre-Installation

PLANNING INSTALLATION

- Read all the instructions before installing.
- To avoid damaging this product, place it on a soft, non-abrasive surface, such as carpet or cardboard.



IMPORTANT: Inspect the wire insulation for any cuts, abrasions, or exposed copper that may have occurred during shipping. If there is a defect in the wire, do not attempt installation. Please call Customer Service Team at 1-800-388-6141 ext 216. For customer service support and the fastest response, please email us at CustomerSupport@DSILighting.com.



NOTE: This product requires one 60W maximum medium base (E26) type “S” or type “A” or 9W maximum medium base (E26) self-ballasted LED vintage Edison bulbs (sold separately).

TOOLS RECOMMENDED (NOT INCLUDED)

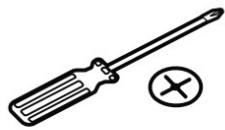

Phillips
Screwdriver



Ladder



Wire
Stripper



Pliers



Safety
Goggles



Electrical
Tape

HARDWARE INCLUDED



NOTE: Hardware is not shown to actual size.

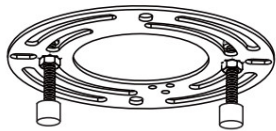

AA

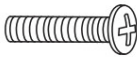

BB



CC

Part	Description	Quantity
AA	Crossbar assembly	1
BB	Outlet box screw	3
CC	Wire connector	2

PACKAGE CONTENTS

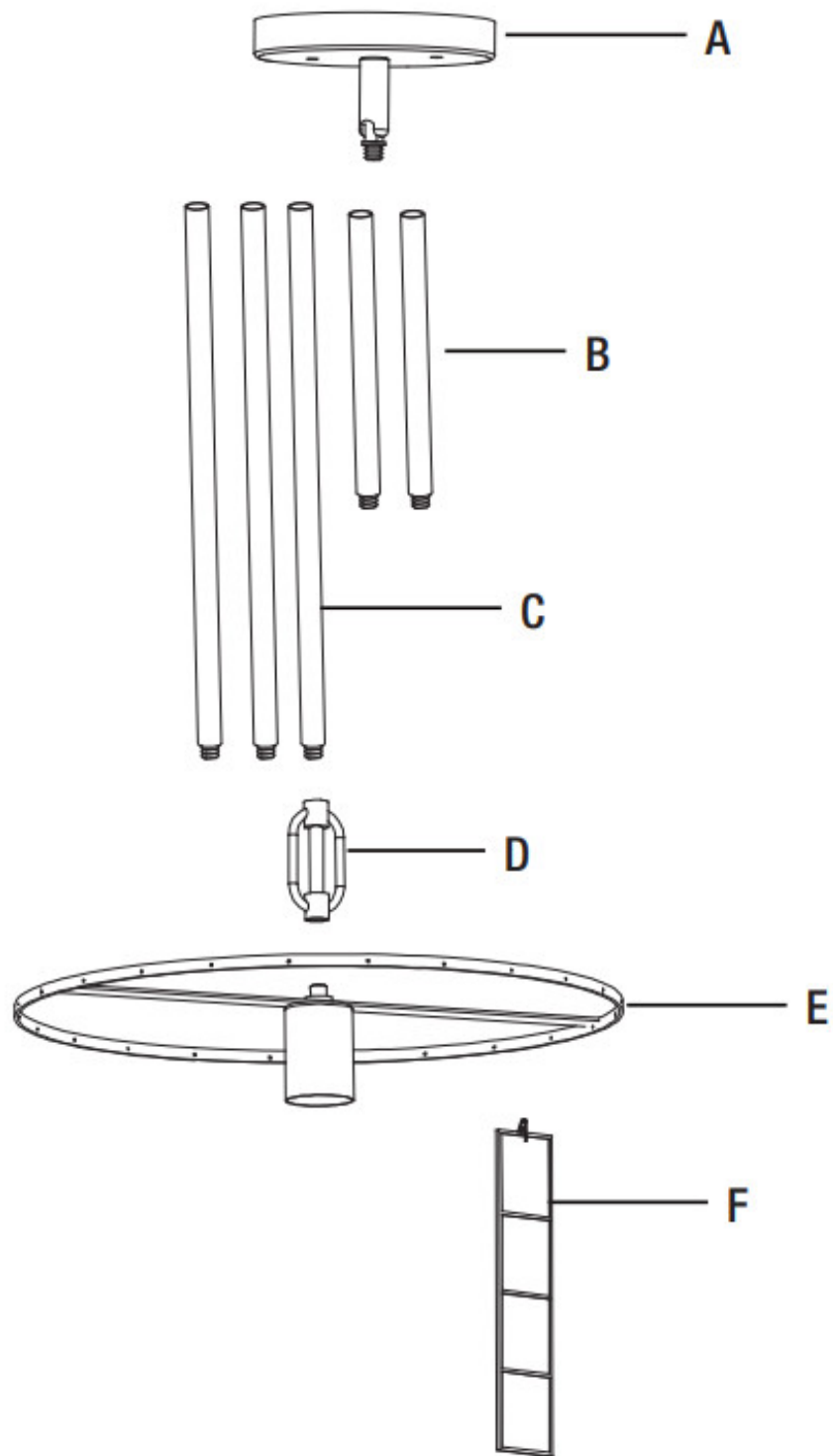

Part	Description	Quantity
A	Ceiling canopy	1
B	6 In. rod	2
C	12 In. rod	3
D	Decorative part	1
E	Socket assembly	1
F	Glass accent + 1 replacement	24+1

Installation

1. Installing the crossbar assembly

Secure the crossbar assembly (AA) to the outlet box (not included) with the outlet box screws (BB). Tighten until snug.

NOTE: The preassembled mounting screws on the crossbar should protrude outward.

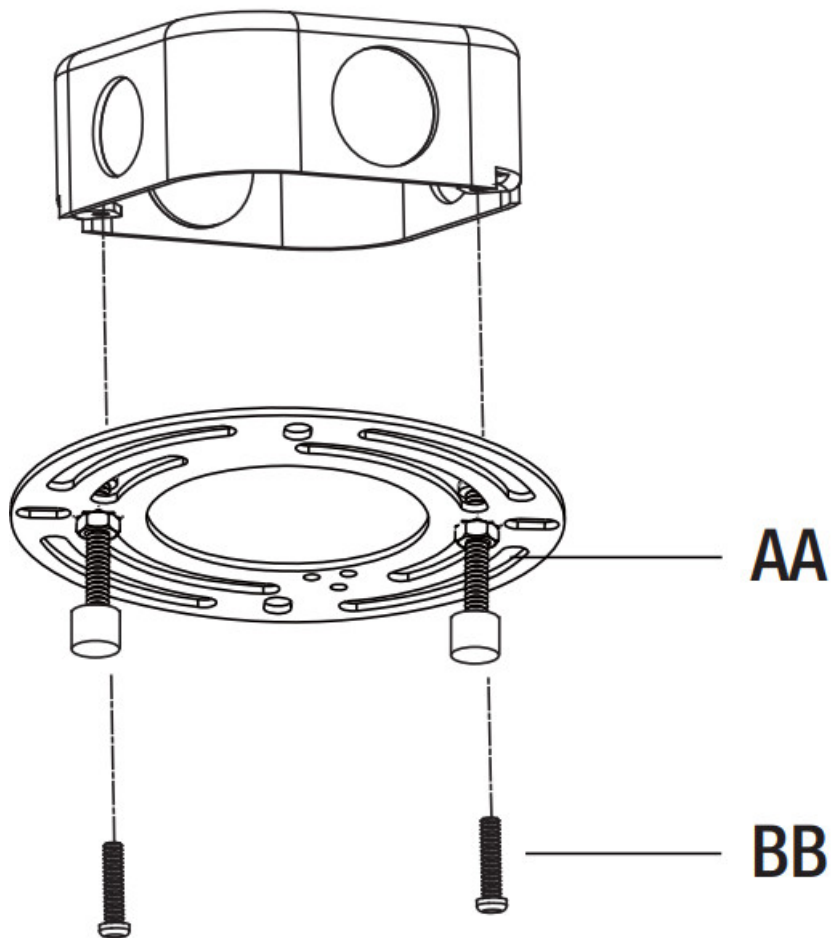

2. Test fitting the ceiling canopy to the crossbar assembly

Remove the mounting balls (1) from the crossbar assembly (AA).

Fit the ceiling canopy (A) to the crossbar assembly (AA) and secure with the mounting balls (1).

*If they do not align, adjust the length of the mounting screws on the crossbar assembly (AA) by unscrewing the preassembled hex nuts.

*Then, screw the mounting screws in or out of the crossbar until the desired length is achieved.

*Once the ceiling canopy (A) is secure, remove the mounting balls (1) and the ceiling canopy (A) and proceed to Step 3.

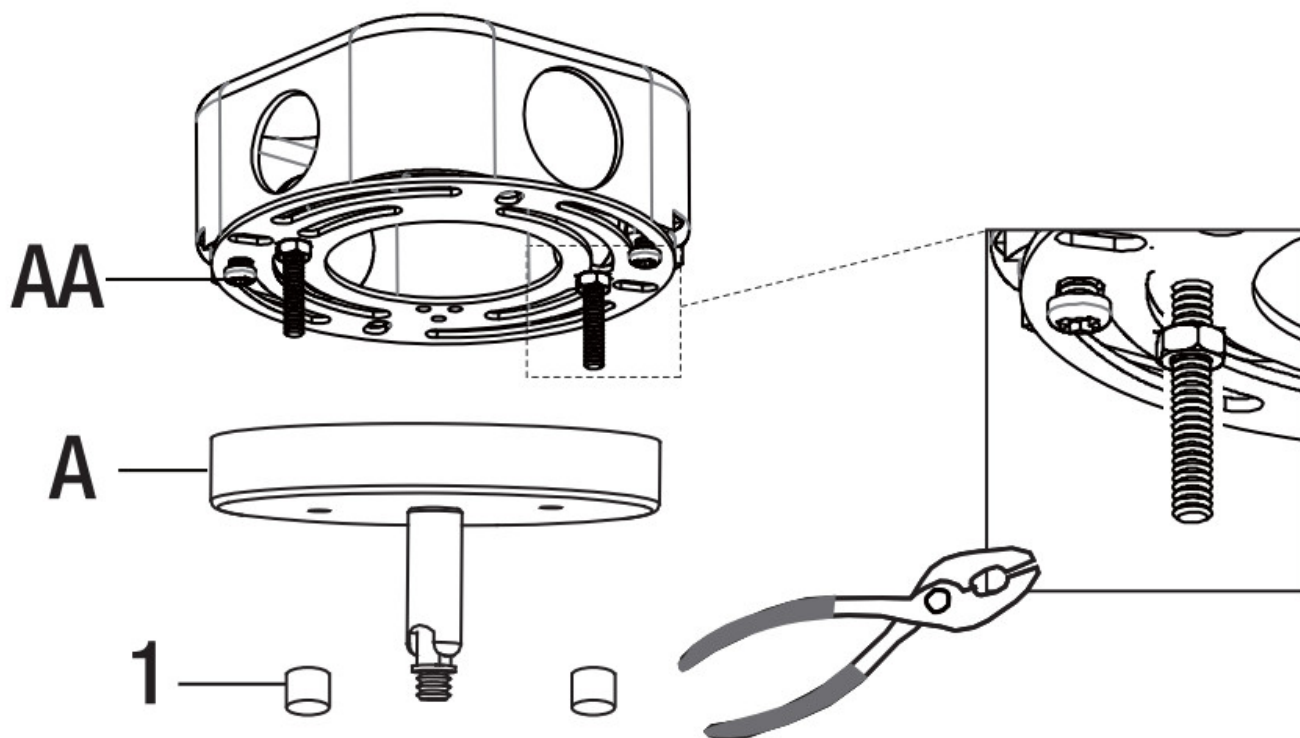

NOTE: The ceiling canopy (A) should be snug against the ceiling and the mounting balls (1).

3. Installing the rods and the ceiling canopy

Guide the fixture wire with bare copper ground wire through the decorative part (D), and screw the decorative part (D) onto the top of the socket assembly (E) securely.

Choose desired hanging length for the light fixture.

Assemble the rods (B/C) to the desired length.

Pass the supply wires and the ground wires through the rod assembly.

Attach the rod assembly to the decorative part (D), hand-tighten until snug.

Thread the ceiling canopy (A) to the uppermost rod. Hand-tighten until snug.

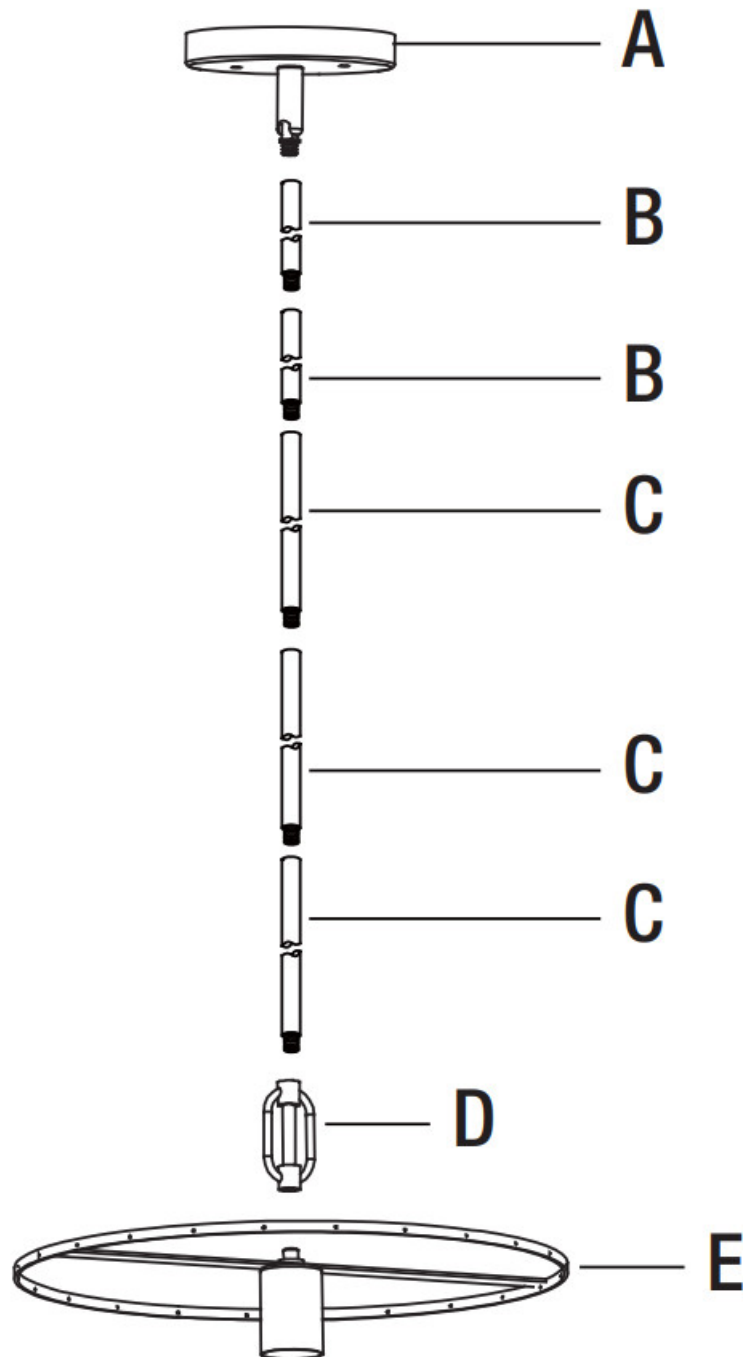

Hint:

- Assemble one rod at a time.
- Pass the ground wire through the rod first.
- Then, pass the supply wire through the rod.
- Thread the rod by hand until snug.

Suggested rod length to hang fixture 30 inches above table top:

- 8 ft. ceiling (2) 6 in. rods + (1) 12 in. rods
- 9 ft. ceiling (2) 6 in. rods + (2) 12 in. rods
- 10 ft. ceiling (2) 6 in. rods + (3) 12 in. rods

4. Making the electrical connections

- * Use wire connectors (CC) to connect the wires.

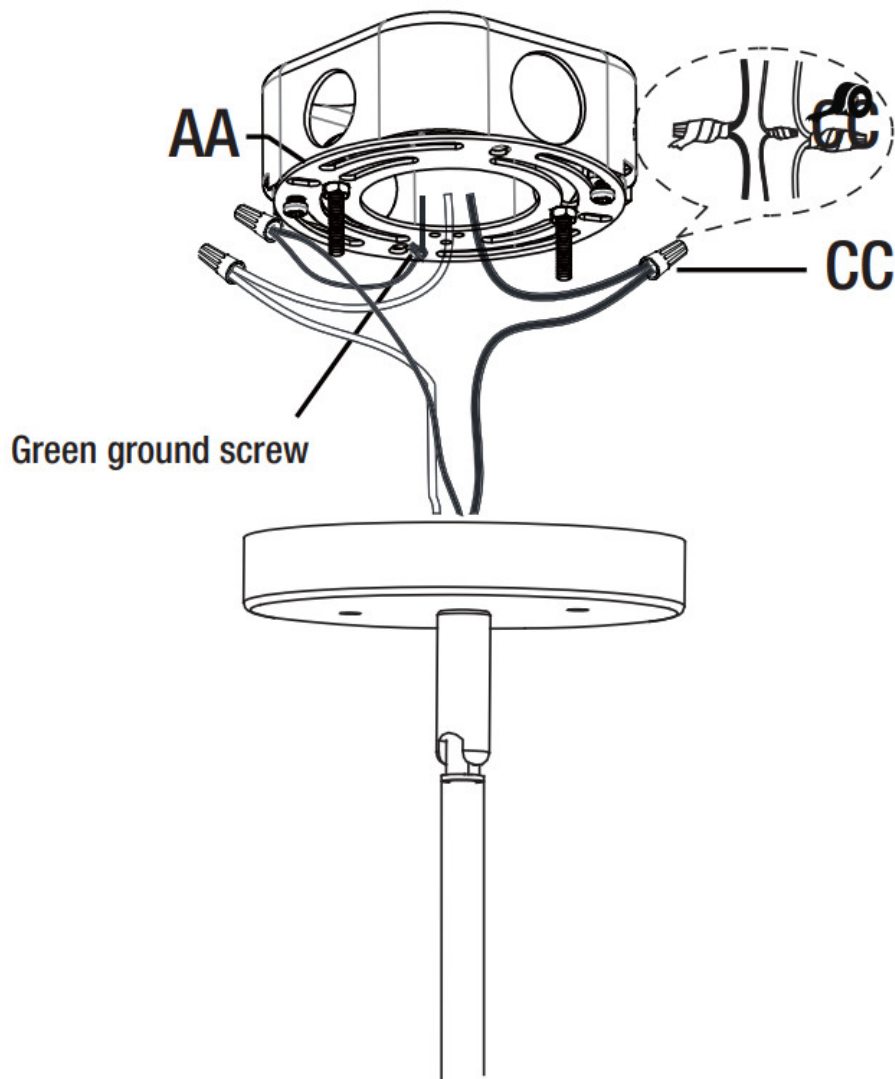

Ground wire:

1. Wrap the supply ground wire around the green ground screw on the crossbar assembly (AA), no less than 2 in. from the end of the wire. Tighten the ground screw.
2. Connect the fixture ground wire to the supply ground wire with a wire connector (CC).

Supply wire:

1. Connect the supply white wire to the white fixture supply wire with a wire connector (CC).
 2. Connect the supply black (or red) wire to the black fixture supply wire with a wire connector (CC).
 3. Wrap each connection with approved electrical tape and carefully insert all of the connected wires into the outlet box.
5. Installing the fixture body to the outlet box
- Re-attach the ceiling canopy (A) of the fixture body to the crossbar assembly (AA).
- Secure with the previously removed mounting balls (1).

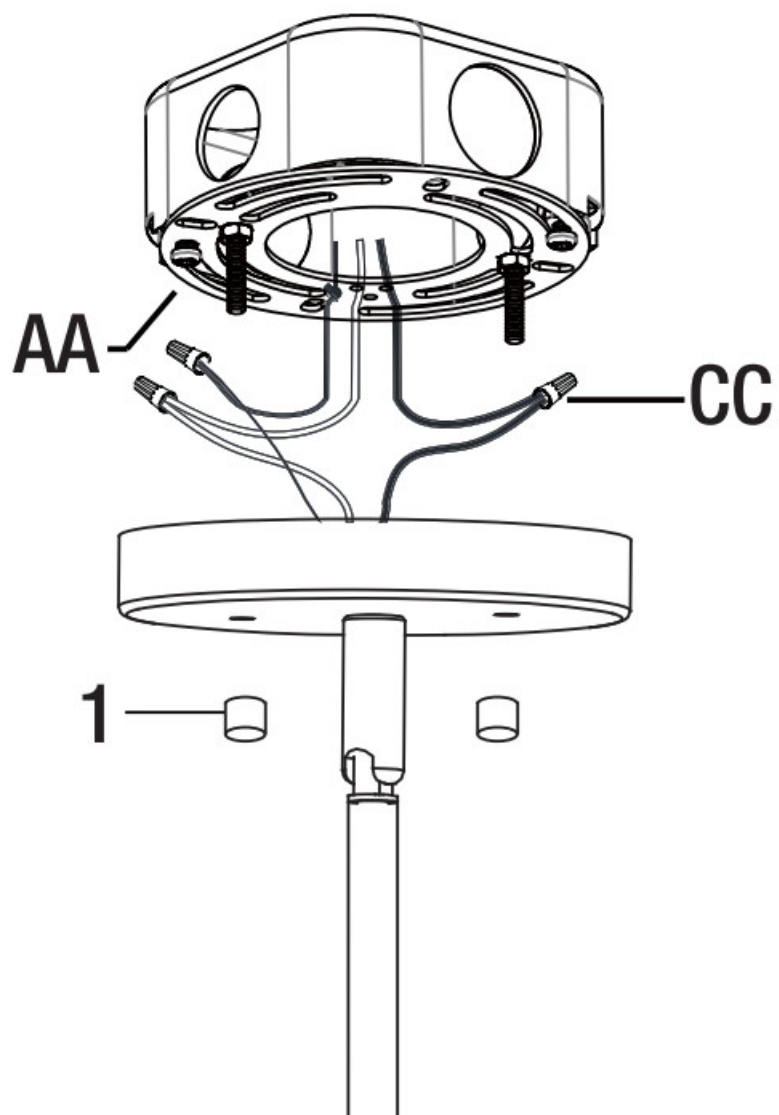

6. Installing the glass accent

Place hooks on the end of the glass accents (F) into small holes on the inside ring of the socket assembly (E).

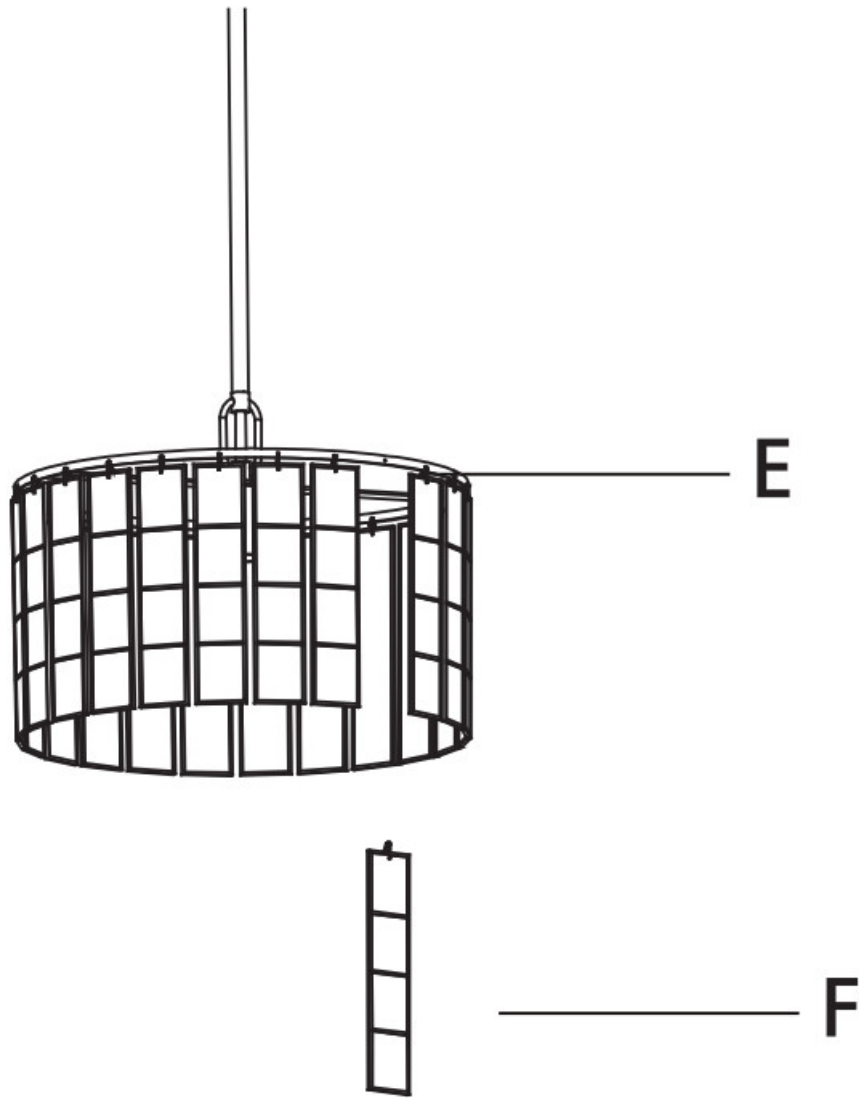

7. Installing the light bulb

Install the correct bulb (not included) referring to fixture markings and/or labels for maximum wattage.

NOTE: Uses one 60W maximum medium base (E26) type “S” or type “A” or 9W maximum medium base (E26) self-ballasted LED vintage Edison bulbs (sold separately).

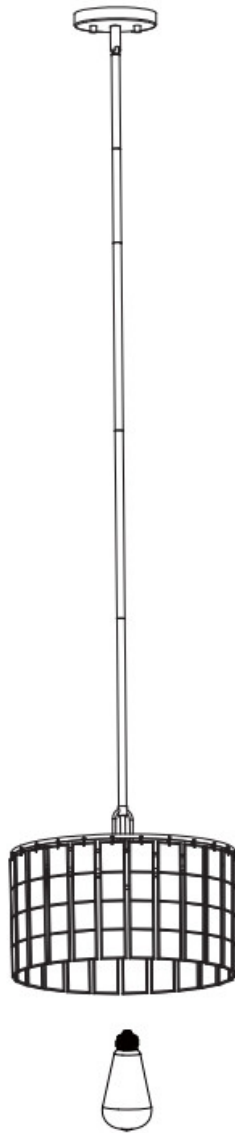

Care and Cleaning

Do not use any cleaners with chemicals, solvents, or harsh abrasives. Use only a dry, soft cloth to dust or wipe carefully.

To clean the fixture, disconnect power by turning off the circuit breaker or by removing the fuse at the fuse box, and use a dry or slightly dampened, clean cloth to wipe the exterior surface of the fixture.

Troubleshooting

Problem	Possible Cause	Solution
The light(s) will not turn on.	The bulb is burned out.	Replace the light bulb.
	The power is off.	Ensure the power supply is turned on.
	There is a faulty switch.	Test or replace the switch.
	There is a faulty wire connection.	Check the wiring.
The fuse blows or the circuit breaker trips when the light is turned on.	There are crossed wires or the power wire is grounding out.	Discontinue use of the light. Check the wire connections. Contact a qualified electrician or call the Customer Care Service Team at 1-800-388-6141 ext 216. For customer service support and the fastest response, please email us at CustomerSupport@DSILighting.com .

Service Parts

MODEL: HD6472D

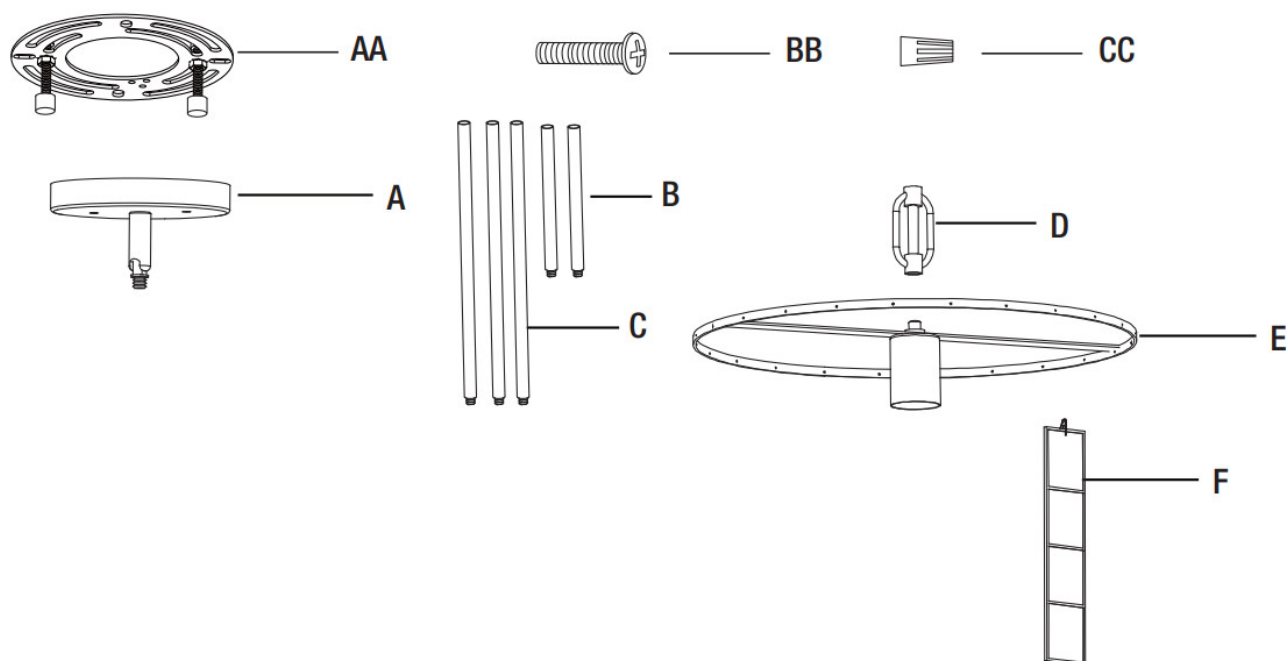

Part	Description
AA	Crossbar assembly
BB	Outlet box screw
CC	Wire connector
A	Ceiling canopy
B	6 in. rod
C	12 in. rod
D	Decorative part
E	Socket assembly
F	Glass accent



Questions, problems, missing parts? Before returning to the store,
call Design Solutions International Customer Service

Mon-Fri 9:30 am to 3:00 pm EST

1-800-388-6141 ext. 216

For customer service support and the fastest response, please email us at

CustomerSupport@DSILighting.com

Retain this manual for future use.

Documents / Resources

	<p>DSI HD6472D Camden 1 Light Matte Black Pendant with Frosted Bound Glass Shade [pdf]</p> <p>] User Manual</p> <p>HD6472D Camden 1 Light Matte Black Pendant with Frosted Bound Glass Shade, HD6472D, Camden 1 Light Matte Black Pendant with Frosted Bound Glass Shade, Pendant with Frosted Bound Glass Shade, Frosted Bound Glass Shade, Bound Glass Shade, Glass Shade</p>
---	---

[Manuals+](#)