



DS18 DSP2.8DBT Digital Sound Processor Owner's Manual

[Home](#) » [DS18](#) » DS18 DSP2.8DBT Digital Sound Processor Owner's Manual 

DS18 DSP2.8DBT Digital Sound Processor Owner's Manual



Congratulations, you have just purchased a product with DS18 quality. Through Engineers with years of experience, critical testing procedures, and a high-tech laboratory we have created a range of high-quality products that reproduce the musical signal with the clarity and fidelity you deserve.

To ensure optimal product operation, read this manual carefully before using the product. Keep the manual in a safe and accessible place for future reference.

Contents

- [1 FEATURES](#)
- [2 ELEMENT'S DESCRIPTION](#)
- [3 INSTALLATION](#)
- [4 FUNCTIONS DIAGRAM](#)
- [5 MENU & CONFIGURATIONS](#)
- [6 SPECIFICATIONS](#)
- [7 WARRANTY](#)
- [8 Documents / Resources](#)
 - [8.1 References](#)
- [9 Related Posts](#)

FEATURES

DSP2.8DBT

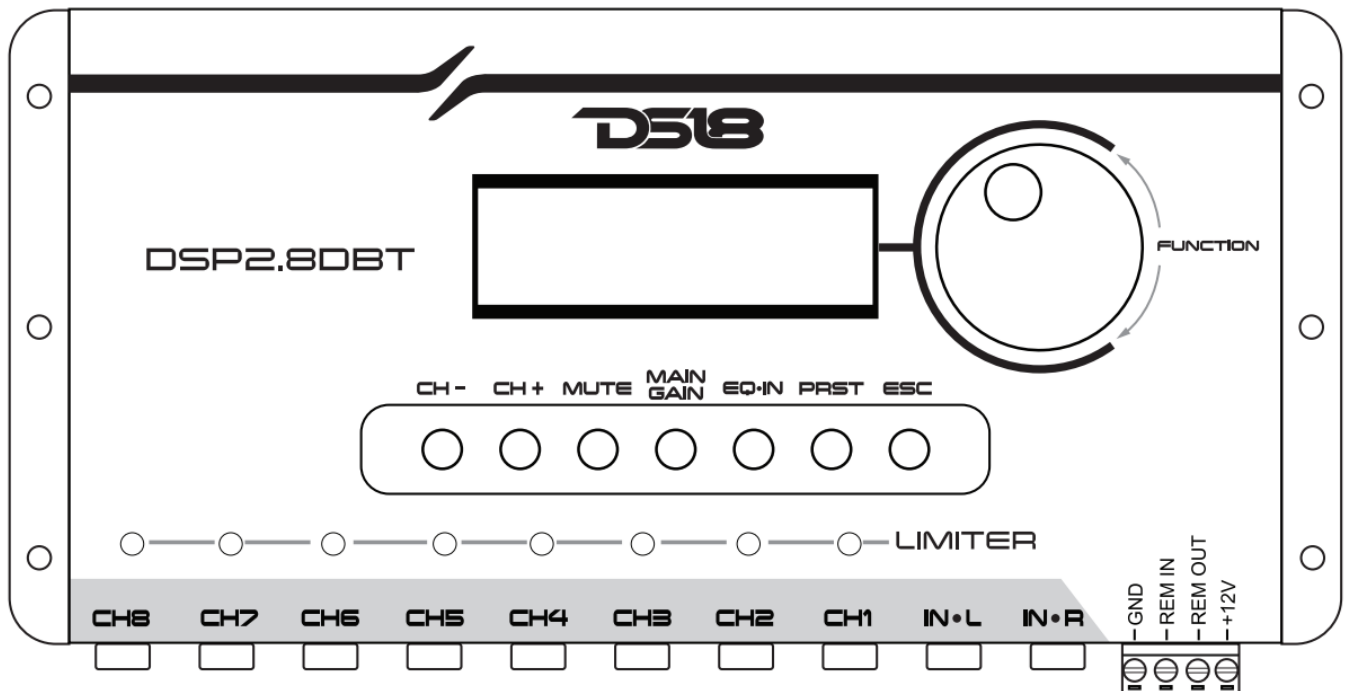

- 2 Channel RCA Audio Input
- 8 Channels RCA Audio Output
- Routing channels.
- Input equalizer with 15 bands between 1/3 octave.
- Parametric equalizer with 3 independent band per channel.
- Crossover with filters: Butterworth, Linkwitz-Riley and Bessel, with attenuations from 6dB/OCT until 48dB/OCT.
- Adjustable time delay per channel.
- Automatic or manual Limiter function with Threshold, Attack and Decay.
- Phase selector.
- Adjustable Input Gain.
- Mute function on each output channel.
- Pink-Noise generator.
- User's password.
- Preset with configurations.
- Independent output gain per channel.
- Remote output with 300mA max.
- Operating voltage 9V~16Vdc.
- BT Interface with Smartphone APP available for Android and iOS

ELEMENT'S DESCRIPTION

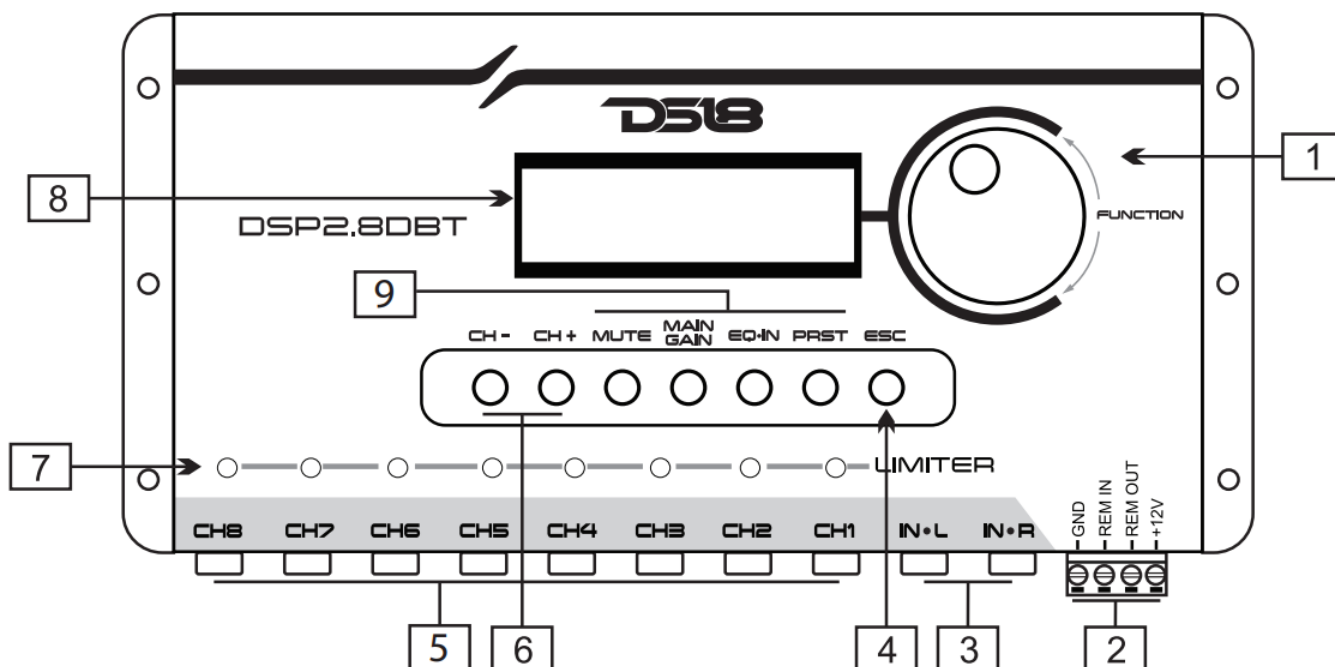

1. The rotary Encoder is responsible by select and change the parameters.
2. The power supply Input, must be connected with 12Vdc and consumes around 0,35A, the REM IN signal comes from player and REM OUT sends the signal to others devices (like amplifiers, mixers).
3. Input signal, must be connected to the player or another signal source.
4. Use the ESC button to return to previous parameters or menus.
5. 8 Independent outputs
6. Use the buttons to select the channel to be configured, can be used in any menu.
7. The LEDs that indicate when the limiter works.
8. Display shows the menus and parameters.
9. Mute: Independent Mute Per Channel
Main gain: Input Gain Adjustable
EQ-IN: Input equalizer with 15 bands between 1/3 octave
PRST: Preset with configurations

INSTALLATION

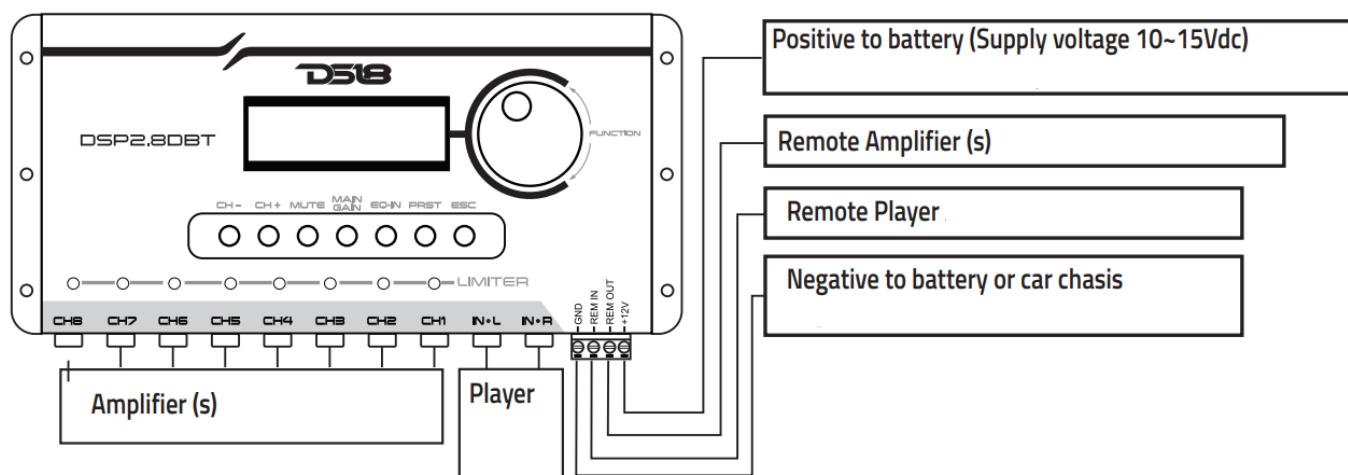

- Wire gauge 1 mm 2/18awg or bigger.

- REM IN must be connected to the player's remote.
- REM OUT must be connected to amplifiers.
- Voltage Power: 10~15Vdc.
- Consumption current: 0.35A.

FUNCTIONS DIAGRAM

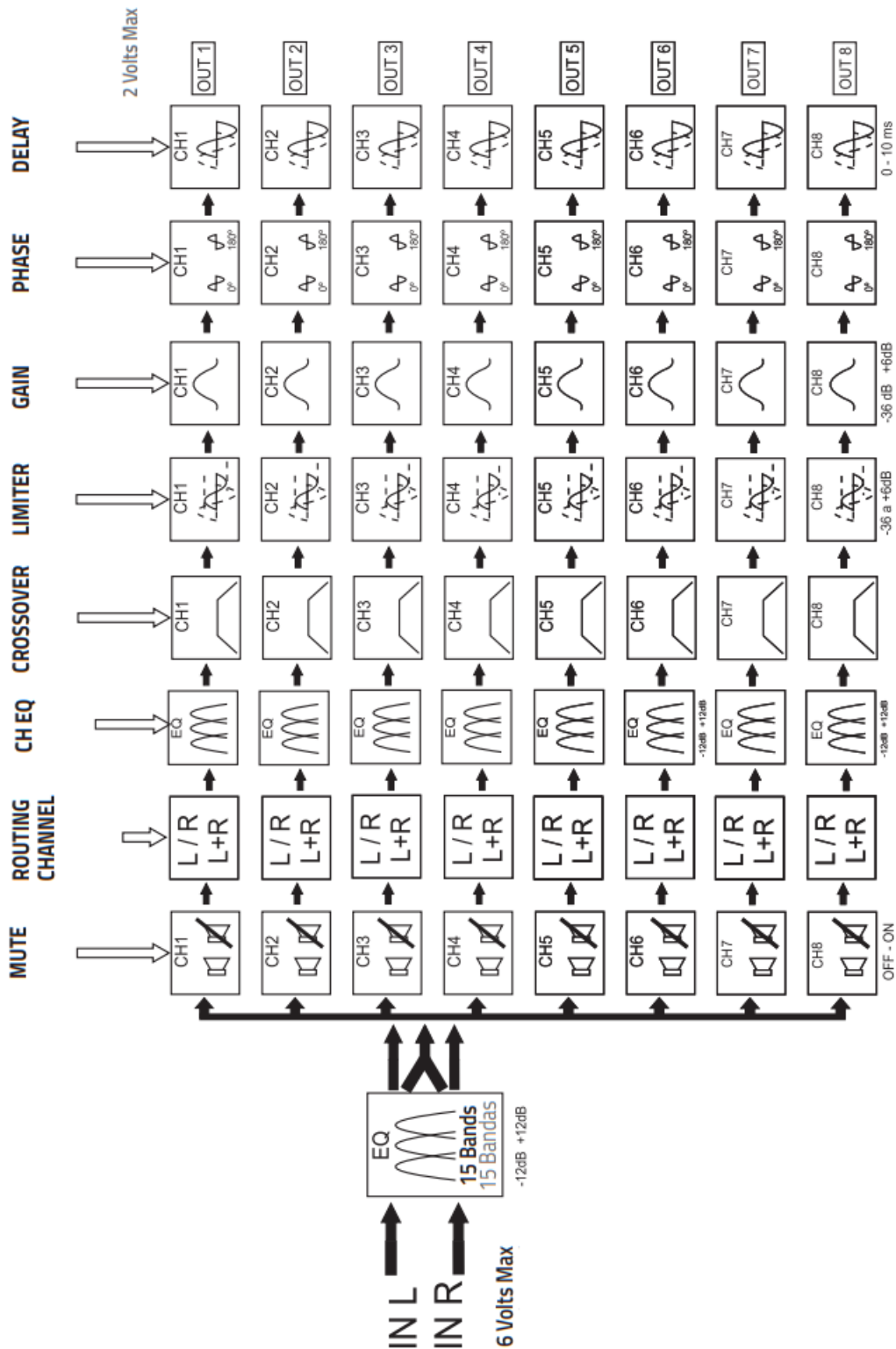

MENU & CONFIGURATIONS

ACCESSING THE MENU

Turn the Encoder to choose the menus, if you want to open the menu, just press the Encoder.

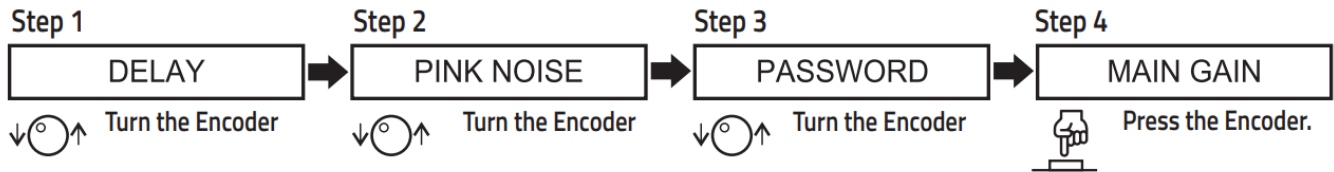

MAIN GAIN

Adjust the main gain in the processor.

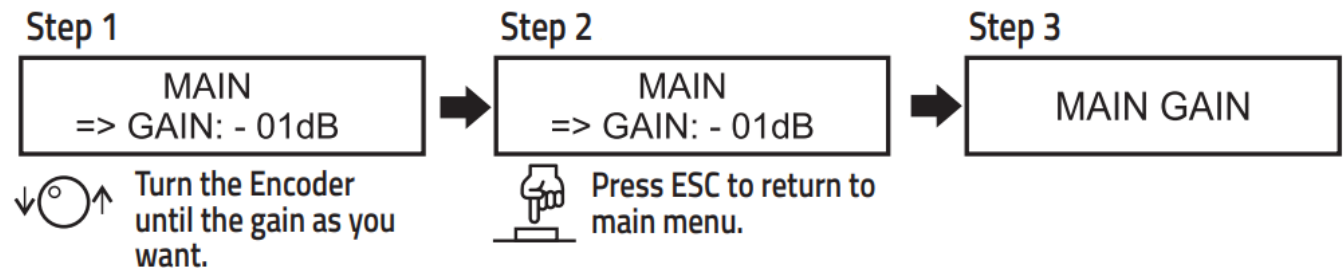

ROUTING CHANNEL OUTPUT

Make the routing channels between input and output. If you select L, that channel will receive just the L side, when you select R, that channel will receive just the R side. If you select L+R, the channel will receive both signals (mono).

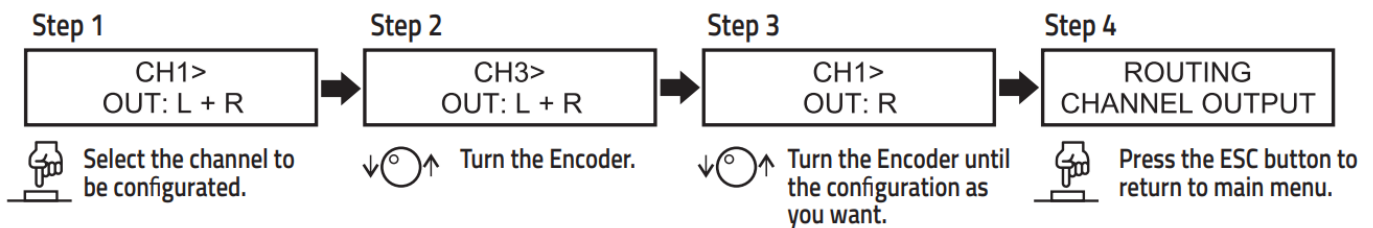

GAIN

Allow change the independent gain per each channel.

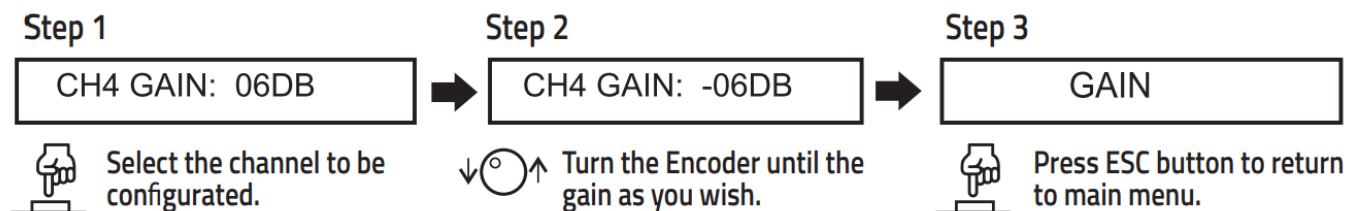

CROSSOVER

Allow eliminate the frequencies that you don't need, it has filters Butterworth, Linkwitz-Riley, and Bessel, with 6~48db/OCT.

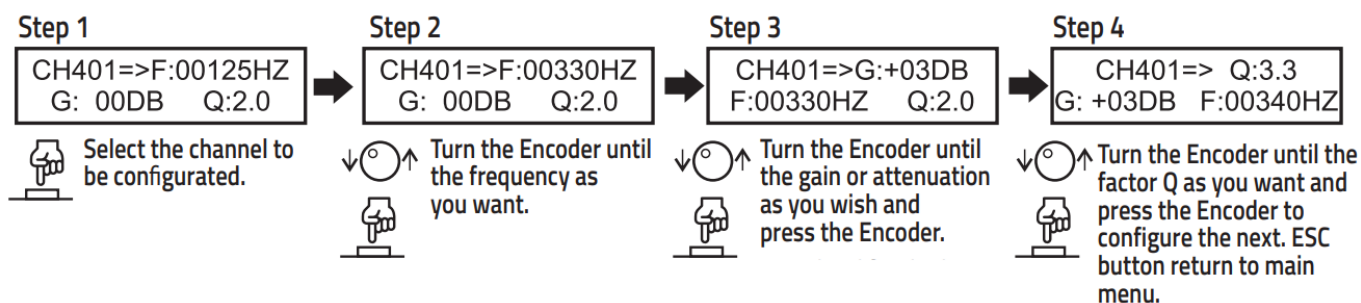

POLARITY / PHASE

Allow changing the polarity in the output.

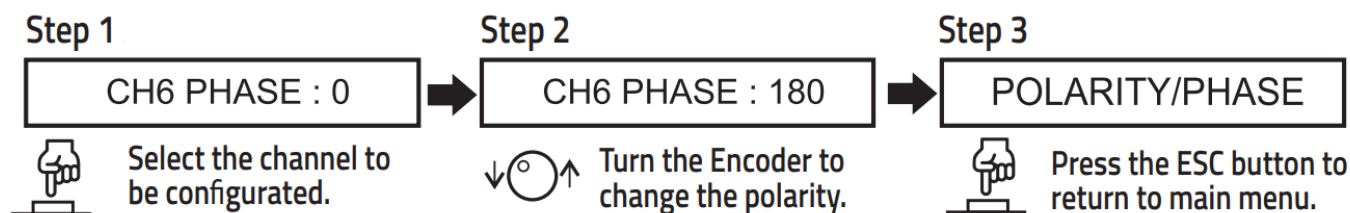

DELAY

Allow increase time delay to align better the speakers.

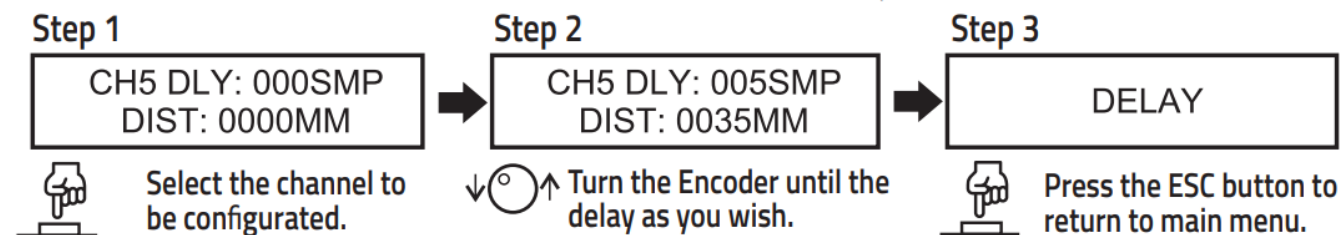

CHANNEL EQ

Channel equalizer allows increase/decrease 3 independent frequencies per channel between 20~20kHz with frequency, gain and Q factor adjustments.

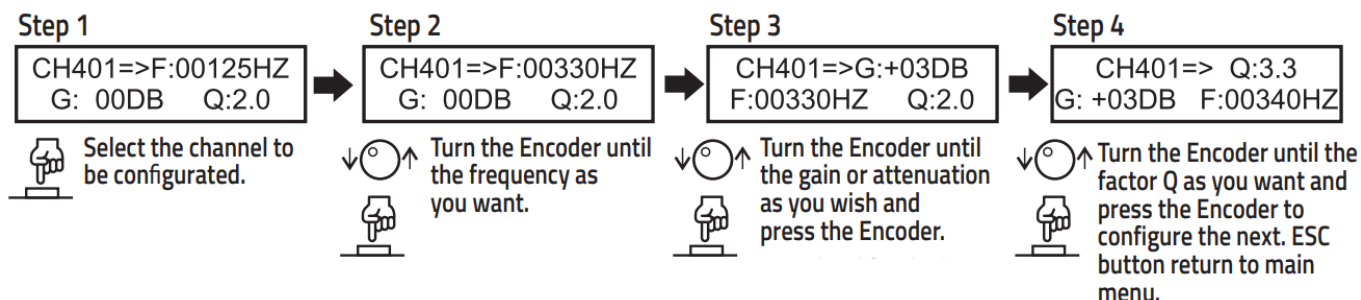

INPUT EQ

Input equalizer allows level up/down the signal by setting a frequency between 20hz and 20khz with 15 bands spaced by 1/3 octave.

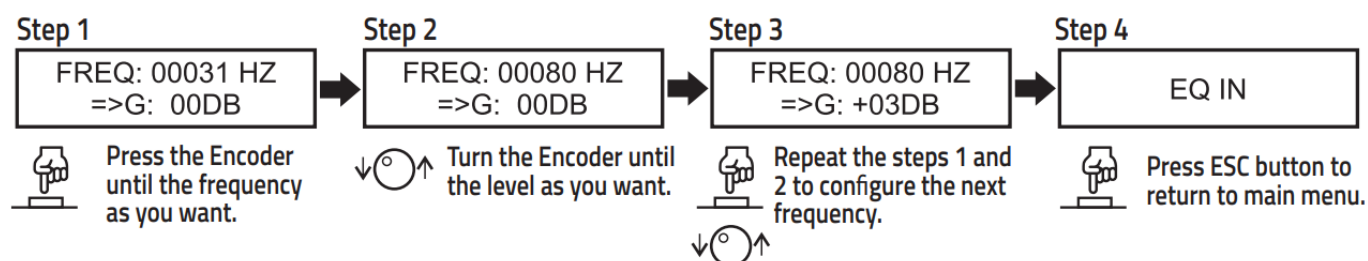

LIMITER

Choose a limit for the audio signal doesn't pass the level max set.

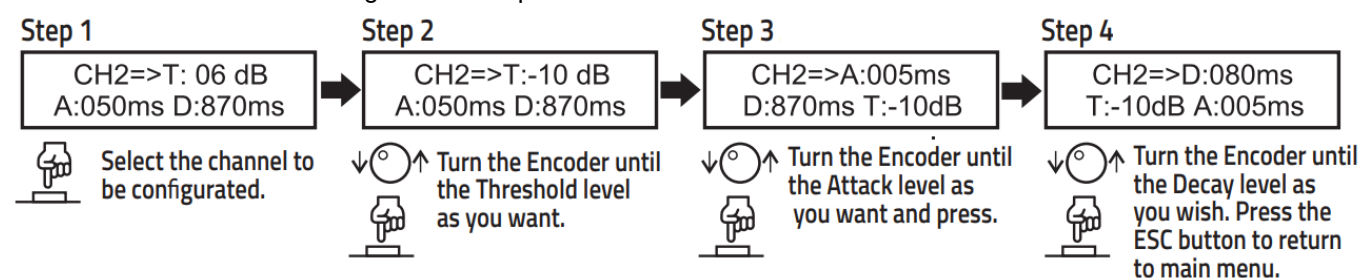

CUSTOM PRESET

The Processor Presets save ALL configurations of the device, just choose the Preset and configure as you wish, so the values will be saved on device automatically.

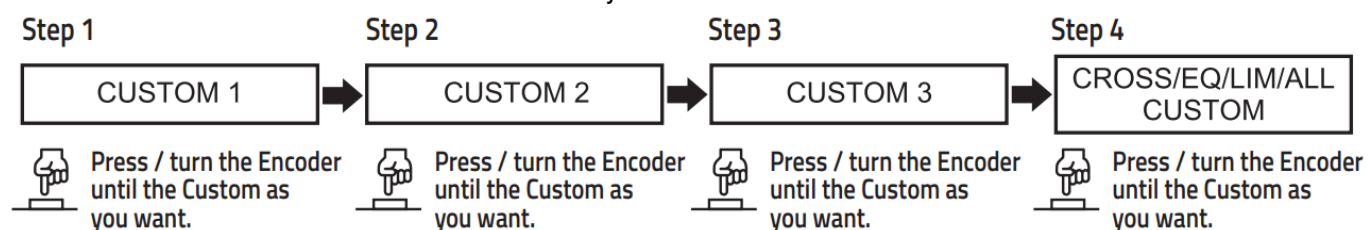

Attention!

The Presets save all the configurations on the processor, if you choose another preset, this one has the factory configurations, it will be needed configuration again as you want.

PINK NOISE

Pink noise Generator to make easier the system alignment:

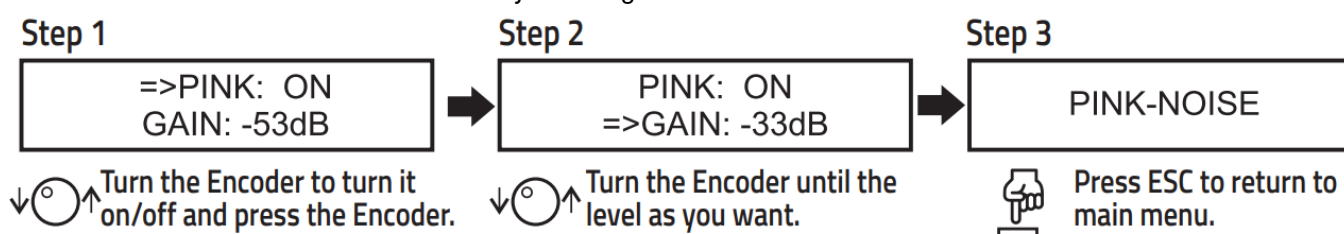

PASSWORD

Define a password to protect the configurations:

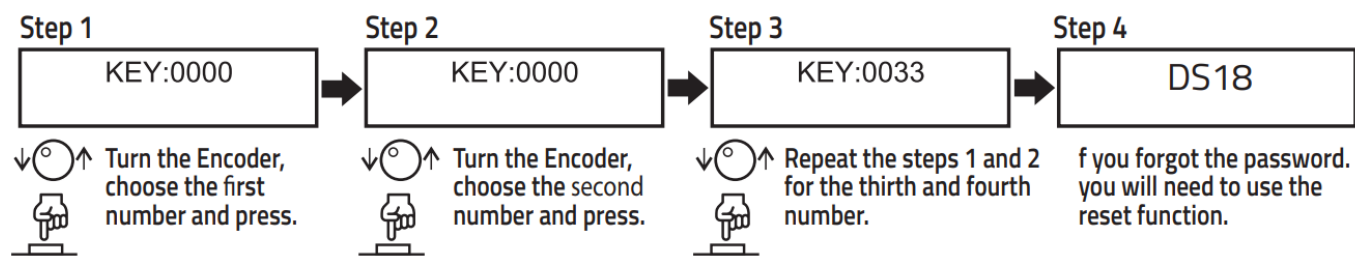

MUTE

To mute a output, select the channel and press the MUTE button to change the mute status.

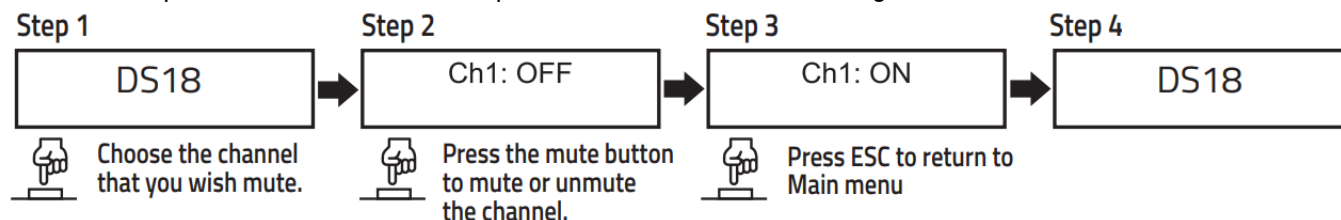

RESET

To make a reset of the processor to factory configurations, return to initial display, press and hold the ESC button, on a few seconds, the processor will be restarted.

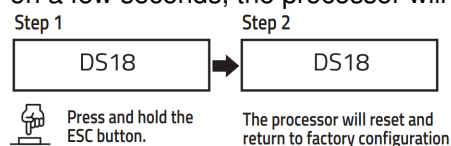

BT INTERFACE

Through a didactic and intuitive interface, it is possible do all the processor's configurations from DS18 by smartphone or tablet, making easier the system alignment, it can be done from your audio system in real time.



- The app can be downloaded directly on Google Play Store or Apple Store for free.
- The app is available only for this DS18 DSP line, but there is a demo mode for the people who don't have some experience with this yet and can learn how it works.

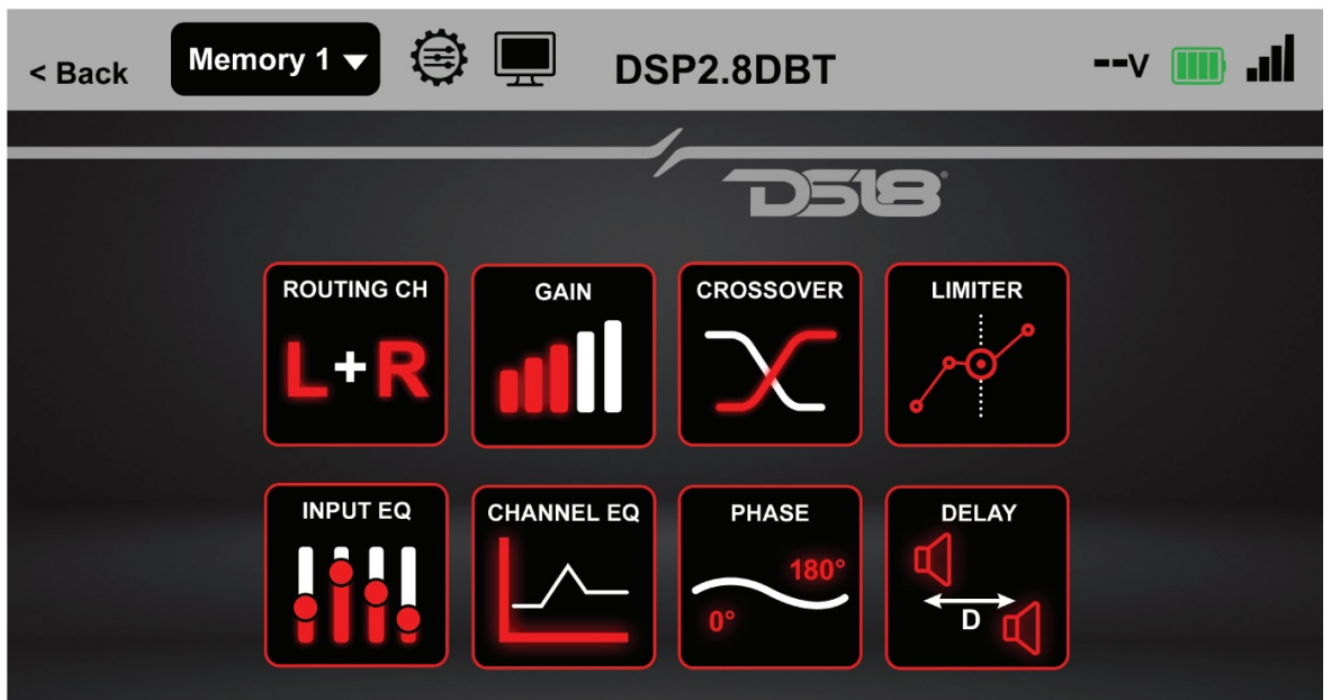

FUNCTIONS

- ROUTING CH
- GAIN
- CROSSOVER
- LIMITER
- DELAY
- INPUT EQ
- CHANNEL EQ
- PHASE
- PRESET
- PASSWORD

PAIRING

- Download the app on Google Play Store or Apple Store.
- Turn on the device's location.
- Turn on the Bluetooth.
- Open the app.
- Automatically the app will find the processor.
- Select the processor.
- Type the password.
- Factory's password: 0000.
- To change the factory password, type your new password again and press the Encoder.
- To change the password again, you must reset the processor.

Compatible with all IOS versions and Android 4.3 or later.

SPECIFICATIONS

INPUTS

Type Unbalanced
Connection RCA
Max level Up to 6 Volts RMS

OUTPUTS (1,2,3,4,5,6,7,8):

Type Unbalanced
Connection RCA
Max Level 2 Volts RMS
Impedance 470kΩ

TECHNICAL INFORMATION

Resolution 24 Bits
Sample Frequency 48Khz
Latency Frequency 1.08ms
Range Frequency 15Hz a 22KHz (-1db)
THD+N max 0,01%
Signal Noise Ratio 100dB

POWER SUPPLY 10~15Vdc

Consumption 300mA (5w)
Fuse / 2 A

Dimensions (H x L x D) 72" x 9.84" x 1.18" / 120 x 250 x 30mm
Weight / 382g / 13.4 Oz

WARRANTY

Please visit our website DS18.com for more information on our warranty policy.

We reserve the right to change products and specifications at any time without notice.
Images may or may not included optional equipment



FOR MORE INFORMATION PLEASE VISIT
DS18.COM



Documents / Resources

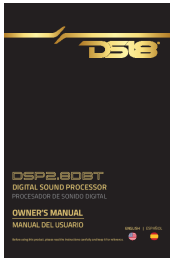

[DS18 DSP2.8DBT Digital Sound Processor](#) [pdf] Owner's Manual
DSP2.8DBT, Digital Sound Processor, Sound Processor, DSP2.8DBT, Processor

References

- [🚫 Official DS18 Pro Audio Store - Speakers, Subwoofers, Amps & More!](#)

[Manuals+.](#)