

DS18 DBPX200.MX Digital Bass Processor Owner's Manual

[Home](#) » [DS18](#) » DS18 DBPX200.MX Digital Bass Processor Owner's Manual 

Contents

- 1 DS18 DBPX200.MX Digital Bass Processor
- 2 Product Information
- 3 Product Usage Instructions
- 4 Frequently Asked Questions
- 5 FEATURES
- 6 OPERATIONS OF FUNCTIONS
- 7 DUAL KNOB DASH MOUNT REMOTE CONTROL
- 8 SIGNAL CONNECTION
- 9 SPECIFICATIONS
- 10 MEASUREMENTS
- 11 GUARANTEE POLICY
- 12 Documents / Resources
 - 12.1 References



DS18 DBPX200.MX Digital Bass Processor



Product Information

Specifications:

- **Product:** Digital Bass Processor with Hi to Low Signal Converter
- **Model:** DBPX200.MX
- **Input Voltage:** Up to 30V
- **Output Voltage Options:** 10V/7.5V/5V
- **Subsonic Crossover Frequency:** 50Hz
- **Ground Isolation Options:** GND/ISO/200

Product Usage Instructions

- **RCA Inputs:**
The RCA Inputs are designed with a balanced input circuit to minimize noise and can handle signal voltages up to 10V.
- **Bass Remote Level Control:**
Adjust the bass level produced by your system and control the amount of bass restoration using the Bass Remote Level Control.
- **Speaker Inputs:**
The Speaker Inputs also use a balanced input circuit and can handle high signal voltages up to 30V.
- **Power LED:**
The Power LED indicates that the unit is powered on.
- **Bass Enhancer LED:**
Indicates low-frequency bass output from the processor.
- **Speaker Input Load Select:**
Select the appropriate load setting (20k/60/20) based on your audio system requirements.
- **Trigger Mode:**
Select the Turn-On mode based on your system type (Audio, DC-ON, REM-IN).
- **Ground Isolation:**
Select the appropriate grounding option (GND / ISO / 200) to resolve alternator whine issues.

- **Subsonic:**

Control the high-pass crossover for the subwoofer output by adjusting the Subsonic setting (ON / OFF) to 50Hz.

- **Output Voltage:**

Adjust the signal voltage of the Bass Restoration Circuit by selecting the desired output voltage (10V / 7.5V / 5V).

- **Power Terminal Block:**

Secure connections properly to prevent shorts and damage to the unit.

- **Bass Restoration Settings:**

Use the SWEEP knob to select the center frequency and the WIDE knob to adjust the frequency range for bass restoration.

Frequently Asked Questions

Q: How do I adjust the bass level using the Bass Remote Level Control?

A: Simply turn the Bass Remote Level Control knob to increase or decrease the bass level produced by your system.

Q: What is the purpose of the Subsonic setting?

A: The Subsonic setting controls the high-pass crossover for the subwoofer output, helping to filter out frequencies below a certain point to protect your speakers.

Q: How do I select the Trigger Mode?

A: Depending on your system type, choose either Audio, DC-ON, or REM-IN as the Turn-On mode for the device.

DIGITAL BASS PROCESSOR WITH HI TO LOW SIGNAL CONVERTER

- Congratulations, you have just purchased a product with DS18 quality. Through Engineers with years of experience, critical testing procedures, and a high-tech laboratory we have created a range of high-quality products that reproduce the musical signal with the clarity and fidelity you deserve.
- To ensure optimal product operation, read this manual carefully before using the product. Keep the manual in a safe and accessible place for future reference.

FEATURES

- Balanced line-level input
- A fully adjustable bass processor that creates low frequencies from the source
- Hi-Level speaker inputs for OEM integration
- Dual knob dash mount remote control
- Input load selector
- Subsonic filter

- Auto Turn-on selectable
- PCB with anti-corrosion coating
- Compact design

BEFORE OPERATING THE UNIT, PLEASE READ THIS MANUAL THOROUGHLY AND RETAIN IT FOR FUTURE REFERENCE

OPERATIONS OF FUNCTIONS

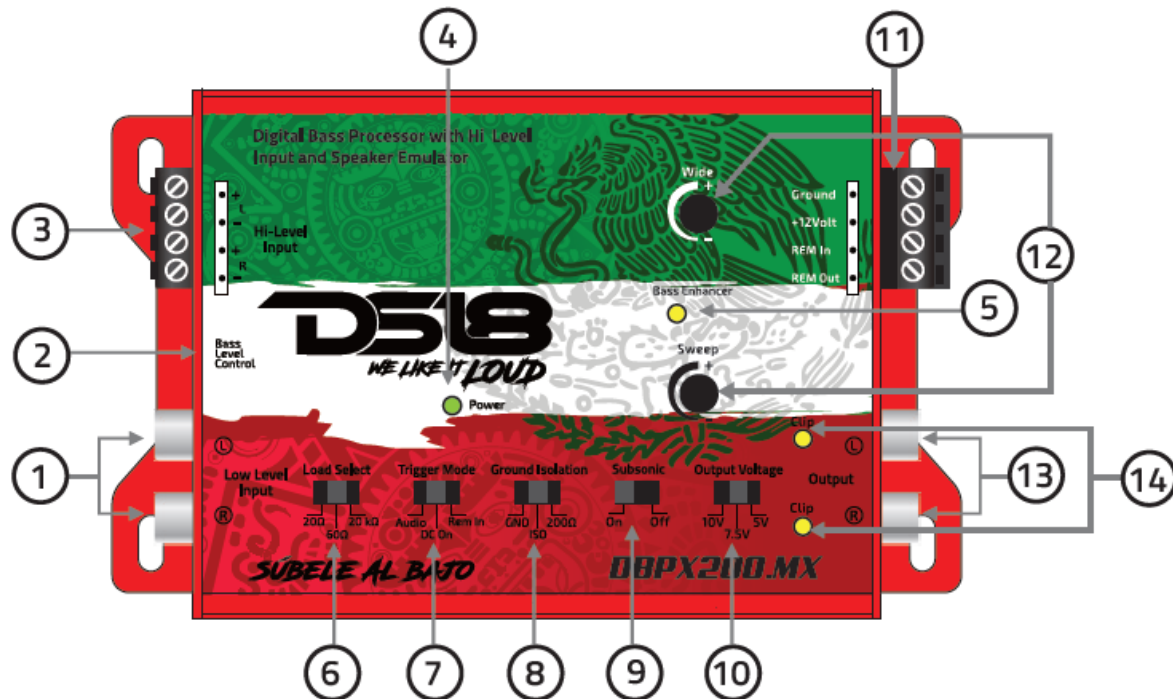

- 1. RCA Inputs:** The inputs of the DBPX200.MX uses a balanced input circuit to minimize induced noise. They are also designed to handle very high signal voltages up to 10V.
- 2. Bass Remote Level Control:** Adjust the level of the bass produced by your system. Also adjusts the amount of bass restoration.
- 3. Speaker Inputs:** The inputs of the DBPX200.MX uses a balanced input circuit to minimize induced noise. They are also designed to handle very high signal voltages up to 30V.
- 4. Power LED:** Notifies that power to the unit is on.
- 5. Bass Enhancer LED:** Low-frequency BASS indicator light at processor output.
- 6. Speaker Input Load Select (20kΩ / 60Ω / 20Ω):** For factory audio systems requiring a resistance load to output audio, select 60Ω first, then 20Ω. All others use the 20kΩ setting.
- 7. Trigger Mode:** Select the "Turn-On" mode depending on your system type. You can turn on the device using:
 - **Audio:** Signal Input from Speaker or RCA.
 - **DC-ON:** Offset voltage from speaker input only.
 - **REM-IN:** Using the remote +12V input from the head unit.
- 8. Ground Isolation (GND/ISO/200Ω):** Occasionally alternator whine may appear in a system due to improper grounding. To help resolve this situation the DBPX200.MX provides alternative grounding connections. Make sure your system is OFF before moving these switches.
- 9. Subsonic (ON/OFF):** This controls the high-pass crossover for the subwoofer output. Adjust from OFF to ON, set at 50Hz

10. **Output Voltage (10V/7.5V/5V):** Systems vary in design, with some geared for powerful SPL performance and others for a more refined audio experience. The Bass Maximizer allows you to adjust the signal voltage of the Bass Restoration Circuit, either increasing or decreasing it. Depending on your system, you can change this switch to a higher or lower setting to optimize your bass output and safeguard your speakers.
11. **Power Terminal Block/+12V/Ground/REM In/REM Out:** Be sure to secure your connections to prevent shorts and damage to your DS18 unit.
12. **Bass Restoration Settings:** These knobs govern the bass restorer functions of the DBPX200.MX. The SWEEP knob enables you to select the center frequency that the DBPX200.MX will maximize. The WIDE knob adjusts the width of the frequency range that the DBPX200.MX will impact.
13. **RCA Output:** Connect these RCA connectors to the subsequent component after the DBPX200.MX, such as a crossover, equalizer, or amplifier. It's important to note that the DBPX200.MX should be placed in line before a crossover.
14. **CLIP Lamp:** Activates when the total harmonic distortion (THD) reaches 1% of the machine output.

DUAL KNOB DASH MOUNT REMOTE CONTROL

1. Power LED Indicator
2. Output Level Knob
3. Bass Restoration level knob
4. Cable connector from processor

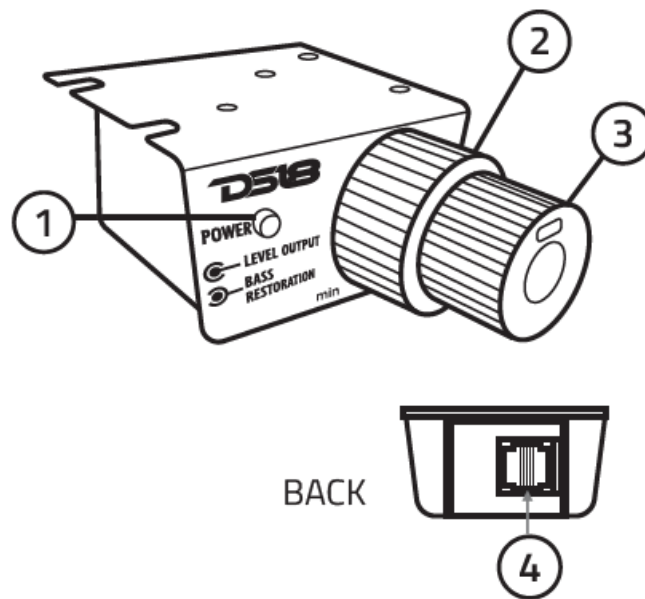

SIGNAL CONNECTION

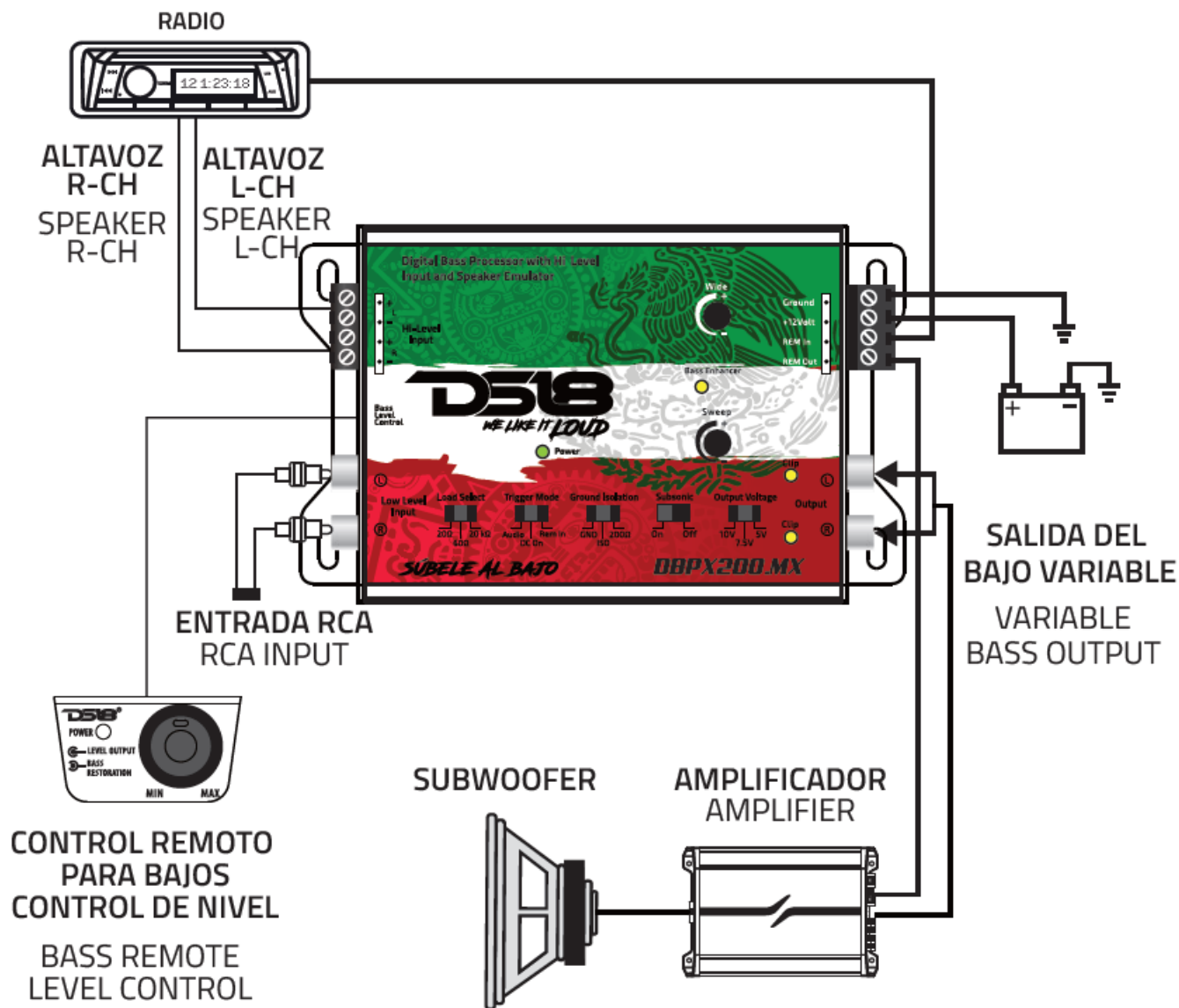

SPECIFICATIONS

GENERAL FEATURES

- Operating Voltage 9-16V
- Power Consumption 0.18A
- Recommended Fuse Rating 1A
- Power Input Terminal
Size 16ga
- LED Indicator Power / Bass
Enhancer
- Ground Isolation Switch Yes
(GND/ISO/200Ω)
- Hi-Level Speaker Input Yes (2
Channels)

- Auto Turn-on Function.....Yes
(Audio/DC)
- Remote Turn-on (Input / Output)
.....Yes
- Remote Level Control.....Yes (Bass Enhancer/Level/Clip LED)
- RCA Connector TypeTiffany
(Silver)
- Compact Size for an Easy Installation in Any Application.....Yes
- Surface Mount Component Technology
.....Yes
- Quality Control Verification using Audio Precision InstrumentsYes
- Housing Material
.....Aluminum
- Body ColorRed / Green /
White

AUDIO SPECIFICATIONS

- Frequency Response10Hz-
20kHz
- S/N
Ratio.....
- THD.....
- 0.05%
- Input Sensitivity (Low-Level)
<8.8V
- Input Sensitivity (Hi-Level)
.....>15V
- Input Impedance.....
- 20Kohms
- Output VoltageSelectable
(5V/7.5V/10V)
- Output Impedance
.....110ohms
- Balanced Input Noise Rejection
.....>45dB
- Stereo
Separation.....>50dB

CROSSOVER SECTION

- Subwoofer LPF Frequency Cut-off..... No (Full Range Signal)
- Subwoofer Infrasonic Frequency Cut-off.....Selectable (Off/50Hz)

BASS PROCESSOR SECTION

- Gain.....
- Center Frequency (Sweep)
.....75Hz~120Hz
- Q Factor (Wide)
.....1~4

MEASUREMENTS

- Overall Length
.....6"/153mm
- Overall Width
3.7"/95mm
- Overall
Height.....1.1"/28mm

MEASUREMENTS

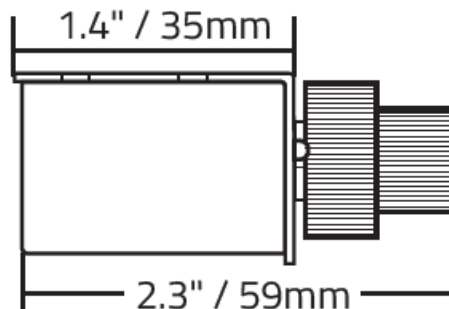
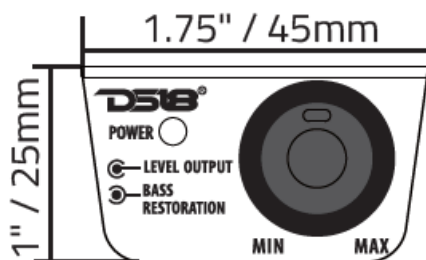
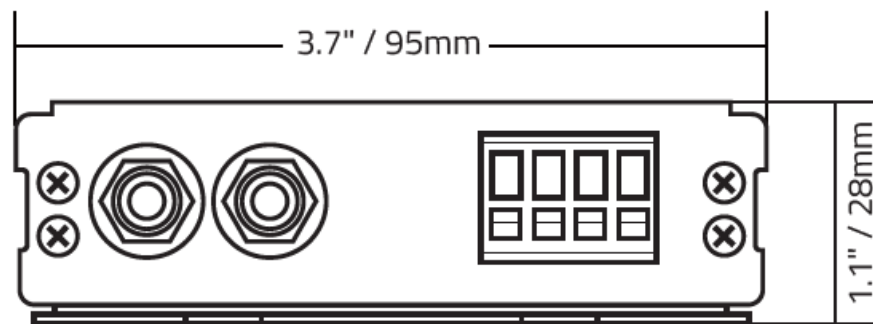
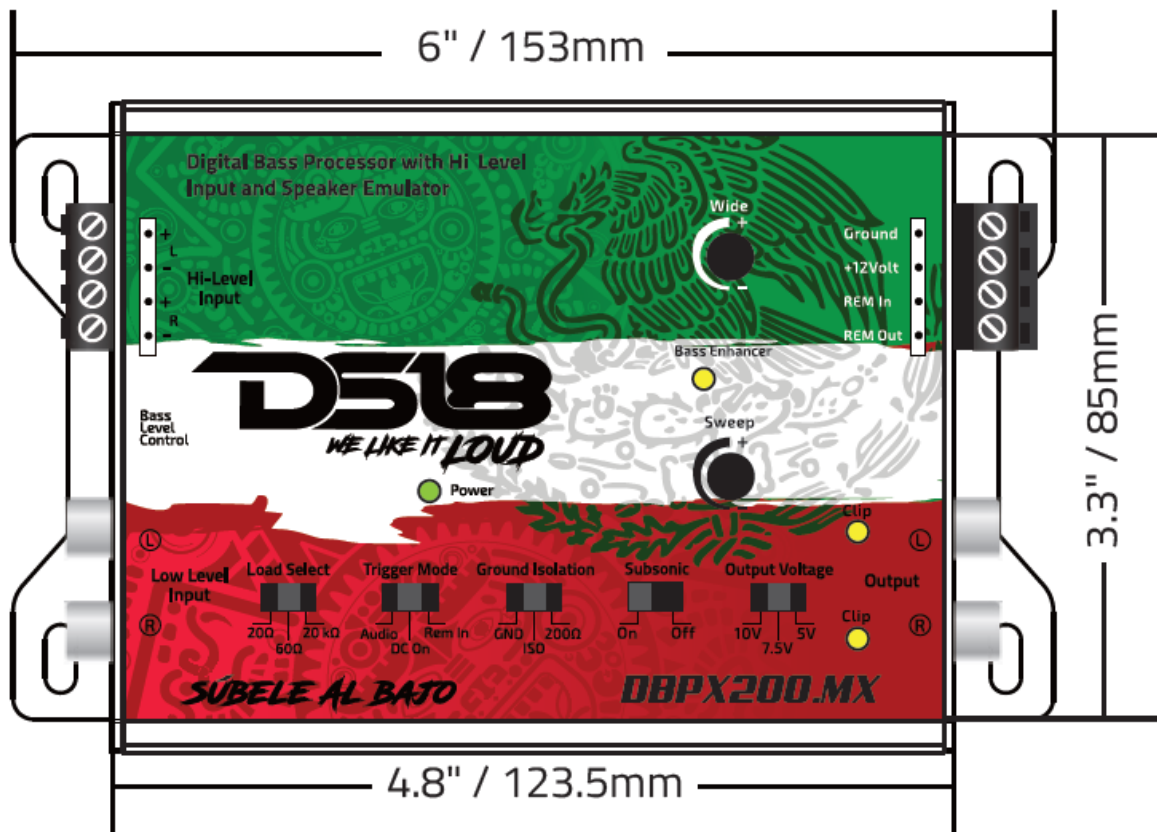

WARNING:

Cancer and Reproductive Harm. www.P65Warning.ca.gov.

GUARANTEE POLICY

Monsiry Group S.R. L. of C.V. Ave. Baburias # 14171 Int. B, Fracc. Jose Sandoval, La Mesa, Tijuana, B.C. Mexico c.p. 22105 [GMO071107H23] guarantees this product for a period of 1 year against any defect in the materials and workmanship used in the manufacture of this product from purchase, delivery or installation, under the following conditions:

- Product Description: _____
- **Brand:** D518
- **Product model:** _____

1. To make the guarantee effective, the policy must be previously sealed by the Distributor who marketed this product.
2. The company is responsible for repairing the defective product, changing parts or changing it if the repair is not possible, without any charge to the consumer and to cover the expenses derived from transportation, compliance with this policy.
3. In no case should the repair time be longer than 30 days, counted from the receipt of the product, in the only workshop authorized by Grupo Monsiry for such purposes, located at the following address:

Grupo Monsiry S de RL de CV

- Carretera Base Aérea 3525 Int. 6 Col. Estrada C.P. 45200 Zapopan, Jalisco.
 - **Tel:** 3338255541
4. The scope of this policy is only within the national territory.
 - DISTRIBUTOR NAME:
 - ADDRESS:
 - PRODUCT PURCHASE DATE: DAY _____ MONTH _____ YEAR: _____
 - STORE SEAL:

THIS POLICY WILL LOSE ITS VALIDITY IN THE FOLLOWING CASES:

1. If the product has been used outside of specifications.
2. If the product has not been used under the user manual.
3. If the product has been intervened by people other than those authorized by the company. For more information, please contact us at the following email address: kicker.ealvarez@gmail.com Tel: 3338255541.

Documents / Resources

	<p>DS18 DBPX200.MX Digital Bass Processor [pdf] Owner's Manual DBPX200.MX, DBPX200.MX Digital Bass Processor, Digital Bass Processor, Bass Processor, P rocessor</p>
---	--

References

- [Official DS18 Pro Audio Store - Speakers, Subwoofers, Amps & More!](#)
- [User Manual](#)

Manuals+, Privacy Policy

This website is an independent publication and is neither affiliated with nor endorsed by any of the trademark owners. The "Bluetooth®" word mark and logos are registered trademarks owned by Bluetooth SIG, Inc. The "Wi-Fi®" word mark and logos are registered trademarks owned by the Wi-Fi Alliance. Any use of these marks on this website does not imply any affiliation with or endorsement.