

**Contents** [ [hide](#) ]

- [1 DREAME D10 PLUS GEN2 Auto Empty Robot Vacuum and Mop](#)
- [2 Product Usage Instructions](#)
- [3 Safety Information](#)
- [4 Product Overview](#)
- [5 Preparing Your Home](#)
- [6 Before Use](#)
- [7 How to Use](#)
- [8 Routine Maintenance](#)
- [9 Troubleshooting](#)
- [10 Specifications](#)
- [11 FAQ](#)
- [12 Documents / Resources](#)
  - [12.1 References](#)

# DREAME

## DREAME D10 PLUS GEN2 Auto Empty Robot Vacuum and Mop



## Product Usage Instructions

- To avoid electric shock, fire, or injury caused by improper use of the appliance, please read the user manual carefully before using the appliance and keep it for future reference.
- Ensure the robot is turned off and stored in a cool, dry place when not in use.
- Recharge the robot at least once every 3 months to prevent over-discharging the battery.
- To prevent hazards due to inadvertent resetting of the thermal cut-out, do not supply the appliance through an external switching device like a timer or a circuit that is regularly switched on and off by the utility.

## Safety Information

To avoid electric shock, fire, or injury caused by improper use of the appliance, please read the user manual carefully before using the appliance and keep it for future reference.

## Usage Restrictions

- This product should not be used by children younger than 8 years old or persons with physical, sensory, intellectual deficiencies, or limited experience or knowledge without the supervision of a parent or guardian to ensure safe operation and to avoid any risks. Cleaning and maintenance shall not be performed by children without

supervision.

- This appliance contains batteries that can only be replaced by skilled persons.
- Clear the area to be cleaned. Children shall not play with the appliance. Ensure children and pets are kept at a safe distance from the robot while it is operating.
- Do not install, charge or use the appliance in the bathrooms or around the pools.
- This product is for floor cleaning in a home environment only. Do not use it outdoors, on non-floor surfaces, or in a commercial or industrial setting.
- If the power cord is damaged, it must be replaced by a special cord or assembly available from the manufacturer or its service agent.
- Do not use the robot in an area suspended above ground level without a protective barrier.
- Do not place the robot upside down. Do not use the LDS cover, robot cover, or bumper as a handle for the robot.
- Use the robot in environments with an ambient temperature above 0°C and below 40°C. Make sure there is no liquid or sticky substance on the floor.
- To prevent damage or harm from dragging, clear any loose objects from the floor, and remove cables or power cords on the cleaning path before operating the appliance.
- Remove fragile or small items from the floor to prevent the robot from bumping into and damaging them.
- Keep hair, fingers, and other body parts away from the suction opening of the robot.
- Do not operate the appliance in a room where an infant or child is sleeping.
- Do not place children, pets, or any item on top of the robot, regardless of whether it is stationary or moving.
- Do not use the robot to clean any burning objects. Do not use the robot to pick up flammable or combustible liquids, corrosive gases, or undiluted acids or solvents.
- Do not vacuum hard or sharp objects. Do not use the appliance to pick up objects such as stones, large pieces of paper or any item that may clog the appliance.
- The plug must be removed from the socket outlet before cleaning or maintaining the appliance.
- Do not wipe the robot or the base station with a wet cloth or rinse them with any liquid. After cleaning washable parts, fully dry the parts before reinstalling and using them.
- Please use this product in accordance with the instructions in the User Manual. Users are responsible for any loss or damage that arise from improper use of this product.

## **Batteries and Charging**

- Do not use any third-party battery or base station with auto-empty. Use only with RCDD0202 supply unit.
- Do not attempt to disassemble, repair, or modify the battery or the base station with auto-empty on your own.
- Do not place the base station with auto-empty near a heat source.
- Do not use a wet cloth or wet hands to wipe or clean the charging contacts of the base station with auto-empty.
- Do not improperly dispose of old batteries. Unneeded batteries should be discarded at an appropriate recycling facility.
- If the power cord becomes damaged or broken, stop using it immediately and contact after-sales service.
- Make sure the robot is turned off when being transported and kept in its original packaging if possible.
- If the robot will not be used for an extended period, fully charge it, then turn it off and store it in a cool, dry place. Recharge the robot at least once every 3 months to avoid over-discharging the battery.



## **Laser Safety Information**

The laser sensor in this product meets the IEC 60825-1:2014/EN 60825-1:2014/A11:2021 Standard for Class 1 laser products. Please avoid direct eye contact with it during use.

- CLASS 1 LASER PRODUCT
- CONSUMER LASER PRODUCT
- EN 50689:2021

### **CAUTION:**

In order to avoid a hazard due to inadvertent resetting of the thermal cut-out, this appliance must not be supplied through an external switching device, such as a timer, or connected to a circuit that is regularly switched on and off by the utility.

-  For indoor use only
-  Read the operator's manual

## Product Overview

### Package Contents



Robot

#### Other Accessories



Side Brush



Dust Bag x2  
(pre-installed x1)



Cleaning Tool  
(pre-installed)



Power Cord



Base Station with  
Auto-Empty



Water Tank



Mop Pad  
(pre-installed)



User Manual

### Robot

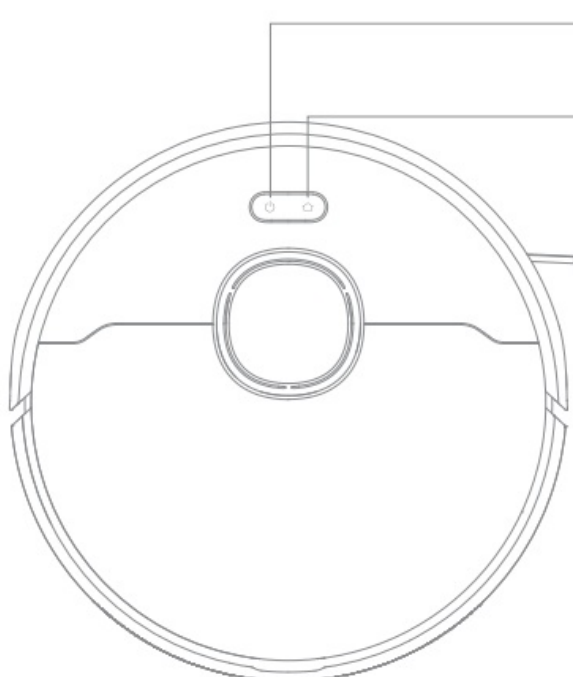

#### Power/Clean Button

- Press and hold for 3 seconds to turn on or off
- Press to start cleaning after the robot is turned on

#### Dock/Spot Cleaning Button

- Press to send the robot back to the base station
- Press and hold for 3 seconds to start spot cleaning

#### Status Indicator

- **Solid White:** Cleaning or cleanup completed
- **Blinking Orange:** Error
- **Breathing White:** Robot is charging when the battery power is not low

#### Note:

- Press any button on the robot to pause while the robot is cleaning or returning to charge.
- Child Lock can be enabled/disabled through the Dreamehome app.

# Robot and Sensors

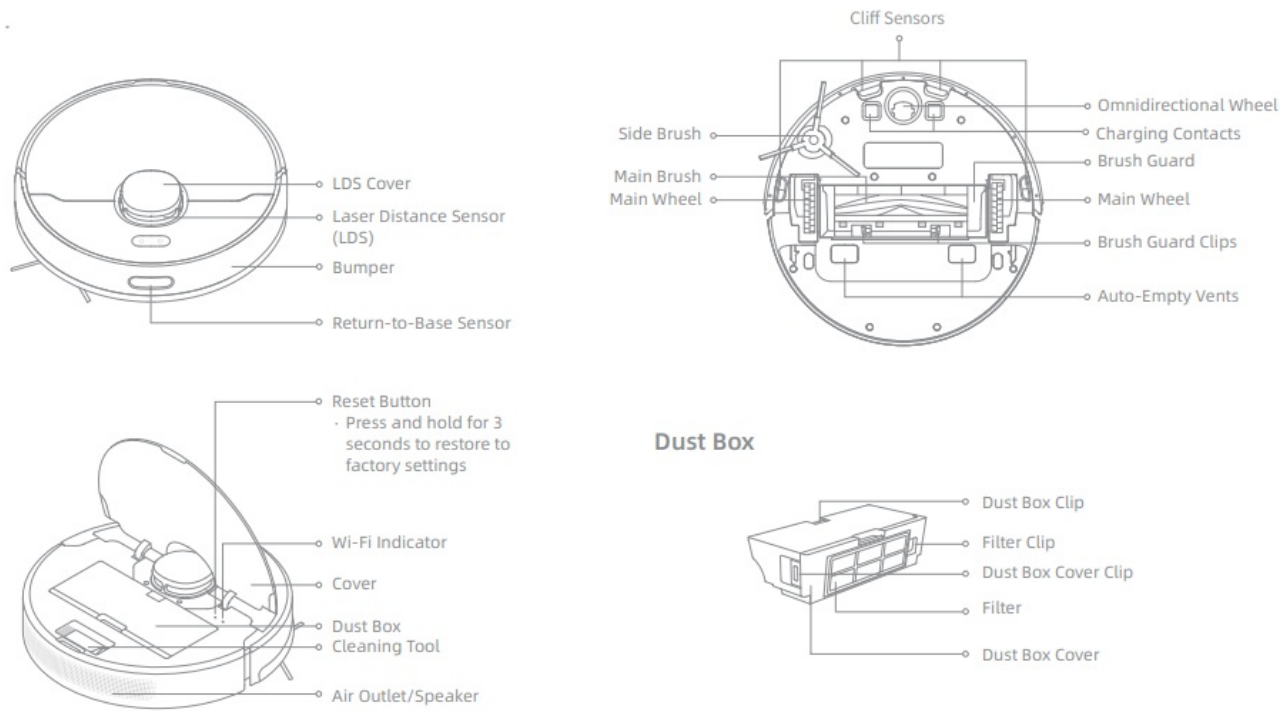

# Mopping Module

# Water Tank

## Water Tank

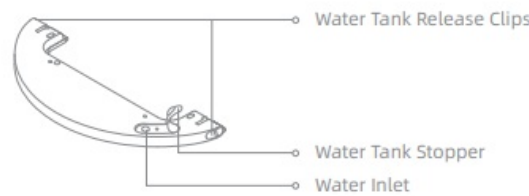

## Mop Pad



# Base Station with Auto-Empty

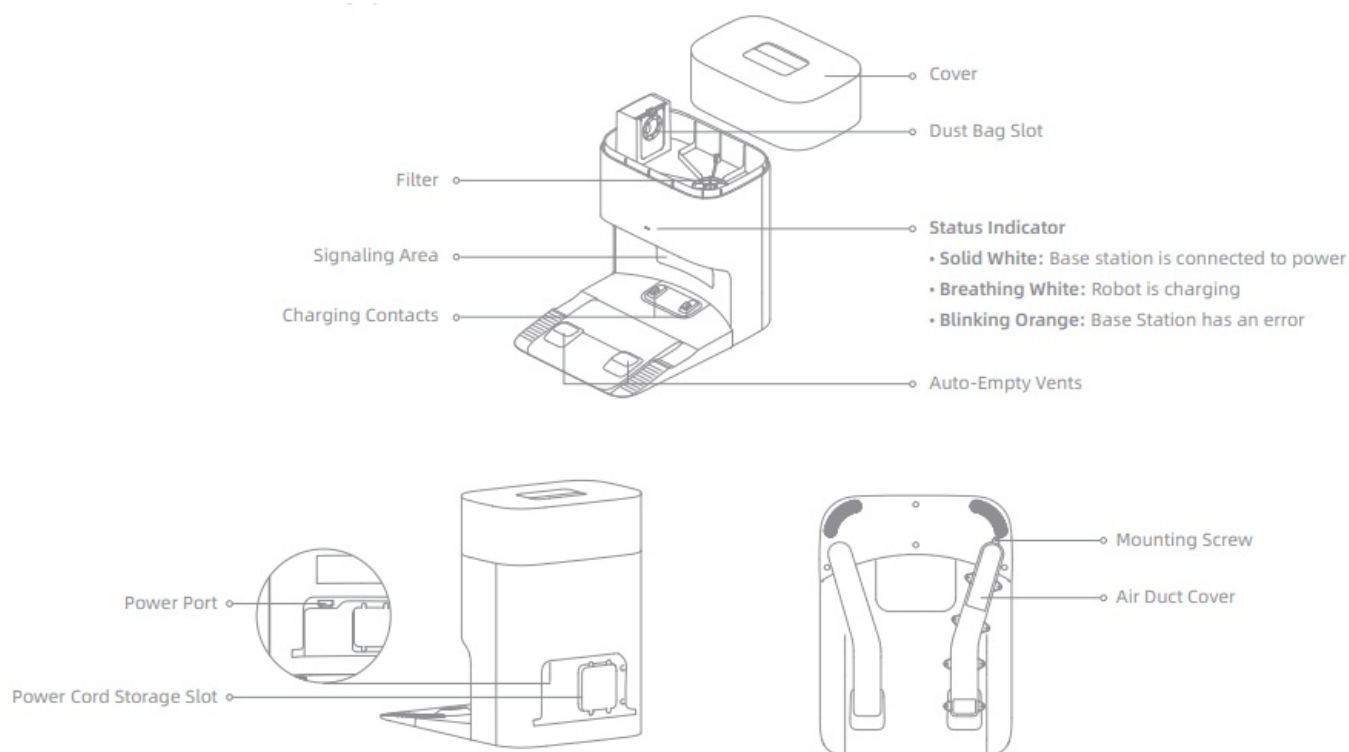

## Preparing Your Home

- Before cleaning, please move away unstable, fragile, valuable or dangerous items, and clean up cables, cloths, toys, hard objects and sharp objects on the ground to avoid being entangled, scratched or knocked over by the robot and causing losses.



- Before cleaning, place a physical barrier at the edge of the stairs and sofa to ensure the secure and smooth operations of the robot.

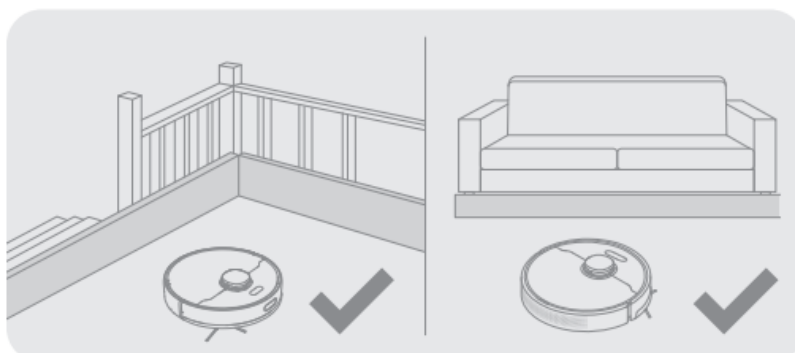

- Open the door of the room to be cleaned, and put the furniture in its proper place to leave more space.

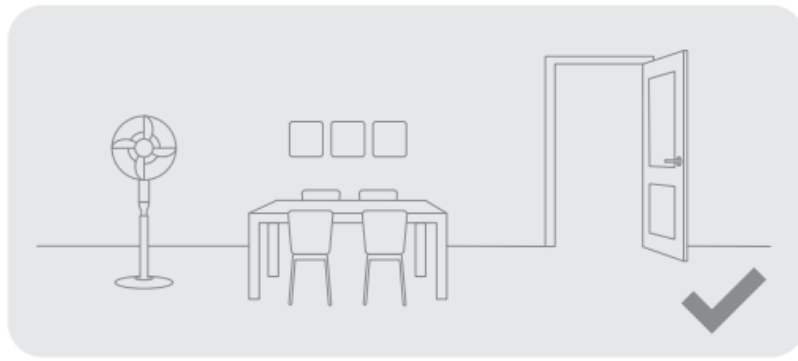

- To prevent the robot from not recognizing areas that need to be cleaned, do not stand in front of the robot, or in a threshold, hallway, or narrow places.

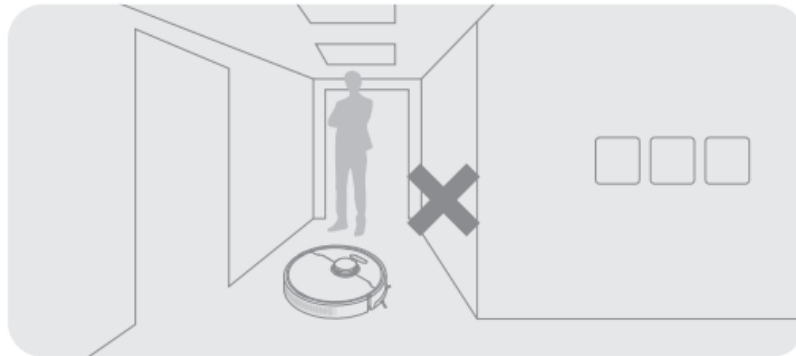

### Note:

- When operating the robot for the first time, follow it around while cleaning to remove any potential obstacles in time.
- Do not vacuum hard objects like stones, steel balls, and toy parts, or sharp objects like construction waste, broken glass, and nails; otherwise, the ground may be scratched.

## Before Use

1. Place the Base Station and Connect to an Electrical Outlet Place the base station on level ground against the wall. Insert the power cord into the base station and plug it into the socket.
  1. 📶 Place the base station in a location that is as open as possible with a good Wi-Fi signal.

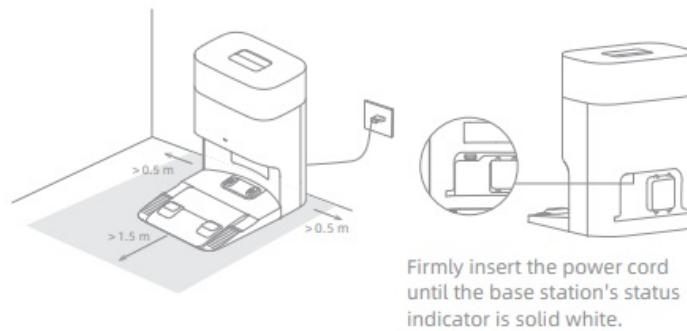

**Note:**

1. Make sure that no objects might block the signaling area.
2. Remove any objects that are closer than 1.5 m from the front and 0.5 m from either side of the base station.

**2. Remove the Protections**

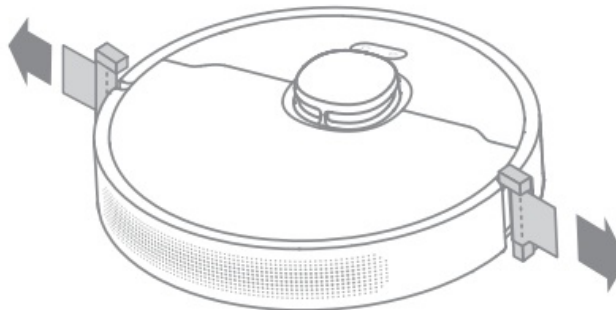

**3. Install the Side Brush**

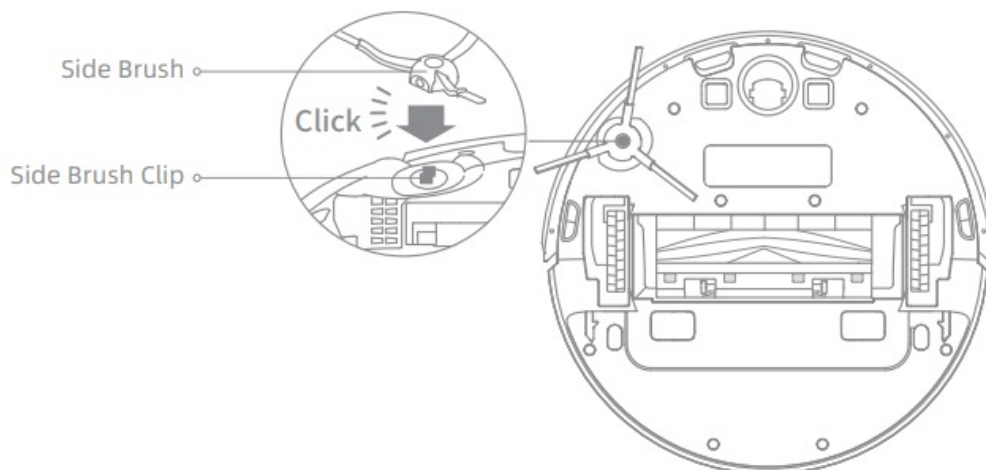

Note: Install the side brush until it clicks into place.

**4. Charge the Robot**

When placing the robot, align the charging contacts at the bottom of the robot with the charging contacts of the base station, and the robot will automatically turn on and start charging.

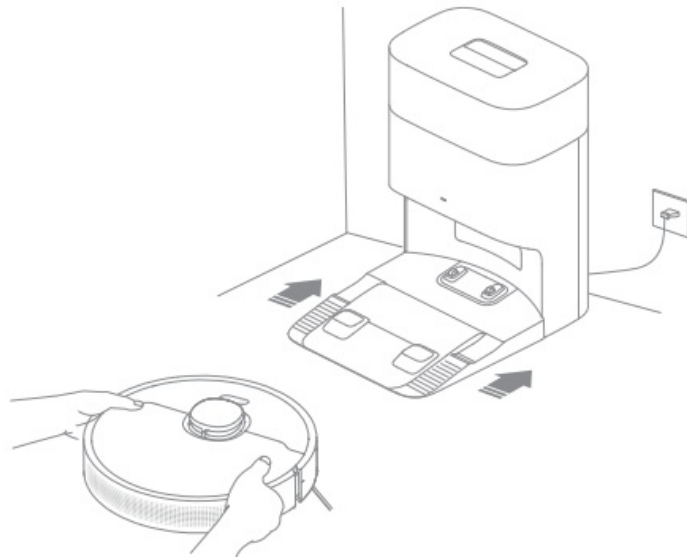

**Note:** It is recommended to fully charge your robot before first time use.

## Connecting with the Dreamehome App

### Download the Dreamehome App

Scan the QR code on the robot, or search “Dreamehome” in the app store to download and install the app.

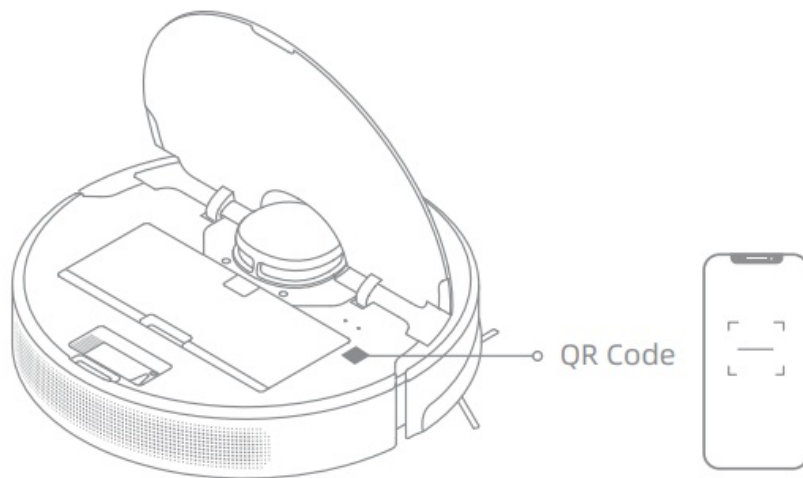

### Note:

- Only 2.4GHz Wi-Fi is supported.
- Due to upgrades in the app software, the actual operations may differ from the directions in this manual. Please follow the instructions based on the current app version.

## Add Device

Open the Dreamehome app, tap  in the upper right corner, and scan the same QR code on the robot again to add the device. Please follow the prompts to finish the Wi-Fi connection.

**Note:** If you want to reset Wi-Fi, repeat step 2 and then follow the prompts to finish the Wi-Fi connection.

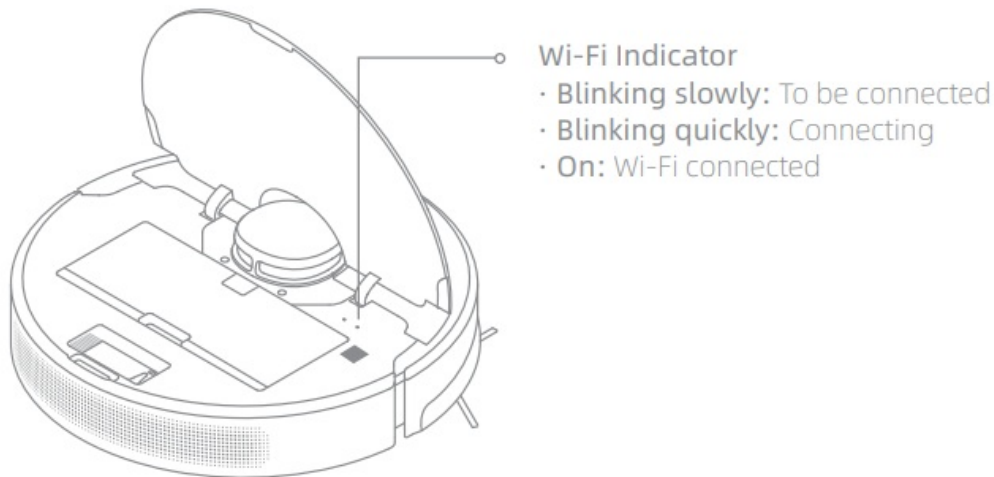

## How to Use

### Turn On/Off

- Press and hold the button for 3 seconds to turn on the robot. The power indicator should be illuminated. Place the robot onto the base station, the robot should turn on automatically and begin charging.
- To turn off the robot, move the robot away from the base station and press and hold the button for 3 seconds.

### Fast Mapping

- After configuring the network for the first time, follow the instructions in the app to quickly create a map.
- The robot will start mapping without cleaning. When the robot returns to the base station, the mapping process has been completed, and the map will be saved automatically.

### Start Cleaning

- Press the button to start cleaning after the robot is turned on. The robot will accurately map out a route, methodically clean along the edges and walls, then finish by cleaning each room in an S-shaped pattern to ensure a thorough job.

### **Note:**

- It is recommended that the robot set out from the base station before cleaning. Do not move the base station while the robot is cleaning. This ensures that the robot returns to the base station smoothly.
- After the robot completes the cleaning task and automatically returns to the base station, the base station will start auto-empty. More settings can be operated on the app.

### **Pause/Sleep**

- When the robot is running, press any button to pause it.
- If the robot is paused for more than 10 minutes, it automatically enters sleep mode. All indicators on the robot will turn off. Press any button on the robot or base station, or use the app to wake up the robot.
- Note: If the robot is paused and placed onto the base station, the current cleaning process will end.

### **Auto Resume Cleaning**

- If the battery is too low, the robot will automatically return to the base station to charge. After charging to the appropriate battery level, it will resume unfinished cleaning tasks.
- Note: To use this function, please open it in the App.

### **Do Not Disturb (DND) Mode**

- When the robot is set to Do Not Disturb (DND) mode, the robot will be prevented from resuming cleaning, and the power indicator will turn off.
- DND mode is disabled by default at the factory. You can use the app to enable DND mode or modify the DND period. The DND period is 22:00–8:00 by default.

**Note:**

- The scheduled cleaning tasks will be performed as usual during the DND period.
- The robot will resume cleanup where it left off after the DND period expires.

**Spot Cleaning**

- When the robot is on standby, press and hold the button for 3 seconds to enable the spot cleaning mode.
- In this mode, the robot cleans a square-shaped area of  $1.5 \times 1.5$  meters around it and returns to its starting point once the spot cleaning is completed.

**Robot Restarting**

- If the robot stops responding or cannot be turned off, press and hold the button for 10 seconds to forcefully turn it off.
- Then, press and hold the button for 3 seconds to turn the robot on.

**Use the Mopping Function**

It is recommended that all floors are vacuumed at least three times before the first mopping session to achieve a better cleaning effect.

- Dampen the mop pad and wring out excess water. Install the mop pad as shown in the diagram.



- Fill the tank with water.

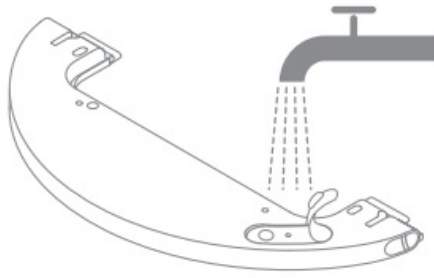

**Note:**

1. Do not use detergent or disinfectant.
  2. Do not fill the water tank with hot water as this may cause the water tank to warp.
- Align the mopping module as indicated by the arrow, then slide it into the back of the robot until it clicks into place. Press the button  or use the Dreamehome app to start cleaning.

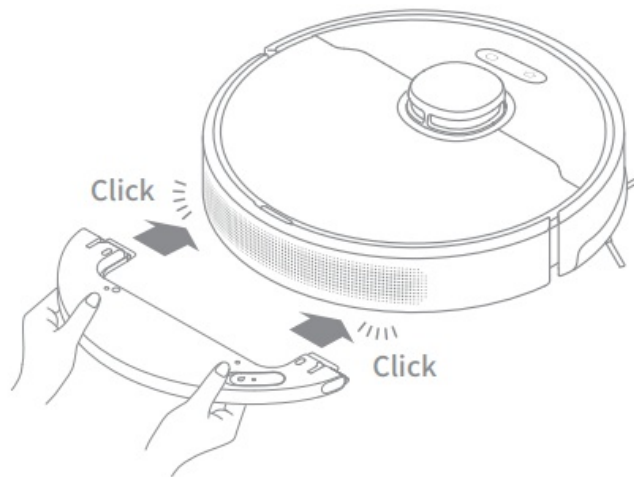

**Note:**

- It is not recommended to use the mopping function on carpets.
  - Use the app to adjust the water flow as required.
- When the robot finishes a cleaning task and returns to the base station, remove the mopping module and wash the mop pad in time. To remove the water tank, slide the two release clips on the side of it to take it out.

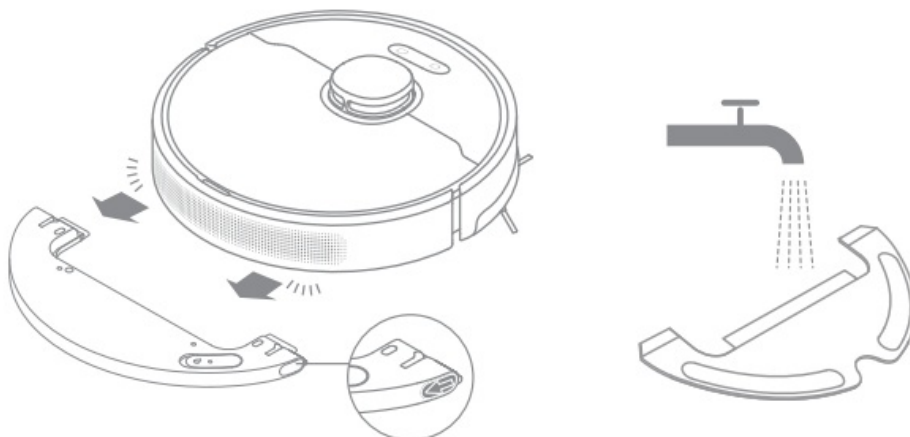

**Note:** When the robot is charging or not in use, remove the mopping module, pour out

all the remaining water in the water tank, and clean the mop pad to prevent mildew or odors.

## Routine Maintenance

### Parts

To keep the robot in good condition, it is recommended to refer to the accessory usage in the app or the following table for routine maintenance.

Part	Maintenance Frequency	Replacement Period
Mop pad	After each use	Every 3 to 6 months
Main Brush	Once every 2 weeks	Every 6 to 12 months
Side Brush		Every 3 to 6 months
Dust box's filter		
Base station's signaling area	Once every month	/
Base station's charging contacts		
Base station's auto-empty vents		
Laser Distance Sensor (LDS)		
Robot's charging contacts		

Part	Maintenance Frequency	Replacement Period
Robot's auto-empty vents		
Bumper		

Omnidirectional wheel	Once every month	
Return-to-Base Sensor		
Cliff sensors		
Bottom of the robot		
Dust box	Clean it as needed	/
Water Tank		
Dust bag	/	Every 2 to 4 months

**Note:** The replacement frequency will depend on your usage of the robot. If an exception occurs due to special circumstances, the parts should be replaced.

## Mopping Module

1. Slide the two release clips on the side of the water tank, remove the mopping module, and pull the mop pad off the mopping module.

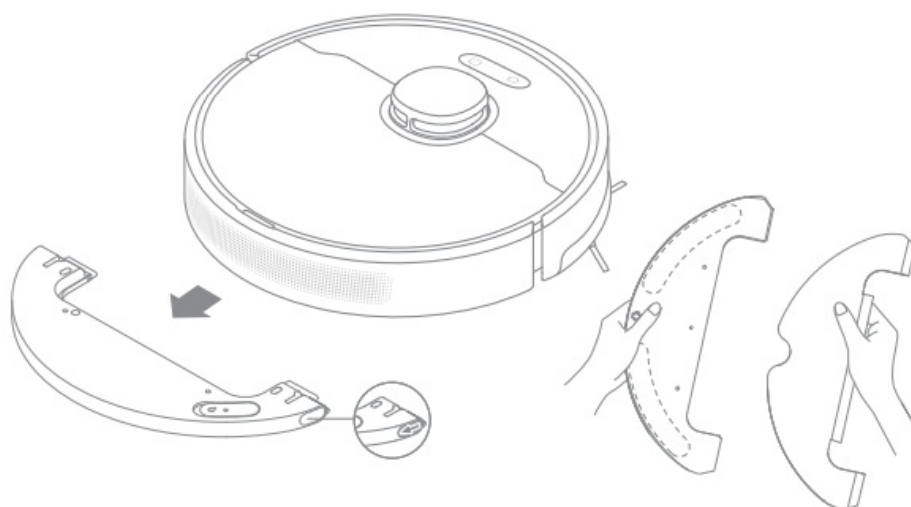

2. Pour out the water in the tank. Clean the tank with water only and leave it to air dry before reinstalling

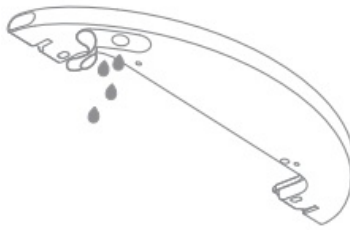

**Note:** Do not directly expose the water tank to sunlight.

3. Clean the mop pad with water only and leave it to air dry before reinstalling.

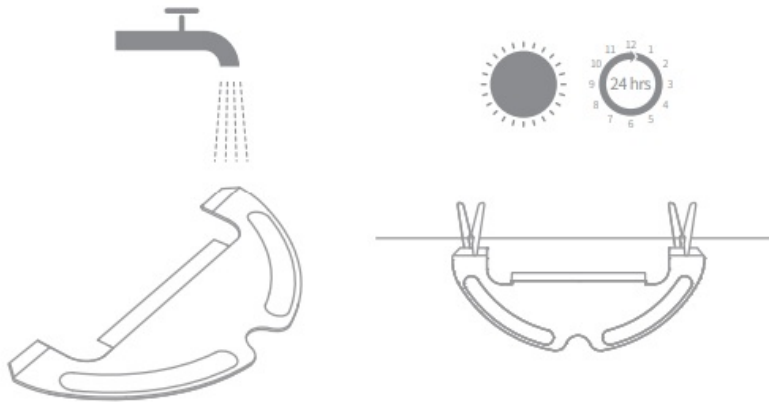

Note: Remove the mop pad from the mopping module before cleaning it, and make sure dirty water does not flow back into the water outlet to avoid clogging.

4. If slow water flow occurs, or the water volume is not well-distributed, clean the air hole in the cover of the water tank.



## Main Brush

1. Press the brush guard clips inwards to remove the brush guard and lift the brush out of the robot.

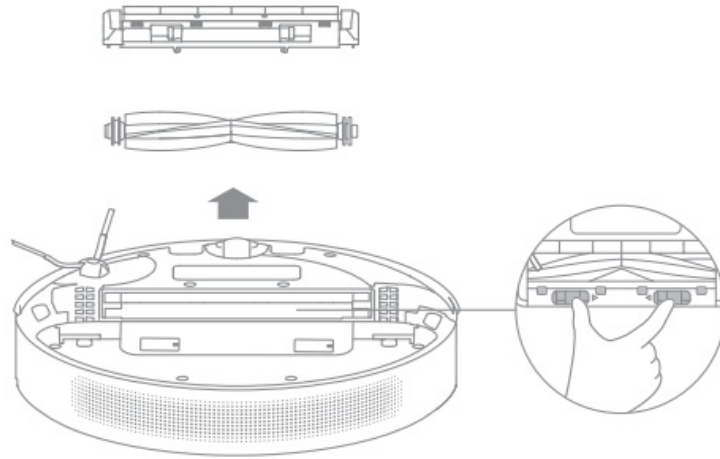

2. Pull out the brush covers at both ends of the brush as shown in the diagram. Use the provided cleaning tool to remove any hairs tangled in the brush. Reinstall the brush covers on both ends of the brush, and then reinstall the brush. Press on the brush guard to lock it in place.

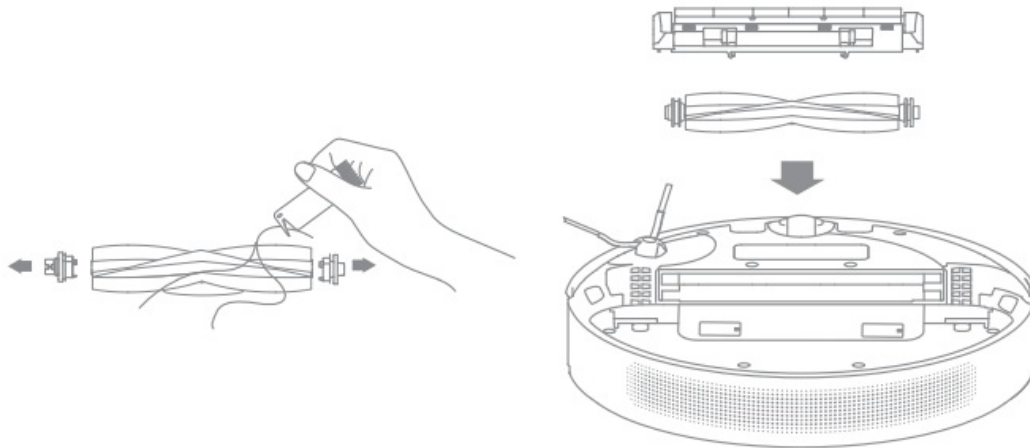

## Side Brush

Remove and clean the side brush.



## Omnidirectional Wheel

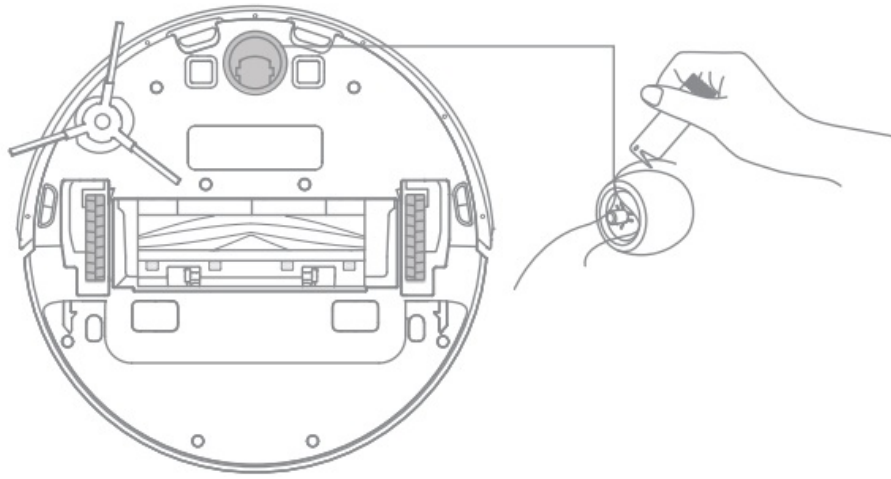

### Note:

- Use a tool such as a small screwdriver to separate the axle and tire of the omnidirectional wheel. Do not use excessive force.
- Rinse the omnidirectional wheel under running water and put it back after drying it completely.

### Dust Box

1. Open the robot's cover and press the clip to remove the dust box.

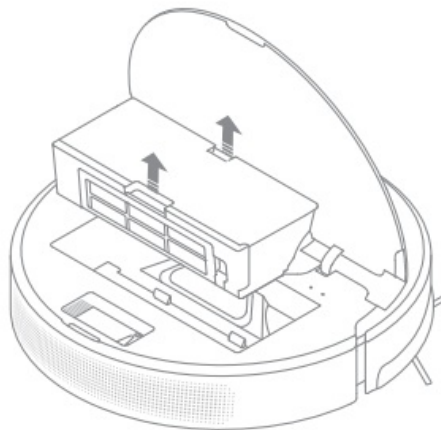

2. Open the dust box cover and empty the dust box as shown in the diagram.

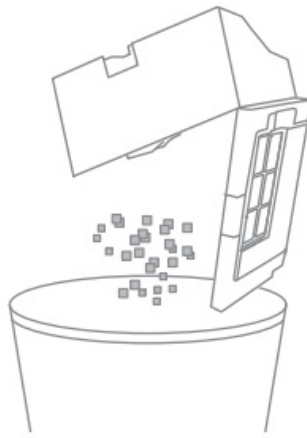

## Filter

1. Remove the filter and tap its basket gently.

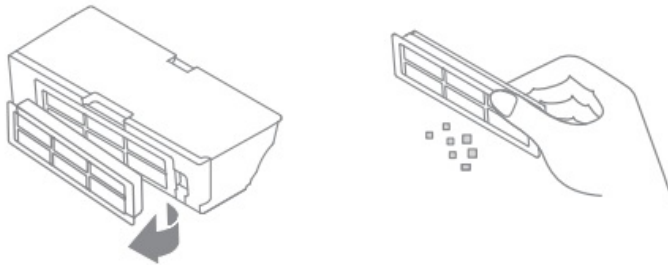

Note: Do not attempt to clean the filter with a brush, a finger or sharp objects to prevent damage.

2. Rinse the dust box and filter with clean water and dry them completely before reinstalling.

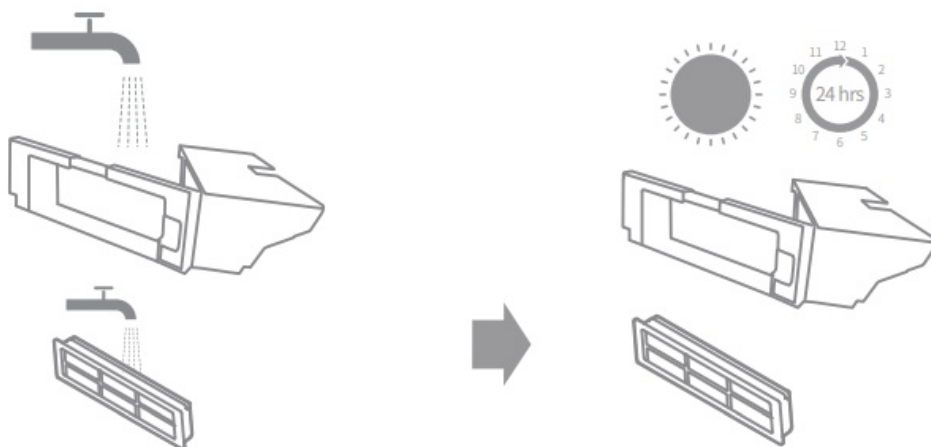

## Note:

- Rinse the dust box and filter with clean water only. Do not use any detergent.
- Use the dust box and filter only when they are completely dry.

## Dust Bag

1. Remove and discard the dust bag.

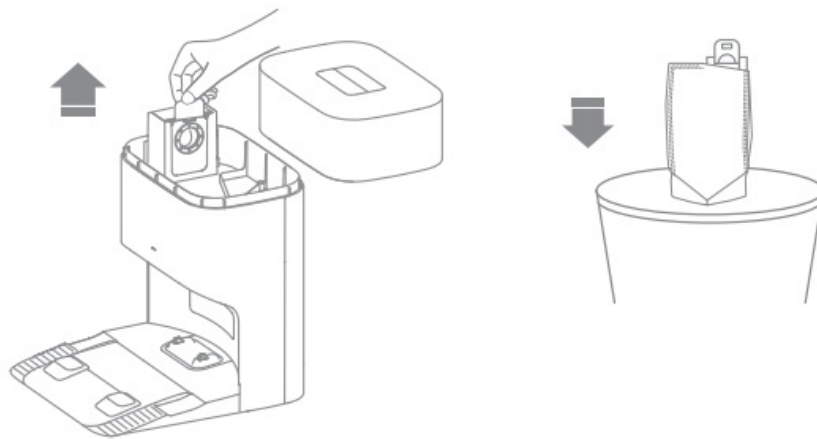

Note: Pulling outwards on the handle will seal the dust bag to prevent the dust and debris from accidentally falling out.

2. Remove the dust and debris from the filter with a dry cloth.

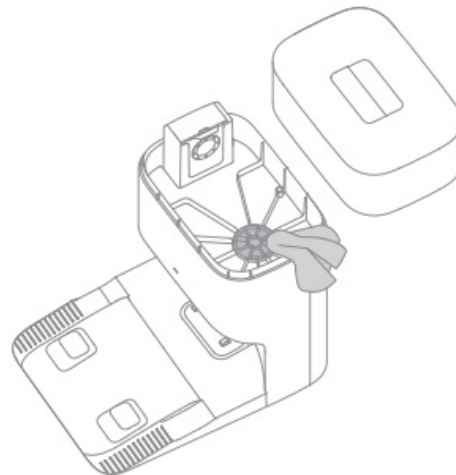

3. Install a new dust bag.

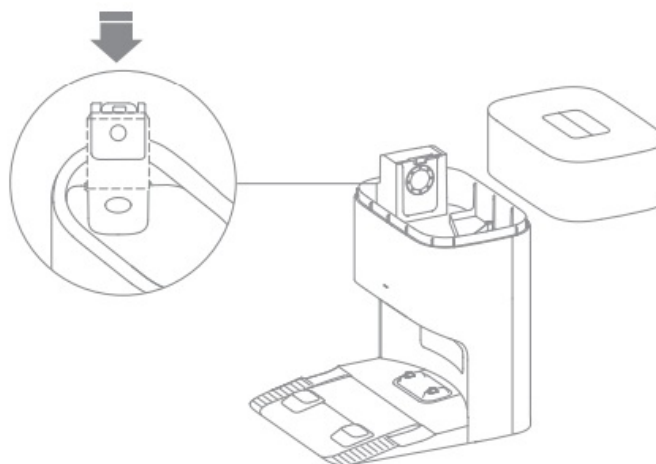

4. Put back the cover of the dust tank.

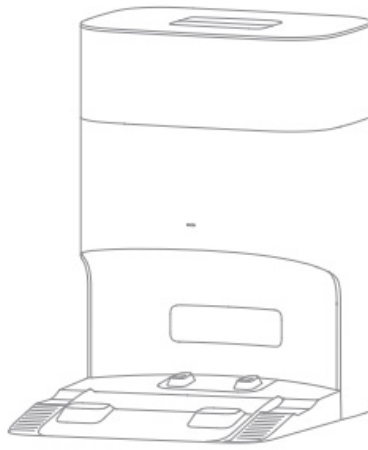

## Robot Sensors

Wipe robot sensors by using a soft and dry cloth, as shown in the figure below:

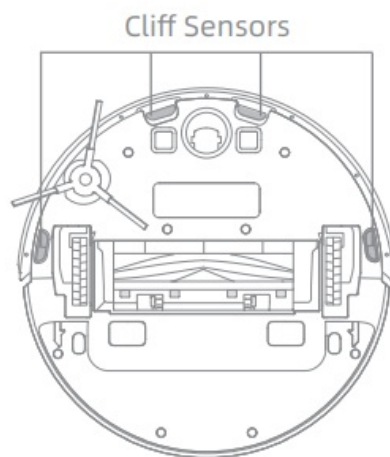
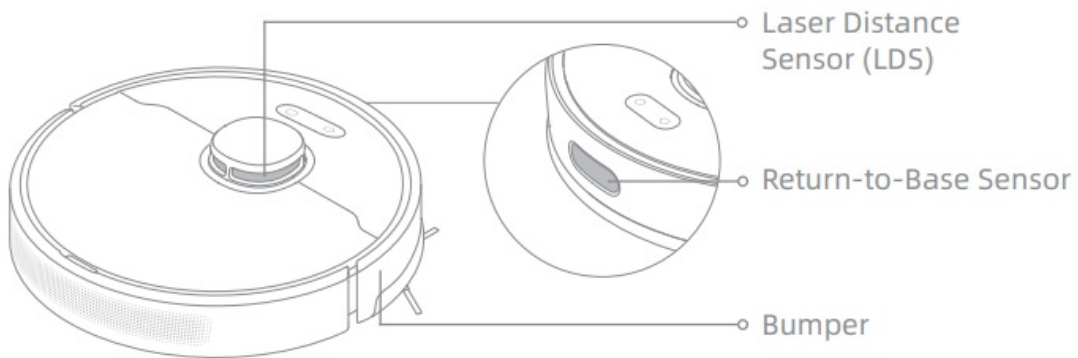

**Note:** A wet cloth can damage sensitive elements within the robot and the base station. Please use a dry cloth for cleaning.

## Charging Contacts and Signaling Area

Clean the charging contacts and the signaling area with a soft and dry cloth.

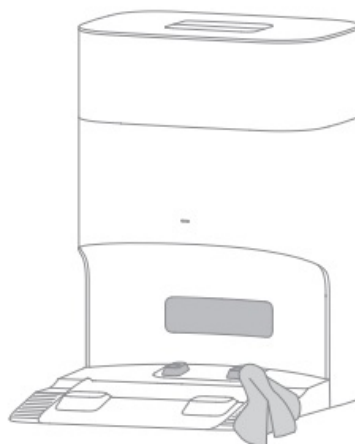
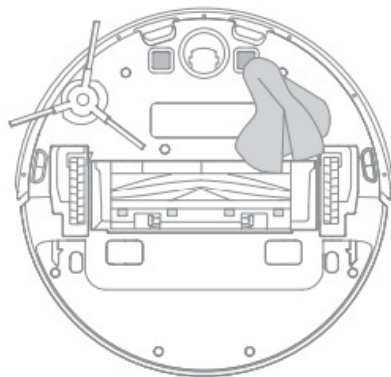

## Auto-empty Vents

Clean the auto-empty vents of the robot and the base station with a soft and dry cloth.

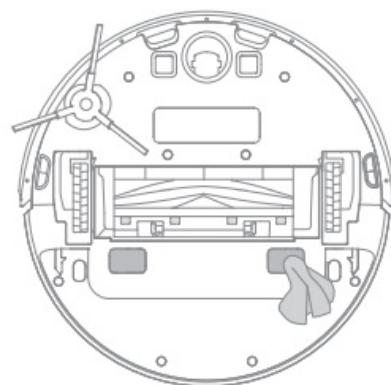

## Air Duct

If the air duct is blocked, please clean it according to the following steps.

1. Unscrew mounting screws on the air duct cover and remove the cover.

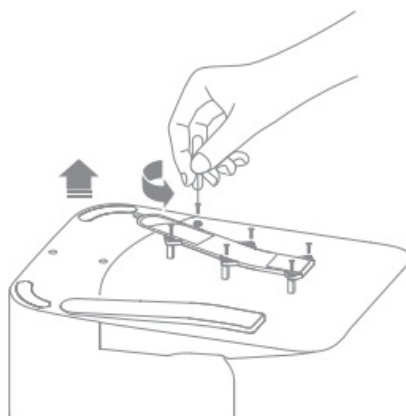

2. Check whether the air duct is blocked by foreign objects. If any, clean them.

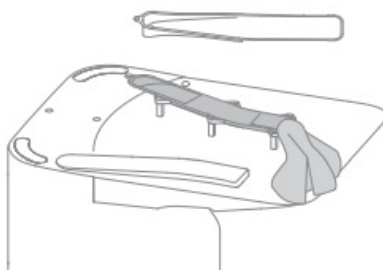

3. Reinstall the air duct cover.

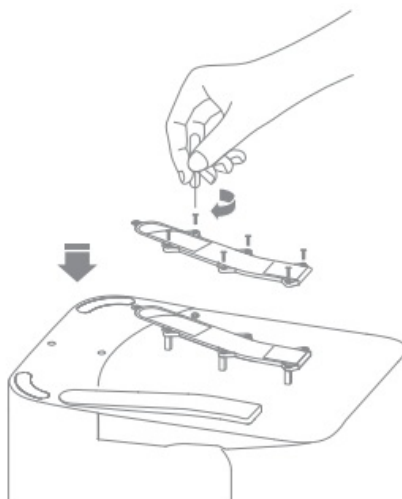

## Battery

The robot contains a high-performance lithium-ion battery pack. Make sure that the battery remains well-charged for daily use to maintain optimal battery performance. If the robot is not used for an extended period of time, turn it off and put it away. To prevent damage from over-discharging, charge the robot at least once every three months.

## Troubleshooting

Problem	Solution
The robot will not turn on.	The battery is low. Recharge the robot on the base station and try again.
	The temperature of the battery is too low or too high. It is recommended to operate the appliance at a temperature between 32°F (0 °C) and 104°F (40°C).

<p>The robot will not charge.</p>	<p>The base station is not connected to power, please make sure both ends of its power cord are correctly plugged in.</p> <p>The contact between the charging contacts on the base station and the robot is poor, please clean the charging contacts.</p>
<p>The robot fails to connect to Wi-Fi.</p>	<p>The Wi-Fi network password is incorrect. Make sure the password used to connect to your Wi-Fi network is correct. The robot does not support a 5 GHz Wi-Fi connection. Make sure the robot is connected to a 2.4 GHz Wi-Fi connection. The Wi-Fi signal is weak. Make sure the robot is in an area with good Wi-Fi coverage.</p> <p>The robot may not be ready to be configured. Please exit and re-enter the app, and then try again as instructed.</p>
<p>The robot cannot find and return to the base station.</p>	<p>The base station is disconnected from power or moved when the robot is not on it. Please connect the base station to the power supply or place the robot onto the base station to charge.</p> <p>There are too many obstructions around the base station. Place the base station in a more open area.</p> <p>Moving the robot may cause it to re-position itself, and it will recreate a map if re-positioning fails. If the robot is too far from the base station, it might not be able to automatically return on its own, in which case you will need to manually place the robot onto the base station.</p> <p>Wipe the signaling area on the base station to remove dust or debris.</p>

<p>The robot gets stuck in front of the base station and cannot return to it.</p>	<p>Clear any obstruction within 0.5 m on the left and right sides or within 1.5 m in front of the base station to prevent the robot from being blocked.</p> <p>The route for returning to charge is blocked, e.g., the door is closed.</p> <p>It is recommended to move the base station to a different place and try again.</p>
---	--

Problem	Solution
<p>The robot will not turn off.</p>	<p>The robot cannot be turned off when it is charging. It is recommended to move the robot from the base station and then press and hold the button for 3 seconds to turn it off.</p> <p>If the robot cannot be turned off by performing step 1, press and hold the button for 10 seconds to forcibly turn off the robot. If the problem persists, please contact after-sales service.</p>
<p>The charging speed is slow.</p>	<p>It takes about 6 hours to fully charge the robot when its battery is low.</p> <p>If you operate the robot at temperatures outside of the specified range, the charging speed will automatically slow down to extend the battery life.</p> <p>The charging contacts on both the robot and the base station may be dirty, please wipe them with a dry cloth.</p>

<p>The noise increases while the robot is operating.</p>	<p>Check whether the dust box's filter is clogged. If so, clean it or replace it.</p> <p>A hard object may be caught in the main brush or the dust box. Check and remove any hard object. The main brush or the side brush may become tangled. Check and remove any foreign objects.</p> <p>Switch the suction mode to Standard or Quiet.</p>
<p>The robot moves without following the set route.</p>	<p>Objects such as power cords and slippers should be organized before using the robot.</p> <p>Working on wet slippery surfaces may cause the main wheel to slip. It is recommended to dry any wet areas before using the robot.</p>
<p>The robot misses the rooms to be cleaned.</p>	<p>Make sure that the doors of the rooms to be cleaned are open.</p> <p>Check whether there is a threshold higher than 2 cm at the door of the room. The robot cannot climb over high thresholds or steps.</p> <p>The place in front of the room to be cleaned may be wet and slippery, causing the robot to slip and work abnormally. Please try drying the floor before using the robot.</p>

Problem	Solution
---------	----------

The robot will not resume cleaning after charging.	<p>Make sure that the robot is not set to the Do Not Disturb (DND) mode, which will prevent it from resuming cleaning.</p> <p>The robot will not resume cleaning after you manually return the robot to the base station to charge, which includes manually placing the robot on the base station or sending the robot to charge via the app, or the robot itself.</p>
The base station cannot automatically empty the dust box.	<p>Check whether the dust bag in the dust tank is full.</p> <p>If the dust bag is not full, check whether there is any obstruction at the auto-empty vents of the robot, the base station, or the dust box. If any, clean the blocked part in time.</p>
No water comes out of the water tank, or only a little bit comes out.	<p>Check whether there is water inside the water tank. Clean the air hole on the water tank stopper.</p> <p>Clean the mop pad if it becomes dirty.</p> <p>Make sure the mop pad is installed correctly according to the user manual.</p>
The robot returns to the base station without performing auto-empty tasks.	<p>DND mode prevents the robot from performing auto-empty tasks.</p>

For more support, contact us via <https://global.dreametech.com>.

## Specifications

### Robot

Model	RLD32GD
Charging Time	Approx. 6 hours
Rated Voltage	14.4 V 
Rated Power	75 W
Operation Frequency	2400-2483.5 MHz
Maximum Output Power	< 20 dBm

#### Base Station with Auto-Empty

Model	RCDD0202
Rated Input	220-240 V 50-60 Hz
Rated Output	20 V  1 A
Rated Power (during dust emptying)	650 W

Under normal use of condition, this equipment should be kept a separation distance of at

least 20 cm between the antenna and the body of the user.

## **Battery Disposal and Removal**

The built-in lithium-ion battery contains substances that are hazardous to the environment. Before disposing of the battery, make sure the battery is removed by qualified technicians and discarded at an appropriate recycling facility.

- The battery must be removed from the appliance before it is scrapped.
- The appliance must be disconnected from the supply mains when removing the battery.
- The battery is to be disposed of safely.

## **CAUTION:**

- Before removing the battery, disconnect the power and run the battery as much as possible.
- Unneeded batteries should be discarded at an appropriate recycling facility.
- Do not expose to high-temperature environments to avoid the risk of explosion.
- Under abusive conditions, liquid may be ejected from the battery. If contact occurs, flush with water and seek medical help.

## **Removal Guide:**

1. Turn over the robot, use a proper tool to remove the screws on the back of the robot, and then remove the cover.
2. Unplug the terminals between the battery and PCB board to remove the battery.

## **WEEE Information**

All products bearing this symbol are waste electrical and electronic equipment (WEEE as in Directive 2012/19/EU), which should not be mixed with unsorted household waste. Instead, you should protect human health and the environment by handing over your waste equipment to a designated collection point for the recycling of waste electrical and electronic equipment, appointed by the government or local authorities. Correct disposal and recycling will help prevent potential negative consequences to the environment and

human health. Please contact the installer or local authorities for more information about the location, as well as the terms and conditions of such collection points.



## FAQ

- **Q:** How often should I recharge the robot vacuum?
- **A:** It is recommended to recharge the robot vacuum at least once every 3 months to prevent over-discharging of the battery.
- **Q:** Can I use the robot vacuum outdoors?
- **A:** No, the robot vacuum is designed for indoor use only. Please do not use it outdoors.

## Documents / Resources

	<a href="#">DREAME D10 PLUS GEN2 Auto Empty Robot Vacuum and Mop [pdf]</a> User Manual D10 PLUS GEN2 Auto-Empty Robot Vacuum and Mop, D10 PLUS GEN2, Auto-Empty Robot Vacuum and Mop, Robot Vacuum and Mop, Vacuum and Mop
---	---

## References

-  [Dreame Global | Smart Robot Vacuum Cleaners](#)
- [User Manual](#)

dreame

Auto-Empty Robot Vacuum and Mop, D10 PLUS GEN2, D10 PLUS GEN2 Auto-Empty Robot Vacuum and Mop, dreame, Robot Vacuum and Mop, Vacuum and Mop

—Previous Post

[DREAME X40 Ultra Robot Vacuum Cleaner User Manual](#)

---

## Leave a comment

Your email address will not be published. Required fields are marked \*

Comment \*

Name

Email

Website

☐ Save my name, email, and website in this browser for the next time I comment.

**Post Comment**

**Search:**

e.g. whirlpool wrf535swhz

**Search**

[Manuals+](#) | [Upload](#) | [Deep Search](#) | [Privacy Policy](#) | [@manuals.plus](#) | [YouTube](#)

This website is an independent publication and is neither affiliated with nor endorsed by any of the trademark owners. The "Bluetooth®" word mark and logos are registered trademarks owned by Bluetooth SIG, Inc. The "Wi-Fi®" word mark and logos are registered trademarks owned by the Wi-Fi Alliance. Any use of these marks on this website does not imply any affiliation with or endorsement.