



## Contents [ [hide](#) ]

- [1 DREAME D10 Plus Gen 2 Auto Empty Robot Vacuum and Mop](#)
- [2 Safety Information](#)
- [3 FCC Caution](#)
- [4 Product Overview](#)
- [5 Preparing Your Home](#)
- [6 Before Use](#)
- [7 Connecting with Dreamehome App](#)
- [8 How to Use](#)
- [9 Routine Maintenance](#)
- [10 Troubleshooting](#)
- [11 Specifications](#)
- [12 Documents / Resources](#)
  - [12.1 References](#)

# DREAME

## DREAME D10 Plus Gen 2 Auto Empty Robot Vacuum and Mop



The illustrations in this manual are for reference only. Please refer to the actual product.

## **Safety Information**

### **IMPORTANT SAFETY INSTRUCTIONS**

When using an electrical appliance, basic precautions should always be followed, including the following:

READ ALL INSTRUCTIONS BEFORE USING (THIS APPLIANCE), Failure to follow the warnings and instructions may result in electric shock, fire and/or serious injury.

### **SAVE THESE INSTRUCTIONS**

Household use only.

**WARNING**— To reduce the risk of fire, electric shock, or injury:

- Do not use outdoors or on wet surfaces.
- Do not allow to be used as a toy. Close attention is necessary when used by or near children, pets or plants.
- Use only as described in this manual. Use only manufacturer's recommended attachments.
- Do not use with damaged cord or plug. If appliance is not working as it should, has been dropped, damaged, left outdoors, or dropped into water, return it to a service center.
- Do not pull or carry by cord, use cord as a handle, close a door on cord, or pull cord around sharp edges or corners. Do not run appliance over cord. Keep cord away from

heated surfaces.

- Do not unplug by pulling on cord. To unplug, grasp the plug, not the cord.
- Do not handle the base station with auto-empty, including charger plug, and charger terminals with wet hands.
- Do not put any object into openings. Do not use with any opening blocked; keep free of dust, lint, hair, and anything that may reduce air flow.
- Keep hair, loose clothing, fingers, and all parts of body away from openings and moving parts.
- Turn off all controls before unplugging.
- Do not use to pick up flammable or combustible liquids, such as gasoline, or use in areas where they may be present.
- Connect to a properly grounded outlet only. See Grounding Instructions.
- Do not pick up anything that is burning or smoking, such as cigarettes, matches, or hot ashes.
- Do not use without dust bag.
- Prevent unintentional starting. Ensure the switch is in the off-position before connecting to battery pack, picking up or carrying the appliance. Carrying the appliance with your finger on the switch or energizing the appliance that has the switch on invites accidents.
- Do not use and store in extremely hot or cold environments (below 0°C/ 32 °F or above 40°C/104 °F). Please charge the robot in temperature above 0°C/ 32 °F and below 40°C/104 °F.
- Recharge only with the charger specified by the manufacturer. A charger that is suitable for one type of battery pack may create a risk of fire when used with another battery pack.
- Use appliances only with specifically designated battery packs. Use of any other battery packs may create a risk of injury and fire.
- When battery pack is not in use, keep it away from other metal objects, like paper clips, coins, keys, nails, screws or other small metal objects, that can make a connection from one terminal to another. Shorting the battery terminals together may cause burns or a fire.
- Under abusive conditions, liquid may be ejected from the battery; avoid contact. If contact accidentally occurs, flush with water. If liquid contacts eyes, additionally seek medical help. Liquid ejected from the battery may cause irritation or burns.

- Do not use a battery pack or appliance that is damaged or modified. Damaged or modified batteries may exhibit unpredictable behavior resulting in fire, explosion or risk of injury.
- Do not expose a battery pack or appliance to fire or excessive temperature. Exposure to fire or temperature above 130°C/266 °F may cause explosion.
- Follow all charging instructions and do not charge the battery pack or appliance outside of the temperature range specified in the instructions. Charging improperly or at temperatures outside of the specified range may damage the battery and increase the risk of fire.
- Have servicing performed by a qualified repair person using only identical replacement parts. This will ensure that the safety of the product is maintained.
- Do not modify or attempt to repair the appliance or the battery pack except as indicated in the instructions for use and care.
- Place the cords from other appliances out of the area to be cleaned.
- Do not operate the vacuum in a room where an infant or child is sleeping.
- Do not operate the vacuum in an area where there are lit candles or fragile objects on the floor to be cleaned.
- Do not operate the vacuum in a room that has lit candles on furniture that the vacuum may accidentally hit or bump into.
- Do not allow children to sit on the vacuum.
- Do not use the vacuum on a wet surface.
- Use only with RCDD0202 supply unit.
- Risk Of Injury. Brush May Start Unexpectedly. Switch off the appliance and Remove the brush Before Cleaning or Servicing.
- Unplug before cleaning or servicing.

## **FCC Caution**

### **Caution:**

This device complies with Part 15 of the FCC Rules / Innovation, Science and Economic Development Canada's licence-exempt RSS(s). Operation is subject to the following two conditions:

1. This device may not cause harmful interference.
2. This device must accept any interference received, including interference that may

cause undesired operation.

Changes or modifications not expressly approved by the party responsible for compliance could void the user's authority to operate the equipment.



This equipment has been tested and found to comply with the limits for a Class B digital device, pursuant to part 15 of the FCC Rules. These limits are designed to provide reasonable protection against harmful interference in a residential installation. This equipment generates uses and can radiate radio frequency energy and, if not installed and used in accordance with the instructions, may cause harmful interference to radio communications. However, there is no guarantee that interference will not occur in a particular installation. If this equipment does cause harmful interference to radio or television reception, which can be determined by turning the equipment off and on, the user is encouraged to try to correct the interference by one or more of the following measures:

- Reorient or relocate the receiving antenna.
- Increase the separation between the equipment and receiver.
- Connect the equipment into an outlet on a circuit different from that to which the receiver is connected.
- Consult the dealer or an experienced radio/TV technician for help.

## **MPE Reminding**

To satisfy FCC / IC RF exposure requirements, a separation distance of 8" (20 cm) or more should be maintained between the antenna of this device and persons during device operation. To ensure compliance, operations at closer than this distance is not recommended.V To disable Wi-Fi module on robot, power the robot ON. Place the robot on the base station with auto-empty. Ensure the Charging

- Contacts on robot and the base station with auto-empty Pins make a connection.
- Press and hold the Dock Button on the robot for 20 seconds until the Wi-Fi module is turned off.
- When the Wi-Fi module is turned off, press any button on the robot to turn the Wi-Fi module on.

	Direct current
	Alternating current

This Device Complies with DHHS Radiation Rules, 21CFR Chapter 1, Subchapter

- J. I: ON
- O: OFF

## GROUNDING INSTRUCTIONS

This appliance must be grounded. If it should malfunction or breakdown, grounding provides a path of least resistance for electric current to reduce the risk of electric shock. This appliance is equipped with a cord having an equipment grounding conductor and grounding plug. The plug must be inserted into an appropriate outlet that is properly installed and grounded in accordance with all local codes and ordinances.

**WARNING** – Improper connection of the equipment-grounding conductor can result in a risk of electric shock. Check with a qualified electrician or service person if you are in doubt as to whether the outlet is properly grounded. Do not modify the plug provided with the appliance – if it will not fit the outlet, have a proper outlet installed by a qualified electrician.

This appliance is for use on a nominal 120-V circuit and has a grounding attachment plug that looks like the plug illustrated as below. Make sure that the appliance is connected to an outlet having the same configuration as the plug. No adaptor should be used with this appliance.

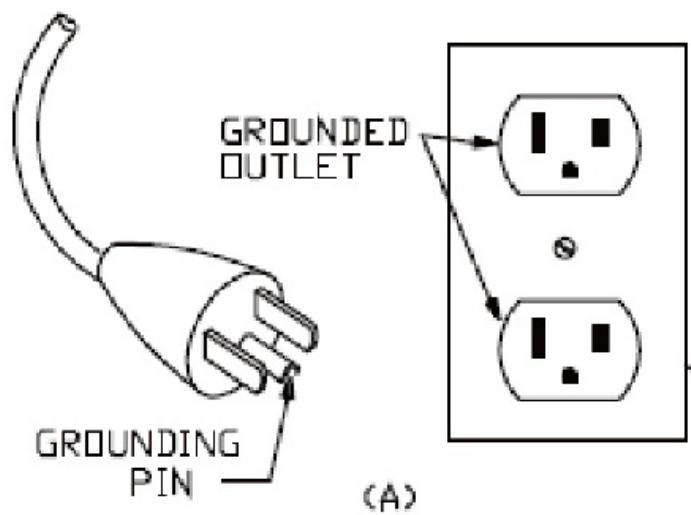

## Product Overview

## Package Contents

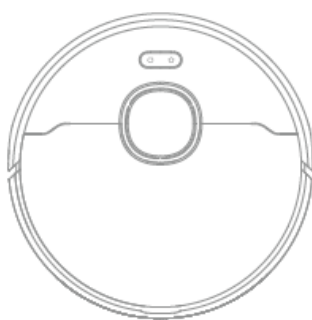

Robot



Base Station with  
Auto-Empty

## Other Accessories



Side Brush



Dust Bag ×2  
(pre-installed ×1)



Cleaning Tool  
(pre-installed)

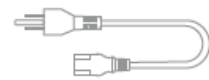

Power Cord

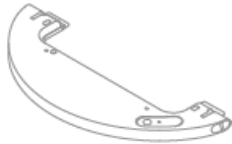

Water Tank



Mop Pad  
(pre-Installed)



User Manual

## Robot

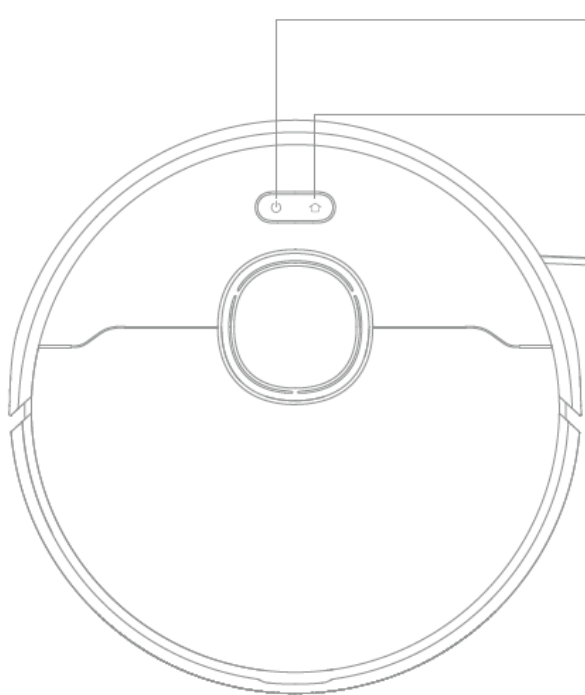

- **Power/Clean Button**
  - Press and hold for 3 seconds to turn on or off
  - Press to start cleaning after the robot is turned on

- **Dock/Spot Cleaning Button**
  - Press to send the robot back to the base station
  - Press and hold for 3 seconds to start spot cleaning

### Status Indicator

- **Solid White:** Cleaning or cleanup completed
- **Blinking Orange:** Error
- **Breathing White:** Robot is charging when the battery power is not low

### Note:

- Press any button on the robot to pause while the robot is cleaning or returning to charge.
- Child Lock can be enabled/disabled through the Dreamehome app.

## Robot and Sensors

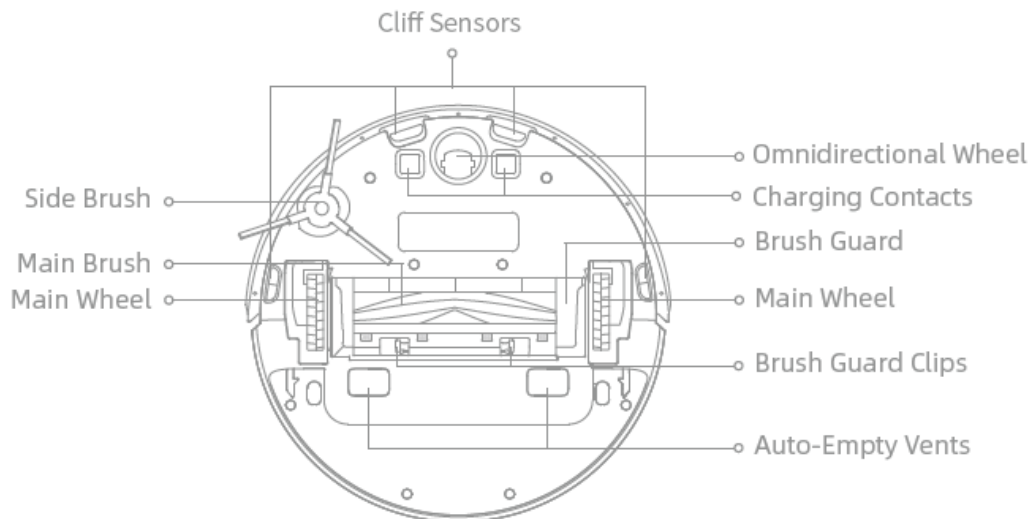
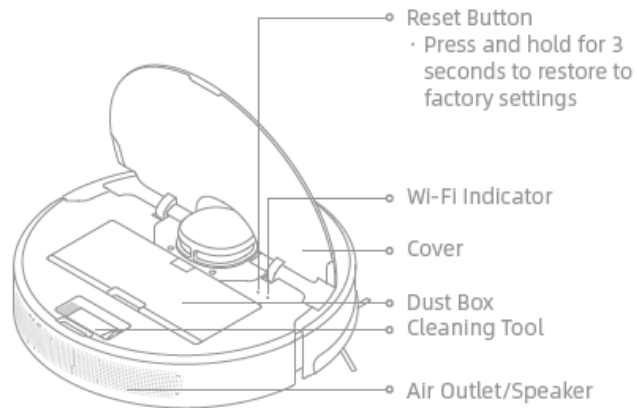
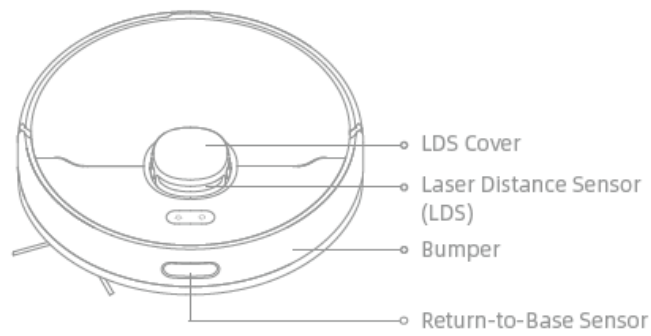

## Dust Box

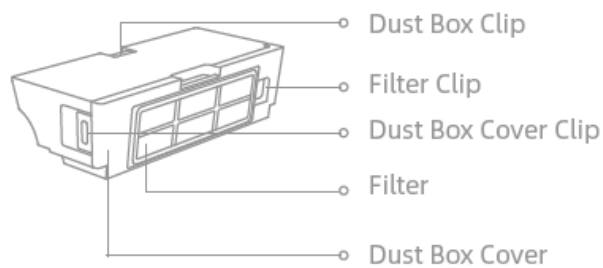

## Mopping Module

## Water Tank

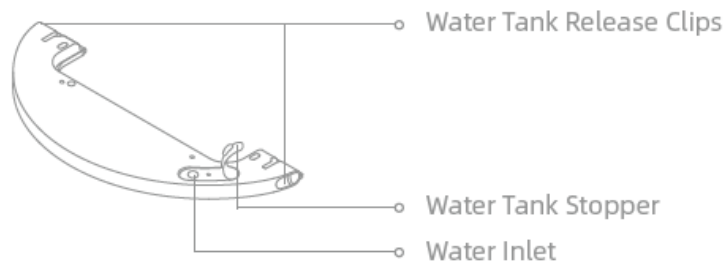

## Mop Pad



## Base Station with Auto-Empty

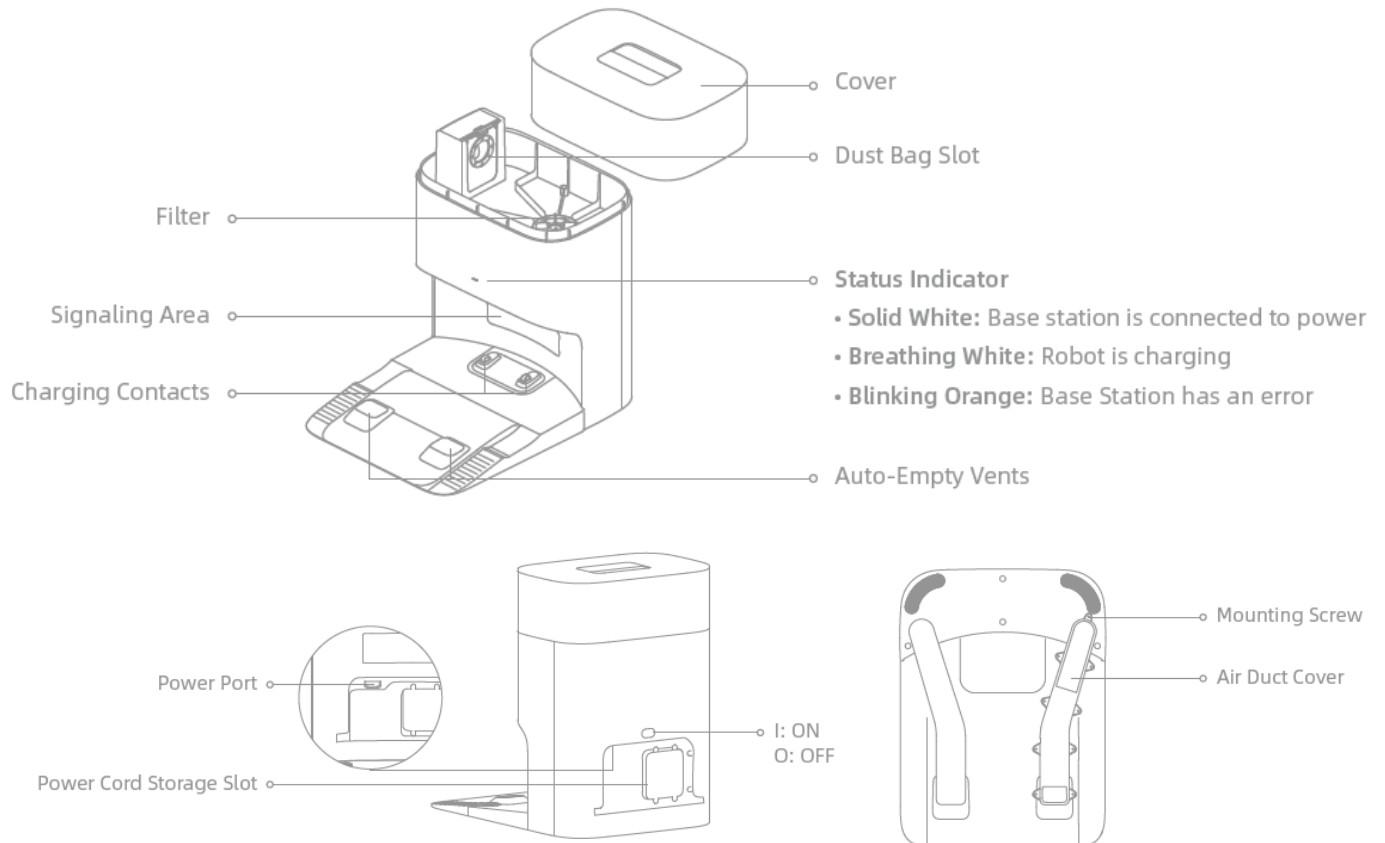

## Preparing Your Home

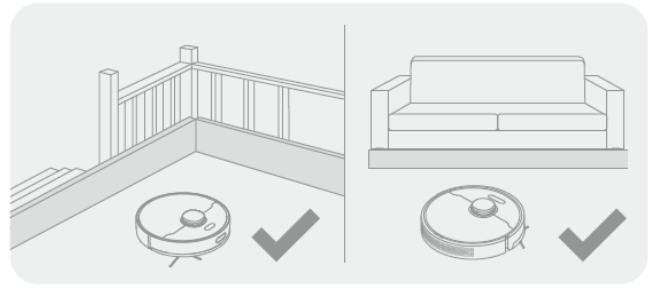

- Before cleaning, please move away unstable, fragile, valuable or dangerous items, and clean up cables, cloths, toys, hard objects and sharp objects on the ground to avoid being entangled, scratched or knocked over by the robot and causing losses.
- Before cleaning, place a physical barrier at the edge of the stairs and sofa to ensure the secure and smooth operations of the robot.

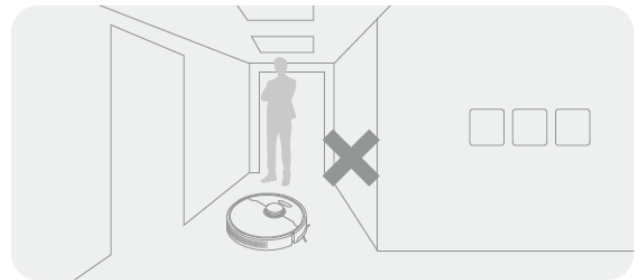
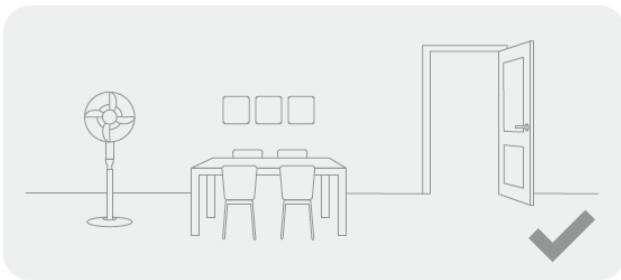

- Open the door of the room to be cleaned, and put the furniture in its proper place to leave more space.
- To prevent the robot from not recognizing areas that need to be cleaned, do not stand in front of the robot, or in a threshold, hallway, or narrow places.
- When operating the robot for the first time, follow it around while cleaning to remove any potential obstacles in time.
- Do not vacuum hard objects like stones, steel balls and toy parts, or sharp objects like construction waste, broken glass and nails, otherwise the ground may be scratched.

## Before Use

### 1. Place the Base Station and Connect to an Electrical Outlet

Place the base station on level ground against the wall. Insert the power cord into the base station and plug it into the socket.



Place the base station in a location that is as open as possible with a good Wi-Fi signal.

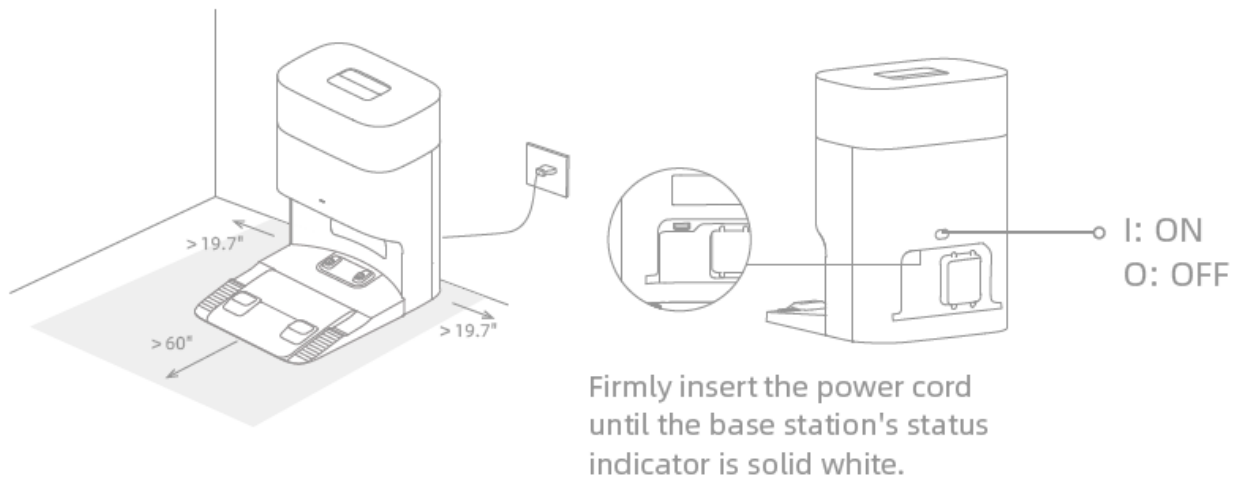

**Note:**

- Make sure that no objects might block the signaling area.
- Remove any objects that are closer than 60" (1.5 m) from the front and 19.7" (0.5 m) from either side of the base station.

2. Remove the Protections

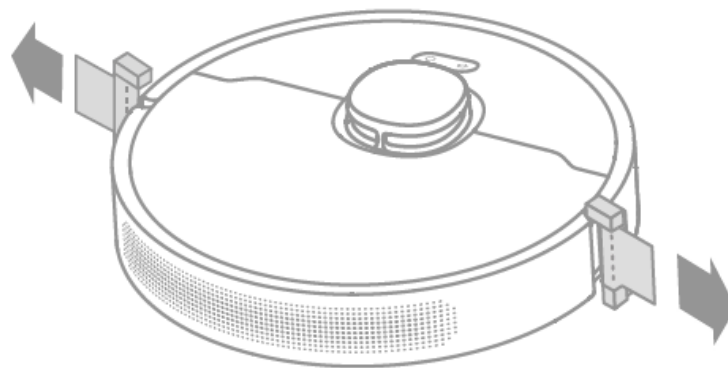

3. Install the Side Brush

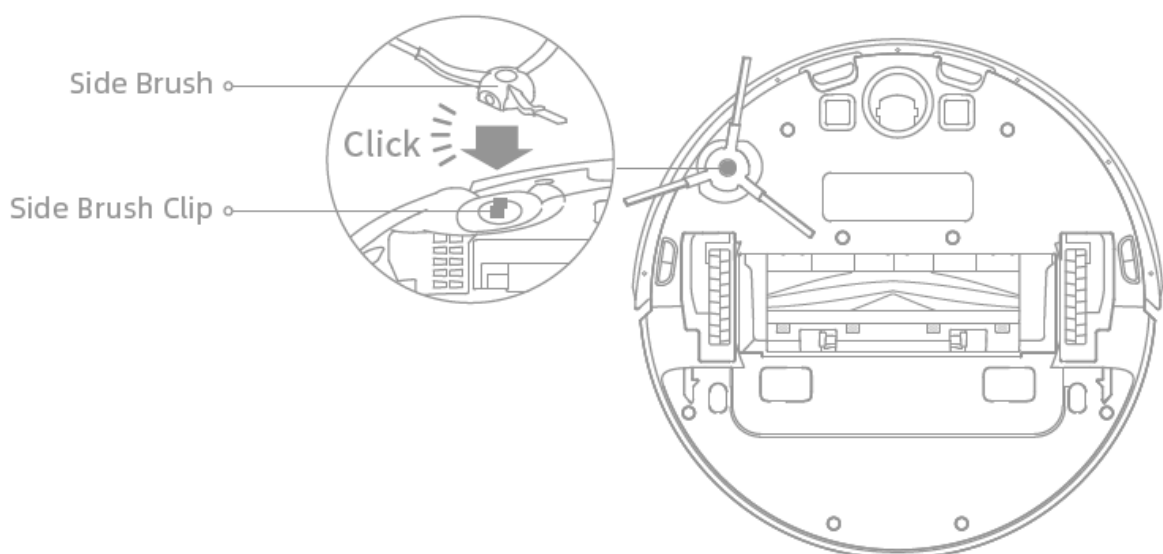

**Note:** Install the side brush until it clicks into place.

4. Charge the Robot

When placing the robot, align the charging contacts at the bottom of the robot with the

charging contacts of the base station, and the robot will automatically turn on and start charging.

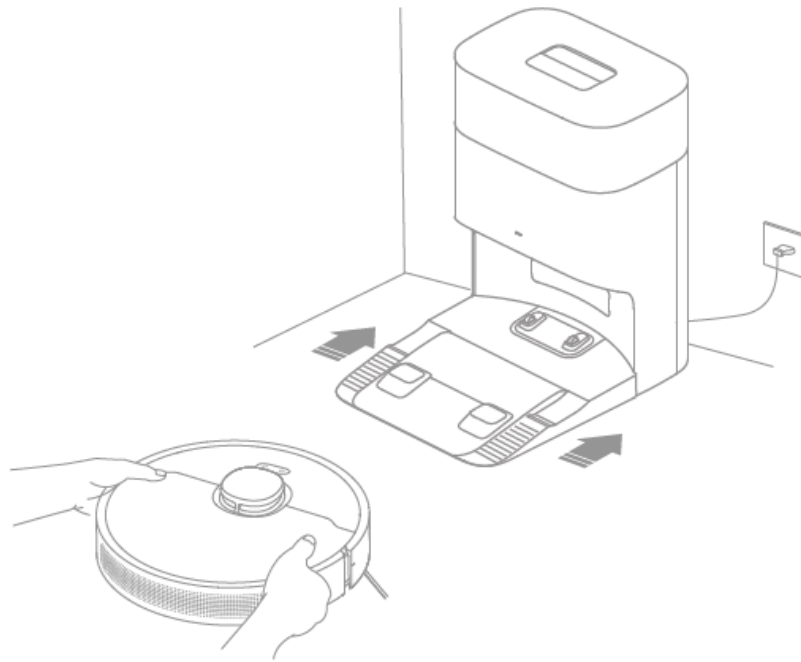

**Note:** It is recommended to fully charge your robot before first time use.

## Connecting with Dreamehome App

### 1. Download Dreamehome App

Scan the QR code on the robot, or search “Dreamehome” in the app store to download and install the app.

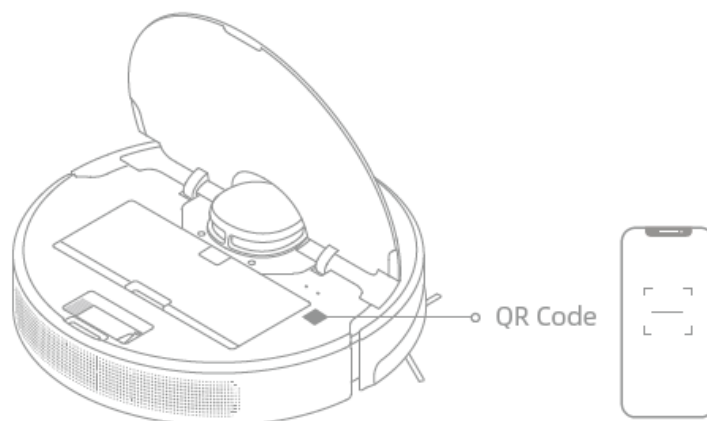

### **Note:**

- Only 2.4GHz Wi-Fi is supported.
- Due to upgrades in the app software, the actual operations may differ from the directions in this manual. Please follow the instructions based on the current app version.

## 2. . Add Device

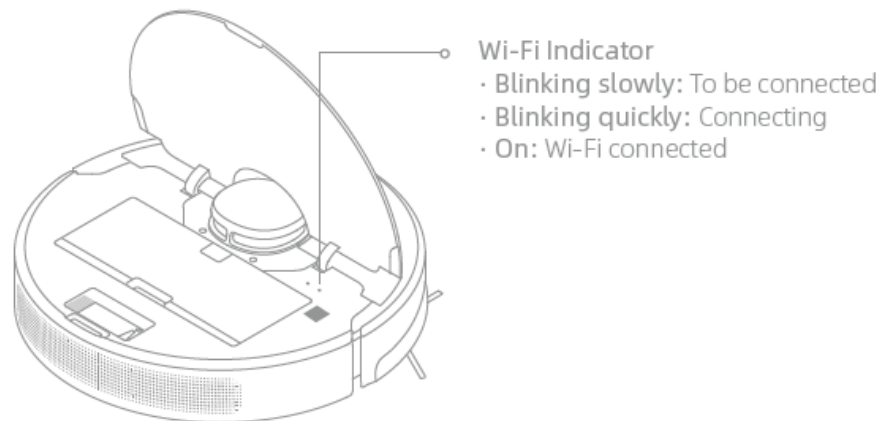

Open the Dreame home app, tap + in the upper right corner, and scan the same QR code on the robot again to add the device. Please follow the prompts to finish the Wi-Fi connection.

**Note:** If you want to reset Wi-Fi, repeat step 2 and then follow the prompts to finish the Wi-Fi connection.



## How to Use

### • Turn On/Off

Press and hold the button  for 3 seconds to turn on the robot. The power indicator should be illuminated. Place the robot onto the base station, the robot should turn on automatically and begin charging. To turn off the robot, move the robot away from the base station and press and hold the button  for 3 seconds.

### • Fast Mapping

After configuring the network for the first time, follow the instructions in the app to quickly create a map. The robot will start mapping without cleaning. When the robot returns to the base station, the mapping process has been completed and the map will be saved automatically.

### • Start Cleaning

Press the button  to start cleaning after the robot is turned on. The robot will accurately map out a route, methodically clean along the edges and walls, then finish by cleaning each room in an S-shaped pattern to ensure a thorough job.

**Note:**

- It is recommended that the robot set out from the base station before cleaning. Do not move the base station while the robot is cleaning. This ensures that the robot returns to base station smoothly.
- After the robot completes the cleaning task and automatically returns to the base station, the base station will start auto-empty. More settings can be operated on the app.

## **Pause/Sleep**

When the robot is running, press any button to pause it. If the robot is paused for more than 10 minutes, it automatically enters sleep mode. All indicators on the robot will turn off. Press any button on the robot or base station, or use the app to wake up the robot.

**Note:** If the robot is paused and placed onto the base station, the current cleaning process will end.

- **Auto Resume Cleaning**

If the battery is too low, the robot will automatically return to the base station to charge. After charging to the appropriate battery level, it will resume unfinished cleaning tasks.

Note: To use this function, please open it in the App.

- **Do Not Disturb (DND) Mode**

When the robot is set to Do Not Disturb (DND) mode, the robot will be prevented from resuming cleaning and the power indicator will turn off. DND mode is disabled by default at the factory. You can use the app to enable DND mode or modify the DND period. The DND period is 22:00–8:00 by default.

**Note:**

- The scheduled cleaning tasks will be performed as usual during the DND period.
- The robot will resume cleanup where it left off after the DND period expires.

## **Spot Cleaning**

When the robot is on standby, press and hold the button for 3 seconds to enable the spot cleaning mode. In this mode, the robot cleans a square-shaped area of  $1.5 \times 1.5$  meters around it and returns to its starting point once the spot cleaning is completed.

## Robot Restarting

If the robot stops responding or cannot be turned off, press and hold the button for 10 seconds to forcefully turn it off. Then, press and hold the button for 3 seconds to turn the robot on.

## Use Mopping Function

It is recommended that all floors are vacuumed at least three times before the first mopping session to achieve a better cleaning effect.

1. Dampen the mop pad and wring out excess water. Install the mop pad as shown in the diagram.

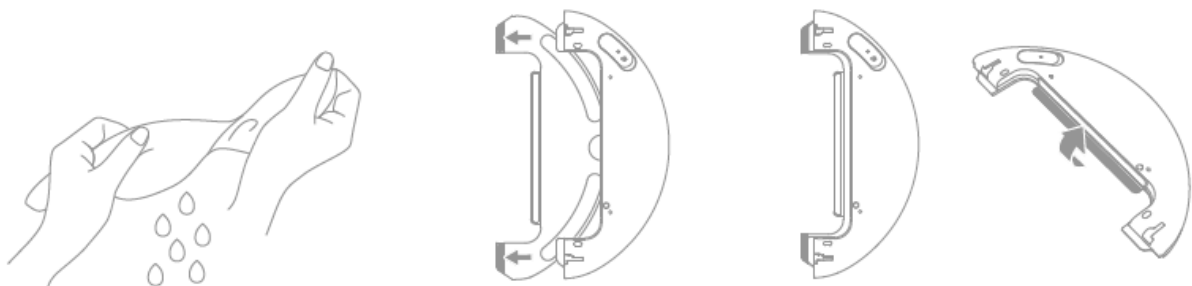

2. Fill up the tank with water.

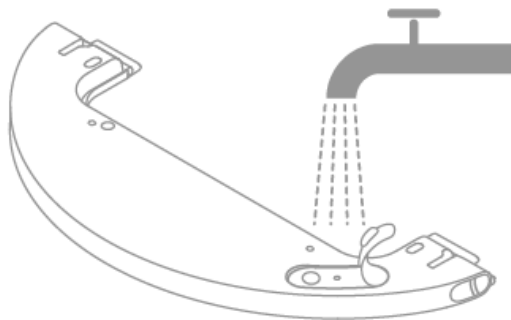

### Note:

- Do not use detergent or disinfectant.
  - Do not fill the water tank with hot water as this may cause the water tank to warp.
3. Align the mopping module as indicated by the arrow, then slide it into the back of the robot until it clicks into place. Press the button  or use the Dreame home app to start cleaning.

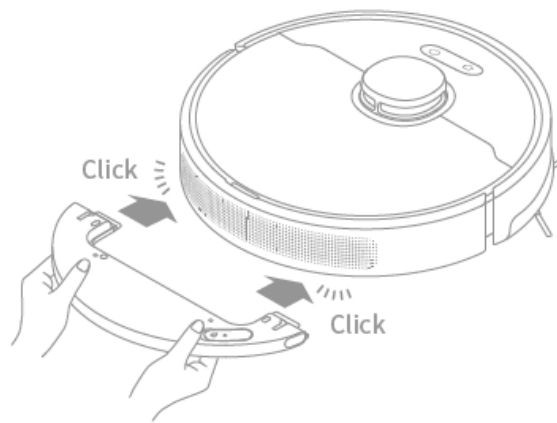

- It is not recommended to use the mopping function on carpets.
- Use the app to adjust the water flow as required.

4. When the robot finishes a cleaning task and returns to the base station, remove the mopping module and wash the mop pad in time. To remove the water tank, slide the two release clips on the side of it to take it out.

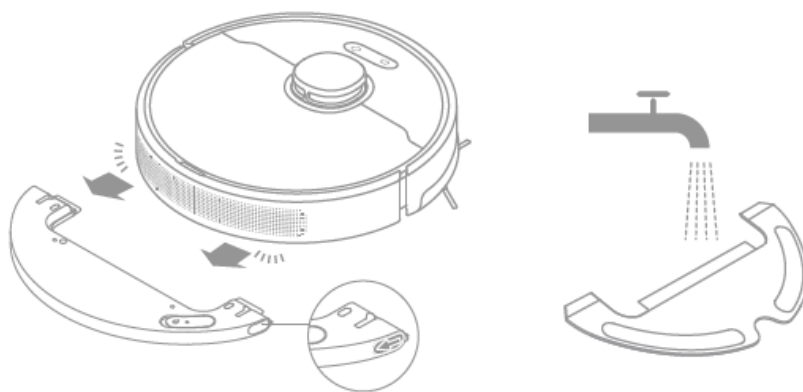

**Note:** When the robot is charging or not in use, remove the mopping module, pour out all the remaining water in the water tank, and clean the mop pad to prevent mildew or odors.

## Routine Maintenance

To keep the robot in good condition, it is recommended to refer to the accessory usage in the app or the following table for routine maintenance.

Part	Maintenance Frequency	Replacement Period
Mop pad	After each use	Every 3 to 6 months
Main Brush		Every 6 to 12 months

Side Brush	Once every 2 weeks	Every 3 to 6 months
Dust box's filter		
Base station's signaling area	Once every month	/
Base station's charging contacts		
Base station's auto-empty vents		
Laser Distance Sensor (LDS)		
Robot's charging contacts		

Part	Maintenance Frequency	Replacement Period
Mop pad	After each use	Every 3 to 6 months
Main Brush	Once every 2 weeks	Every 6 to 12 months
Side Brush		Every 3 to 6 months
Dust box's filter		
Base station's signaling area	Once every month	/
Base station's charging contacts		
Base station's auto-empty vents		
Laser Distance Sensor (LDS)		
Robot's charging contacts		

Note: The replacement frequency will depend on your usage of the robot. If an exception

occurs due to special circumstances, the parts should be replaced.

## Mopping Module

1. Slide the two release clips on the side of the water tank, remove the mopping module, and pull the mop pad off the mopping module.

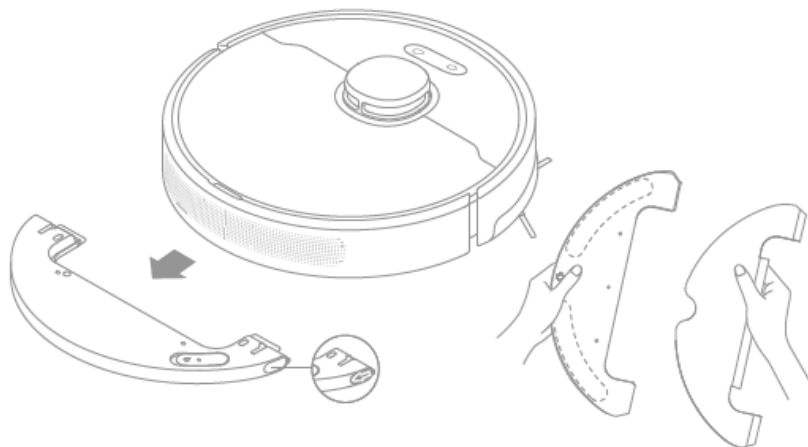

2. Pour out the water in the tank. Clean the tank with water only and leave it to air dry before reinstalling.

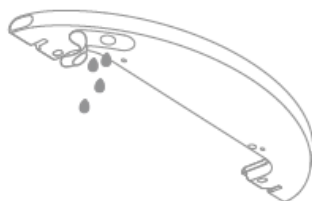

Note: Do not directly expose the water tank to sunlight.

3. Clean the mop pad with water only and leave it to air dry before reinstalling.

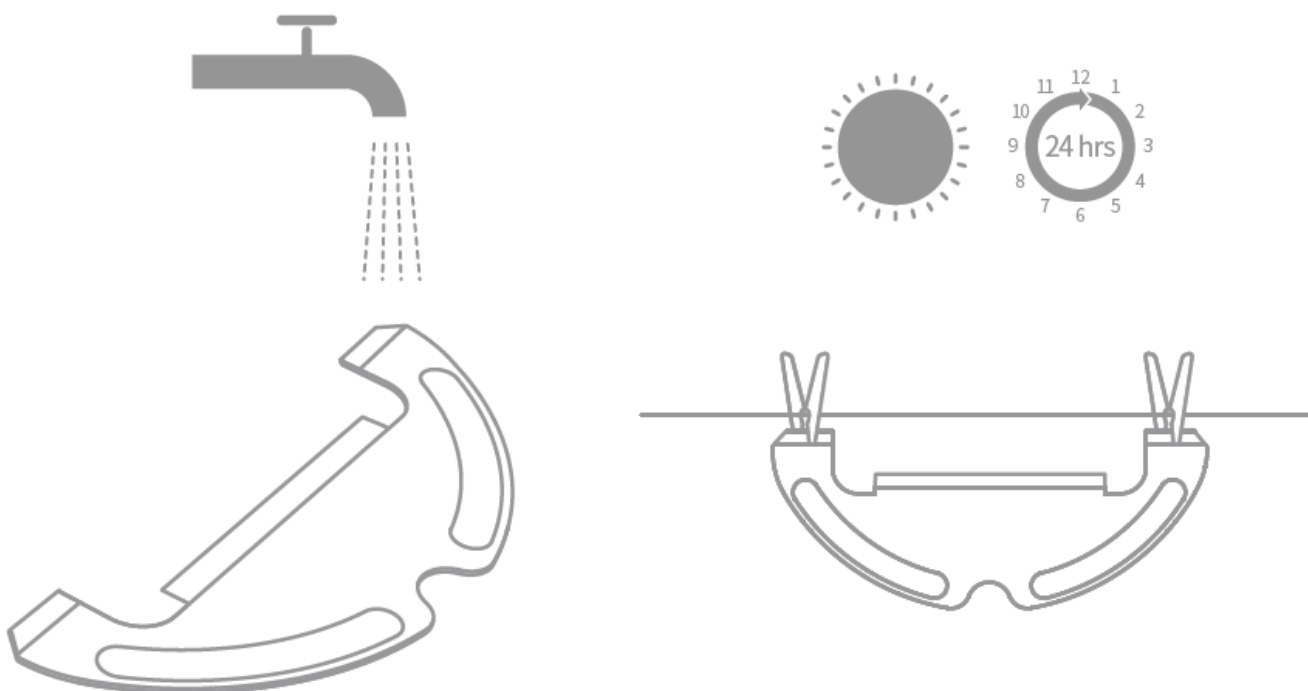

**Note:** Remove the mop pad from the mopping module before cleaning it, and make

sure dirty water does not flow back into the water outlet to avoid clogging.

4. If slow water flow occurs, or the water volume is not well-distributed, clean the air hole in the cover of the water tank.

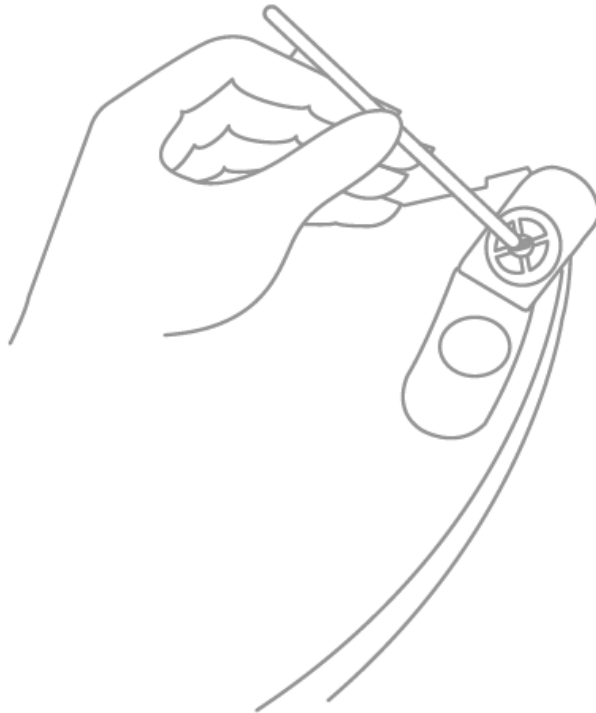

## Main Brush

1. Press the brush guard clips inwards to remove the brush guard and lift the brush out of the robot.
- 2.

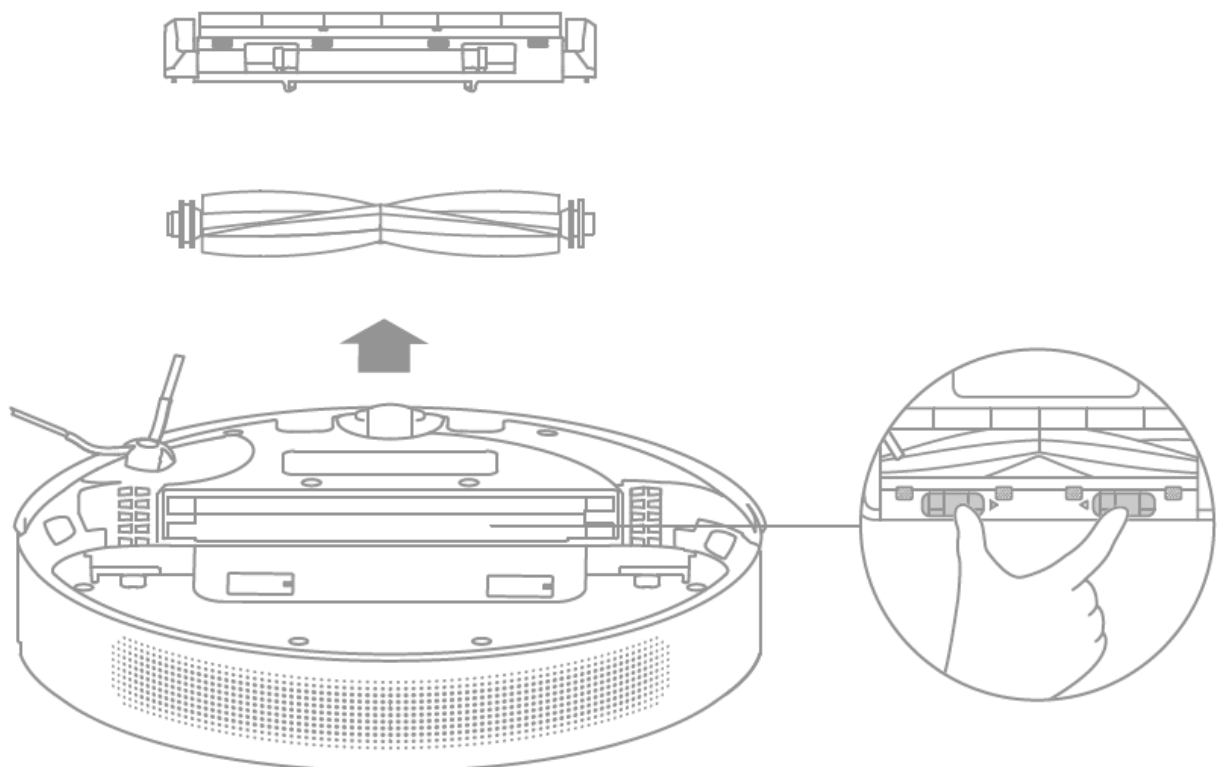

Pull out the brush covers at both ends of the brush as shown in the diagram. Use the provided cleaning tool to remove any hairs tangled in the brush. Reinstall the brush covers on both ends of the brush, and then reinstall the brush. Press on the brush guard to lock it in place.

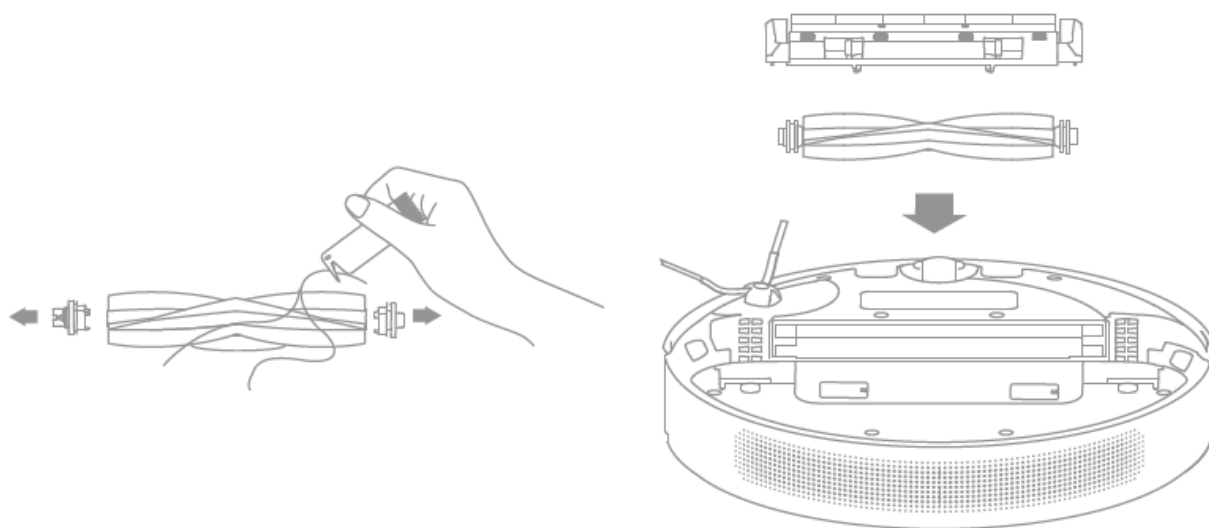

### Side Brush

Remove and clean the side brush.

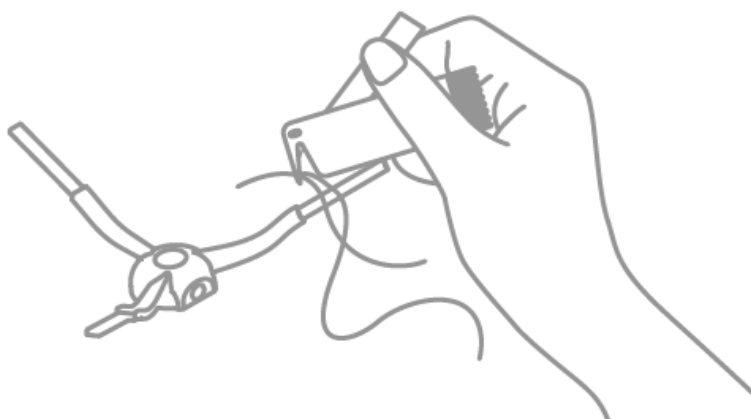

### Omnidirectional Wheel

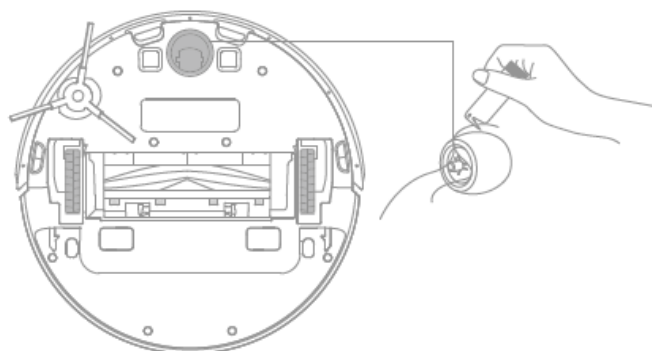

- Use a tool such as a small screwdriver to separate the axle and tire of the omnidirectional wheel. Do not use excessive force.
- Rinse the omnidirectional wheel under the running water and put it back after drying it completely.

## Dust Box

1. Open the robot's cover and press the clip to remove the dust box.

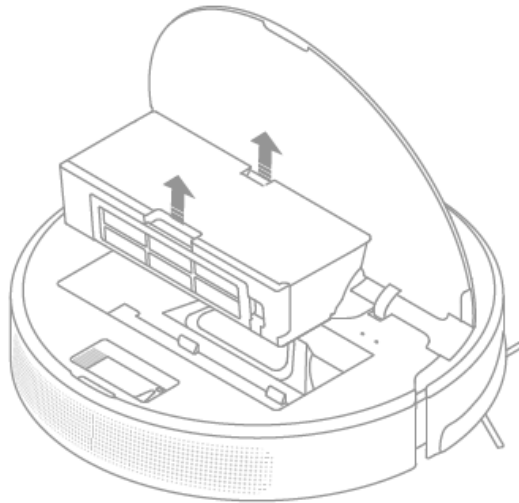

2. Open the dust box cover and empty the dust box as shown in the diagram.

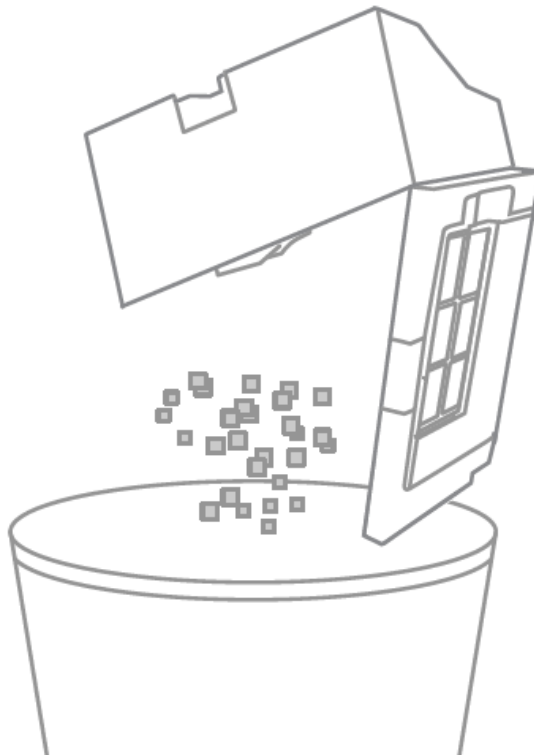

## Filter

1. Remove the filter and tap its basket gently.

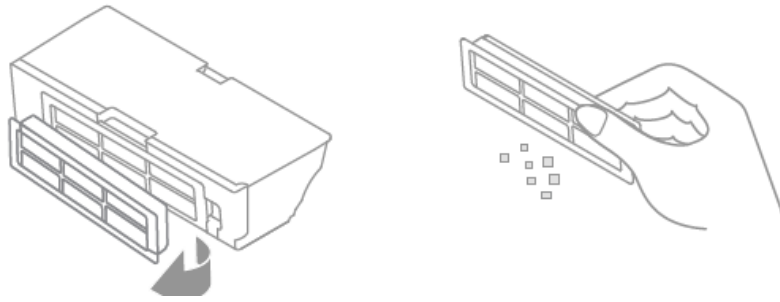

Do not attempt to clean the filter with a brush, a finger or sharp objects to prevent damage.

2. Rinse the dust box and filter with clean water and dry them completely before reinstalling.

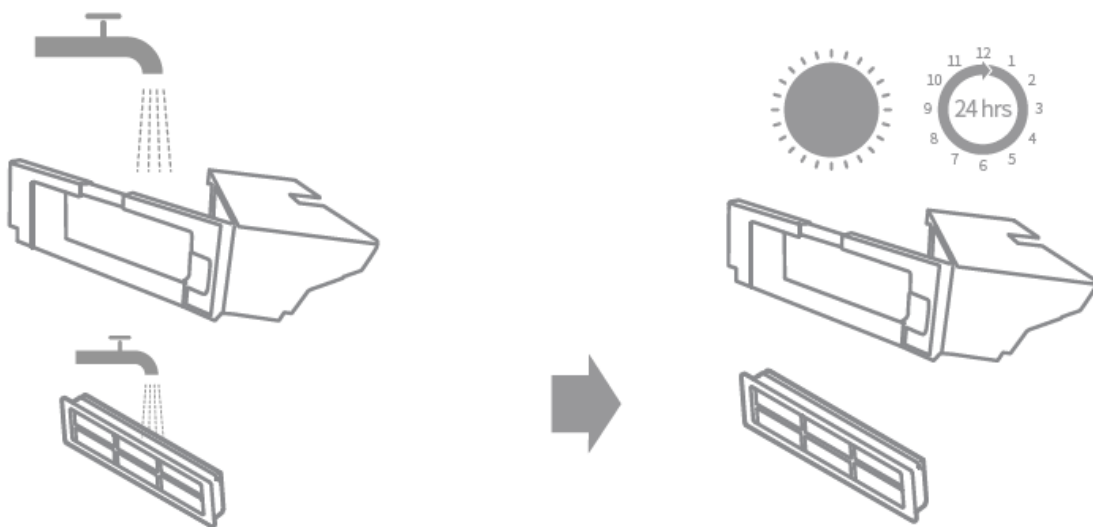

#### **Note:**

1. Rinse the dust box and filter with clean water only. Do not use any detergent.
2. Use the dust box and filter only when they are completely dry.

#### **Dust Bag**

1. Remove and discard the dust bag.

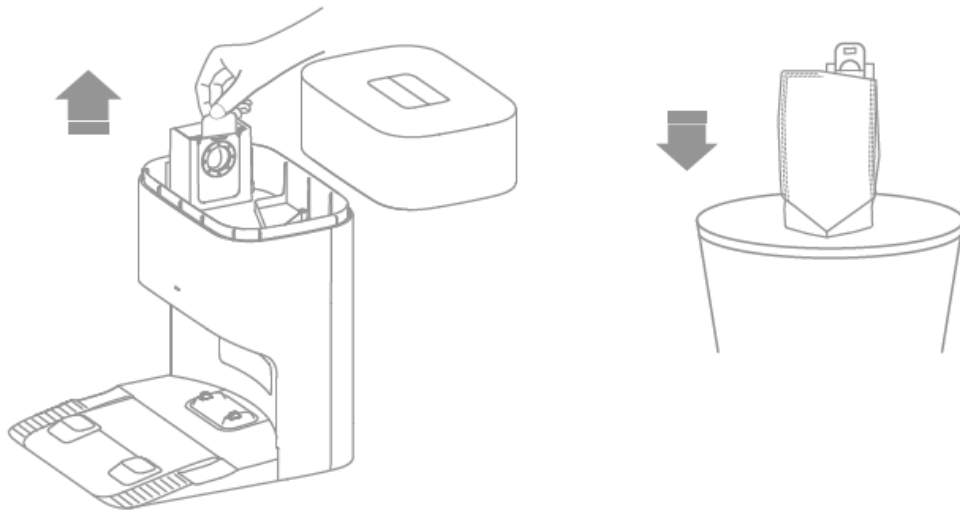

Note: Pulling outwards on the handle will seal the dust bag to prevent the dust and debris from accidentally falling out.

2. Remove the dust and debris from the filter with a dry cloth.
3. Install a new dust bag.

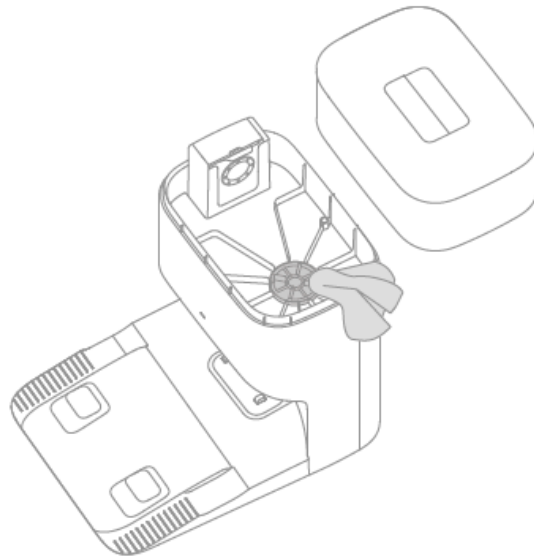

4. Put back the cover of the dust tank.

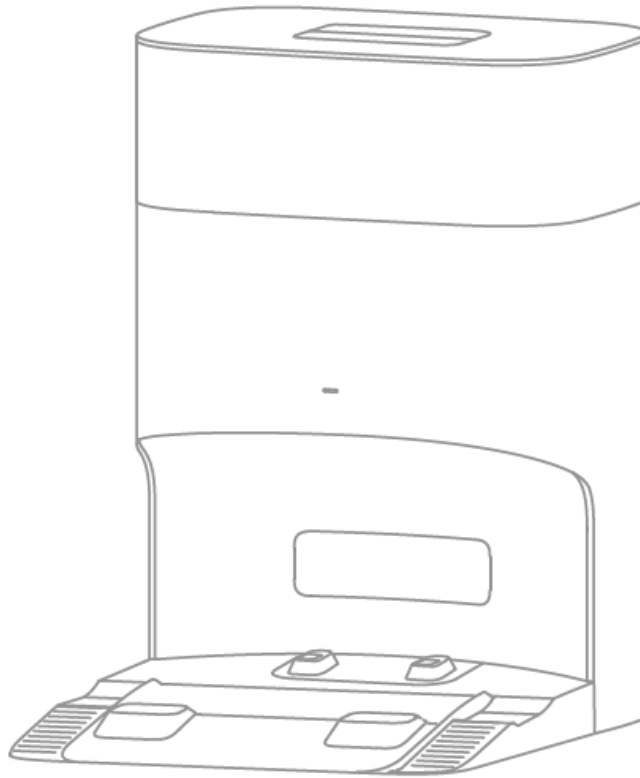

## Robot Sensors

Wipe robot sensors by using a soft and dry cloth, as shown in the below figure:

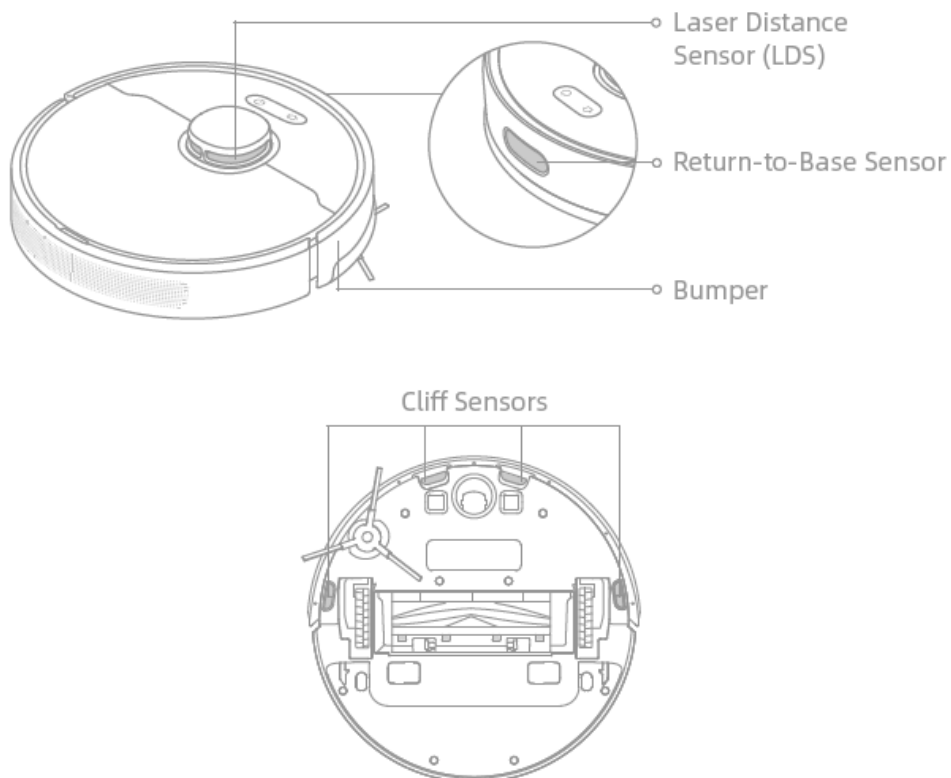

Note: A wet cloth can damage sensitive elements within the robot and the base station. Please use a dry cloth for cleaning.

## Charging Contacts and Signaling Area

Clean the charging contacts and the signaling area with a soft and dry cloth.

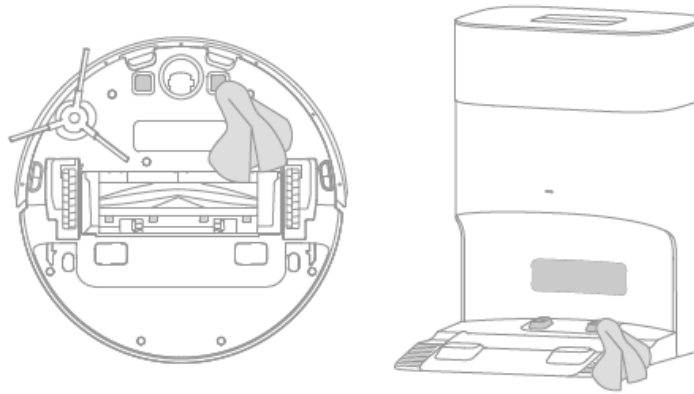

### **Auto-empty Vents**

Clean the auto-empty vents of the robot and the base station with a soft and dry cloth.

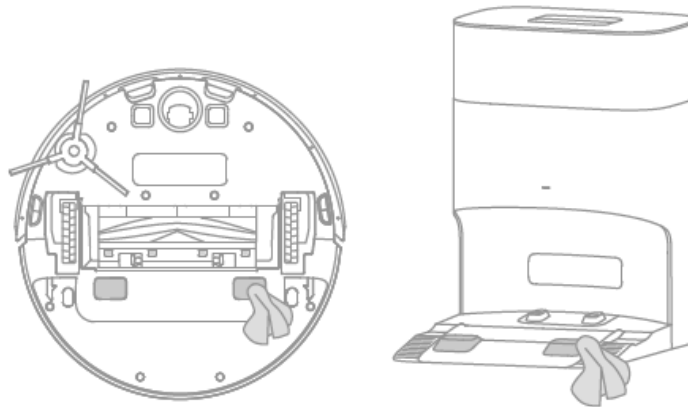

### **Air Duct**

If the air duct is blocked, please clean it according to the following steps.

1. Unscrew mounting screws on the air duct cover and remove the cover.

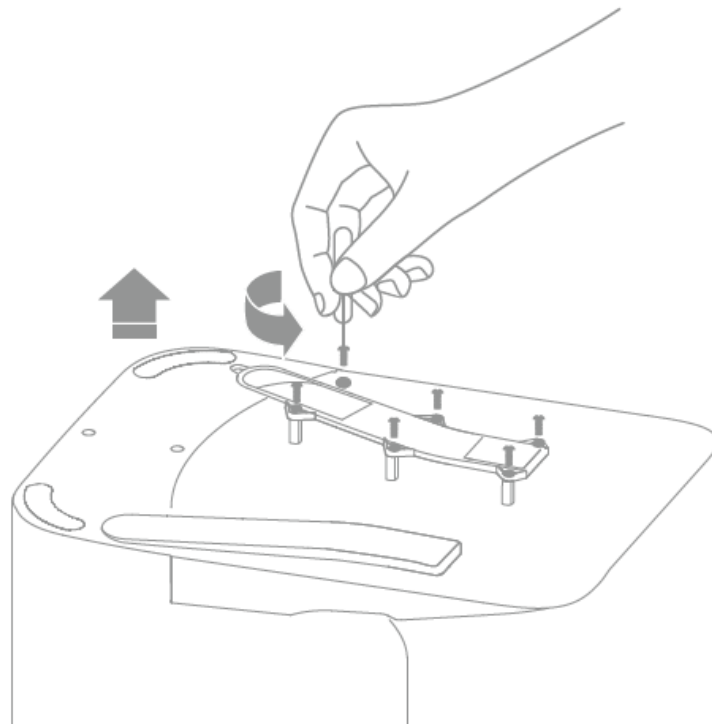

2. Check whether the air duct is blocked by foreign objects. If any, clean them.

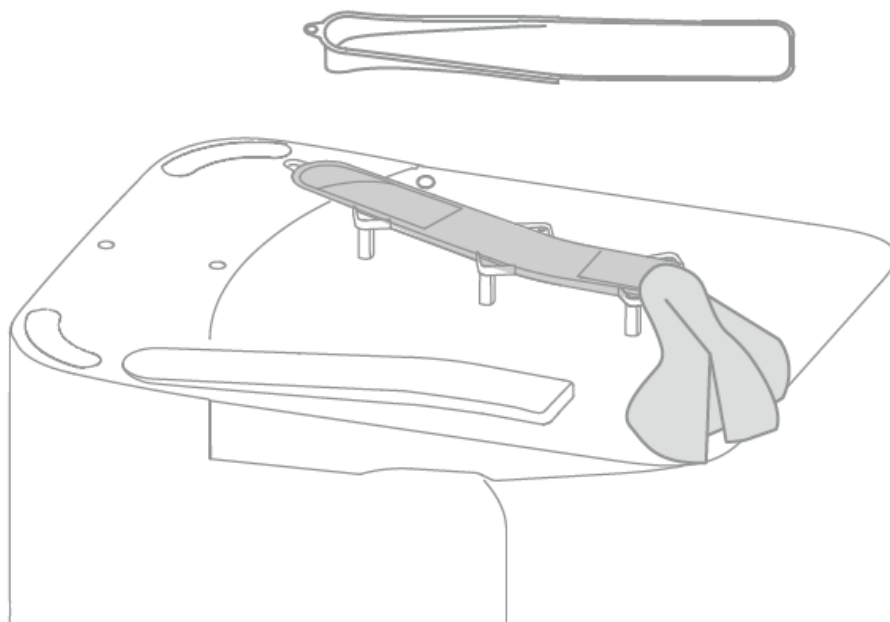

3. Reinstall the air duct cover.

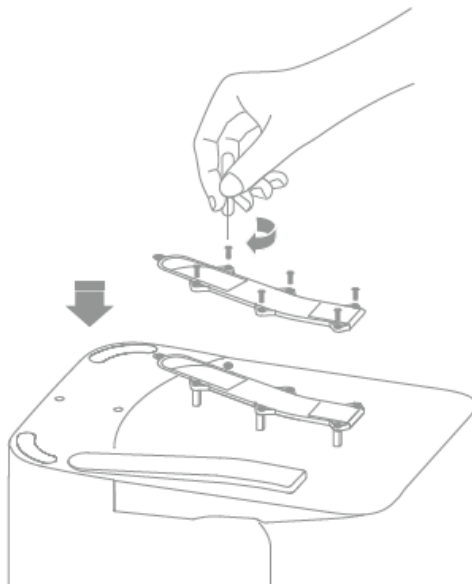

## Battery

The robot contains a high-performance lithium-ion battery pack. Make sure that the battery remains well-charged for daily use to maintain optimal battery performance. If the robot is not used for an extended period of time, turn it off and put it away. To prevent damages from over-discharging, charge the robot at least once every three months.

## Troubleshooting

Problem	Solution
The robot will not turn on.	The battery is low. Recharge the robot on the base station and try again. The temperature of the battery is too low or too high. It is recommended to operate the appliance at a temperature between 32°F (0°C) and 104°F (40°C).
The robot will not charge.	The base station is not connected to power, please make sure both ends of its power cord are correctly plugged in. The contact between the charging contacts on the base station and the robot is poor, please clean the charging contacts.

The robot fails to connect to Wi-Fi.	The Wi-Fi network password is incorrect. Make sure the password used to connect to your Wi-Fi network is correct. The robot does not support a 5 GHz Wi-Fi connection. Make sure the robot is connected to a 2.4 GHz Wi-Fi connection. The Wi-Fi signal is weak. Make sure the robot is in an area with good Wi-Fi coverage. The robot may not be ready to be configured. Please exit and re-enter the app, and then try again as instructed.
The robot cannot find and return to the base station.	The base station is disconnected from power or moved when the robot is not on it. Please connect the base station to the power supply or place the robot onto the base station to charge. There are too many obstructions around the base station. Place the base station in a more open area. Moving the robot may cause it to re-position itself, and it will recreate a map if re-positioning fails. If the robot is too far from the base station, it might not be able to automatically return on its own, in which case you will need to manually place the robot onto the base station. Wipe the signaling area on the base station to remove dust or debris.
The robot gets stuck in front of the base station and cannot return to it.	Clear any obstruction within 19.7" (0.5 m) on the left and right sides or within 60" (1.5 m) in front of the base station to prevent the robot from being blocked. The route for returning to charge is blocked, e.g. the door is closed. It is recommended to move the base station to a different place and try again.

Problem	Solution
The robot will not turn off.	The robot cannot be turned off when it is charging. It is recommended to move the robot from the base station, and then press and hold the button for 3 seconds to turn it off. If the robot cannot be turned off by performing step 1, press and hold the button for 10 seconds to forcibly turn off the robot. If the problem persists, please contact after-sales service.

The charging speed is slow.	It takes about 6 hours to fully charge the robot when its battery is low. If you operate the robot at temperatures outside of the specified range, the charging speed will automatically slow down to extend the battery life. The charging contacts on both the robot and the base station may be dirty, please wipe them with a dry cloth.
The noise increases while the robot is operating.	Check whether the dust box's filter is clogged. If so, clean it or replace it. A hard object may be caught in the main brush or the dust box. Check and remove any hard object. The main brush or the side brush may become tangled. Check and remove any foreign objects. Switch the suction mode to Standard or Quiet.
The robot moves without following the set route.	Objects such as power cords and slippers should be organized before using the robot. Working on wet slippery surfaces may cause the main wheel to slip. It is recommended to dry any wet areas before using the robot.
The robot misses the rooms to be cleaned.	Make sure that the doors of the rooms to be cleaned are open. Check whether there is a threshold higher than 0.8" (2 cm) at the door of the room. The robot cannot climb over high thresholds or steps. The place in front of the room to be cleaned may be wet and slippery, causing the robot to slip and work abnormally. Please try drying the floor before using the robot.

Problem	Solution
The robot will not resume cleaning after charging.	Make sure that the robot is not set to the Do Not Disturb (DND) mode, which will prevent it from resuming cleaning. The robot will not resume cleaning after you manually return the robot to the base station to charge, which includes manually placing the robot on the base station or sending the robot to charge via the app, or the robot itself.

The base station cannot automatically empty the dust box.	Check whether the dust bag in the dust tank is full. If the dust bag is not full, check whether there is any obstruction at the auto-empty vents of the robot, the base station, or the dust box. If any, clean the blocked part in time.
No water comes out of the water tank, or only a little bit comes out.	Check whether there is water inside the water tank. Clean the air hole on the water tank stopper. Clean the mop pad if it becomes dirty. Make sure the mop pad is installed correctly according to the user manual.
Robot returns to the base station without performing auto-empty tasks.	DND mode prevents the robot from performing auto-empty tasks.

For additional services, please contact us via [support.us@dreame.tech](mailto:support.us@dreame.tech)

**Tel:** +1 [866-977-5177](tel:866-977-5177)

## Specifications

### Robot

Model	RLD32GD
Charging Time	Approx. 6 hours
Rated Voltage	14.4 V
Rated Power	75 W
Operation Frequency	2400-2483.5 MHz
Maximum Output Power	< 20 dBm

Under normal use of condition, this equipment should be kept a separation distance of at least 8" (20 cm) between the antenna and the body of the user.

## Base Station with Auto-Empty

Model	RCDD0202
Rated Input	120 V 60 Hz 4.4A
Rated Output	20 V     1 A

For more support, contact us via [support.us@dreame.tech](mailto:support.us@dreame.tech)

- Website: <https://global.dreame.tech.com>
- Tel: +1 [866-977-5177](tel:866-977-5177)
- Manufactured by: Dreame Trading (Tianjin) Co., Ltd.
- Address: Room 2112-1-1, South District, Finance and Trade Center, No.6975 Yazhou Road, Dongjiang Bonded Port Area, Tianjin Pilot Free Trade Zone, Tianjin, China

Made in China

## Documents / Resources

	<a href="#">DREAME D10 Plus Gen 2 Auto Empty Robot Vacuum and Mop [pdf]</a> User Manual R2423C-D10 Plus Gen 2, RLD32GD-US-A00, D10 Plus Gen 2 Auto Empt y Robot Vacuum and Mop, D10 Plus Gen 2, Auto Empty Robot Vacuum a nd Mop, Robot Vacuum and Mop, Vacuum and Mop, Mop
---	---

## References

- [User Manual](#)

dreame

Auto-Empty Robot Vacuum and Mop, D10 Plus Gen 2, D10 Plus Gen 2 Auto Empty Robot Vacuum and Mop dreame, Mop, R2423C-D10 Plus Gen 2, RLD32GD-US-A00, Robot Vacuum and Mop, Vacuum and Mop

---

## Leave a comment

Your email address will not be published. Required fields are marked \*

Comment \*

Name

Email

Website

☐ Save my name, email, and website in this browser for the next time I comment.

**Post Comment**

**Search:**

e.g. whirlpool wrf535swhz

**Search**

[Manuals+](#) | [Upload](#) | [Deep Search](#) | [Privacy Policy](#) | [@manuals.plus](#) | [YouTube](#)

This website is an independent publication and is neither affiliated with nor endorsed by any of the trademark owners. The "Bluetooth®" word mark and logos are registered trademarks owned by Bluetooth SIG, Inc. The "Wi-Fi®" word mark and logos are registered trademarks owned by the Wi-Fi Alliance. Any use of these marks on this website does not imply any affiliation with or endorsement.