

**DRAPER**

**PAC12 3 in 1 Portable  
Air Conditioner with  
Remote Control**



# DRAPER PAC12 3 in 1 Portable Air Conditioner with Remote Control Instruction Manual

[Home](#) » [DRAPER](#) » DRAPER PAC12 3 in 1 Portable Air Conditioner with Remote Control Instruction Manual 

## Contents

- [1 DRAPER PAC12 3-in-1 Portable Air Conditioner with Remote Control](#)
- [2 Preface](#)
- [3 Product Reference](#)
- [4 Product Introduction](#)
- [5 Specification](#)
- [6 Explanation of Symbols](#)
- [7 General Health and Safety](#)
- [8 Identification and Unpacking](#)
- [9 Operation](#)
- [10 Maintenance and Troubleshooting](#)
- [11 Troubleshooting](#)
- [12 Documents / Resources](#)
  - [12.1 References](#)



**DRAPER PAC12 3-in-1 Portable Air Conditioner with Remote Control**



## **Preface**

These are the original product instructions. This document is part of the product; retain it for the life of the product, passing it on to subsequent holders. Read this manual in full before attempting to assemble, operate, or maintain this product. This Draper Tools manual describes the purpose of the product and contains all the necessary information to ensure its correct and safe use. Following all the instructions and guidance in this manual will ensure the safety of both the product and the operator and increase the lifespan of the product.

All photographs and drawings within this manual are supplied by Draper Tools to help illustrate the correct operation of the product. Every effort has been made to ensure the information contained in this manual is accurate. However, Draper Tools reserves the right to amend this document without prior warning. Always use the latest version of the product manual.

## **Product Reference**

User Manual for 3-in-1 Portable Air Conditioner with Remote Control  
Stock No: 23833  
Part No: PAC12

## **Revisions**

Version 1: December 2023

## **First release**

As our manuals are continually updated, always ensure that the latest version is used. Please visit [drapertools.com/manuals](https://drapertools.com/manuals) for the latest version of this manual and the associated parts list, if applicable.

## Understanding the Safety Content of This Manual

**WARNING!** – Situations or actions that may result in personal injury or death.

**CAUTION!** – Situations or actions that may result in damage to the product or surroundings.

**Important:** – Information or instructions of particular importance.

## Copyright Notice

Copyright Draper Tools Limited.

- Permission is granted to reproduce this manual for personal and educational use ONLY. Commercial copying, redistribution, hiring, or lending is strictly prohibited.
- No part of this manual may be stored in a retrieval system or transmitted in any other form or means without written permission from Draper Tools Limited.
- In all cases, this copyright notice must remain intact.

## Product Introduction

### Intended Use

This product has been designed as a portable air conditioner for cooling single rooms. It also has a ventilation function for circulating air and a dehumidifying function for the removal of moisture. Any other application beyond the conditions established for use will be considered misuse. Draper Tools accepts no responsibility for improper use of this product. Read this manual in full before attempting to assemble it, operate or maintain the product, and retain it for later use.

## Specification

Stock No.	23833
Part No.	PAC12
Cooling Capacity	3.5Kw (12000btu)
Rated Input (Cooling)	1330W
Circulation	400m3/hr
Rated Voltage/Frequency	220 -240V/AC – 50Hz
Noise Level	≤ 64dbBA
Net weight	29kg
Unit Dimensions	440 × 335 × 665mm
Remote Control batteries	2 × AAA (not supplied)
Extraction Rate	31 litres per 24 hours
Exhaust Hose Size	1.5m
Suggested Room Size	18 – 25m <sup>2</sup>
Temperature Range	16 – 32°C

## Explanation of Symbols



Read the instruction manual



**Warning!**



Do not incinerate or throw onto fire



**Warning!** Flammable gas.  
Risk of explosion



Mandatory action required



**DO NOT** Adjust factory settings or  
attempt to modify product



Keep appliance away from naked  
flames or sources of ignition.



Supply voltage



Input power



Cooling rating – British Thermal Units/  
Kilowatts



Air movement volume



Suggested operational  
space parameters



Dehumidifier moisture  
collection capacity



Auto defrost



Auto restart



Manoeuvrable product



Refrigerant



Ingress protection rating



Product dimensions



Net product weight



Earthed



WEEE –

Waste Electrical & Electronic Equipment

Do not dispose of Waste Electrical & Electronic Equipment  
in with domestic rubbish



European conformity



UK Conformity Assessed

## Health and Safety Information

**WARNING!:** Read all the Health and Safety instructions before operating, maintaining, or repairing this product. Non-compliance with these instructions may result in injury or damage to the user or the product.

## General Health and Safety

### Precautions

This appliance can be used by children aged 8 years and above and persons with reduced physical, sensory, or mental capabilities or lack of experience and knowledge if they have been given supervision or instruction

concerning the use of the appliance in a safe way and understand the hazards involved. Children shall not play with the appliance. Cleaning and user maintenance shall not be done by children without supervision.

- The unit is designed only for use with R290 (propane) gas.
- The refrigerant loop is sealed. Only a qualified technician should service it.
- NEVER discharge the refrigerant into the atmosphere.
- R290 (propane) is flammable and heavier than air. It collects first in low areas but can be circulated by the fans.
- If propane gas is present or even suspected, only trained personnel should attempt to find the cause. R290 gas used in the unit has no odor. The lack of smell does not indicate a lack of escaped gas.
- If a leak is detected, immediately evacuate all persons from the area, ventilate the room, and contact the local fire department to advise them that a propane leak has occurred.
- Do not let any persons back into the room until the qualified service technician has arrived and advises that it is safe to return to the room.
- No open flames, cigarettes, or other possible sources of ignition should be used inside or in the vicinity of the unit.
- Parts must only be replaced with identical repair parts.
- DO NOT operate with wet hands. Keep the unit away from sources of water, moisture, or any other liquids.
- DO NOT unplug or tilt the unit while it is in operation.
- DO NOT unplug by pulling on the power cord.
- DO NOT put objects on the unit, climb, or sit on the unit.
- DO NOT touch or insert fingers or other objects into the air outlet.
- DO NOT operate the unit if it is dropped, damaged, or showing signs of product malfunction.
- DO NOT clean the appliance with any chemicals.
- DO NOT use any means to accelerate the defrosting process or to clean, other than those recommended by the manufacturer.
- The appliance shall be stored to prevent mechanical damage from occurring.
- DO NOT place in direct sunlight or near objects that may cause mechanical vibration or shock.
- DO NOT pierce or burn, even after use.
- Compliance with national gas regulations shall be observed.
- Keep the air inlet and exhaust outlet clear of any obstructions.
- Place the unit on a firm, level surface in an area with at least 50cm of free space around it to allow for proper air circulation.
- The appliance shall be stored in a well-ventilated area where the room size corresponds to the room area as specified for operation.
- WARNING! Install the unit in rooms that exceed 12m<sup>2</sup>. Do not install the unit in a place where inflammable gas may leak.
- DO NOT leave the unit running unattended.
- WARNING! Any person who is involved with working on refrigerant circuits should hold a currently valid certificate from an industry-accredited assessment authority, which authorizes their competence to handle refrigerants safely by an industry-recognized assessment specification.
- WARNING! Servicing shall only be performed as recommended by the equipment manufacturer.
- Maintenance and repair requiring the assistance of other skilled personnel shall be carried out under the supervision of the person competent in the use of flammable refrigerants.

## **Connection to the Power Supply**

**WARNING!** Risk of electric shock. DO NOT open this product.

- This appliance is supplied with an approved plug and cable for your safety. The product must be installed according to national wiring regulations.
- If the power supply cord is damaged, it must be replaced by Draper Tools, an authorized service agent, or similarly qualified personnel in order to avoid a hazard.
- The damaged or incomplete plug, when cut from the cable, must be disabled to prevent connection to a live electrical outlet.

This product is Class I\* and is designed for connection ONLY to a power supply matching that is detailed on the rating label and compatible with the plug fitted. The value of the fuse fitted is marked on the pin face of the plug. Should the fuse need replacing, ensure the substitute is of the correct rating, approved to BS 1363/A and ASTA or BS Kite marked. This should only be performed by suitably qualified personnel. ASTA BSI The fuse can be replaced by removing the cover using a small plain slot screwdriver and removing the broken fuse from its holder. This should only be performed by suitably qualified personnel.

- DO NOT use an extension lead or adaptor plug.
- Earthed: This product requires an earth connection to protect against electric shock from accessible conductive parts in the event of a failure of the basic insulation.

## **Residual Risk**

The safety instructions in this manual cannot account for all possible conditions and situations that may occur. Exercise common sense and caution when using this product and protect against any additional conceivable risks.

## **Identification and Unpacking**

### **Product Overview**



1. Control panel
2. Airflow adjustable louvers
3. Recessed handle
4. Air inlet
5. Air exhaust outlet
6. Castors
7. Plug storage
8. Drain valve
9. Air filter

### **What's in the Box?**

Carefully remove the product from the packaging and examine it for signs of damage that may have occurred during shipment. Before assembling the product, lay the contents out and check them against the parts shown below. If any part is damaged or missing, do not attempt to use the product. Please contact the Draper Helpline; contact details can be found at the back of this manual.

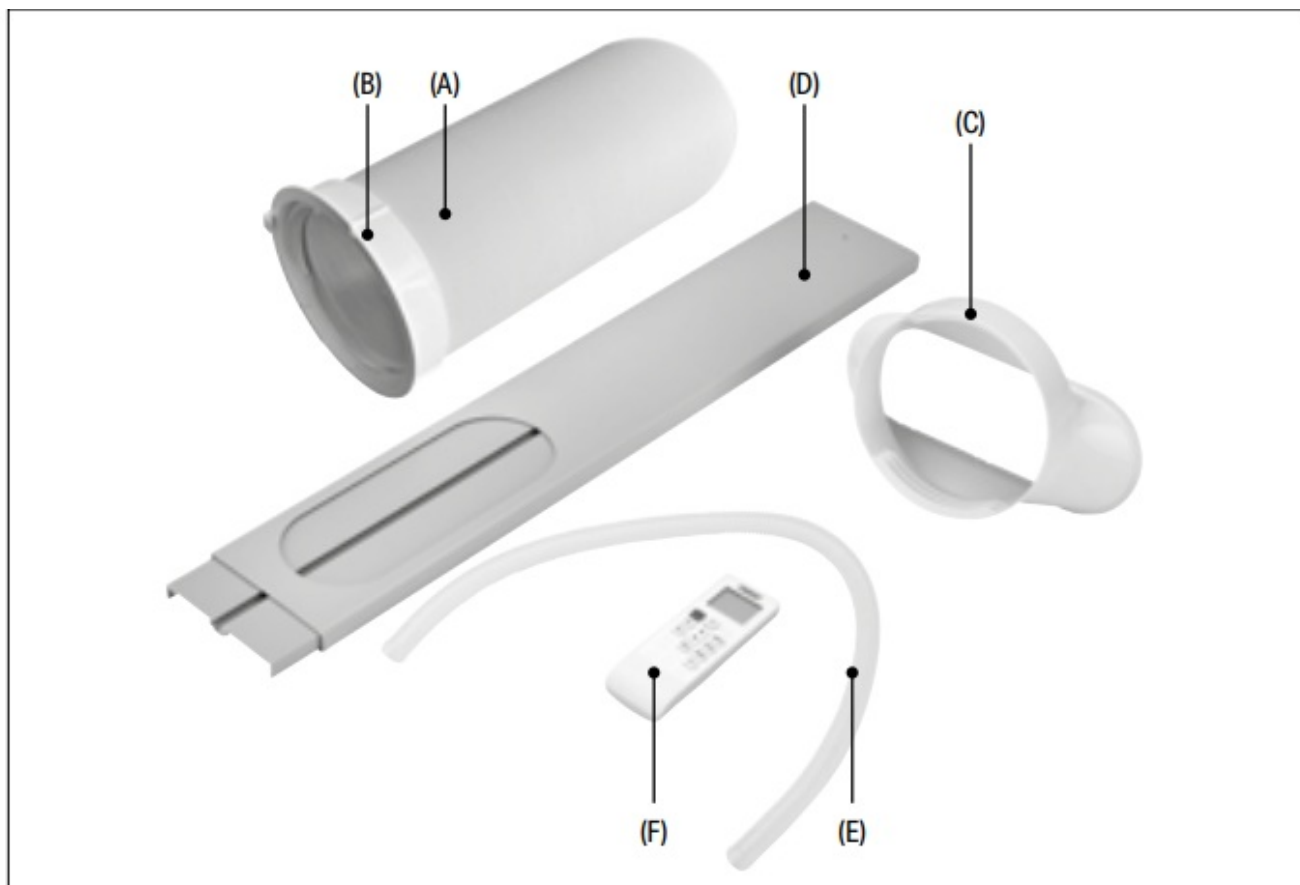

- (A) 1 × Exhaust hose
- (B) 1 × Exhaust hose connector
- (C) Window kit hose adaptor
- (D) Window seal kit
- (E) Drainage hose
- (F) Remote control

### Packaging

Keep the product packaging for the duration of the warranty period for reference should the product need to be returned for repair.

**WARNING!** Keep packaging materials out of reach of children. Dispose of packaging correctly and responsibly and according to local regulations.

Please visit [drapertools.com](http://drapertools.com) for our full range of accessories and consumables.

### Before Operation

Important: Before using this product, read and understand all the safety instructions listed in this manual.

- Allow the unit to stand upright for at least 24 hours before setting up.
- Place the unit on a firm, level surface in an area with at least 50cm of free space around it to allow for proper air circulation.

### Attach the Exhaust Hose

The air conditioner requires venting outside so that the exhaust heat and moisture coming from the unit can escape the room. Do not replace or extend the exhaust hose as this will result in decreased efficiency or cause the unit to shut down.



1. Connect the hose connector (B) to one end of the exhaust hose (A). Fig.1

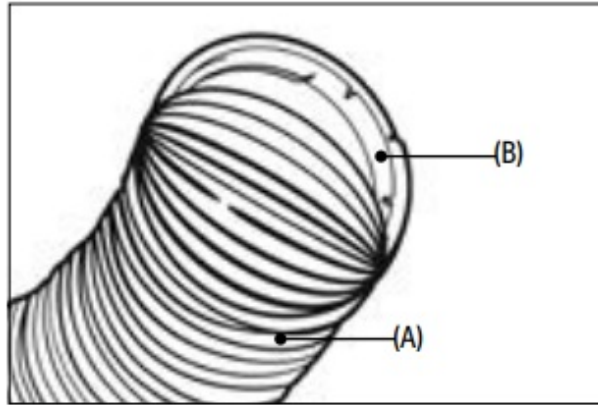

Fig. 1

2. Connect the window kit adapter (C) to the other end. Fig.2

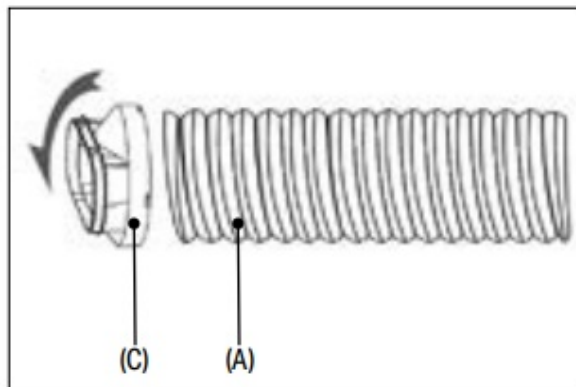

Fig. 2

3. Extend the window kit (D) to the length of your window and connect it to the exhaust hose. Fig.3

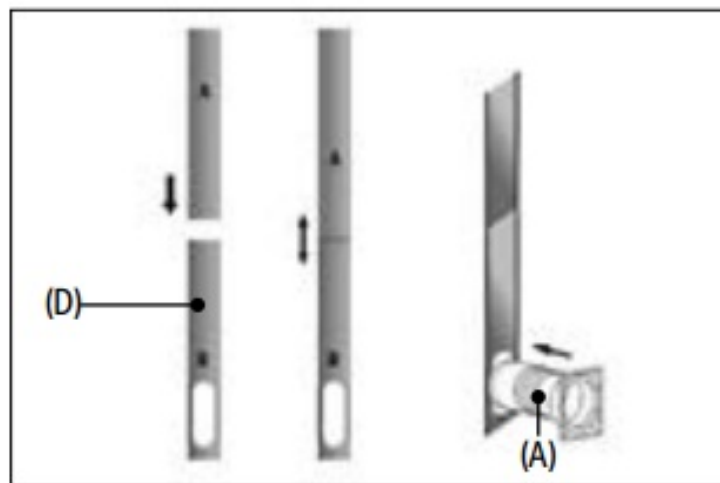

Fig. 3

4. Close your window to secure the kit firmly in place. Fig. 4

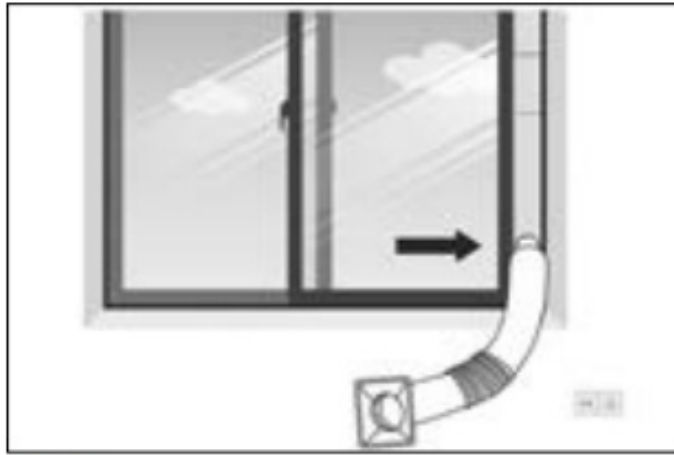

Fig. 4

5. Attach the hose connector (B) to the exhaust air outlet (5). Fig. 5

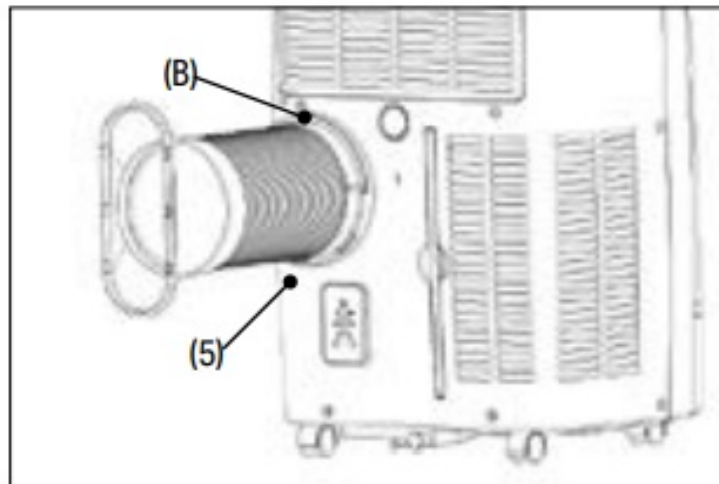

Fig. 5

### Before Operation

6. Adjust the length of the exhaust hose – ensuring the distance between the unit and the window is at least 70cm and at least 90cm from the floor. Avoid bending the hose.
7. Plug in and switch the unit on.

### Control Panel/ Display

8. Power Switch on or off.

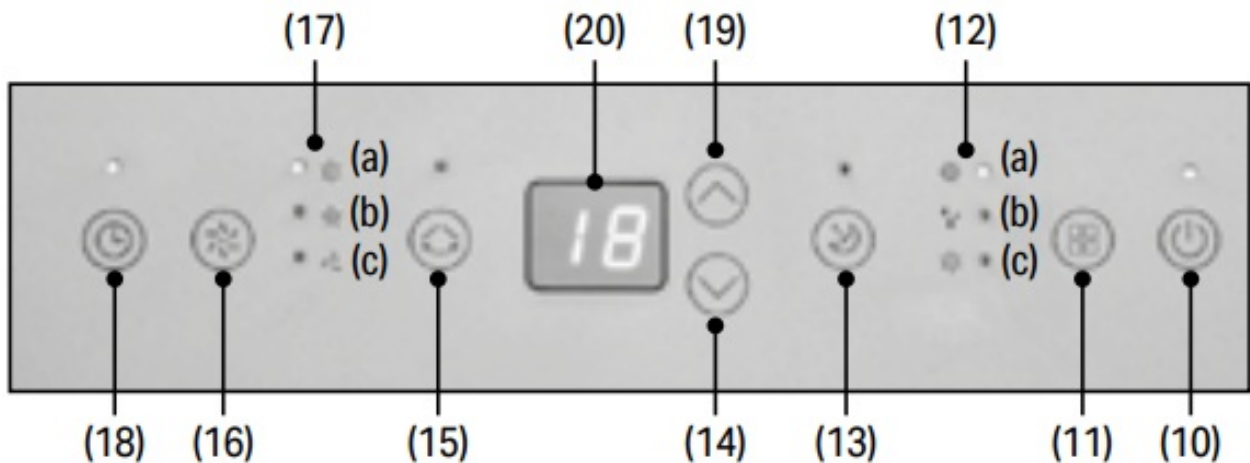

9. Mode Switch between cool, dehumidifier/dry, or fan.
10. Mode Indicator Shows mode setting selected – (a) cool, (b) dehumidifier, or (c) fan.
11. Sleep Turn sleep mode on or off.

12. Down Decrease the temperature or time set.
13. Swing Adjust the airflow direction.
14. Fan Speed Switch fan speed from high, medium, and low.
15. Fan Speed Indicator Shows the fan speed selected – (a) high, (b) medium, or (c) low.
16. Timer 1 hour – 24 hours– Set time for the unit to automatically start or stop.
17. Up Increase temperature from 16°C – 32°C or time set.
18. Digital Display Displays time or temperature selected.

### **Remote Control**

The unit can be operated using the remote control instead of using the control panel buttons. Insert 2 × AAA batteries (not supplied) into the back of the remote control. Ensure the batteries are fitted in the correct +/- orientation.



## **Operation**

### **Start-Up/Shutdown**

1. Plug in and the display screen will come on and the SPEED indicator will flash.
2. To select an operating mode press the POWER button (10) or use the remote control. Note: The unit will default to FAN mode.
3. To stop the operation press the POWER button again.
4. Allow the unit to completely stop before unplugging it.

### **Operation Modes (11)**

- The unit has four operation modes: COOL, DEHUMIDIFIER (DRY), FAN, or SLEEP.
- To change from °C Centigrade to °F Fahrenheit either hold the MODE button down for 2-3 seconds or press the °C /°F button on the remote control to switch.

### **Cooling Mode (12a)**

1. Press the MODE button until the COOL indicator lights up.

2. Press the UP and DOWN buttons to adjust the required temperature. The temperature can be set between 16°C and 32°C.
3. Press the SPEED button until the desired fan speed indicator lights up. To control the direction of the airflow, press the SWING button (15).

Note: The air conditioner will stop if the room temperature is lower than the selected temperature.

### **Dehumidifier/Dry Mode (12b)**

1. Press the MODE button on the control panel until the dehumidifier indicator lights up. Remove the drain valve plug and connect the drainage hose (E ) to the drain outlet (8) at the bottom of the unit.

**Note:** In this mode, the fan speed is low, and a temperature cannot be selected.

### **Refer to section**

Manual Drainage and Continuous Drainage for more information on using the drainage hose.

### **Ventilation/Fan Only Mode (12c)**

1. Press the MODE button until the FAN indicator lights up.

**Note:** In ventilation mode, the room air is circulated, but not cooled.

2. Press the SPEED button to select the desired fan speed.

### **Sleep Mode (13)**

1. The SLEEP mode can be activated when in COOL mode by pressing the button on the control panel or by selecting the remote control.
2. In SLEEP mode: the display screen light will dim and the fan will operate at low speed.

### **Timer Setting – 1hour – 24hours (18)**

The timer operates in two ways:

- To Turn it Off (when powered on) – Press the TIMER button to select the timer function. Then press the UP and DOWN arrows until the delay of the time required is set.
- To Turn it ON (when power is off) – Press the TIMER button to select the timer function. Then press the UP and DOWN arrows until the delay on time required is set.
- To cancel the timer – Press UP/DOWN until '00' is displayed or press the POWER button.

### **Automatic Defrost**

At low room temperatures, frost may build up at the evaporator during operation. If this occurs the unit will start defrosting and the power light will blink. The unit will automatically start defrosting and the POWER light will blink.

### **The defrost operates as follows.**

- When the unit operates in the COOL or DEHUMIDIFIER/DRY mode, the temperature sensor will sense the evaporator coil temperature is below -1°C.
- The compressor will then stop operating for 10 minutes or until the temperature reaches 7°C, the unit will then restart in COOL mode.

- When the unit operates in the dehumidifying mode, once the coil temperature sensor senses the temperature of the evaporator is below 40°C and the difference between the coil temperature and room temperature is below 19°C, the compressor will operate for 20 minutes. The unit will then start defrosting for 5 minutes and the POWER indicator will blink.

### Overload Protection

In the event of a power loss, to protect the compressor there is a 3-minute delay until the compressor will restart.

## Maintenance and Troubleshooting

Problem	Possible cause	Remedy
The unit does not operate.	Not plugged in.	Plug into power socket.
	Auto shut off operated due to water level at maximum or 'Ft' shown on screen.	Drain the water – see <b>9.1 drainage</b> .
	Room temperature too cold or hot	Operating temperature is 5 - 35°C.
Operating with reduced efficiency	Air filter dirty.	Clean the air filter – <b>see 9.4 and 9.5</b> Recommend cleaning every 2 weeks.
	Air duct is blocked.	Clear the obstruction.
	Door or window opened.	Keep doors and window closed during operation.
	Exhaust hose not fitted.	Securely attach the hose.
Water leakage	Overflowed while moving unit.	Empty the water before moving.
	Drain hose is kinked or bent.	Straighten the drain hose.
Excessive Noise	Unit not positioned on a flat level surface.	Place the appliance on a flat level surface.
	Noise sounds like flowing water.	Normal operation – noise coming from flowing refrigerant.
Fan continues to operation after powered off	Normal operation. The compressor fan will continue to operate to blow out any remaining condensed water.	Wait a few minutes until the unit has completely stopped before unplugging.
Error Codes		
E0, E1, E2		Fault with unit. Contact Draper helpline for advice.
Ft		Condensation high level alarm. Empty the water – <b>see 9.1</b>

### Manual Drainage

- The unit will automatically stop when the tank is full.
- Unplug before emptying the unit.
- Move the unit carefully to avoid spilling the water.
- Place a container for the water below the drain.
- Remove the drain valve to allow the water to flow out into the container.

### Notes

- During drainage, tilt the body back slightly.
- When the water has emptied, refit the drain valve.
- Always ensure the drain valve is fitted correctly before restarting the unit.

### **Continuous Drainage**

The self-evaporating system uses the collected water to cool the condenser coils for more efficient performance. There is no need to empty the drainage tank in cooling mode as any condensation will evaporate and exit through the exhaust outlet. For continuous operation in dehumidifying mode, connect the drain hose to the unit so that the water can automatically flow into a bucket or drain.

1. Switch off the unit and remove the drain valve. Retain in a safe place.
2. Securely connect the drainage hose (E), making sure it is not kinked and clear of any obstructions.
3. Place the end of the hose over a drain or bucket so the water flows freely out of the unit.
4. To prevent any airlocks, do not submerge the end of the hose completely in the water.

### **General Cleaning**

- Always switch off and plug the unit before cleaning.
- Clean the outer surface of the unit with a soft damp cloth and mild detergent. Wipe dry.
- Clean the air inlet and filter regularly to stop a build of dust which can have a detrimental effect on the performance of the unit.
- DO NOT operate the unit without the air filter fitted.

### **Cleaning the Air Inlet Cover (4)**

1. Lift off the air inlet mesh cover from the unit.  
WARNING! To avoid injury to your fingers, do not touch the evaporator surface when removing the filter.
2. Use a soft brush or vacuum cleaner to remove any dust or debris.
3. Refit to the unit.

### **Cleaning the Removable Air Filter (9)**

1. Slide out the filter mesh from the unit.
2. Use a vacuum cleaner to suck dust and any debris from the filter.
3. Turn the filter over and rinse the air filter under running water.
4. Allow the filter to air dry completely before refitting.

## **Troubleshooting**

### **Storage**

When the appliance is not in use for an extended period, it is recommended to follow these steps:

1. Unplug and remove the exhaust hose and window kit. Store both with the main unit.
2. Drain the water and clean the filter. Allow the filter to dry before refitting.
3. Keep the appliance upright when storing. Store in a dry and well-ventilated area.

Important: The evaporator inside the appliance must be dried out before it is packed to avoid component

damage and mold growth.

4. Either place in a dry open area until dried out or turn on to FAN mode until the exhaust hose is dry.

### **Spares, Returns, and Disposal**

For spare parts, servicing, and repair and replacement options, please contact the Draper Tools Product Helpline for details of your nearest authorized agent. Draper Tools will endeavor to hold any spare parts, if applicable, for seven years from the date that it sells the final matching stock item. Any servicing or repairs carried out by unauthorized personnel or installation of spare parts not supplied by Draper Tools will invalidate your warranty. At the end of its working life, dispose of the product responsibly and in line with local regulations. Recycle where possible.

- DO NOT dispose of this product with domestic waste; most local authorities provide appropriate recycling facilities.
- WARNING! Releasing refrigerant into the atmosphere is strictly forbidden!
- DO NOT burn or mutilate batteries; this may release toxic or corrosive substances.
- Dispose of the battery in accordance with local regulations or return it to your warranty agent or stockist for recycling.

### **Warranty**

Draper Tools products are carefully tested and inspected before shipment and are guaranteed to be free from defective materials and workmanship. Should the tool develop a fault, return the complete tool to your nearest distributor or contact Draper Tools directly. Contact information can be found at the back of this manual. Proof of purchase must be provided. If, upon inspection, it is found that the fault occurring is due to defective materials or workmanship, repairs will be carried out free of charge. This warranty period covers parts and labor for 24 months from the date of purchase. Where tools have been hired out, the warranty period covers 90 days from the date of purchase.

This warranty does not apply to any consumable parts, batteries, or normal wear and tear, nor does it cover any damage caused by misuse, careless or unsafe handling, alterations, accidents, or repairs attempted or made by any personnel other than the authorized Draper Tools repair agent. In all cases, to make a claim for faulty workmanship or materials within the standard warranty period, please contact or return the product to the place of purchase.

Proof of purchase may be required. If the place of purchase is no longer trading or if you experience any difficulties with your warranty, please contact Customer Services with the product details and your proof of purchase. Contact details can be found at the back of this manual. If the tool is not covered by the terms of this warranty, repairs, and carriage charges will be quoted and charged accordingly. This warranty supersedes any other guarantees expressed or implied and variations of its terms are not authorised. Your Draper Tools guarantee is not effective until you can produce, upon request, a dated receipt or invoice to verify your purchase within the guarantee period. Please note that this warranty is an additional benefit and does not affect.

### **Contact Details**

Draper Tools  
Draper Tools Limited  
Hursley Road Chandler's Ford  
Eastleigh Hampshire SO53 1YF

### **UK**

Website: [drapertools.com](http://drapertools.com)

Email: [sales@drapertools.com](mailto:sales@drapertools.com)

Product Helpline: +44 (0) 23 8049 4344

Telephone Sales Desk: +44 (0) 23 8049 4333

General Enquiries: +44 (0) 23 8026 6355

General Fax: +44 (0) 23 8026 0784

Please contact the Draper Tools Product Helpline for repair and servicing inquiries.

## Delta International

Delta International BV  
Oude Graaf 8 6002 NL  
Weert Netherlands

## Documents / Resources

	<p><a href="#">DRAPER PAC12 3 in 1 Portable Air Conditioner with Remote Control</a> [pdf] Instruction Manual</p> <p>23833, PAC12, PAC12 3 in 1 Portable Air Conditioner with Remote Control, PAC12, 3 in 1 Portable Air Conditioner with Remote Control, Air Conditioner with Remote Control, Conditioner with Remote Control, Remote Control, Control</p>
---	--

## References

- [Draper Tools Official Website | Hand Tools, Power Tools and Accessories](#)
- [Manuals | Draper Tools](#)
- [User Manual](#)

[Manuals+](#), [Privacy Policy](#)

This website is an independent publication and is neither affiliated with nor endorsed by any of the trademark owners. The "Bluetooth®" word mark and logos are registered trademarks owned by Bluetooth SIG, Inc. The "Wi-Fi®" word mark and logos are registered trademarks owned by the Wi-Fi Alliance. Any use of these marks on this website does not imply any affiliation with or endorsement.