



DRAPER LVC-IV Low-Voltage Control Module Instruction Manual

[Home](#) » [DRAPER](#) » DRAPER LVC-IV Low-Voltage Control Module Instruction Manual 

Contents

- [1 DRAPER LVC-IV Low-Voltage Control Module](#)
- [2 Overview](#)
- [3 Technical Specifications](#)
- [4 Uses](#)
- [5 Programming Radio Frequency \(RF\) Remote Control](#)
- [6 Infrared \(IR\) Remote Control](#)
- [7 DC Low-voltage Trigger](#)
- [8 RS232 / RS485 Information](#)
- [9 Wiring LVC-IV to Motor](#)
- [10 Documents / Resources](#)
 - [10.1 References](#)
- [11 Related Posts](#)



DRAPER LVC-IV Low-Voltage Control Module



Overview

The LVC-IV module contains a 3-screw terminal block for a low voltage wall switch, an IR receiver jack, a built-in RF receiver, two RJ25 ports for RS232 / RS485, a low-voltage relay port with cable and a user-serviceable 3.5 Amp fuse.

Technical Specifications

- **Power Supply:** 110V-120V / 60Hz
- **Temperature:** -40° C – 85° C
- **Frequency:** 433 MHz
- **Power:** <300W
- **Transmit Power:** <10mW
- **Sensitivity:** -110dBm
- **Fuse:** 3.15 Amp

Compatible components for each are listed below.

Uses

Uses

**IR (Infrared)
Remote Control**

**RJ25 Ports for
RS-232/RS-485
Communication**

Low-Voltage Wall Switch

“Dry” Contact Closure

**RF (Radio Frequency)
Remote Control**

3rd Party Control
Control systems employing “dry”
contacts or Serial Communication.

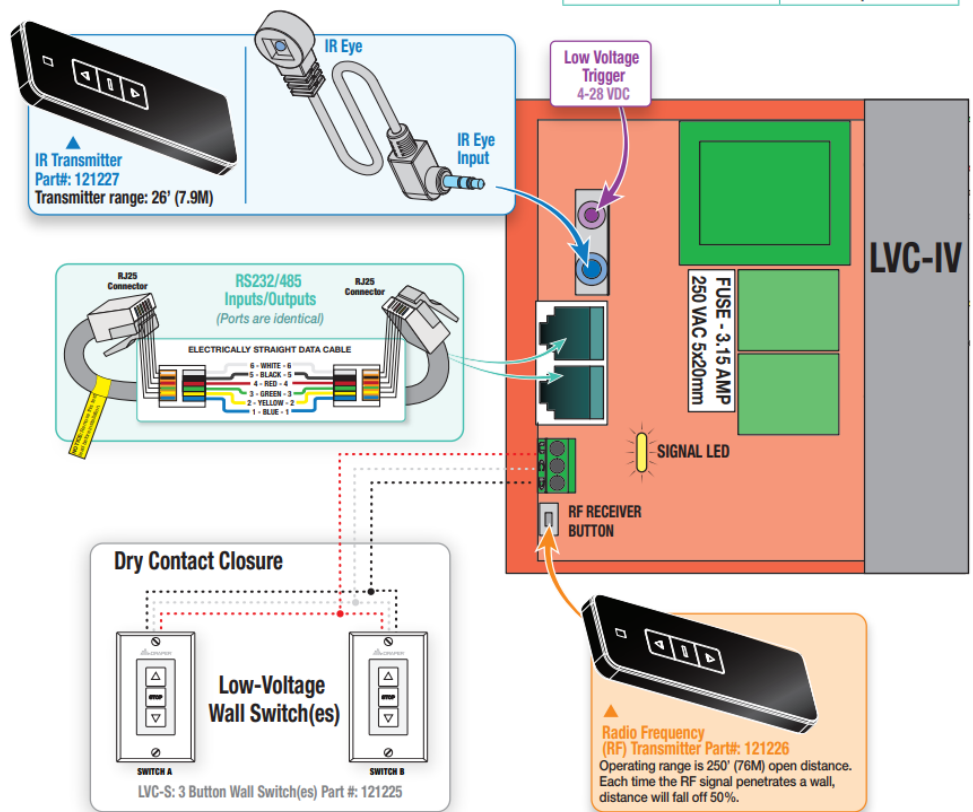

The 120V LVC-IV also used as a Single-Pole, Double-Throw dry closure to control equipment by the same means listed above.

COMPATIBLE COMPONENTS		PART NO.
IRT / R	Infrared Remote Control (Connects to IR Port)	121228
WRT / R	Radio Frequency Remote (antenna built in)	121226
LVC-S	Low-Voltage Wall Switch.	121225
	Low-Voltage Wall Switch w/ Locking Cover	121232
KS-1	Power Supply Key Switch.	121017
SP-KSM	3-position Momentary Key Switch (Please Note: 'Stop' won't work)	121022
Auxillary Control	Control systems employing “dry” contacts or Serial Communication.	By Others

Programming Radio Frequency (RF) Remote Control

The LVC-IV comes with built-in Radio Frequency Remote control capability (optional handheld transmitter NOT included).

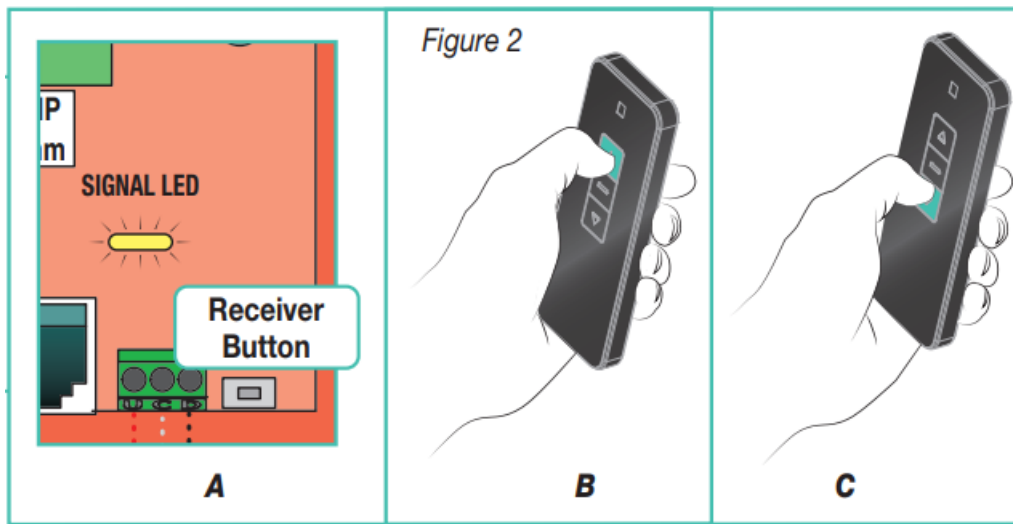

To “Learn” a remote

1. Press the receiver button on LVC-IV (see Fig. 2A).
2. The signal light will flash slowly.



3. Press (UP) on the transmitter within 10 seconds (see Fig. 2B).
4. The signal light flashes three times quickly

To “Un-Learn” a remote

1. Press the receiver button on LVC-IV (see Fig. 2A).
2. The signal light will flash slowly.



3. Press (DOWN) on the transmitter within 10 seconds (see Fig. 2C).
4. The signal light flashes three times quickly.

To “Un-Learn” all remotes

Please Note: Operating range is 250ft (76 meters) open distance. RF Signal will degrade significantly with each wall it is required to penetrate. If you are experiencing issues with RF signal strength, the RF antenna can be threaded out one of the knockouts for better reception.

PLEASE NOTE:

1. RF receiver MUST NOT TOUCH METAL OBJECTS!
The maximum distance of Transmitter will be affected negatively.
2. Disconnect the power supply before installing the RF receiver.
3. Avoid electrostatic interference:
Static electricity will damage the electronic components.
4. Ensure there is > 5' (1.52M) between the RF receiver and the ground.
5. Ensure there is > 1' (30.5cm) between the RF receiver and the ceiling.
6. Ensure there is > 1' (30.5cm) between the RF receiver and the transmitter.

7. Multiple receivers must be spaced > 8" (20cm) apart.

Infrared (IR) Remote Control

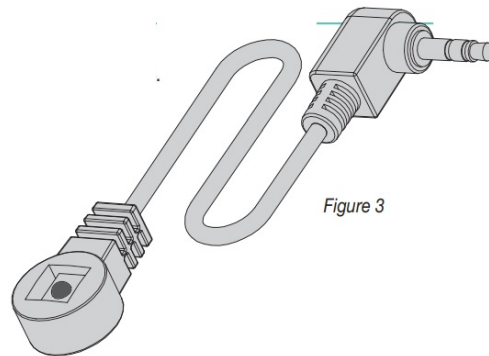

Figure 3

1. Plug Optional IR Eye into mini plug input provided on LVC-IV (see Fig. 3).
2. IR Remote Control transmitter does not need to be “learned” by the LVC-IV. Simply point and operate.
3. Maximum IR Eye cable length is 42" (1 meter).

Please Note: IR Transmitter Range is 26ft. (7.9 meters).

DC Low-voltage Trigger

The LVC-IV comes with a built-in connection for sending a DC trigger (4-28 VDC) from the projector to the projection screen.

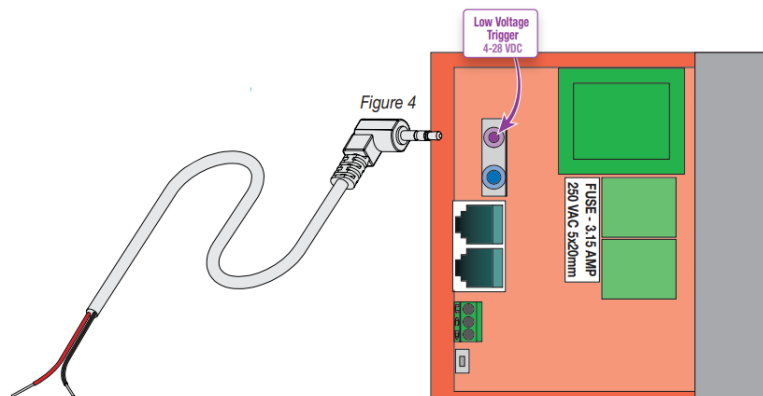

Figure 4

1. Connect remote trigger voltage from projector to the low-voltage trigger cable.
2. Plug the mini-jack plug of the low-voltage trigger cable to the LVC-IV (Figure 4).
3. When the projector is 'ON' the low-voltage output of the projector will cause LVC-IV to deploy the projection screen. When the projector 'OFF' the low-voltage is removed from LVC-IV and the projection screen will retract into case.

RS232 / RS485 Information

RS232 / RS485 CommPort Parameters:

Frequency (BAUD Rate)	2400
Data long code	8
Parity Check	N
Start bit	1
Stop bit	1
Flow Control	NONE

COMMAND	COMMAND STRINGS	REMARK
UP	9A 01 01 00 0A DD D7	ID No. : 1 / Channel : 01
STOP	9A 01 01 00 0A CC C6	ID No. : 1 / Channel : 01
DOWN	9A 01 01 00 0A EE E4	ID No. : 1 / Channel : 01

For more detailed programming instructions or group control go to:
<http://www.draperinc.com/DraperPro>
 (registration required)

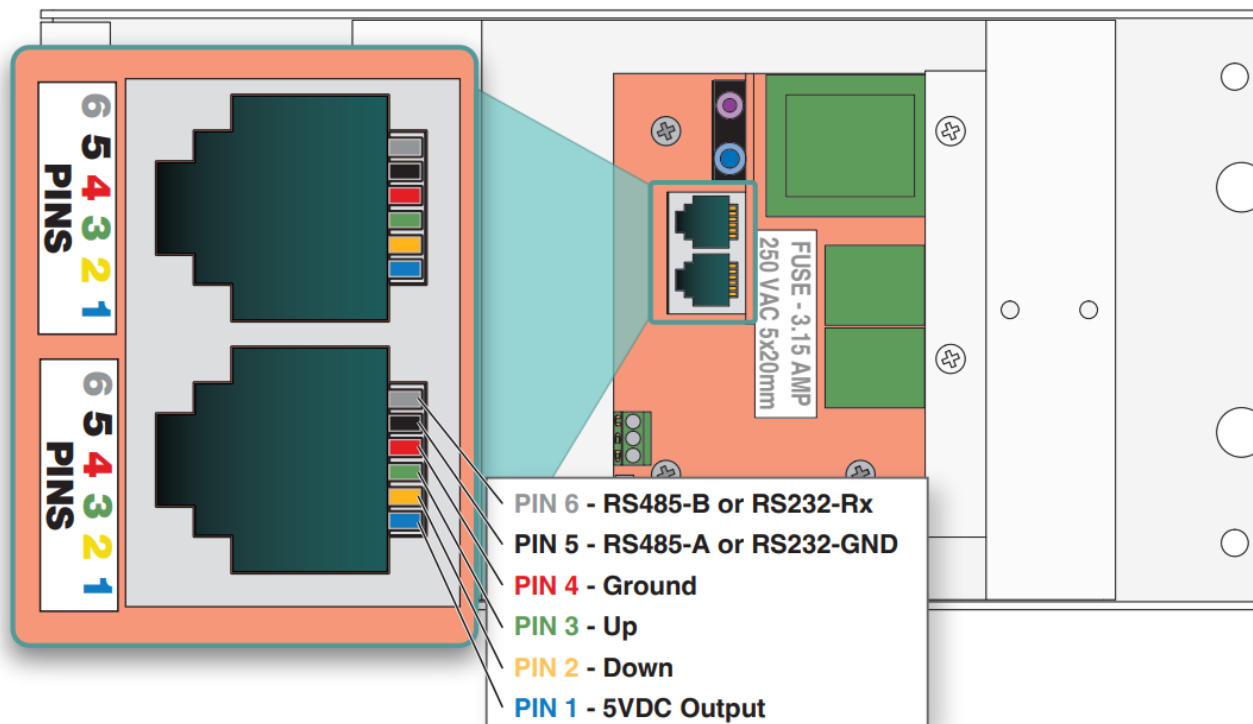

Wiring LVC-IV to Motor

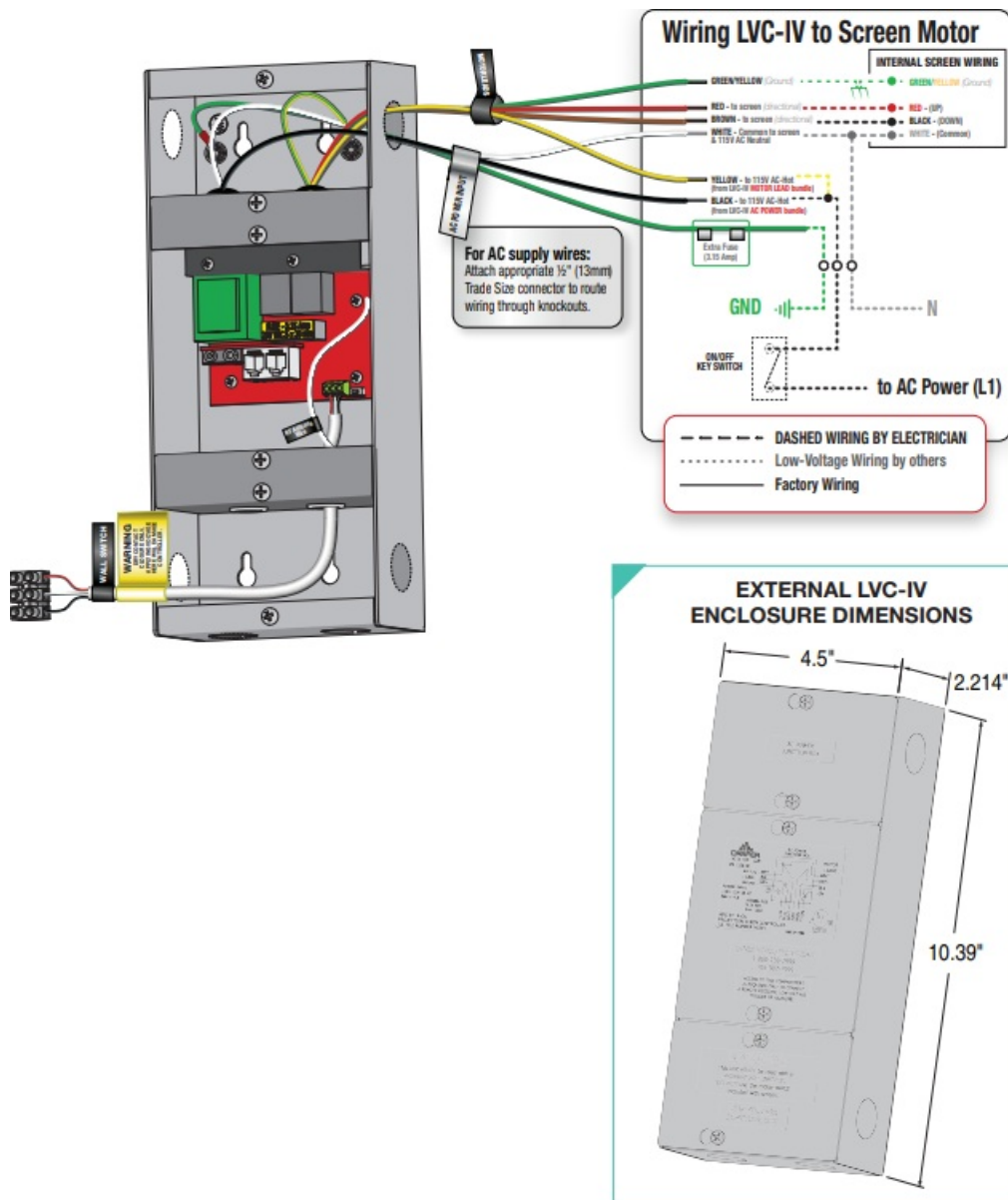

If you encounter any difficulties installing or servicing your LVC-IV, call your dealer or contact Draper, Inc. Draper, Inc. | 411 S. Pearl St. Spiceland, IN 47385
draperinc.com | 765.987.7999 | 800.238.7999
 © 2022 All Rights Reserved | FORM: LVCIV_110_Wiring22

Documents / Resources

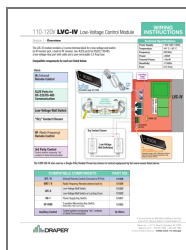

DRAPER LVC-IV Low-Voltage Control Module [pdf] Instruction Manual
 LVC-IV Low-Voltage Control Module, LVC-IV, Low-Voltage Control Module, Control Module, Module

References

- [Draper Pro Portal Login :: Draper, Inc.](#)