



DRAPER 02168 Tyrolean Flicker Machine User Manual

[Home](#) » [DRAPER](#) » DRAPER 02168 Tyrolean Flicker Machine User Manual 

DRAPER 02168 Tyrolean Flicker Machine



These instructions accompanying the product are the original instructions. This document is part of the product, keep it for the life of the product passing it on to any subsequent holder of the product. Read all these instructions before assembling, operating or maintaining this product.

This manual has been compiled by Draper Tools describing the purpose for which the product has been designed,

and contains all the necessary information to ensure its correct and safe use. By following all the general safety instructions contained in this manual, it will ensure both product and operator safety, together with longer life of the product itself.

All photographs and drawings in this manual are supplied by Draper Tools to help illustrate the operation of the product.

Whilst every effort has been made to ensure the accuracy of information contained in this manual, the Draper Tools policy of continuous improvement determines the right to make modifications without prior warning.

Contents

- 1 INTRODUCTION**
- 2 REVISIONS**
- 3 UNDERSTANDING THIS MANUALS SAFETY CONTENT**
- 4 COPYRIGHT © NOTICE**
- 5 GUARANTEE**
- 6 TECHNICAL DESCRIPTION**
 - 6.1 IDENTIFICATION**
- 7 ASSEMBLY AND OPERATION**
 - 7.1 INSTALLING THE ROLLER AND DRIVE HANDLE FIGS.1
2**
 - 7.2 ADJUSTING THE PATTERN/TEXTURE CONTROL – FIG.3**
 - 7.3 USING THE REDUCER COVER – FIG.4**
- 8 OPERATION**
- 9 MAINTENANCE**
- 10 DISPOSAL**
- 11 CONTACTS**
- 12 Documents / Resources**
 - 12.1 References**
- 13 Related Posts**

INTRODUCTION

USER MANUAL FOR: **Stainless Steel Tyrolean Flicker Machine**

Stock No: 02168

Part No: SSTF

REVISIONS

Date first published March 2018.

As our user manuals are continually updated, users should make sure that they use the very latest version.

Downloads are available from: <http://drapertools.com/manuals>

Draper Tools Limited

Hursley Road

Chandler's Ford

Eastleigh

Hampshire

O53 1YF

UK

Website: drapertools.com

Product Helpline: +44 (0) 23 8049 4344

General Fax: +44 (0) 23 8026 0784

UNDERSTANDING THIS MANUALS SAFETY CONTENT

WARNING! Information that draws attention to the risk of injury or death. **CAUTION!** Information that draws attention to the risk of damage to the product or surroundings.

COPYRIGHT © NOTICE

Copyright © Draper Tools Limited.

Permission is granted to reproduce this publication for personal and educational use only. Commercial copying, redistribution, hiring or lending is prohibited.

No part of this publication may be stored in a retrieval system or transmitted in any other form or means without written permission from Draper Tools Limited. In all cases this copyright notice must remain intact.

GUARANTEE

Draper tools have been carefully tested and inspected before shipment and are guaranteed to be free from defective materials and workmanship.

Should the tool develop a fault, please return the complete tool to your nearest distributor or contact:

Draper Tools Limited, Chandler's Ford, Eastleigh, Hampshire, SO53 1YF. England.

Telephone Sales Desk: (023) 8049 4333 or:

Product Helpline (023) 8049 4344.

A proof of purchase must be provided.

If upon inspection it is found that the fault occurring is due to defective materials or workmanship, repairs will be carried out free of charge. This guarantee period covering parts/labour is 6 months from the date of purchase except where tools are hired out when the guarantee period is 90 days from the date of purchase. The guarantee is extended to 24 months for parts only. This guarantee does not apply to normal wear and tear, nor does it cover any damage caused by misuse, careless or unsafe handling, alterations, accidents, or repairs attempted or made by any personnel other than the authorised Draper warranty repair agent.

Note: If the tool is found not to be within the terms of warranty, repairs and carriage charges will be quoted and made accordingly.

This guarantee applies in lieu of any other guarantee expressed or implied and variations of its terms are not authorised.

Your Draper guarantee is not effective unless you can produce upon request a dated receipt or invoice to verify your proof of purchase within the guarantee period.

Please note that this guarantee is an additional benefit and does not affect your statutory rights.

Draper Tools Limited.

TECHNICAL DESCRIPTION

IDENTIFICATION

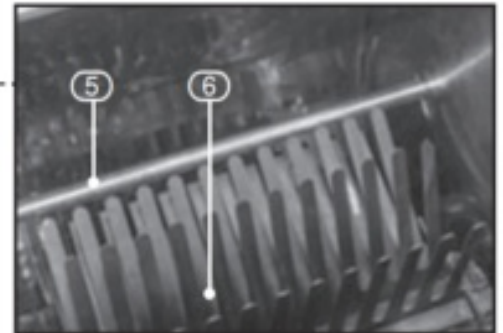
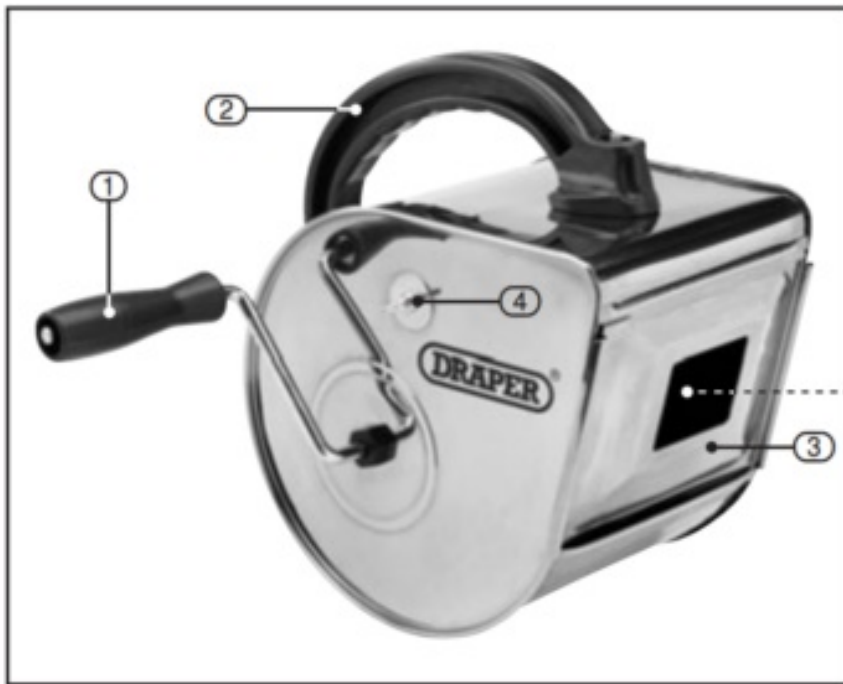

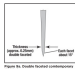
- ① Drive handle.
- ② Carry handle.
- ③ Reducer cover.
-  Texture/pattern control adjuster.
- ⑤ Pressure bar.
- ⑥ Roller.

ASSEMBLY AND OPERATION

INSTALLING THE ROLLER AND DRIVE HANDLE FIGS.1 2

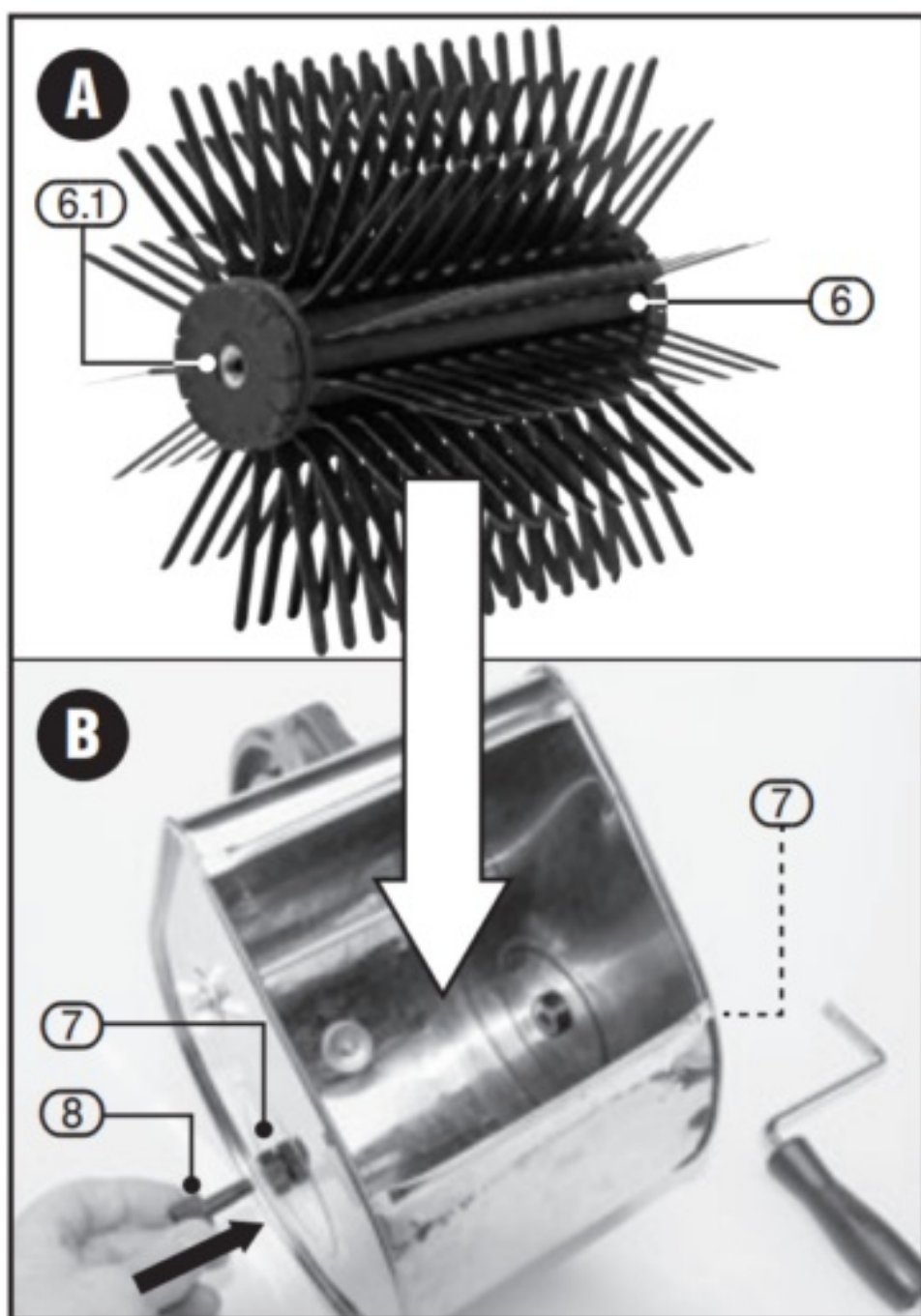

FIG.1

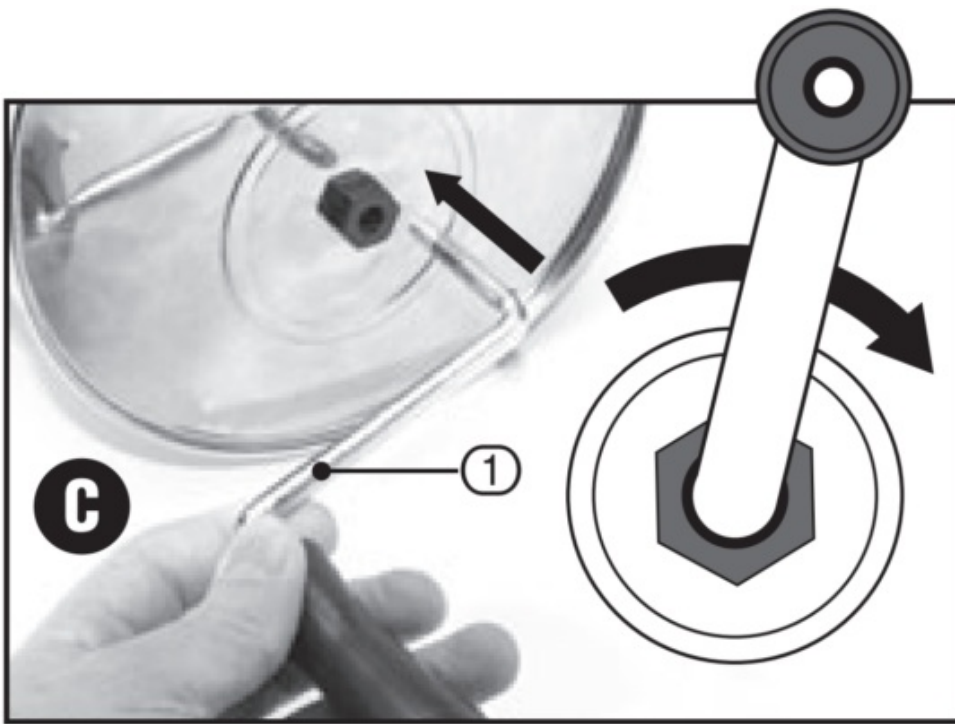

FIG.2

Note: The flicker machine can be set up for the drive handle to be used in right or left-handed operation.

- If not already removed, un-tighten and remove the threaded plastic bolt (8).
- Lightly loosen the 2 plastic nuts (7) located on each side of the machine.
 - A Place the roller inside the housing of the machine.
 - B Line up the roller with the hole in the housing to enable the threaded bolt to be inserted into the threaded aperture in the roller (6.1).
- Tighten the bolt.
 - C Insert the drive handle (1) through the plastic nut (7).
- Wind the drive handle clockwise into the roller to secure the handle in place.
- Re-tighten the 2 plastic nuts (7) to complete.

ADJUSTING THE PATTERN/TEXTURE CONTROL – FIG.3

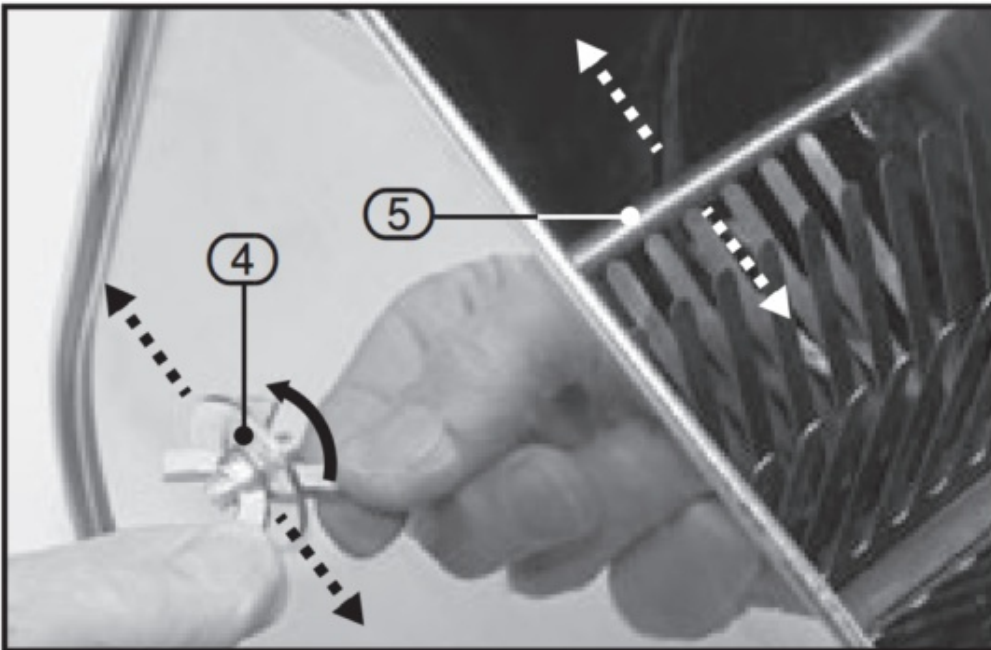
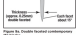

FIG.3

- To increase the pressure on the blades of the roller, unscrew the 2 wing nuts  on either side of the machine housing.
- Sliding the bar (5) lower will incrementally increase the pressure onto the blades.
- The pressure bar can be completely removed from the machine, such as for cleaning etc., by removing the wing nuts/washers.

USING THE REDUCER COVER – FIG.4

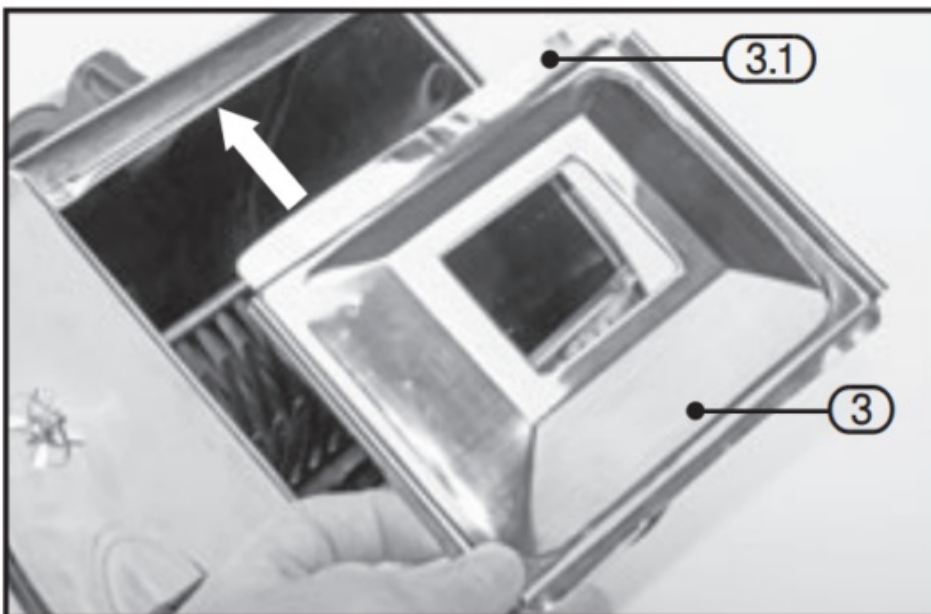

FIG.4

The reducer cover **3** is used for working on small areas, or for re-touch work.
To fix the reducer cover:

- Insert the longer tabbed edge of the cover **3.1** underneath the lip at the top of the unit.
- Push the cover forwards to full extent, then slide the bottom of the cover downwards so that the smaller, tabbed edge fits securely inside.



OPERATION

Droplets of workable cement-rich mortar are flicked onto the work surface by rotating sprung tines located on the horizontal roller. The tines are always partially immersed in the mix.

As a rule, the machine is used in conjunction with manufacturer's pre-prepared mixes. When using such mixes, always follow the manufacturer's supplied guidelines and instructions.

Best results are obtained by using small quantities more frequently. Always use materials within one hour of mixing.

Method of application - 1st layer: Keeping a minimum distance of 500mm/20" away from the work surface, allow a full spread of material from the machine (**take special care at this point if working on scaffolding**). Regulate the turning speed of the drive handle to ensure maximum output of material but at the same time obtaining a thin surface covering.

Following layers: Incrementally build up the texture over the initial 'thin' covering. The turning speed of the drive handle can be reduced slightly, allowing for increased pick up of material. Move closer to the work area as the turning speed is reduced.

Keeping the handle turning, continue building up the textured finish. A total thickness of 6-8mm/ 1/4" - 5/16" will give the optimum 'honeycombed' finish.

MAINTENANCE

It is vital that the machine is thoroughly washed and cleaned during any break in the work and also at the end of the working session.

Follow the previous assembly instructions in reverse to disassemble the machine for cleaning and storage.

Replacement consumable parts listed below can be obtained for this machine through the usual Draper stockists.

Item	Stock No.	Part No.
Replacement roller.	02248	SSTFR

DISPOSAL



- At the end of the machine's working life, or when it can no longer be repaired, ensure that it is disposed of

according to national regulations.

- Contact your local authority for details of collection schemes in your area. In all circumstances:
 - Do not dispose of with domestic waste.
 - Do not incinerate.

CONTACTS

Draper Tools Limited, Hursley Road,
Chandler's Ford, Eastleigh, Hampshire. SO53 1YF. U.K.

Helpline: (023) 8049 4344

Sales Desk: (023) 8049 4333

Internet: drapertools.com

E-mail: sales@drapertools.com

General Enquiries: (023) 8026 6355

Service/Warranty Repair Agent:

For aftersales servicing or warranty repairs, please contact the Draper Tools Helpline for details of an agent in your local area.



©Published by Draper Tools Limited.

No part of this publication may be reproduced, stored in a retrieval system or transmitted in any form or by any means, electronic, mechanical photocopying, recording or otherwise without prior permission in writing from Draper Tools Ltd.

Documents / Resources

	DRAPER 02168 Tyrolean Flicker Machine [pdf] User Manual 02168 Tyrolean Flicker Machine, 02168, Tyrolean Flicker Machine
---	--

References

-  [Draper Tools Official Website | Hand Tools, Power Tools and Accessories](#)
-  [Manuals | Draper Tools](#)