



## Contents [ [hide](#) ]

- [1 Dr Dabber SWITCH2 Induction Heating System](#)
- [2 Specifications](#)
- [3 On/Off](#)
- [4 APP Connection – iOS](#)
- [5 APP Connection – Android](#)
- [6 Change Temperature Setting](#)
- [7 Activate Heating Cycle](#)
- [8 Charging](#)
- [9 Getting Started](#)
- [10 Cleaning Tips](#)
- [11 App Usage](#)
- [12 Device Settings](#)
- [13 Temperature Settings](#)
- [14 Light Modes](#)
- [15 Hold Time](#)
- [16 Device Information](#)
- [17 FAQs](#)
- [18 How do I turn on the Switch2?](#)
  - [18.1 Documents / Resources](#)
    - [18.1.1 References](#)





## Specifications

Feature	Description
Battery	Indicated by 3 LEDs on the back of the device.
Charging	USB-C Charging can be used while charging.
Temperature Settings	Five settings ranging from 400°F to 540°F.

## On/Off

- Slide the switch to the right to turn on.
- Switch<sup>2</sup> has a 5-minute auto shut-off feature. Press any button to wake from sleep mode.
- The 3 LEDs on the back of the device indicate battery level. Pulsing lights indicate less than 10% remaining.

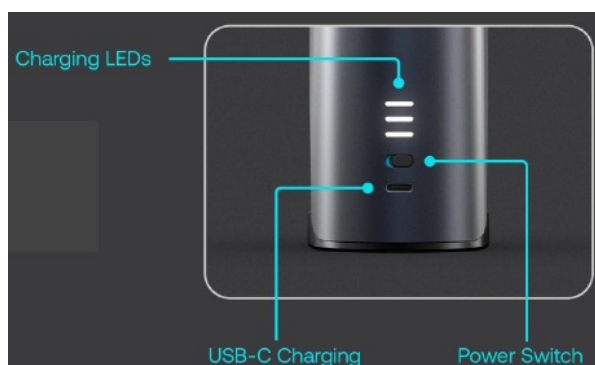

## APP Connection – iOS

1. Download the Lablink Browser from [www.lablinkbrowser.com](http://www.lablinkbrowser.com).
2. Make sure to allow any permission pop-up during this process.
3. Copy the following link and paste it into the LabLink browser to access the web app:  
<https://drdabber.app/>
4. Switch<sup>2</sup> must be powered on and nearby. Press “Launch” then select your device from the list. Perform any necessary firmware updates.

## APP Connection – Android

1. Download the Dr. Dabber Sync app from the Google Play Store.
2. Make sure to allow any permission pop-up during this process.
3. Switch<sup>2</sup> must be powered on and nearby. Press “Launch” then select your device from the list. Perform any necessary firmware updates.

## Change Temperature Setting

Press the + button to increase temperature, and the – button to decrease temperature. The LEDs will change colors to indicate the selected temperature setting.

Setting	Default Temperature (°F)	LED
Setting 1	400	Purple
Setting 2	460	Blue
Setting 3	480	Cyan
Setting 4	500	Orange
Setting 5	540	White

Setting	Default Temperature (°F)	LED
Setting 1	400	 Purple
Setting 2	440	 Blue
 Setting 3	480	 Cyan
Setting 4	500	 Orange
Setting 5	540	 White

 = The Default and Our Recommended Setting

The Default and Our Recommended Setting

## Activate Heating Cycle

- Press the  button once to activate. The LEDs will pulse Red to indicate heating and Green when the Switch<sup>2</sup> reaches the desired temperature.
- The heating cycle can be canceled at any time by pressing the button again.
- 3 white flashes from the LED band indicate a low battery.

## Charging

- To charge, plug the charging cable into the device. The device can be used while charging. LEDs will pulse White while charging and turn solid when fully charged.

## Getting Started

- Use the supplied charger to fully charge your Switch<sup>2</sup>.
- Rest both hands on top of the crown and gently push upwards from the bottom of the glass attachment with your thumbs to remove. Never pull up from the mouthpiece to remove the glass attachment as it can break and cause injury.



- Once the glass attachment is removed from the device, fill the attachment up to the top of the percolator puck with water. Filling lower than this point will affect vapor

quality.

- Gently push the glass attachment back down into place, ensuring that the markings on the attachment and the device are lined up. This will align the glass with the vapor pathway.
- Lift off the magnetic carb cap and load your concentrates into the insert with the supplied Drop Loading tool. It is very important to avoid putting the tip of the loading tool directly in the insert. Hover the loading tool above the insert and click the button to heat the concentrate on the tip and drop it into the insert. Do not scrape the tool on the edge of the insert as the electronics in Switch<sup>2</sup> can be damaged if the battery powered Drop comes in contact with the induction field.
- Place the carb cap back on the insert to seal the induction well.
- Your device is now ready to use! You can either use the +/- buttons on Switch<sup>2</sup> or the app to choose your temperature, then just hit the button to begin the heating cycle.



## Cleaning Tips

- We recommend swabbing your insert with Iso-Swabs or cotton swabs after every use for optimal flavor and longevity.
- If you need to remove the insert for deeper cleaning, remove the glass attachment and set it down on a stable surface, then gently pry off the aluminum insert and clean the induction well. Always use the supplied tweezers to remove the insert and cap it evenly when removing, as both the quartz and the sapphire inserts are very fragile and can break easily.
- Removing the insert is not required for regular maintenance and is only recommended when necessary. NEVER remove the insert when it is hot. Wait for the device to cool down after use before removing it to avoid burns.

- We recommend using 99% isopropyl alcohol to clean the glass attachment. Ensure your attachment is thoroughly rinsed with clean water and refilled before using again.
- Do NOT use isopropyl alcohol on the outer shell of Switch<sup>2</sup> or anywhere on the Blue Onyx finish. If necessary, use a damp paper towel with a small amount of dish soap to wipe down the body, making sure to avoid water entering the charging port.



## App Usage

- Enter the same account details you use on [drdabber.com](https://drdabber.com).
- If you do not already have an account on [drdabber.com](https://drdabber.com), create an account to link your Switch<sup>2</sup>.
- This page will show all information about how you use your Switch<sup>2</sup>.

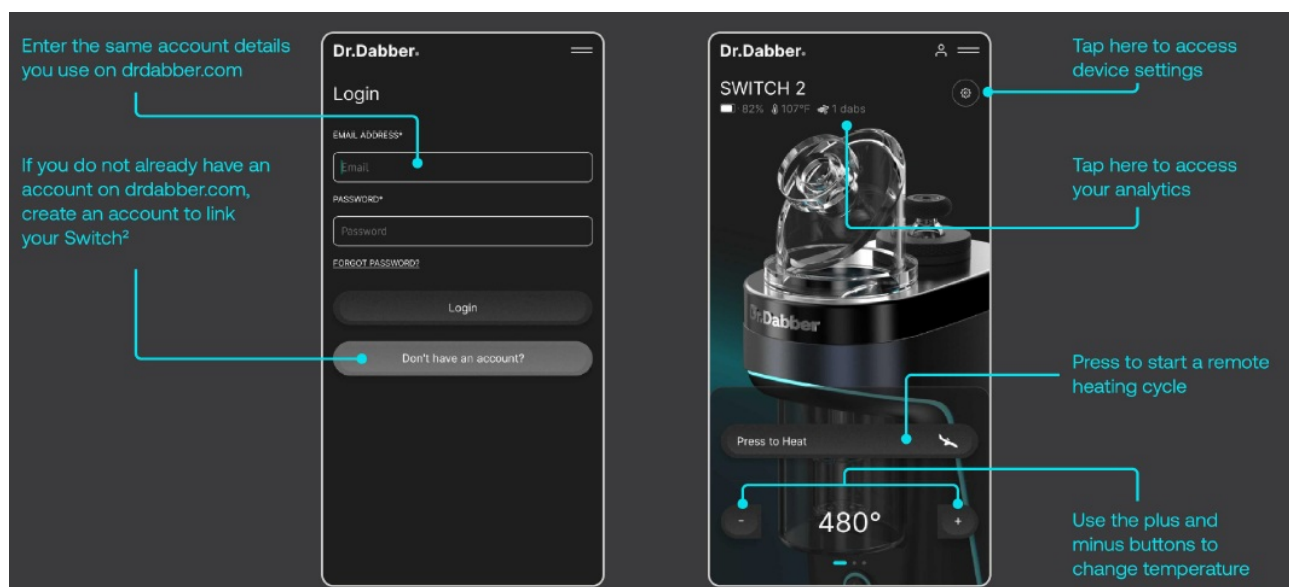

## Device Settings

- Tap here to access device settings.
- Tap here to access your analytics.
- Press to start a remote heating cycle.

- Use the plus and minus buttons to change the temperature.

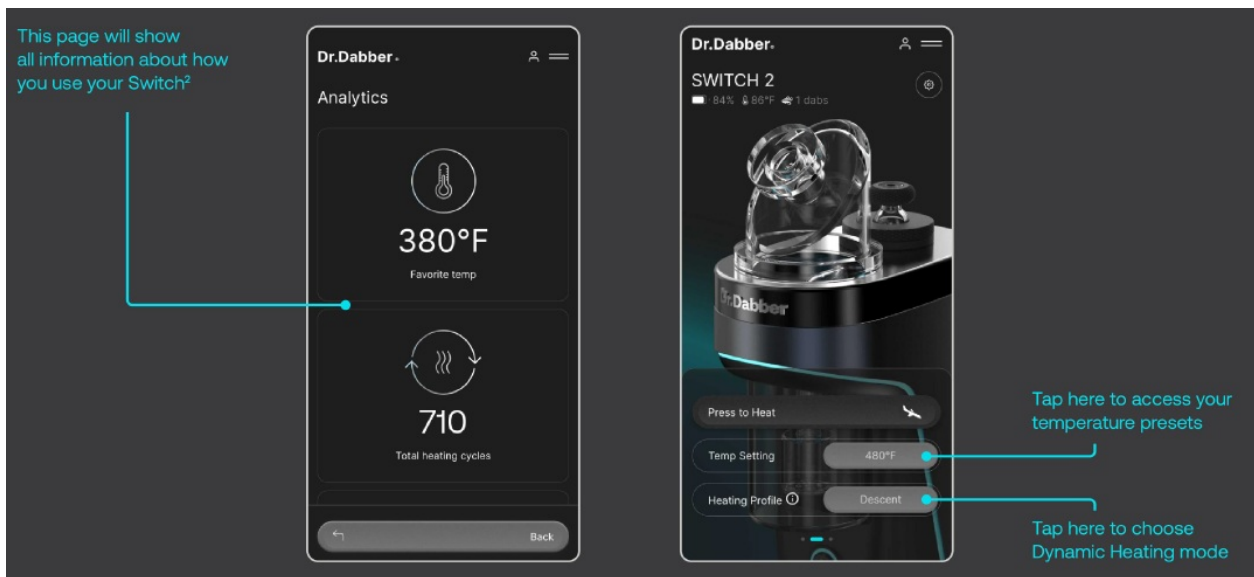

## Temperature Settings

- Tap to select a heating profile.
- Press and hold to customize the heating profile.
- Tap to reset your customized settings to default.
- Tap to generate a code to share your heating profile with friends or to enter a code you have received.
- You can manually enter a temperature by tapping here.
- To customize a temperature preset, swipe left or right to adjust the temperature, then click save.

## Light Modes

- Tap here to access Solid colors.
- Slide left or right to change brightness. Slide to the left to activate the finish mode.
- Tap any theme to change the lights on your Switch².

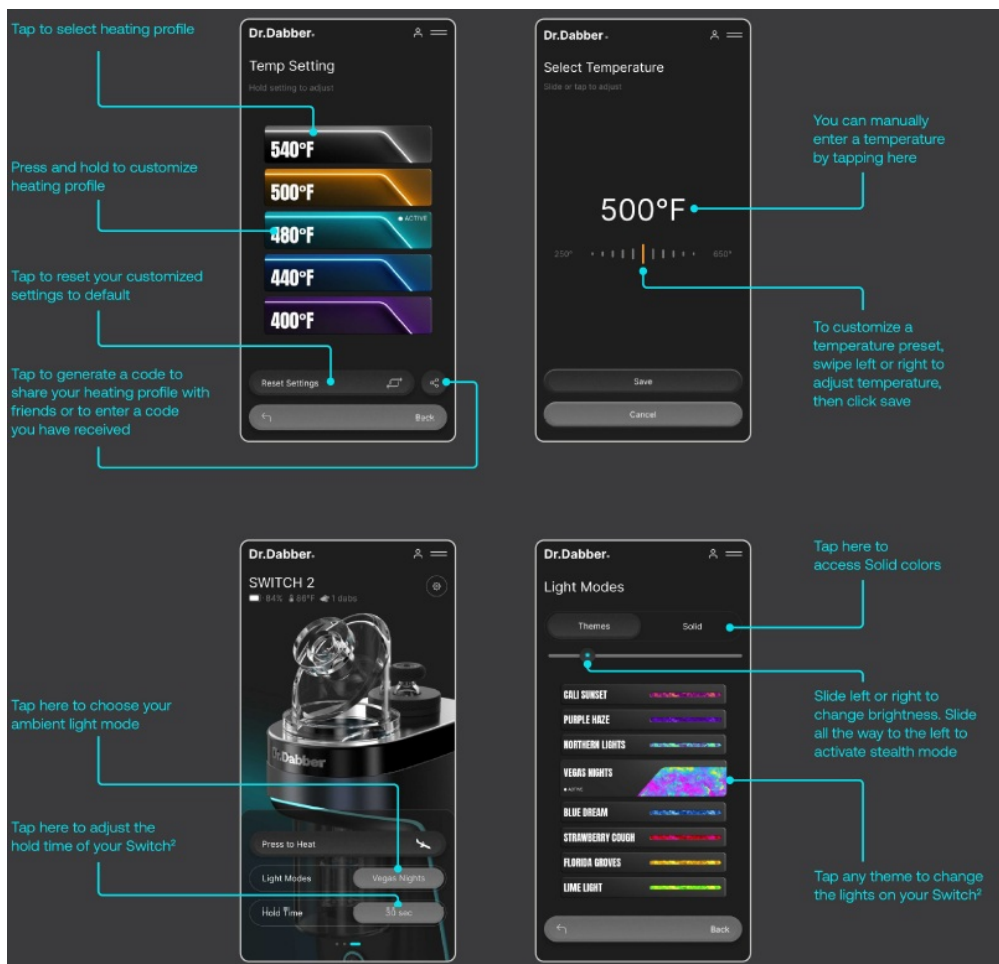

## Hold Time

- Tap to manually enter hold time.
- Swipe left or right to change hold time.
- Tap to save hold time settings.

## Device Information

- Name your device here.
- See all your device info here.
- Tap to adjust when Switch<sup>2</sup> goes into sleep mode.
- Tap to reset Switch<sup>2</sup> to factory settings.



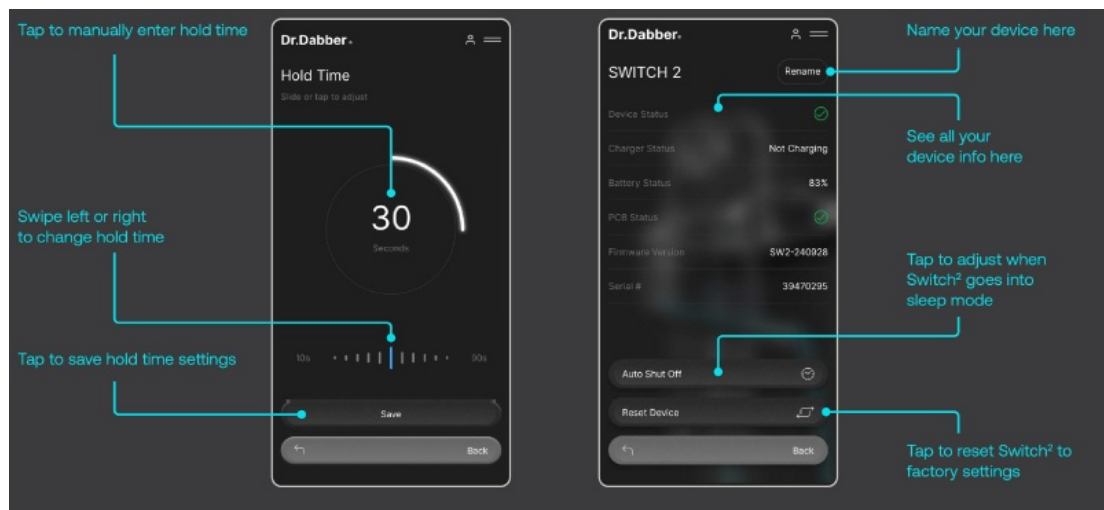

For more information, go to: <https://drdabber-helpscoutdocs.com/article/126-switch2-knowledge-base>.

For more information, go to: [Dr. Dabber Knowledge Base](#)

## FAQS

---

### How do I turn on the Switch2?

Slide the switch to the right to turn on.

### How do I charge the device?

Plug the charging cable into the device. The device can be used while charging.

### How do I connect the app?

Download the Lablink Browser for iOS or Dr. Dabber Sync app for Android and follow the instructions to connect.

### How do I change the temperature?

Press the + or - button to adjust the temperature. The LEDs will change colors to indicate the setting.

# Documents / Resources

	<a href="#">Dr Dabber SWITCH2 Induction Heating System [pdf]</a> Instruction Manual 2BLGB-SWITCH2, 2BLGBSWITCH2, SWITCH2 Induction Heating System , SWITCH2, Induction Heating System, Heating System, System
---	---

## References

- [User Manual](#)

Dr Dabber

2BLGB-SWITCH2, 2BLGBSWITCH2, Dr Dabber, Heating System, Induction Heating System, Switch2, SWITCH2 Induction Heating System, System

---

## Leave a comment

Your email address will not be published. Required fields are marked \*

Comment \*

Name

Email

Website

☐ Save my name, email, and website in this browser for the next time I comment.

**Post Comment**

**Search:**

e.g. whirlpool wrf535swhz

**Search**

[Manuals+](#) | [Upload](#) | [Deep Search](#) | [Privacy Policy](#) | [@manuals.plus](#) | [YouTube](#)

This website is an independent publication and is neither affiliated with nor endorsed by any of the trademark owners. The "Bluetooth®" word mark and logos are registered trademarks owned by Bluetooth SIG, Inc. The "Wi-Fi®" word mark and logos are registered trademarks owned by the Wi-Fi Alliance. Any use of these marks on this website does not imply any affiliation with or endorsement.