

# DPR DN01, DN02, DP03, DP02 Label Dispenser User Manual

[Home](#) » [DPR](#) » DPR DN01, DN02, DP03, DP02 Label Dispenser User Manual 



**USER MANUAL**  
**Label dispenser**  
**DN01 – DN02 – DP03 – DP02**



Please keep the original packaging in case you need to return the unit.  
If we receive the system in non-original packaging, the warranty may be void.

## Contents

- [1 CHARACTERISTICS](#)
- [2 PROGRAMMING](#)
- [3 SENSOR CALIBRATION](#)
- [4 SMART SOLUTIONS FOR THE LABELING INDUSTRY](#)
- [5 Documents / Resources](#)
- [6 Related Posts](#)

## CHARACTERISTICS

### Electrical Characteristics

- External power supply with 220/18VAC transformer

- Fuse protection 2A

## Electronic Characteristics

- Photocell to detect label presence
- Tachometer to control the label length
- Display with 2 lines of 16 characters

## Electrical Characteristics

- Personalization of company name
- Photocell function control
- Programmable quantity of labels to detach from 0 to 999
- Continual display of the detached label quantity
- Continual display of the number of detached label series
- Programmable length of the detached part of the label
- Three different feed types
- An acoustic alarm sounds when the number of label series reaches the programmed quantity
- Programmable series from 2 to 3 labels of different lengths

## Mechanical Characteristics

- Maximum dimensions DN01 and DN02: W=330mm (12.99"); H=240mm (9.45"); D=410mm (16.14") DP02: W=320mm (12.60"); H=210mm (8.26"); D=260mm (10.24") DP03: W=240mm; H=210mm (8.26"); D=260mm (10.24")
- Speed 120 rpm
- Roll diameter up to 300mm (11.81") (DN01 – DN02) or 200mm (7.87") (DP02 – DP03)
- Core holder from 30mm (1.18")
- Label width up to 70mm (2.75") (DP03), 150mm (5.90") (DN01 – DP02), or 210mm (8.26") (DN02)
- Table to write on the label if required before removal
- Mechanical regulation of the clutch

## PROGRAMMING

### Exiting Menu

### IMPORTANT



To exit at any moment from the programming mode and implement an alarm reset, push this button.

When first switched on the panel will display the following: 

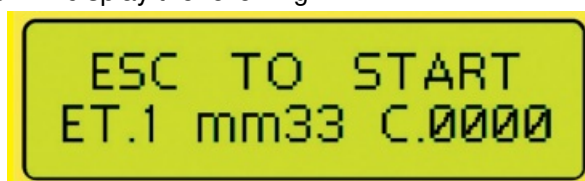

## Enable First Menu



Push this button to enter into the program mode and the panel will indicate that you wish to detach one series label at a time.

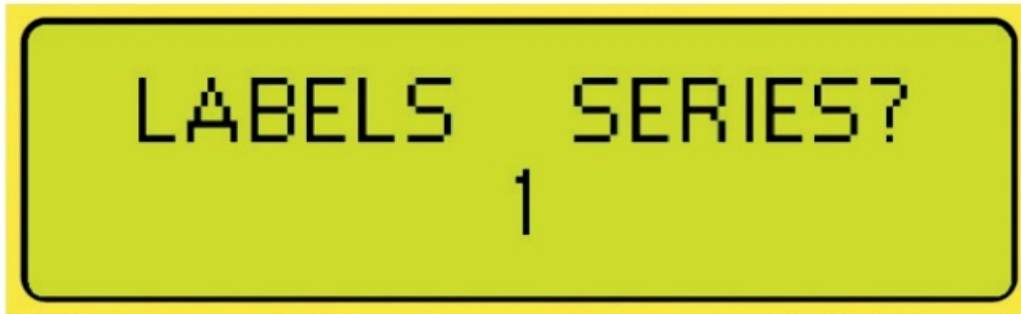

Push this button again if you don't want to select the series type and set the detached label length.



By successively pushing these buttons you can change the series from 1 to 3 labels. Even if they are of different sizes but are part of a single series the panel will display it:



Having established the type of series to use, when pushing these buttons for each type of label, it is possible to modify the length of the label section that needs to be detached for every single label. The panel will then display the following three types of messages.

PROG. ETICHETTA 1  
mm. 34

PROG. ETICHETTA 2  
mm. 18

PROG. ETICHETTA 3  
mm. 28

#### Enable Second Menu



By successfully pushing these buttons you can choose three different feed types.

FEED TYPE  
TEMPORIZED

FEED TYPE  
AUTOMATIC

FEED TYPE  
MANUAL

#### > Temporized feed

This option allows the user to define the detach delay time from 1 to 60 seconds between labels.  
To run this option please follow the next operation.

FEED TYPE  
TEMPORIZED



By successively pushing this button you enter the setting seconds menu.

PROGRAM. TIMER  
SEC. XX



By successfully pushing these buttons you can select the detach delay time from 1 to 60 seconds between labels.

Example: In this case, you can detach a label every 15 seconds.



#### Automatic feed

This function dispenses the labels automatically.

#### > Manual feed



This function dispenses the label only if you push the ESC button or the pedal (optional accessory).

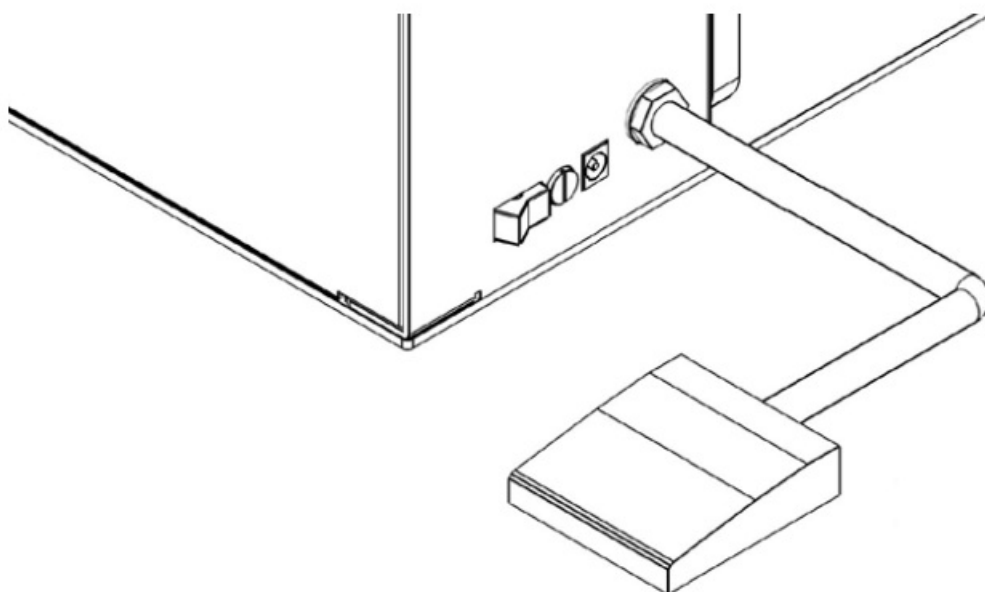

#### IMPORTANT

In both cases, the dispenser will be stopped if the counter function is active and you reach the set number of labels.

#### Enable Third Menu



By successfully pushing this button you can select the counter function that presets the number of labels to detach. The panel will then display the following two types of messages.

ACTIVE COUNTER  
YES

ACTIVE COUNTER  
NO



Push this button to choose between having the counter function on or off.

When selecting “**ACTIVE COUNTER YES**” you can define the number of labels to detach and the panel will display the sequential counter with the option to select from 1 to 9999 labels or a series of labels to detach.

LABEL QUANTITY  
0001

LABEL QUANTITY  
9999



By pushing these buttons you can select the 4 digits of the counter one at a time.



Once selected, the digit to be modified can be changed between a value from 0 to 9.

#### IMPORTANT



To ensure that the detached labels correspond to the number selected under the active counter menu YOU

MUST push this button for a few seconds to reset the counter.

ESC TO START  
ET.1 mm33 C.0000



#### IMPORTANT

With the manual function, Automatic feed ON, the counter reset will display “0001” because the first label available for detachment will be displayed.

ESC TO START  
L.1 mm15 C.0001

#### NOTE:



During operation, once the last label that was programmed detaches the dispenser will stop and emit an acoustic warning signal. To turn off the alarm and reset the counter push this button.

When selecting “**ACTIVE COUNTER NO**” the counter is disabled and the labels can be detached with undefined quantities.





#### Enable Fourth Menu

**PROGR** By successfully pushing this button you can enable the function that allows the customers' name to appear on the display.



**<<** **>>** By pushing these buttons you can select the 16 digits of the counter one after another in order to insert the required text.

**M** **000** Having selected the digit to program with these buttons, you can change the value with letters, numbers, and symbols.

**PROGR** By successfully pushing this button you enable the control of the sensor functions for label presence. All of the digits will be on, as shown below with the functioning sensors, not in use.

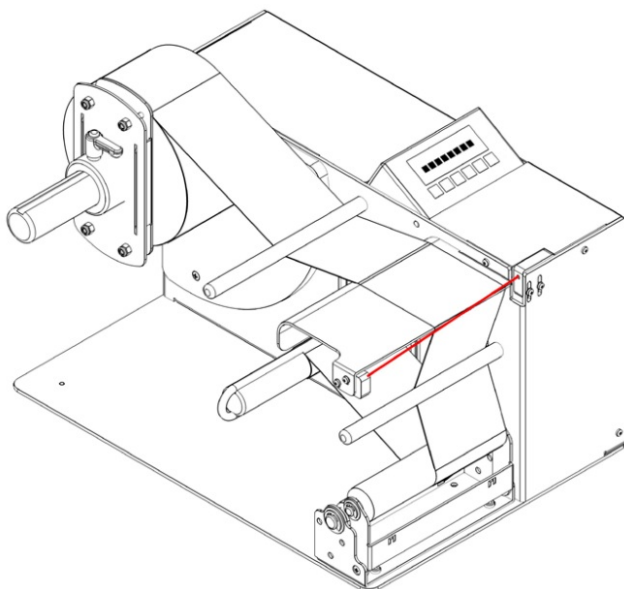

By covering the sensor next to the panel with a finger, the digits turn off. As shown in the following demonstrates the use of the sensors by the label.

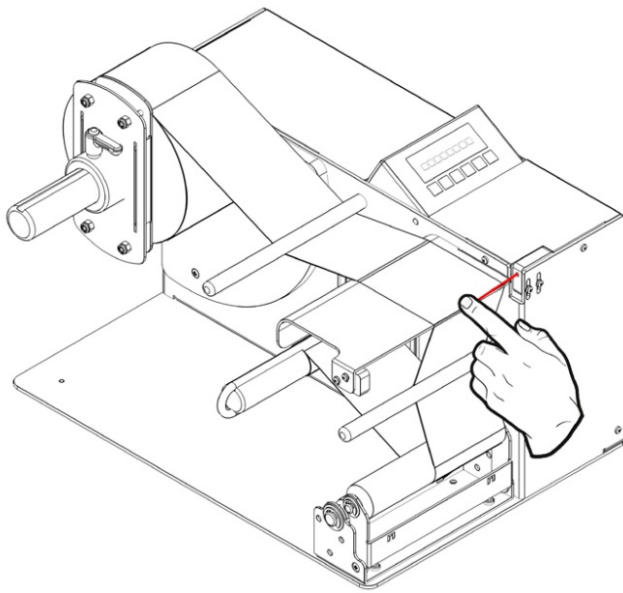

### MOTOR MANUAL ADVANCE



Press this key for manual advance of the motor.

### COUNTER ZERO SETTING



Press this key for 4 seconds to reset the counter to 0. When reset the dispenser will emit a sound.

### ROLL LOAD ON THE DISPENSER

Load the roll of labels on the hub. Tighten the roll by attaching the plate. The tighter the plate the more tension is applied to the roll.

**Note:** If during standard operation more than one label is detached pls increase the pressure on the plate springs.

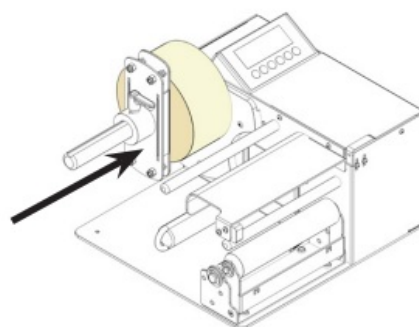
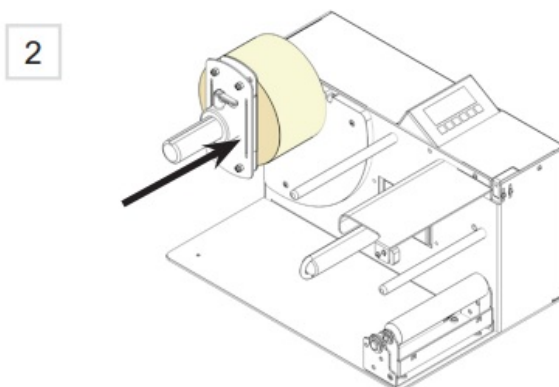
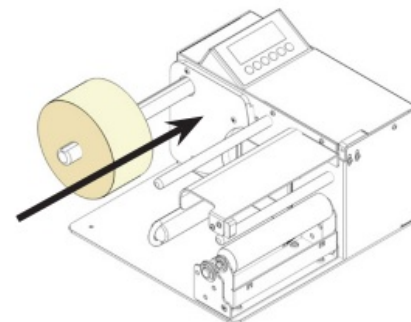
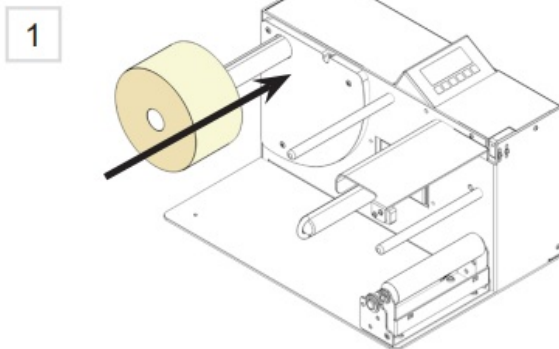

*DN01 and DN02*

*DP02 and DP03*

Follow the loading procedure as seen below:



Open the drag roller and pass the backing through the rollers.

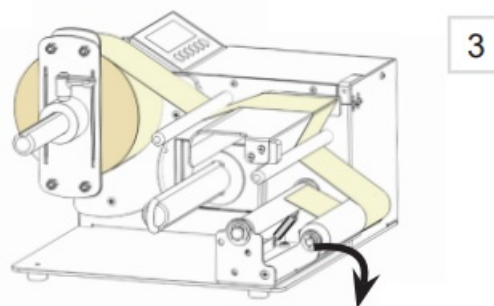
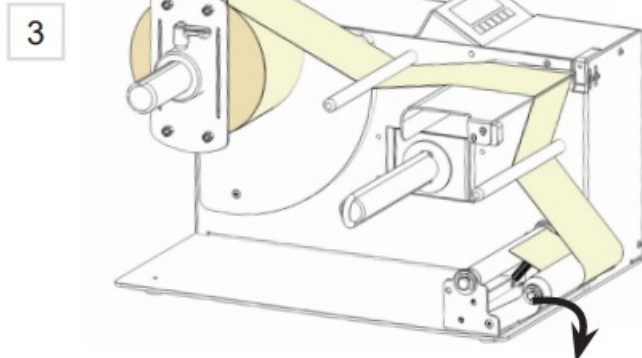

Block the backing with the fork on the recovery roller. Close the drag roller.

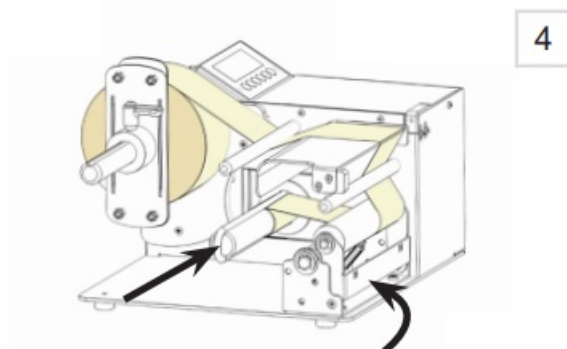
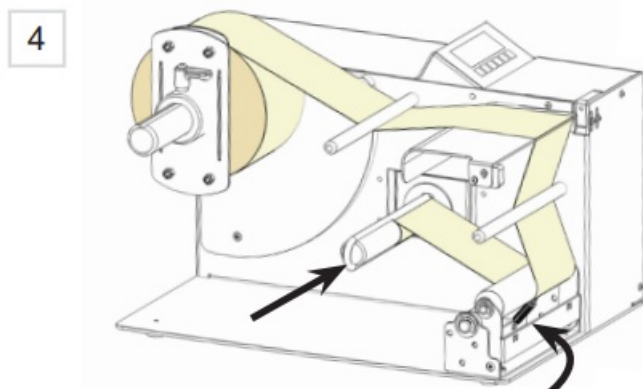

Push the displayed button to roll up the backing on the recovery roll.

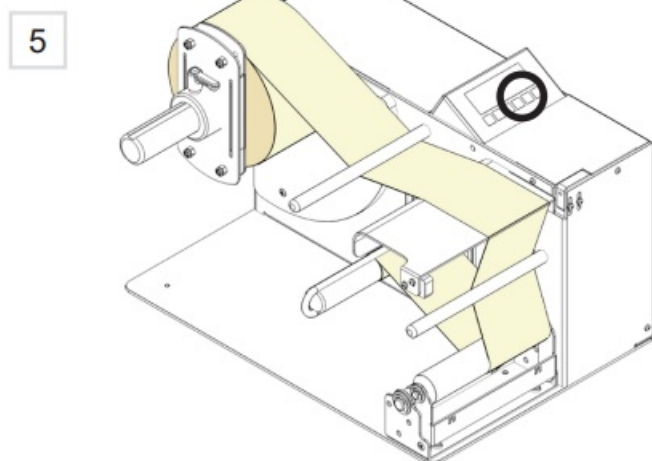

*DN01 and DN02*

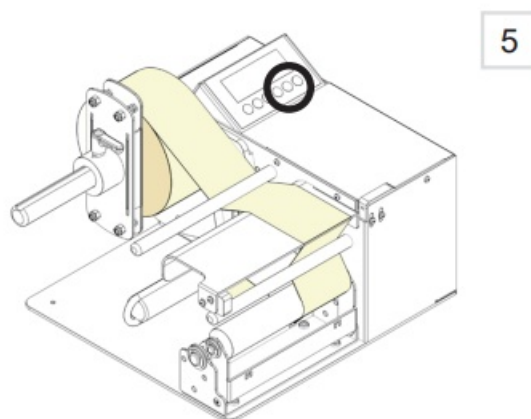

*DP02 and DP03*

## SENSOR CALIBRATION

### IMPORTANT



The device is calibrated in our lab, please do the following operations only if necessary. Without any label between the sensors, the digits on the display must be black.

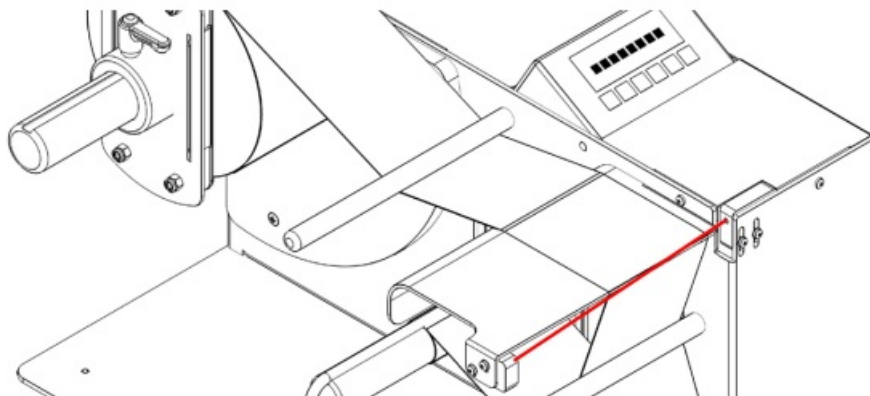

Put a label away from the plate 20mm, the digits on the display should be white; if not pls unscrew sensor 2 and move it up or down to obtain this condition then tighten the screws.

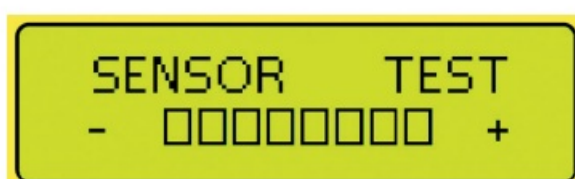
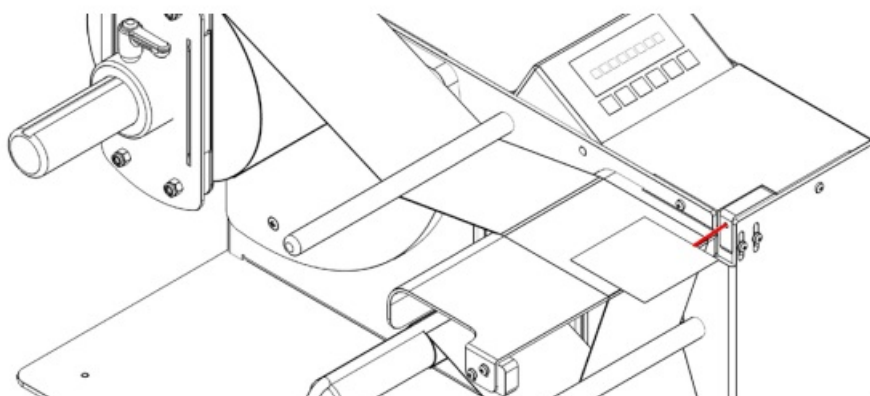

## SMART SOLUTIONS FOR THE LABELING INDUSTRY

Label rewinder

## OTHER PRODUCTS



LABEL UNWINDER/REWINDER

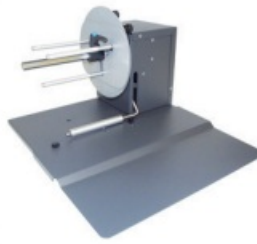

SMALL LABEL  
UNWINDER/REWINDER



LABEL COUNTER



ROLL TO ROLL SYSTEM  
FOR LABEL PRINTERS



ROLL TO ROLL SYSTEM  
FOR EPSON PRINTERS



ROLL TO ROLL SYSTEM  
FOR VipCOLOR VP SERIES



ROLL TO ROLL SYSTEM  
FOR PRIMERA LX SERIES



MATRIX REMOVER AND SLITTER

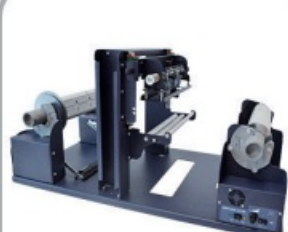

LONGITUDINAL LABEL SLITTER



EASY LABEL DISPENSER



ELECTRONIC  
LABEL DISPENSER



SCORPIO SERIES:  
DIGITAL LABEL FINISHING SYSTEMS



GEMINI:  
DIGITAL DIE CUTTER FOR SHEETS



VIRGO:  
DESKTOP DIGITAL FINISHING SYSTEM



MOTORIZED CORE HOLDER  
UNWINDER/REWINDER

– FOR MORE INFO CONTACT YOUR RESELLER –

# DPR

Documents / Resources

	<p><a href="#">DPR DN01, DN02, DP03, DP02 Label Dispenser</a> [pdf] User Manual DN01, DN02, DP03, DP02, Label Dispenser, Dispenser</p>
--	--