



DOSS FreeTalk Bluetooth Speaker with Flexible Stand User Manual

[Home](#) » [Doss](#) » DOSS FreeTalk Bluetooth Speaker with Flexible Stand User Manual 

Contents

- [1 DOSS FreeTalk Bluetooth Speaker with Flexible Stand](#)
- [2 Introduction](#)
- [3 Specification](#)
- [4 Illustration](#)
- [5 Buttons and Control](#)
- [6 Preparation](#)
- [7 FCC Statement](#)
- [8 Documents / Resources](#)
 - [8.1 References](#)
- [9 Related Posts](#)

DOSS

DOSS FreeTalk Bluetooth Speaker with Flexible Stand



Introduction

Thanks for purchasing the DOSS FreeTalk, the Bluetooth Speaker. We advise you to read, and follow and keep the following Instructions to be able to correctly set up the speaker and enjoy all of its features to the fullest.

Packing Content:

- 1 x DOSS Bluetooth Speaker
- 1 x Micro USB-C Charging Cable
- 1 x User Manual



Specification

- Input: DC 5V 2A 9V 2A 12V 1.5A
- Battery: Li-ion 3.7V 1500mAh
- Charging time: 3 hours
- TalkTime: 16 hours
- Unit dimension: 5.8 x 5.6 x 1.3 inches
- Bluetooth version: V5.3
- Operating distance: $\leq 10\text{M}$, 33ft
- Warranty: One-year limited

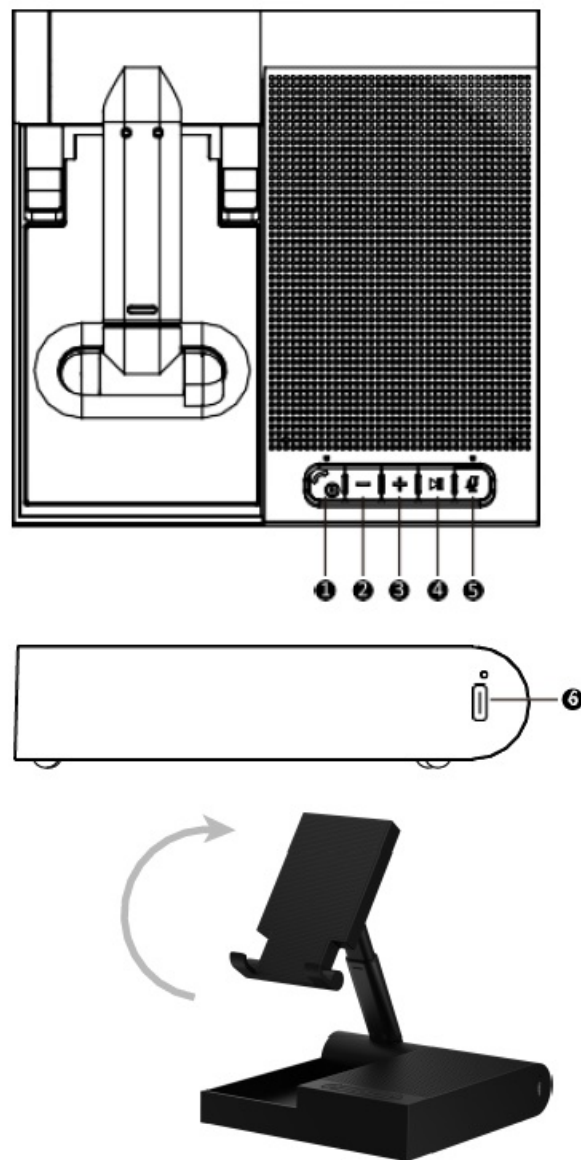

Illustration



Buttons and Control

NO.	Buttons	You want to	How to
1		Turn on/off Reject a call Answer/ end a call	Press and hold for 3 seconds Press and hold for 2 seconds Press
2		Volume down Go to previous track	Press Press and hold
3		Volume up Skip to next trap	Press Press and hold
4		Play/Pause Disconnect Reconnect	Press Press and hold for 3 seconds Press
5		Mic on/off	Press
6		Charge the speaker	Insert the charging cable

Indicators

Indicator view	Indicator state	System state
	Flashing blue Solid blue off	Bluetooth pairing Bluetoothmode/USB-Cmode Power off
	Solid red off	Charging Fully charged

Preparation

Use the supplied USB-C cable to charge your speaker directly from the cell phone adapter (please make sure its output is 5V 2A). Make sure that the speaker is fully charged before using it for the first time. The charging indicator will remain RED when charging and be OFF once fully charged.

Pairing your device via Bluetooth

Power on your speaker, and then turn on Bluetooth on your device to choose DOSS FreeTalk in the list. If the pairing succeeds, the Bluetooth indicator light will go solid blue with a clear prompt tone.

Wireless charging

When the speaker is using the charger to take charge, your mobile phone will be wireless charged by placing it on the phone holder.

Note: You can pair your computer with the speaker via using a USB-C cable. The speaker will auto turn off after 10 minutes without any device connection. If your device cannot discover the DOSS FreeTalk, please long press the play/pause button and try to pair again.

Warning

- DO NOT drop, hit or shake the speaker.
- DO NOT disassemble, repair or modify the speaker by yourself.
- DO NOT use cleaning products that contain benzene, solvents or alcohol.
- DO NOT expose the speaker to excessive heat or direct sunlight for a long time.
- DO NOT store the speaker in a place with humidity or dust.
- DO NOT place heavy objects on top of the speaker.
- DO NOT use the speaker near a microwave oven or wireless LAN products.

FCC Statement

This equipment has been tested and found to comply with the limits for a Class B digital device, pursuant to part 15 of the FCC Rules. These limits are designed to provide reasonable protection against harmful interference in a residential installation. This equipment generates, uses and can radiate radio frequency energy and, if not installed

and used in accordance with the instructions, may cause harmful interference to radio communications. However, there is no guarantee that interference will not occur in a particular installation. If this equipment does cause harmful interference to radio or television reception which can be determined by turning the equipment off and on, the user is encouraged to try to correct the interference by one or more of the following measures:

- Reorient or relocate the receiving antenna.
- Increase the separation between the equipment and receiver.
- Connect the equipment into an outlet on a circuit different from that to which the receiver is connected.
- Consult the dealer or an experienced radio/TV technician for help.
- **Caution:** Any changes or modifications to this device not explicitly approved by manufacturer could void your authority to operate this equipment. This device complies with part 15 of the FCC Rules. Operation is subject to the following two conditions:
 1. This device may not cause harmful interference, and
 2. this device must accept any interference received, including interference that may cause undesired operation.

RF Exposure Information

The device has been evaluated to meet general RF exposure requirement. The device can be used in portable exposure condition without restriction.

ISED Statement

This device contains licence-exempt transmitter(s)/receiver(s) that comply with Innovation, Science and Economic Development Canada's licence-exempt RSS(s). Operation is subject to the following two conditions:

1. This device may not cause interference.
2. This device must accept any interference, including interference that may cause undesired operation of the device. This equipment should be installed and operated with a minimum distance of 20 cm between the radiator and your body.

Contact:

www.dossaudio.com

1-[833-275-3677](tel:833-275-3677) Mon-Fri 9AM-5PMPT (USA)

Documents / Resources

	<p>DOSS FreeTalk Bluetooth Speaker with Flexible Stand [pdf] User Manual FreeTalk Bluetooth Speaker with Flexible Stand, FreeTalk, Bluetooth Speaker with Flexible Stand, Speaker with Flexible Stand, Flexible Stand, Stand, Speaker</p>
---	---

References

- [User Manual](#)

This website is an independent publication and is neither affiliated with nor endorsed by any of the trademark owners. The "Bluetooth®" word mark and logos are registered trademarks owned by Bluetooth SIG, Inc. The "Wi-Fi®" word mark and logos are registered trademarks owned by the Wi-Fi Alliance. Any use of these marks on this website does not imply any affiliation with or endorsement.