



DOSATRON PJD1122V 14 GPM Viscous Injection Seal Kit Instructions

[Home](#) » [DOSATRON](#) » DOSATRON PJD1122V 14 GPM Viscous Injection Seal Kit Instructions 



An Ingersoll Rand Business

**PJD1122V 14 GPM Viscous Injection Seal Kit
Instructions**



Part # PJD1122V
D14TMZ10 – 14 GPM
Viscous Injection
Seal Kit

This kit contains:

(1) JDI123	Plunger seal
(1) JDI122	Injection stem o-ring
(1) JDI100	Sleeve o-ring
(1) PJD1118V	Check valve assembly

Contents

- [1 Kit Contents:](#)
- [2 Instructions](#)
- [3 Documents / Resources](#)
- [4 Related Posts](#)

Kit Contents:

PJDI118V: Check valve assembly



JDI100: Sleeve o-ring



JDI122: Injection stem o-ring



JDI123: Plunger seal



We recommend cleaning all parts with warm soapy water and a toothbrush before installing the new parts.

Water normally lubricates the parts, but you may use silicone on the o-ring to facilitate insertion.

Check valve may be taken apart and cleaned in between maintenance to remove particles.



CAUTION: Parts may contain concentrated chemicals. The use of Proper Protective Equipment is recommended when performing maintenance.

Instructions

(Parts included in kit noted in blue)

1. Unscrew injection stem assembly nut (PDI702) and set aside. Pull down on stem to detach from body of unit. Remove the hose clamp (20M046).

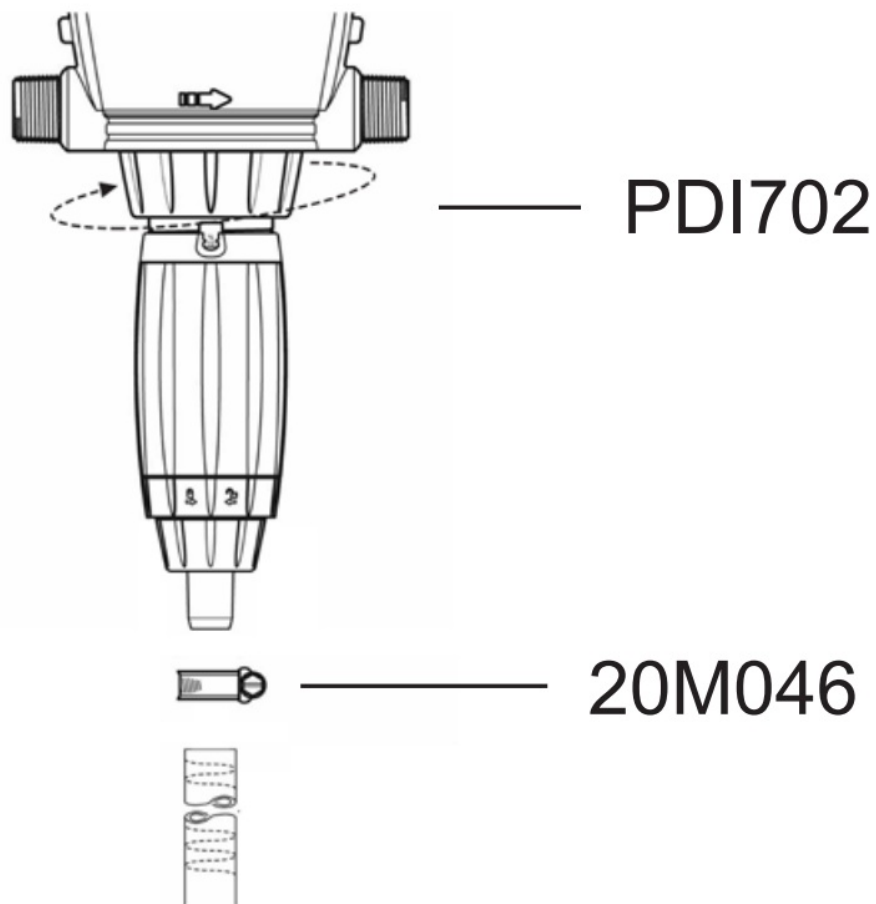

2. Unscrew check valve nut (PDI747) and pull out check valve assembly (PJD118V). It will come out in one piece. Discard.

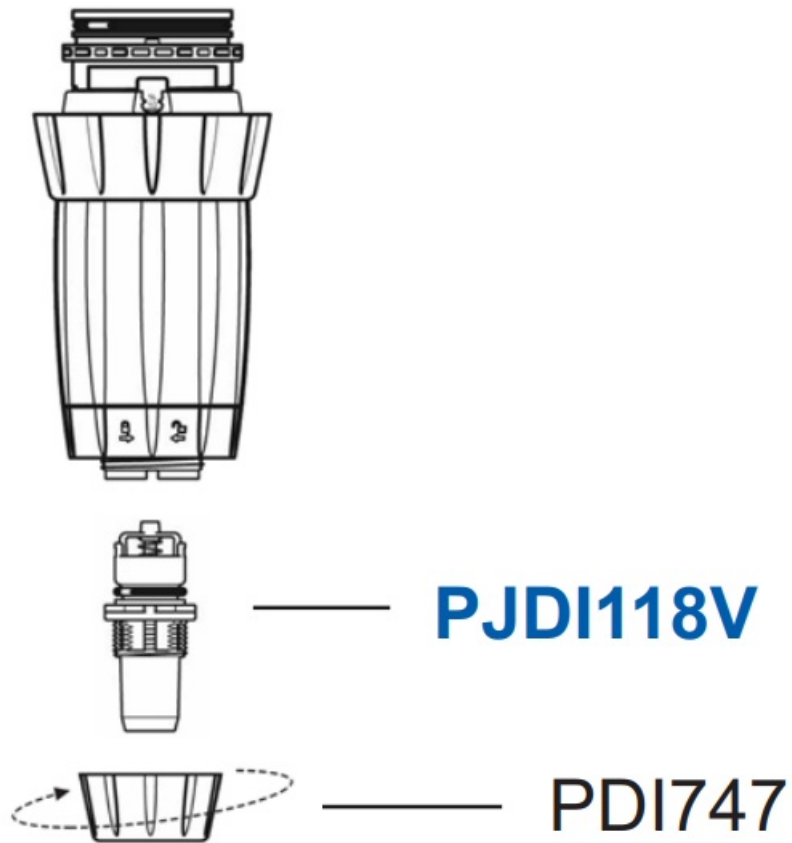

3. Unscrew locking nut (PDI746), remove “C” clamp (PDI751) by slightly spreading the opening and gently sliding it down over the threads. Unscrew adjusting sleeve (PPDI037). Holding the sleeve (PDI741), push up on the threaded part of the injection stem (PDI743) and slide it out of the sleeve from the top. Replace both sleeve and injection stem o-rings (JDI100 and JDI122).



To remove o-ring easily without tools, squeeze it on either side to raise the seal, then slide it over the groove

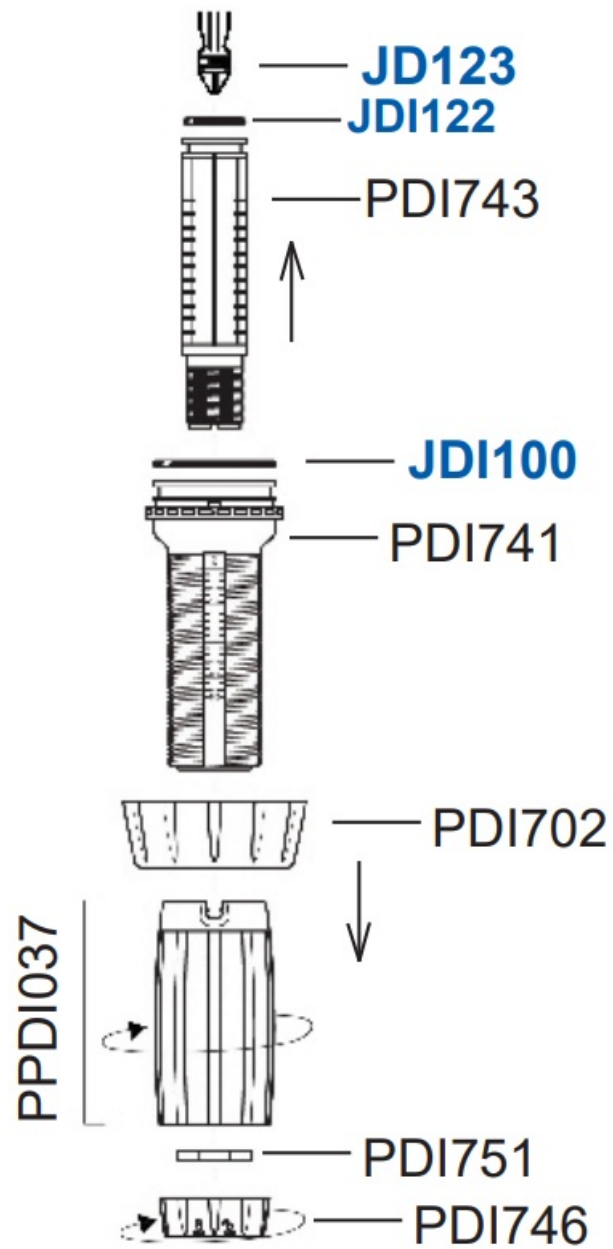

4. Remove and replace plunger seal (JDI123), using same method as above.

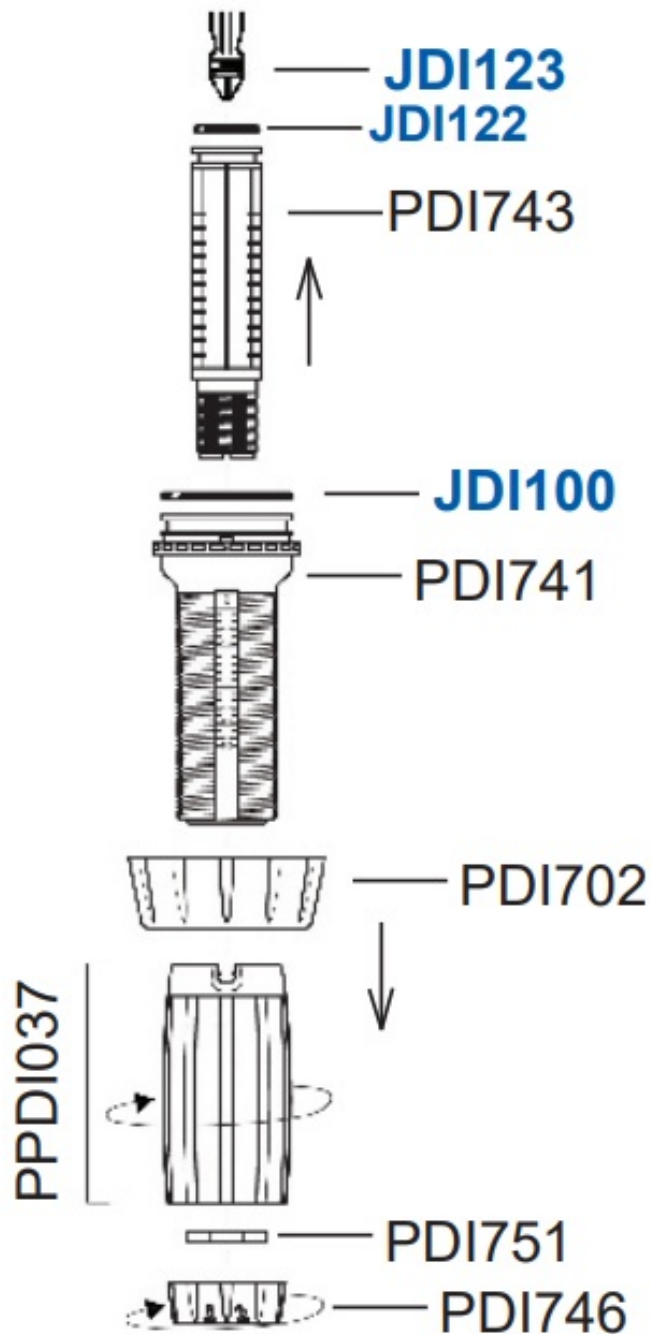

Using tools could damage the plunger and affect the injection rate

5. Slide the injection stem (PDI743) down into the sleeve (PDI741), making sure the small key located on the bottom inside of the sleeve is properly aligned with the longest groove on the white stem. Holding the black sleeve, pull down on the white stem as far as it will go. Screw adjusting sleeve (PPDI037) back onto the sleeve (PDI741).

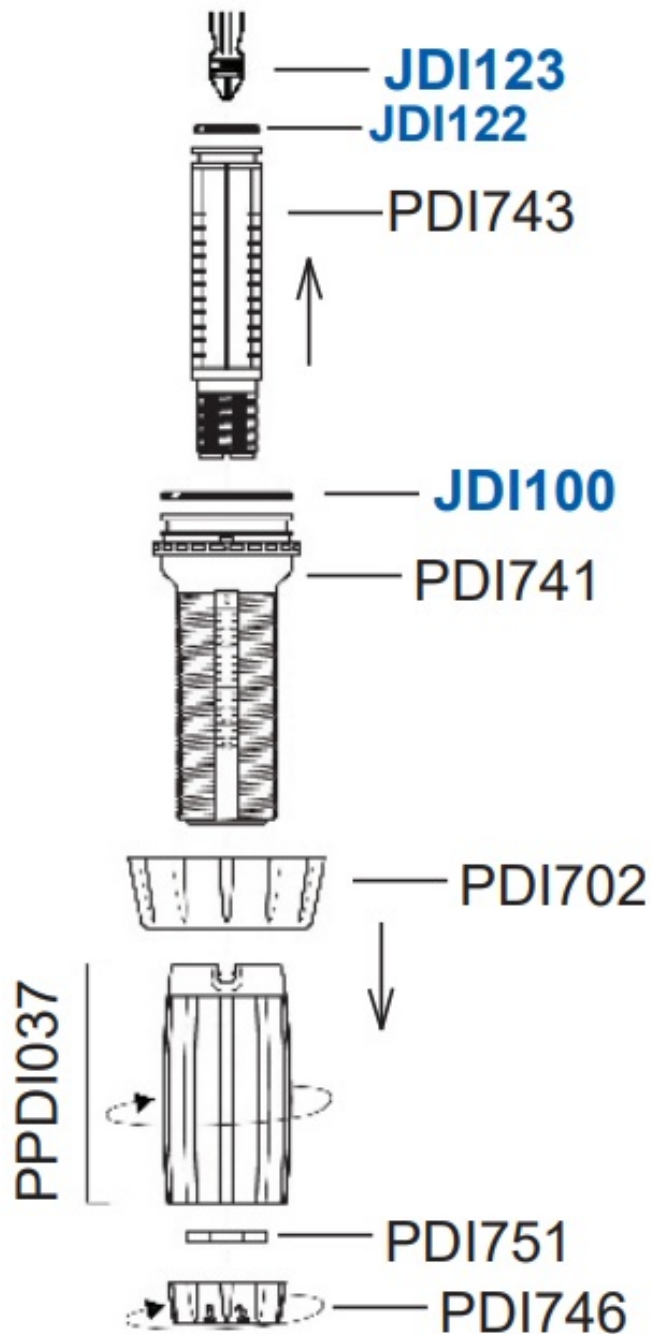

Reinstall “C” clamp by sliding it gently over the thread at the bottom of the white stem. Rotate clamp until it clicks into place. Screw locking nut (PDI746) back on.

6. Insert new check valve (PDI118V) at the bottom of the stem, making sure that the 4 white keys on the check valve seat next to the 4 black keys on the bottom of the stem. Screw check valve nut (PDI747) back on.

PJDI118V

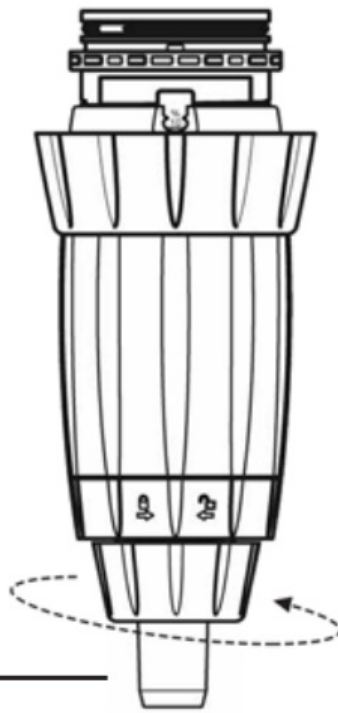

PDI747

7. Push injection stem assembly in position at the bottom of the blue body, making sure desired scale is facing front of injector. Screw injection stem nut (PDI702). Insert hose onto the bottom of the check valve barb Attach the clamp (20M046).

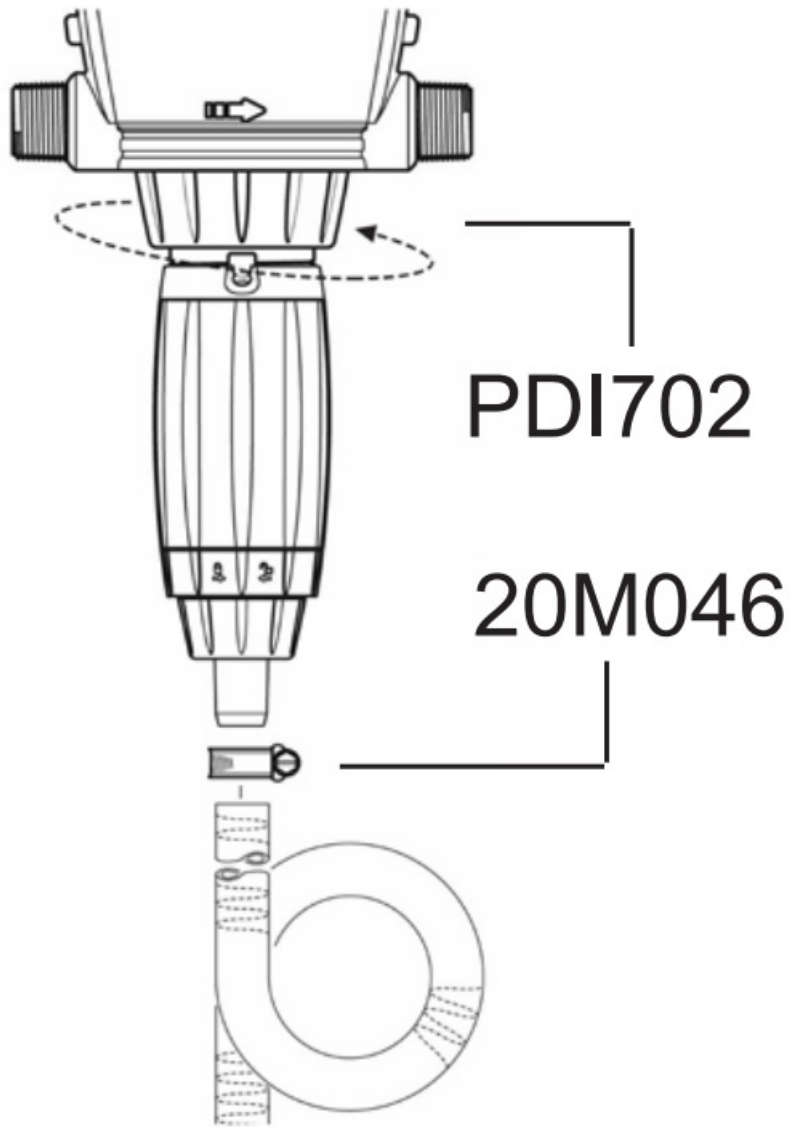

To ensure hose is air-tight, you may choose to carefully cut the top of hose before reinserting.



DOSATRON®

An Ingersoll Rand Business

Documents / Resources

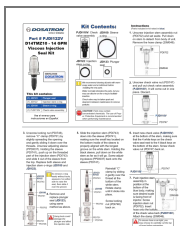

[DOSATRON PDI122V 14 GPM Viscous Injection Seal Kit](#) [pdf] Instructions
 PDI122V, 14 GPM Viscous Injection Seal Kit, Injection Seal Kit, 14 GPM Viscous Seal Kit, Seal
 Kit, Injection Seal, Seal