



DOSATRON D14TMZ10 14 GPM Injection Seal Kit Instruction Manual

[Home](#) » [DOSATRON](#) » DOSATRON D14TMZ10 14 GPM Injection Seal Kit Instruction Manual 

Contents

- [1 DOSATRON D14TMZ10 14 GPM Injection Seal Kit](#)
- [2 Product Information](#)
- [3 Product Usage Instructions](#)
- [4 Kit Contents](#)
- [5 Instructions](#)
- [6 Documents / Resources](#)
- [7 Related Posts](#)



DOSATRON D14TMZ10 14 GPM Injection Seal Kit



Product Information

The PDI122 D14TMZ10 – 14 GPM Injection Seal Kit is a maintenance kit for a unit that injects concentrated chemicals. The kit includes a plunger seal, injection stem o-ring, sleeve o-ring, check valve assembly, and sleeve valve assembly o-ring. The kit is designed to replace worn or damaged parts to ensure the proper functioning of the unit.

Product Usage Instructions

1. Unscrew the injection stem assembly nut (PDI702) and set it aside. Pull down on stem to detach it from the body of the unit. Unscrew hose nut (PDI748).
2. We recommend cleaning all parts with warm soapy water and a toothbrush before installing the new parts. Water normally lubricates the parts, but you may use silicone on the o-ring to facilitate insertion. Check valve

may be taken apart and cleaned in between maintenance to remove particles. CAUTION: Parts may contain STOP concentrated chemicals. The use of Proper Protective Equipment is recommended when performing maintenance.

3. Unscrew the check valve nut (PDI747) and pull out the check valve assembly (PJD1118). It will come out in one piece. Discard.
4. Remove and replace the plunger seal (JDI123), using the same method as step 2.
5. Slide the injection stem (PDI743) down into the sleeve (PDI741), making sure the small key located on the bottom inside of the sleeve is properly aligned with the longest groove on the white stem. Holding the black sleeve, pull down on the white stem as far as it will go. Screw adjusting sleeve (PPDI037) back onto the sleeve (PDI741). Reinstall C clamp by sliding it gently over the thread at the bottom of the white stem. Rotate clamp until it clicks into place. Screw the locking nut (PDI746) back on.
6. Insert a new check valve (PJD1118) at the bottom of the white stem, making sure that the 4 white keys on the check valve seat next to the 4 black keys on the bottom of the stem. Screw check valve nut (PDI747) back on.
7. Push the complete injection stem assembly in position at the bottom of the blue body, making sure the desired scale is facing front of the injector. Keys at the top of the black sleeve should slide into the slots at the bottom of the body. Slide injection stem nut (PDI702) up the sleeve and screw back on. Insert hose back onto the bottom of the check valve barb (PJD1118). Screw the hose nut (PDI748) back on. To ensure hose is airtight, you may choose to carefully cut the top of hose before reinserting.

This kit contains

(1) JDI123	Plunger seal
(1) JDI122	Injection stem o-ring
(1) JDI100	Sleeve o-ring
(1) PJD1118	Check valve assembly

Kit Contents

- **PJD1118:** Check valve assembly
- **JDI100:** Sleeve o-ring



We recommend cleaning all parts with warm soapy water and a toothbrush before installing the new parts. Water normally lubricates the parts, but you may use silicone on the o-ring to facilitate insertion. Check valve may be

taken apart and cleaned in between maintenance to remove particles.

CAUTION: Parts may contain concentrated chemicals. The use of Proper Protective Equipment is recommended when performing maintenance.

Instructions

(Parts included in kit noted in blue)

1. Unscrew injection stem assembly nut (PDI702) and set aside. Pull down on stem to detach from body of unit. Unscrew hose nut (PDI748).

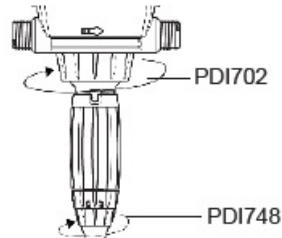

2. Unscrew check valve nut (PDI747) and pull out check valve assembly (PDI118). It will come out in one piece. Discard.

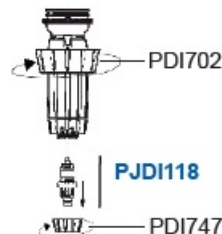

3. Unscrew locking nut (PDI746), remove "C" clamp (PDI751) by slightly spreading the opening and gently sliding it down over the threads. Unscrew the adjusting sleeve (PPDI037). Holding the sleeve (PDI741), push up on the threaded part of the injection stem (PDI743) and slide it out of the sleeve from the top. Replace both sleeve and injection stem o-rings (JDI100 and JDI122).

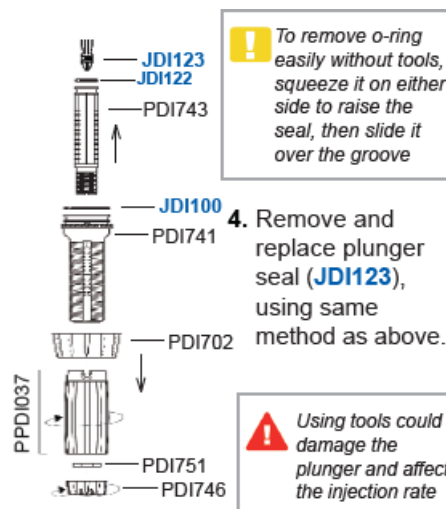

4. Slide the injection stem (PDI743) down into the sleeve (PDI741), making sure the small key located on the bottom inside of the sleeve is properly aligned with the longest groove on the white stem. Holding the black sleeve, pull down on the white stem as far as it will go. Screw adjusting sleeve (PPDI037) back onto the sleeve (PDI741).

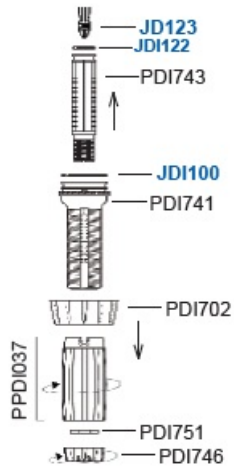

- Reinstall “C” clamp by sliding it gently over the thread at the bottom of the white stem. Rotate clamp until it clicks into place. Screw locking nut (PDI746) back on. (See back cover for steps 6 and 7.)
5. Insert new check valve (PDI118) at the bottom of the white stem, making sure that the 4 white keys on the check valve seat next to the 4 black keys on the bottom of the stem. Screw check valve nut (PDI747) back on.

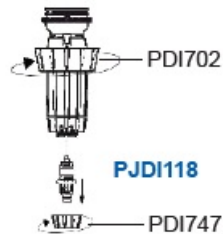

6. Push complete injection stem assembly in position at the bottom of the blue body, making sure desired scale is facing front of injector. Keys at the top of the black sleeve should slide into the slots at the bottom of the body. Slide injection stem nut (PDI702) up the sleeve and screw back on. Insert hose back onto the bottom of the check valve barb (PDI118). Screw hose nut (PDI748) back on.

To ensure hose is air-tight, you may choose to carefully cut the top of hose before reinserting.

Documents / Resources

	<p>DOSATRON D14TMZ10 14 GPM Injection Seal Kit [pdf] Instruction Manual PDI122, JDI123, JDI122, JDI100, PDI118, D14TMZ10 14 GPM Injection Seal Kit, D14TMZ10, 14 GPM Injection Seal Kit, Injection Seal Kit, Seal Kit</p>
--	---