



DOSATRON D14MZ5 Interactive Schematics User Manual

[Home](#) » [DOSATRON](#) » DOSATRON D14MZ5 Interactive Schematics User Manual 

Contents

- [1 DOSATRON D14MZ5 Interactive Schematics](#)
- [2 Product Information](#)
- [3 Product Usage](#)
- [4 parts](#)
- [5 installation](#)
- [6 UNIT SPECIFICATIONS](#)
- [7 SUGGESTED MAINTENANCE](#)
- [8 DOCUMENT INSTRUCTIONS](#)
- [9 SUGGESTED INSTALLATION](#)
- [10 Documents / Resources](#)
- [11 Related Posts](#)



DOSATRON D14MZ5 Interactive Schematics



Product Information

The Dosatron D14MZ5 is a water-powered dosing unit that can dilute concentrated products at a ratio of 1:200 to 1:20. It has a flow rate of 14 gallons per minute (3 m³/h) and can handle water pressures ranging from 4.3 to 85 PSI (0.3 to 6 bar).

The unit has a 3/4 NPT connection and requires a 200 mesh/80 micron water filter installed prior to the unit for optimal performance. A one-way check valve should also be installed downstream from the unit to protect against water hammer.

For maintenance, it is recommended to use the Injection Seal Kit Part#: PJDI120 or Injection Seal Kit – Viscous Part#: PJDI120V for yearly maintenance. The Rebuild Kit Part#: MKD14MZ5 can also be used to extend the life of the unit.

Product Usage

1. Install a 200 mesh/80 micron water filter prior to the unit for optimal performance.
2. Connect the unit to a water source using a 3/4 NPT connection.
3. Adjust the dilution ratio by turning the dosage adjustment nut (clockwise for a higher ratio, counterclockwise for a lower ratio).
4. Install a one-way check valve downstream from the unit to protect against water hammer.
5. Turn on the water source and adjust the water pressure between 4.3 and 85 PSI (0.3 to 6 bar) for optimal performance.
6. To maintain the unit, use Injection Seal Kit Part#: PJDI120 or Injection Seal Kit – Viscous Part#: PJDI120V for yearly maintenance. The Rebuild Kit Part#: MKD14MZ5 can also be used to extend the life of the unit.

parts

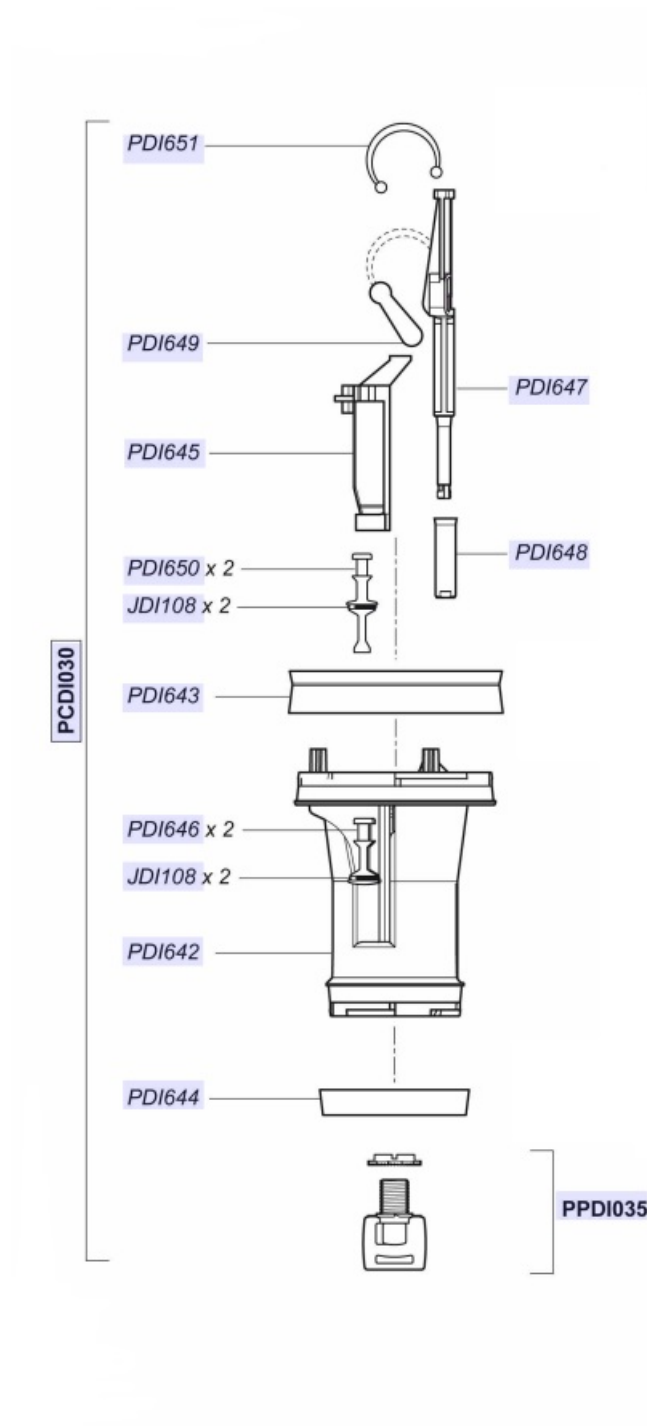

installation

14 GPM - 1:200 - 1:20

3 m³/h - 0.5 - 5 %

4.3 - 85 psi

0.3 - 6 bar

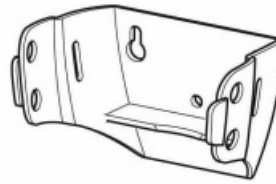
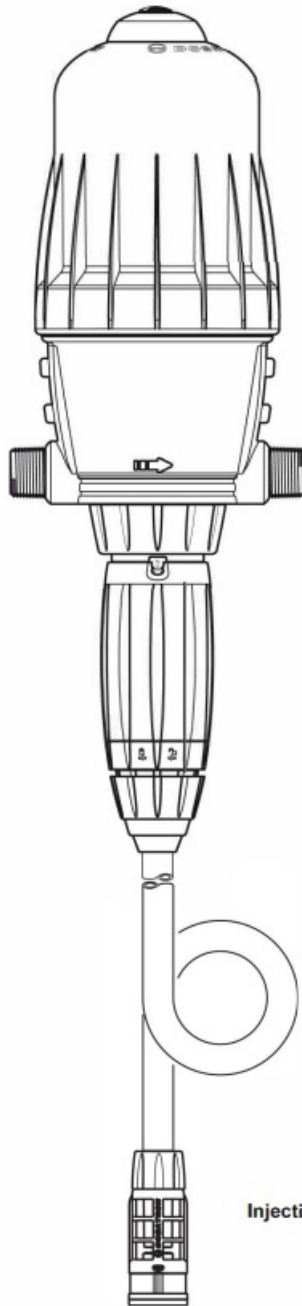

Injection Seal Kit Part # **PJDI120**

Injection Seal Kit - Viscous Part # **PJDI120V**

Rebuild Kit Part # **MKD14MZ5**

14 GPM - 1:200 - 1:20
 3 m³/h - 0.5 - 5 %
 4.3 - 85 psi
 0.3 - 6 bar

C+M

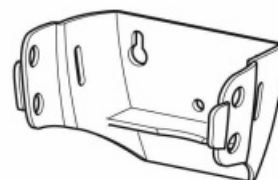
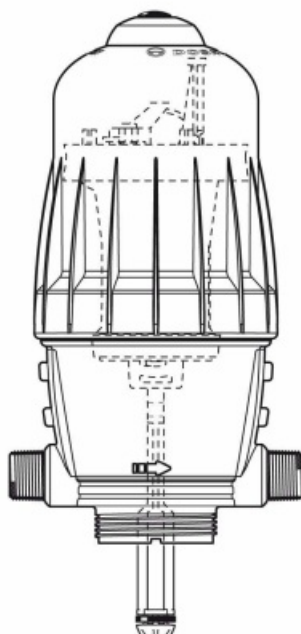

A

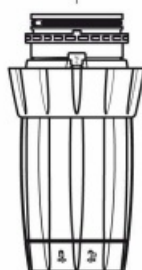

D

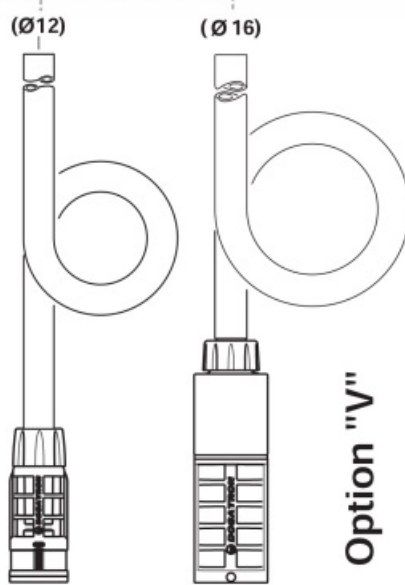
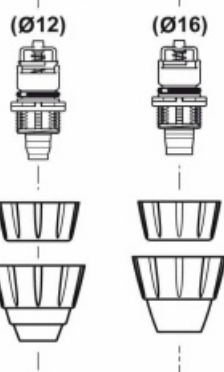

14 GPM - 1:200 - 1:20
3 m³/h - 0.5 - 5 %
4.3 - 85 psi
0.3 - 6 bar

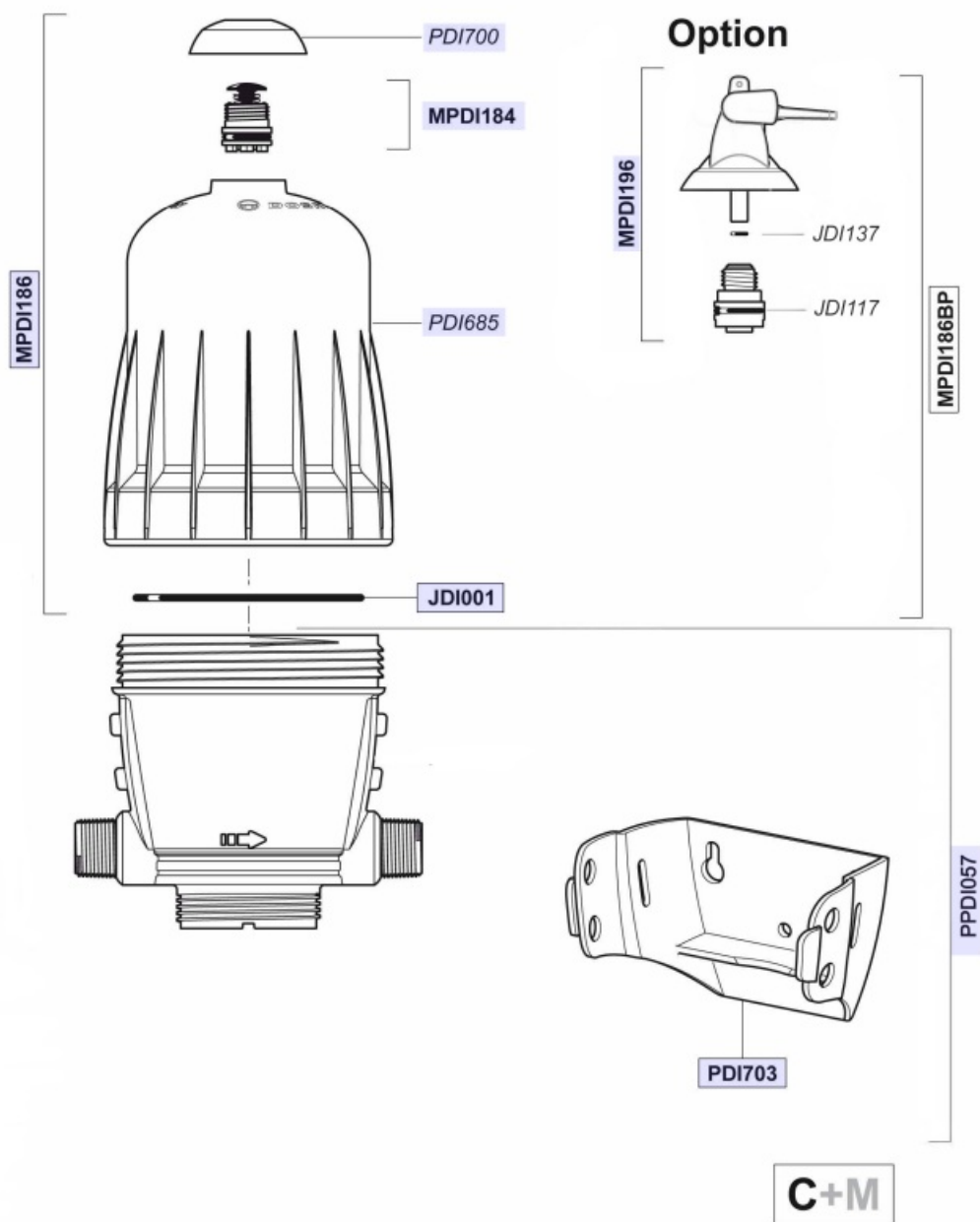

14 GPM - 1:200 - 1:20
3 m³/h - 0.5 - 5 %
4.3 - 85 psi
0.3 - 6 bar

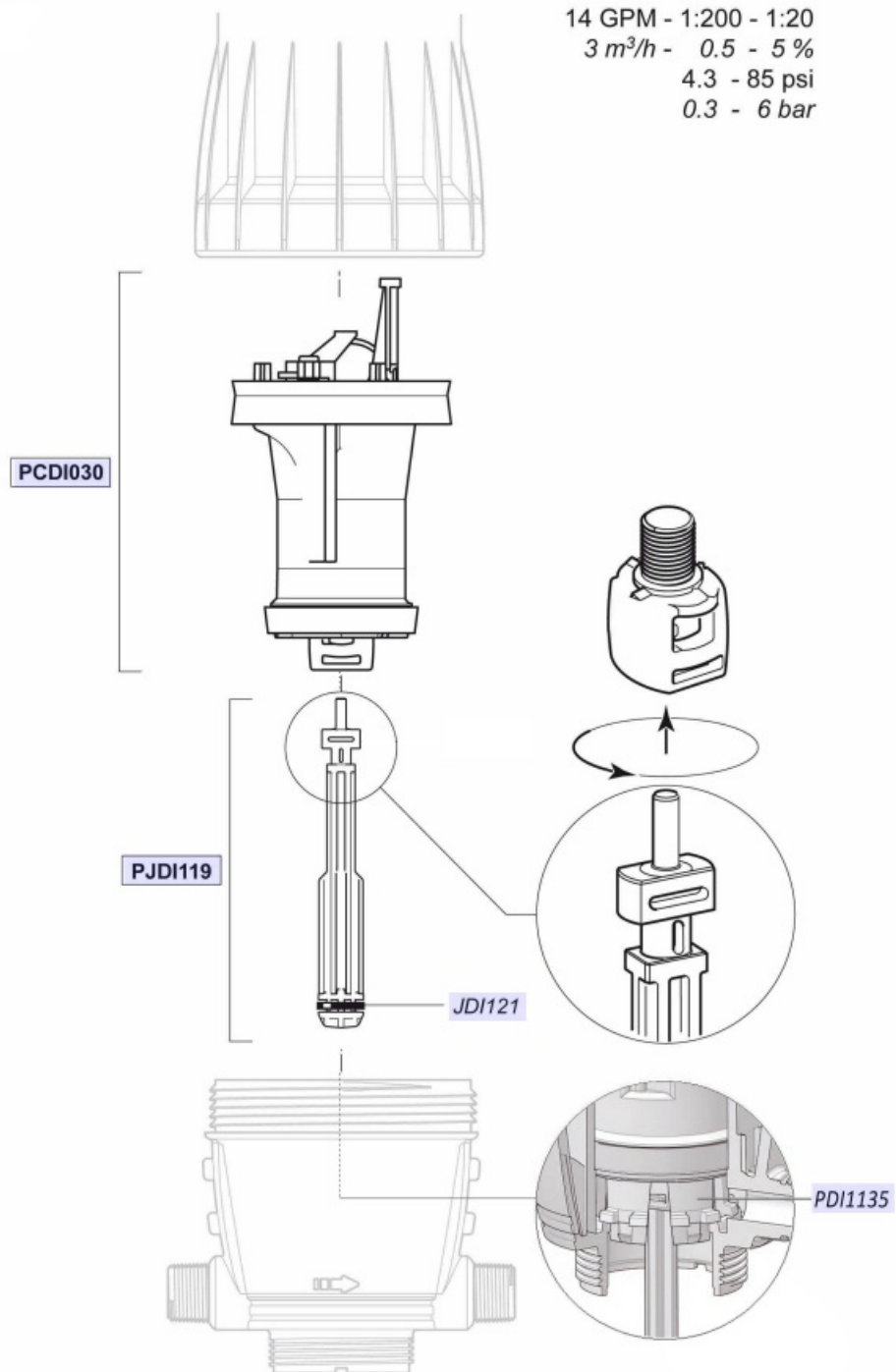

14 GPM - 1:200 - 1:20
3 m³/h - 0.5 - 5 %
4.3 - 85 psi
0.3 - 6 bar

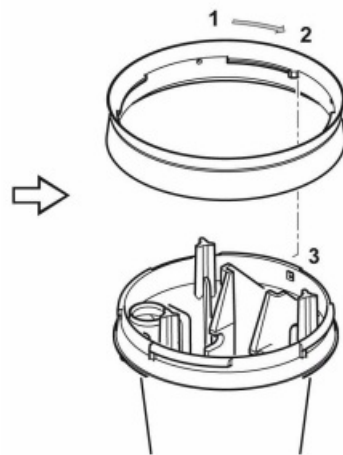
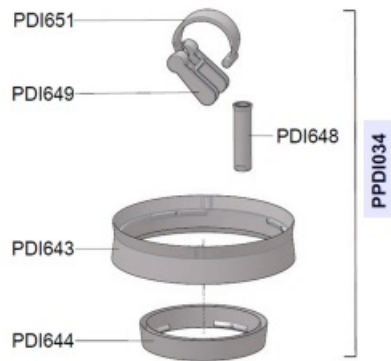

14 GPM - 1:200 - 1:20
3 m³/h - 0.5 - 5 %
4.3 - 85 psi
0.3 - 6 bar

EMDI006

JDI108 x 2

JDI001

PDI648

JDI108 x 2

C+M

14 GPM - 1:200 - 1:20
 3 m³/h - 0.5 - 5 %
 4.3 - 85 psi
 0.3 - 6 bar

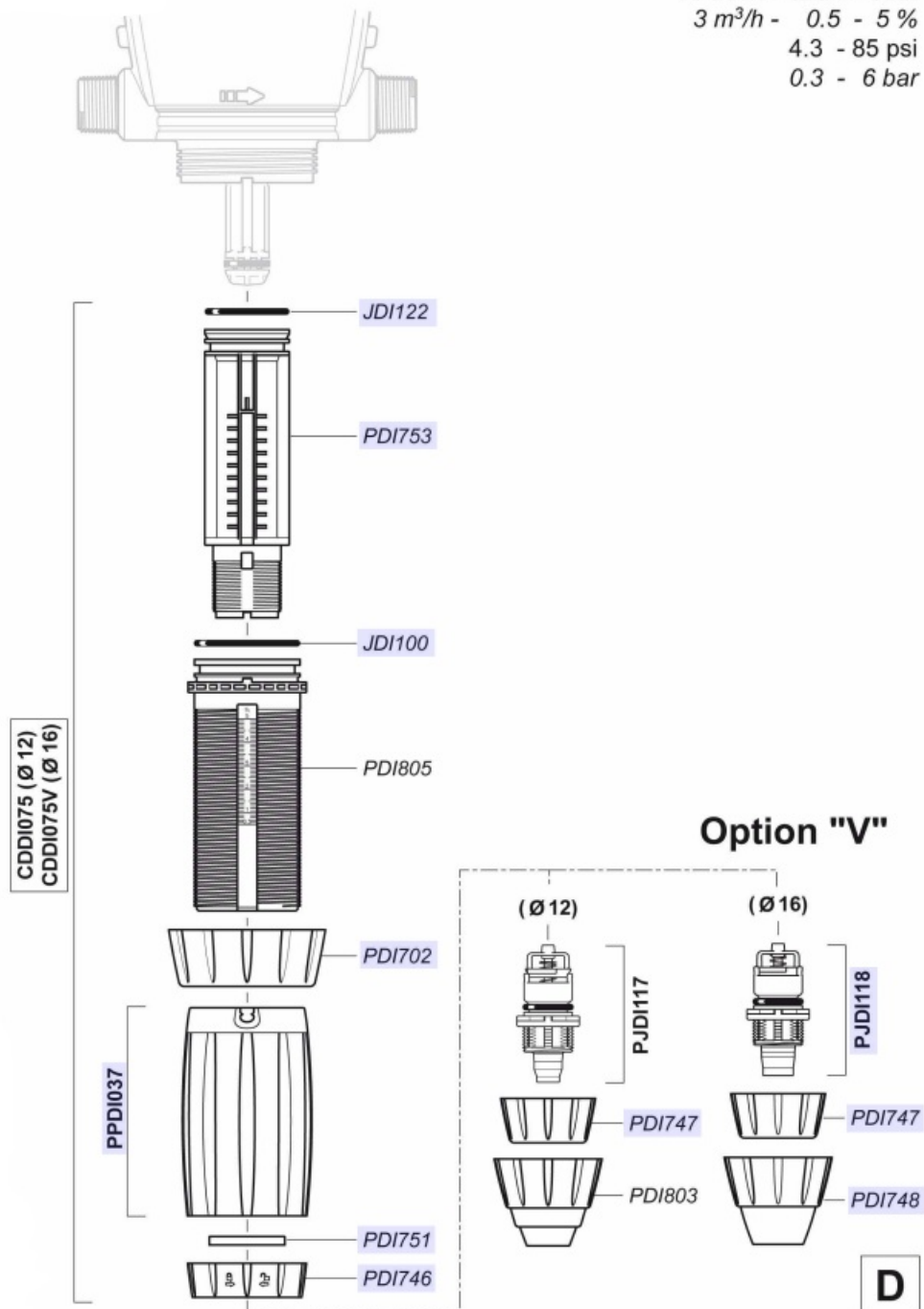

14 GPM - 1:200 - 1:20
 3 m³/h - 0.5 - 5 %
 4.3 - 85 psi
 0.3 - 6 bar

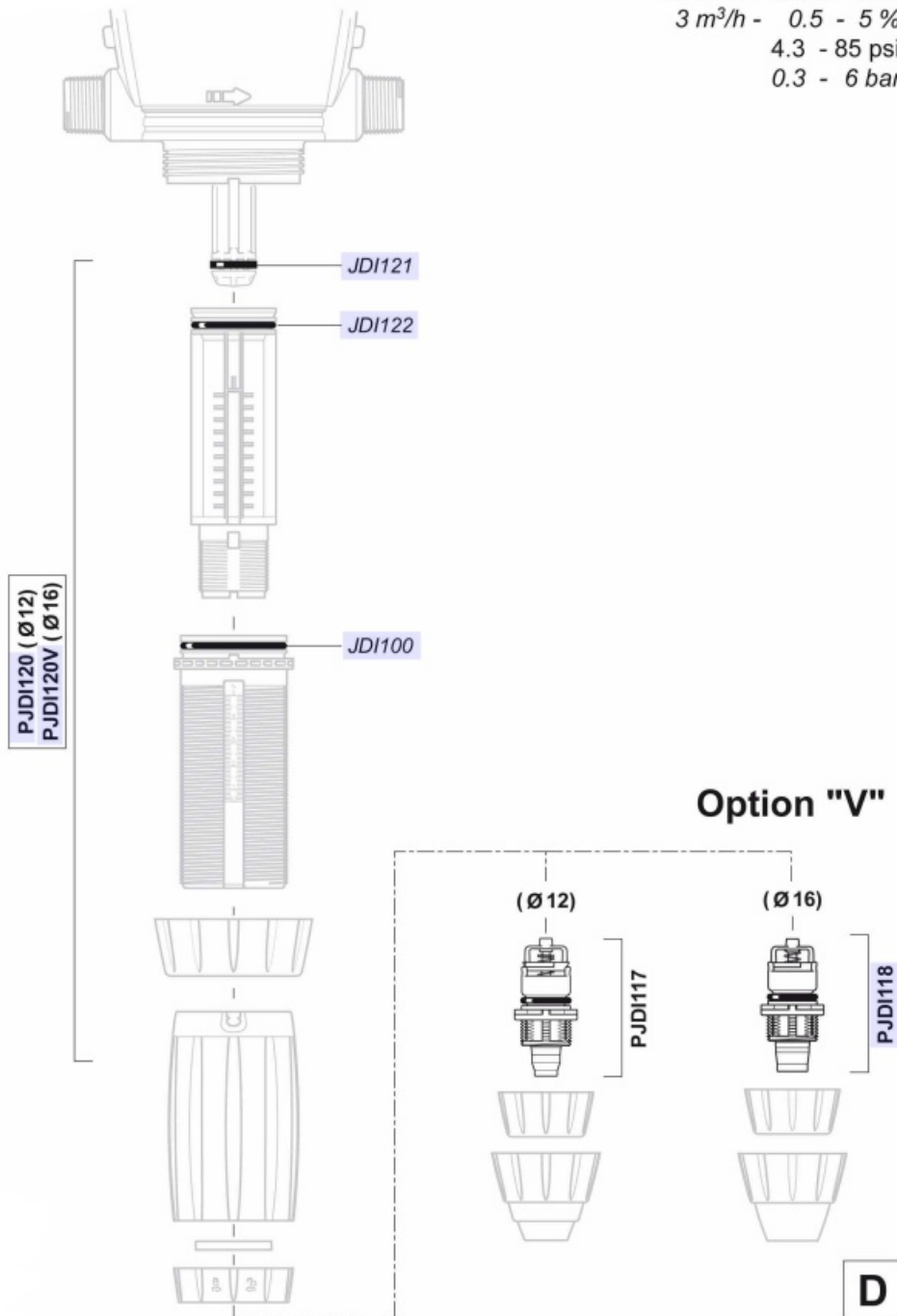

14 GPM - 1:200 - 1:20
 3 m³/h - 0.5 - 5 %
 4.3 - 85 psi
 0.3 - 6 bar

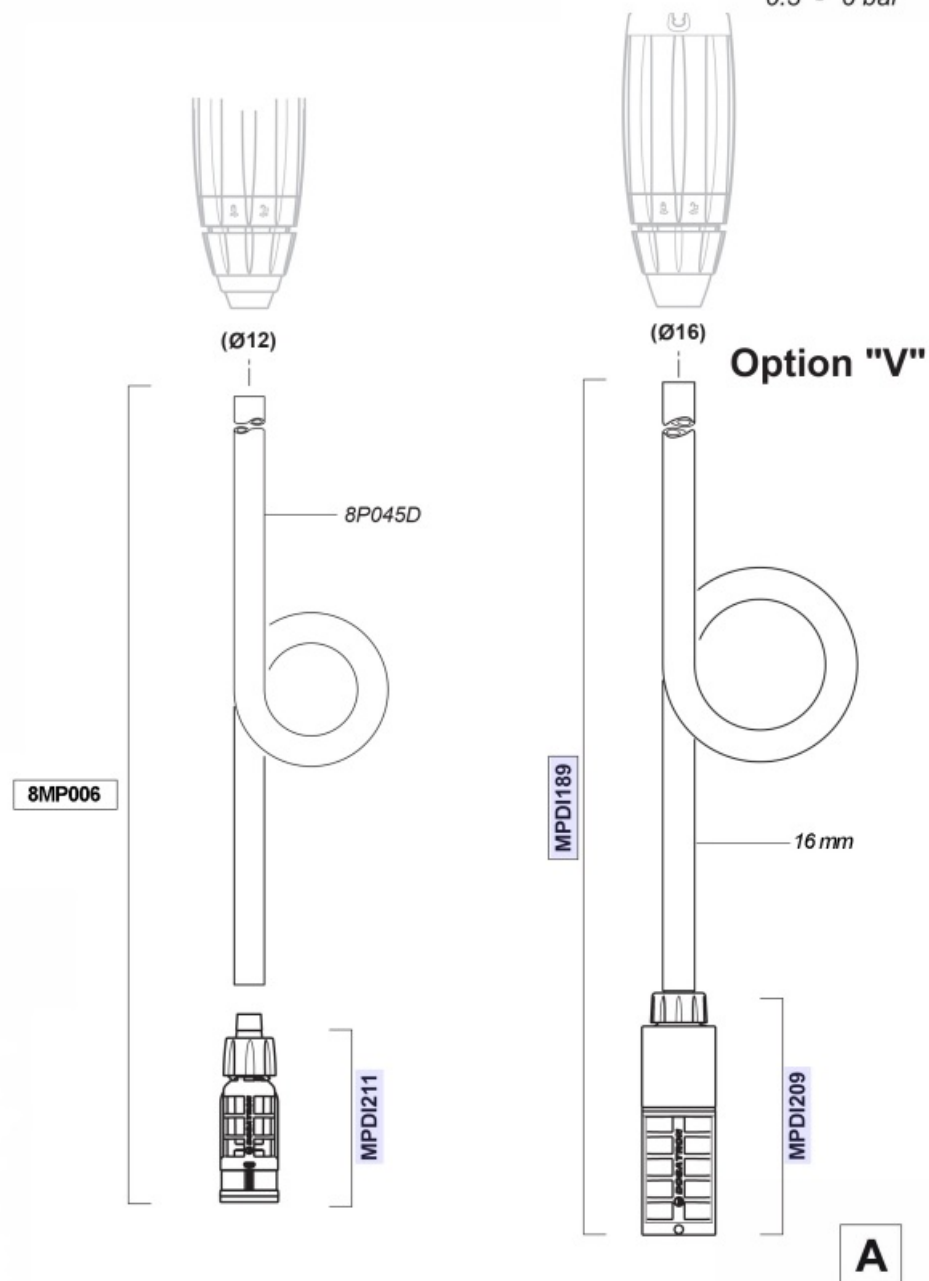

UNIT SPECIFICATIONS

- 1 :200 – 1 :20
- 4.3 – 85 PSI
- 3/4" NPT Connection

SUGGESTED MAINTENANCE

- Injection Seal Kit
Part#: PJD1120
 For yearly maintenance
- Injection Seal Kit – for Viscous
Part#: PJD1120V

For yearly maintenance

- Rebuild Kit

Part #: MKD14MZ5

Extends the life of your unit

DOCUMENT INSTRUCTIONS

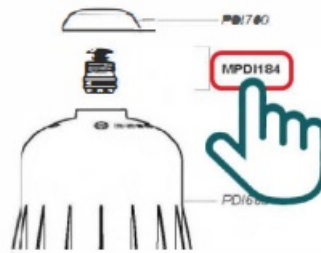

- Click on a part#, to visit item page
- Click arrow back from item page, to return to this document

SUGGESTED INSTALLATION

- 200 mesh/80 micron water filter prior to the unit
- One-way check valve down-stream from the unit for water hammer protection

Dosatron International, LLC.

- 1-800-523-8499
- 1-727-443-5404
- www.dosatronusa.com

Documents / Resources

| | |
|---|---|
|  | <p>DOSATRON D14MZ5 Interactive Schematics [pdf] User Manual D14MZ5 Interactive Schematics, D14MZ5, Interactive Schematics, Schematics</p> |
|---|---|