



DOSATRON D14MZ2 14 GPM Interactive Schematics Owner's Manual

[Home](#) » [DOSATRON](#) » DOSATRON D14MZ2 14 GPM Interactive Schematics Owner's Manual 

Contents

- [1 DOSATRON D14MZ2 14 GPM Interactive Schematics](#)
- [2 Product Information](#)
- [3 PART LIST](#)
- [4 Product Usage Instructions](#)
- [5 SUGGESTED MAINTENANCE](#)
- [6 DOCUMENT INSTRUCTIONS](#)
- [7 SUGGESTED INSTALLATION](#)
- [8 Documents / Resources](#)
- [9 Related Posts](#)



DOSATRON D14MZ2 14 GPM Interactive Schematics



Product Information

- **Unit Specifications:**

- 1: 500 – 1 :50,
- 4.3 – 85 PSI,
- 3/4 NPT Connection

- Water Powered Dosing Technology

- **Suggested Installation:**

- 200 mesh/80 micron water filter prior to the unit
- One-way check valve down-stream from the unit for water hammer protection

- **Suggested Maintenance:**

- Mini-Maintenance Kit Part#: PJDI116MINI-H for regular maintenance
- Injection Seal Kit Part#: PJDI116 for yearly maintenance
- Rebuild Kit Part#: MKD14MZ2 extends the life of your unit

PART LIST

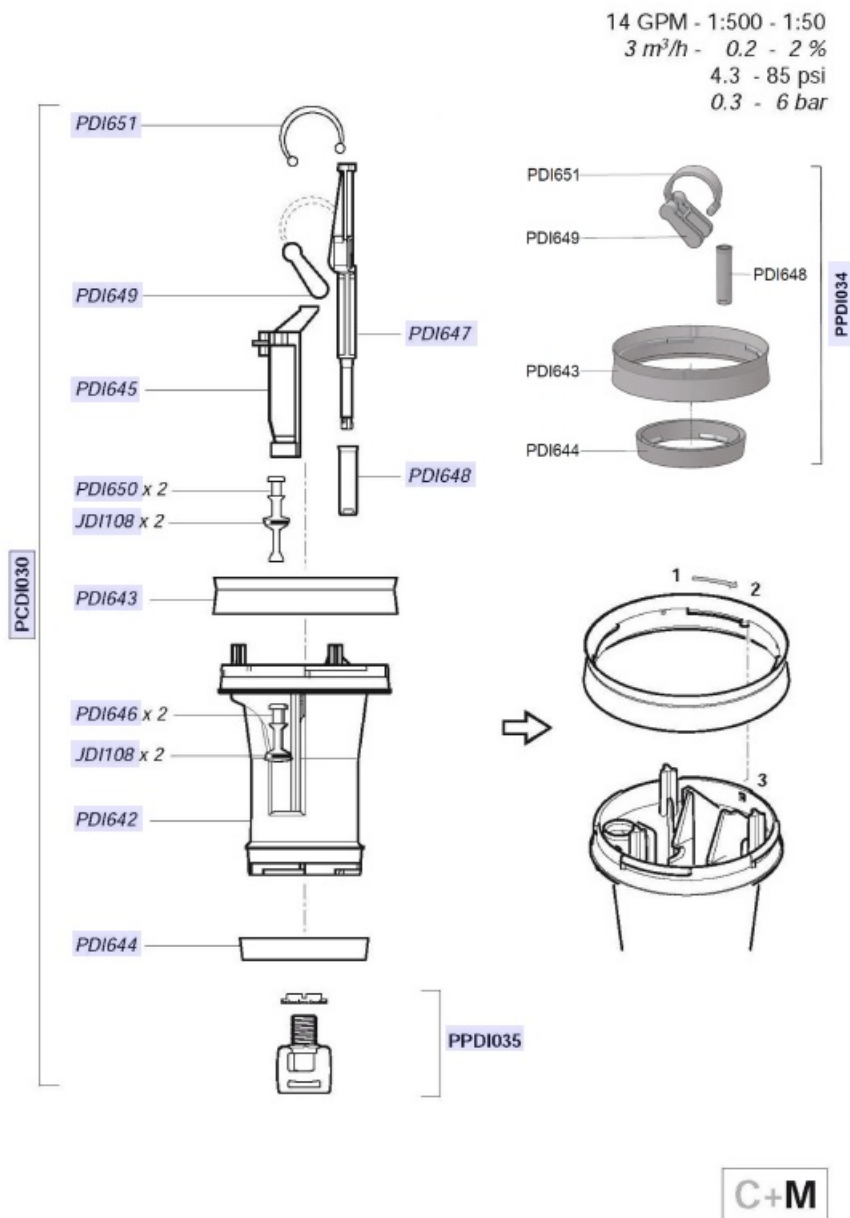

Product Usage Instructions

1. Install a 200 mesh/80 micron water filter prior to the unit and a one-way check valve downstream from the unit for water hammer protection.
2. Connect the dosing unit to a water supply with a 3/4 NPT connection.
3. Adjust the dosing rate by turning the dosage adjustment knob on the unit. The dosing rate can be adjusted from 1:500 to 1:50.
4. The unit operates based on water pressure, therefore ensure that the water pressure is maintained between 4.3 to 85 PSI.
5. For regular maintenance, use the Mini-Maintenance Kit Part#: PJDI116MINI-H.
6. For yearly maintenance, use the Injection Seal Kit Part#: PJDI116.
7. To extend the life of your unit, use the Rebuild Kit Part#: MKD14MZ2.

SUGGESTED MAINTENANCE

- Mini-Maintenance Kit

- **Part#:** PJD116MINI-H For regular maintenance
- **Injection Seal Kit**
 - **Part#:** PJD116 For yearly maintenance
- **Rebuild Kit**
 - **Part #:** MKD14MZ2 Extends the life of your unit

DOCUMENT INSTRUCTIONS

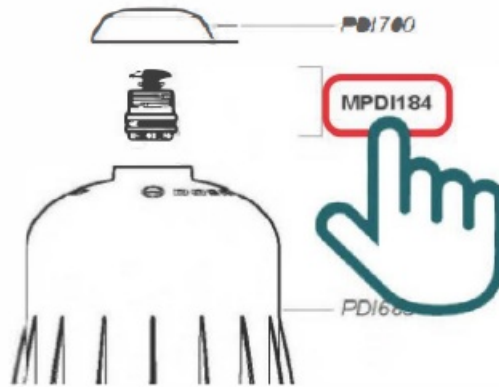

- Click on a part#, to visit item page
- Click arrow back from item page, to return to this document.



SUGGESTED INSTALLATION

- 200 mesh/80 micron water filter prior to the unit
- One-way check valve down-stream from the unit for water hammer protection

14 GPM - 1:500 - 1:50

3 m^3/h - 0.2 - 2 %

4.3 - 85 psi

0.3 - 6 bar

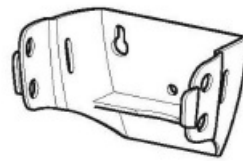
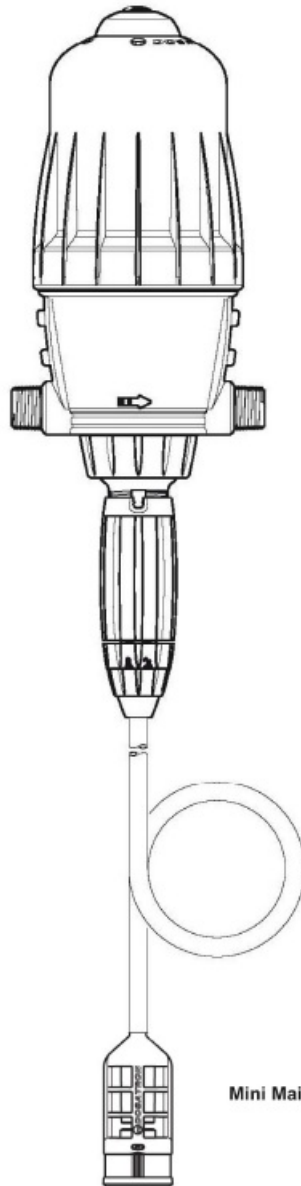

Injection Seal Kit Part # **PJDI116**

Mini Maintenance Kit Part # **PJDI116MINI-H**

Rebuild Kit Part # **MKD14M22**

14 GPM - 1:500 - 1:50
3 m³/h - 0.2 - 2 %
4.3 - 85 psi
0.3 - 6 bar

C+M

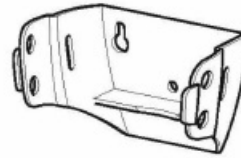
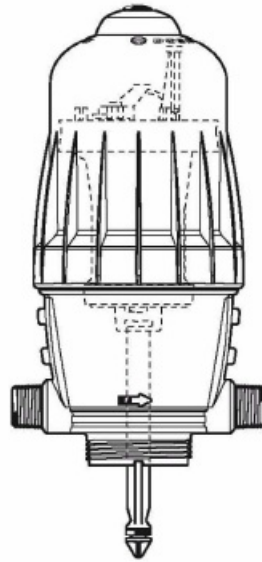

D

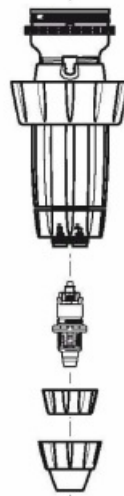

A

(Ø8)

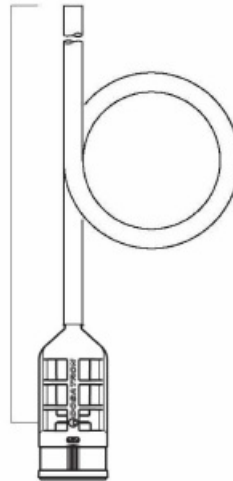

14 GPM - 1:500 - 1:50
3 m³/h - 0.2 - 2 %
4.3 - 85 psi
0.3 - 6 bar

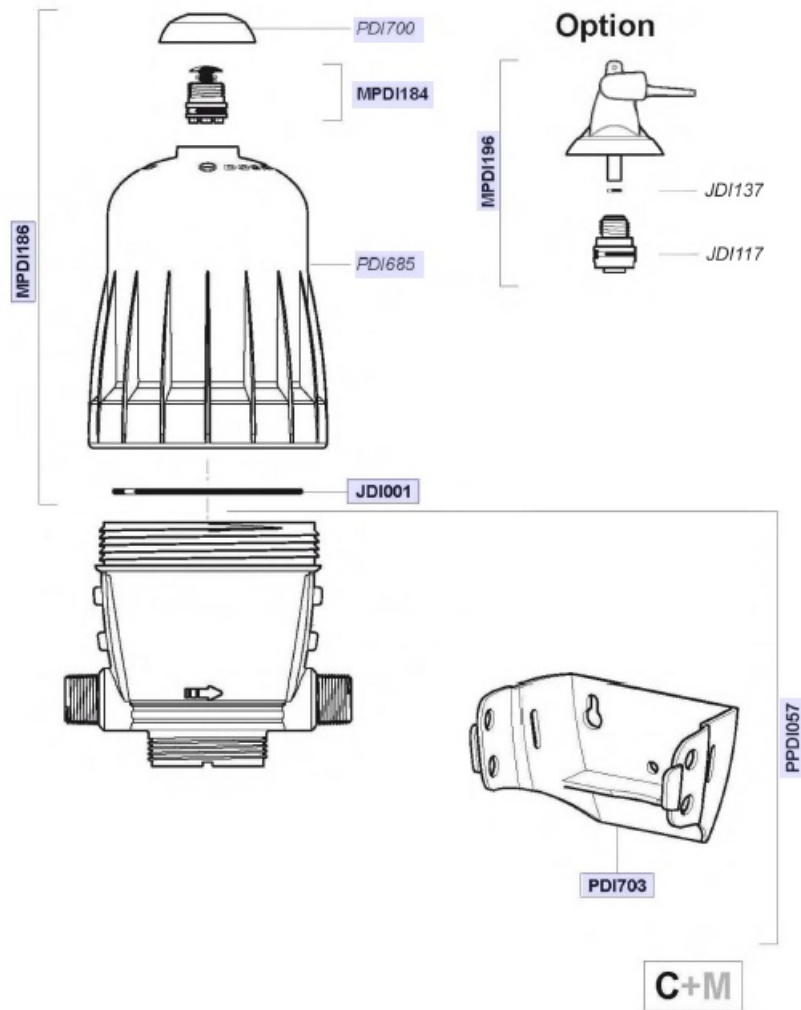

14 GPM - 1:500 - 1:50
3 m³/h - 0.2 - 2 %
4.3 - 85 psi
0.3 - 6 bar

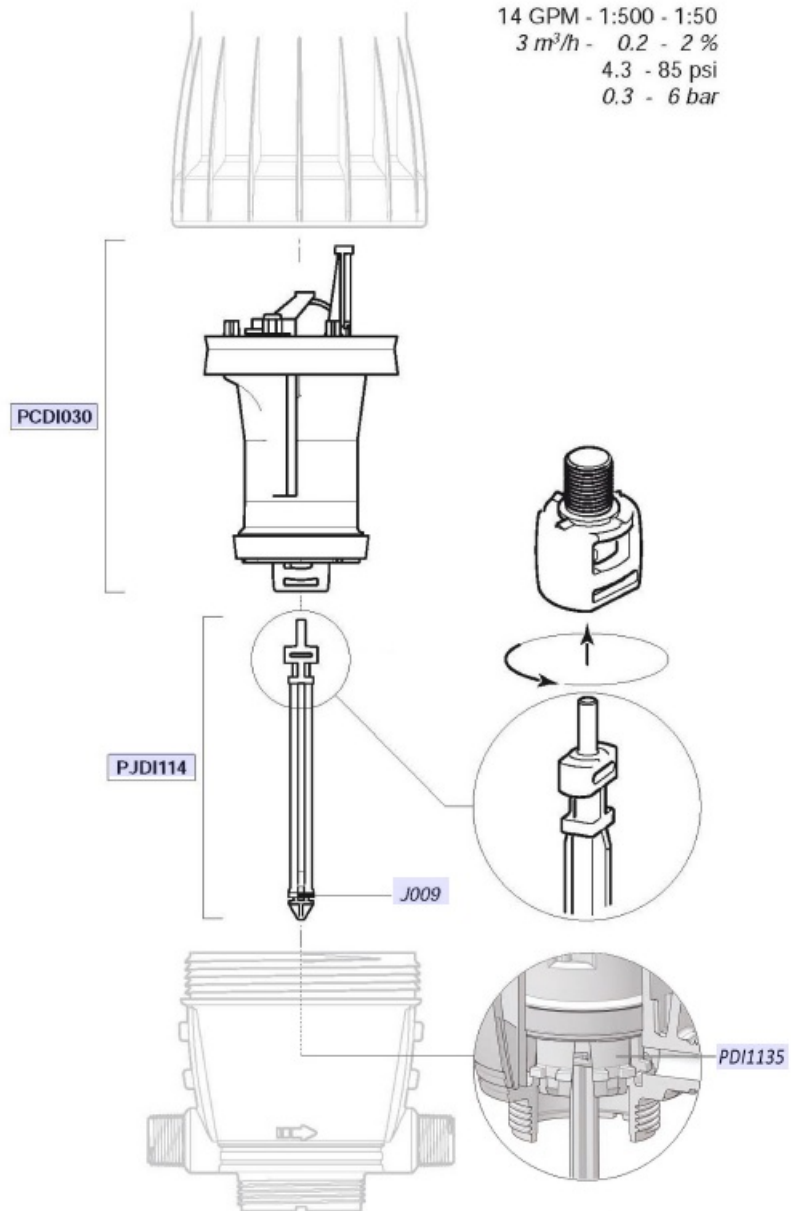

14 GPM - 1:500 - 1:50
3 m³/h - 0.2 - 2 %
4.3 - 85 psi
0.3 - 6 bar

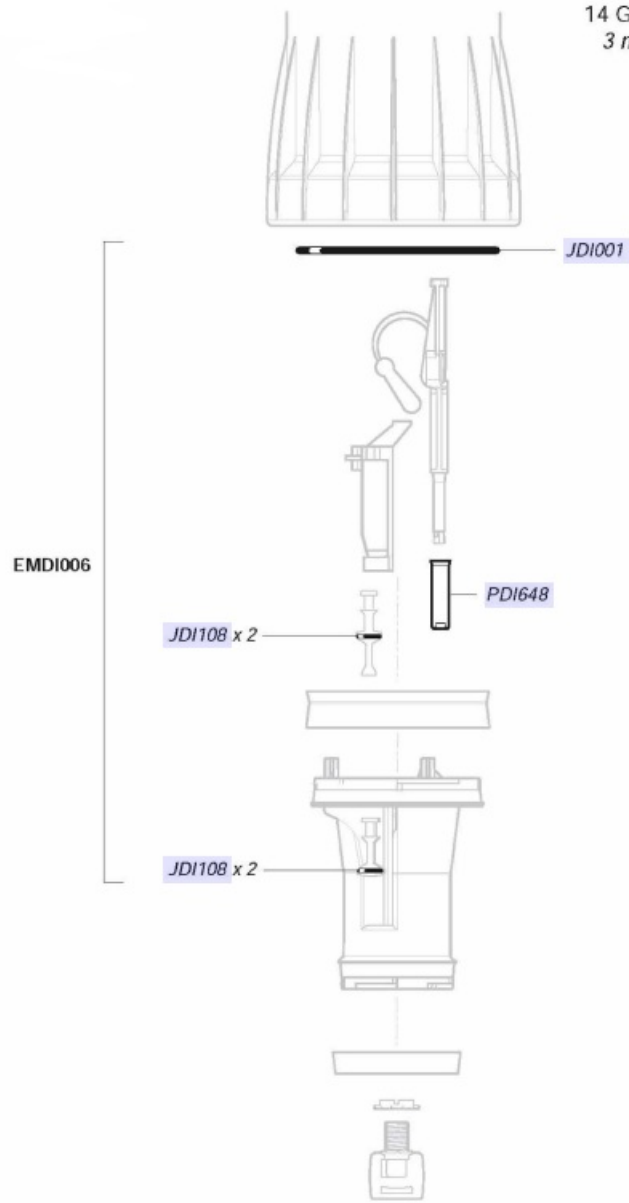

C+M

14 GPM - 1:500 - 1:50
3 m³/h - 0.2 - 2 %
4.3 - 85 psi
0.3 - 6 bar

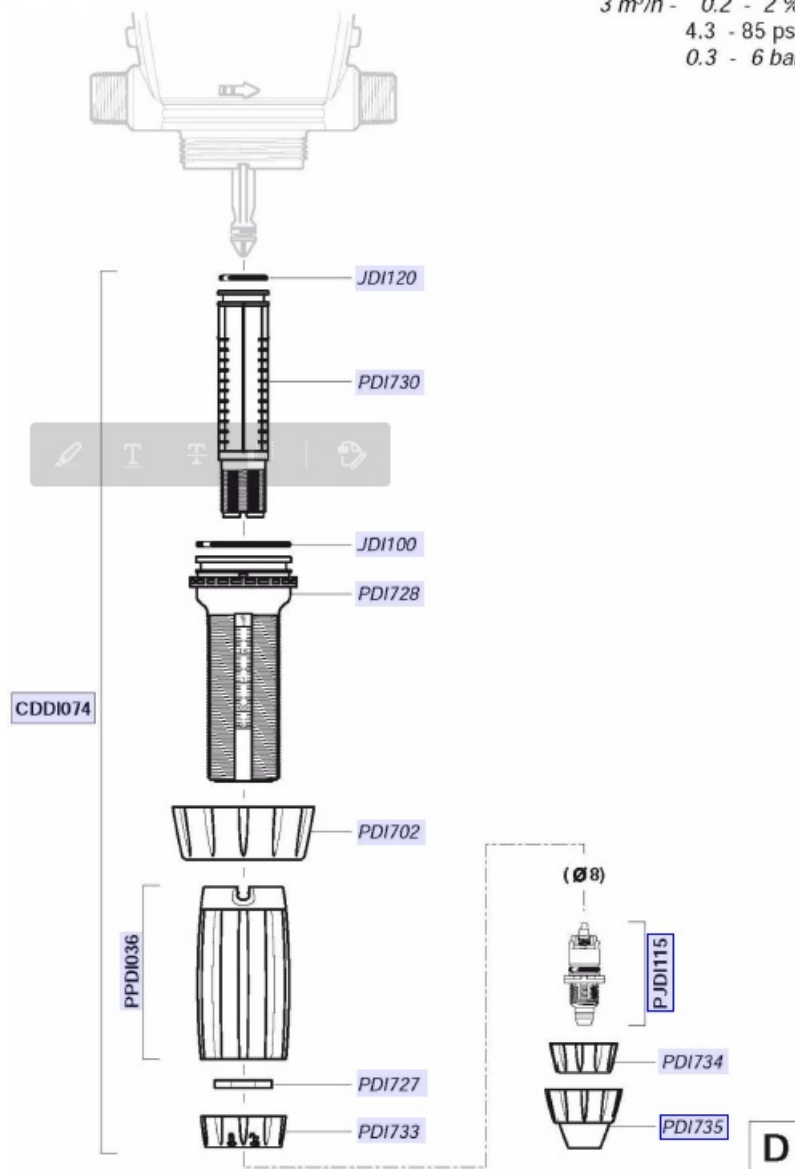

14 GPM - 1:500 - 1:50
3 m³/h - 0.2 - 2 %
4.3 - 85 psi
0.3 - 6 bar

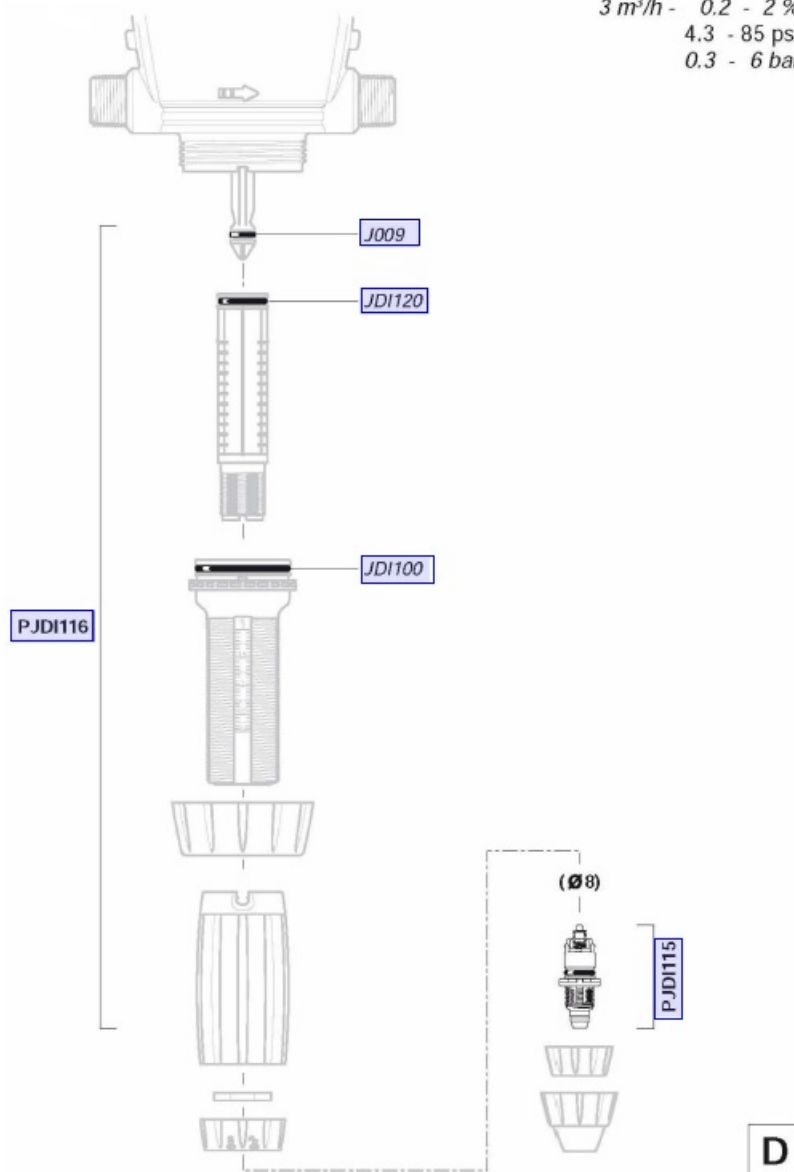

14 GPM - 1:500 - 1:50
 $3 \text{ m}^3/\text{h}$ - 0.2 - 2 %
 4.3 - 85 psi
 0.3 - 6 bar

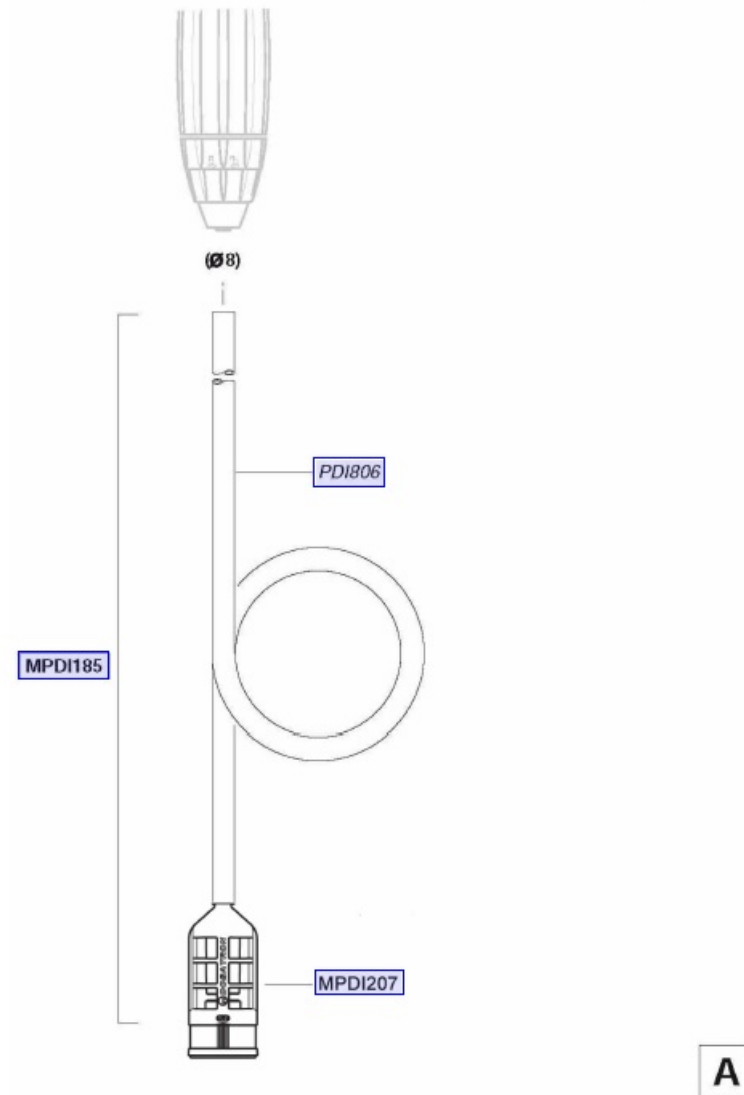

Dosatron International, LLC.

1-800-523-8499

1-727-443-5404

www.dosatronusa.com

Documents / Resources

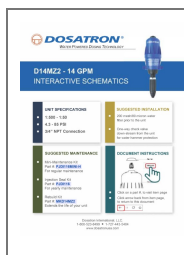

[DOSATRON D14MZ2 14 GPM Interactive Schematics](#) [pdf] Owner's Manual
 D14MZ2 14 GPM Interactive Schematics, D14MZ2, 14 GPM Interactive Schematics, Interactive Schematics