



## DoorBird D21X Light Push Buttons Installation Guide

[Home](#) » [DoorBird](#) » DoorBird D21X Light Push Buttons Installation Guide 



### Contents

- [1 INSTALLATION D21X LIGHT PUSH BUTTONS](#)
- [2 Documents / Resources](#)
- [3 Related Posts](#)

## INSTALLATION D21X LIGHT PUSH BUTTONS

### INSTALLATION D21X LICHTTASTER

D21x rectangular light push button

D21x rechteckiger Lichttaster

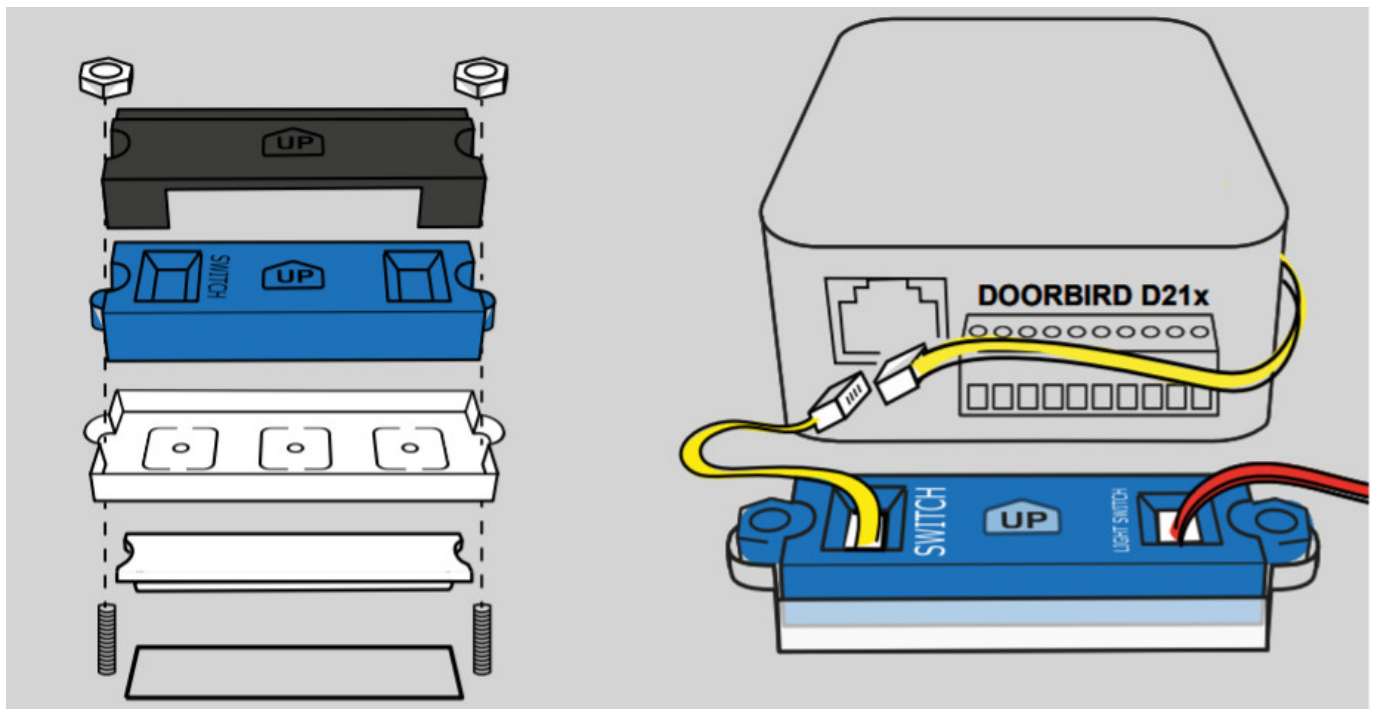

Make sure that the light switch is aligned upwards according to the „UP“ marking and surrounded by the silicone seal.

Plug the enclosed yellow cable into the „Switch“ connection on the light switch and then connect it to the yellow cable of the main unit.

The „Light Switch“ connection is a potential-free contact that can be used, for example, to control a time relay (max. 24 VDC/VAC, 1 A) to switch the staircase lighting. Use the enclosed pink cable for this purpose.

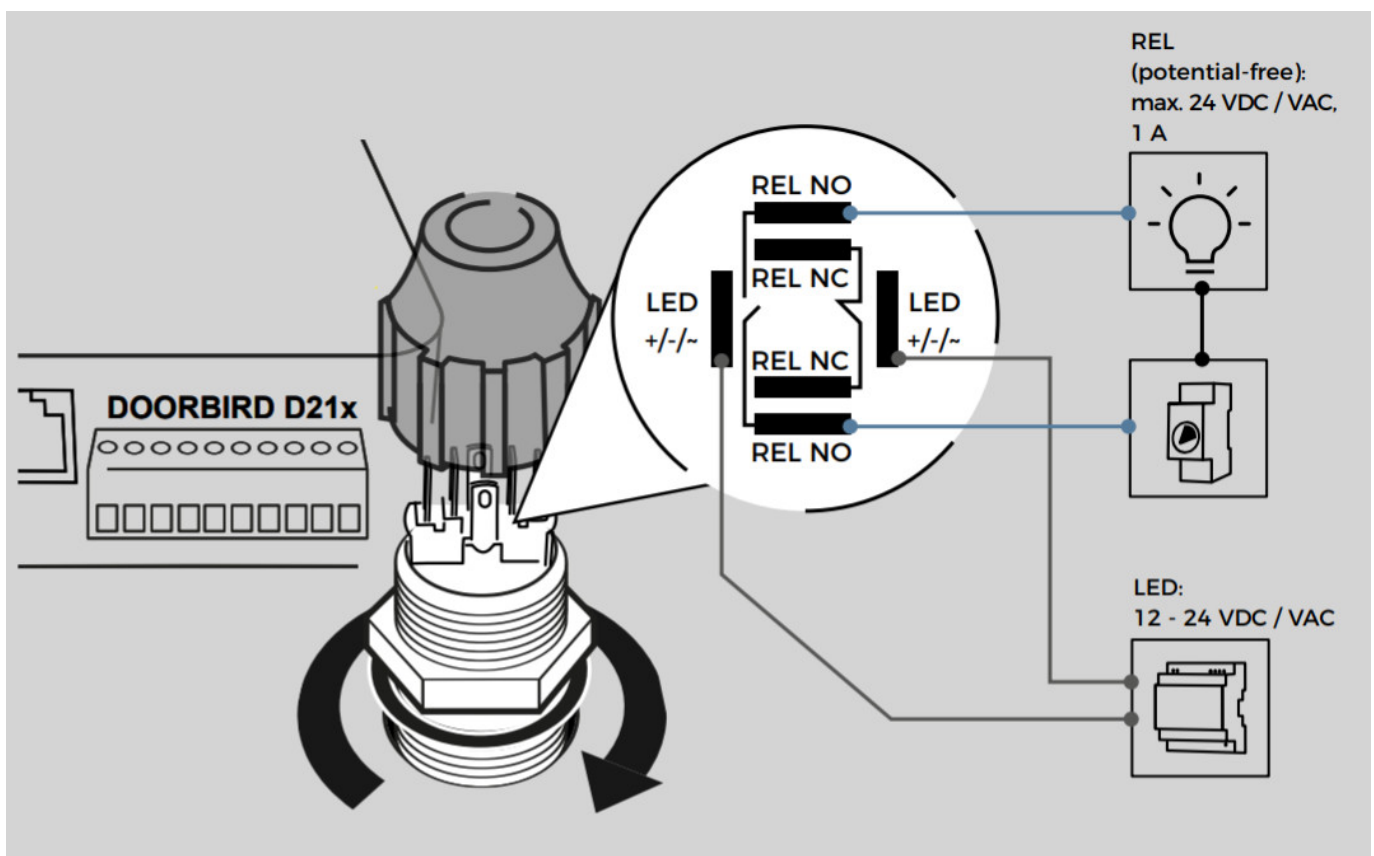

The round light switch provides a connection for the power supply of the integrated LED of the button (12-24 VDC / VAC) and an open/closed potential-free contact, which can be used e.g. for the control of a time relay (max. 24 VDC / VAC, 1 A) to switch the staircase lighting.

REL NO: Normally open.

REL NC: Normally closed.

Documents / Resources

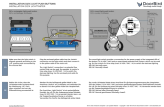
	<a href="#">DoorBird D21X Light Push Buttons</a> [pdf] Installation Guide D21X, Light Push Buttons, D21X Light Push Buttons
---	--