

# ***Dongguan*** **M090** **Aromatherapy** **Diffusers**



## **Dongguan M090 Aromatherapy Diffusers User Manual**

[Home](#) » [Dongguan](#) » Dongguan M090 Aromatherapy Diffusers User Manual 

### **Contents**

- [1 Dongguan M090 Aromatherapy Diffusers](#)
- [2 SET UP](#)
- [3 REMOTE CONTROL FUNCTIONS](#)
- [4 CLEANING YOUR DIFFUSER](#)
- [5 SAFETY](#)
- [6 REPLACING THE NOZZLE](#)
- [7 FCC](#)
- [8 FAQs](#)
- [9 Documents / Resources](#)
  - [9.1 References](#)
- [10 Related Posts](#)

# ***Dongguan***

**Dongguan M090 Aromatherapy Diffusers**



## SET UP

- To open your Scent Diffuser, rotate the upper half of your device in a counterclockwise motion, while firmly holding the bottom half.

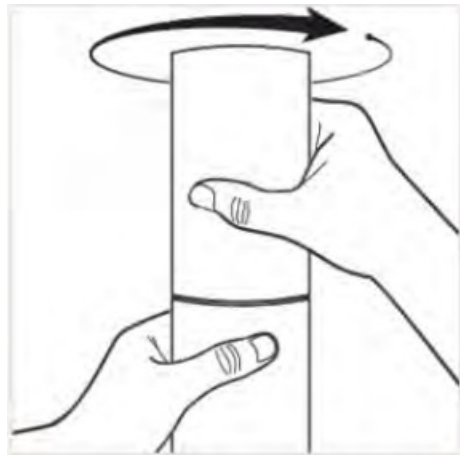

- Remove the empty oil bottle from the diffuser by turning it clockwise. Save this to use in the cleaning process of your diffuser.



- Select your Fragrance Oil carefully and screw the bottle counterclockwise into the diffuser.



- Once you have securely screwed on the Fragrance Oil, close the unit by sliding the upper half back into place and turning clockwise.

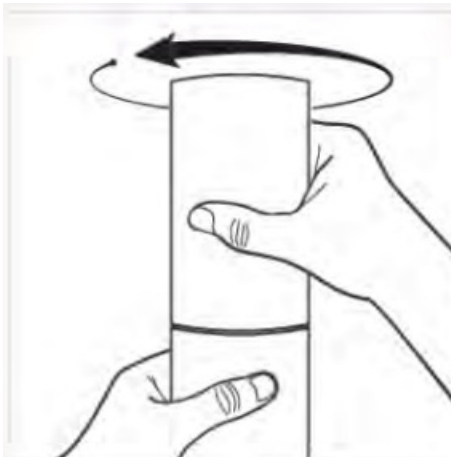

- Connect the power adapter into the diffuser's power port and plug it into a 110V or 220 V power outlet.

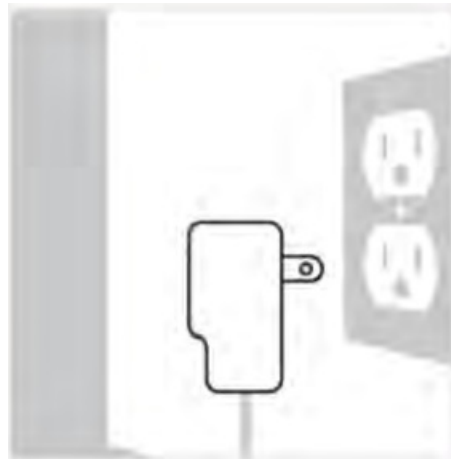

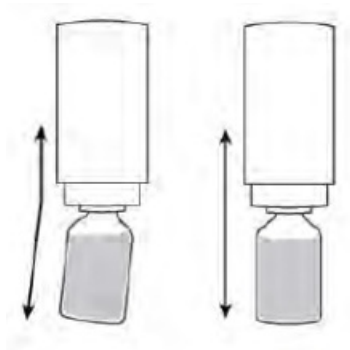

- **Important:** Make sure the bottle is screwed in tight and parallel to the top half of the diffuser.

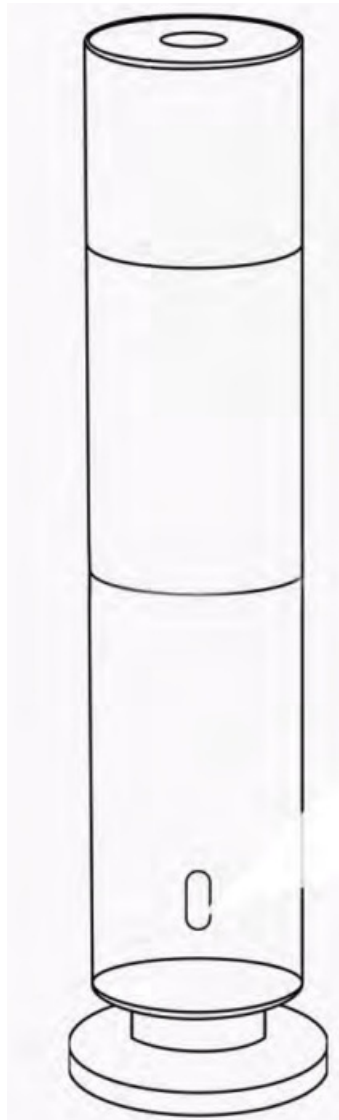

## REMOTE CONTROL FUNCTIONS



-  **Blue LED Light** – Indicates the device is powered on
-  **Green LED Light** – Indicates the scent is being diffused
-  **Red LED Light** – Flashes when any button on the remote control is being pressed

## REMOTE CONTROL FUNCTIONS

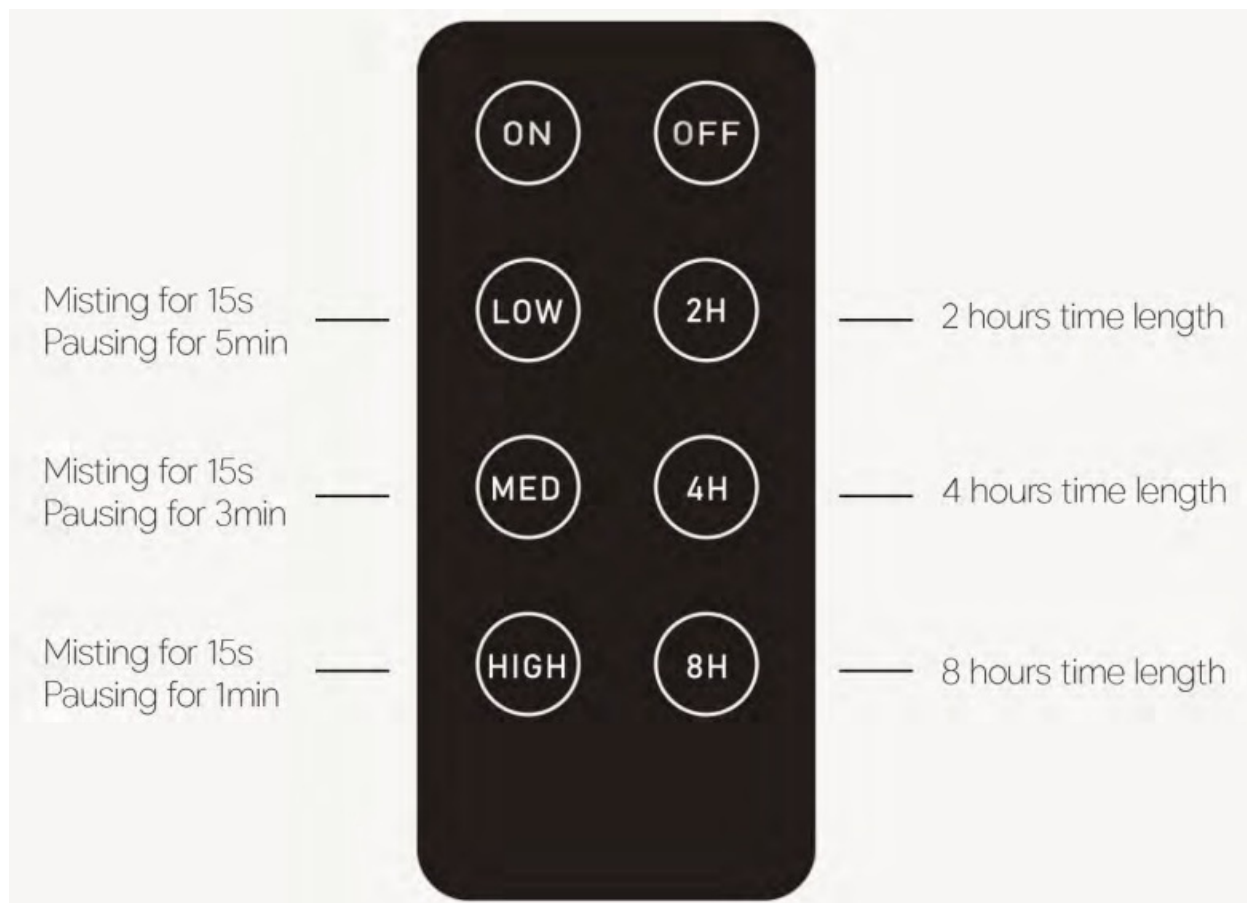

**Matching method:** Within 5 seconds of powering on the machine, press any key on the remote control, and the machine indicator light will flash, indicating successful matching.

### TIPS FOR PROPER USAGE

- Avoid windows or air vents so the scent can circulate through the surrounding area.
- Place the diffuser in an area on its own so the scent can flow freely.
- Always position the diffuser upright so the Fragrance Oil can diffuse upward into the air.
- Your Scent Diffuser will only work properly when using our Fragrance Oils. Use of any other oil is not recommended and will void the warranty.
- To preserve the motor of your Scent Diffuser, we recommend running it for no more than 8 hours a day.

### CLEANING YOUR DIFFUSER

Your Scent Diffuser should be cleaned every 1-2 months and when switching fragrances to ensure optimal performance.

1. Fill the empty oil bottle that came with your diffuser with 1/4 inch of rubbing alcohol.
2. Screw the alcohol-filled bottle into the diffuser.
3. Run the diffuser for 15 minutes to ensure the alcohol can filter through the whole device.
4. Unplug the device from the wall outlet and keep the diffuser in an upright position. Wipe the device with a damp cloth to remove oil stains and fingerprints. Avoid using any harsh or abrasive cleaning products.
5. reconnect both halves of the diffuser. Remove the alcohol-filled bottle, Replace it with our Fragrance Oil and plug it into the wall outlet. You're ready to begin scenting

## SAFETY

To ensure safe usage, follow these precautions:

- Do not tilt the diffuser as oil can spill inside the device and damage the mechanics.
- Use of the Scent Diffuser and Fragrance Oils requires adult supervision.
- Do not wet the device or place it near any liquids, sinks, bathtubs, or outdoors.
- Do not use the device with any power cord other than the one provided with your diffuser. Position the power cord to prevent it from being a tripping hazard. Before connecting your diffuser to a power outlet, check that the voltage label specified on the adapter is the same as the power supply.
- Do not run the unit on empty. Unless there is oil in the bottle or alcohol for cleaning, turn the device off.
- Do not ingest any Fragrance Oils or apply them to any part of the skin. Keep oils out of contact with eyes, ears, nose, mouth, and any other bodily opening. If contact does occur, flush with water immediately until all traces of oil have been removed entirely from the area.

## REPLACING THE NOZZLE

1. To change the nozzle, unplug the diffuser, remove the bottle of oil, and carefully pull out the clear tube. Gently pull out the black nozzle by wiggling it gently using a pair of tweezers.



2. Replace it with a new nozzle and ensure the nozzle is pressed very firmly into the top of the diffuser. The tube can be reinserted into the nozzle. It is very important that you put the tube into the correct opening of the nozzle otherwise the unit will not diffuse scent. Within the nozzle there is a small round tube holder that the tube needs to be firmly secured into.



- **Tip:** If you are having difficulty seeing the tube holder inside the nozzle, hold a flashlight into the nozzle to increase visibility.

## **DISCLAIMERS**

- The Scent Diffuser comes with a 90-day limited warranty.
- The Scent Diffuser motor has a 3,000-hour life.
- The Scent Diffuser is NOT silent. It makes a humming sound that can amplify as the motor continues to work. This is to be expected.
- All diffusers are specifically designed to be used with our
- Fragrance Oils. Using any other oils, adding water, or any
- other misuse of the diffuser will void the 90-day warranty.

**For any inquiries or support please contact your seller.**

### **What services can we do:**

- Providing varieties of diffusers for different areas.
- Providing varieties of fragrance oils.

## **FCC**

This device complies with part 15 of the FCC Rules. Operation is subject to the following two conditions: (1) This device may not cause harmful interference, and (2) this device must accept any interference received, including interference that may cause undesired operation. Any Changes or modifications not expressly approved by the party responsible for compliance could void the user's authority to operate the equipment.

**Note:** This equipment has been tested and found to comply with the limits for a Class B digital device, pursuant to part 15 of the FCC Rules. These limits are designed to provide reasonable protection against harmful interference in a residential installation. This equipment generates uses and can radiate radio frequency energy and, if not installed and used in accordance with the instructions, may cause harmful interference to radio communications. However, there is no guarantee that interference will not occur in a particular installation. If this equipment does cause harmful interference to radio or television reception, which can be determined by turning the equipment off and on, the user is encouraged to try to correct the interference by one or more of the following measures:

- Reorient or relocate the receiving antenna.
- Increase the separation between the equipment and receiver.
- Connect the equipment into an outlet on a circuit different from that to which the receiver is connected.
- Consult the dealer or an experienced radio/TV technician for help.

### **FCC Radiation Exposure statement**

The device has been evaluatec to meel general RF exposure requirement. The device can be used in porlable exposure conditions without restriction.

## **FAQs**

- **Q: Can I use any type of essential oil in the diffuser?**

- A: It is recommended to use high-quality essential oils specifically designed for aromatherapy diffusers.
- **Q: How often should I clean the diffuser?**
  - A: It is advisable to clean the diffuser after every 5-6 uses to prevent any buildup or residue

## Documents / Resources

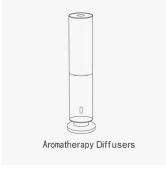
	<p><a href="#">Dongguan M090 Aromatherapy Diffusers</a> [pdf] User Manual 2BK5F-M090, 2BK5FM090, M090 Aromatherapy Diffusers, M090, Aromatherapy Diffusers, Diff users</p>
---	--

## References

- [User Manual](#)

[Manuals+](#), [Privacy Policy](#)

This website is an independent publication and is neither affiliated with nor endorsed by any of the trademark owners. The "Bluetooth®" word mark and logos are registered trademarks owned by Bluetooth SIG, Inc. The "Wi-Fi®" word mark and logos are registered trademarks owned by the Wi-Fi Alliance. Any use of these marks on this website does not imply any affiliation with or endorsement.