

Dongguan Lingjie Electronics Technology E100 Wireless mouse User Manual

[Home](#) » [Dongguan Lingjie Electronics Technology](#) » Dongguan Lingjie Electronics Technology E100 Wireless mouse User Manual 

Contents

- [1 Dongguan Lingjie Electronics Technology E100 Wireless mouse](#)
- [2 Product Function](#)
- [3 USB Installation](#)
- [4 Packing List](#)
- [5 Parameters](#)
- [6 FCC STATEMENT](#)
- [7 Documents / Resources](#)
- [8 Related Posts](#)



Dongguan Lingjie Electronics Technology E100 Wireless mouse

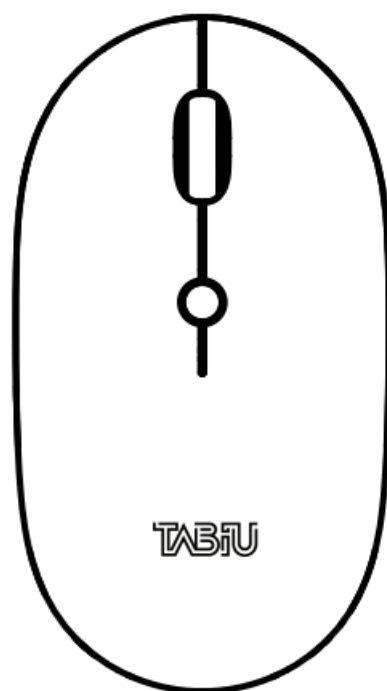

Product Function

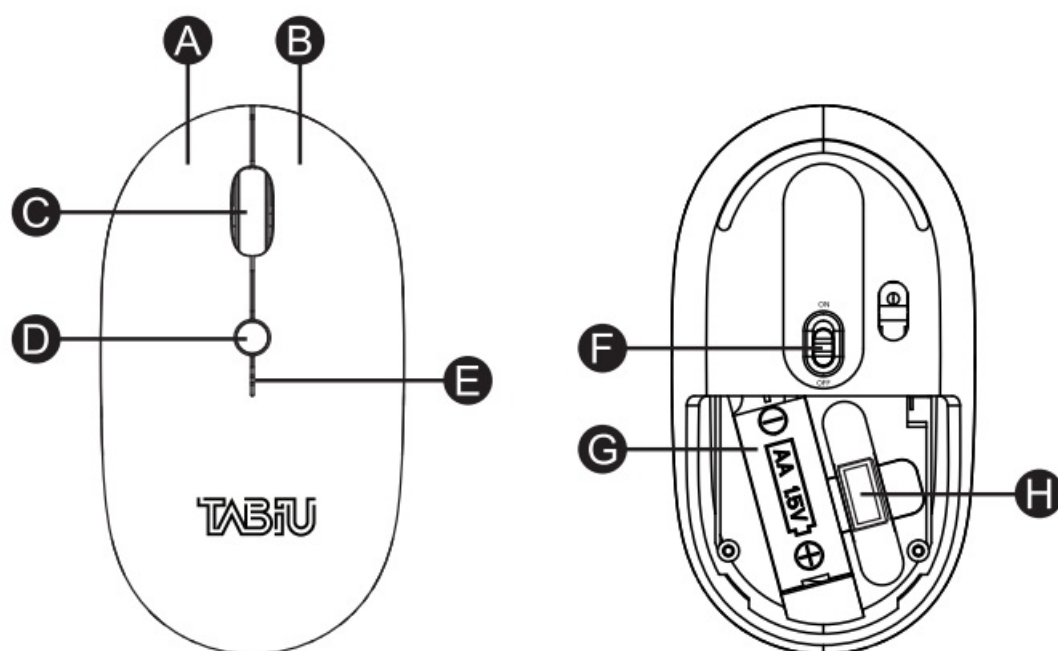

1. Left Button
2. Right Button
3. Scroll Wheel
4. DPI Switch Button
5. low battery
6. power Switch
7. battery Compartment
8. Receiving Slot

USB Installation

1. Open the battery cover,

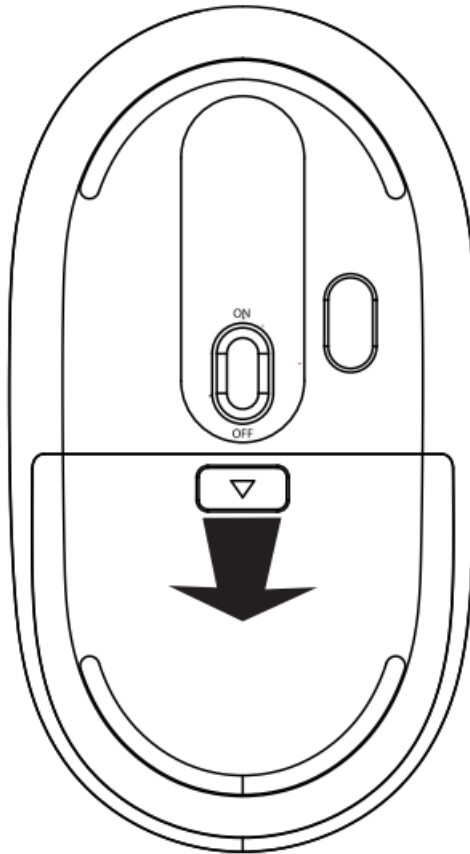

2. Install the battery and slide the power switch to "ON"

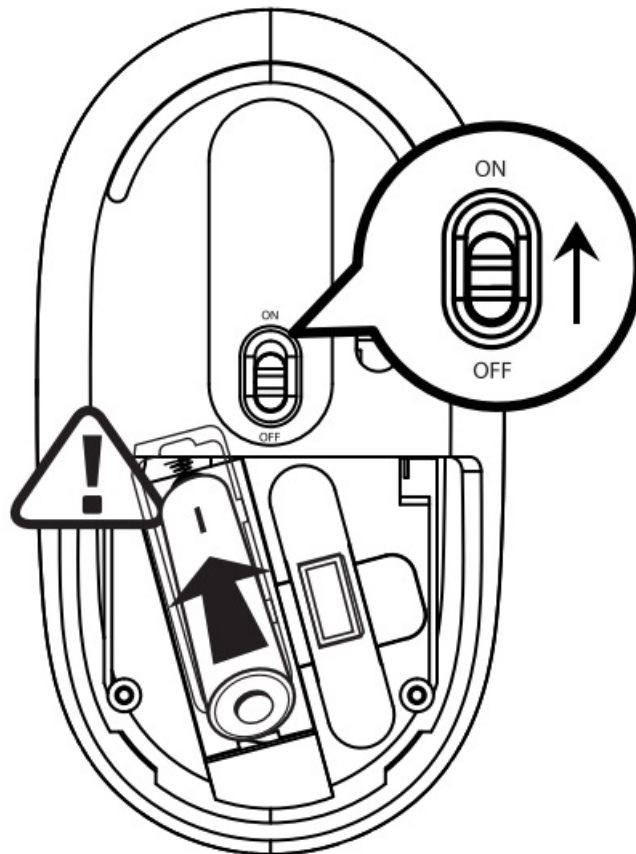

3. Take out the receiver

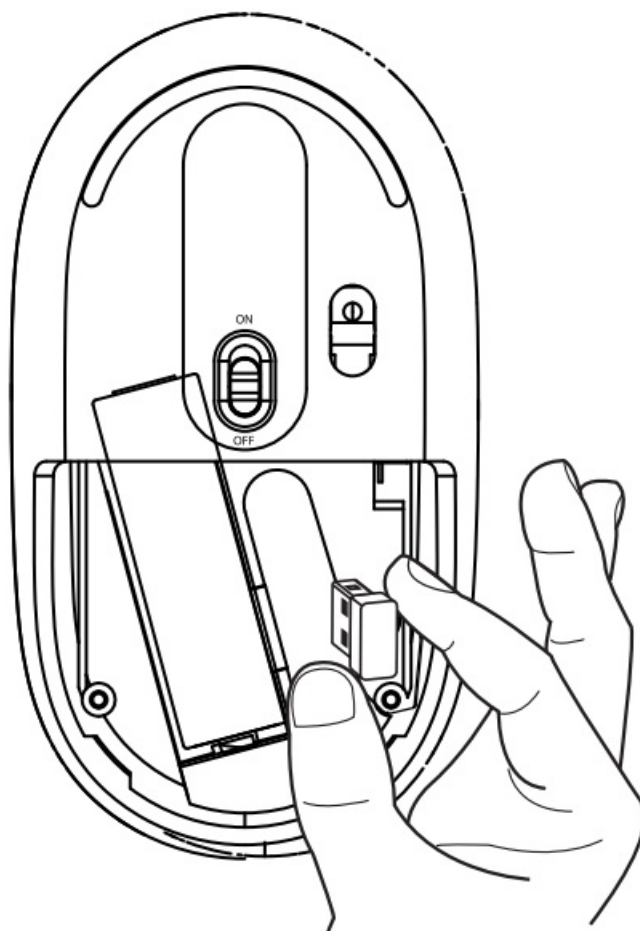

4. Plug USB into Computer

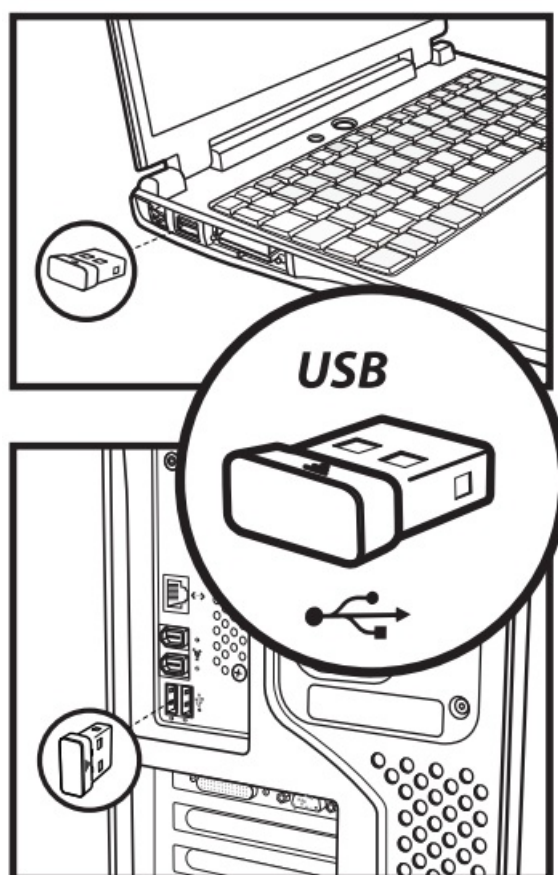

Packing List

- Wireless Mouse
- USB Receiver
- User Manual

Parameters

Specification:

Sensor: Optical

Mouse DPI: 800/1200/1600 dpi

Mouse Click Lifespan: 5000,000 times

Voltage: 1.5V

Connection Distance: 15m

Working voltage: 1.5V

Working current: 20mA

Polling Rate: 500Hz

Dimension: 109.86x60.53x32.54mm

Weight: 65.0g±5.0g

Battery: 1AA alkaline battery (not included)

System Requirement:

Windows 7, Windows 8, Windows 10 or later

Mac OS X 10.10 or later

Android 4.3 or later

FCC STATEMENT

This device complies with Part 15 of the FCC Rules. Operation is subject to the following two conditions: This device may not cause harmful interference, and This device must accept any interference received, including interference that may cause undesired operation.

Warning: Changes or modifications not expressly approved by the party responsible for compliance could void the user's authority to operate the equipment.

NOTE: This equipment has been tested and found to comply with the limits for a Class B digital device, pursuant to Part 15 of the FCC Rules. These limits are designed to provide reasonable protection against harmful interference in a residential installation. This equipment generates uses and can radiate radio frequency energy and, if not installed and used in accordance with the instructions, may cause harmful interference to radio communications. However, there is no guarantee that interference will not occur in a particular installation. If this equipment does cause harmful interference to radio or television reception, which can be determined by turning the equipment off and on, the user is encouraged to try to correct the interference by one or more of the following measures:

- Reorient or relocate the receiving antenna.
- Increase the separation between the equipment and receiver.
- Connect the equipment into an outlet on a circuit different from that to which the receiver is connected. Consult the dealer or an experienced radio/TV technician for help.

RF warning statement:

The device has been evaluated to meet general RF exposure requirement. The device can be used in portable exposure condition without restriction.

Documents / Resources

	Dongguan Lingjie Electronics Technology E100 Wireless mouse [pdf] User Manual E100, 2ANBU-E100, 2ANBUE100, E100 Wireless mouse, E100, Wireless mouse
---	---

[Manuals+](#).