



DOMETIC SPK Series Cable Set Installation Guide

[Home](#) » [Dometic](#) » DOMETIC SPK Series Cable Set Installation Guide 



DRIVING SUPPORT
PERFECT VIEW



SPK 150, SPK 160, SPK 170, SPK 180-V

© 2021 Dometic Group. The visual appearance of the contents of this manual is protected by copyright and design law. The underlying technical design and the products contained herein may be protected by design, patent or be patent pending. The trademarks mentioned in this manual belong to Dometic Sweden AB. All rights are reserved.

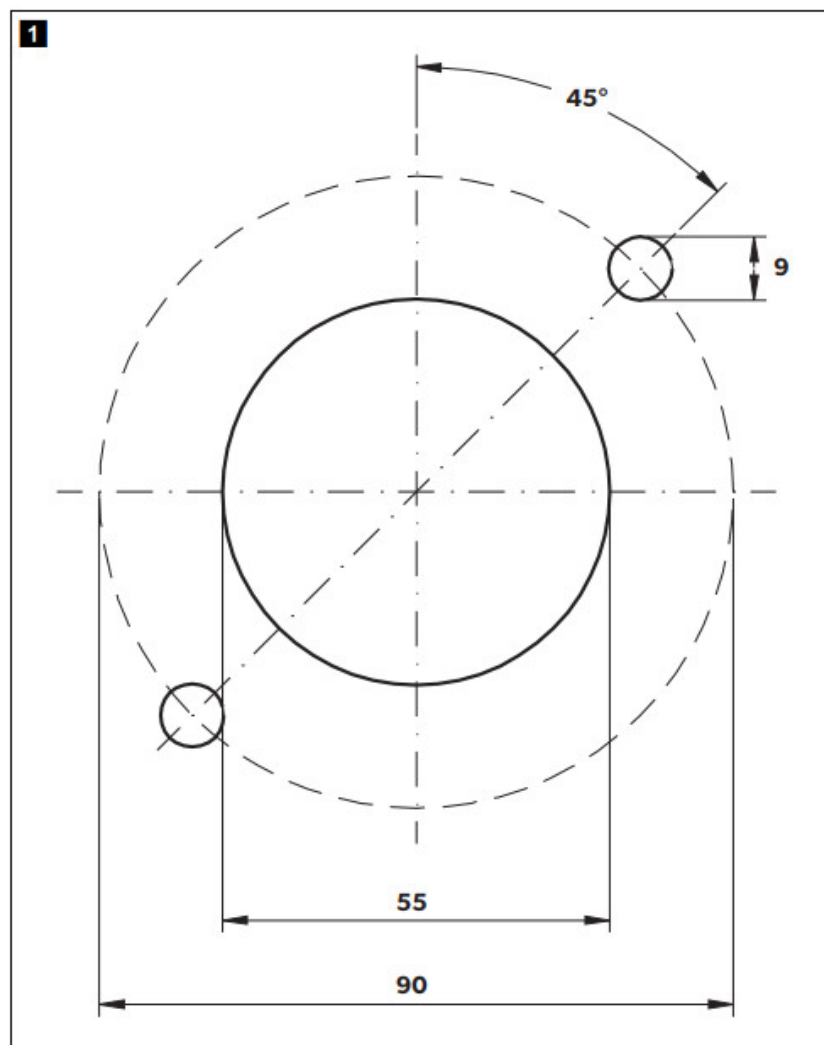

Contents

- [1 Intended use](#)
- [2 Intended use](#)
- [3 Safety and installation instructions](#)
- [4 Scope of delivery](#)
- [5 Warranty](#)
- [6 Disposal](#)
- [7 Documents / Resources](#)
 - [7.1 References](#)
- [8 Related Posts](#)

Intended use

Please read these instructions carefully and follow all instructions, guidelines, and warnings included in this product manual in order to ensure that you install, use, and maintain the product properly at all times. These instructions **MUST** stay with this product.

By using the product, you hereby confirm that you have read all instructions, guidelines, and warnings carefully and that you understand and agree to abide by the terms and conditions as set forth herein. You agree to use this product only for the intended purpose and application and in accordance with the instructions, guidelines, and warnings as set forth in this product manual as well as in accordance with all applicable laws and regulations. A failure to read and follow the instructions and warnings set forth herein may result in an injury to yourself and others, damage to your product or damage to other property in the vicinity.

This product manual, including the instructions, guidelines, and warnings, and related documentation, maybe subject to changes and pdates. For up-to-date product information, please visit documents.dometic.com,

Intended use

The spiral cable is required to connect the camera and monitor when installing the RVS reversing video system, with a manufacture date as of January 2010, in a truck with tractor and semi-trailer/trailer:

- 9600000209 SPK150 is compatible with RV-500SPK
- 9600000220 SPK160 is compatible with RV-100SPK
- 9600000235 SPK170 is compatible with CAM44 and CAM604
- 9600005573 SPK180-V is compatible with the original camera from Volvo

The cable set has been designed for the requirements of commercial use. The installation sockets are supplied ready for connection and enable easy final mounting on the vehicle.

This product is only suitable for the intended purpose and application in accordance with these instructions.

This manual provides information that is necessary for proper installation and/or operation of the product.

Poor installation and/or improper operating or maintenance will result in unsatisfactory performance and a possible failure.

The manufacturer accepts no liability for any injury or damage to the product resulting from:

- Incorrect assembly or connection, including excess voltage
- Incorrect maintenance or use of spare parts other than original spare parts provided by the manufacturer
- Alterations to the product without express permission from the manufacturer
- Use for purposes other than those described in this manual

Dometic reserves the right to change product appearance and product specifications.

Safety and installation instructions

This documentation contains mounting instructions. The manufacturer will not accept any warranty for damages resulting from incorrect installation.

When installing the spiral cable, note the following:

- Use the drilling template supplied to mark the mounting position of the sockets (fig.1, page 3).
- Always install the DIN plug connection with the socket contacts towards the camera, i.e. on the semi-trailer/trailer.
- Choose the installation position for the socket so that the required cable length does not exceed the total length of the connection cable. Please note that the required cable length will change when driving along curves or jackknifing the trailer.

Scope of delivery

Description	SPK 150	SPK160	SPK 170	SPK180-V
Sockets for towing vehicles	9102200065	9102200087	9102200173	9600005598
Sockets for semi-trailers/trailers	9102200064	9102200086	9102200172	9600005598
7-pin spiral cable	9102200204	9102200204	9102200204	9102200204

The statutory warranty period applies. If the product is defective, please contact the manufacturer's branch in your country (see dometic.com/dealer) or your retailer. For repair and warranty processing, please include the following documents when you send in the device:

Warranty

- A copy of the receipt with purchasing date
- A reason for the claim or description of the fault

Disposal

► Place the packaging material in the appropriate recycling waste bins wherever possible.



If you wish to finally dispose of the product, ask your local recycling center or specialist dealer for details about how to do this in accordance with the applicable disposal regulations.

Mobile living made is easy.



dometic.com

**YOUR LOCAL
DEALER**

dometic.com/dealer

**YOUR LOCAL
SUPPORT**

dometic.com/contact

**YOUR LOCAL
SALES OFFICE**

dometics.com/seles-offices

A complete list of Dometic companies, which comprise the Dometic Group, can be found in the public filings of:



DOMETIC GROUP AB Hemvarnsgatan 15 SE-17154 Solna Sweden

444510164427 .01.2021

Documents / Resources

	<p>DOMETIC SPK Series Cable Set [pdf] Installation Guide SPK 150, SPK 160, SPK 170, SPK 180-V, SPK Series Cable Set</p>
---	--

References

-  [Dometic Outdoor USA - Compact solutions for Outdoor living | Dometic.com](#)
-  [Contact Us | Dometic.com](#)
-  [Find a Dealer | Dometic.com](#)