

DMXINM CR2450 Built in Smart Toilet with Bidet User Guide

[Home](#) » [DMXINM](#) » DMXINM CR2450 Built in Smart Toilet with Bidet User Guide 

DMXINM CR2450 Built in Smart Toilet with Bidet

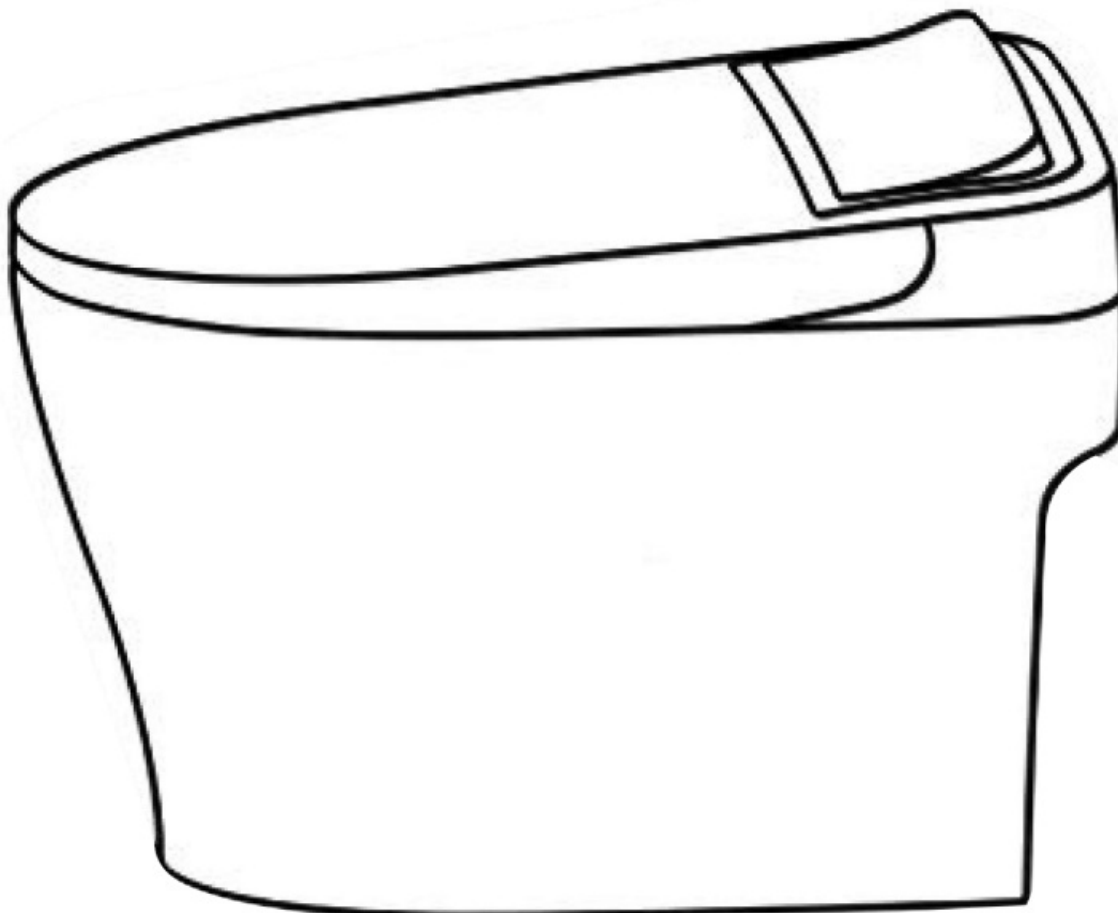

Contents

- 1 Thank you
- 2 Remote Control Instructions
- 3 Detailed Explanation of Smart Toilet Features
- 4 Function description of the side buttons
- 5 Seating sensor
- 6 Power Outage Flushing Accessory Instructions
- 7 How to Perform Daily Maintenance and Cleaning
- 8 When the nozzle function weakens
- 9 Safety Precautions
- 10 Product Specifications
- 11 Documents / Resources
 - 11.1 References

Thank you

INSTRUCTIONS FOR THE USE OF PRODUCTS

Thank you for choosing our products. Please read the instructions carefully. If you encounter any difficulties, feel free to contact us anytime, and we'll help you resolve the issues.

Remote Control Instructions

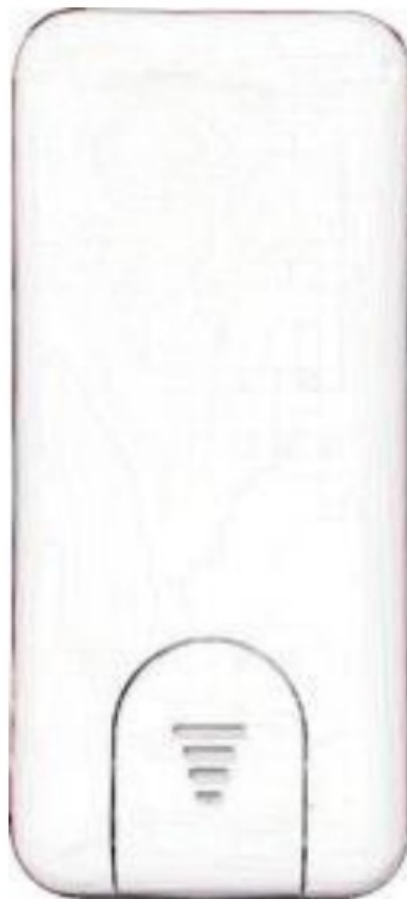

Battery Model: CR2450



Open/Close the smart toilet.

Open – Open/Close the toilet lid.

Turn over – Lift/Close the toilet seat.

Water temp – Adjust the water temperature for posterior wash/feminine wash.

Seat temp – Adjust the seat heating temperature.

Dry temp – Adjust the warm air drying temperature.

Hips/move – Initiate posterior wash; after initiation, pressing this button again will move the nozzle for cleaning.

Female/move – Initiate feminine wash; after initiation, pressing this button again will move the nozzle for cleaning.

Drying – Activate the warm air drying function.

Flow adjust – When the cleaning function is activated, press this button to adjust the water flow intensity.

Stop – Stop the currently running function.

Position adjust – When the cleaning function is activated, press this button to adjust the nozzle position.

Flush water – Activate the flushing function.

Shower – Activate the nozzle self-cleaning function.

Night light – In the powered-on state, turn on/off the night light function.

Energy conservation – Initiate energy-saving mode.

Detailed Explanation of Smart Toilet Features

1. Automatic Toilet Seat Opening/Closing Function Instructions

To enable or disable the automatic opening/closing of the toilet seat, long-press the “Open” button on the remote control for 3 seconds and wait to hear a “drip” sound, indicating that the smart toilet has executed the command to turn on/off the automatic seat opening/closing function.

2. Automatic Flushing On/Off Instructions

To activate or deactivate the automatic flushing function, long-press the “Flush water” button on the remote control for 3 seconds and wait to hear a “drip” sound, indicating that the smart toilet has executed the command to turn on/off the automatic flushing.

3. Water Temperature Adjustment

To adjust the water temperature, use the “Water temp” button on the remote control. There are four temperature levels to choose from: room temperature, 34°C, 37°C, and 40°C.

4. Seat Temperature Adjustment

To adjust the seat temperature, use the “Seat temp” button on the remote control. There are four temperature levels to choose from: room temperature, 34°C, 37°C, and 40°C.

5. Warm Air Temperature Adjustment

To adjust the warm air temperature, use the “Dry temp” button on the remote control. There are four levels to choose from: room temperature, 01, 02, and 03.

6. Warm Air Drying Function Instructions

To use the warm air drying function, a person must be seated on the toilet seat for it to activate. The seat has a sensor to prevent accidental activation. Press the “Drying” button on the remote control to start the drying process and press the “Stop” button after drying is complete.

7. Hip Cleaning Function Instructions

To use the hip cleaning function, a person must be seated on the toilet seat for it to activate. The seat has a sensor to prevent accidental activation. Press the “Hips” button on the remote control to start the hip cleaning function. The nozzle will first self-clean and then perform the cleaning process. Use the “Flow adjust” button to increase or decrease water flow, and use the “Position adjust” button to move the nozzle forward or backward. Press the “Stop” button after cleaning is complete.

8. Female Cleaning Function Instructions

To use the female cleaning function, a person must be seated on the toilet seat for it to activate. The seat has a sensor to prevent accidental activation. Press the “female” button on the remote control to start the female cleaning function. The nozzle will first self-clean and then perform the cleaning process. Use the “Flow adjust” button to increase or decrease water flow, and use the “Position adjust” button to move the nozzle forward or backward. Press the “Stop” button after cleaning is complete.

9. Foot Sensor to Open Toilet Seat Explanation

When using the toilet, the smart toilet will sense the presence of a person and automatically open the toilet seat. For male urination, you can use the foot sensor to open the toilet seat. After the toilet seat is open, simply bring your foot close to the sensor device located under the toilet, and the seat will automatically open.

10. Night Light Switch Instructions

The night light can be turned on/off by long-pressing the “Night light” button on the remote control.

Function description of the side buttons

	<p>Power On/Off Button Press and hold this button to power on/off the smart toilet.</p>
	<p>Warm Air Drying Button Press this button to activate the warm air drying function.</p>
	<p>Female Cleaning Button Press this button to activate the female cleaning function.</p>
	<p>Hip Cleaning Button Press this button to activate the hip cleaning function.</p>
	<p>Flush Button Press this button to activate the flush function.</p>

Seating sensor



The seat is equipped with sensors.

Even if the switch is mistakenly pressed when no one is seated, it won't spray water. Without someone on the seat, the rear wash and female wash functions won't activate.

Power Outage Flushing Accessory Instructions



The power outage flushing accessory is compatible with a 9V battery and is intended for maintaining the toilet's flushing function during unexpected power outages. Please remove the device during regular use to prevent unnecessary battery depletion.

How to Perform Daily Maintenance and Cleaning

Unplug power and make sure power is off before cleaning.

Wipe with a soft, damp cloth.

Clean up stains promptly to prevent lingering marks.

Cleaning with a damp cloth helps prevent static electricity.

Static electricity can attract dust and may cause the toilet to appear darker or dirtier.

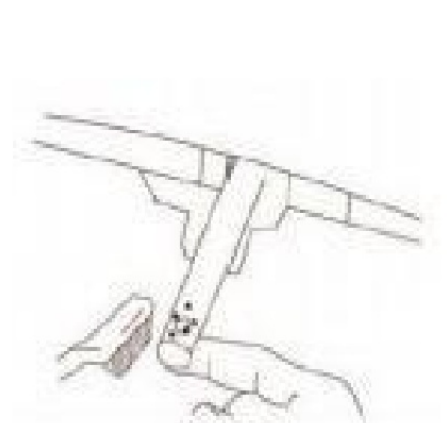
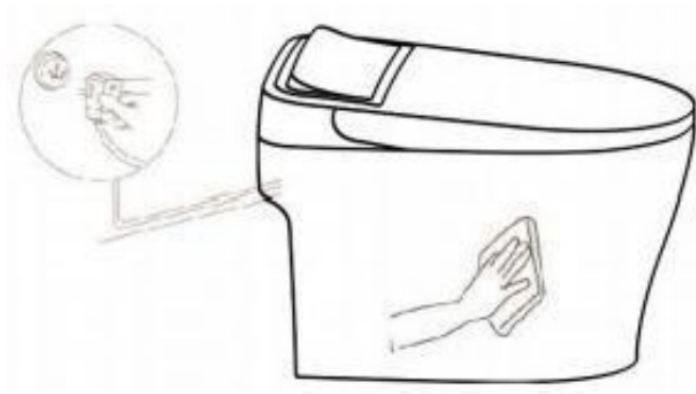

Nozzle Cleaning

Use a small brush to clean nozzle.

- Do not forcibly stretch or bend the nozzle.

Please regularly remove the dust adhering to the power cord. Unplug the power plug when cleaning, Wipe with a dry cloth.

- Poor insulation may cause a fire.

When the nozzle function weakens

Please clean the filter with the following step if water pressure weakens. (Cleaning frequency depends on water quality)

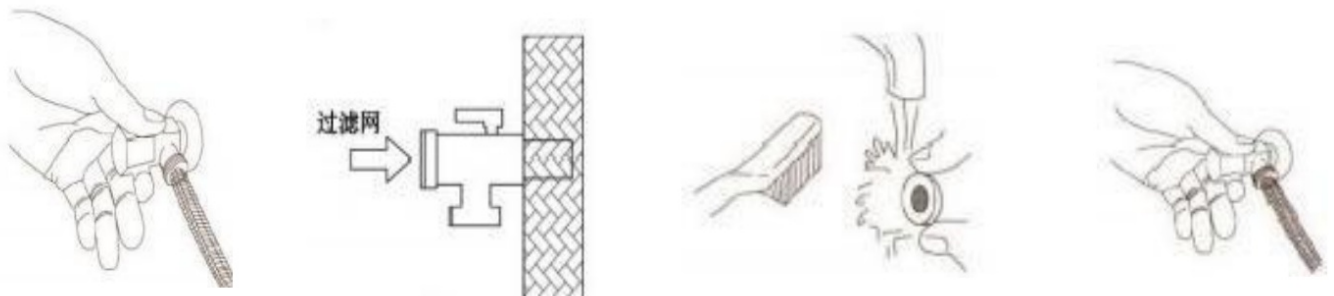

1. Turn off valve, make sure no water supply. Turn and remove filter.
2. Place a basin underneath the valve for water dripping. Be sure valve is off before removing filter. Do not over tighten water hose when installing filter. May cause leaking.
3. Use a small brush and water to clean the filter.
4. Put the filter back from its original direction. Tighten the hose.
5. Turn on valve.
6. Test before using.

Safety Precautions

1. Plug in the power cord Before use, please make sure that the power cord is plugged in. The plug and the

socket are tightly fitted and there must be no loose or incomplete insertion, otherwise it may cause accidental fire due to overheating.

2. Please unplug the power cord when not using this product for a long time.
3. When the toilet is clogged, please unplug the power cord and use a commercially available pipe to unclog it. If the power plug is not unplugged, it will be cleaned in auto mode. It may cause sewage overflow and indoor flooding.
4. Do not expose this product to direct sunlight. Easy to cause discoloration, aging or cracking of the product.
5. Do not pour water or cleaning products on the power plug.
6. This product is an electrical device. Please do not install it in a location prone to water splashes or high humidity. When used in the bathroom, ensure the installation of a ventilation fan or ventilation port to maintain optimal air circulation.
7. Use power wiring as follows:

The socket circuit should be safeguarded by a high-sensitivity and fast-leakage switch (rated induction current below 15mA) or an insulating transformer (above 1.5KVA and below 3KVA). Install the socket at a distance greater than 0.3m from the ground and as far away as possible from the bathtub.
8. Ground wire must be connected. The term "ground wire" mentioned here indicates that the grounding resistance should be below 100Ω, and a copper wire with a diameter of 1.6mm or more should be used for the ground wire of the switchboard.

Product Specifications

Category		Specification	
Rated Voltage		AC 120V±10%, 50HZ/60HZ	
Power		1600W (under the condition of water inlet temperature 15°C, 240kpa)	
Cleaning Feature	Water Output	Hip Wash	Approximately 700ml/min
		Feminine Wash	Approximately 700ml/min
	Water Temp		Room temp,34°C, 37°C, 40°C (4 levels)
	Water Heating		Instant heating
	Heating power		1300W
	Safety devices		Inlet and outlet water temperature sensor, temperature fuse, thermostat, leakage protector
Dryer Feature	Warm Air Temp		Room temp, 48°C, 55°C, 60°C(4levels)
	Air Speed		>4m/s
	Heating power		Avg 220W(Max. 350W)
	Safety Devices		Bimetal strip, temperature fuse
Seat Heating	Seat Temp		Room temp,34°C,37°C,40°C(4levels)
	Heating power		Approximately 45W
	Safety Devices		Temperature sensor, temperature fuse
Mobile Cleaning		Nozzle moves back and forth 2cm	
Nozzle Setting		Adjustable front and rear	
Water Temp		3 35°C	
Water Pressure		0.15-0.75mpa	

Documents / Resources

	<p>DMXINM CR2450 Built in Smart Toilet with Bidet [pdf] User Guide</p> <p>CR2450 Built in Smart Toilet with Bidet, CR2450, Built in Smart Toilet with Bidet, Smart Toilet with Bidet, Toilet with Bidet</p>
---	---

References

- [User Manual](#)

Manuals+. Privacy Policy

This website is an independent publication and is neither affiliated with nor endorsed by any of the trademark owners. The "Bluetooth®" word mark and logos are registered trademarks owned by Bluetooth SIG, Inc. The "Wi-Fi®" word mark and logos are registered trademarks owned by the Wi-Fi Alliance. Any use of these marks on this website does not imply any affiliation with or endorsement.