



Contents [[hide](#)]

- [1 DK2 MFT4X8 Series Folding Utility Trailer](#)
- [2 TECHNICAL SPECIFICATIONS](#)
- [3 SAFETY](#)
- [4 ASSEMBLY](#)
- [5 PARTS & SCHEMATICS](#)
- [6 WARRANTY](#)
- [7 FAQ](#)
- [8 Documents / Resources](#)
 - [8.1 References](#)



DK2 MFT4X8 Series Folding Utility Trailer



TECHNICAL SPECIFICATIONS

	MFT4X8	MFT4X8G
--	--------	---------

PAYLOAD CAPACITY	1,383 lb (627 kg)	1,379 lb (625 kg)
GVWR	1,720 lb (780 kg)	
WHEELS & TIRES	5.30-12, 550 kPa (80 PSI), 12 x 5 rim	
MATERIAL	UV Powder Coated Steel	Hot-Dip Galvanized Steel, Galvanneal
RAILS	Tubular steel (sold separately)	
FLOORING	Solid steel, anti-slip textured	
LIGHTING	Pre-wired, quick connect D.O.T. LED with flat 4-wire harness and connector	
COUPLER	2" (~5 cm), Class II 3,500 lb (1,587 kg)	
BED DIMENSIONS	96" (L) x 48" (W) / 243.8 cm (L) x 121.9 cm (W)	
DIMENSIONS	135" (L) x 62.3" (W) x 20" (H) / 342.9 cm (L) x 158.2 cm (W) x 50.8 cm (H)	
WEIGHT	337 lb (152 kg)	341 lb (154 kg)
SHIPPING DIMENSIONS	48.4" (L) x 62.2" (W) x 7.9" (H) / 122.9 cm (L) x 158 cm (W) x 20.1 cm (H)	
SHIPPING WEIGHT	376 lb (170 kg)	381 lb (172 kg)
WARRANTY	1-year limited	

SAFETY

SAFETY CONVENTIONS

DANGER! This indicates a hazardous situation, which, if not avoided, could result in

death or serious injury.

WARNING! This indicates a hazardous situation, which, if not avoided, could result in minor or moderate injury.

CAUTION! This information is important in proper use of your machine. Failure to follow this instruction could result in damage to your machine or property.

ADDITIONAL INFORMATION AND POTENTIAL CHANGES

We reserve the right to discontinue, change, and improve our products at any time without notice or obligation to the purchaser. The descriptions and specifications contained in this manual were in effect at printing. Equipment described within this manual may be optional. Some illustrations may not be applicable to your machine.

IMPORTANT SAFETY CHECKLIST

Trailers are generally not used everyday. Your trailer may sit for extended periods of time between uses making it very important to check all components thoroughly before each use. Following these simple instructions will maximize the life of your trailer and help you safely transport cargo.

CAUTION! DO NOT ABUSE THE TRAILER: Trailer performance is best if you follow the guidelines set forth in this manual. Do not force the trailer to do a job it is not designed for. Know your trailer; learn its applications and limitations.

1. Make sure the towing vehicle as well as the hitch are capable of towing the trailer.
Check your vehicle owner's manual for trailering things.
2. Inspect the trailer and all of its parts before each use.
3. Check the operation of all lights. Operating lights are mandatory on a trailer.
4. Check to ensure wheel bolts are tight. Torque to 85-90 ft.-lbs. Re-tighten after the first 50 miles (80km).
5. Check the tire pressure. Maximum 80 PSI (550 KPA) when carrying the maximum rated load.
6. Re-pack the wheel bearings every 2,000 miles (3,200km) or a minimum of once every year.
7. Check that the trailer coupler is fastened securely onto the trailer ball. The trailer ball must be a 2-inch ball.
8. Make sure the safety chain is attached to the trailer and the towing vehicle.

9. If your trailer has an optional side kit, make sure all bolts and pins are in place before transporting your trailer.
10. Do not exceed the Gross Vehicle Weight Rating (G.V.W.R.) which is shown on the trailer serial/certification label.
11. Balance and secure the load on the trailer. See “Loading Your Trailer” section.
12. Lubrication of the coupler, springs, and the tilt mechanism should be done periodically to stop corrosion and keep parts moving freely.

DANGER! KEEP CHILDREN AWAY: Be sure children are kept a safe distance from the trailer operating area.

DANGER! NEVER SIT OR RIDE ON THE TRAILER: Serious injury or death could occur.

DANGER! EXERCISE EXTREME CAUTION WHEN TILTING THE TRAILER: There are many areas of the trailer where injury can occur if used improperly. The trailer may tilt quickly and unexpectedly during the loading and unloading process. The tilt option should not be used for heavy loads.

DANGER! Ramps should be used for loading heavy items.

DANGER! Do not drive with the trailer in the tilted position.

DANGER! Do not load more than one all-terrain vehicle onto this trailer.

DANGER! If the trailer is incorrectly attached to the vehicle, it could pull away from the vehicle and fall off.

DANGER! Secure the trailer to the towing vehicle before transportation. Make sure coupler is locked and the safety chains are attached to the trailer and the vehicle.

DANGER! Secure your cargo into the trailer properly and in compliance to local laws.

DANGER! When driving do not exceed the speed limit. Braking time can be considerably longer when a vehicle is towing a loaded trailer.

DANGER! Any modifications made to the trailer or parts of the trailer will void the trailer warranty and release Marlon Recreational Products Ltd. of any responsibility for damages, injuries or accidents incurred.

LIGHTING & WIRING MAINTENANCE

DANGER! USE ONLY ORIGINAL EQUIPMENT PARTS AND ACCESSORIES: Consult Marlon at 1 [888-277-6960](tel:888-277-6960) for the recommended accessories. The use of improper

accessories may cause hazards or injuries.

WIRING LEGEND				
SYMBOL	COLOR	DESCRIPTION	OPERATION	
G	Green Wire	Passenger Side (Right)	Right Signal	Brake
B	Brown Wire	Running Lights	Tail Light Marker	Yellow Front Side Markers
Y	Yellow Wire	Driver Side (Left)	Left Signal	Brake
W	White Wire	Ground	Trailer Ground	

NOTE:

Brake light goes out on the side that is signaling. Lower Filament (Brighter light) = Brake & Signal. Higher Filament (Dimmer Light) = Running Lights

TO TEST THE VEHICLE WIRING:

You will need a 12v light tester. Attach the wire clamp of the tester to the ground wire on the vehicle plug. Then touch the tester pin into one of the vehicle plug contacts. Turn on the corresponding vehicle operation i.e. Running Lights. This will illuminate the tester light if the vehicle wiring is correct. Follow this same procedure for the signal and brake lights.

TO TEST THE TRAILER WIRING:

Once you have confirmed that the vehicle trailer plug is operating properly, connect the trailer plug into your vehicle. To proceed to test each of the lights and power leads using your 12v light tester. Follow the wiring legend and diagram to test each corresponding wire for power when the trailer light is not operating.

CAUTION! Always be sure to check your brake, running and signal lights before each

use. Make sure that all of your connections are solid and that all wiring is in good condition.

CAUTION! Bare, stripped, or pinched wire will cause a short in the trailer, which will cause the vehicle fuse to blow. A solid ground is required for your lights to work properly. All contacts must be to bare metal. Light covers should be well maintained and kept clean. Be sure that your lights are always visible, not obstructed by your load.

LOADING YOUR TRAILER

- Distribute the weight evenly.
- Center the load over the axle, keeping about 10% of the weight on the tongue. (If vehicle wheels are not on a crossbeam you will need to add wood to the floor to support each axle.
- Center the load from side to side.
- Always secure your cargo into the trailer properly and in compliance to local laws.

WARNING! Do not build your trailer load higher than 3 feet. Higher loading will affect trailer handling due to increased wind resistance. This may cause violent movements, accidents and serious injury.

WARNING! TRAILER CAPACITY

- Never overload your trailer. Each trailer has a maximum payload that should not be exceeded. Overloading your trailer could cause serious damage to your trailer as well as the towing vehicle. Please refer to your trailer serial/certification label located on the same frame of the trailer for capacity details.
- The Gross Vehicle Weight Rating (G.V.W.R.) is the weight of the trailer + the maximum payload the trailer can carry. The trailer weight and the payload must not exceed this weight rating.
- Be sure that any load carried in your trailer does not extend beyond the frame of your trailer. Never place loads on one side only.

WARNING! TONGUE WEIGHT

- The tongue weight is 10% of the load (this does not include the weight of the trailer).

- The load is divided so that 90% of the load is over the axle and 10% is over the tongue.

TRAILER COUPLER

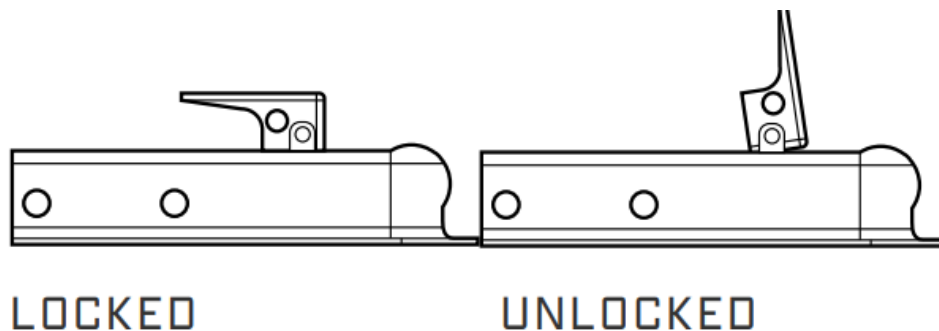

TO ADJUST COUPLER TO BALL:

Set the coupler and tongue onto the 2-inch trailer ball on your vehicle. Raise the locking lever, push up on the channel lock and turn nut to tighten or loosen the coupler. Proper adjustment is obtained when the coupler is as tight as possible on the ball and the locking lever can still be opened and closed.

CAUTION! Before towing your trailer be sure to check the capacity of your trailer hitch on your vehicle (never exceed this or your trailer's capacity). The DK2® by Marlon Trailer is equipped with a 2-inch coupler and must be used with 2-inch trailer ball. Make sure that the trailer ball is completely engaged in the coupler ball.

WHEEL BEARING & HUB ASSEMBLY

NOTE: No parts are more critical for the dependable performance of your trailer than the bearings, races, and seals. To ensure that your trailer performs reliably, you should inspect the bearings, races, and seals and re-pack the bearings every 12 months or 3,200km (2,000 miles). This is easily found on the internet by searching "Trailer Wheel Bearings Maintenance".

RE-PACKING WHEEL BEARINGS

1. Loosen wheel bolts (do not remove)
2. Support trailer so wheel is off the ground (jack stand – floor jack – block)
3. Remove nuts and wheel

- 4. Disassemble hub
- 5. Clean hub and pack bearings with wheel bearing grease
- 6. Re-install bearings, nut and cotter pin **WARNING! DO NOT** over-tighten nut. The hub must turn freely and without play.
- 7. Re-attach bolts and wheel (torque to 80 ft-lbs.)

ASSEMBLY

TOOLS REQUIRED

WRENCH / SOCKET	16 mm, 17 mm, 18 mm, 19 mm, 20 mm, 21 mm
PLIERS	
PHILLIPS SCREWDRIVER	
RUBBER Mallet	

NOTE: The trailer parts are called out by standing at the rear of the trailer looking toward the hitch. The trailer frame parts are labeled • Do not tighten any nuts and bolts until the entire trailer is assembled. Periodically check all the nuts and bolts for tightness Tighten the wheel lug nuts to 85-90 ft.-lbs. (115.24 -122.02 Nm) of torque after assembling the trailer, after the first 20, 50, and 100 miles (30, 80, 160 kilometres) of driving and before each tow thereafter.

STEP 1: FRAME

Lay the front frame (1) and rear frame (2) as shown. Note the location of the marker light holes in the front side rails.

- 1. Use M10 x 20 hex bolts (6), M10 nuts (7), and M10 washers (8) to mount the eight stake pockets (3) to the trailer as shown.
- 2. Use M10 x 20 hex bolts (6), M10 nuts (7) and M10 washers (8) to mount the front hinges (4) to the front frame (1) and the rear hinges (5) to the rear frame (2).
- 3. Connect the two frames with M10x 20 hex bolts (6), M10 nuts (7), and M10 washers (8).

ITEM N°	DESCRIPTION	PART N°	QTY
1	Front frame weldment	100-0168	1
2	Rear frame weldment	100-0169	1
3	Stake pocket	100-0180	8
4	Front frame deck hinge	100-0181	2
5	Rear frame deck hinge	100-0182	2
6	M10 x 20 hex bolt	210-0135	28
7	M10 nylock nut	210-0003	28
8	M10 washer	210-0002	28

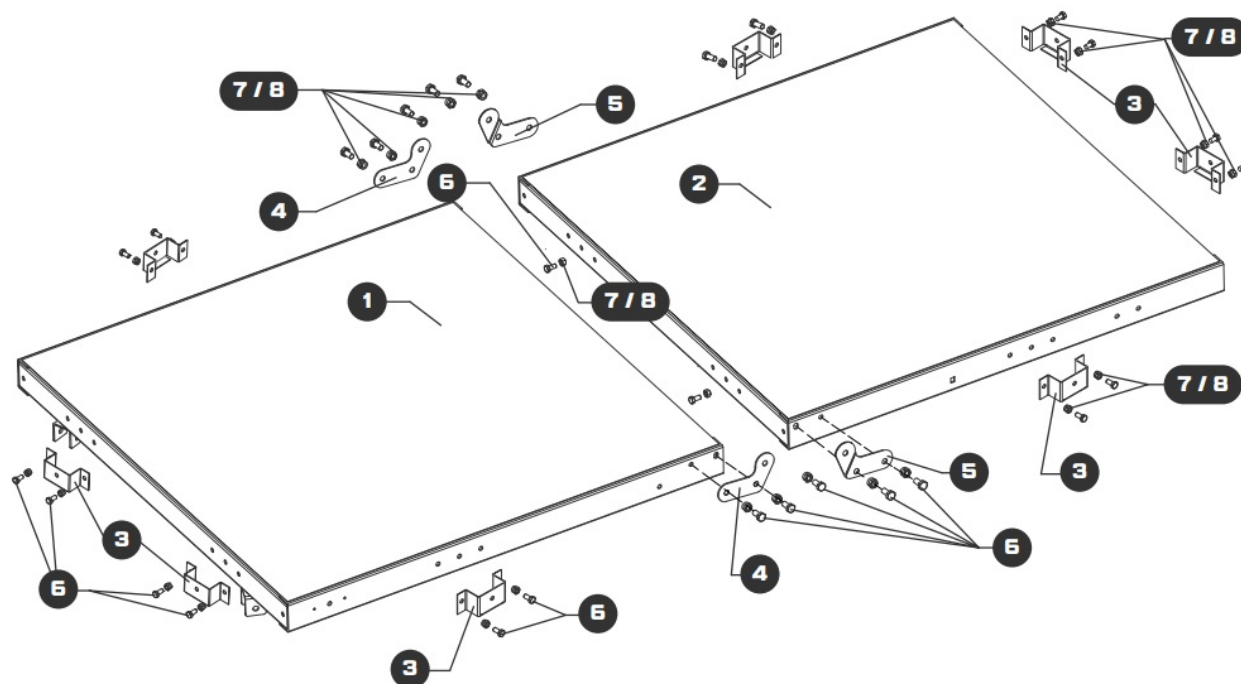

STEP 2: TONGUE

1. Flip the front frame (1) over so it is upside down.
2. Position tongue (2) to the front frame (1), fitting the tongue (2) into the U bracket on the front cross member.

3. Use L-pin (3) to go through the U bracket and lock with R-pin (12) after.
4. Use M10 x 30 (4) hex bolts, M10 nuts (5), and M10 washers (13), and M12 x 25 hex bolts (6), M12 nuts (7), and M12 washers (14) to connect the tongue (2) ends to the tow bar connect hangers (8). Do not tighten the bolts until the assembly is complete.
5. Connect the tongue bottom plate (9), and coupler tongue top plate (10) as shown with M10 x 20 hex bolts (11), M10 nuts (13), and M10 washers (14).

ITEM N°	DESCRIPTION	PART N°	QTY
1	Front frame weldment	100-0168	1
2	Tongue weldment	100-0170	2
3	L-pin	207-0031	2
4	M10 x 30 hex bolt	210-0093	2
5	M10 nylock nut	210-0003	14
6	M12 x 25 hex bolt	210-0138	2
7	M12 nylock nut	210-0015	2
8	Tow bar connect hanger	100-0179	2
9	Tongue bottom plate	100-0172	1
10	Coupler tongue top plate	100-0171	1
11	M10 x 20 hex bolt	210-0135	12
12	R-pin	207-0012	2
13	M10 washer	210-0002	14
14	M12 washer	210-0004	2

5	M10 x 25 carriage bolt	210-0001	4
6	M10 nylock nut	210-0003	10
7	M10 washer	210-0002	10

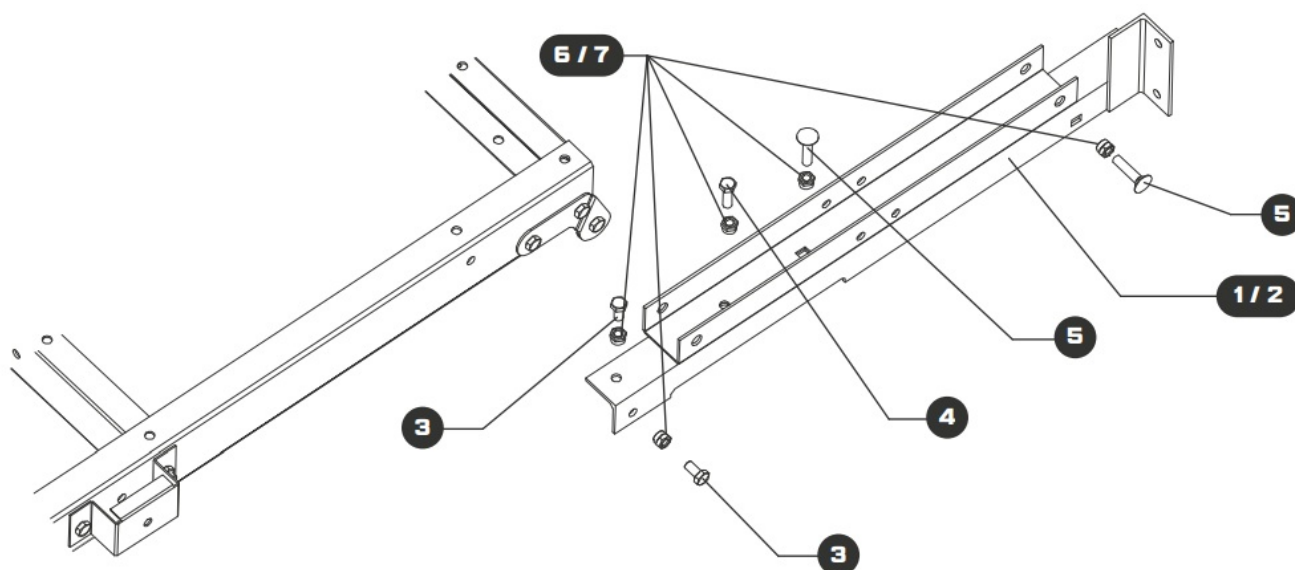

STEP 4: FENDERS

NOTE: You will have to prop up the bed to give yourself space to attach the fender and caster brackets

1. Connect the fender brackets (1) to the spring hangers (2, 3) with M10 x 20 hex bolts (8), M10 nuts (9), and M10 washers (10).
2. Connect the fenders (4) to the fender brackets (1) with M10 x 20 hex bolts (8), M10 nuts (9), and M10 washers (10).
3. Connect the caster brackets (5, 6) to the spring hangers (2, 3) with M10 x 20 hex bolts (8), M10 nuts (9), and M10 washers (10).
4. Install the casters (7) to the caster brackets (5, 6) and secure with M10 nuts (9) and M10 washers (10).

NOTE: The holes on the side of the fender edge should be facing toward the trailer.

ITEM N°	DESCRIPTION	PART N°	QTY
---------	-------------	---------	-----

1	Fender bracket	100-0173	2
2	Left spring hanger	100-0177	1
3	Right spring hanger	100-0178	1
4	Fender	206-0037	2
5	Right caster bracket	100-0184	1
6	Left caster bracket	100-0185	1
7	Caster	216-0007	4
8	M10 x 20 hex bolt	210-0135	12
9	M10 nylock nut	210-0003	16
10	M10 washer	210-0002	16

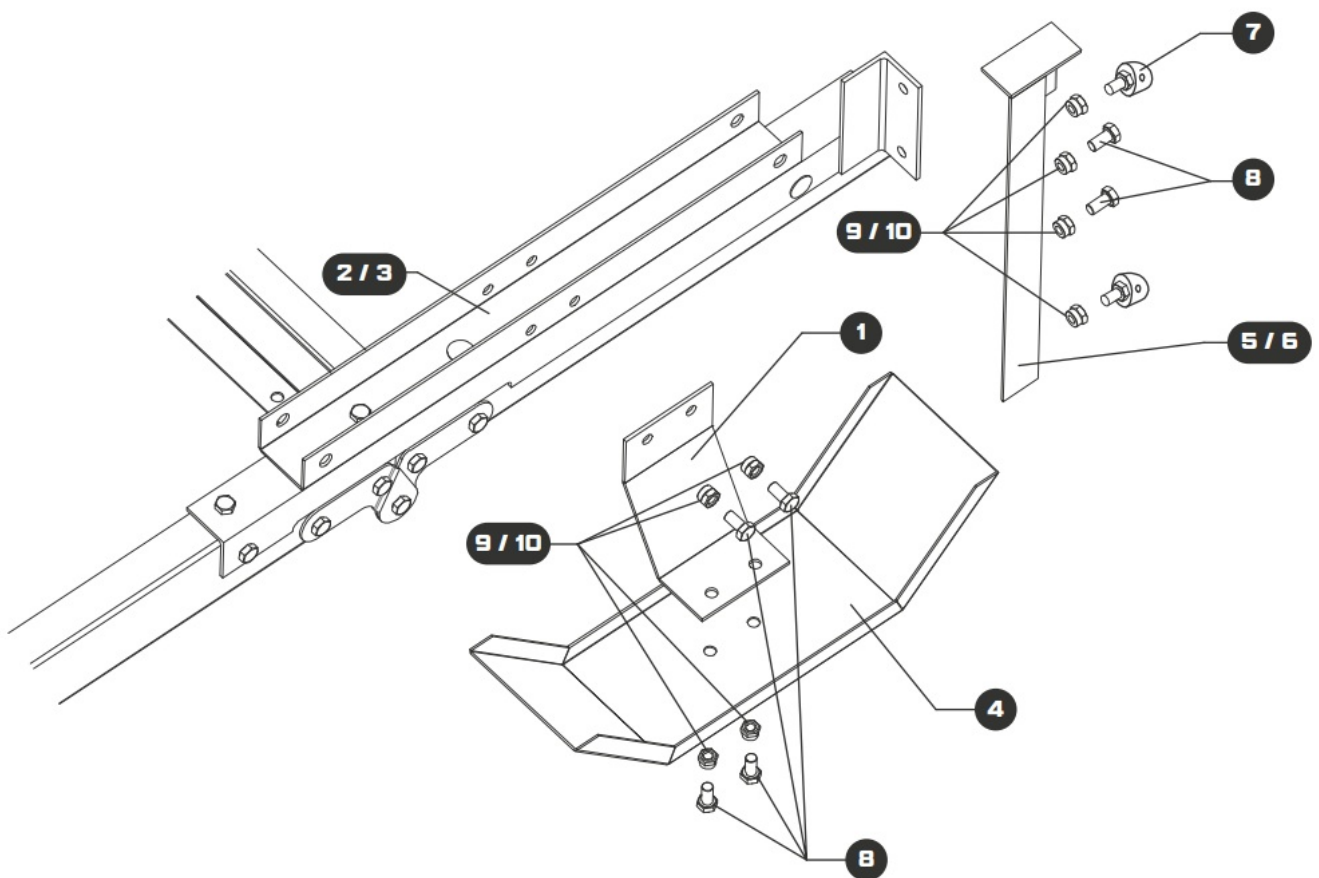

STEP 5: SPRING AND AXLE

1. Place the 3-leaf springs (1) into the spring hangers (2, 3) with the eye facing forward towards the tongue of the trailer. Secure with M14 x 85 hex bolts (7) and M14 nuts (9) by going through the spring hangers (2, 3) and spring eyes as well as above the rear of the spring.
2. Place the axle (4) onto the 3-leaf springs (1) with the hole on the axle over the peg on the spring. Fasten the axle to each spring with M10 x 95 x 38 U-bolts (6), M10 nuts (8), and M10 washers (10) through the spring plate (5).

ITEM N°	DESCRIPTION	PART N°	QTY
1	3-leaf spring	219-0003	2
2	Left spring hanger	100-0177	1
3	Right spring hanger	100-0178	1
4	Axle	310-0113	1
5	Spring plate	100-0035	2
6	M10 x 95 x 38 U-bolt	210-0154	4
7	M14 x 85 hex bolt	210-0092	4
8	M10 nylock nut	210-0003	8
9	M14 nylock nut	210-0064	4
10	M10 washer	210-0002	8

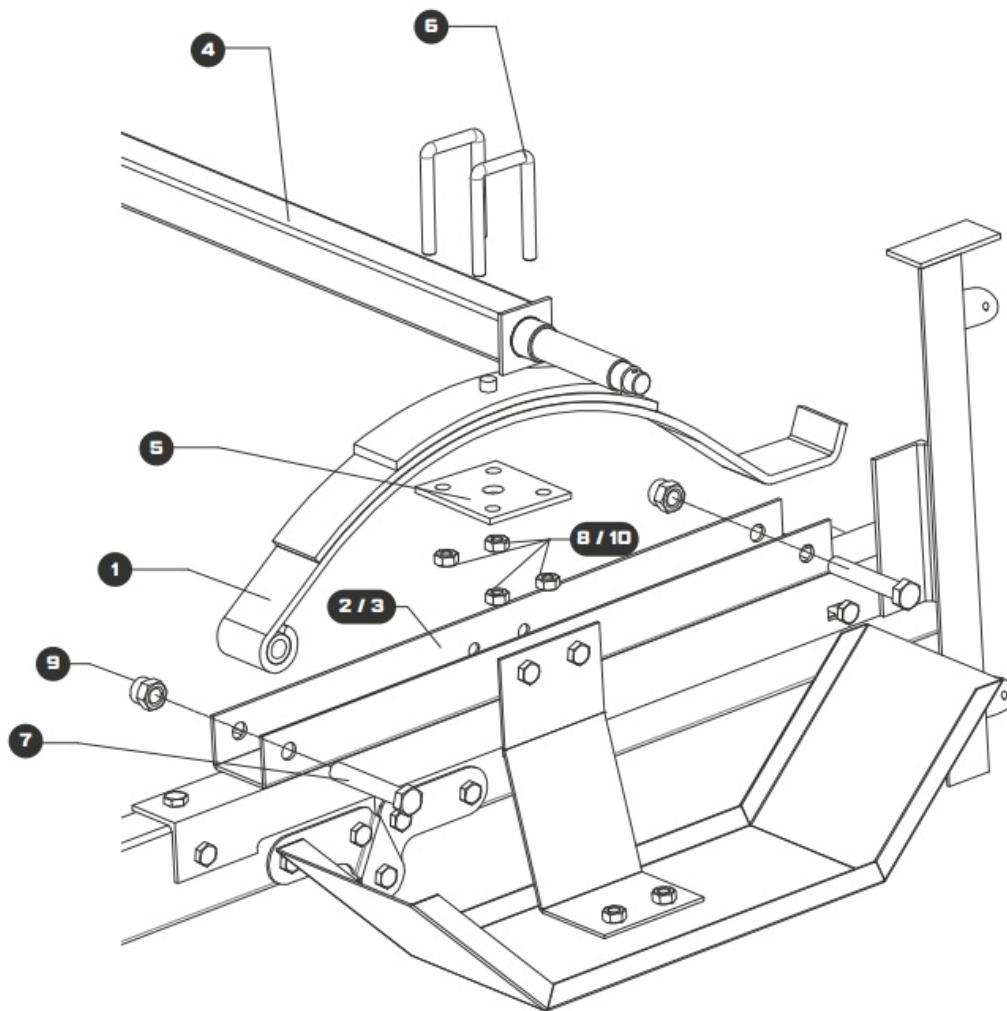

STEP 6: TIRES

1. Locate both tires (1) and hub assemblies (2). For easy access, be certain that grease fittings (11) are facing out away from the hub (2) as shown in FIG A.
2. Remove the dust cap assembly (3, 4) using a small pry bar between the flange on the dust cap (3, 4) and the face of the hub (2) (FIG B).
3. Remove the cotter pin (5), bearing (6), and washer (7). See FIG C.
4. Remove castle nut (8), from axle (9) ends.
5. Carefully slide the tire (1) and hub assembly (2) onto the axle (9) with lug nuts (10) facing outward. See drawing below.
- 6.

ITEM N°	DESCRIPTION	PART N°	QTY
1	Tire and wheel	220-0044	2
2	Hub assembly	310-0078	2

3	Dust cap with hole	229-0067	2
4	Rubber dust cap	229-0105	2
5	Cotter pin	207-0006	2
6	Bearing (30205)	202-0004	2
7	M22 washer	210-0165	2
8	M22 x 1.5 castle nut	210-0166	2
9	Axle	310-0113	1
10	Lug nut	210-0012	10
11	Grease fitting	229-0083	2

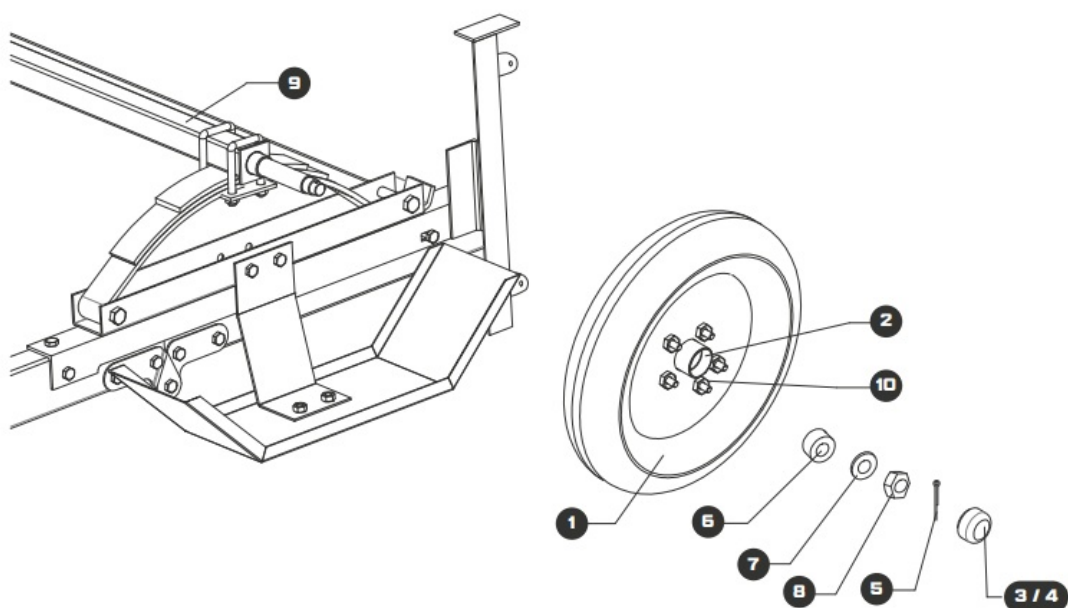
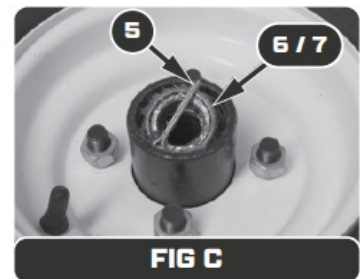
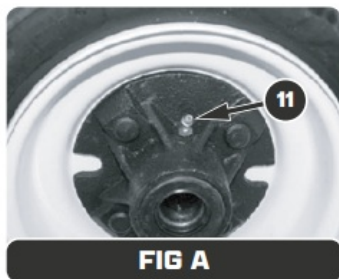

Install the bearing (6) with the taper facing inward toward the hub (2).

7. Install the washer (7) and castle nut (8). Tighten the castle nut (8) while turning the

tire/hub (1, 2). Tighten the castle nut (8) until there is resistance while turning the tire/hub (1, 2).

8. Install the cotter pin (5) through the castle nut (8) and hole in the axle (9) end. If holes are not aligned, slightly loosen the castle nut (8) – no more than one castellation – to align holes.
9. Spread the cotter pin (5) to retain the castle nut (8). See FIG D.
10. Pump approximately 8-10 pumps of a hand grease gun into the hub (2).
11. Install the dust cap (3, 4) firmly on the hub (2) with a rubber mallet. See FIG E.
12. Repeat steps 2-11 for the other tire/hub (1, 2).
13. While the trailer is still upside-down, move to installing the wiring.

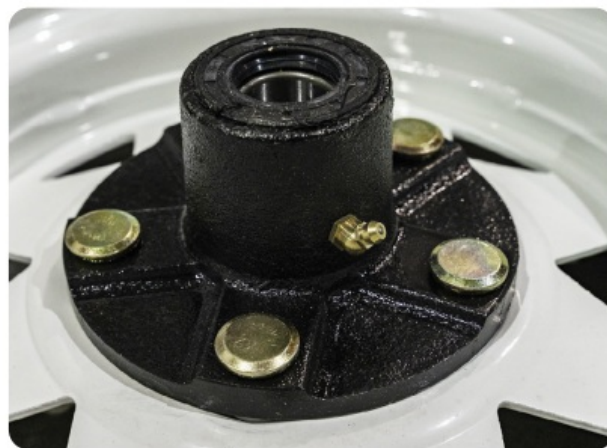
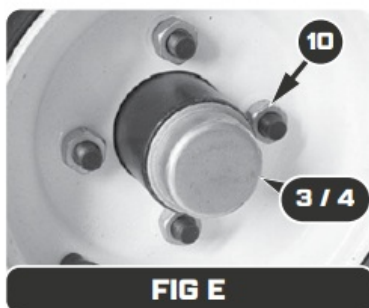
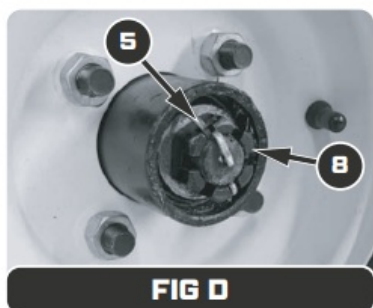

STEP 7: GETTING YOUR TRAILER TOW-READY

DANGER! BEFORE TOWING: Always re-install and fasten the hardware that was removed to fold the trailer. See the note below.

IMPORTANT: The front and rear frames (1, 2), and the tongue are fastened together in 3 places:

1. Between both frames (1, 2) by two M10 x 20 hex bolts (3), M10 nuts (4), and M10 washers (11).
2. Spring hangers (6, 7) by a total of four M10 x 25 carriage bolts (5), M10 nuts (4), and M10 washers (11).
3. Tongue (8) by two L-pins (9) and R-pins (10).

Removing this hardware allows for the trailer bed to fold.

WARNING! AFTER FOLDING: Use a strap to hook and secure both cross members underneath the front and rear frames (1, 2) to ensure the trailer does not unfold during stowaway transport.

ITEM N°	DESCRIPTION	PART N°	QTY
1	Front frame weldment	100-0168	1
2	Rear frame weldment	100-0169	1
3	M10 x 20 hex bolt	210-0135	2
4	M10 nylock nut	210-0003	6
5	M10 x 25 carriage bolt	210-0001	4
6	Left spring hanger	100-0177	1
7	Right spring hanger	100-0178	1
8	Tongue weldment	100-0170	1
9	L-pin	207-0031	2
10	R-pin	207-0012	2
11	M10 washer	210-0002	6

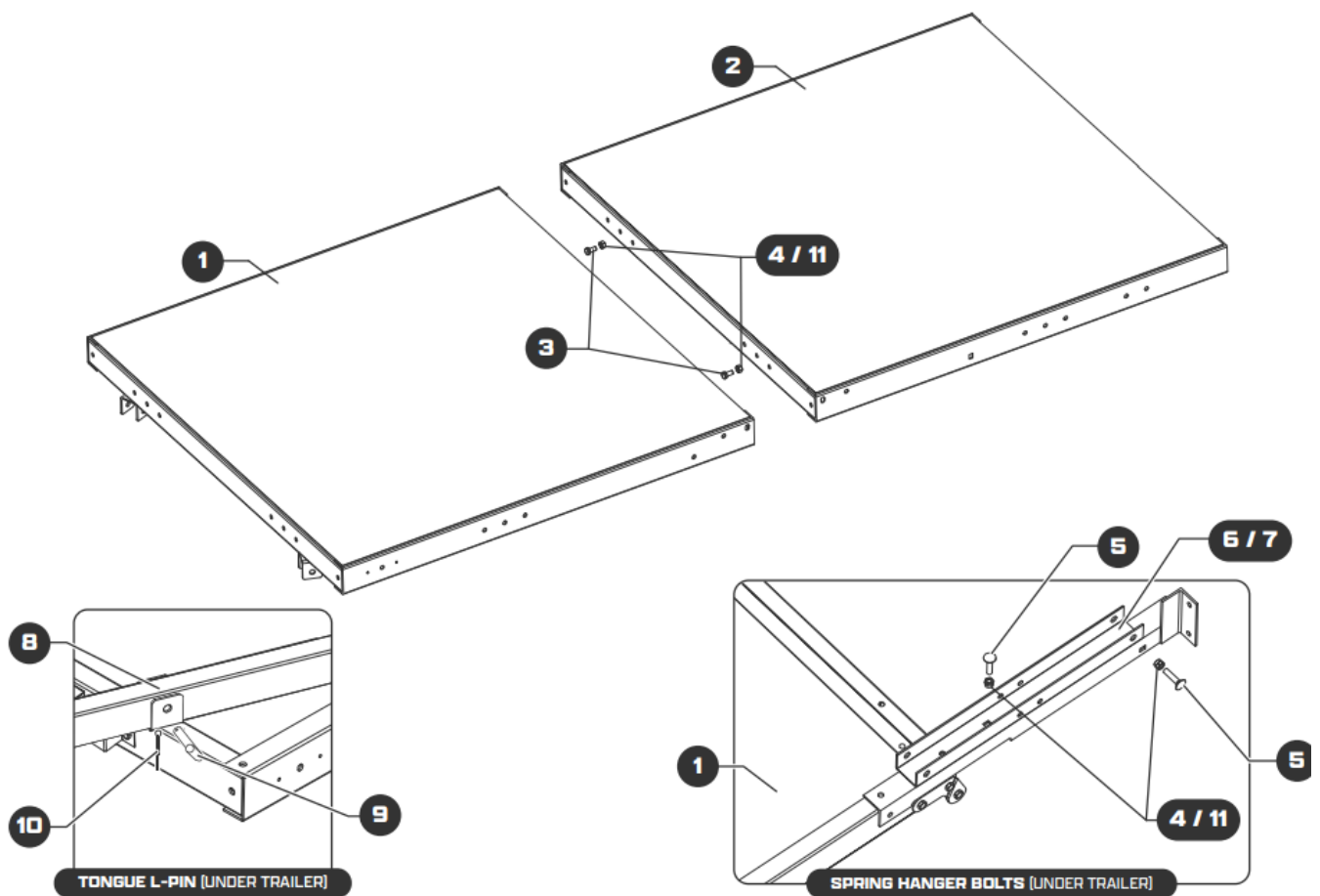

STEP 8: LIGHTING KIT

1. Attach the light brackets (1) to the rear side rails by using M10 x 20 hex bolts (7), M10 nuts (8), and M10 washers (11).
2. Attach the license plate bracket (2) with the left tail light (3), to the light bracket (1) on the left side rail using M6 nuts (8).
3. Attach the right tail light (4) to the light bracket (1) on the rear right side rail using M6 nuts (8).
4. Attach the side markers (5) to the front side rails using M4 x 65 phillips screws (9) and M4 nuts (10).

NOTE: The trailer should still be – at this point – upside down. The figure shown below shows the position of the lighting components on a right-side up trailer for clarity.

ITEM N° DESCRIPTION PART N° QTY

1. Taillight bracket 100-0183 2
2. License plate bracket 205-0037 1

3. Left taillight 205-0023 1
4. Right taillight 205-0024 1
5. Marker light 205-0069 2
6. M10 x 20 hex bolt 210-0135 4
7. M10 nylock nut 210-0003 4
8. M6 lock nut 210-0167 4
9. M4 x 65 phillips pan bolt 210-0153 4
10. M4 nylock nut 210-0108 4
11. M10 washer 210-0002 4

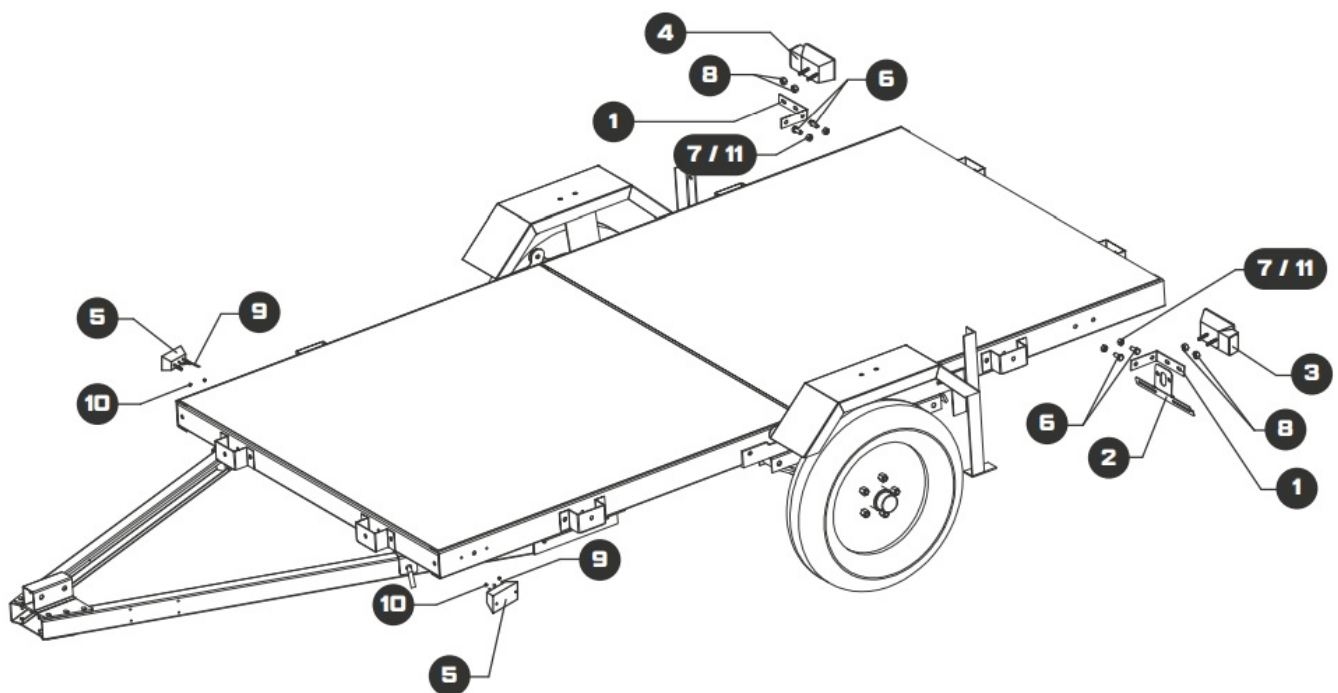

STEP 9: WIRING

NOTE: Only a qualified technician should perform the electrical service that may be needed to enable your particular make/model vehicle to power the trailer's 12 volt DC lighting system. This is beyond the scope of this manual.

1. Have a qualified service technician install a 4-wire, 12V DC connector in the trunk area of your vehicle.
2. Locate the vehicle's connector plug near the trailer's coupler and lay out the trailer's wiring harness wires.

NOTE: The diagram below shows the trailer right side up. Keep in mind, your trailer

should still be upside down at this point to make wiring installation easier, so the left and right sides appear reversed.

3.

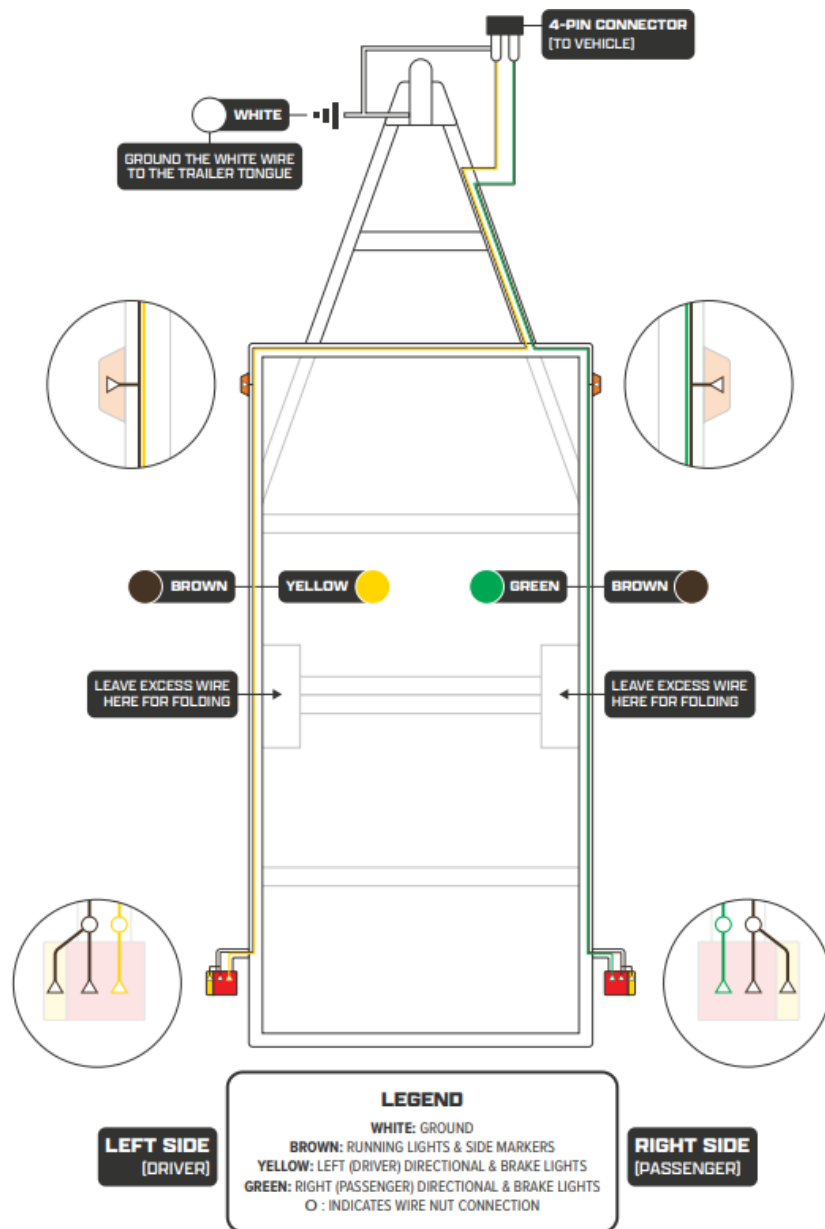

Connect the brown wire to the vehicle's left taillight by stripping, wrapping, and taping the connector plug.

4. Connect the yellow wire to the vehicle's left signal and brake light wire.
5. Connect the green wire to the vehicle's right signal and brake light wire.
6. Attach the white ground wire at the plug end of the wiring harness to the small mounting hole in the tow bar using a 1/4" (6 mm) tapping screw (not included). See FIG F.

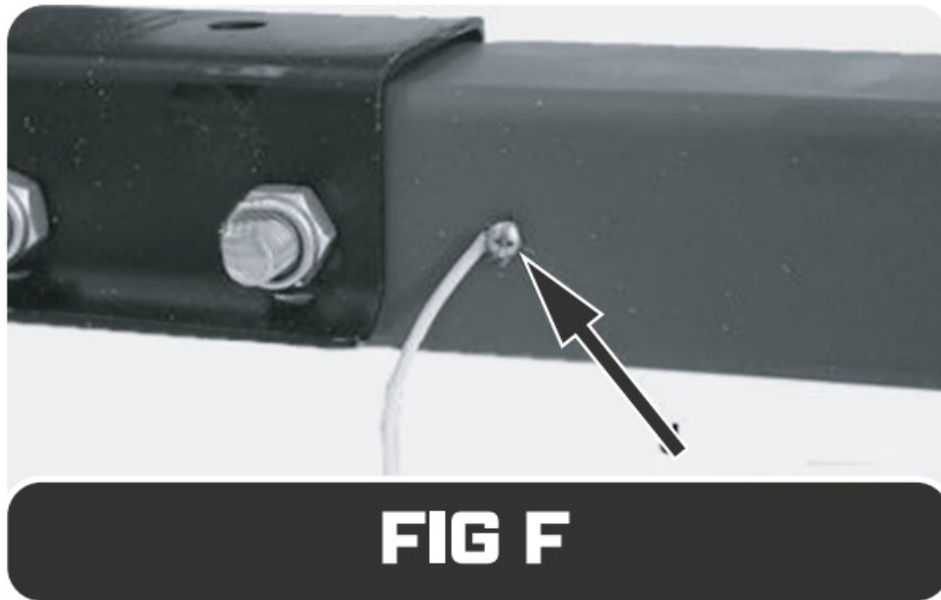

7. Run the yellow/brown wires along the inside of the front cross member to the side running light on the front left (driver) side rail.
8. Run the green/brown wires along the inside of the front cross member to the side running light on the front right (passenger) side rail.
9. Connect the wire lead from the two side running lights to the brown wire on each side of the trailer using the quick connects. Insert wire clips along the entire length of the side rails of the trailer to secure the wiring harness.
10. Run the yellow/brown wires to the left taillight, leaving some excess wire where the frame folds.
11. Strip approximately 3/4" (19 mm) of insulation off the ends of the wires.
12. Connect the yellow wire to the yellow wire of the left (driver) taillight.
13. Connect the brown wire to the brown wire of the left (driver) taillight.
14. Run the green/brown wires to the right (passenger) taillight, leaving some excess wire where the frame folds.
15. Strip approximately 3/4" (19 mm) of insulation off the ends of the wires.
16. Connect the green wire to the green wire of the right (passenger) taillight.
17. Connect the brown wire to the brown wire of the right (passenger) taillight.
NOTE: Use dielectric grease on each connector for corrosion prevention.
18. Turn over the whole trailer assembly so the tires touch the ground. **CAUTION!** Make sure you get the assistance of 1 or 2 additional people. Do not try to flip the trailer on your own.
19. Even though the wheels were already mounted to the hubs, you must tighten all the lug nuts to 85-90 ft.-lb. of torque.

STEP 10: COUPLER

1. Attach the coupler (1) to the coupler tongue top plate (2) using two sets of M12 x 80 hex bolts (4), M12 nuts (6), and M12 washers (5). When installing the front bolt, thread it through the center link of the safety chain (3) to secure the chain (3) to the coupler (1).
2. Lock the coupler trigger using its locking pin and R-pin.
3. Pull up and down on the coupler (1) to see if the coupler (1) fits snug on the vehicle's ball hitch. There must not be any play between the ball and the coupler (1). If there is play, tighten the adjustment nut (FIG G) until snug. If the nut is too tight, the coupler handle will not lock.

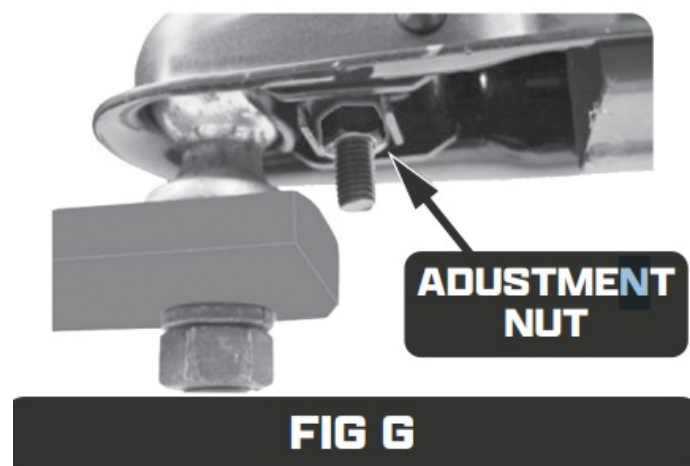

ITEM N° DESCRIPTION PART N° QTY

1. Coupler 204-0003 1
2. Coupler tongue top plate 100-0171 1
3. Safety chain 208-0002 1
4. M12 x 80 hex bolt 210-0043 2
5. M12 washer 210-0004 2
6. M12 nylock nut 210-0015 2

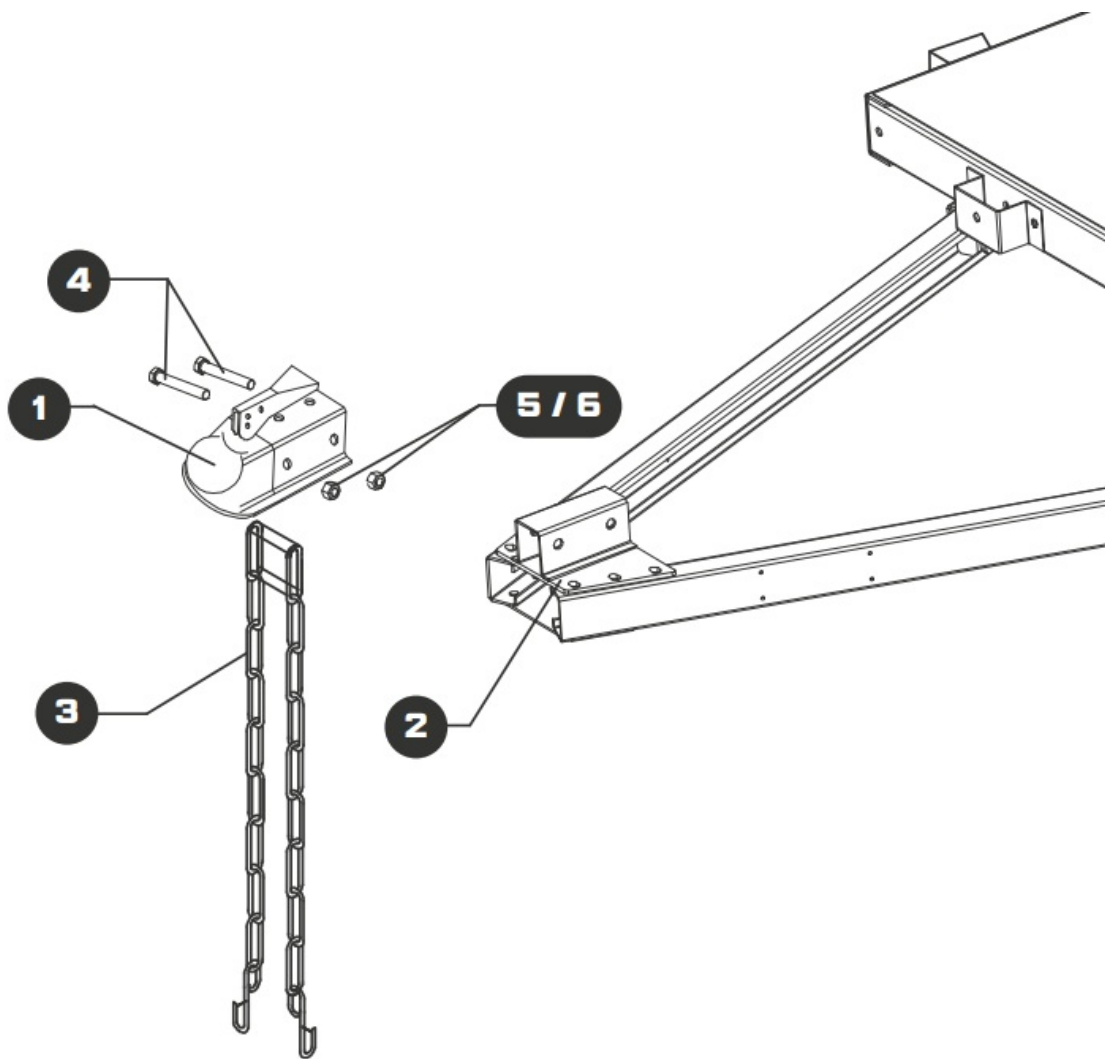

WARNING! RISK OF TRAILER UNCOUPLING: The coupler provided with your trailer requires a 2-inch (5.08 cm) hitch ball. Use only a 2-inch (5.08 cm) hitch ball on the tow vehicle towing this trailer.

NOTE: To reduce friction between the ball hitch and the coupler, apply a layer of multipurpose lithium grease over the ball hitch. Wipe off any excess grease when not in use to avoid staining clothes.

The assembly of your new 4 ft. x 8 ft. Folding Trailer is now complete. Please ensure that you continue to follow safety and maintenance instructions in this manual, and always practice safe towing.

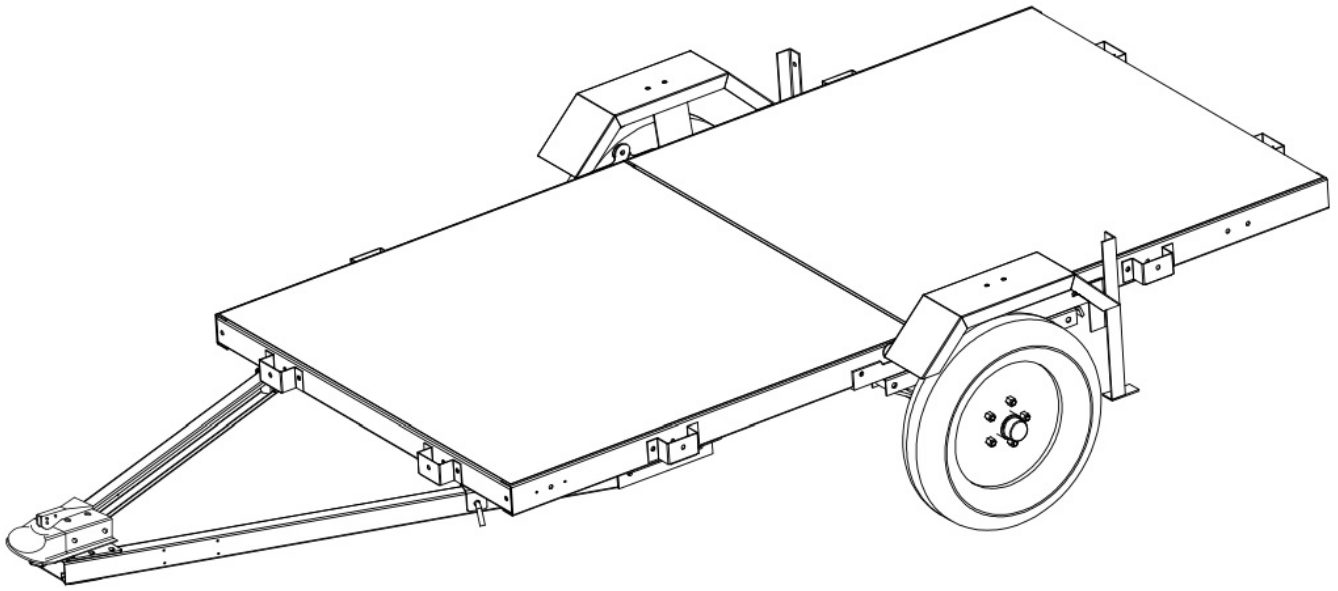

PARTS & SCHEMATICS

PARTS LIST

ITEM N°	DESCRIPTION	PART N°	QTY
1	FRONT FRAME WELDMENT	100-0168	1
2	REAR FRAME WELDMENT	100-0169	1
3	TONGUE WELDMENT	100-0170	2
4	COUPLER TONGUE TOP PLATE	100-0171	1
5	TONGUE BOTTOM PLATE	100-0172	1
6	3-LEAF SPRING	219-0003	2
7	AXLE ASSEMBLY	310-0113	1
8	HUB ASSEMBLY	310-0078	2
9	TIRE & WHEEL	220-0044	2
10	FENDER	206-0037	2

11	FENDER BRACKET	100-0173	2
12	LEFT SPRING HANGER	100-0177	1
13	RIGHT SPRING HANGER	100-0178	1
14	TOW BAR CONNECT HANGER	100-0179	2
15	COUPLER	204-0003	1
16	STAKE POCKET	100-0180	8
17	FRONT FRAME DECK HINGE	100-0181	2
18	REAR FRAME DECK HINGE	100-0182	2
19	TAILLIGHT BRACKET	100-0183	2
20	RIGHT CASTER BRACKET	100-0184	1
21	LEFT CASTER BRACKET	100-0185	1
22	MARKER LIGHT	205-0069	2

ITEM N°	DESCRIPTION	PART N°	QTY
23	LEFT TAILLIGHT	205-0023	1
24	RIGHT TAILLIGHT	205-0024	1
25	CASTER	216-0007	4
26	LICENSE PLATE BRACKET	205-0037	1
27	TONGUE FRONT WIRE HARNESS	205-0070	1

28	FRAME LEFTHAND WIRE HARNES S	205-0071	1
29	FRAME RIGHTHAND WIRE HARNE SS	205-0076	1
30	L-PIN	207-0031	2
31	SAFETY CHAIN	208-0002	1
32	SPRING PLATE	100-0035	2
33	LUG NUTS	210-0012	10
34	M10 X 95 X 38 U-BOLT	210-0154	4
35	M10 X 20 HEX BOLT	210-0135	60
36	M10 X 30 HEX BOLT	210-0093	4
37	M12 X 25 HEX BOLT	210-0138	2
38	M12 X 80 HEX BOLT	210-0043	6
39	M10 X 25 CARRIAGE BOLT	210-0001	4
40	M12 WASHER	210-0004	8
41	M10 WASHER	210-0002	76
42	M12 NYLOCK NUT	210-0015	8
43	M10 NYLOCK NUT	210-0003	76
44	M4 X 65 PHILIPS PAN BOLT	210-0153	4
45	M14 X 85 HEX BOLT	210-0092	4
46	M4 NYLOCK NUT	210-0108	4

47	M6 LOCK NUT	210-0167	4
48	M14 NYLOCK NUT	210-0064	4
49	R-PIN	207-0012	2

SCHEMATICS

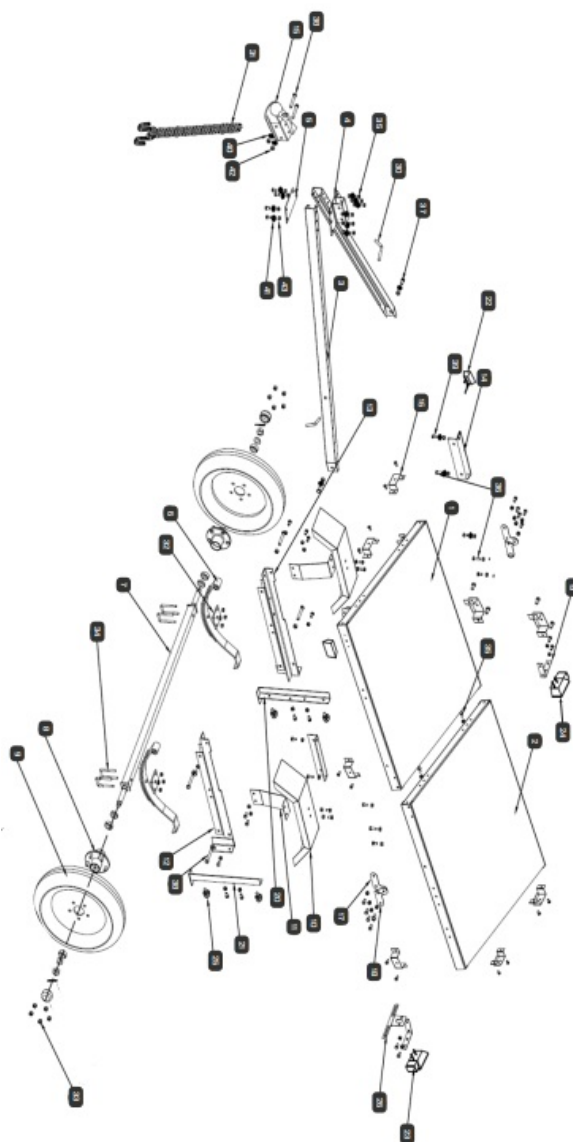

AXLE ASSEMBLY PARTS & SCHEMATICS

PARTS LIST: AXLE ASSEMBLY

ITEM N°	DESCRIPTION	PART N°	QTY
---------	-------------	---------	-----

1	AXLE WELDMENT	300-0074	1
2	SEAL (25 X 52 X 15)	217-0019	2

ITEM N°	DESCRIPTION	PART N°	QTY
3	BEARING (30205)	202-0004	4
4	HUB ASSEMBLY	310-0078	2
5	M22 WASHER	210-0165	2
6	M22 X 1.5 CASTLE NUT	210-0166	2
7	COTTER PIN	207-0006	2
8	GREASE FITTING	229-0083	2
9	DUST CAP WITH HOLE	229-0067	2
10	RUBBER DUST CAP	229-0105	2

SCHEMATICS: AXLE ASSEMBLY

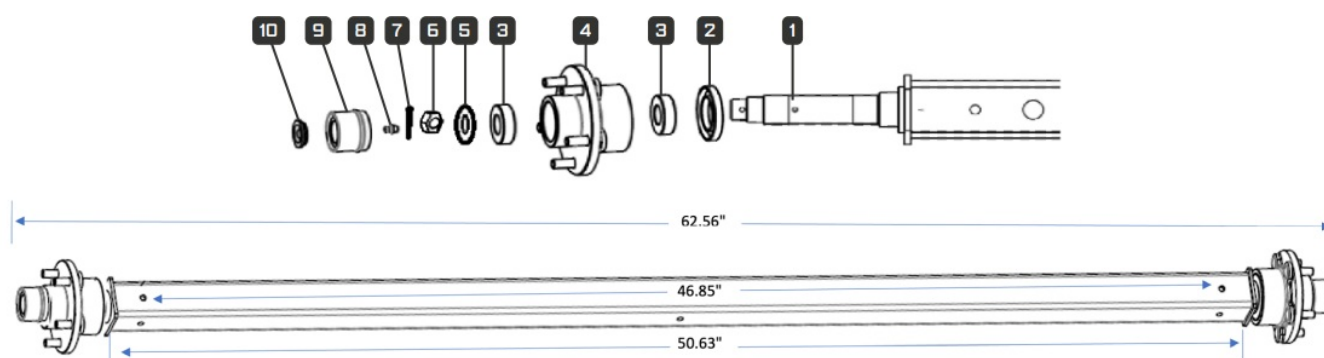

NOTE: If you find any damaged or missing parts please call Marlon® Customer Service or contact us via our website. We will replace any damaged or missing parts to you for free. Please do not return to the store.

CUSTOMER SERVICE 1 (888) 27 7-6960 | WWW.DK2.COM

WARRANTY

WHAT IS COVERED

Marlon Recreational Products Ltd. warrants to the original purchaser of a DK2 by Marlon product that the product will be free and clear of manufacturing defects in workmanship and materials under normal use and service for a period of one (1) year from the date of the original purchase. If within one (1) year from the original date of purchase this product fails due to defect in material or workmanship, Marlon will repair, replace, or supply any defective part at our option. Upon expiry of one (1) year, Marlon will have no further liability related to the Product. Marlon does not authorize any party, including its authorized distributors or dealers, to offer any other warranty on behalf of Marlon Recreational Products Ltd.

THIS WARRANTY DOES NOT COVER OR APPLY TO

- Damage to the product due to misuse, mishandling and abuse.
- Improper installation, maintenance and storage.
- Expendable parts such as blades, teeth, hardware (nuts, bolts, springs, etc.), winch straps, cable or rope (winches), belts, chains, tires, bearings or hub assemblies, dust caps, springs, markers, snow deflectors, and scraper blades (snow plows).
- Normal wear and tear.
- Consequential damage and incidental damages such as damage to persons or property.

REGISTERING YOUR DK2 BY MARLON PRODUCT

Please take a minute to register your DK2 by Marlon product online at www.detailk2.com/warranty or by calling customer service at 1 [888-277-6960](tel:888-277-6960).

PROCEDURE FOR OBTAINING A RETURN AUTHORIZATION

Within the one (1) year warranty period, the purchaser of the DK2 by Marlon product must notify an authorized distributor or dealer of the claimed defect and provide proof of original purchase. At this time the validity of the claim will be determined and a Return Goods Authorization Number (RGA) will be issued if approved. No returned product will be accepted under warranty unless accompanied by an RGA# issued by Marlon.

RESOLUTION FOR A DEFECTIVE DK2 BY MARLON PRODUCT

Marlon Recreational Products Ltd. will at its option repair or replace the defective product or parts covered by this warranty. The repaired DK2 by Marlon product or parts will be shipped to the purchaser upon completion. All transportation charges shall be the responsibility of the purchaser. Any damage in transit will be the responsibility of the carrier or at the risk of the purchaser.

TRAILER LICENSING

The DK2 by Marlon Trailer Kit **MUST BE CERTIFIED** after assembly by a local garage which is approved and holds a license to provide safety certificates for roadway vehicles. In order to register your trailer with the Department of Motor Vehicles or Ministry of Transportation and obtain a license plate you will need to have either the NVIS form in Canada or the Manufacturers Certificate of Origin in the US filled out and signed by the dealer transferring ownership to you. This form is found in your trailer manual package. Take this form along with the bill of sale (cash register receipt) and safety certificate to your local Department of Motor Vehicles or Ministry of Transportation licensing office. Once you pay the appropriate fees you will be issued a title or registration and license plate to be attached to the trailer.

U.S.A. RESIDENTS TO CONTACT NATIONAL HIGHWAY TRAFFIC SAFETY ADMINISTRATION

If you believe that your vehicle has a defect, which could cause an accident, personal injury or death, immediately inform the National Highway Traffic Safety Administration (NHTSA) in addition to notifying Marlon Recreational Products Ltd.

If NHTSA receives similar complaints, or finds safety defects existing in a group of vehicles it may open an investigation

or order a recall and remedy campaign. However, NHTSA cannot become involved in individual problems between you, your dealer, or Marlon Recreational Products Ltd.

To contact NHTSA, you may either call the Auto Safety Hotline toll-free at 1 [800-424-9393](tel:800-424-9393) (or 366-0123 in Washington, DC area) or write to: NHTSA, U.S. Department of Transportation, Washington, DC 20590.

FAQ

- **What does the warranty cover?**

The warranty covers defects in the product or parts. It does not cover damage from misuse, improper installation, or normal wear and tear.

- **How do I obtain a Return Authorization?**

To obtain a Return Authorization, contact an authorized distributor or dealer within the warranty period and provide proof of purchase. An RGA# will be issued if the claim is approved.

- **How should I license my trailer?**

After assembling the DK2 by Marlon Trailer Kit, it must be certified by a local garage approved to provide safety certificates for vehicles. This certification is necessary for licensing the trailer.

Documents / Resources

	DK2 MFT4X8 Series Folding Utility Trailer [pdf] User Manual MFT4X8, MFT4X8G, MFT4X8 Series Folding Utility Trailer, MFT4X8 Series, Folding Utility Trailer, Utility Trailer, Trailer
--	---

References

- [User Manual](#)

DK2

DK2, Folding Utility Trailer, MFT4X8, MFT4X8 Series, MFT4X8 Series Folding Utility Trailer, MFT4X8G, Trailer, Utility Trailer

Leave a comment

Your email address will not be published. Required fields are marked *

Comment *

Name

Email

Website

☐ Save my name, email, and website in this browser for the next time I comment.

Post Comment

Search:

e.g. whirlpool wrf535swhz

Search

[Manuals+](#) | [Upload](#) | [Deep Search](#) | [Privacy Policy](#) | [@manuals.plus](#) | [YouTube](#)

This website is an independent publication and is neither affiliated with nor endorsed by any of the trademark owners. The "Bluetooth®" word mark and logos are registered trademarks owned by Bluetooth SIG, Inc. The "Wi-Fi®" word mark and logos are registered trademarks owned by the Wi-Fi Alliance. Any use of these marks on this website does not imply any affiliation with or endorsement.