



dJI RS Intelligent  
Tracking Module



# dJI RS Intelligent Tracking Module User Manual

[Home](#) » [DJI](#) » dJI RS Intelligent Tracking Module User Manual 

## Contents

- [1 dJI RS Intelligent Tracking Module](#)
- [2 Overview](#)
- [3 Operations](#)
- [4 Firmware Update](#)
- [5 Appendix](#)
- [6 Documents / Resources](#)
  - [6.1 References](#)
- [7 Related Posts](#)



**dJI RS Intelligent Tracking Module**

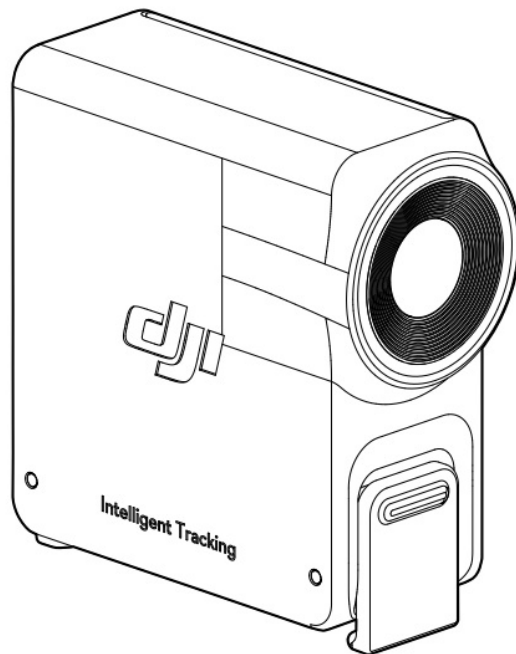

## Using this Manual

### Legend

Important Hints and Tips Reference

### Read Before Use

DJI™ provides you with tutorial videos and the following documents:



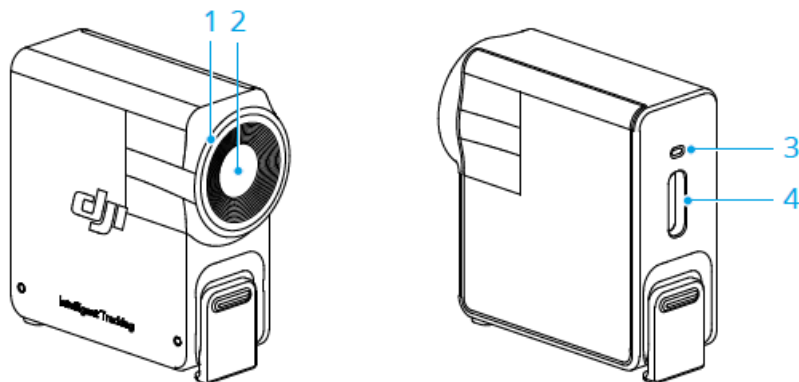

1. Safety Guidelines
2. Quick Start Guide
3. User Manual

It is recommended to watch all the tutorial videos and read the Safety Guidelines before using for the first time. Make sure to review the Quick Start Guide before using for the first time and refer to this User Manual for more information.

## Overview



1. Ring Light

Battery Level		
 —	Solid red	ActiveTrack disabled(in sleep mode) or subject lost
 —	Solid green	ActiveTrack in use
 .....	Blinks green	Subject lost temporarily
 —	Solid yellow	Composition being adjusted
 .....	Blinks yellow	Countdown for taking a picture or recording (shutter triggered after 3s of blinking)

## 2. Tracking Lens

## 3. Status Indicator

Light signals and meanings are consistent with the ring light.

## 4. USB-C Data Port

Connect to a computer for firmware updates.

# Operations

## Installation

After installing the intelligent tracking module, slide right from the home page to enter the ActiveTrack settings interface and adjust according to shooting needs. For detailed operations, refer to Slide Right – ActiveTrack Settings.

- If the status indicator does not light up after installation, check if the magnetic attachment is in place.
- If the tracking module idle for more than five minutes, it automatically enters sleep mode and the indicator turns off. To wake up the module, press the trigger on the gimbal.

## RS 4 / RS 4 Pro

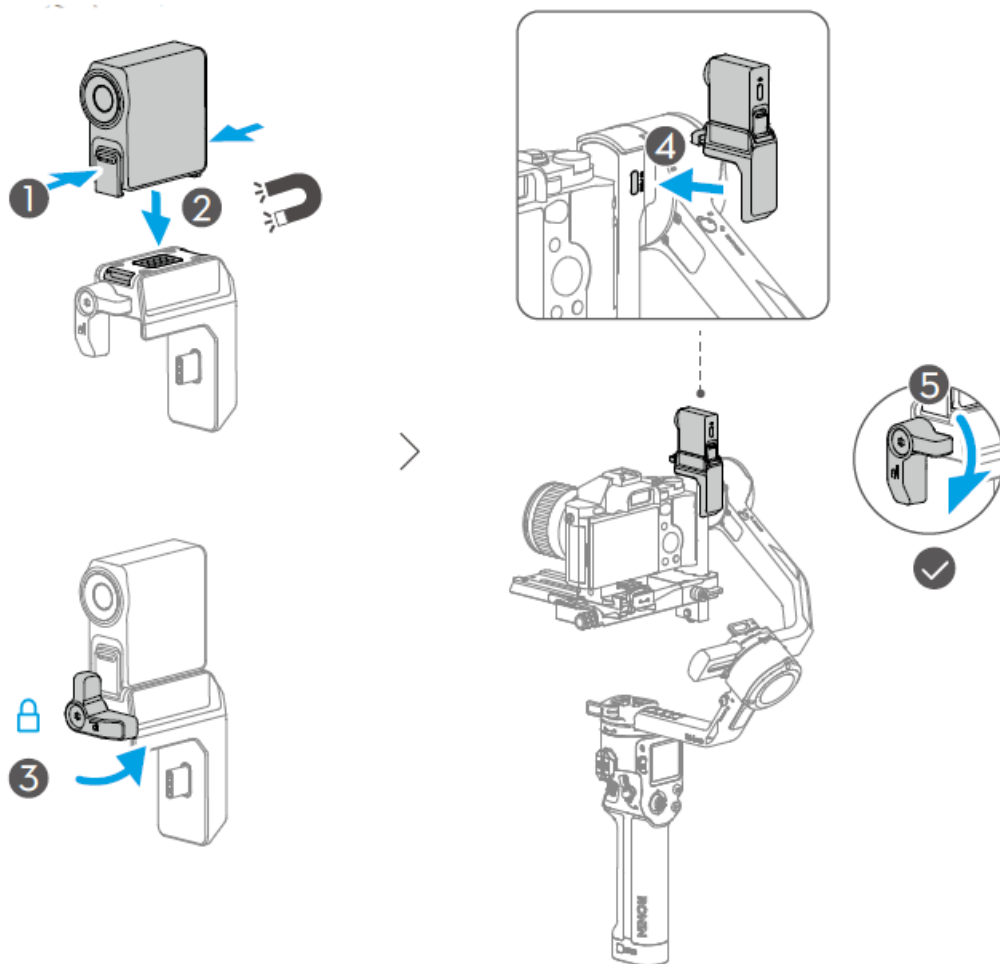

#### RS 4 Mini

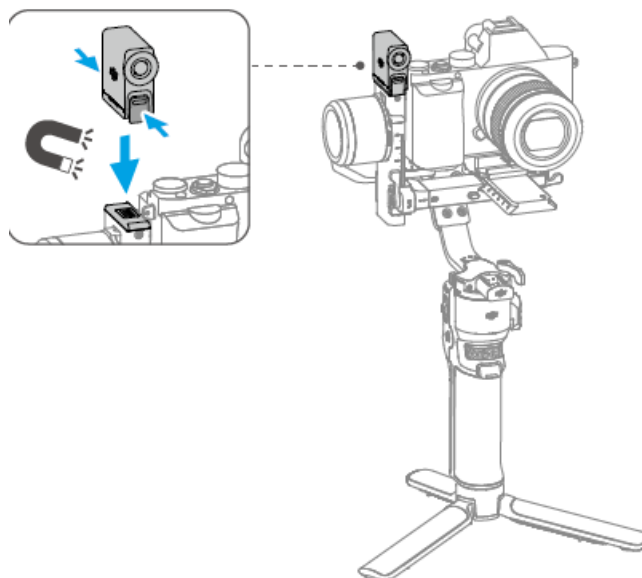

Slide Right – ActiveTrack Settings

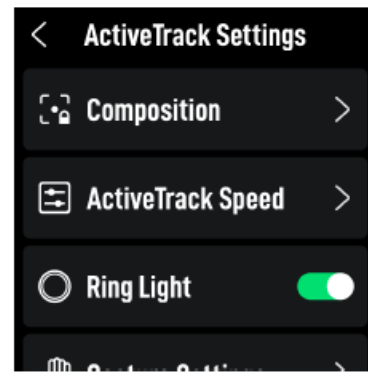
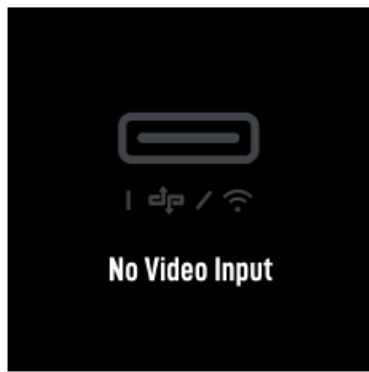

- If no intelligent tracking module is connected, No Signal Input will display on the screen.
- When the intelligent tracking module is connected, composition, ActiveTrack Speed and gestures can be set on this page.
- Composition: When Composition is adjusted to Center Tracking Subject, the subject tracked will be moved to the center of the ActiveTrack view. When ActiveTrack is enabled with Keep Current Framing, the gimbal will maintain the current composition.
- ActiveTrack Speed: Slow speed provides smooth tracking, ideal for live streaming.
- Medium speed works well for parallel tracking, while fast speed is best for close-up circling shots or high-motion scenes.

The touchscreen does not display the ActiveTrack view.

In Center Tracking Subject, the subject may not always stay perfectly centered due to variations in camera, lens, and shooting distance. If this happens, use the joystick to adjust the composition.

## Tracking and Shooting

- It is not recommended to use in backlight or low-light scenarios.
- During tracking, keep the subject 0.5 m to 10 m away from the tracking lens.

## Control via Buttons and Joystick

- Press the trigger to enable or disable the ActiveTrack.
- Once the subject is being tracked, you can use the joystick to adjust the composition.
- Press the trigger twice to disable the ActiveTrack and recenter the gimbal.
- During shooting, you can switch ActiveTrack mode using the gimbal mode switch.
- In Pan Follow (PF) mode, only the pan axis can follow; in Pan and Tilt Follow (PTF) mode, both the pan and tilt axes can follow; in Full Follow (FPV) mode, ActiveTrack is not supported.
- When shooting from a mid-low camera position, the gimbal handle should point in the direction of the subject being tracked.

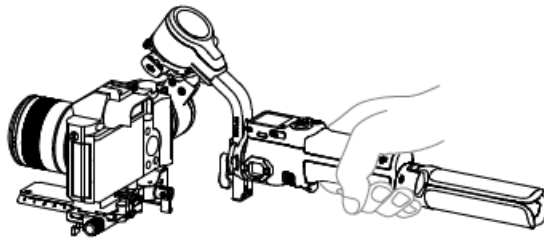

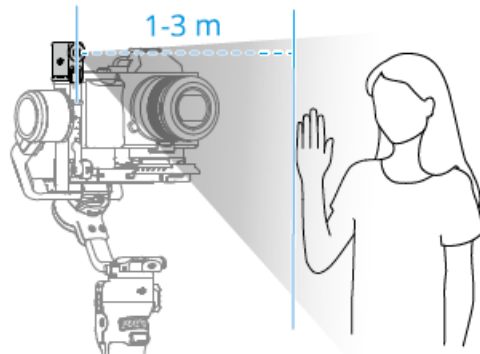

## Control via Gesture

- Enable tracking: Show the gesture to the camera or press the trigger. The indicator turns solid green.

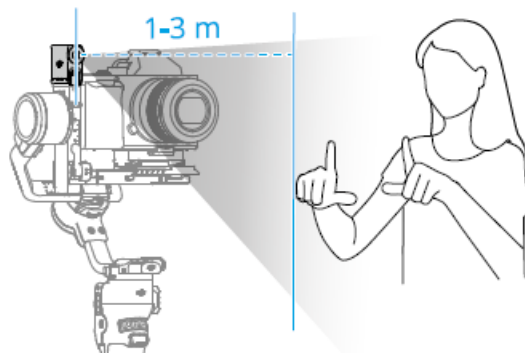

- The tracking module only supports following people and prioritizes those close to the lens and near the center of the view. The subject tracked should be 1 m to 3 m away from the tracking lens.
- Adjusting composition: Adjust the composition as needed during tracking. Show the gesture to the camera. The indicator turns solid yellow and tracking is automatically paused. The subject can move to the desired position in the frame.
- Show the gesture again to confirm the composition. The indicator turns solid green and tracking automatically resumes.



Stop tracking: Show the  gesture or press the trigger again. The indicator turns solid red.

- Shooting: Whether tracking is in use or not, you can use  to start a countdown for taking a photo or starting/stopping recording. The indicator pulses yellow during the countdown.

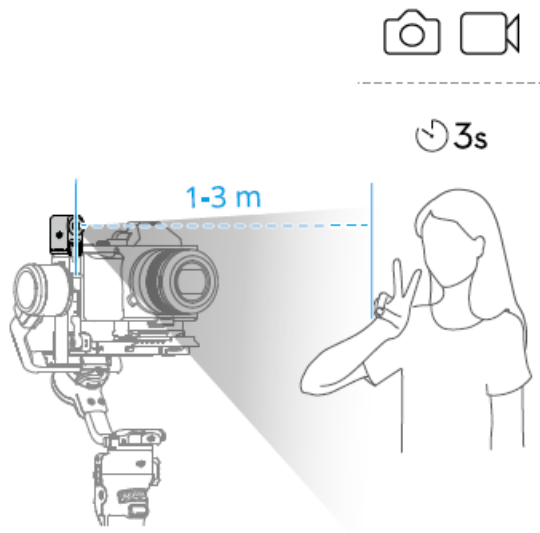

## Firmware Update

The tracking module needs to be connected to a computer for firmware update.

1. Visit <https://www.dji.com/rs-4-mini/downloads> and download the corresponding firmware package.
2. Use the included USB-C cable to connect the tracking module to the computer.
3. Place the downloaded firmware package (file ending in .bin) in the root directory of the tracking module.
4. Once copied, disconnect the USB connection.
5. Reconnect the tracking module to the computer. The tracking module will automatically start the update process. The status indicator will blink red and green alternately. DO NOT disconnect the connection during the process.
6. The status indicator remaining solid red indicates that the update is complete.

## Appendix

### Specifications

Visit the following website for specifications. <https://www.dji.com/rs-4-mini/specs>



### Contact

### DJI SUPPORT

This content is subject to change without notice. Download the latest version from <https://www.dji.com/rs-4-mini/downloads>



If you have any questions about this document, please contact DJI by sending a message to [DocSupport@dji.com](mailto:DocSupport@dji.com)

DJI is a trademark of DJI.

Copyright © 2025 DJI All Rights Reserved.

**Documents / Resources**

<div><div>DJI RS Intelligent Tracking Module</div><div>User Manual</div><div></div></div>	<div><a href="#">dJI RS Intelligent Tracking Module</a> [pdf] User Manual</div> <div>RS Intelligent Tracking Module, RS, Intelligent Tracking Module, Tracking Module, Module</div>
--	---

**References**

- [User Manual](#)

Manuals+, Privacy Policy

This website is an independent publication and is neither affiliated with nor endorsed by any of the trademark owners. The "Bluetooth®" word mark and logos are registered trademarks owned by Bluetooth SIG, Inc. The "Wi-Fi®" word mark and logos are registered trademarks owned by the Wi-Fi Alliance. Any use of these marks on this website does not imply any affiliation with or endorsement.