



# dji RC 2 Next-Gen Drone Remote Controller with Integrated Screen User Manual

[Home](#) » [DJI](#) » dji RC 2 Next-Gen Drone Remote Controller with Integrated Screen User Manual 

## Contents

- [1 dji RC 2 Next-Gen Drone Remote Controller with Integrated Screen](#)
- [2 Specifications](#)
- [3 Compliance Information](#)
- [4 Documents / Resources](#)



**dji RC 2 Next-Gen Drone Remote Controller with Integrated Screen**



WE ARE HERE FOR YOU



Check battery level: press once.  
Power on/off: press, then press and hold.

# 1

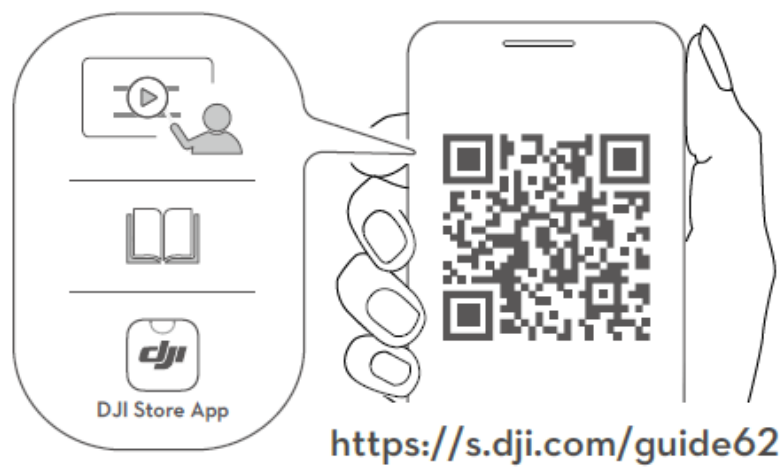

# 2

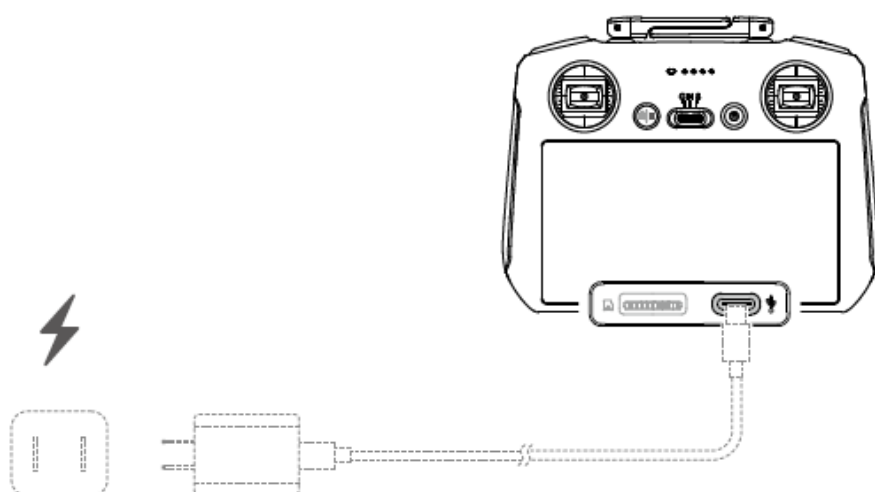

3

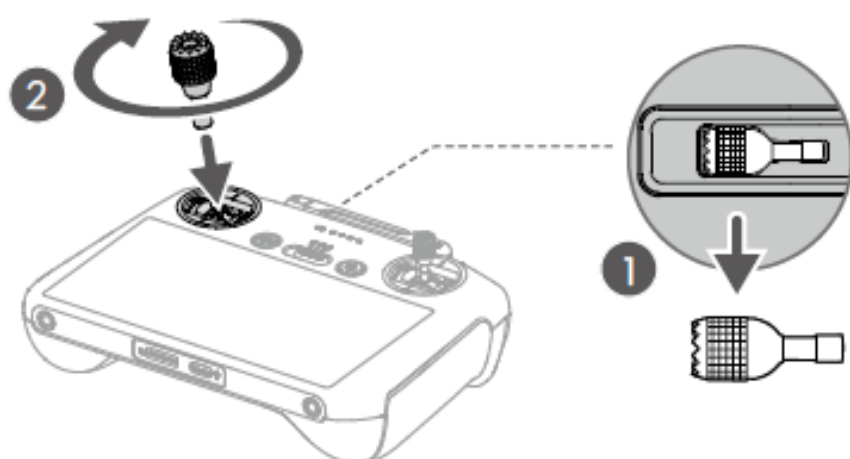

4

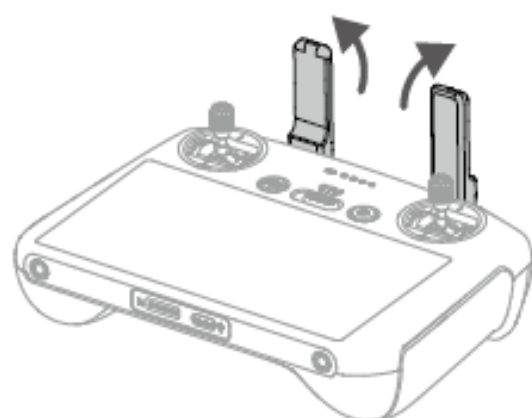

5

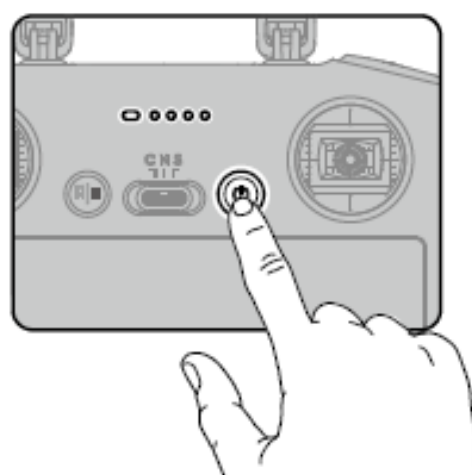

## Disclaimer

By using this product, you signify that you have read, understand, and accept the terms and conditions of this guideline and all instructions at <https://www.dji.com/rc-2>. EXCEPT AS EXPRESSLY PROVIDED IN AFTER-SALES SERVICE POLICIES AVAILABLE AT [HTTPS://WWW.DJI.COM/SERVICE/POLICY](https://www.dji.com/service/policy), THE PRODUCT AND ALL MATERIALS AND CONTENT AVAILABLE THROUGH THE PRODUCT ARE PROVIDED “AS IS” AND ON “AS AVAILABLE BASIS” WITHOUT WARRANTY OR CONDITION OF ANY KIND. This product is not intended for children.

## Specifications

Model	RC331
Operating Temperature	-10° to 40° C (14° to 104° F)
Transmission System	When used with different aircraft hardware configurations, the DJI RC 2 remote controllers will automatically select the corresponding firmware version for updating to support the transmission technology enabled by the hardware performance of the linked aircraft. Refer to the user manual of the linked aircraft for more information.
Operation Frequency Range <sup>[1]</sup>	2.4000-2.4835 GHz; 5.170-5.250 GHz; 5.725-5.850 GHz
Transmission Power (EIRP)	2.4 GHz: <33 dBm (FCC), <20 dBm (CE/SRRC/MIC) 5.1 GHz: <23 dBm (CE) 5.8 GHz: <33 dBm (FCC), <30 dBm (SRRC), <14 dBm (CE)
Wi-Fi	
Protocol	802.11a/b/g/n/ac/ax
Operation Frequency Range <sup>[1]</sup>	2.4000-2.4835 GHz; 5.150-5.250 GHz; 5.725-5.850 GHz
Transmission Power (EIRP)	2.4 GHz: <26 dBm (FCC); <20 dBm (CE/SRRC/MIC) 5.1 GHz: <23 dBm (FCC/CE/SRRC/MIC) 5.8 GHz: <23 dBm (FCC/SRRC); <14 dBm (CE)
Bluetooth	
Protocol	Bluetooth 5.2
Operation Frequency Range	2.4000-2.4835 GHz
Transmission Power (EIRP)	<10 dBm

[1] 5.8 and 5.1GHz frequencies are prohibited in some countries. In some countries, the 5.1GHz frequency is only allowed for use in indoor.

## Compliance Information

### FCC Compliance Notice

Supplier's Declaration of Conformity

Product name: DJI RC 2

Model Number: RC331

Responsible Party: DJI Research LLC

Responsible Party Address: 435 Portage Ave, Palo Alto, CA 94306

Website: [www.dji.com](http://www.dji.com)

We, DJI Research LLC, being the responsible party, declares that the above mentioned model was tested to

demonstrate complying with all applicable FCC rules and regulations.

This device complies with Part 15 of the FCC Rules. Operation is subject to the following two conditions: (1) This device may not cause harmful interference, and (2) This device must accept any interference received, including interference that may cause undesired operation.

Any changes or modifications not expressly approved by the party responsible for compliance could void the user's authority to operate the equipment.

This equipment has been tested and found to comply with the limits for a Class B digital device, pursuant to part 15 of the FCC Rules. These limits are designed to provide reasonable protection against harmful interference in a residential installation. This equipment generates, uses and can radiate radio frequency energy and, if not installed and used in accordance with the instructions, may cause harmful interference to radio communications. However, there is no guarantee that interference will not occur in a particular installation. If this equipment does cause harmful interference to radio or television reception, which can be determined by turning the equipment off and on, the user is encouraged to try to correct the interference by one or more of the following measures:

- Reorient or relocate the receiving antenna.
- Increase the separation between the equipment and receiver.
- Connect the equipment into an outlet on a circuit different from that to which the receiver is connected.
- Consult the dealer or an experienced radio/TV technician for help.

### **RF Exposure Information**

This equipment complies with FCC radiation exposure limits set forth for an uncontrolled environment. End user must follow the specific operating instructions for satisfying RF exposure compliance. This transmitter must not be co-located or operating in conjunction with any other antenna or transmitter.

The portable device is designed to meet the requirements for exposure to radio waves established by the Federal Communications Commission (USA).

These requirements set a SAR limit of 1.6 W/kg averaged over one gram of tissue. The highest SAR value reported under this standard during product certification for use when properly worn on the body.

These requirements set a SAR limit of 4 W/kg averaged over ten gram of tissue. The highest SAR value reported under this standard during product certification for use when properly worn on the limbs.

### **ISED Compliance Notice**

CAN ICES-003 (B) / NMB-003 (B)

This device contains licence-exempt transmitter(s)/receiver(s) that comply with Innovation, Science and Economic Development Canada's licence-exempt RSS(s). Operation is subject to the following two conditions:

(1) This device may not cause interference.

(2) This device must accept any interference, including interference that may cause undesired operation of the device.

This equipment complies with RSS-102 radiation exposure limits set forth for an uncontrolled environment. End user must follow the specific operating instructions for satisfying RF exposure compliance. This transmitter must not be co-located or operating in conjunction with any other antenna or transmitter. The portable device is designed to meet the requirements for exposure to radio waves established by the CNR-102.

### **Compliance Statement:**

SZ DJI TECHNOLOGY CO., LTD. hereby declares that this device (DJI RC 2) is in compliance with the essential requirements and other relevant provisions of Radio Equipment Regulations 2017. A copy of the GB Declaration of Conformity is available online at [www.dji.com/euro-compliance](http://www.dji.com/euro-compliance)

### **Environmentally friendly disposal**

Old electrical appliances must not be disposed of together with the residual waste, but have to be disposed of separately. The disposal at the communal collecting point via private persons is for free. The owner of old appliances is responsible to bring the appliances to these collecting points or to similar collection points. With this little personal effort, you contribute to recycle valuable raw materials and the treatment of toxic substances.

