



dji Mini 3 Series Propeller Guard User Guide

[Home](#) » [DJI](#) » dji Mini 3 Series Propeller Guard User Guide 

Contents

- [1 dji Mini 3 Series Propeller Guard](#)
- [2 INSTRUCTIONS](#)
- [3 Specifications](#)
- [4 Documents / Resources](#)
- [5 Related Posts](#)

DJI MINI 3

dji Mini 3 Series Propeller Guard



Carefully read this entire document and all safe and lawful practices provided before use.

1

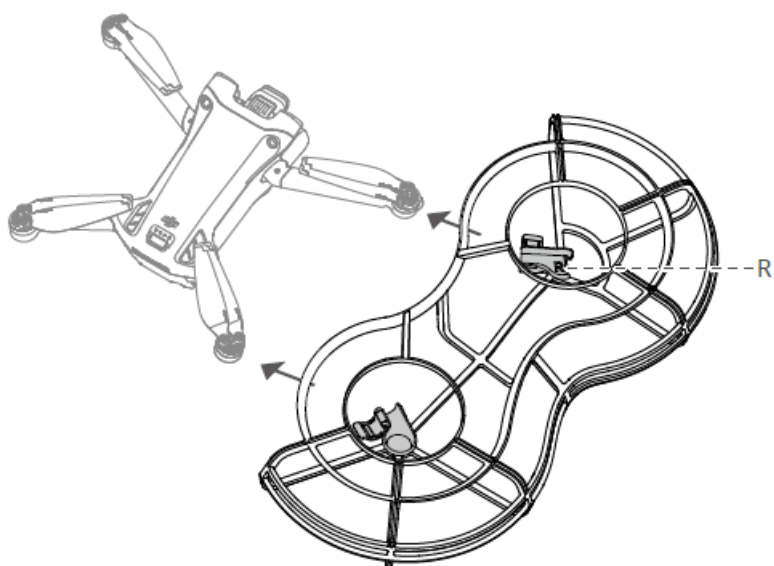

2

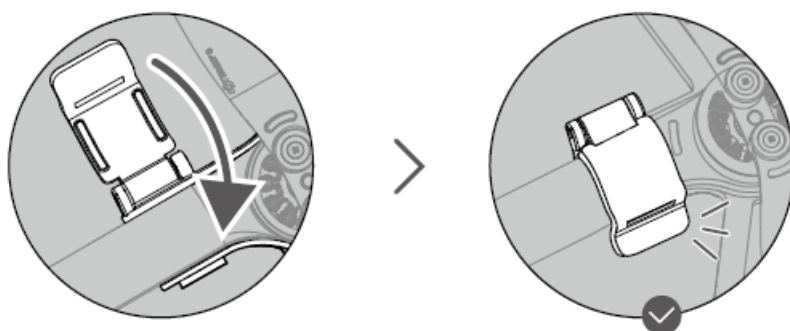

3

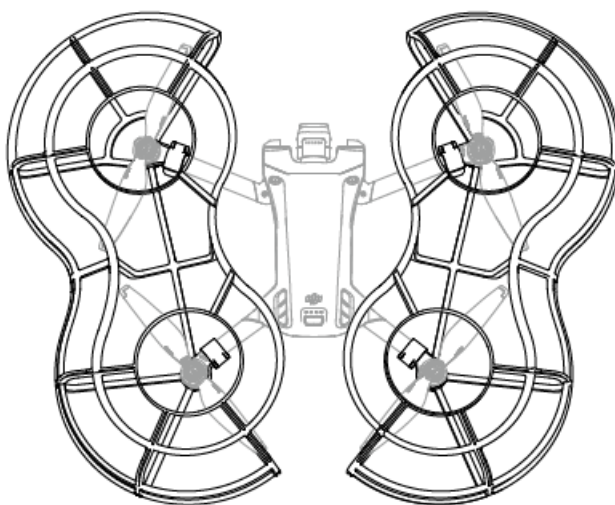

INSTRUCTIONS

- DO NOT use the propeller guard in windy environments.
- When the propellers are rotating, stay away from the propellers and propeller guard to avoid injury.

- The aircraft weight exceeds 250 g after the propeller guard is installed. Make sure you understand and comply with the local laws and regulations and, if required, have obtained corresponding approval and clearance from the related government agencies before flight.
- When using the propeller guard together with the Intelligent Flight Battery, the maximum takeoff altitude of the aircraft is 1,500 m (4,921 ft) to ensure flight safety. It is not recommended to use the propeller guard together with the Intelligent Flight Battery Plus.
- After installing the propeller guard, hover the aircraft until DJI Fly prompts that the payload has been detected, and the payload mode is enabled. If the status of the payload mode in DJI Fly does not match the actual situation, turn it on or off manually in the app.
- After installing the propeller guard, the flight height, flight distance, and maximum flight speed will be limited. Pay attention to prompts in DJI Fly. Fly with caution and maintain visual line of sight of your aircraft when using the propeller guard.
- Before installing the propeller guard onto DJI Mini 3 Pro, make sure to update the aircraft firmware to v01.00.0450 or later. Otherwise, the flight stability cannot be guaranteed.
- After installing the propeller guard onto DJI Mini 3 Pro, the obstacle sensing function will be unavailable. The aircraft cannot actively bypass obstacles or brake when obstacles are on its route. There is no obstacle sensing when using intelligent flight modes, either.
- If max power load alarm prompts, fly with caution.

Specifications

- Weight 84 g
- Radius 94 mm
- Installation Circumference: 416 × 334 × 89 mm

www.quefairedemesdechets.fr

Documents / Resources

 <p>DJI MINI 3 SERIES 360° Propeller Guard</p>	<p>dji Mini 3 Series Propeller Guard [pdf] User Guide</p> <p>Mini 3 Series Propeller Guard, Mini 3 Series, Propeller Guard, Guard</p>
---	---