



dji AVATA 2 Two Way Charging Hub User Guide

[Home](#) » [DJI](#) » dji AVATA 2 Two Way Charging Hub User Guide 



Two-Way Charging Hub
User Guide
V1.0





Contact
DJI SUPPORT

<https://www.dji.com/support>



<https://www.dji.com/avata-2/downloads>

This content is subject to change without prior notice.

DJI and DJI AVATA are trademarks of DJI.

Copyright © 2024 DJI All Rights Reserved.



YCBZSS00276902

Contents

- [1 AVATA 2 Two Way Charging Hub](#)
- [2 Introduction](#)
- [3 Usage](#)
- [4 Status LED Descriptions](#)
- [5 Specifications](#)
- [6 Compliance Information](#)
- [7 Documents / Resources](#)
 - [7.1 References](#)

AVATA 2 Two Way Charging Hub



Carefully read this entire document and all safe and lawful practices provided before use.

A1

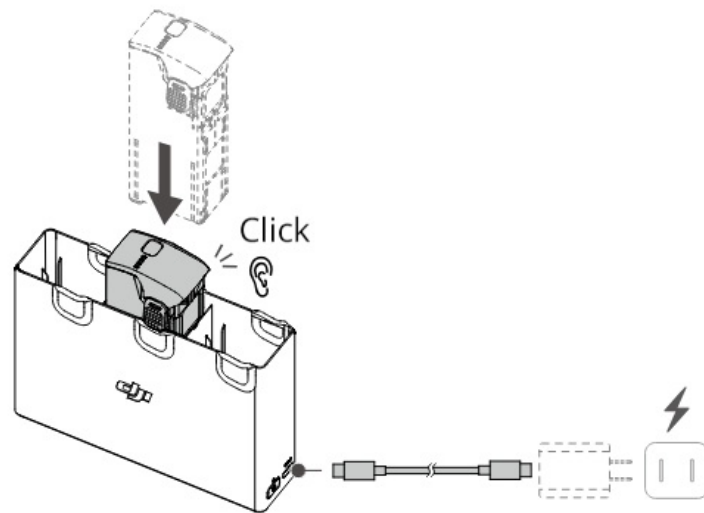

A2

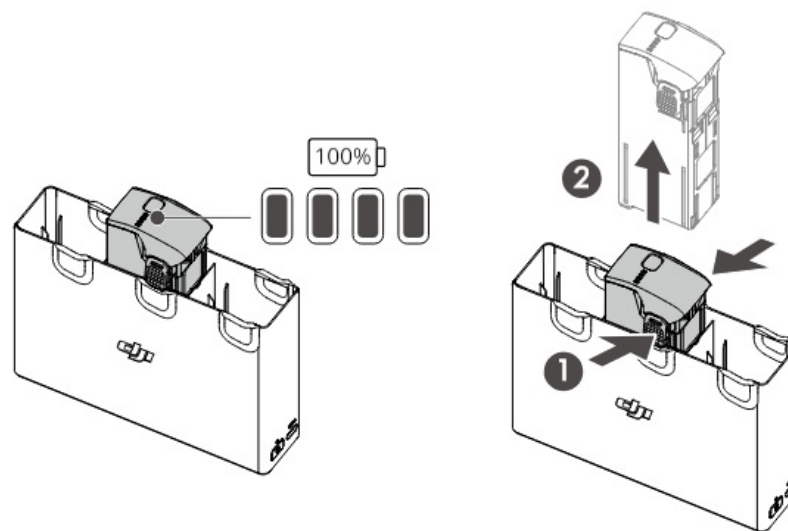

B

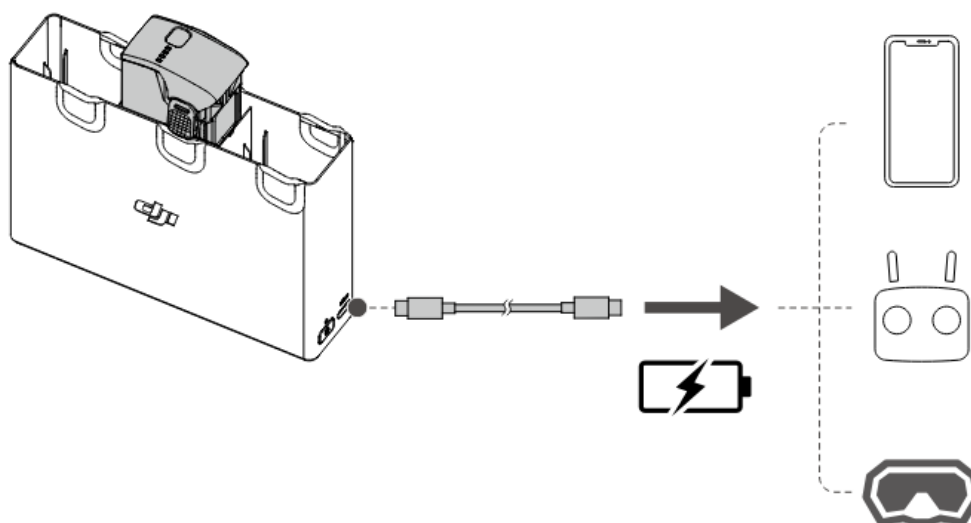

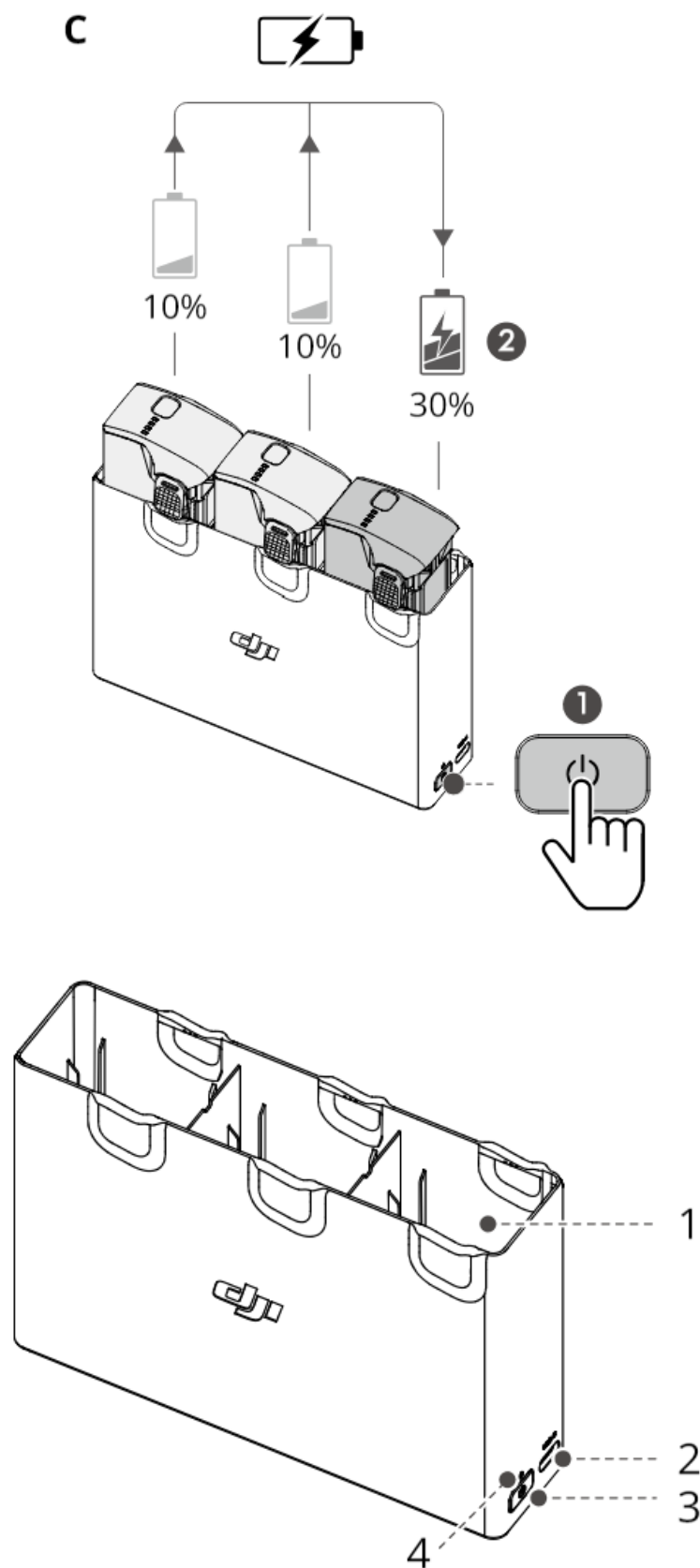

1	2	3	4
Battery Port	USB-C Port	Function Button	Status LED

Warnings

1. When using the DJI AVATA™ 2 Two-Way Charging Hub (hereinafter referred to as “charging hub”) to charge DJI

Avata 2 Intelligent Flight Batteries, it is recommended to use the DJI 65W Portable Charger or a USB Power Delivery charger.

2. The charging hub is only compatible with the BWX520-2150-14.76 Intelligent Flight Battery. DO NOT use the charging hub with other battery models.
3. Place the charging hub on a flat, stable surface with good ventilation when charging an external device or accumulating power. Make sure the device is properly insulated to prevent fire hazards.
4. DO NOT attempt to touch the metal terminals on the battery ports. Clean the metal terminals with a dry cloth if there is any noticeable buildup.
5. Make sure to charge batteries with low battery power in time. It is recommended to store the batteries in the charging hub.

Introduction

The DJI Avata 2 Two-Way Charging Hub is designed to charge up to three DJI Avata 2 Intelligent Flight Batteries. After the Intelligent Flight Batteries are inserted, the charging hub can supply power to external devices via the USB-C port, such as a remote controller or a mobile phone. The charging hub can also use the power accumulation function to transfer the remaining power of multiple low-power batteries into the battery with the highest remaining power.

Usage

Charging Intelligent Flight Batteries

1. Insert the batteries into the charging hub until they click into place. (Figure A1)
2. Connect the charging hub to a power outlet using a USB-C charger. The Intelligent Flight Battery with the highest power level will be charged first. The status LED indicates the battery level during charging. Refer to the Status LED Descriptions for more information about the blinking patterns.
3. The battery can be stored in the charging hub after charging. Remove the battery from the charging hub for use. (Figure A2)

Using the Charging Hub as a Power Bank

1. Insert an Intelligent Flight Battery into the charging hub. Connect an external device via the USB-C port, such as a mobile phone or remote controller. (Figure B)
 2. The battery with the lowest power level will be discharged first, followed by the remaining batteries to be discharged sequentially. To stop charging the external device, disconnect the external device from the charging hub.
-  If the remaining charge of a battery is lower than 7%, the battery cannot charge the external device.
 - Press the function button to activate charging if charging does not start automatically.

Power Accumulation

1. Insert more than one battery into the charging hub, and press and hold the function button until the status LED turns green. The status LED of the charging hub pulses green, and the charge is transferred from the battery

with the lowest power level to the battery with the highest power level. (Figure C)

2. To stop accumulating power, press and hold the function button until the status LED turns yellow. After stopping power accumulation, press the function button to check the power level of the batteries.
- Power accumulation stops automatically in the following situations:
 - a) The receiving battery is fully charged, or the power of the output battery is lower than 5%.
 - b) A charger or external device is connected to the charging hub or any battery is inserted or withdrawn from the charging hub during power accumulation.
 - c) Power accumulation is interrupted for more than 15 minutes due to abnormal battery temperature.
 - After accumulating power, charge the battery with the lowest power level as soon as possible to avoid over-discharging.

Status LED Descriptions

Blinking Pattern	Description
Solid yellow	The charging hub is idle
Pulses green	Charging the battery or accumulating power
Solid green	All batteries fully charged or supplying power to external devices
Blinks yellow	Temperature of the batteries is too low or too high (no further operation needed)
Solid Red	Power supply error or battery error (remove and reinsert the batteries or unplug and plug in the charger)

Specifications

Product Model	CHX520-80
Compatible Power Adapter	DJ 65W Portable Charger, DJI 65W Car Charger, or other USB PD chargers
Compatible Battery Model	BWX-2150-14.76
Dimensions	141.8×37.1×100.2 mm
Weight	Approx. 114g
Operating Temperature	5° to 40° C (41° to 104° F)
Input (USB-C)	5V/9V/12V/15V/20V, MAX 3A
Output (USB-C)	5V  2A
Charging Time (Single Battery)	DJ 65W Portable Charger: Approx. 45 mins

Compliance Information

FCC Compliance Statement
Supplier's Declaration of Conformity
Product name: DJI Avata 2 Two-way Charging Hub
Model Number: CHX520-80
Responsible Party: DJI Research LLC

Responsible Party Address: 17301 Edwards Road, Cerritos, CA 90703

Website: www.dji.com

We, DJI Research LLC, being the responsible party, declares that the above mentioned model was tested to demonstrate complying with all applicable FCC rules and regulations.

This device complies with part 15 of the FCC Rules. Operation is subject to the following two conditions: (1) This device may not cause harmful interference, and (2) this device must accept any interference received, including interference that may cause undesired operation.

Any changes or modifications not expressly approved by the party responsible for compliance could void the user's authority to operate the equipment.

ISED Compliance

CAN ICES-003 (B) / NMB-003(B)

EU & UK Compliance Notice



EU Compliance Statement: SZ DJI TECHNOLOGY CO., LTD. hereby declares that this device (DJI Avata 2 Two-way Charging Hub) is in compliance with the essential requirements and other relevant provisions of the Directive 2014/30/EU.

A copy of the EU Declaration of Conformity is available online at www.dji.com/euro-compliance

EU contact address: DJI GmbH, Industriestrasse 12, 97618, Niederlauer, Germany

GB Compliance Statement: SZ DJI TECHNOLOGY CO., LTD. hereby declares that this device (DJI Avata 2 Two-way Charging Hub) is in compliance with the essential requirements and other relevant provisions of Electromagnetic Compatibility Regulations 2016.

A copy of the GB Declaration of Conformity is available online at www.dji.com/euro-compliance

Environmentally friendly disposal



Old electrical appliances must not be disposed of together with the residual waste, but have to be disposed of separately. The disposal at the communal collecting point via private persons is for free. The owner of old appliances is responsible to bring the appliances to these collecting points or to similar collection points. With this little personal effort, you contribute to recycle valuable raw materials and the treatment of toxic substances.

dji AVATA 2

Documents / Resources

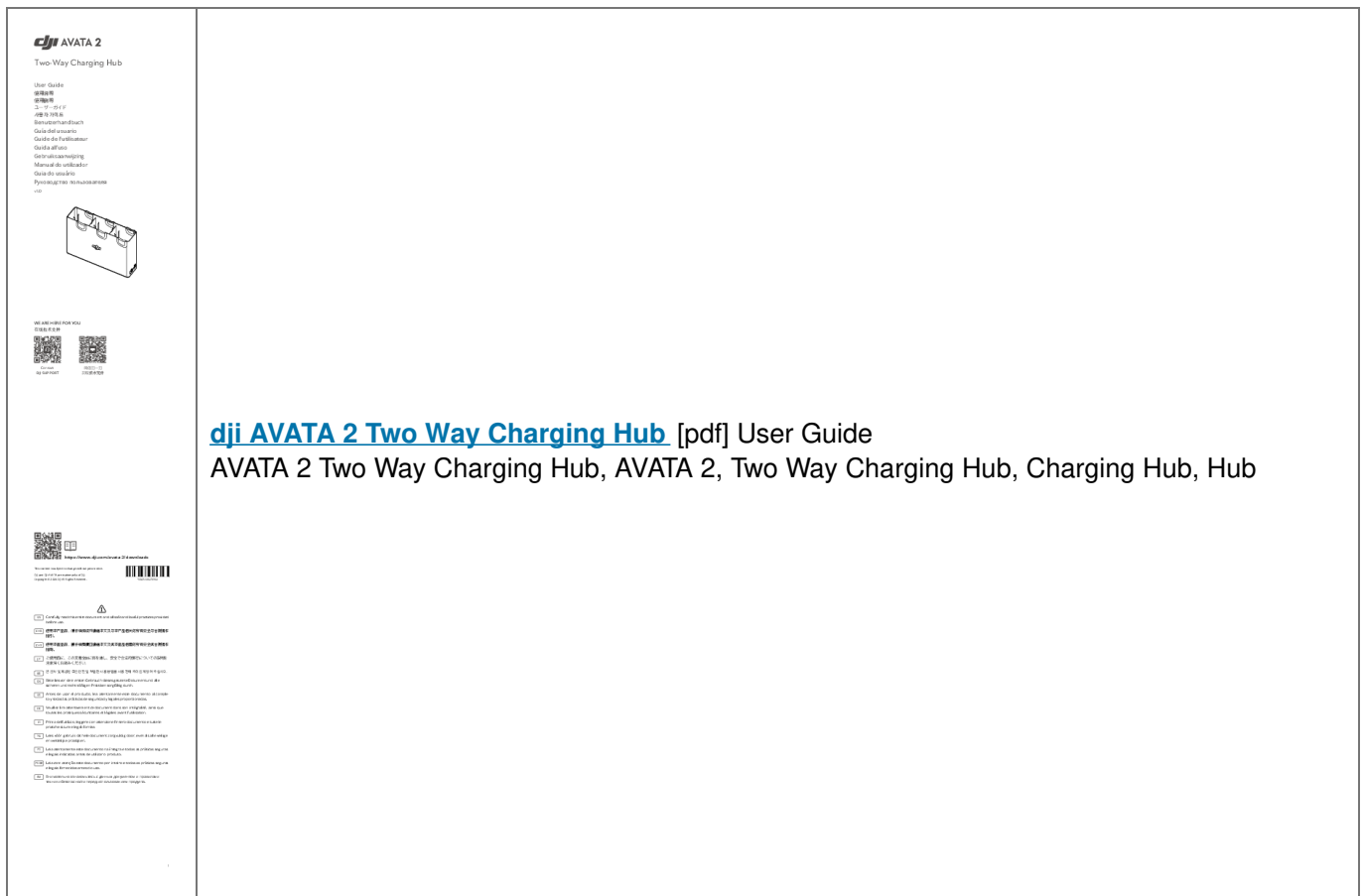

[dji AVATA 2 Two Way Charging Hub](#) [pdf] User Guide
AVATA 2 Two Way Charging Hub, AVATA 2, Two Way Charging Hub, Charging Hub, Hub

This website is an independent publication and is neither affiliated with nor endorsed by any of the trademark owners. The "Bluetooth®" word mark and logos are registered trademarks owned by Bluetooth SIG, Inc. The "Wi-Fi®" word mark and logos are registered trademarks owned by the Wi-Fi Alliance. Any use of these marks on this website does not imply any affiliation with or endorsement.